

SW 10TH ST. CONNECTOR

FDOT DISTRICT 4

**Waterford Homes & Waterford Courtyards
Project Overview**

October 25, 2022

Vanita Saini, P.E.
FDOT Project Manager



Ground Rules

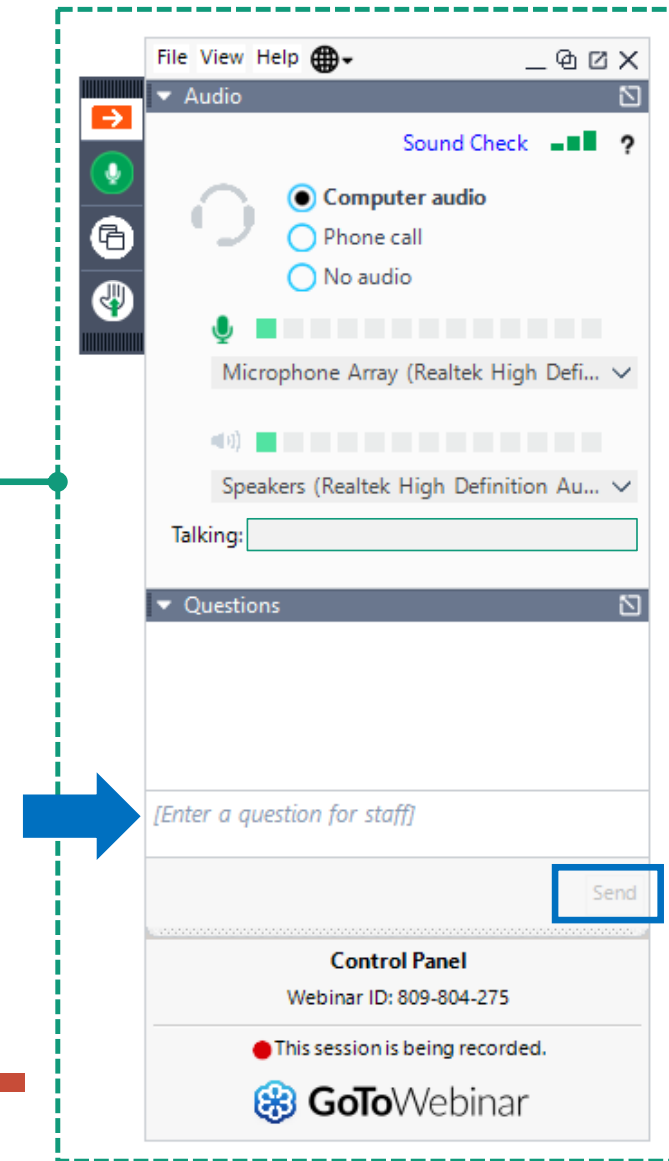
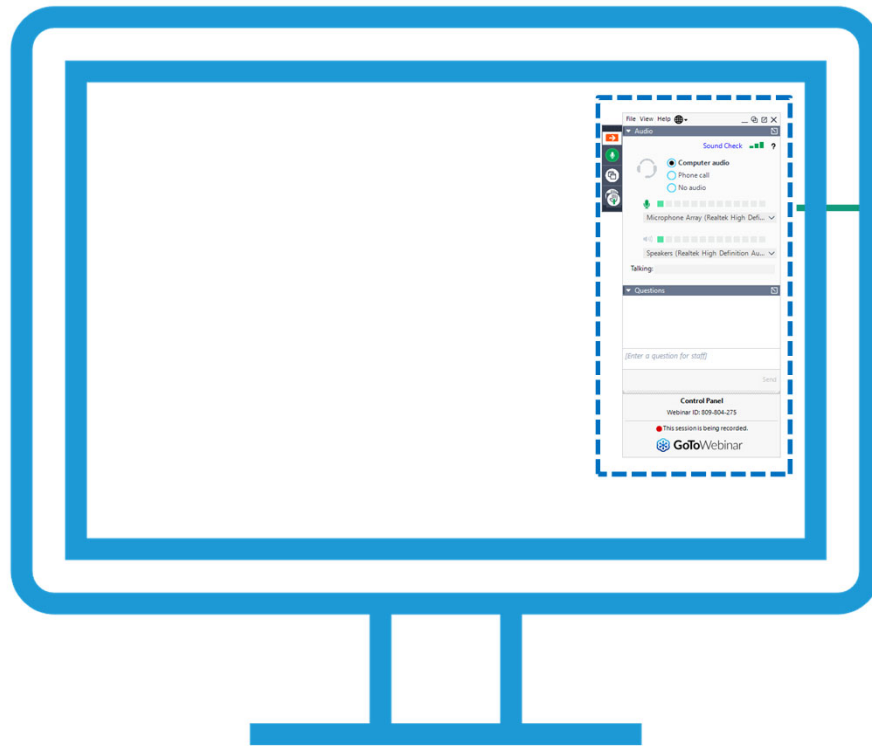

Title VI Non-Discrimination Statement and Contacts

The Florida Department of Transportation is required to comply with various non-discrimination laws and regulations, including Title VI of the Civil Rights Act of 1964. Public participation is solicited without regard to race, color, national origin, age, sex, religion, disability, or family status.

www.fdot.gov/equalopportunity/titlevicontacts.shtm

Persons wishing to express concerns about Title VI may do so by contacting either:

Sharon SinghHagyan,
District Four Title VI Coordinator

3400 W. Commercial Blvd. Ft. Lauderdale, FL 33309, (954) 777-4190,
Sharon.SinghHagyan@dot.state.fl.us
Toll Free: (866) 336-8435, ext. 4190

Aldrin T. Sanders,
Statewide Title VI Coordinator

605 Suwannee Street Tallahassee, FL 32399, (850) 414-4764,
Aldrin.Sanders@dot.state.fl.us
Toll Free: 866-374-3368, ext. 4764

Current Situation

- Why SW 10th Street Connector?
 - Original design vs. today's use
 - Safety and mobility needs of local and regional users
 - Quality of life and accessibility impacts
 - Movement of goods and services impacted by current corridor



Regional



Combined Project Limits

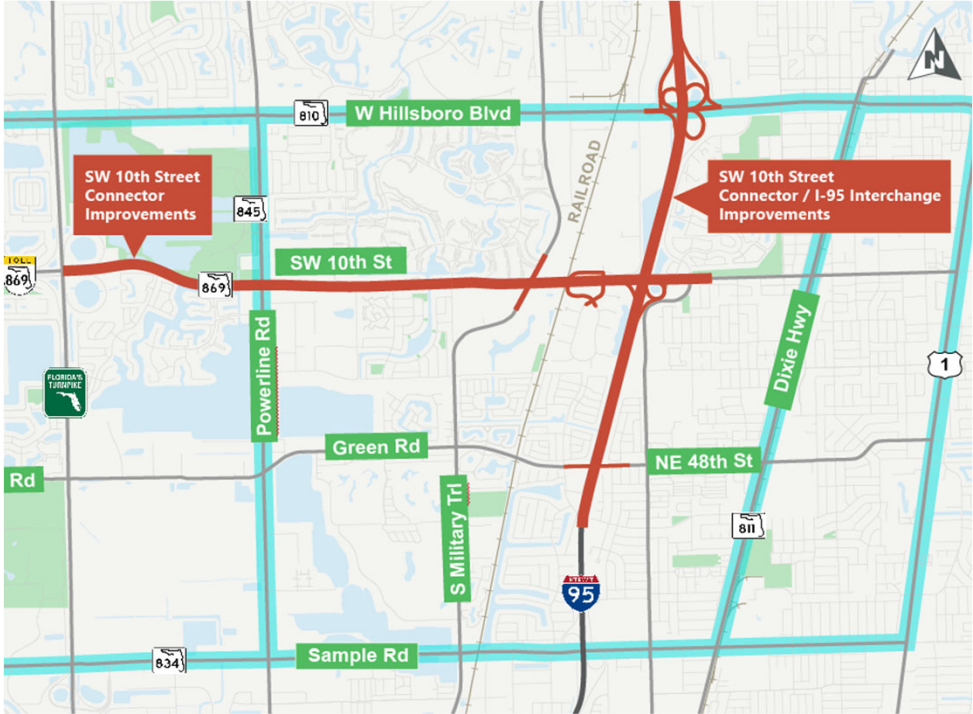

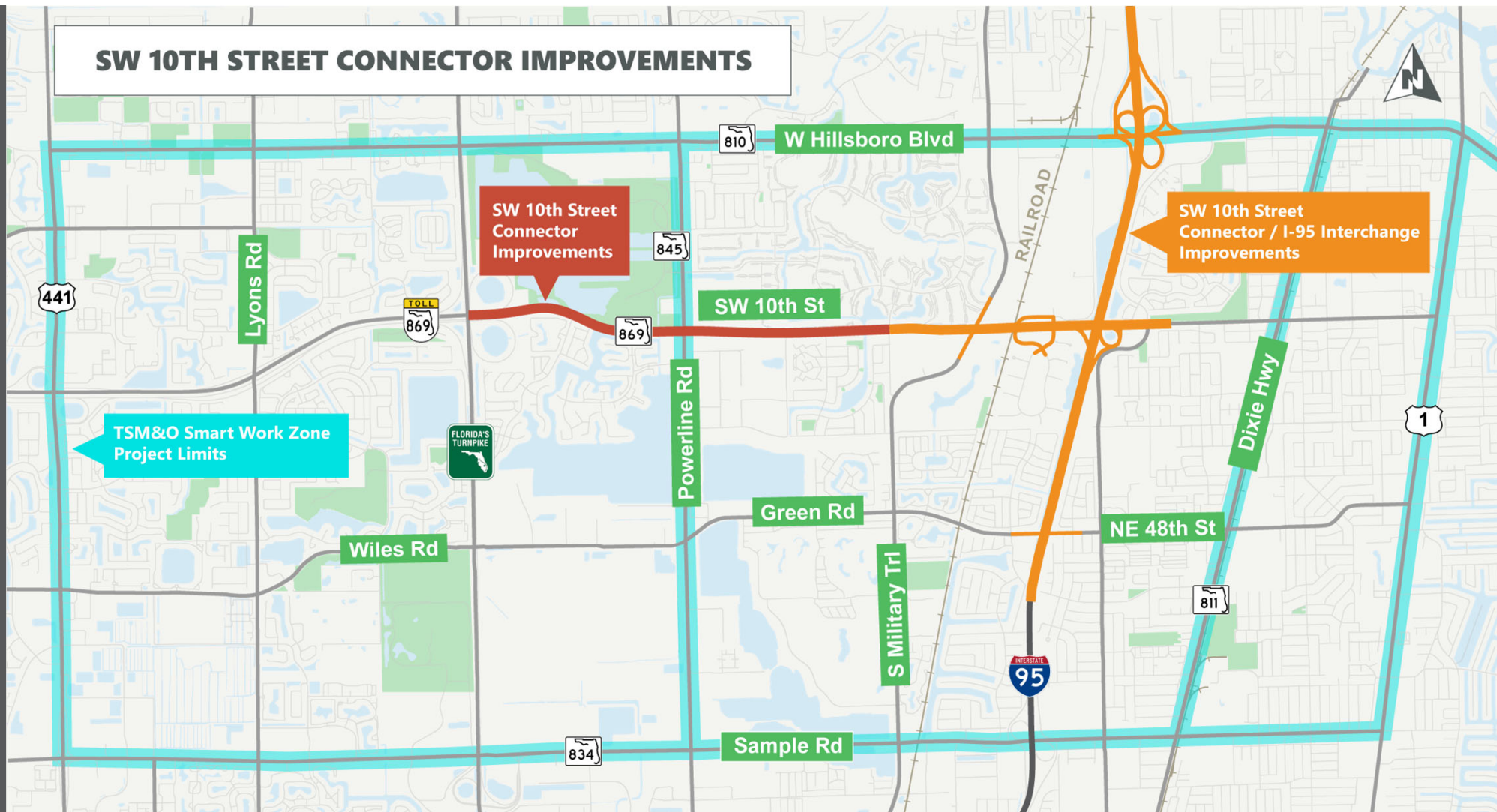

Vision



Your **safety, time, and quality of life** are priority



Providing residents, commercial traffic, and the region the **safe, efficient, and reliable transportation option** that has been promised for decades



Complete the missing link in the region's limited access and highway network

Innovations with YOU in Mind

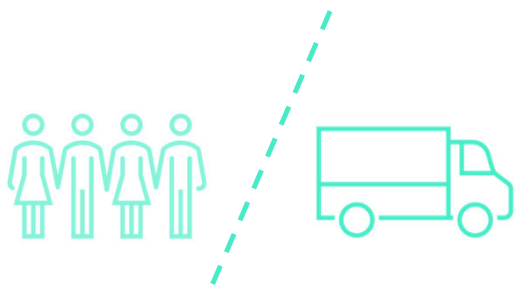

Separate the major highway traffic from the local residential and commercial/business traffic



Allow freight and commuter traffic and other non-local traffic to bypass the residential areas

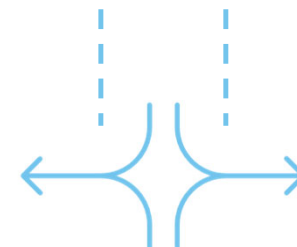

Innovatively improve several major cross-street arterial intersections

SW 10th Street Connector - Roadway

1 Local SW 10th Street

- Access for all Businesses and Residential Communities
- Lower Speed
 - (35 mph)
- Bicycle and Pedestrian Facilities

2 SW 10th Street Connector Lanes

- Regional Connection
- Higher Speed
 - (60 mph)
- Limited Access (No Tolls)
- Trucks Allowed

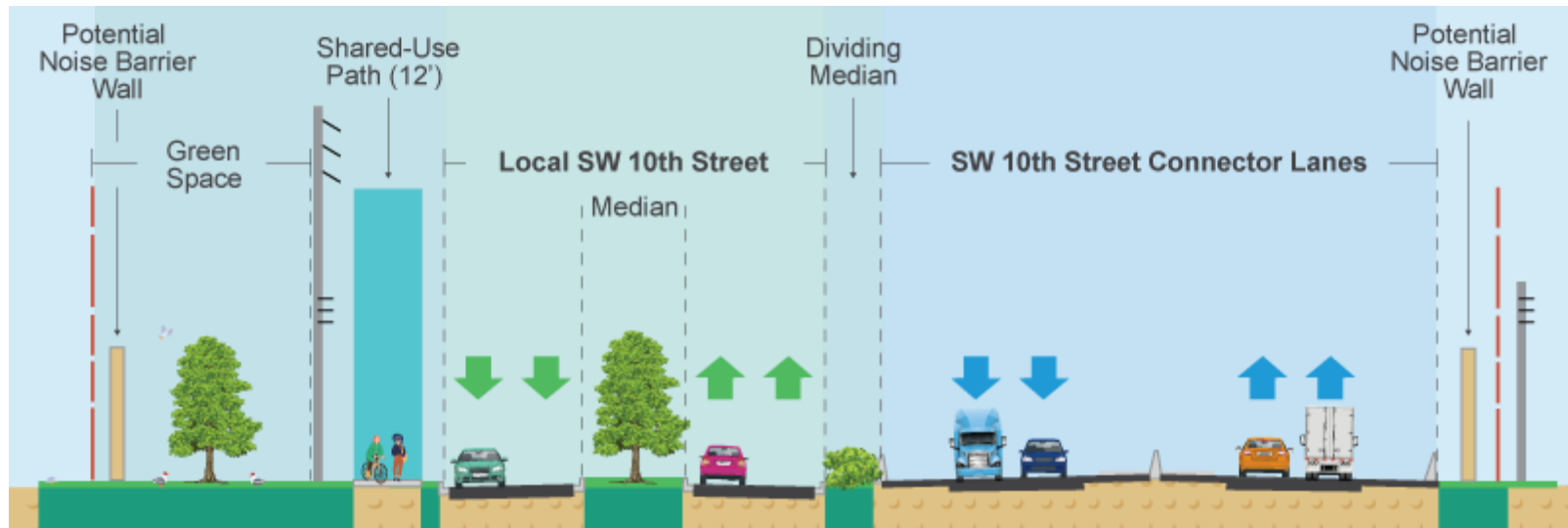

SW 10th St Connector Lanes / Local SW 10th St – Looking West



SW 10th Street Connector / I-95 Interchange: Looking West

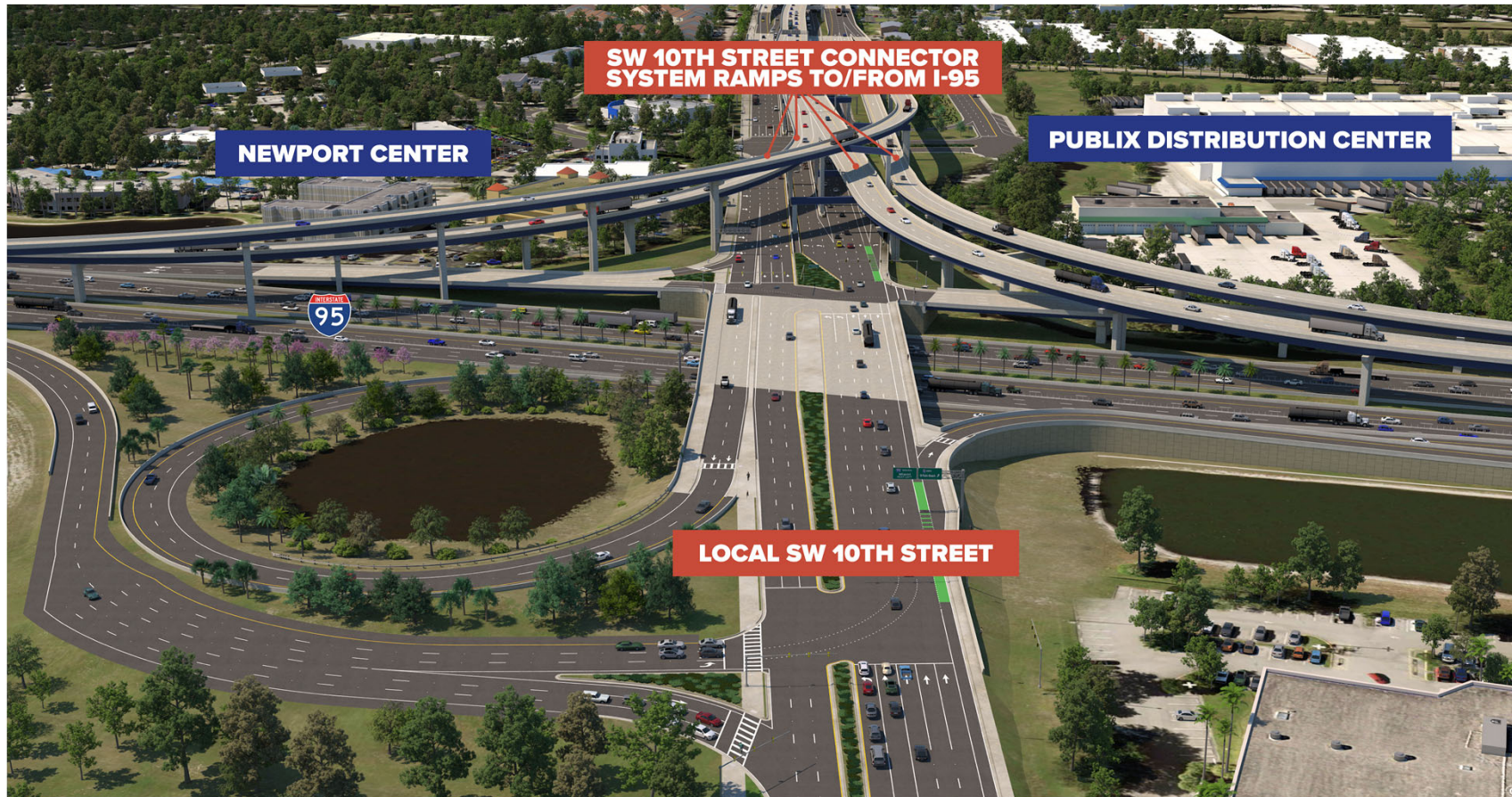

SW 10th Street Connector / I-95 Interchange at Military Trail



A safer, more connected South Florida region.

RETURNING SW 10TH STREET BACK TO THE LOCAL COMMUNITY



- Noise barrier walls
- Improved and landscaped green space
- 12'-wide shared-use path
- Aesthetic enhancements for retaining walls, noise barrier walls, bridge structures

Legend

- Blue Steel Bridges
- Green Steel Bridges
- Noise Barrier Walls
- Retaining Walls
- Enhanced Retaining Walls

- Schematic Representation
 - Noise Barrier Wall locations pending Public Outreach in Design Phase

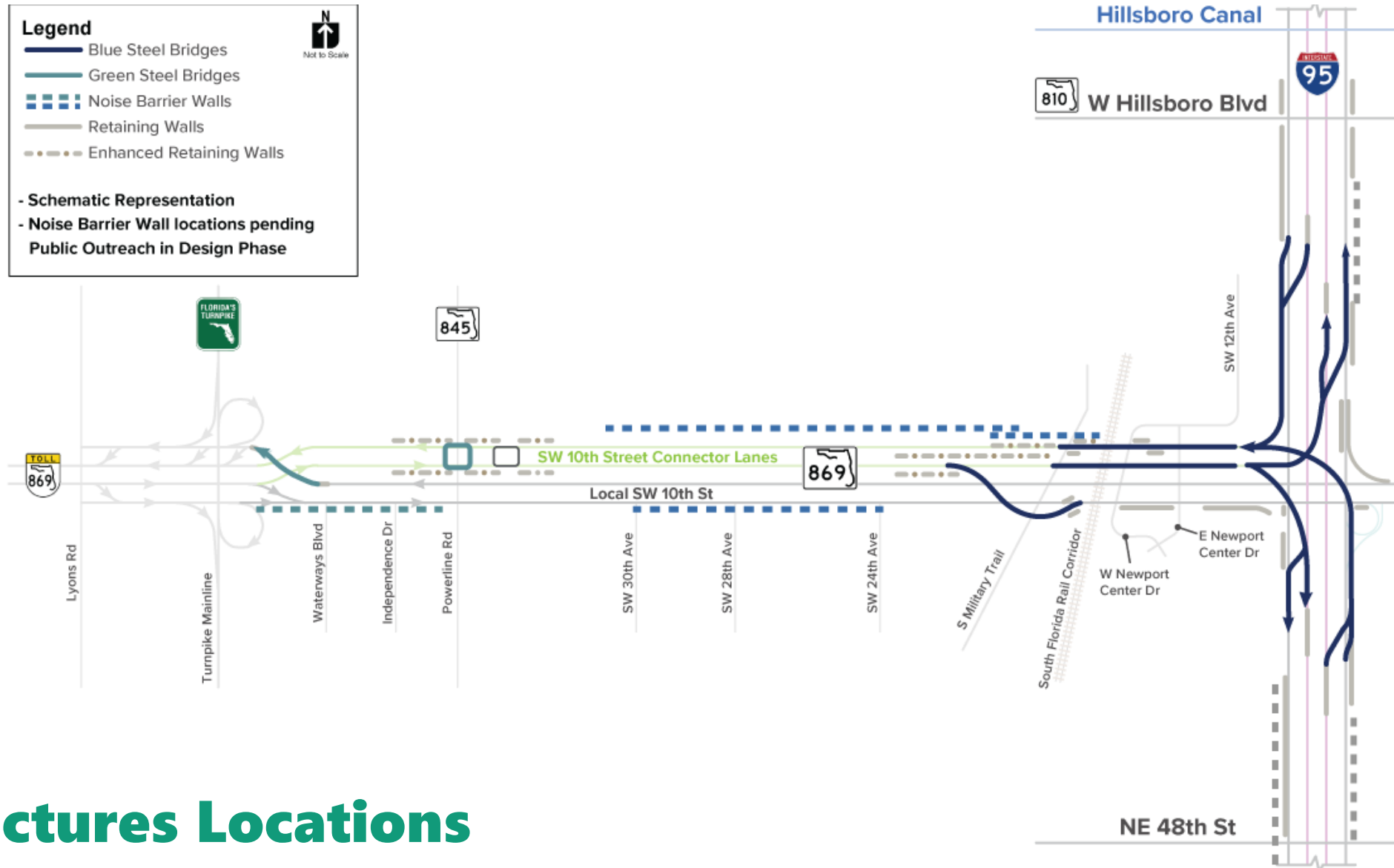

Structures Locations

Proposed Noise Barrier Walls

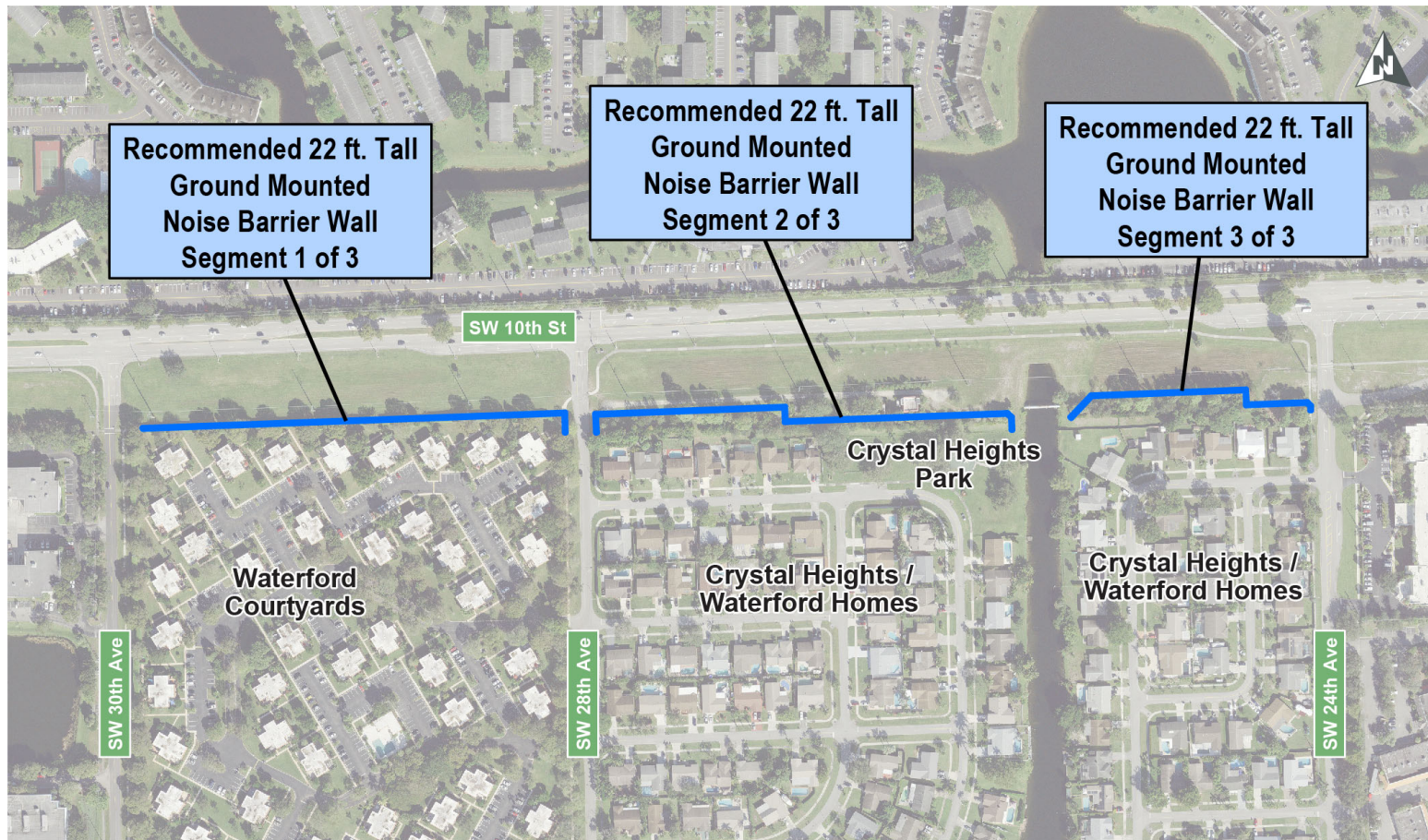

Existing Roadside Berm Area

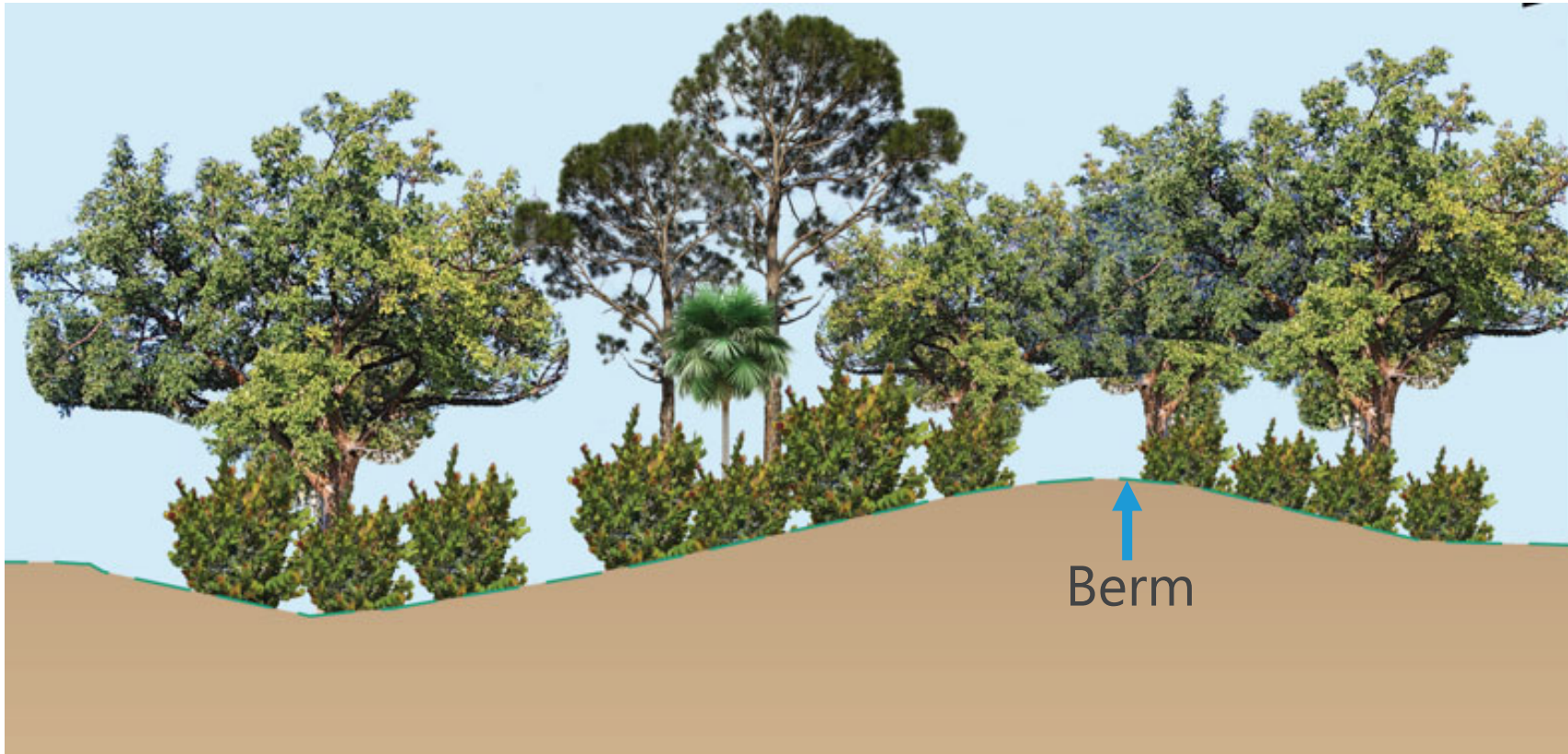

Existing Roadside and Swale / Berm Area Photos

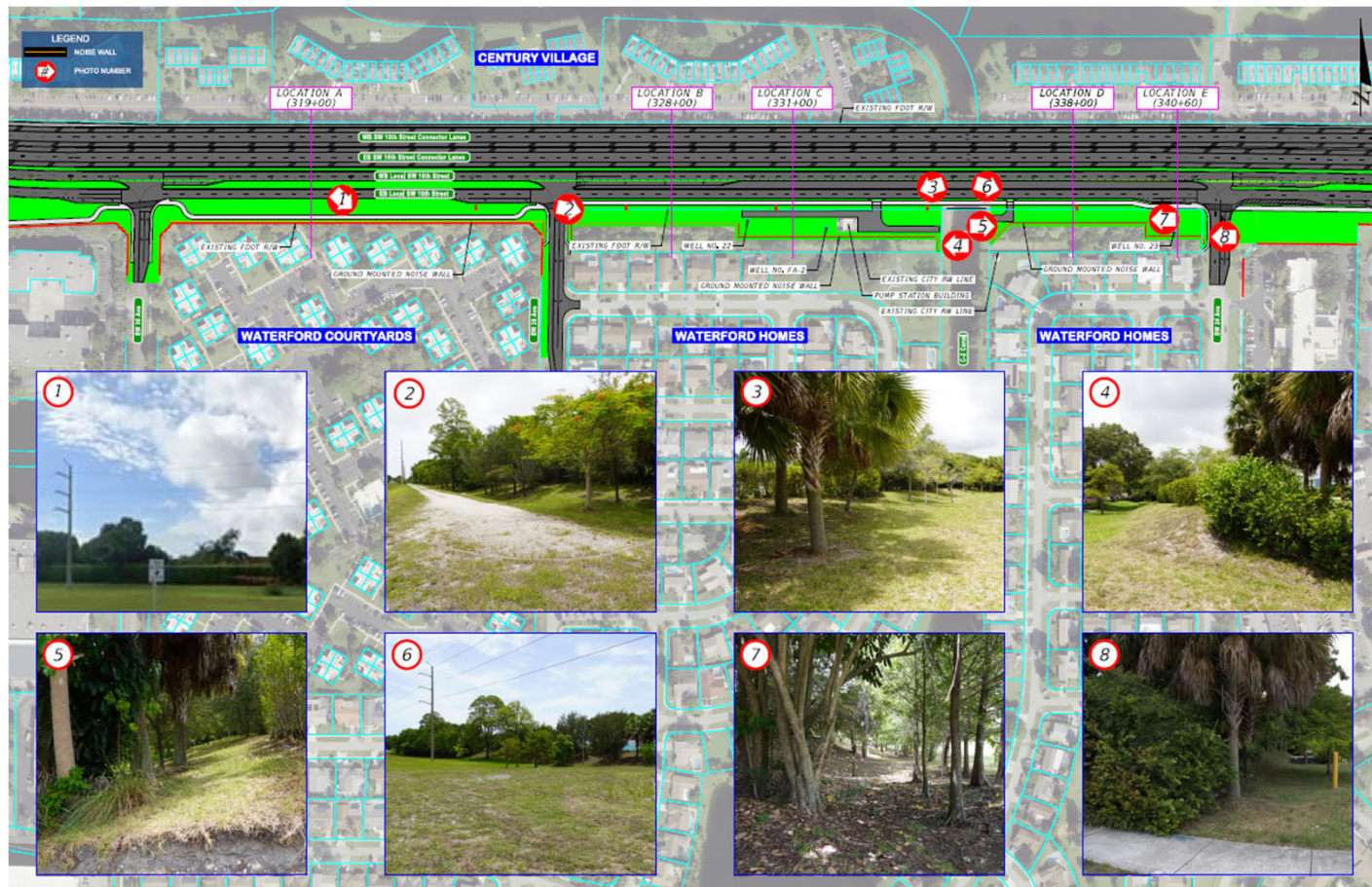

Location A - Existing Conditions Photos between SW 30th Avenue and SW 28th Avenue

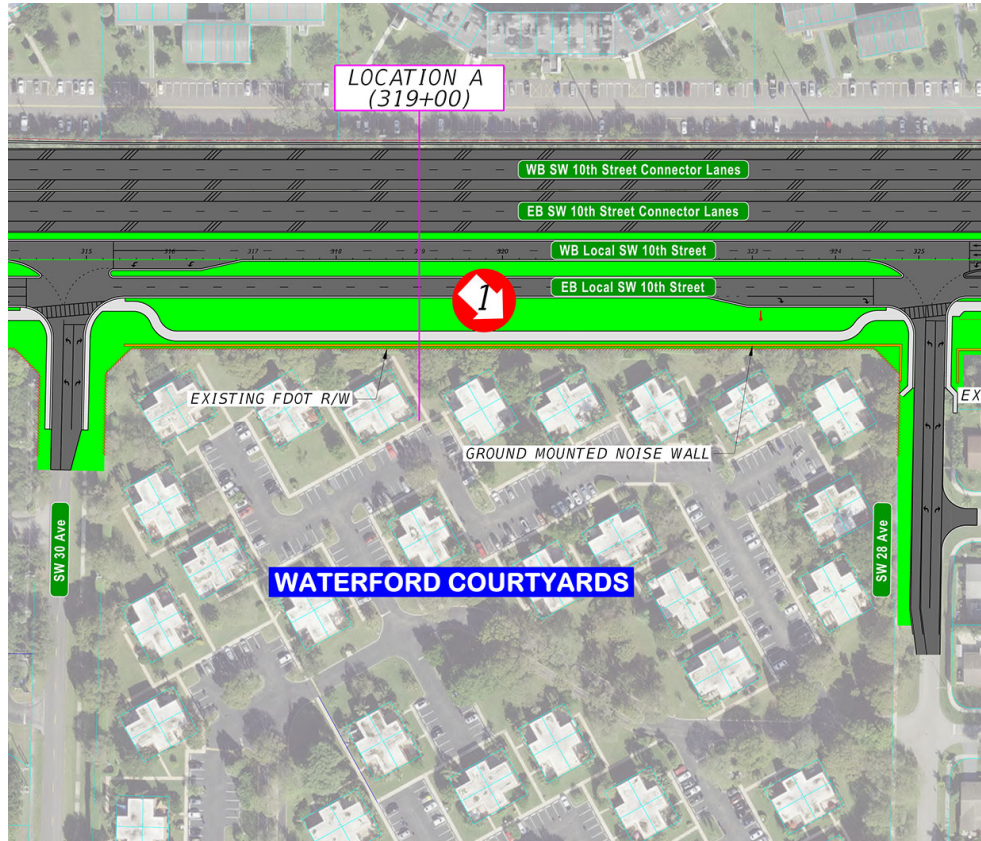

Location A – Existing Conditions between SW 30th Avenue and SW 28th Avenue

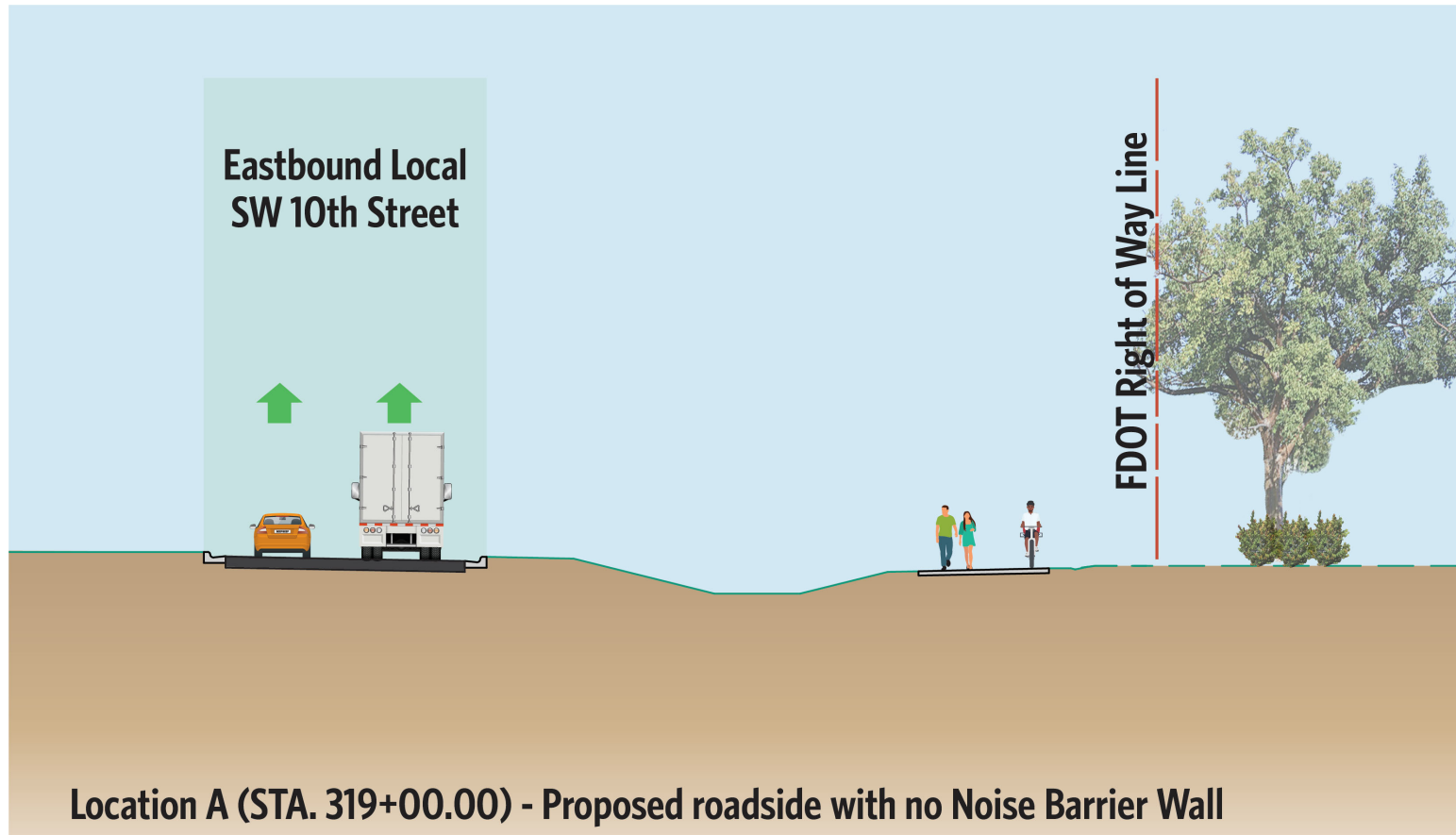

Location A – Proposed Noise Barrier Wall Option between SW 30th Avenue and SW 28th Avenue

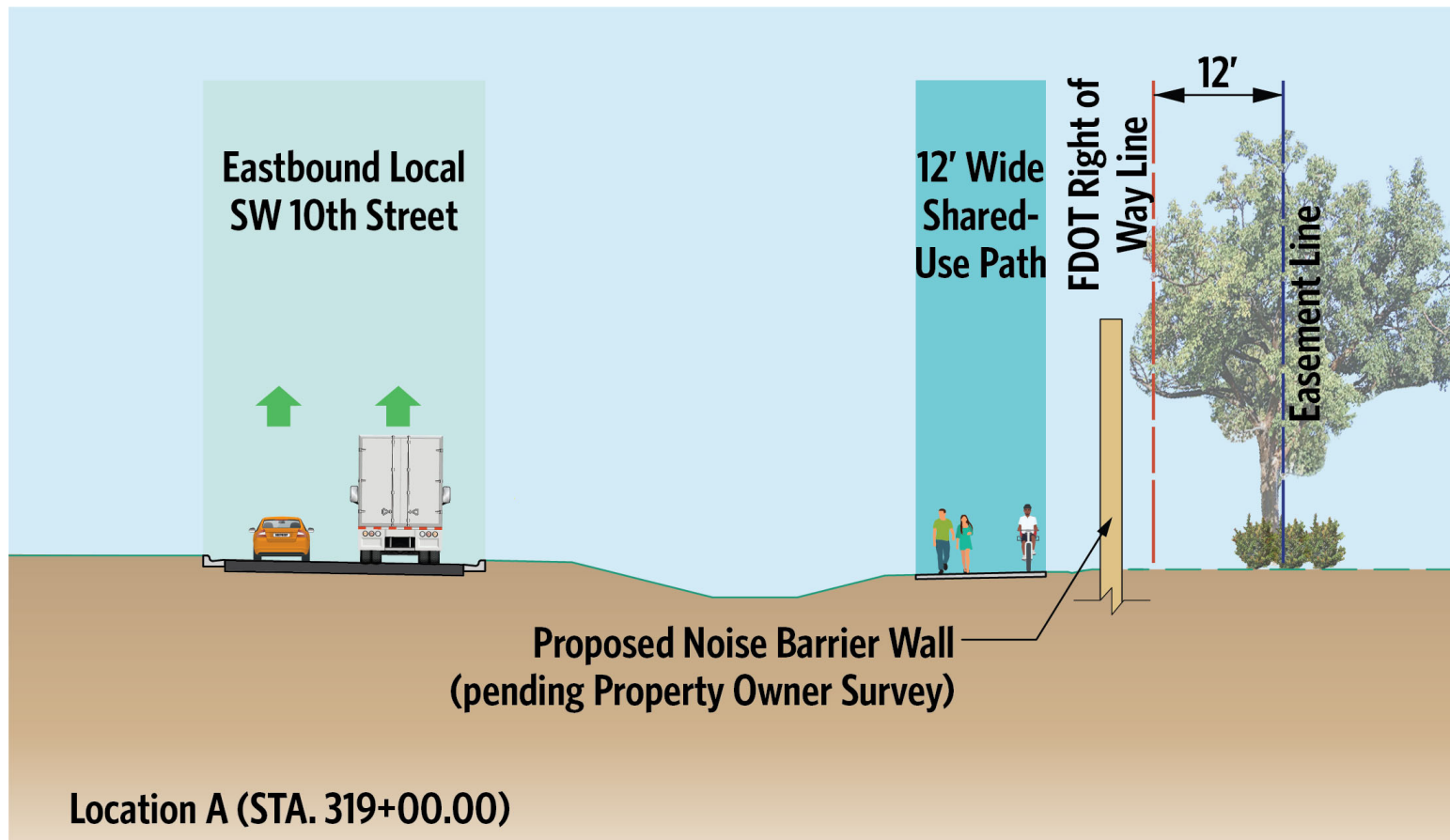

Location B - Existing Conditions Photos

Just east of SW 28th Avenue

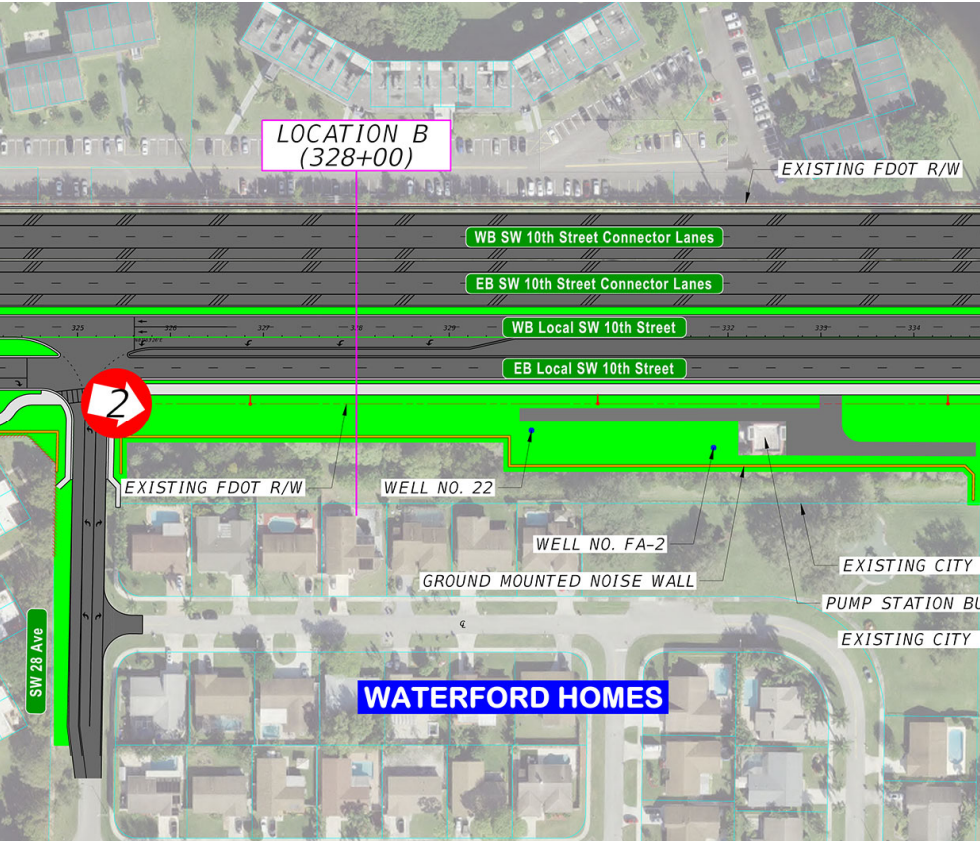

Location B – Proposed No Noise Barrier Wall Option

Just east of SW 28th Avenue

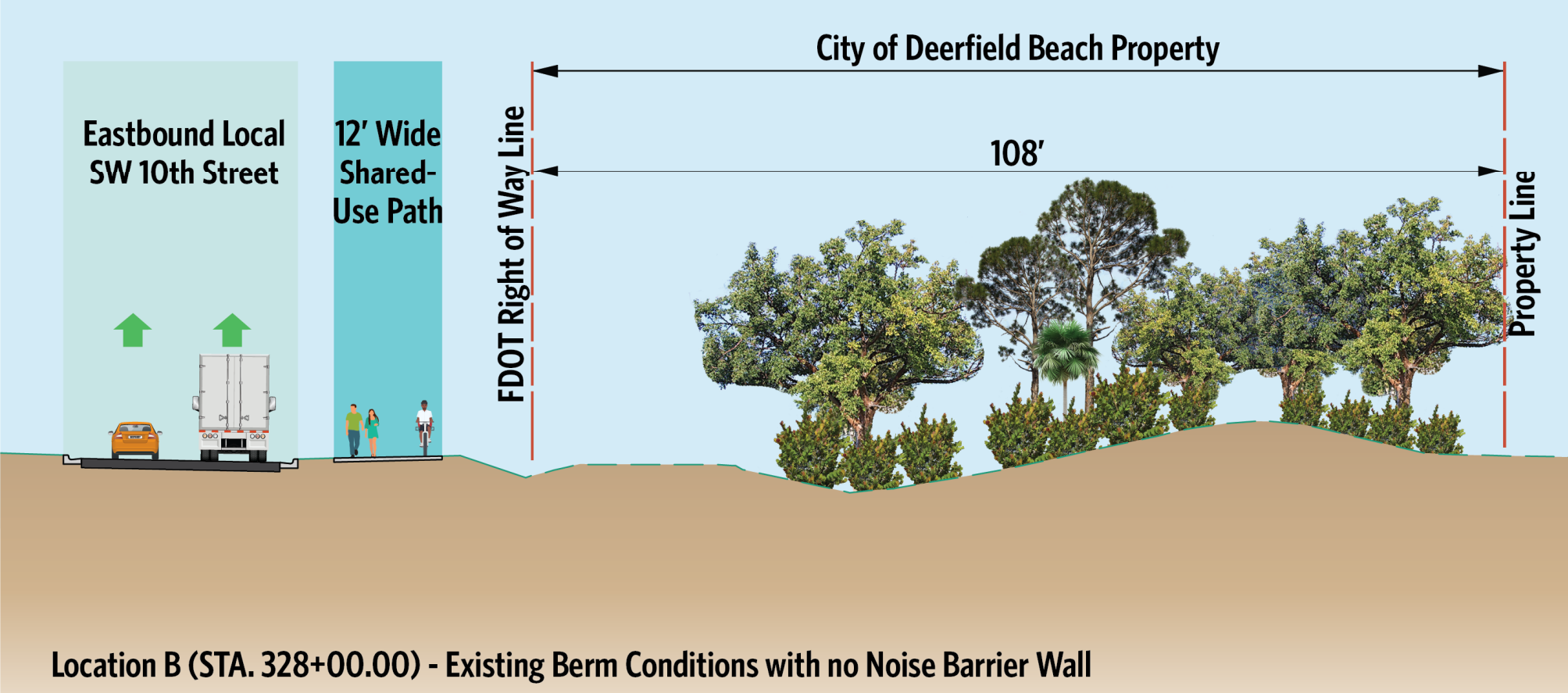

Location B – Proposed Option 1
Just east of SW 28th Avenue

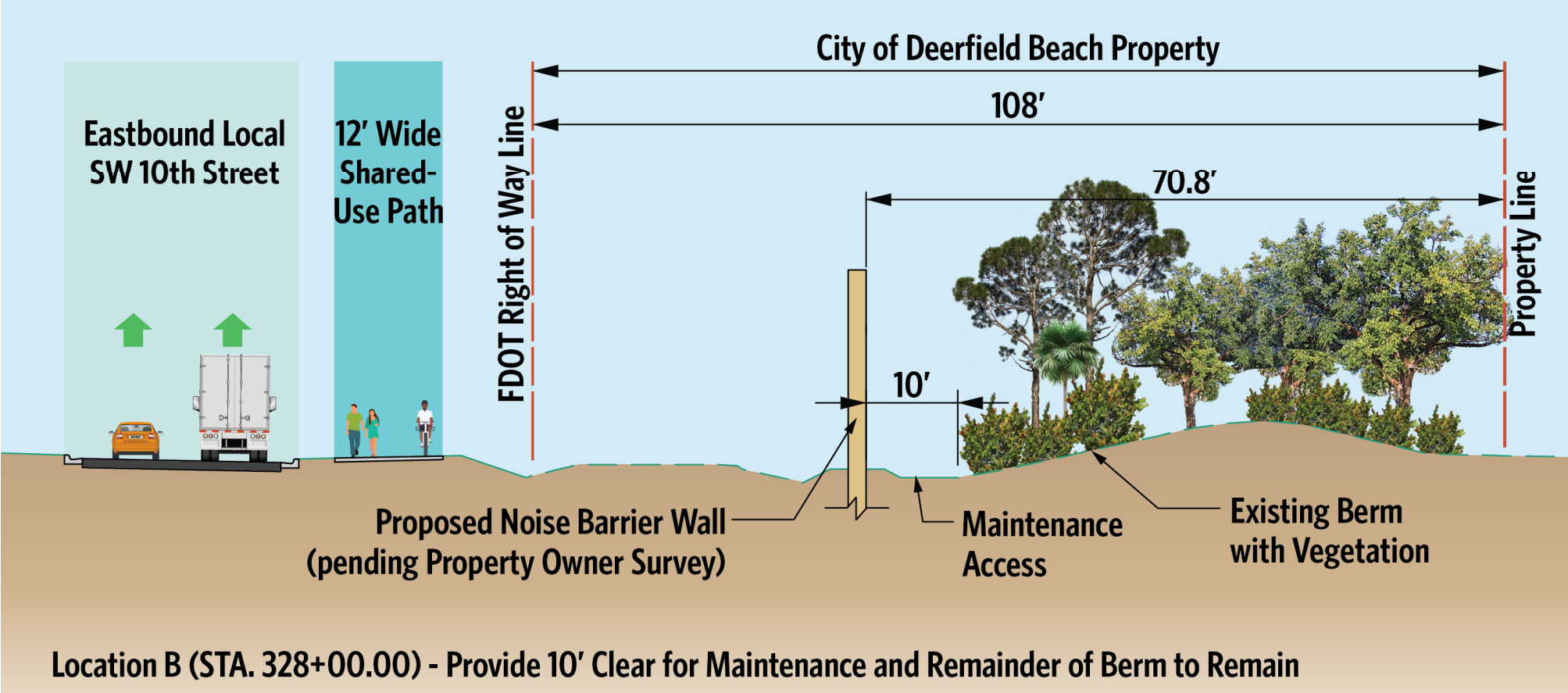

Location B – Proposed Option 2

Just east of SW 28th Avenue

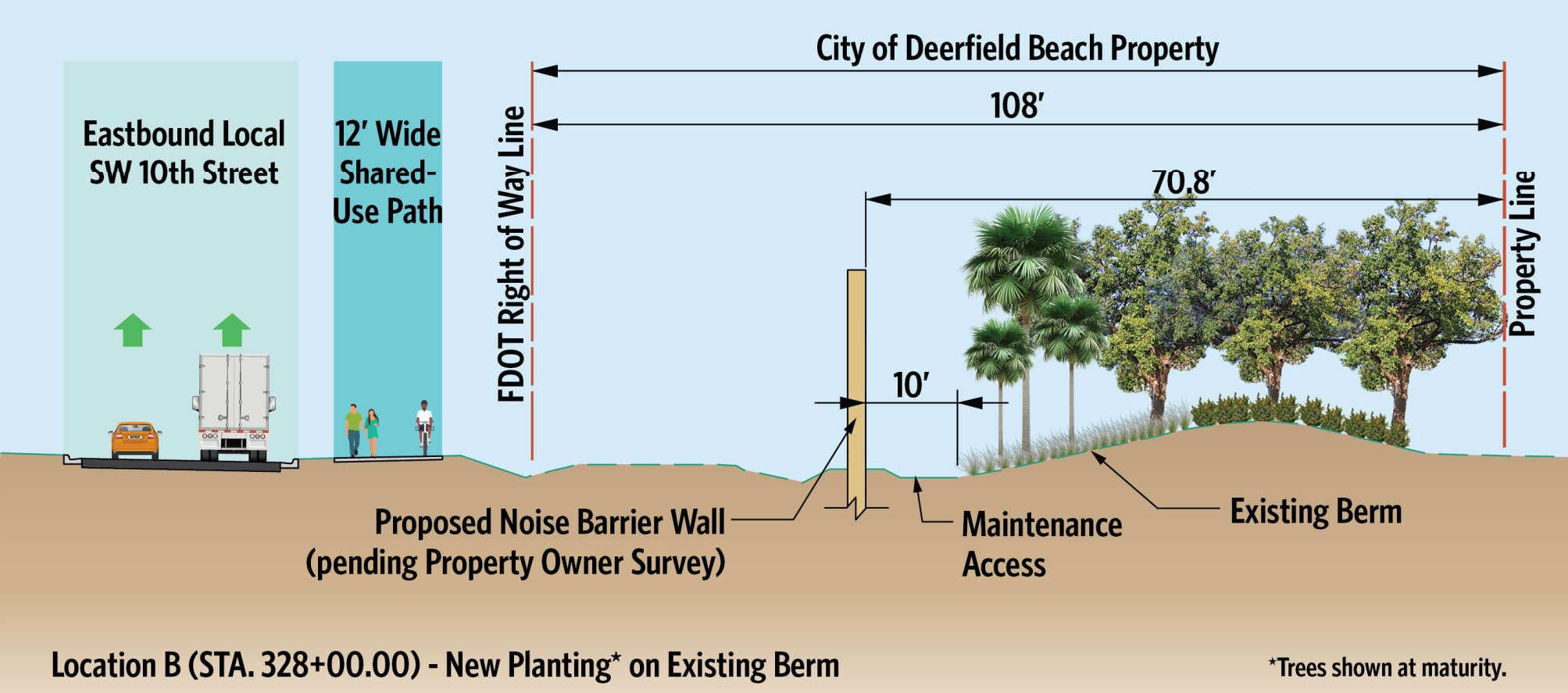

Location B – Proposed Option 3
Just east of SW 28th Avenue

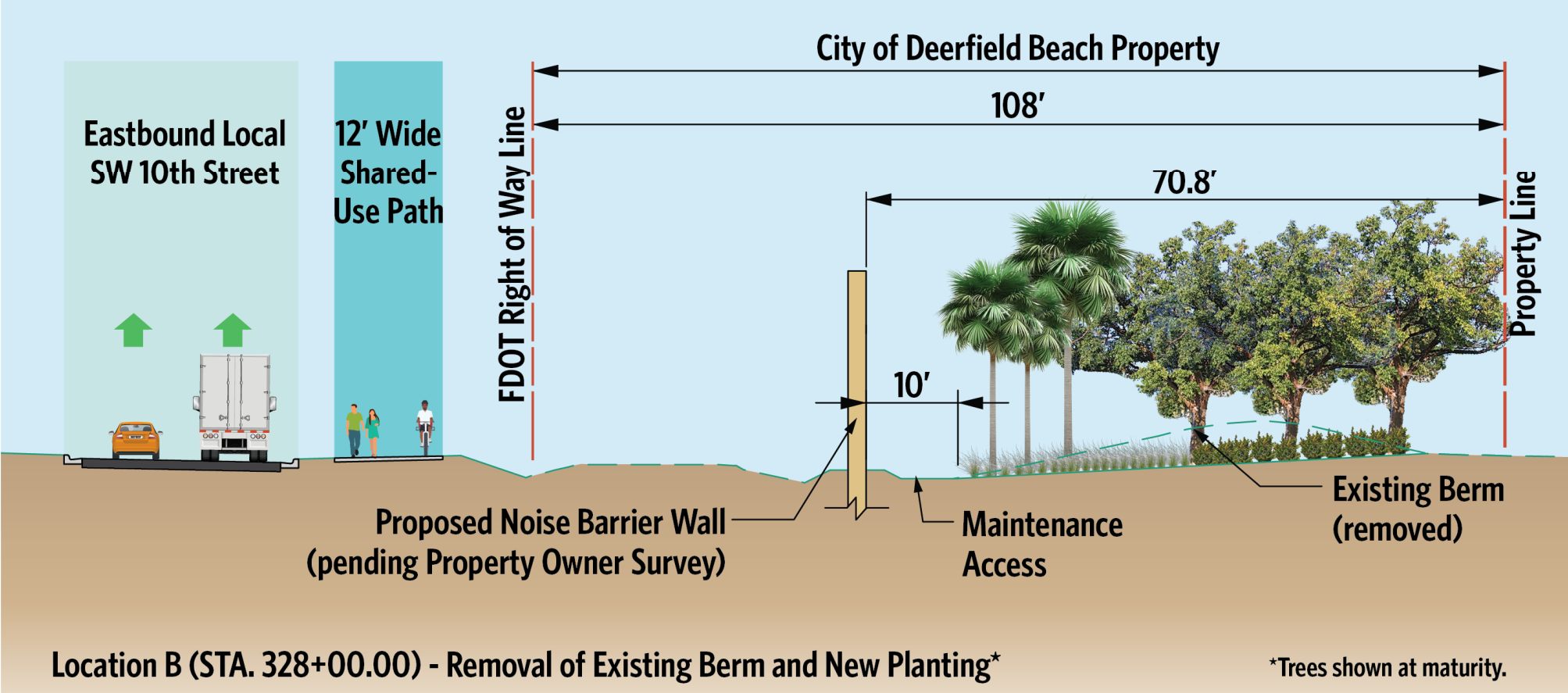

Location C - Existing Conditions Photos

Between SW 28th Avenue and C-2 Canal

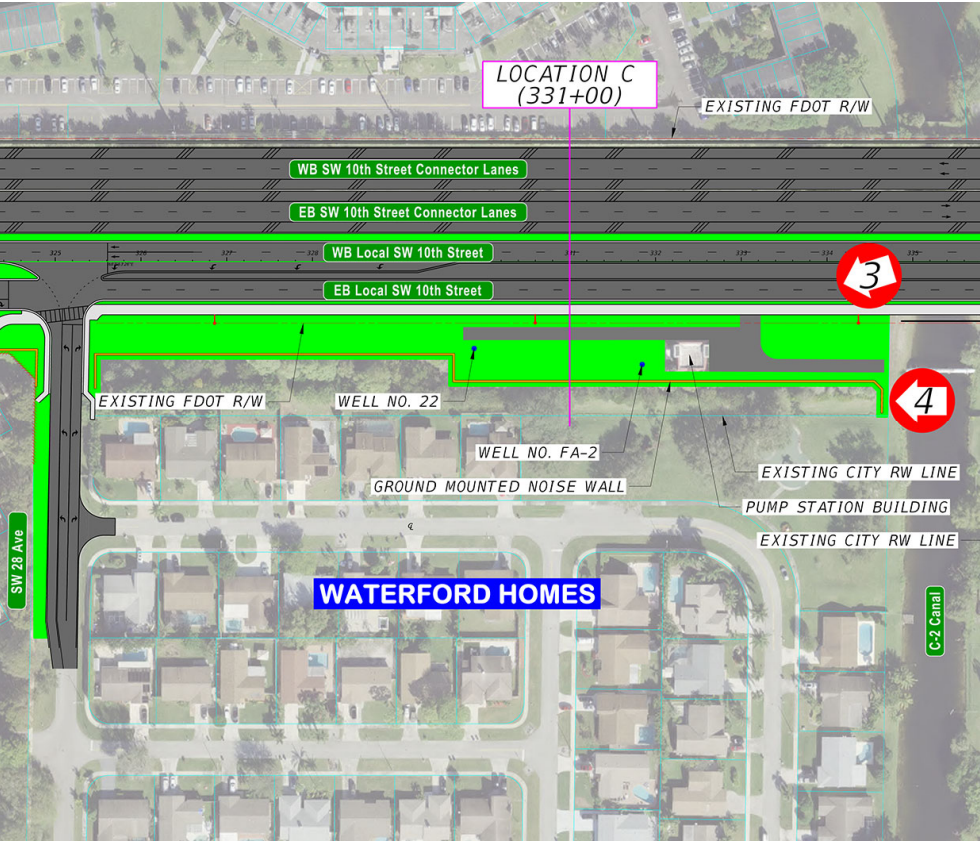

Location C - Proposed No Noise Barrier Wall Option

Between SW 28th Avenue and C-2 Canal

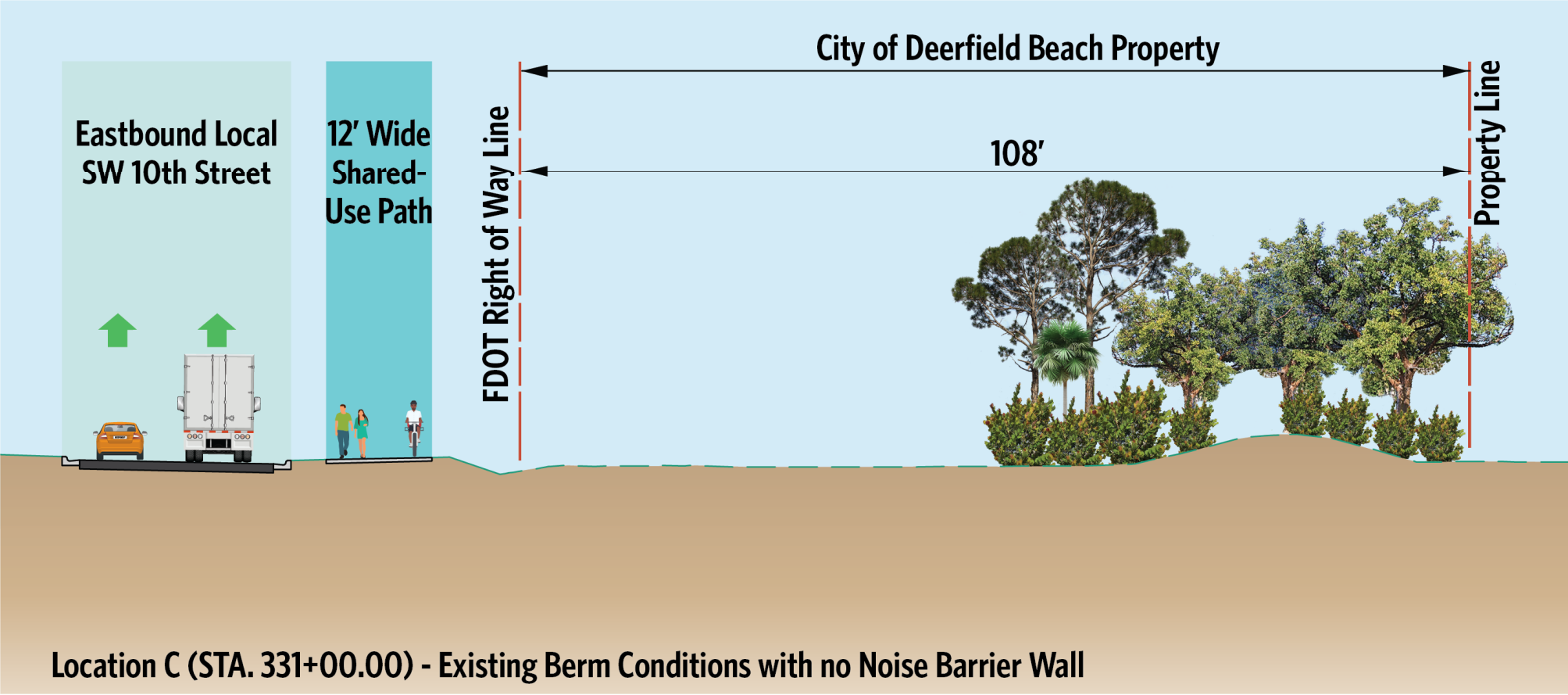

Location C (STA. 331+00.00) - Existing Berm Conditions with no Noise Barrier Wall

Location C – Proposed Option 1

Between SW 28th Avenue and C-2 Canal

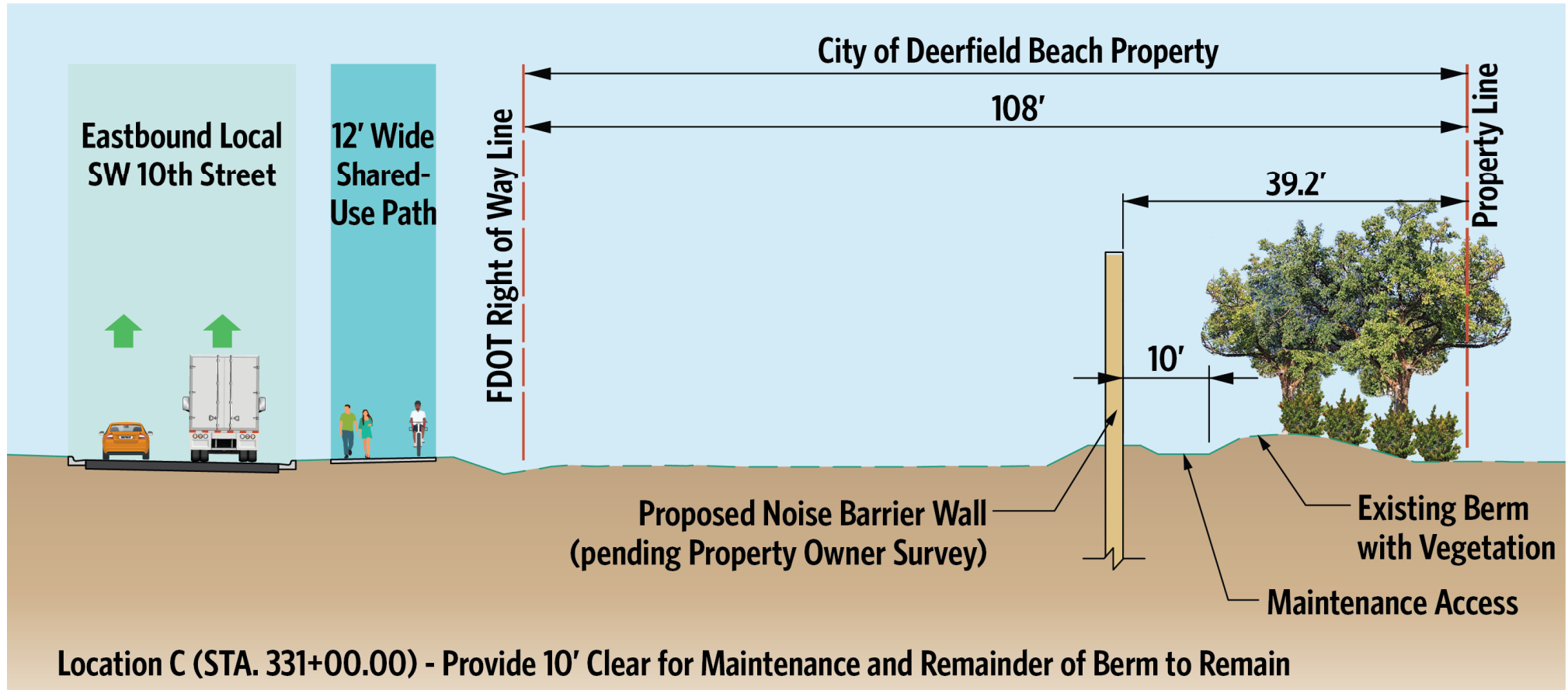

Location C – Proposed Option 2

Between SW 28th Avenue and C-2 Canal

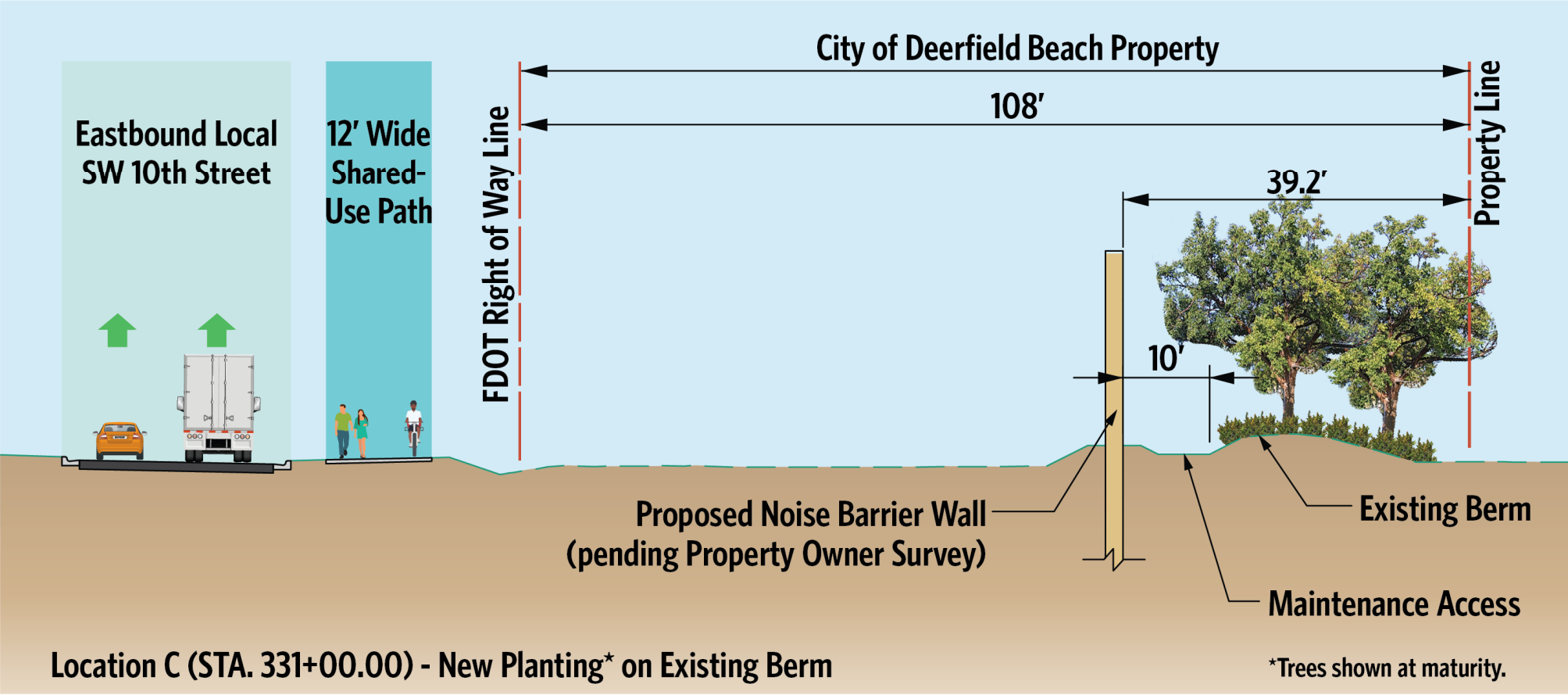

Location C – Proposed Option 3

Between SW 28th Avenue and C-2 Canal

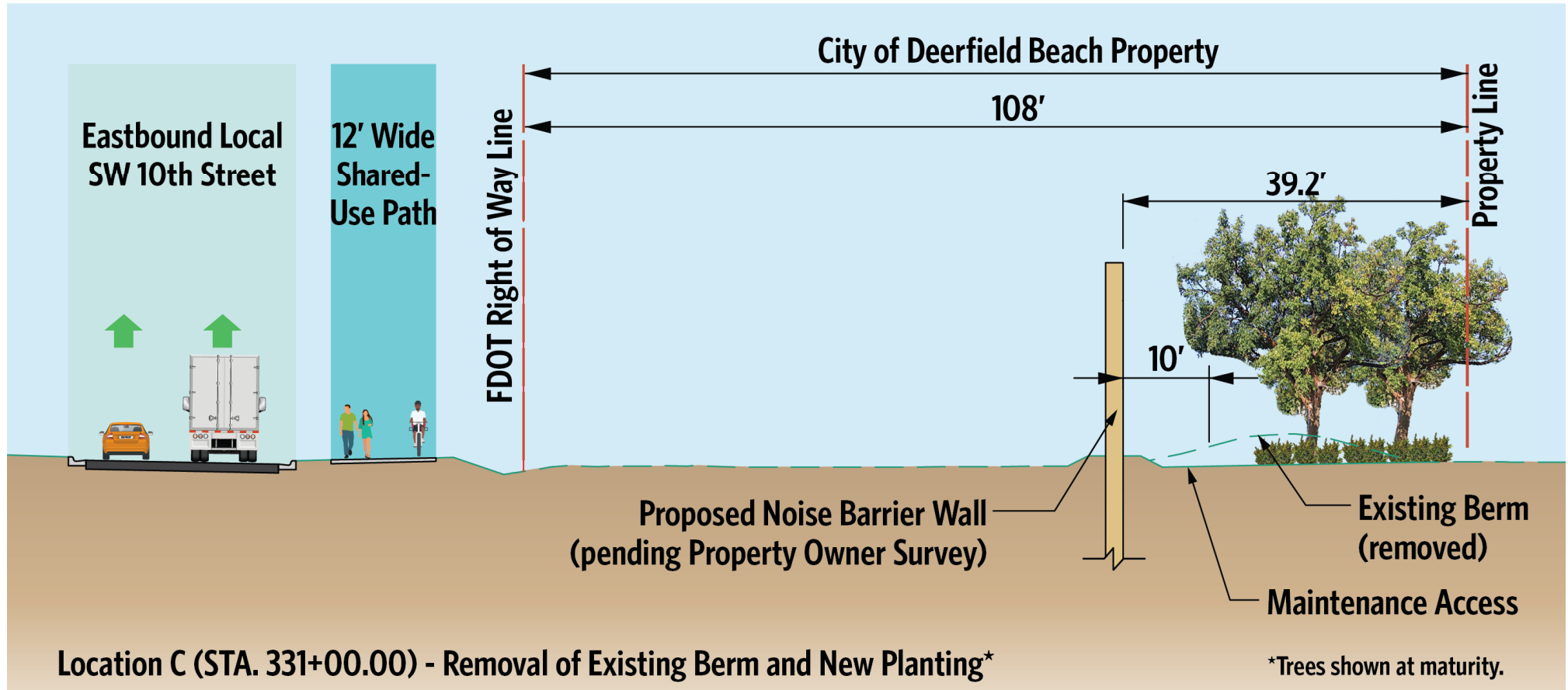

Legend

- Blue Steel Bridges
- Green Steel Bridges
- Noise Barrier Walls
- Retaining Walls
- Enhanced Retaining Walls

- Schematic Representation
- Noise Barrier Wall locations pending Public Outreach in Design Phase

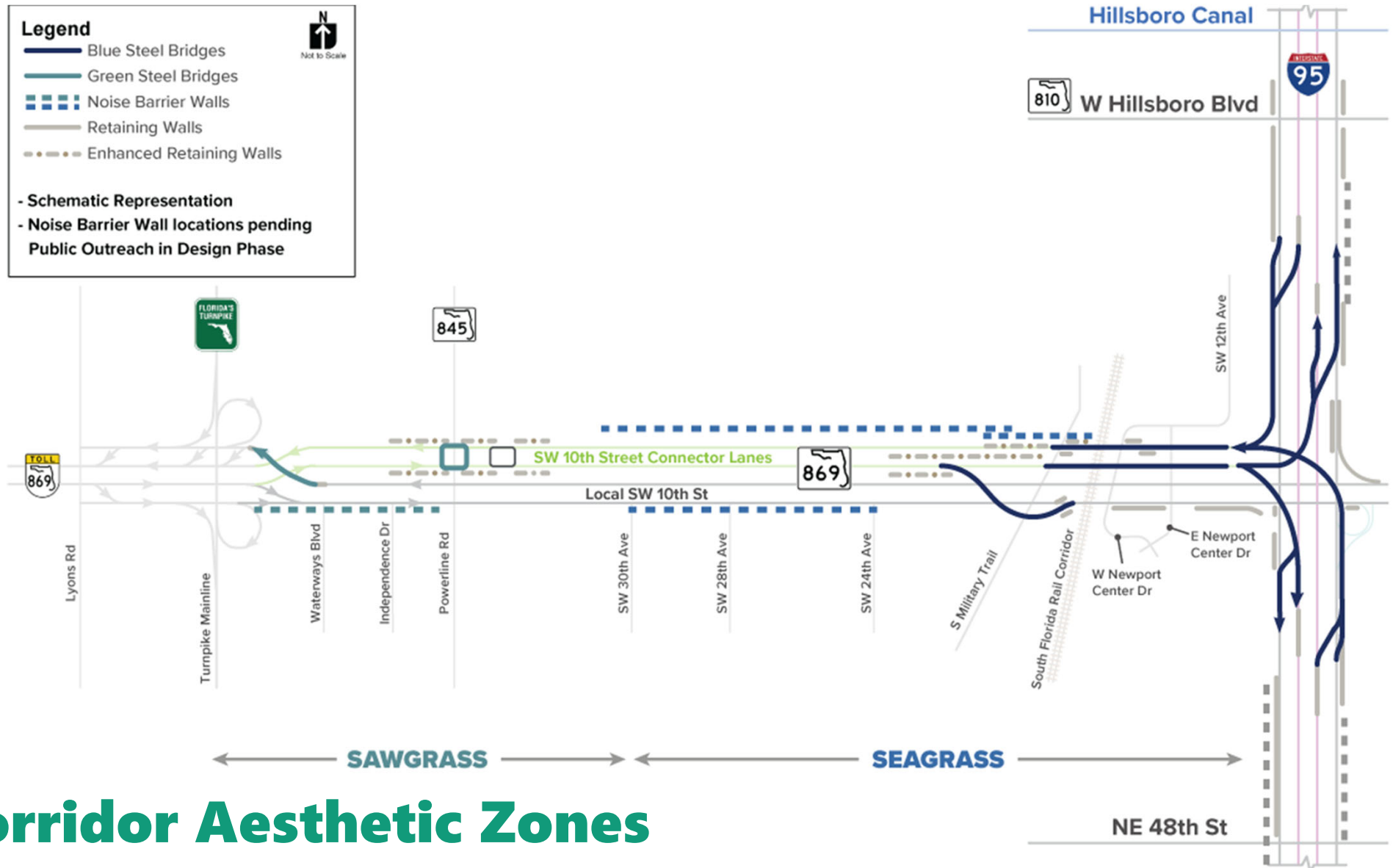

Corridor Aesthetic Zones

Sawgrass



Working inland from the **breathhtaking coastline** of the Atlantic Ocean to the **vast wetlands and marshes** of western Broward County.

Seagrass



Inspired by the miles of **beautiful Atlantic Ocean shoreline.**

Color Options

STEEL BRIDGE COLOR OPTIONS (GIRDERS & STRADDLES)



Federal Standard 15052

Federal Standard 15193

CONCRETE COLOR OPTIONS (WALLS, PIERS, & MSE WALLS)

Option 1



Federal Standard 16440

FDOT Standard Tex Cote
Sandalwood

Federal Standard 15123

Federal Standard 15193

Option 2



Federal Standard 16440

FDOT Standard Tex Cote
Sandalwood

Federal Standard 15177

Federal Standard 15193

Sawgrass Conceptual Noise Barrier Walls

SAWGRASS OPTION 1 (Federal Standard 15193 / FDOT Standard Tex Cote Sandalwood)



SAWGRASS OPTION 2 (Federal Standard 15193 / FDOT Standard Tex Cote Sandalwood)



SAWGRASS OPTION 3 (Federal Standard 15193 / FDOT Standard Tex Cote Sandalwood)



Seagrass Conceptual Noise Barrier Walls

SEAGRASS OPTION 1 (Federal Standard 15123 / FDOT Standard Tex Cote Sandalwood)

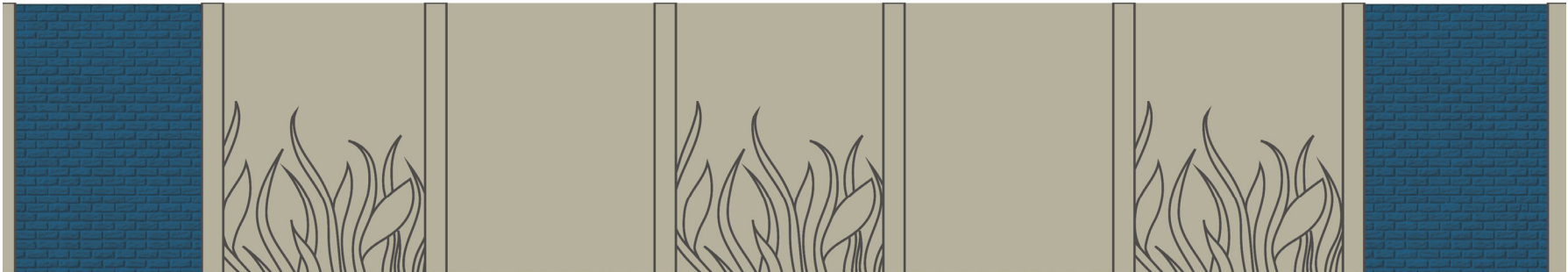

SEAGRASS OPTION 2 (Federal Standard 15123 / FDOT Standard Tex Cote Sandalwood)

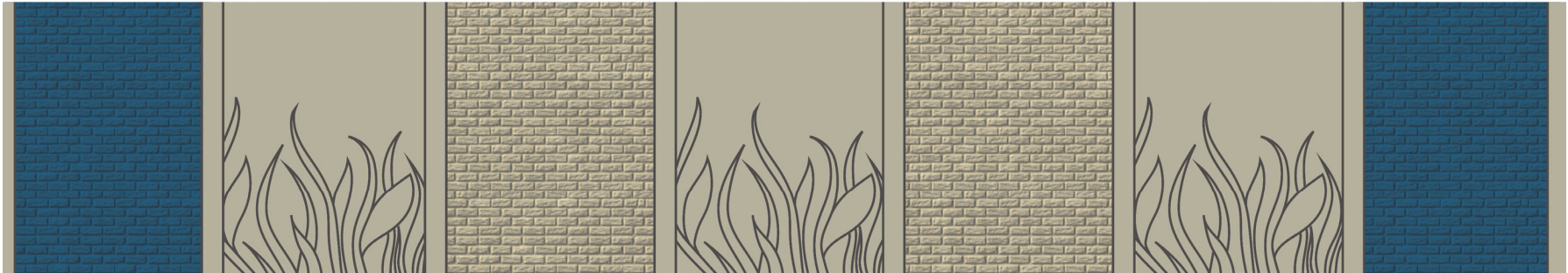

Seagrass Conceptual Noise Barrier Walls

SEAGRASS OPTION 1 (Federal Standard 15177 / FDOT Standard Tex Cote Sandalwood)



SEAGRASS OPTION 2 (Federal Standard 15177 / FDOT Standard Tex Cote Sandalwood)

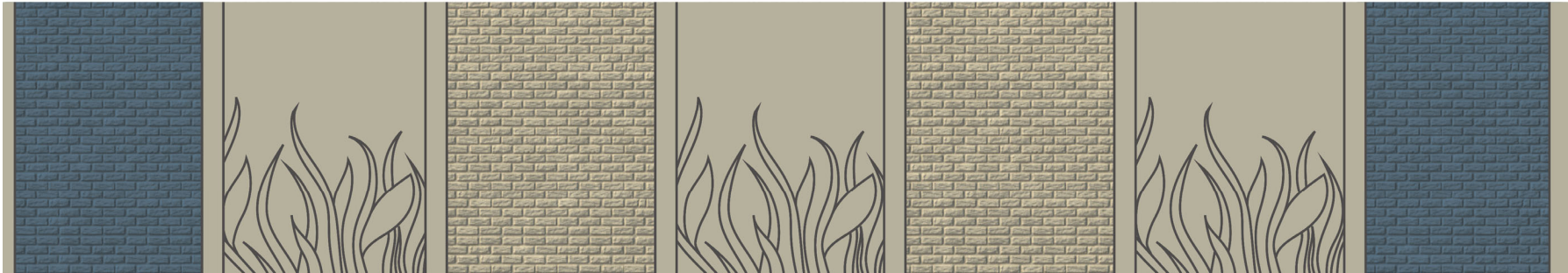

MSE Retaining Walls

Examples of existing MSE (Mechanically Stabilized Earth) retaining walls currently in use throughout the state:



MSE Retaining Walls

Recommended MSE Retaining Wall Texture Options



MSE walls will use Federal Standard 16440 as a primary color with additional color options included in architectural enhancements.



Ashlar Stone



Cut Coral Block



Smooth Brick

MSE Architectural Enhancements

Representative examples only – final architectural design pending

Option 1: Traditional

Colors to change based on location

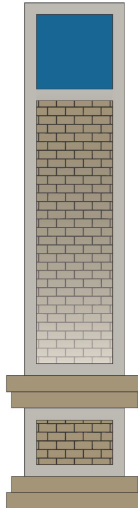
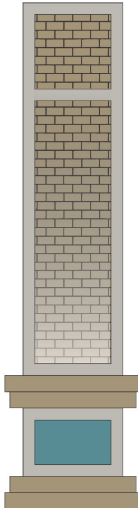
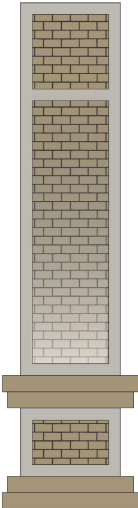

Option 1a:
Traditional

Option 1b:
2-Tone with
Color Splash

Option 1c:
2-Tone with Top
Color Splash

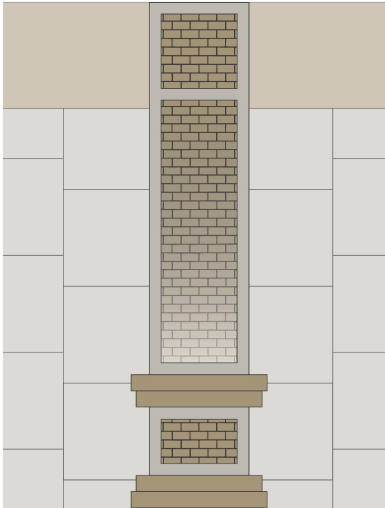

Enhancement
example positioned
on MSE wall

Option 2: Modern

Colors to change based on location

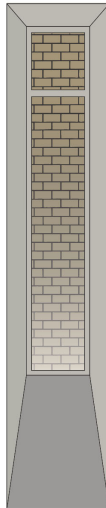
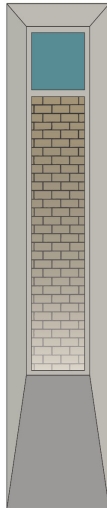
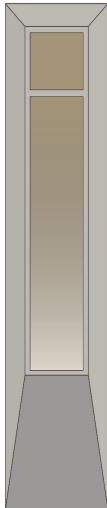

Option 2a:
Modern

Option 2b:
Modern 2-Tone
& Color Splash

Option 2c:
Modern
2-Tone

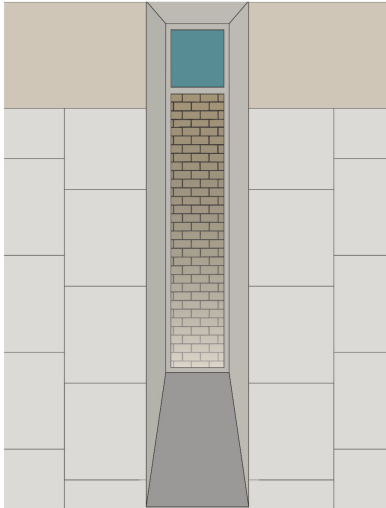

Enhancement
example positioned
on MSE wall

Bridge Pier & Pier Base Options

BRIDGE PIERS

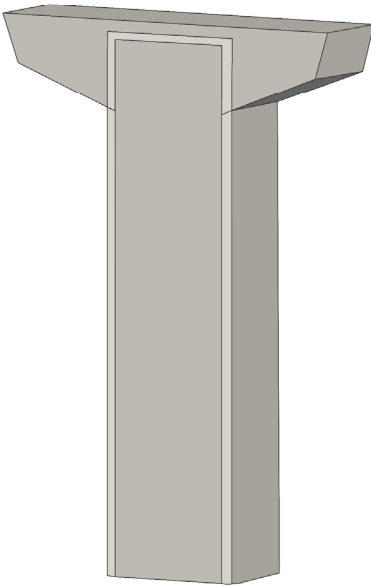

Option 1: Plain Concrete

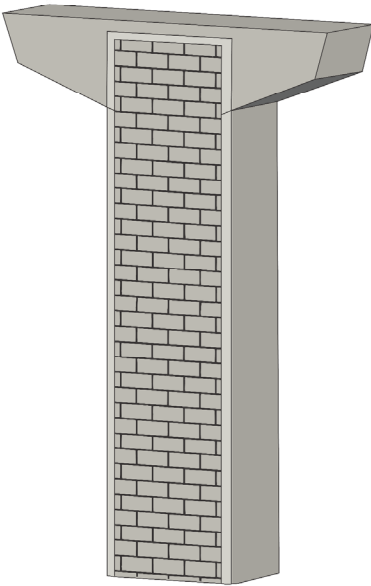

Option 2: Full Brick

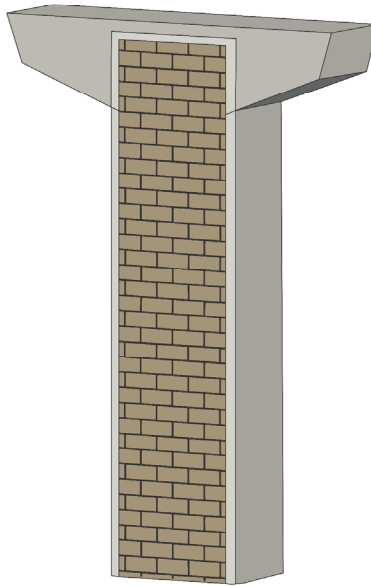

Option 3: Full Brick 2-Tone

PIER BASES

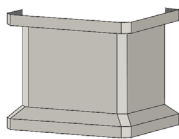

Option 1: Plain Concrete

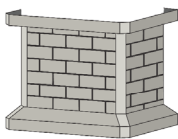

Option 2: Full Brick

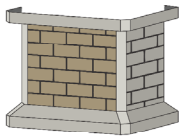

Option 3: Full Brick 2-Tone

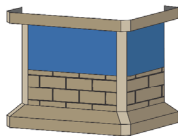
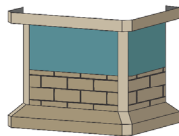

Option 4: 2-Tone with Color
*Color to change based on
corridor location

Steel Bridge Beam & Straddle Pier Color Options

BRIDGE BEAMS FROM SAWGRASS EXPRESSWAY TO POWERLINE ROAD

Green & Concrete



COATED STEEL
Federal Standard 15193

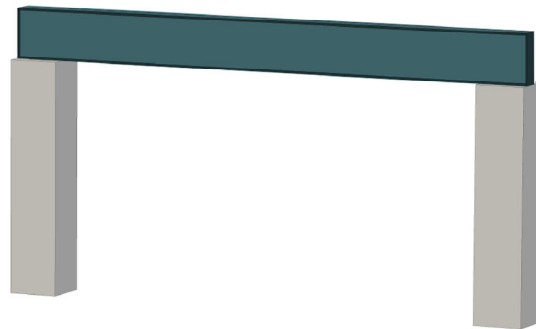

BRIDGE BEAMS MILITARY TRAIL TO I-95



COATED STEEL
Federal Standard 15052



Take Our Online Aesthetics Survey



SW10Street.com

Survey will close on Friday, October 28, 2022

Upcoming

Join us for the
Public Information Meeting

Virtual

Wednesday, November 9, 2022

6:00 pm

Register at sw10street.com

In-Person

Monday, November 14, 2022

6:00 pm

DoubleTree by Hilton Hotel Deerfield Beach - Boca Raton
100 Fairway Dr, Deerfield Beach, FL 33441

Questions and Comments?

Vanita Saini, P.E. | FDOT Project Manager

Florida Department of Transportation, District Four

3400 W. Commercial Blvd.

Ft. Lauderdale, Florida 33309

Phone: (954) 777-4468

Toll-free: (866) 336-8435, ext. 4468

Email: Vanita.Saini@dot.state.fl.us

Project Website: SW10Street.com

Scan to take the online survey:



SW 10TH ST. CONNECTOR

FDOT DISTRICT 4



SW 10th Street
GO
Connector