

MEDIAN CROSSOVERS
TYPICAL LAYOUTS AND SECTIONS

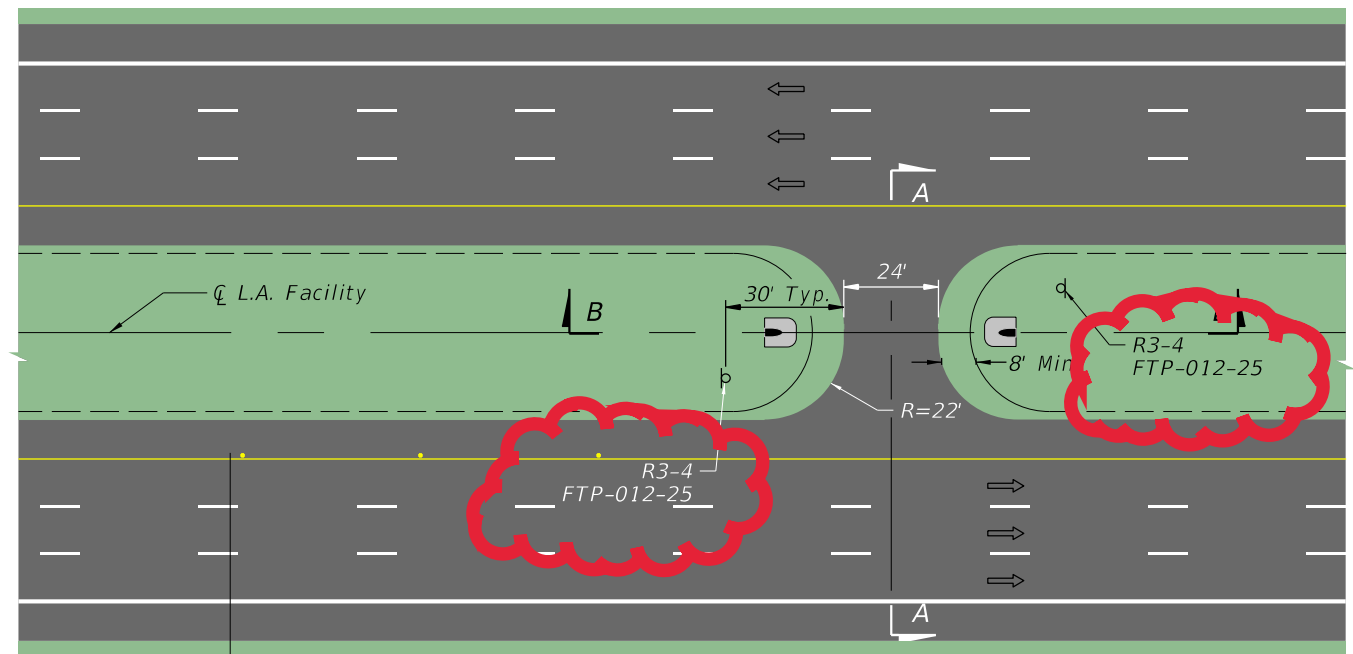

Yellow RPMs Placed in Accordance with Standard Plans, Index 706-001
(Typical Each Side)

PLAN VIEW - 6 LANES (OR MORE)

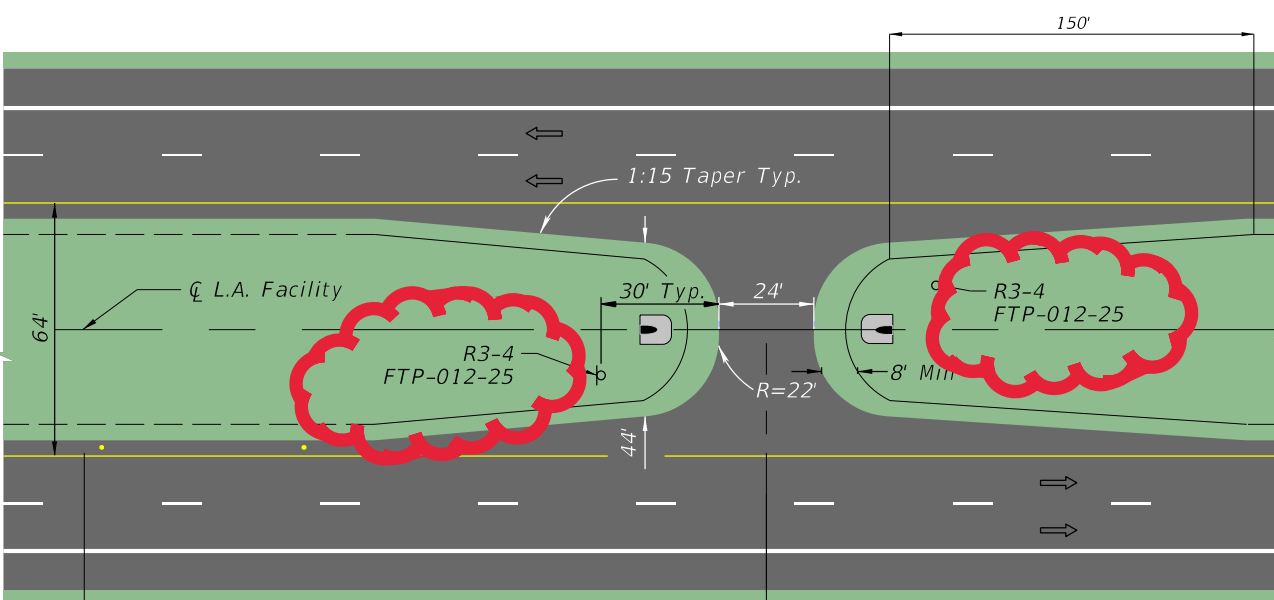

Yellow RPMs Placed in Accordance with Standard Plans, Index 706-001
(Typical Each Side)

PLAN VIEW - 4 LANES

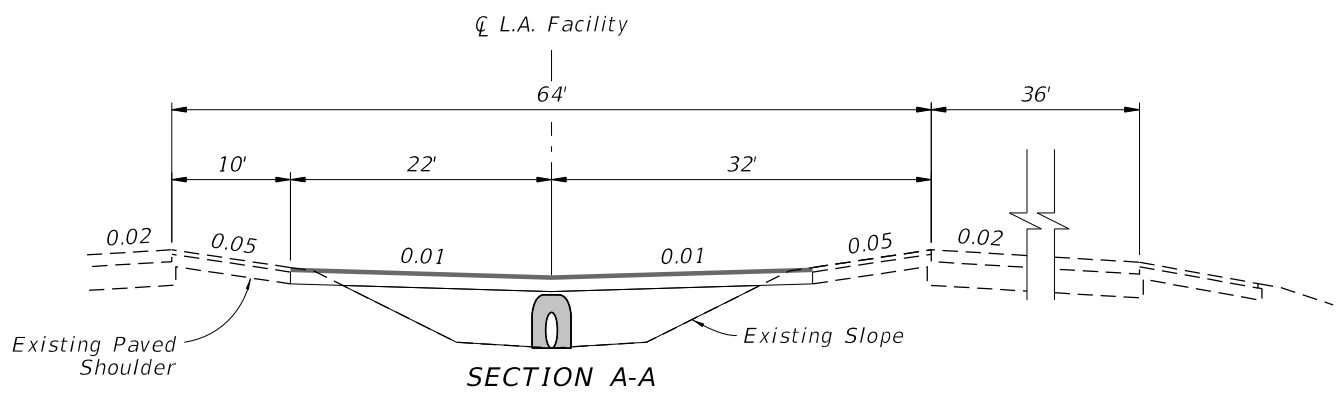

SECTION A-A

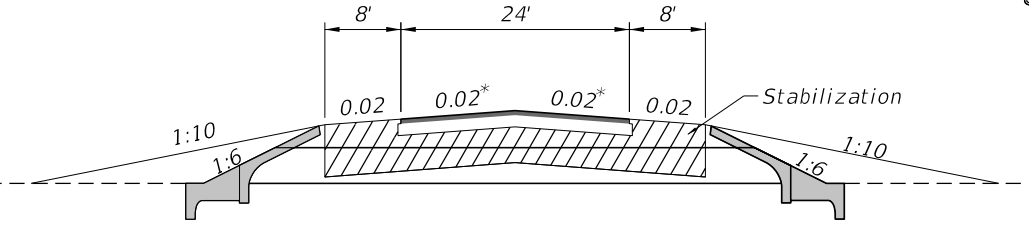

SECTION B-B

* For freeway grades 2% or greater,
match freeway grade

LEGEND:

Sign



R3-4
(36"x36")

FTP-012-25
(36"x18")

NOT TO SCALE

EXHIBIT 211-1
01/01/2026

*MEDIAN BARRIER OPENING FOR MEDIAN
CROSSOVERS TYPICAL LAYOUT*

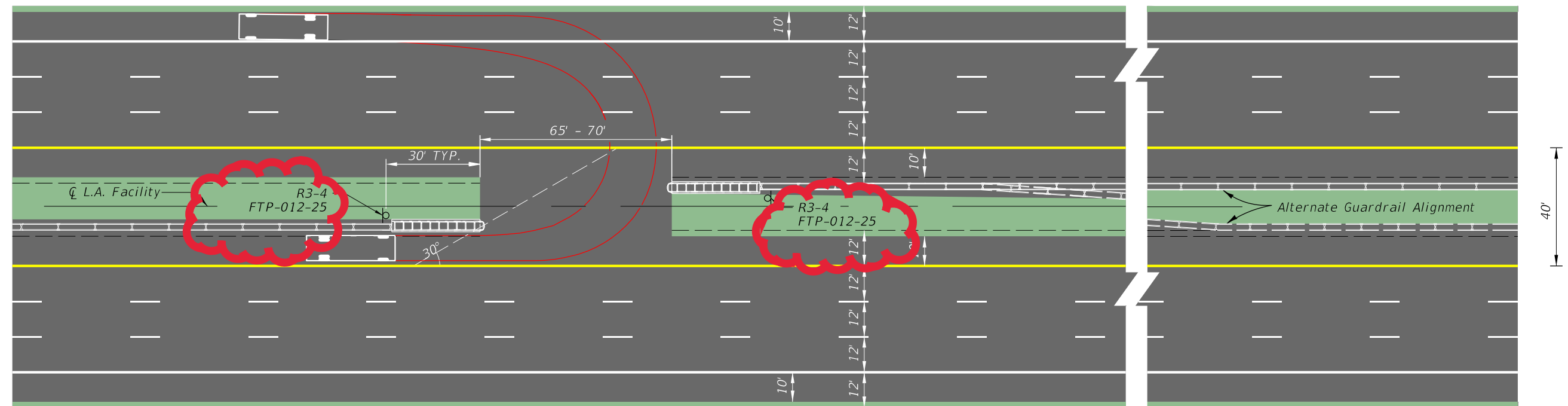

PLAN VIEW

LEGEND:

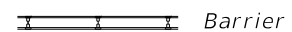

b *Sign*



R3-4
(36"x36")

OFFICIAL
USE ONLY

FTP-012-25
(36"x18")

NOTES:

1. Provide Yellow RPMs placed outside yellow edge line in advance of crossover as shown in Standard Plans, Index 706-001.
2. Minimum turning radius for SU vehicle shown, and were generated by AutoTURN.
3. For lane and median configurations other than the 6-lane, 40-foot median shown here, adjustments in turn radii or additional pavement may be required.

NOT TO SCALE

EXHIBIT 211-2
01/01/2026

TYPICAL ONE-WAY PAIRS AND DIVIDED ARTERIALS/COLLECTORS
WITH UNSIGNALIZED ONE-WAY EGRESS

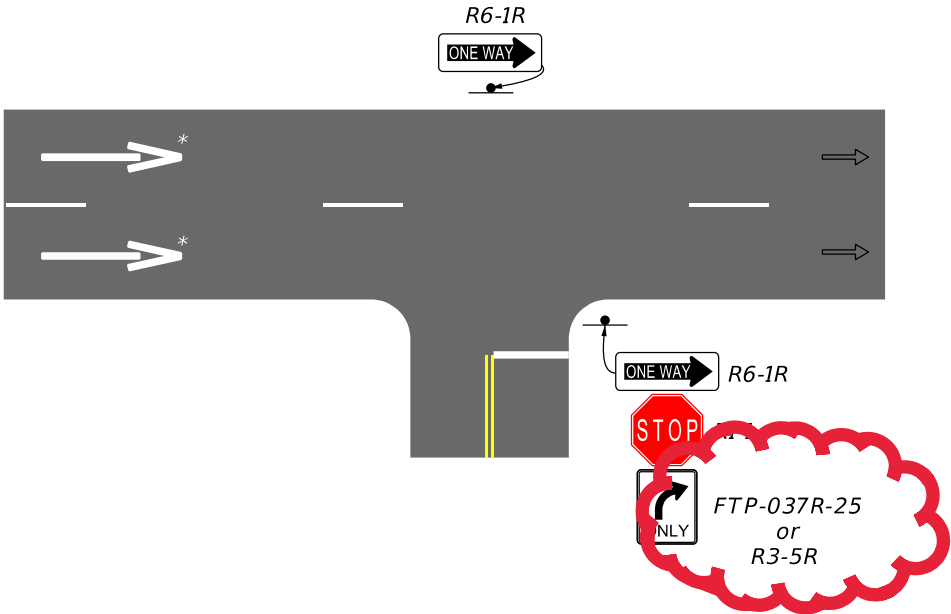

- Installation Details
- 1) R6-1 shall be placed on far side median or shoulder depending on facility type.
 - 2) RIGHT TURN ARROW (FTP-037R-25) or LEFT TURN ARROW (FTP-037L-25) typically added by district driveway permit.
 - 3) Mandatory Movement Lane Control (R3-5) sign must be added to side street.
- * See FDM 230.4.4 for how often to place Wrong-Way arrows based on context classification.

Legend
⇒ Direction of travel
→ Wrong Way Arrow

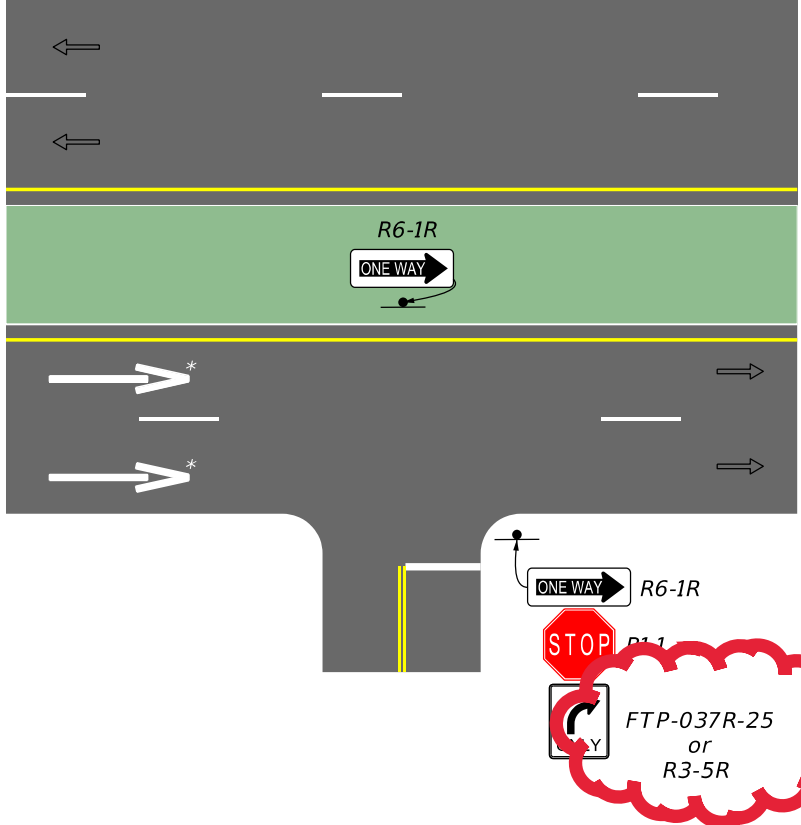

NOT TO SCALE
EXHIBIT 230-5
01/01/2026

TYPICAL TWO-WAY APPROACH TO
UNDIVIDED SIGNALIZED AND UNSIGNALIZED
ONE-WAY STREET

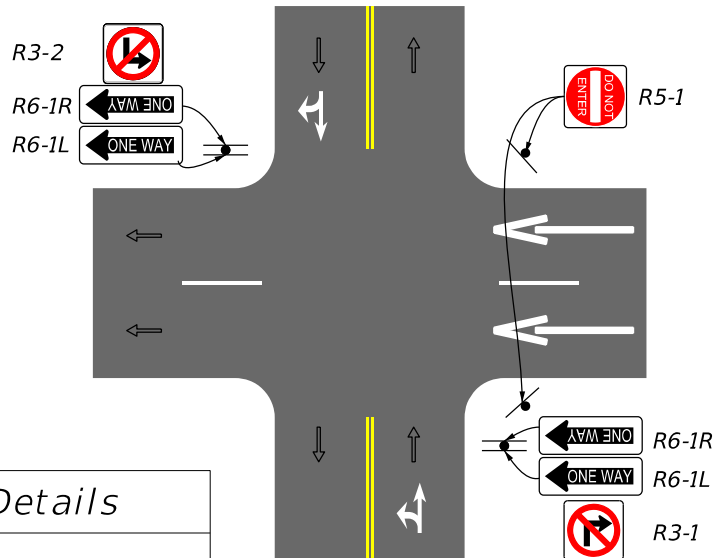

- Installation Details
- 1) Wrong-Way signing and pavement markings for signalized and stop control.
 - 2) Place Wrong-Way arrows four feet upstream of stop bar, if present.

Legend
⇒ Direction of travel
→ Wrong Way Arrow
↗ Lane Assignment Arrow

NOT TO SCALE
EXHIBIT 230-6
10/2022

TYPICAL ONE-WAY APPROACH TO
UNDIVIDED SIGNALIZED AND UNSIGNALIZED
ONE-WAY STREET

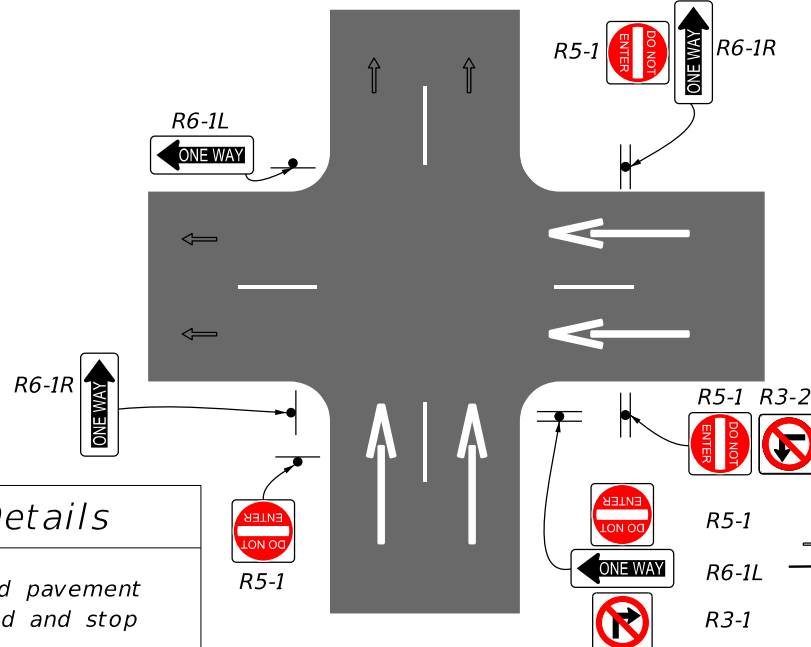

- Installation Details
- 1) Wrong-Way signing and pavement markings for signalized and stop control.
 - 2) Place Wrong-Way arrows four feet upstream of stop bar, if present.

Legend
⇒ Direction of travel
→ Wrong Way Arrow
NOT TO SCALE
EXHIBIT 230-7
10/2022