

925 Roadway Cross Sections

925.1 General

Cross sections depict the existing ground and manmade features and proposed roadway template as sections perpendicular to the respective stations along a centerline or baseline of construction.

Roadway Cross Sections sheets can be used to convey supplemental information during the plans phase review process and may also be used for coordination purposes (e.g., permit or utility, local agency, public meetings).

See *Exhibit 925-1* for an example of a Roadway Cross Sections sheet.

925.2 Sheet Set Up

Show cross sections on standard preformatted cross section sheets (available in the FDOT CADD Software).

Place as many cross sections on a sheet as possible with sections spaced to avoid overlapping. Create cross sections using a scale of 1" = 20' horizontal and 1" = 10' vertical. Show the scale at the bottom right corner of the sheet above the title block. The standard cross section interval is 50 feet. Another interval may be used when appropriate based on the type and complexity of the project.

Show cross sections with stations increasing from the bottom to the top of the sheet and with multiple columns placed from the left to the right.

The order of cross sections within the plan set should be the mainline, side streets, then ramps.

Display the begin and end construction limits and include the name of the mainline (e.g., SR 22), side street (e.g., Easy Street), or ramp (e.g., Ramp A). Indicate exception limits (e.g., Bridge No. 770175 STA 105+20 to 109+60).

Center the cross sections on the sheet with the survey baseline or the construction centerline placed vertically in the center. Where the survey baseline and the construction centerline are not parallel, show the distance between the two at each cross section.

925.3 Required Information

As illustrated in **Exhibit 925-1**, each cross section must include a background grid at the appropriate scale. Display the station for each cross section in the lower right area of the grid. Display (in feet) the horizontal offsets from the centerline along the bottom of the grid. Display the vertical elevations along both sides of the grid.

Each cross section must provide the following:

- (1) Label the centerline or baseline of construction.
- (2) Show and label R/W limits.
- (3) Show existing ground lines.
- (4) Show below-ground portions of existing features, e.g., pavement, curb, sidewalk.
- (5) Show and label parallel underground utilities. Label only the utility type (e.g., “G”, “W”); the size of pipe is not required.
- (6) Show the proposed roadway template and include:
 - (a) Profile grade elevation(s)
 - (b) Special ditch elevations
 - (c) Pavement and sidewalk cross slopes
 - (d) Median and outer slope ratios
- (7) Show and label the lower limits (undercut line) of the removal of organic or plastic materials. See **FDM 216** and [Standard Plans, Index 120-002](#) for the requirements of subsoil excavation; i.e., removal of unsuitable organic or plastic soils.

Showing parallel drainage pipes or structures is not required.

Exhibit 925-1
 Roadway Cross Sections
 Date: 1/1/2025

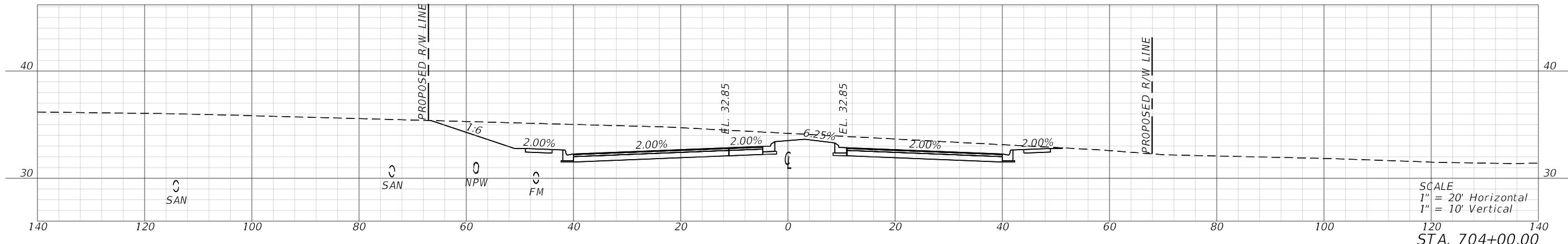
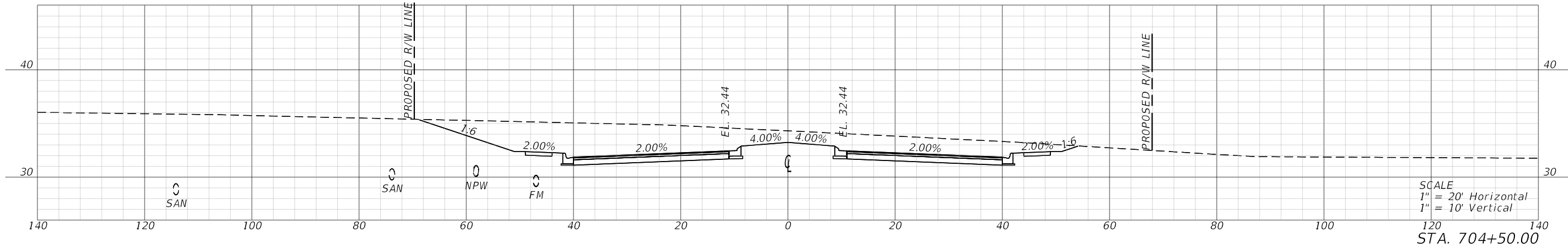
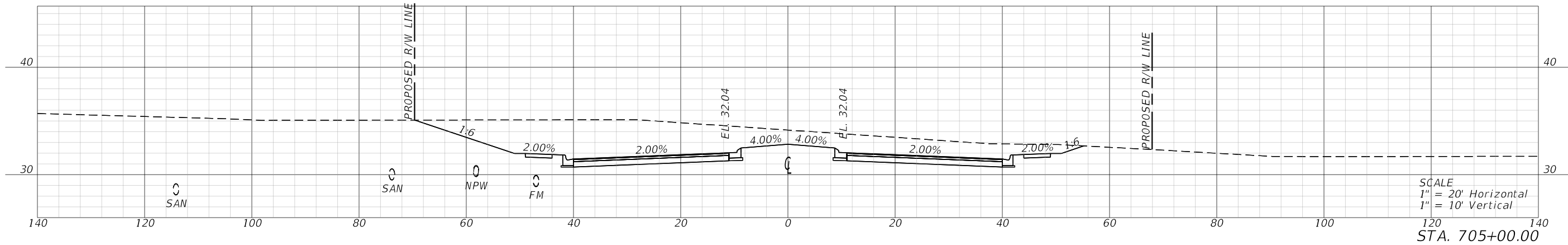

REVISIONS				ENGINEER OF RECORD			STATE OF FLORIDA DEPARTMENT OF TRANSPORTATION			SHEET NO.
DATE	DESCRIPTION	DATE	DESCRIPTION	LUKE S. WALKER LICENSE NUMBER: 99991 ROADWAY ENGINEERS, INC. 123 MAIN STREET TALLAHASSEE, FL 32301			ROAD NO.	COUNTY	FINANCIAL PROJECT ID	
							SR 61	WAKULLA	220495-5-52-01	10

ROADWAY CROSS SECTIONS

THE OFFICIAL RECORD OF THIS SHEET IS THE ELECTRONIC FILE DIGITALLY SIGNED AND SEALED UNDER RULE 61G15-23.004, F.A.C.