

## 923 Utility Adjustments

### 923.1 General

Utility Adjustments sheets provide a plan view that highlights the location of existing, proposed, and relocated utilities. These sheets are used when the project corridor contains numerous utilities with significant potential for conflict or harm. Projects with minor utility work or impacts may include this information on roadway (or other component) plan sheets.

Prepare Utility Adjustment sheets on standard-format sheets (11"x17") or a large-format sheets (24"x36", 36"x48" or 36"x72") using a horizontal scale of 1" = 40', or 1" = 50'. Use landscape orientation regardless of sheet size selected.

#### 923.1.1 Utility Notes

See **FDM 914** for required utility notes to be include on the General Notes sheet.

### 923.2 Required Information

Display a north arrow and scale within each plan view, typically in the upper right portion.

Display roadway plan view (gray scaled as background) such that the centerline of construction, or baseline of construction stationing, increases from left to right. Other proposed design elements should also be shown, such as overhead sign or mast arms. Do not display information and graphic data that is not relevant.

Display and label the following information:

- (1) Display existing and proposed utilities within the project limits using lines and standard utility symbols (see the [CADD Manual](#)). Though not utilities, display and label Department-owned subsurface communication (ITS) lines.
- (2) Indicate the disposition of existing utilities not to remain in service (e.g., "To Be Removed", "To Be Adjusted", "To Be Relocated", "To Be Placed Out Of Service").
- (3) Indicate the utility type, Agency Owner (UAO), and size and material of existing utilities to remain in service.
- (4) Display and label overhead utilities indicating the line voltage. For a multi-line electrical overhead crossing, accurately show the location of each line.

- (5) Indicate field verified vertical elevation and horizontal location ( $V_{vh}$ ) of existing utilities (SUE data). Leader line must point to location on plan view where field data was taken. Include the  $V_{vh}$  number shown in the Utility Verification table.
- (6) Display a Utility Verification table in each view panel of the sheet that contains  $V_{vh}$  information for utilities shown in that panel. Required table information includes:
  - (a)  $V_{vh}$  number
  - (b) Utility type and owner
  - (c) Size and Material
  - (d) Location (Sta/Offset/Lt or Rt)
  - (e) Existing ground and top of utility elevations

If number of  $V_{vh}$  data points or required view panels are extensive, the table may be shown on separate standard-format sheets (11"x17") titled "Utility Verification Sheets".

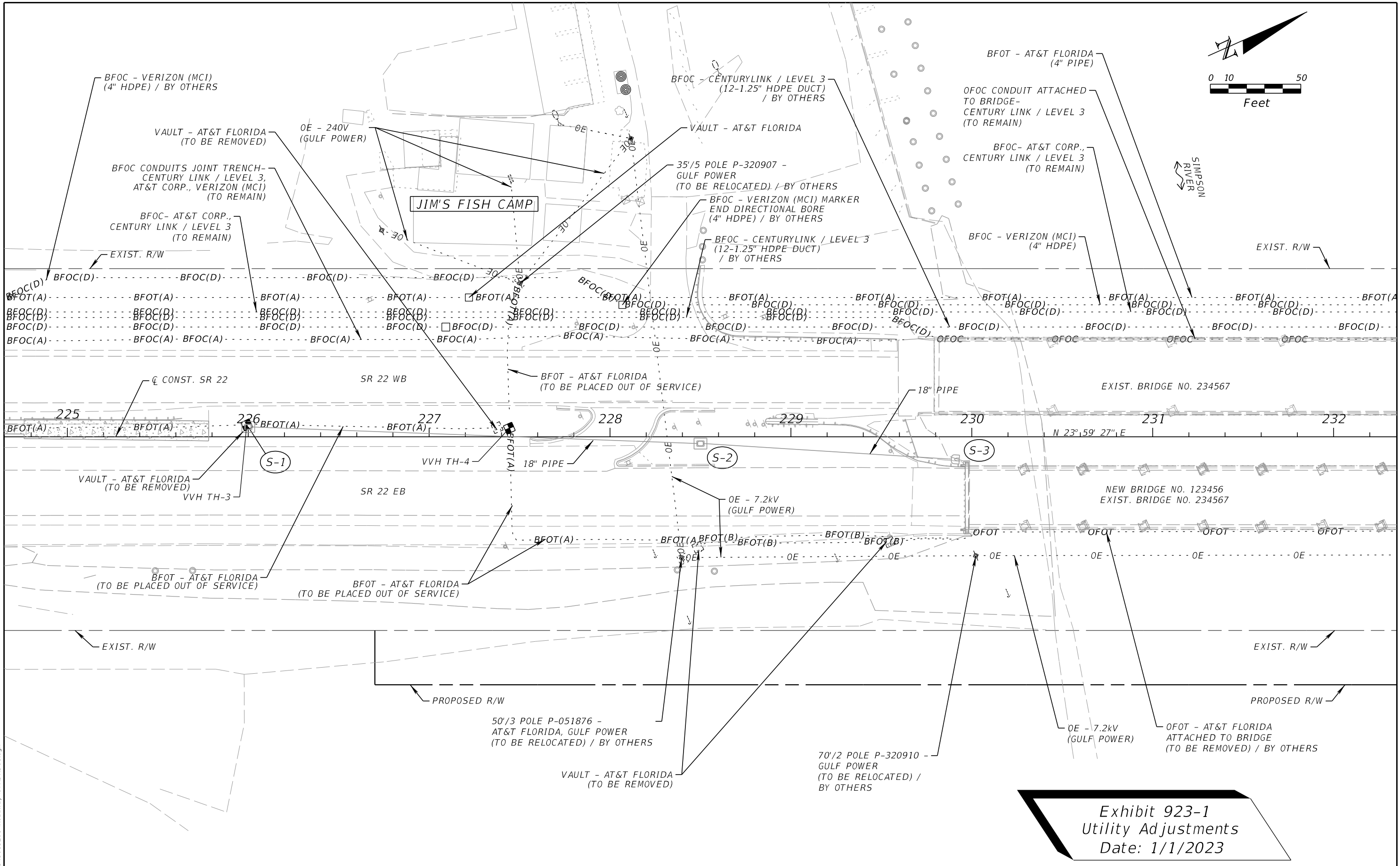
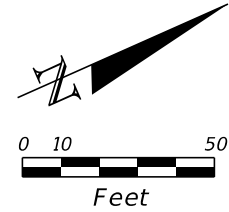

**Exhibit 923-1**  
**Utility Adjustments**  
**Date: 1/1/2023**

REVISIONS				ENGINEER OF RECORD		STATE OF FLORIDA DEPARTMENT OF TRANSPORTATION			SHEET NO.
DATE	DESCRIPTION	DATE	DESCRIPTION	LUKE S. WALKER, P.E. LICENSE NUMBER: 99991 ROADWAY ENGINEERS, INC. 123 MAIN STREET TALLAHASSEE, FL 32301	ROAD NO.	COUNTY	FINANCIAL PROJECT ID		
					SR 22	BAY	123456-1-52-01	UTILITY ADJUSTMENTS	
									102

1/17/2023 9:27:58 AM P5972BW  
 C:\Worksets\FDOT\12345615201\Roadway\UT\ADRD01.dgn

THE OFFICIAL RECORD OF THIS SHEET IS THE ELECTRONIC FILE DIGITALLY SIGNED AND SEALED UNDER RULE 61G15-23.004, F.A.C.