

FABRICATION NOTES

1. The abbreviated FSB designation for depth and width is FSB "depth" x "width", e.g. FSB 12 x 48.
2. All bar dimensions are out-to-out.
3. Strands N shall be ASTM A416, Grade 250 or 270, $\frac{3}{8}$ " \emptyset or larger strands, stressed to 10,000 lbs. each.
4. Unless otherwise noted, the minimum concrete cover for reinforcing steel shall be 2".
5. For referenced Dimensions, Angles and Case Numbers, see Florida Slab Beam - Table of Variables in Structures Plans.
6. Bars 4D1 & 6Y1 correspond to END 1, and 4D2 & 6Y2 correspond to END 2.
7. Bars 5E1 correspond to interior FSBs, and 5E2 correspond to exterior FSBs.
8. Rake the top surface of the Slab Beams transversely to provide a roughened surface with $\frac{1}{4}$ " amplitude.

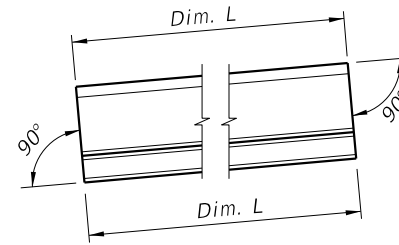

SCHMATIC SIDE ELEVATION OF BEAM
(Beam on a Positive Grade shown; Beam on a Negative Grade or Horizontal Grade similar.)

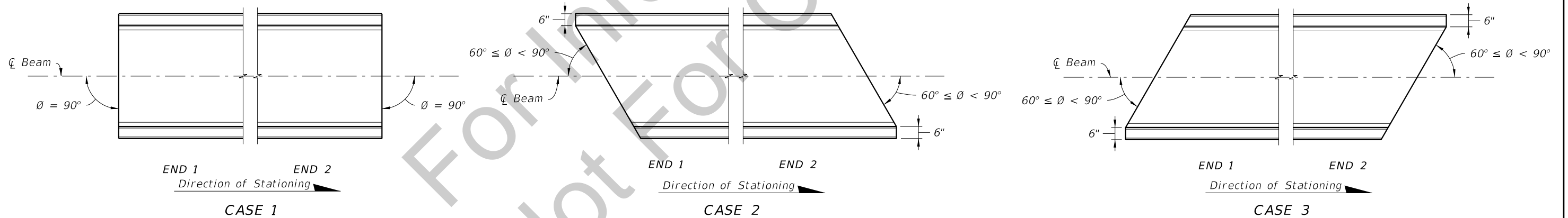

SCHMATIC PLAN VIEWS AT BEAM ENDS

1/29/2016 2:50:56 PM

LAST REVISION	01/01/16	REVISION	DESCRIPTION:
---------------	----------	----------	--------------



DEVELOPMENTAL
DESIGN STANDARDS

TYPICAL FLORIDA SLAB BEAM
DETAILS AND NOTES

INDEX NO.
D20450

SHEET NO.
1 of 3

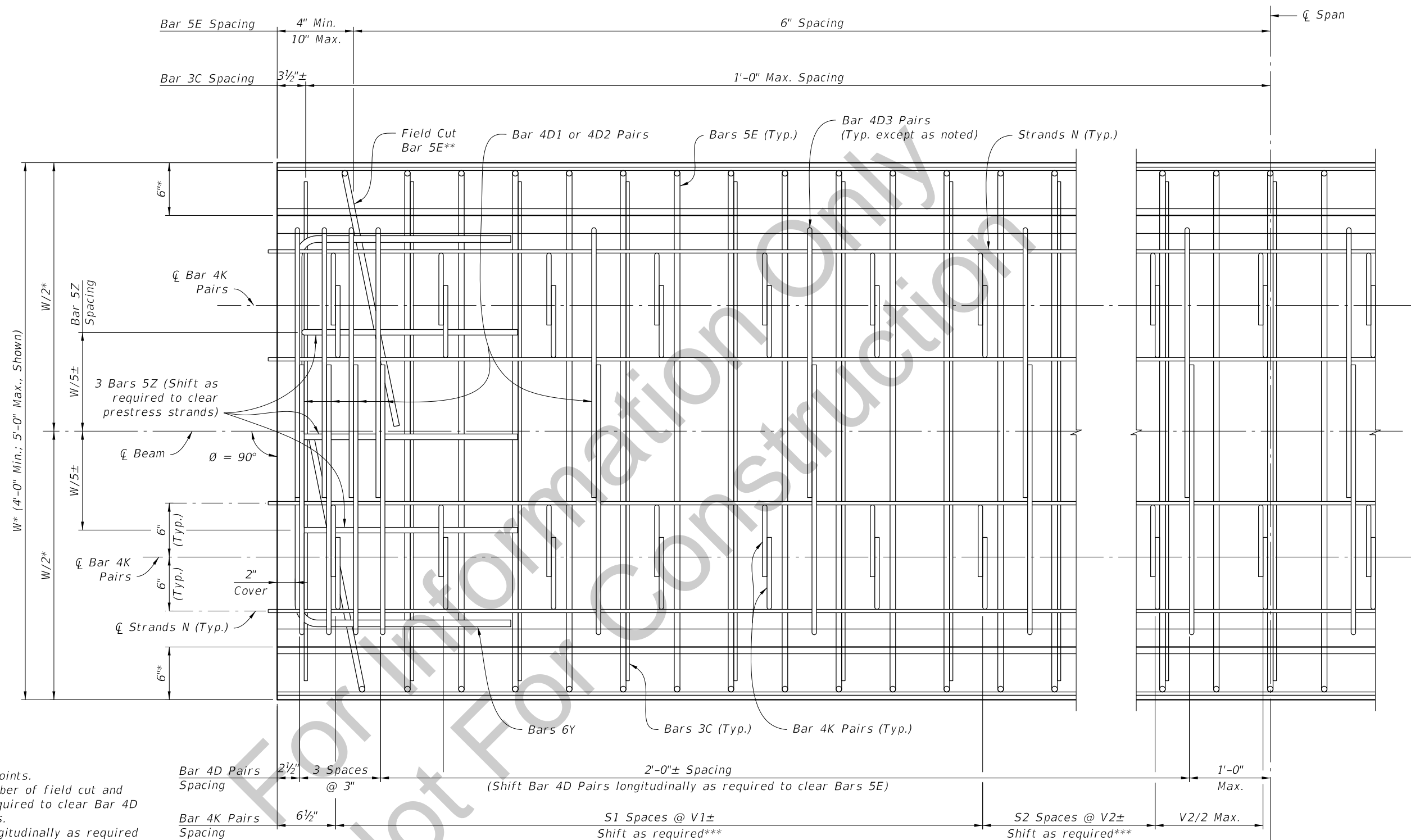

* Measured to Working Points.
 ** At Beam ends, use number of field cut and rotated Bars 5E as required to clear Bar 4D Pairs and Bar 4K Pairs.
 *** Shift Bar 4K Pairs longitudinally as required to clear Bar 4D Pairs and Bars 3C and 5E.

CROSS REFERENCE:
 For Dimensions V1, V2 & W and number of spaces S1 & S2, see Florida Slab Beam - Table of Variables in Structures Plans.
 See Indexes D20451, D20452 and D20453 for Bars 5E Details.

PARTIAL PLAN VIEW $\theta = 90^\circ$
 (END 1 SHOWN, END 2 SIMILAR)
 (INTERIOR BEAM SHOWN, EXTERIOR BEAM SIMILAR, SEE BARS 5E DETAILS)

1/29/2016 2:50:58 PM

LAST REVISION 01/01/16	DESCRIPTION:	 DEVELOPMENTAL DESIGN STANDARDS	TYPICAL FLORIDA SLAB BEAM DETAILS AND NOTES	INDEX NO. D20450	SHEET NO. 2 of 3
---------------------------	--------------	--	--	----------------------------	----------------------------

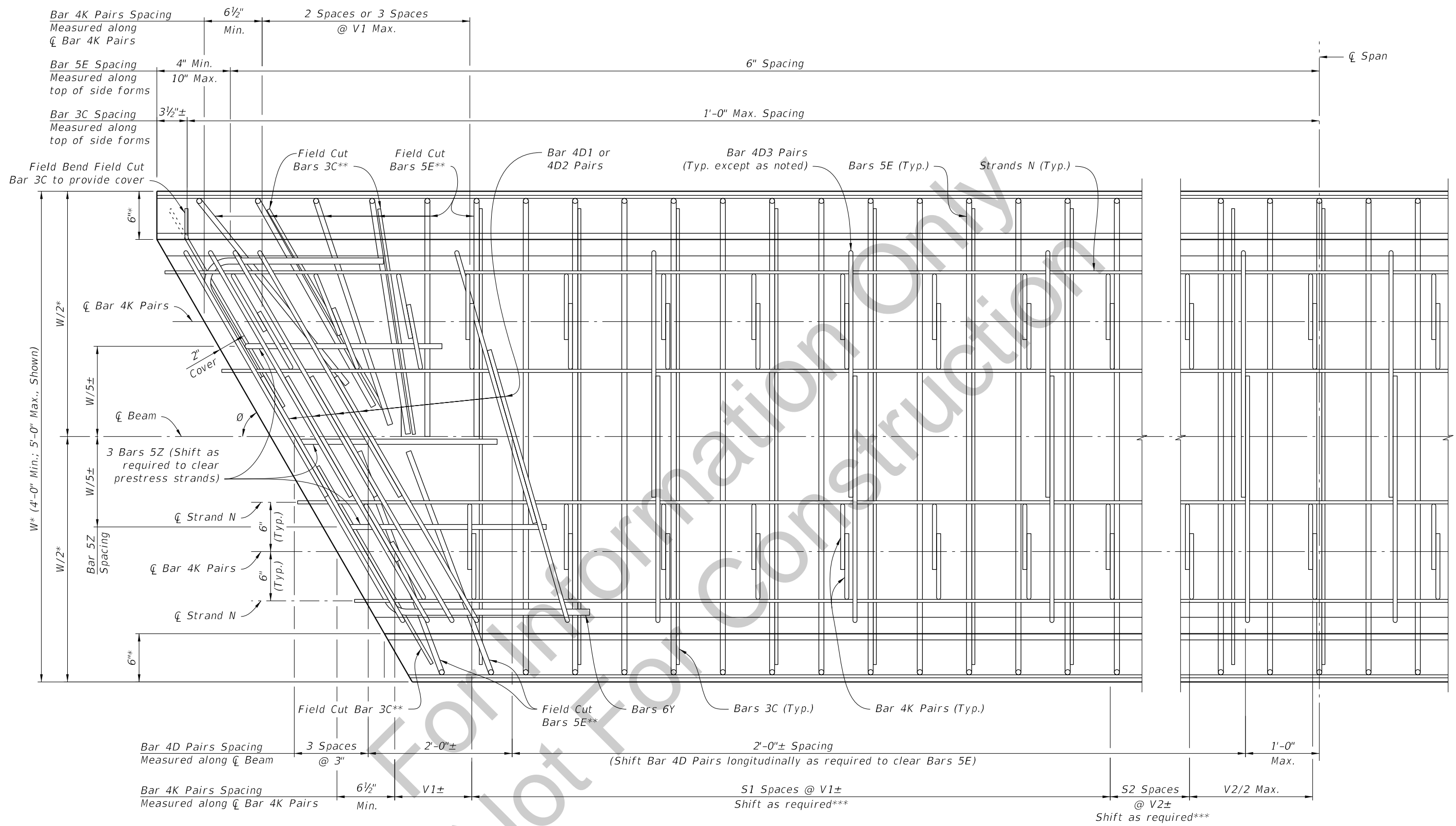

PARTIAL PLAN VIEW $60^\circ \leq \theta < 90^\circ$
 (END 1 SHOWN, END 2 SIMILAR)
 (INTERIOR BEAM SHOWN, EXTERIOR BEAM SIMILAR, SEE BARS 5E DETAILS)

CROSS REFERENCE:
 For Dimensions V1, V2 & W, Angle θ and number of spaces S1 & S2, see Florida Slab Beam - Table of Variables in Structures Plans.
 See Indexes D20451, D20452 and D20453 for Bars 5E Details.

* Measured to Working Points.
 ** At Beam ends, use number of field cut and rotated Bars 3C and 5E as required to clear Bar 4D Pairs and Bar 4K Pairs.
 *** Shift Bar 4K Pairs longitudinally as required to clear Bar 4D Pairs and Bars 3C and 5E.

1/29/2016 2:50:58 PM

LAST REVISION 01/01/16	DESCRIPTION:	 DEVELOPMENTAL DESIGN STANDARDS	TYPICAL FLORIDA SLAB BEAM DETAILS AND NOTES	INDEX NO. D20450	SHEET NO. 3 of 3
---------------------------	--------------	--	--	----------------------------	----------------------------