



## Florida Department of Transportation

CHARLIE CRIST  
GOVERNOR

605 Suwannee Street MS # 31  
Tallahassee, FL 32399-0450

STEPHANIE C. KOPELOUSOS  
SECRETARY

DCE MEMORANDUM NO. 05-08

ROADWAY DESIGN BULLETIN 08-05

**Date:** February 22, 2008

**To:** District Construction Engineers and District Design Engineers

**From:** Brian A. Blanchard, P.E., Director, Office of Construction  
David C. O'Hagan, P.E. State Roadway Design Engineer

**Copies:** Ananth Prasad, Lora Hollingsworth, Jim Mills, David Sadler

**Subject:** Project Information Sign

**RECOMMENDATION:** Starting with the October 2008 letting, the Project Information Sign shown in Interim Index 600 sheet 13 of 13 (attached) is required for all contracts with more than 90 days of contract time. This project specific sign shall be detailed in the plans, with the exceptions of "Season/Year" and "Contractor's name" and paid for under Maintenance of Traffic, Lump Sum, in accordance with specification 102-11.5.

Placement of these signs should be approximately 500 feet in advance of the first advance warning sign or as close to be beginning of the project as practical, on each mainline approach. This sign may be omitted if physical constraints prohibit placement of this sign due to its width.

**BACKGROUND:** The Department has received several requests from the traveling public to provide project information for our construction projects. The Department agrees that this is a good suggestion and has developed a standard format for providing the public with project specific details and contact information.

## IMPLEMENTATION PLAN:

**Construction:** Project Information Signs may be added to projects currently underway, if requested by the District Construction Engineer. **This memorandum serves as a blanket approval to process this change and should be attached to the Work Order or Supplemental Agreement.**

Interim Index 600 sheet 13 of 13 has been posted on the Design Standards Web page which provides the construction details for the Project Information Sign.  
<http://www.dot.state.fl.us/rddesign/rd/2008Interims/600.pdf>

**District Design:** Update plans to include a sign detail for the Project Information Sign beginning with the October 2008 letting, sooner if possible.

**Central Office Design:** Update the 2009 Plans Preparation Manual Volume 1 Chapter 10 by adding the following language:

**10.7.3 Project Information Sign:** The Project Information Sign shown in Index 600 is required for all contracts with more than 90 days of contract time. This sign should be located approximately 500 feet in advance of the first advance warning sign or as close to be beginning of the project as practical, on each mainline approach. This sign may be omitted if physical constraints prohibit placement of this sign due to its width.

For additional information contact either:

Stefanie Maxwell, Central Office Construction at:  
850-414-4314 or [Stefanie.maxwell@dot.state.fl.us](mailto:Stefanie.maxwell@dot.state.fl.us)

Cheryl Adams, Central Office Roadway Design at:  
850-414-4327 or [Cheryl.adams@dot.state.fl.us](mailto:Cheryl.adams@dot.state.fl.us)

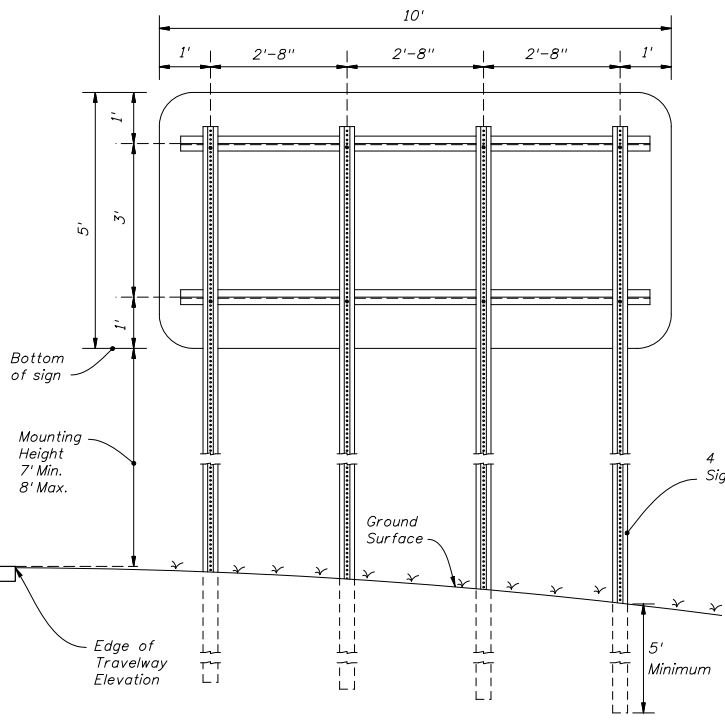

4 POST SIGN SUPPORT MOUNTING DETAIL

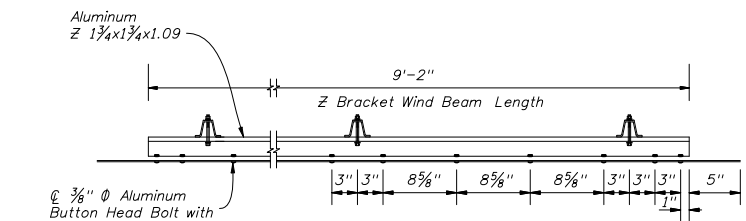

BRACKET DETAIL

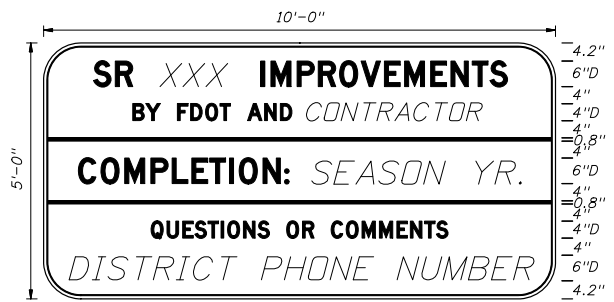

BORDER 10'-0" X 5'-0"  
 R=8" 8" Radii  
 TH=0.25" 4" and 6" series D Legend  
 IN=0.75" Blue Background  
 White Legend and Border

PROJECT INFORMATION SIGN DETAIL

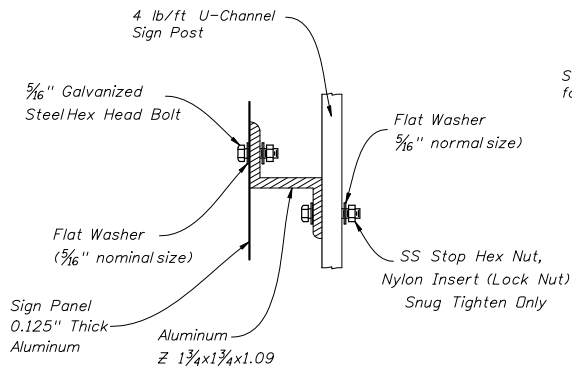

SIGN ATTACHMENT DETAIL

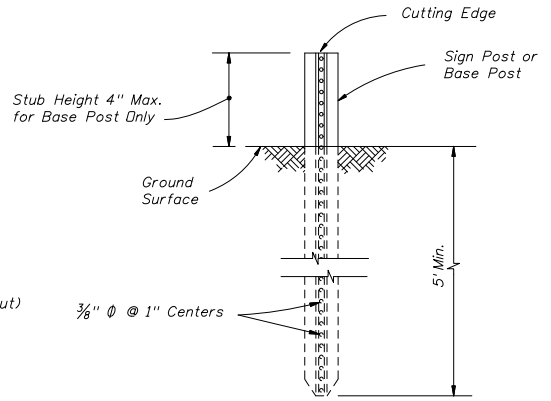

TYPICAL FOUNDATION DETAIL

See QPL for post, splice and connection details.  
 No bolts installed closer than 1" to cutting edge.

PROJECT INFORMATION SIGN

REVISIONS					
DATE	BY	DESCRIPTION	DATE	BY	DESCRIPTION
11/07/07	L.W.	New sheet Index 600 13 Of 13 PROJECT INFORMATION SIGN.			

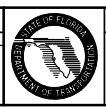

2008 Interim Design Standard  
**GENERAL INFORMATION FOR TRAFFIC CONTROL THROUGH WORK ZONES**

Interim Date 01/01/08	Sheet No. 13 of 13
Index No. <b>600</b>	