

CONTRACT PLANS COMPONENTS

ROADWAY  
SIGNING AND PAVEMENT MARKING  
SIGNALIZATION

INDEX OF SIGNALIZATION PLANS

SHEET NO.	SHEET DESCRIPTION
T-1	KEY SHEET
T-2	GENERAL NOTES
T-3 - T-7	SIGNALIZATION PLAN

GOVERNING STANDARD PLANS:

Florida Department of Transportation, FY 2025-26 Standard Plans for Road and Bridge Construction and applicable Interim Revisions (IRs).

Standard Plans for Road Construction and associated IRs are available at the following website: <http://www.fdot.gov/design/standardplans>

GOVERNING STANDARD SPECIFICATIONS:

Florida Department of Transportation, 2025-26 Standard Specifications for Road and Bridge Construction at the following website: <http://www.fdot.gov/programmanagement/Implemented/SpecBooks>

STATE OF FLORIDA  
DEPARTMENT OF TRANSPORTATION

SIGNALIZATION PLANS

FINANCIAL PROJECT ID 451481-1-52-01

POLK COUNTY (16210000)

STATE ROAD NO. 35 (US 98)  
RESURFACING, RESTORATION, AND REHABILITATION  
FROM SHARON DRIVE TO N OF NORTON ROAD

PROJECT LOCATION URL:	<a href="https://tinyurl.com/3958dbvf">https://tinyurl.com/3958dbvf</a>
PROJECT LIMITS:	BEGIN MP 3.569 – END MP 5.982
EXCEPTIONS:	NONE
BRIDGE LIMITS:	NONE
RAILROAD CROSSING:	NONE

PHASE 11  
OCTOBER 2025

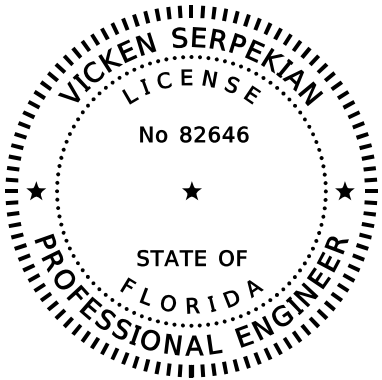
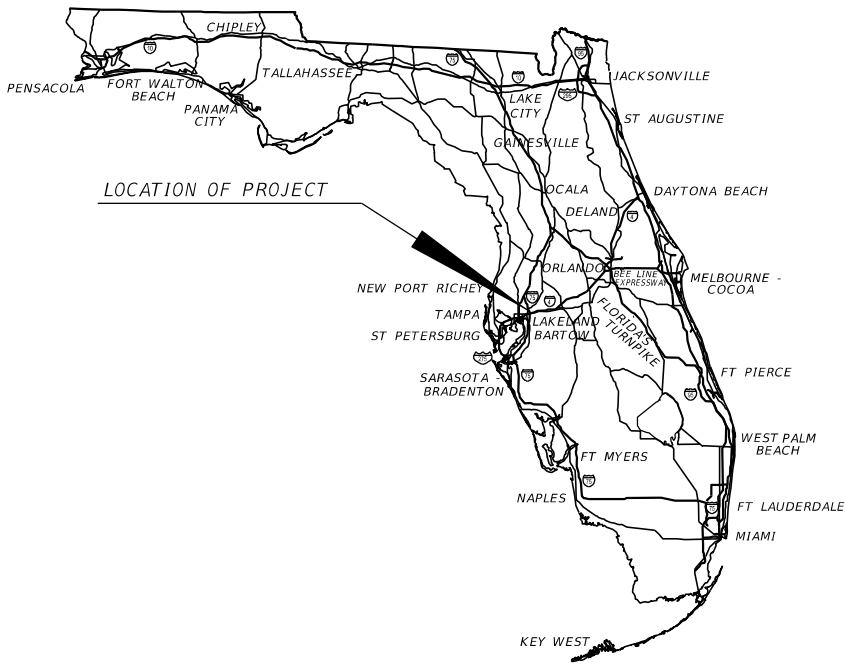

THIS ITEM HAS BEEN DIGITALLY  
SIGNED AND SEALED BY

ON THE DATE ADJACENT TO THE SEAL

SIGNATURE MUST BE VERIFIED  
ON ANY ELECTRONIC COPIES.

SIGNALIZATION PLANS  
ENGINEER OF RECORD:

VICKEN SERPEKIAN, P.E., P.T.O.E.  
P.E. NO.: 82646  
ELEMENT ENGINEERING GROUP, LLC  
1713 E. 9th AVENUE  
TAMPA, FL 33605  
(813) 386-2101  
CONTRACT NO.: CAP02  
VENDOR NO.: 56-2565488

FDOT PROJECT MANAGER:

RICHARD HOWARD, P.E.

CONSTRUCTION CONTRACT NO.	FISCAL YEAR	SHEET NO.
TBD	27	T-1

- SIGNALIZATION GENERAL NOTES:
1. THE INSTALLATION OF CONDUIT AND PULL BOXES FOR THE SIGNAL DETECTION LOOPS IS TO BE COORDINATED WITH UTILITY COMPANIES AS DIRECTED BY PROJECT ENGINEER.
  2. MAINTAINING AGENCIES:  
  
CITY OF LAKELAND  
MALL ACCESS 3  
SLEEPY HILL RD.  
FOXWOOD BLVD./CARPENTERS WAY)
  3. PAVEMENT MARKINGS ARE SHOWN FOR REFERENCE PURPOSES ONLY. FOR PAVEMENT MARKING DESIGN INFORMATION, SEE PAVEMENT MARKING PLANS.
  4. WHEN CONSTRUCTION IS COMPLETE, PROVIDE A SET OF "AS-BUILT" PLANS IN ELECTRONIC FORM (PDF) TO:  
  
FDOT TRAFFIC OPERATIONS  
NEAL TURNER, P.E., TSM&O ENGINEER – ARTERIALS  
801 N. BROADWAY AVE.  
P.O. BOX 1249  
BARTOW, FL 33830-1249  
EMAIL: NEAL.TURNER@DOT.STATE.FL.US  
PHONE: (863)-519-2216
  5. THE LOCATION(S) OF THE UTILITIES SHOWN IN THE PLANS (INCLUDING THOSE DESIGNATED Vv Vh AND Vvh) ARE BASED ON LIMITED INVESTIGATION TECHNIQUES AND SHOULD BE CONSIDERED APPROXIMATE ONLY. THE VERIFIED LOCATION/ELEVATIONS APPLY ONLY AT THE POINTS SHOWN. INTERPOLATIONS BETWEEN POINTS HAVE NOT BEEN VERIFIED.
  6. IF THE EXISTING PULL BOXES AND CONDUITS ARE IN GOOD CONDITION AS DIRECTED BY THE ENGINEER, THEY MAY BE USED IN LIEU OF THE PROPOSED PULL BOXES AND CONDUIT.

CITY OF LAKELAND TRAFFIC OPERATIONS  
(STATE ROAD (S.R.) 35 / UNITED STATES (U.S.) HWY. 98 AT GIBSONIA-GALLOWAY RD. AND W DAUGHTERY RD.)

1. AT LEAST TWO (2) FULL BUSINESS DAYS PRIOR TO BEGINNING THE TRAFFIC SIGNAL INSTALLATION, CONTACT CITY OF LAKELAND TRAFFIC OPERATIONS AT (863) 834-3491.
2. AT LEAST TWO (2) FULL BUSINESS DAYS PRIOR TO BEGINNING THE TRAFFIC SIGNAL INSTALLATION, CONTACT THE TRAFFIC SIGNAL INSPECTOR/LIAISON:  
  
FRANK RODRIGUEZ  
FLORIDA DEPARTMENT OF TRANSPORTATION  
BARTOW OPERATIONS CENTER  
2740 S.R. 60 WEST  
BARTOW, FL 33830  
PH: (863)-519-4117
3. FOR REMOVED SIGNAL EQUIPMENT, CONTACT CITY OF LAKELAND TRAFFIC OPERATIONS AT (863) 834-3491 TO CONFIRM THE LOCATION AND DELIVERY OF SALVAGEABLE MATERIALS.
4. WHEN CONSTRUCTION IS COMPLETE, IN ADDITION TO THE REQUIREMENT OF STANDARD SPECIFICATION 9-8, PROVIDE A SET OF "AS-BUILT" PLANS TO:  
  
CITY OF LAKELAND TRAFFIC OPERATIONS  
THERESA SCHWARTZ, P.E., MANAGER OF TRAFFIC OPERATIONS  
834 E. ROSE STREET  
LAKELAND, FL 33801
5. ALL SIGNALIZATION AND COMMUNICATION DOWNTIME SHALL NOT EXCEED MORE THAN 12 HOURS. A 48 HOUR ADVANCED NOTICE SHALL BE GIVEN TO THE CITY OF LAKELAND TRAFFIC OPERATIONS.
6. VERIFY THE COLOR CODE OF SIGNAL CABLE WITH CITY OF LAKELAND TRAFFIC OPERATIONS PRIOR TO WIRING THE INTERSECTION.
7. CONTACT CITY OF LAKELAND TRAFFIC OPERATIONS PRIOR TO ORDERING CONTROLLER ASSEMBLY TO CONFIRM EQUIPMENT COMPATIBILITY.

POLK COUNTY TRAFFIC OPERATIONS  
(S.R. 35 / U.S. HWY. 98 AT TARGET/MALL ACCESS 3, SHOPPING CENTER/SLEEPY HILL RD., AND CARPENTERS WAY/FOXWOOD BLVD.)

1. AT LEAST TWO (2) FULL BUSINESS DAYS PRIOR TO BEGINNING THE TRAFFIC SIGNAL INSTALLATION, CONTACT THE POLK COUNTY TRAFFIC ENGINEERING SIGNAL SHOP AT (863) 535-2200.
2. FOR REMOVED SIGNAL EQUIPMENT, CONTACT POLK COUNTY TRAFFIC ENGINEERING SIGNAL SHOP AT (863) 535-2200 TO CONFIRM THE LOCATION AND DELIVERY OF SALVAGEABLE MATERIALS.
3. WHEN CONSTRUCTION IS COMPLETE, IN ADDITION TO THE REQUIREMENT OF STANDARD SPECIFICATION 9-8, PROVIDE A SET OF "AS-BUILT" PLANS TO:

POLK COUNTY TRAFFIC ENGINEERING  
AMY SHAFER GREGORY, P.E., TRAFFIC ENGINEER  
3000 SHEFFIELD RD.  
WINTER HAVEN, FL 33880

- SIGNALIZATION PAY ITEM NOTES:
1. 630-2-11 AND 630-2-12:  
ALL CONDUIT RUNS SHOWN ON THE PLANS ARE SCHEMATIC AND FIELD ADJUSTMENTS MAY BE NECESSARY, WITH THE EXCEPTION OF ELECTRICAL POWER SERVICE DUCTS. ALL UNDERGROUND CONDUITS SHALL BE SCHEDULE 40PVC, UNLESS OTHERWISE SPECIFIED IN THE PLANS. ALL CONDUIT SHALL BE TERMINATED WITH A BELL END AND SPARES ARE TO BE CAPPED AND HAVE TRACK WIRE OR MULE TAPE.
  2. 632-7-1:  
COMPLETELY REWIRE INTERSECTION PROPOSED LOOPS AT ALL SIGNAL LOCATIONS.  
  
VERIFY THE COLOR CODE OF SIGNAL CABLE WITH THE MAINTAINING AGENCY PRIOR TO WIRING THE LOOPS.  
  
ALL FIELD WIRING MUST BE NEATLY BUNDLED AND CLEARLY IDENTIFIED WITH PERMANENT, LEGIBLE, WEATHER-PROOF TAGS THAT ARE SECURELY ATTACHED TO EACH CABLE. THE TAGGING SYSTEM PROPOSED SHALL BE SUBMITTED FOR APPROVAL WITH THE OTHER EQUIPMENT SUBMITTALS REQUIRED FOR THIS PROJECT.
  3. 632-7-6:  
INCLUDES THE REMOVAL OF THE EXISTING CODUCTORS AND CONDUITS OF THE EXITING DETECTION LOOPS IF NOT UTILIZED.
  4. 635-2-11:  
PULL BOXES ARE TO BE PLACED BEHIND CURB AND GUTTER. IF THERE IS NO CURB AND GUTTER, PULL BOXES SHALL BE PLACED A MINIMUM OF 7' FROM THE EDGE OF PAVEMENT. ALL PULL BOXES INCLUDE CONCRETE MOW PAD APRONS.  
  
INCLUDES THE COST FOR THE REMOVAL OF EXISTING PULL BOXES AND ASSOCIATED CONCRETE MOW PADS.  
  
USE POLYMER CONCRETE CONSTRUCTION PULL BOXES WITH POLYMER CONCRETE COVERS. SIGNALIZATION PULL BOXES AND COVERS MUST INCLUDE THE RAISED LOGO "TRAFFIC SIGNAL" FOR SIGNALIZATION PULL BOXES.
  5. 660-2-101, 660-2-102, AND 660-2-106:  
PERMANENTLY MARK EACH LOOP PER PHASE AND PER VEHICLE MOVEMENT AT EACH SPLICE POINT AND AT THE CABINET TERMINATION POINT.  
  
FOR INCREASED SENSITIVITY, INDUCTANCE LOOPS TO HAVE A MINIMUM OF THREE TURNS OF WIRE.
  6. 671-2-40:  
INCLUDES ADJUSTMENT OF SIGNAL TIMINGS AND NEW LOOP DETECTORS INSTALLATION.
  7. 676-1-500:  
CORE-DRILL EXISTING CONTROLLER CABINET BASE AND INSTALL NEW CONDUITS IF SPARE CONDUIT STUB-OUTS CANNOT BE USED. INSTALL NEW CONDUITS INTO THE EXISTING FOUNDATION AS REQUIRED IN PLANS. WHEN ADDITIONAL CONDUITS ARE REQUIRED, THE CONDUIT SHALL BE A MINIMUM OF 2" IN DIAMETER. LOCATE NEW CONDUITS SO THEY WILL NOT OBSTRUCT THE MAINTENANCE OF EQUIPMENT IN THE CABINET OR THE ANCHORING OF THE CABINET FLANGE TO THE CONCRETE FOUNDATION. PROTECT INTERNAL CABINET AND EQUIPMENT FROM DUST AND DEBRIS CAUSED BY CORE DRILLING.  
  
IF THE CONTROLLER CABINET BASE CANNOT ACCOMMODATE ADDITIONAL CONDUITS VIA CORE DRILLING, CONTROLLER MODIFICATION INCLUDES A COMPLETE BASE RECONSTRUCTION.

REVISIONS				ENGINEER OF RECORD	STATE OF FLORIDA DEPARTMENT OF TRANSPORTATION			SHEET NO.
DATE	DESCRIPTION	DATE	DESCRIPTION	VICKEN SERPEKIAN, P.E., P.T.O.E. LICENSE NUMBER: 82646 ELEMENT ENGINEERING GROUP, LLC 1713 E. 9TH AVENUE TAMPA, FL 33605	ROAD NO.	COUNTY	FINANCIAL PROJECT ID	GENERAL NOTES
					S.R. 35	POLK	451481-1-52-01	
								T-2

THE OFFICIAL RECORD OF THIS SHEET IS THE ELECTRONIC FILE DIGITALLY SIGNED AND SEALED UNDER RULE 61G15-23.004, F.A.C.

BEGIN PROJECT  
BEGN CONSTRUCTION  
BEGIN MILLING  
& RESURFACING  
STA. 500+41.85  
CL CONST. S.R. 35 (U.S. 98)

PROPOSED TYPE A SIGNAL  
DETECTION LOOP IS 6'x20' PLACED  
2' IN FRONT OF STOP BAR (TYP.)

EXISTING STRAIN POLE  
TO REMAIN (TYP.)

EXISTING CONTROLLER  
CABINET TO REMAIN

8 LF (4 RUNS, (4) LV) 630-2-12  
1 PI 632-7-1  
1 PI 632-7-6  
1 EA 671-2-40  
1 EA 676-1-500

4 LF (1 RUN, (1) LV) 630-2-12  
2 EA 635-2-11

155 LF (3 RUNS, (3) LV) 630-2-12

CL CONST. S.R. 35 (U.S. 98)

10 LF (1 RUN, (1) LV) 630-2-12  
1 EA 635-2-11

278 LF (2 RUNS, (2) LV) 630-2-12

10 LF (1 RUN, (1) LV) 630-2-12  
1 EA 635-2-11

12 LF (1 RUN, (1) LV) 630-2-12  
2 EA 635-2-11

LEGEND

MILL & RESURFACE 127 LF (2 RUNS, (2) LV) 630-2-12

633-6 100 DA

S.R. 35 (U.S. 98) AT TARGET/MALL ENTRANCE  
ROADWAY ID 16210000, MP 3.622  
SIGNAL ID: 767

MALL ACCESS 3

TARGET ENTRANCE

1"=40'

630-2-12 136 LF (3 RUNS, (3) LV)  
635-2-11 1 EA

630-2-12 10 LF (1 RUN, (1) LV)

10 LF (1 RUN, (1) LV)

630-2-12 1 EA  
635-2-11

137 LF (1 RUN, (1) LV) 630-2-11

PROPOSED TYPE B SIGNAL  
DETECTION LOOP (TYP.)

16 AS 660-2-102

R/W LINE  
154 LF (2 RUNS, (2) LV) 630-2-11

10 LF (1 RUN, (1) LV) 630-2-12  
1 EA 635-2-11

S.R. 35 (U.S. 98)

504

166'

505

132'

50

L-5

L-5

190

189

188

503

187

186

501

184

132'

S6A1

S6A2

S6A3

S6A4

S6B1

S6B2

S6B3

S6B4

CL SURVEY S.R. 35 (U.S. 98)

R/W LINE

R/W LINE

R/W LINE

630-2-11 5 LF (1 RUN, (1) LV)  
635-2-11 1 EA

NOTES:

1. MAJOR STREET IS S.R. 35 (U.S. 98): MOVEMENTS 1, 2, 5, AND 6.  
MINOR STREET IS TARGET/MALL ENTRANCE: MOVEMENTS 3, 4, 4R, 7, 8, AND 8R.
2. THE POSTED SPEED LIMITS ARE AS FOLLOWS:  
S.R. 35 (U.S. 98): 45 MPH  
TARGET/MALL ENTRANCE: EXISTING TO REMAIN
3. EXISTING SIGNAL OPERATING PLAN TO REMAIN.
4. EXISTING SIGNAL CONTROLLER TIMINGS TO REMAIN.
5. ALL EXISTING SIGNAL INFRASTRUCTURE, WITH THE EXCEPTION OF THE EXISTING  
DETECTION LOOPS IMPACTED BY THE MILLING AND RESURFACING, ARE TO REMAIN.

REVISIONS				ENGINEER OF RECORD			STATE OF FLORIDA DEPARTMENT OF TRANSPORTATION			SIGNALIZATION PLAN	SHEET NO.  T-3
DATE	DESCRIPTION	DATE	DESCRIPTION	VICKEN SERPEKIAN, P.E., P.T.O.E. LICENSE NUMBER: 82646 ELEMENT ENGINEERING GROUP, LLC 1713 E. 9TH AVENUE TAMPA, FL 33605			ROAD NO.	COUNTY	FINANCIAL PROJECT ID		
							S.R. 35	POLK	451481-1-52-01		

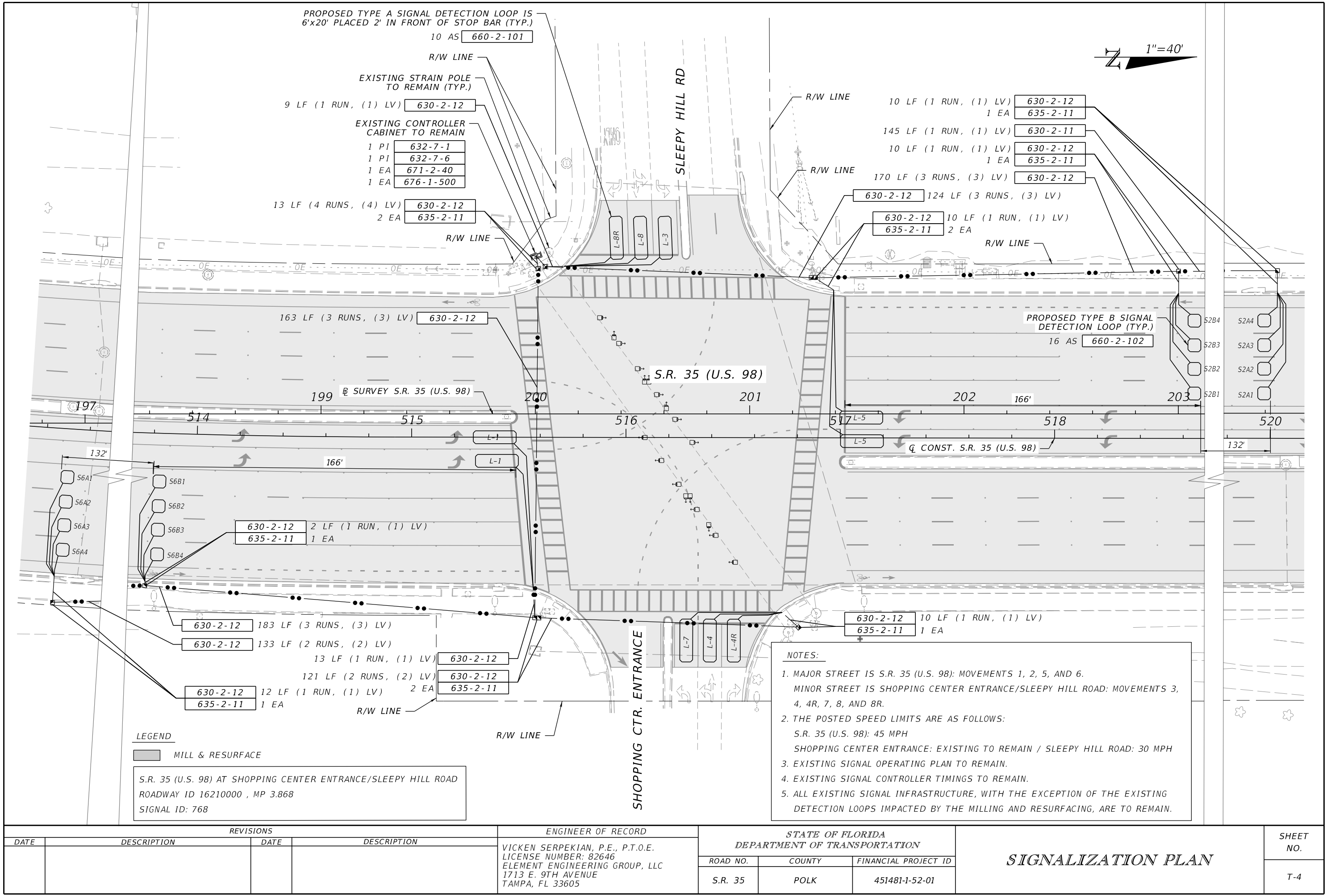

PROPOSED TYPE A SIGNAL DETECTION LOOP IS 6'x20' PLACED 2' IN FRONT OF STOP BAR (TYP.)

10 AS 660-2-101

R/W LINE

EXISTING STRAIN POLE TO REMAIN (TYP.)

9 LF (1 RUN, (1) LV) 630-2-12

EXISTING CONTROLLER CABINET TO REMAIN

1 PI 632-7-1  
1 PI 632-7-6  
1 EA 671-2-40  
1 EA 676-1-500

13 LF (4 RUNS, (4) LV) 630-2-12  
2 EA 635-2-11

R/W LINE

SLEEPY HILL RD

R/W LINE

10 LF (1 RUN, (1) LV) 630-2-12  
1 EA 635-2-11

145 LF (1 RUN, (1) LV) 630-2-11

10 LF (1 RUN, (1) LV) 630-2-12  
1 EA 635-2-11

170 LF (3 RUNS, (3) LV) 630-2-12

630-2-12 124 LF (3 RUNS, (3) LV)

630-2-12 10 LF (1 RUN, (1) LV)  
635-2-11 2 EA

R/W LINE

PROPOSED TYPE B SIGNAL DETECTION LOOP (TYP.)  
16 AS 660-2-102

S2B4  
S2A4  
S2A3  
S2A2  
S2A1

S.R. 35 (U.S. 98)

199 SURVEY S.R. 35 (U.S. 98)

202

203

514

515

516

517

518

520

Q CONST. S.R. 35 (U.S. 98)

132'

166'

132'

S6A1  
S6A2  
S6A3  
S6A4

S6B1  
S6B2  
S6B3  
S6B4

630-2-12 2 LF (1 RUN, (1) LV)  
635-2-11 1 EA

630-2-12 183 LF (3 RUNS, (3) LV)

630-2-12 133 LF (2 RUNS, (2) LV)

13 LF (1 RUN, (1) LV)

121 LF (2 RUNS, (2) LV)

630-2-12 12 LF (1 RUN, (1) LV) 2 EA  
635-2-11 1 EA

R/W LINE

R/W LINE

SHOPPING CTR. ENTRANCE

L-7

L-4

L-4R

630-2-12 10 LF (1 RUN, (1) LV)  
635-2-11 1 EA

NOTES:

1. MAJOR STREET IS S.R. 35 (U.S. 98): MOVEMENTS 1, 2, 5, AND 6.  
MINOR STREET IS SHOPPING CENTER ENTRANCE/SLEEPY HILL ROAD: MOVEMENTS 3, 4, 4R, 7, 8, AND 8R.
2. THE POSTED SPEED LIMITS ARE AS FOLLOWS:  
S.R. 35 (U.S. 98): 45 MPH  
SHOPPING CENTER ENTRANCE: EXISTING TO REMAIN / SLEEPY HILL ROAD: 30 MPH
3. EXISTING SIGNAL OPERATING PLAN TO REMAIN.
4. EXISTING SIGNAL CONTROLLER TIMINGS TO REMAIN.
5. ALL EXISTING SIGNAL INFRASTRUCTURE, WITH THE EXCEPTION OF THE EXISTING DETECTION LOOPS IMPACTED BY THE MILLING AND RESURFACING, ARE TO REMAIN.

LEGEND

MILL & RESURFACE

S.R. 35 (U.S. 98) AT SHOPPING CENTER ENTRANCE/SLEEPY HILL ROAD  
ROADWAY ID 16210000 , MP 3.868  
SIGNAL ID: 768

REVISIONS				ENGINEER OF RECORD			STATE OF FLORIDA DEPARTMENT OF TRANSPORTATION			SHEET NO.
DATE	DESCRIPTION	DATE	DESCRIPTION	VICKEN SERPEKIAN, P.E., P.T.O.E. LICENSE NUMBER: 82646 ELEMENT ENGINEERING GROUP, LLC 1713 E. 9TH AVENUE TAMPA, FL 33605			ROAD NO.	COUNTY	FINANCIAL PROJECT ID	
							S.R. 35	POLK	451481-1-52-01	

SIGNALIZATION PLAN

T-4

THE OFFICIAL RECORD OF THIS SHEET IS THE ELECTRONIC FILE DIGITALLY SIGNED AND SEALED UNDER RULE 61G15-23.004, F.A.C.

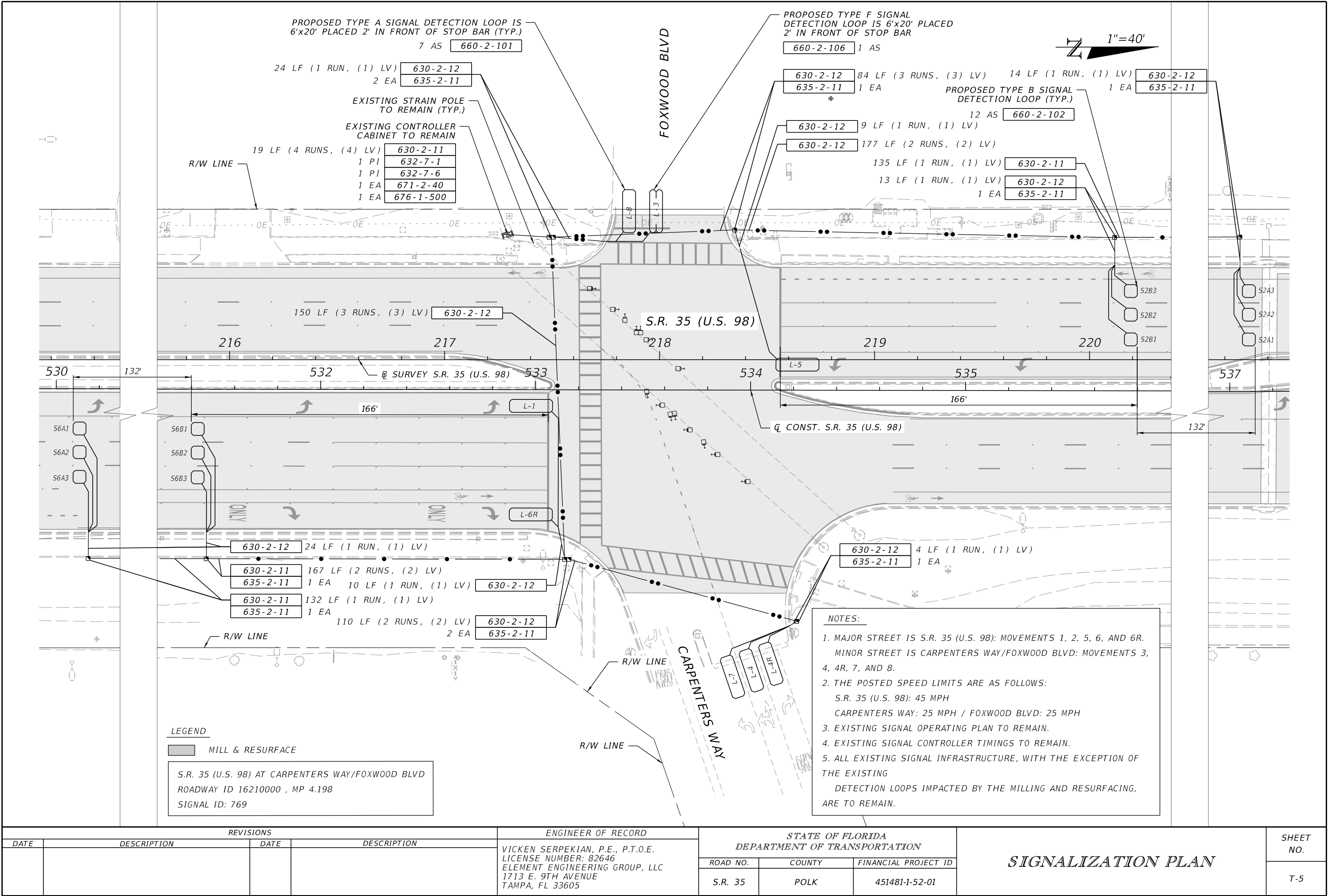

THE OFFICIAL RECORD OF THIS SHEET IS THE ELECTRONIC FILE DIGITALLY SIGNED AND SEALED UNDER RULE 61G15-23.004, F.A.C.

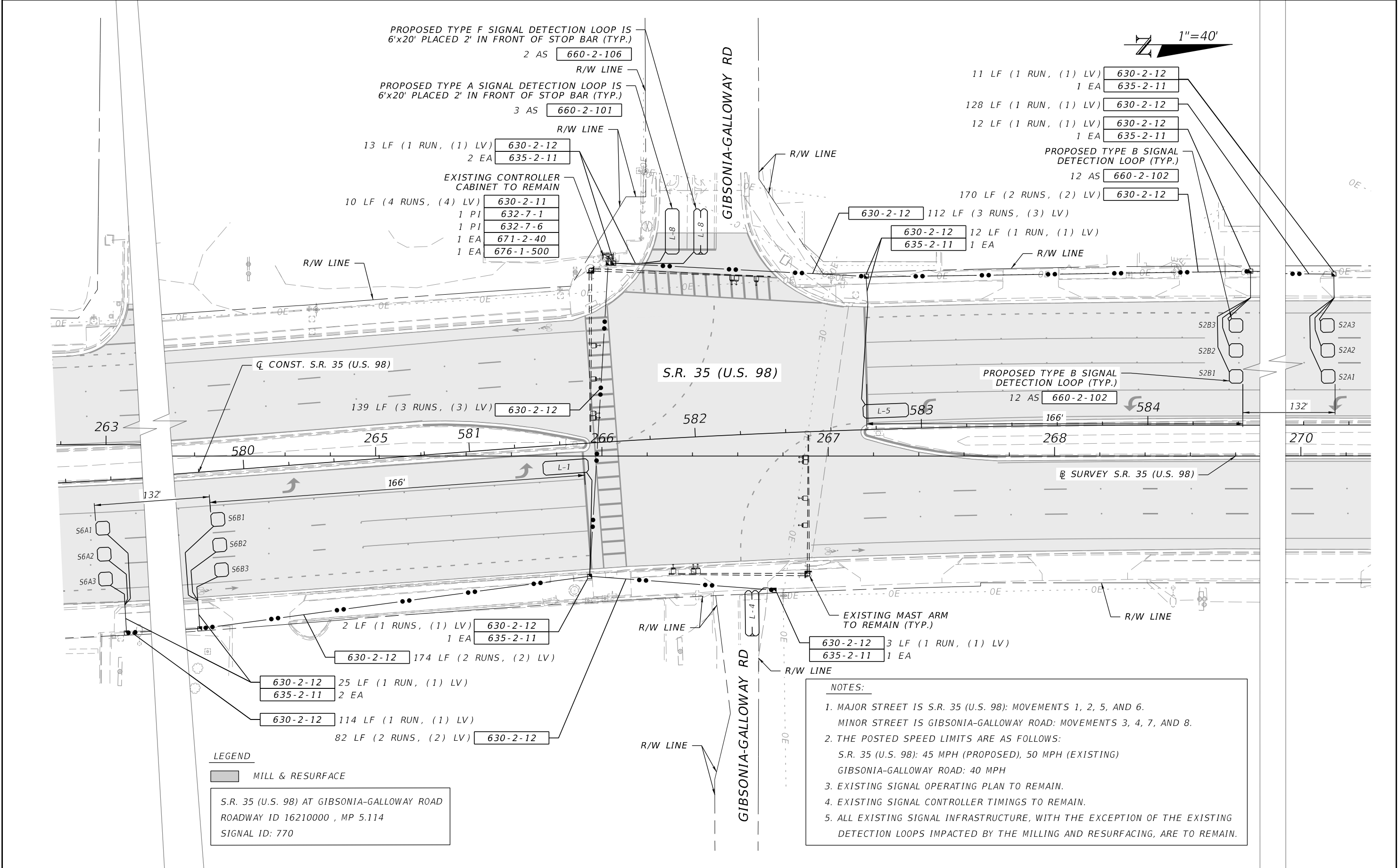

REVISIONS				ENGINEER OF RECORD		STATE OF FLORIDA DEPARTMENT OF TRANSPORTATION			SIGNALIZATION PLAN	SHEET NO.  T-6
DATE	DESCRIPTION	DATE	DESCRIPTION	VICKEN SERPEKIAN, P.E., P.T.O.E. LICENSE NUMBER: 82646 ELEMENT ENGINEERING GROUP, LLC 1713 E. 9TH AVENUE TAMPA, FL 33605		ROAD NO.	COUNTY	FINANCIAL PROJECT ID		
						S.R. 35	POLK	451481-1-52-01		

