

CONTRACT PLANS COMPONENTS

ROADWAY
SIGNING AND PAVEMENT MARKING
LIGHTING
SIGNALIZATION

**STATE OF FLORIDA
DEPARTMENT OF TRANSPORTATION**

SIGNING AND PAVEMENT MARKING PLANS

FINANCIAL PROJECT ID 439750-2-52-01

HIGHLANDS COUNTY (09010000 & 09030000)

STATE ROAD NO. 25 (US 27)

FROM SOUTH OF SR 66 TO NORTH OF SR 66

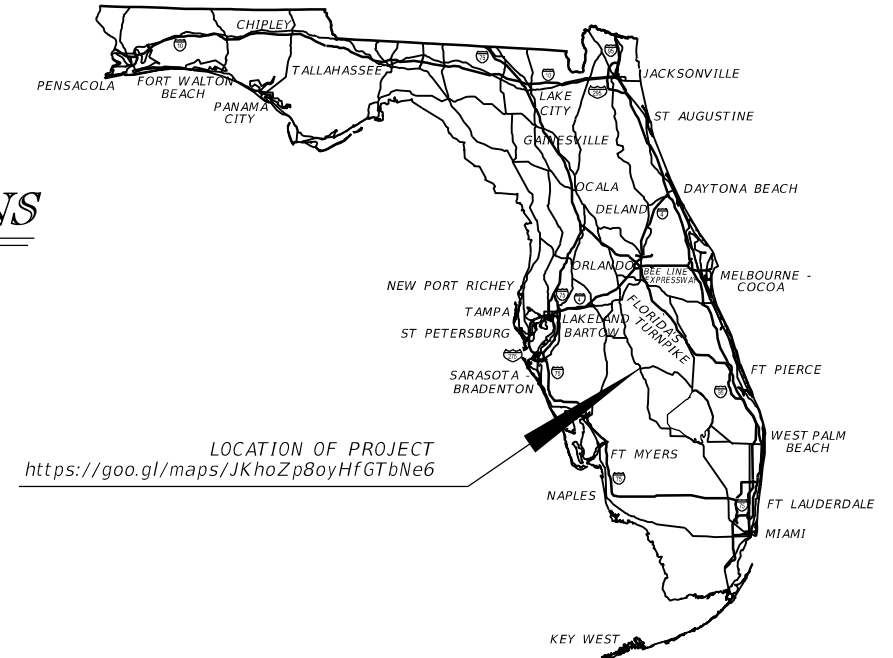

INDEX OF SIGNING AND PAVEMENT MARKING PLANS

SHEET NO.	SHEET DESCRIPTION
S-1	KEY SHEET
S-2	GENERAL NOTES
S-3 TO S-13	SIGNING AND PAVEMENT MARKING PLANS
S-14 TO S-15	GUIDE SIGN WORKSHEETS

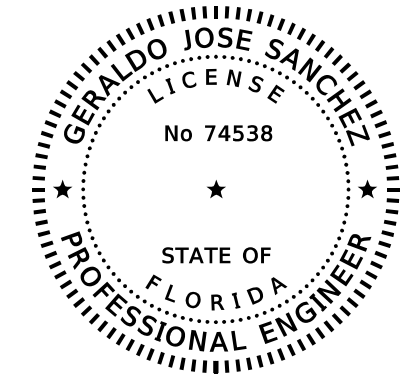
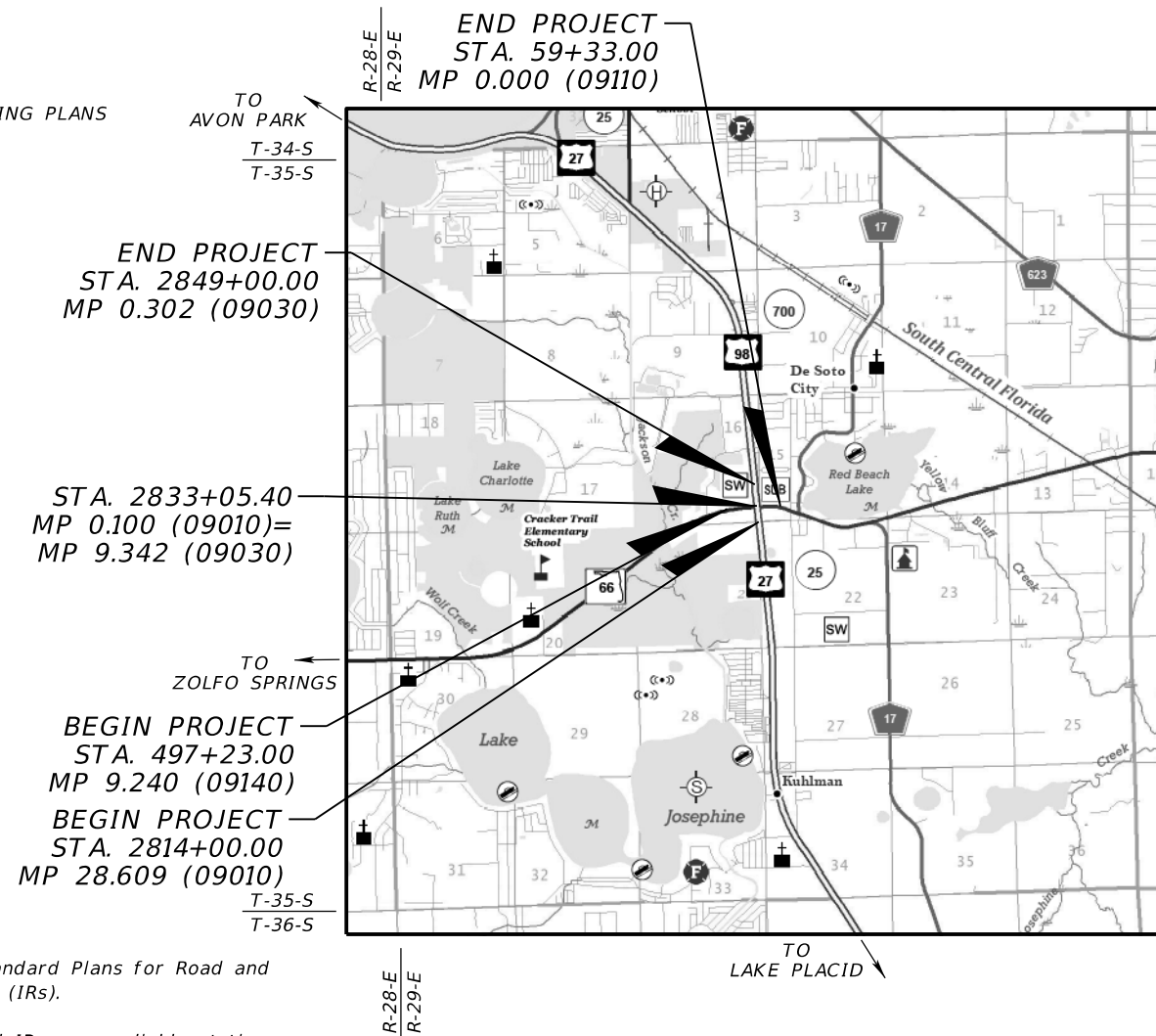

PHASE IV
APRIL 2026

THIS ITEM HAS BEEN DIGITALLY SIGNED AND SEALED BY

ON THE DATE ADJACENT TO THE SEAL
SIGNATURE MUST BE VERIFIED ON ANY ELECTRONIC COPIES.

**SIGNING AND PAVEMENT MARKING PLANS
ENGINEER OF RECORD:**

GERALDO JOSE SANCHEZ, P.E.
P.E. LICENSE NUMBER 74538
PATEL GREENE AND ASSOCIATES, LLC
200 E ROBINSON ST., SUITE 300
ORLANDO, FL 32801
(407) 720-7420
CONTRACT NO.: C9Y78
VENDOR NO.: F452209743/43-001

FDOT PROJECT MANAGER:
JENNIFER FREEMAN

GOVERNING STANDARD PLANS:

Florida Department of Transportation, FY2026-27 Standard Plans for Road and Bridge Construction and applicable Interim Revisions (IRs).

Standard Plans for Road Construction and associated IRs are available at the following website: <http://www.fdot.gov/design/standardplans>

Standard Plans for Bridge Construction are included in the Structures Plans Component

GOVERNING STANDARD SPECIFICATIONS:

Florida Department of Transportation, FY 2026-27 Standard Specifications for Road and Bridge Construction at the following website: <http://www.fdot.gov/programmanagement/Implemented/SpecBooks>

CONSTRUCTION CONTRACT NO.	FISCAL YEAR	SHEET NO.
T1947	27	S-1

4/24/2026 3:54:51 PM USER: kyle.southwell c:\pw\workdir\pateelgreene-pw-01\pw_user\dms02462\KEYSSP01.dgn



THE OFFICIAL RECORD OF THIS SHEET IS THE ELECTRONIC FILE DIGITALLY SIGNED AND SEALED UNDER RULE 61G15-23.004, F.A.C.

GENERAL NOTES:

- 1) EXERCISE CAUTION WORKING AROUND EXISTING SIGNS TO REMAIN OR WHILE RELOCATING EXISTING SIGNS SO AS TO PREVENT DAMAGE TO THE SIGNS. IF THE SIGNS ARE DAMAGED BEYOND USE BY WORK OPERATIONS, AS DETERMINED BY THE ENGINEER, THE SIGNS SHALL BE REPLACED AT NO COST TO THE DEPARTMENT.
- 2) THE PROPOSED PAVEMENT MARKINGS ARE INTENDED TO MATCH THE EXISTING STRIPING CONFIGURATION.
- 3) ALL ROUTE MARKER AUXILIARIES SHALL MATCH THE COLOR COMBINATION OF THE RESPECTIVE MARKER WHICH THEY SUPPLEMENT.
- 4) ALL ABBREVIATIONS CORRESPOND TO THE FOLLOWING DEFINITIONS:

DBL = DOUBLE
 RPMS= RETRO-REFLECTIVE PAVEMENT MARKERS
 WHT = WHITE
 W/R = WHITE/RED
 YEL = YELLOW
 Y/Y = YELLOW/YELLOW
 OG = OPEN GRADED ASPHALT SURFACES
 OT = OTHER SURFACES
 TAPE = PERMANENT TAPE
 PRE = PREFORMED THERMOPLASTIC
 PROF = PROFILED THERMOPLASTIC

TURN ARROW LEGEND

-  DIRECTIONAL ARROW PRE W/ BLK CONTRAST BLOCK
-  DIRECTIONAL ARROW PRE W/ BLK CONTRAST BORDER
-  DIRECTIONAL ARROW (STANDARD THERMOPLASTIC)

4/24/2026 3:55:02 PM USER: kyle.southwell
 c:\pw_work\air\patel\greene-pw-01\pw_user\dms02462\GNWTSPO1.dgn

THE OFFICIAL RECORD OF THIS SHEET IS THE ELECTRONIC FILE DIGITALLY SIGNED AND SEALED UNDER RULE 61G15-23.004, F.A.C.

REVISIONS				ENGINEER OF RECORD	STATE OF FLORIDA DEPARTMENT OF TRANSPORTATION			GENERAL NOTES	SHEET NO.
DATE	DESCRIPTION	DATE	DESCRIPTION	GERALDO J. SANCHEZ, P.E. LICENSE NUMBER 74538 PATEL, GREENE & ASSOCIATES, LLC 200 E ROBINSON ST., SUITE 300 ORLANDO, FL 32801	ROAD NO.	COUNTY	FINANCIAL PROJECT ID		S-2
						SR 25	HIGHLANDS		

1" = 40'

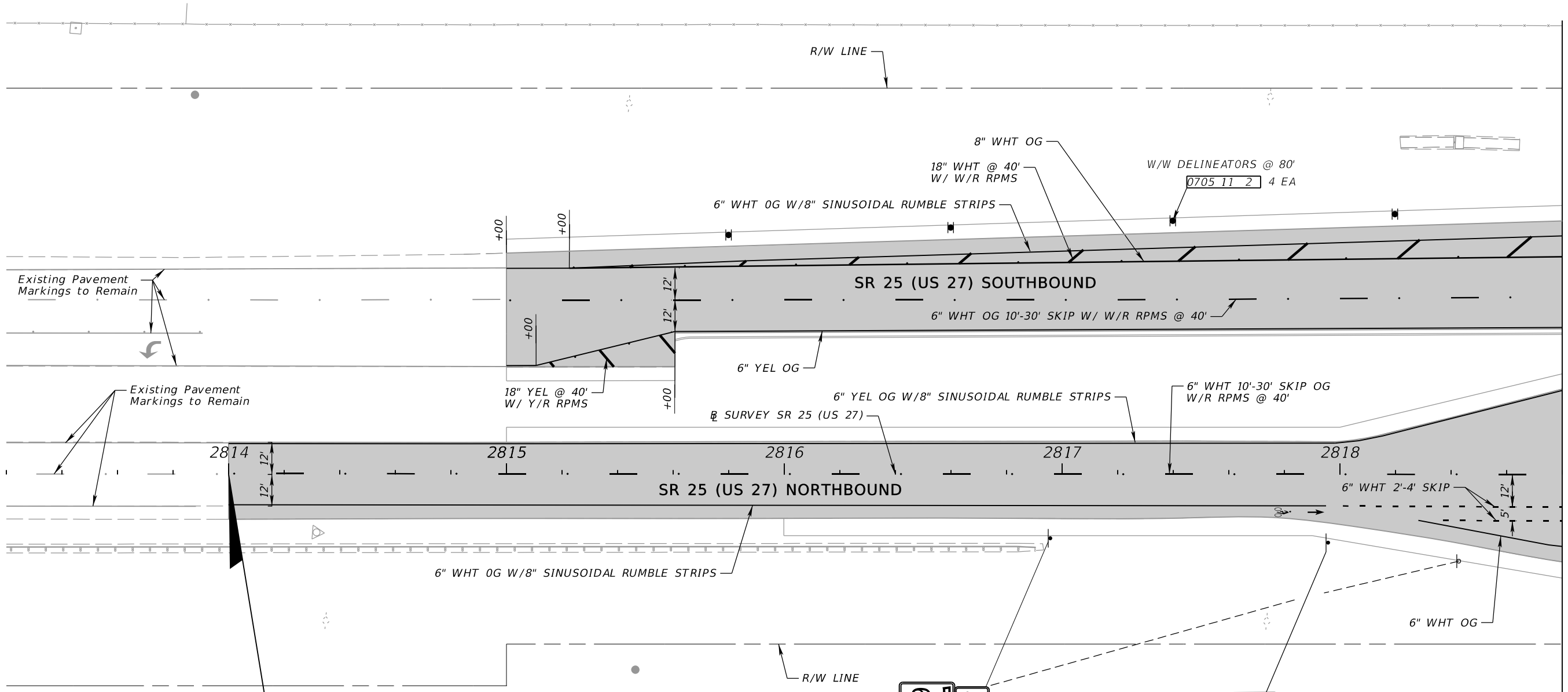

BEGIN PROJECT
 BEGIN SIGNING AND PAVEMENT MARKINGS
 MATCH EXISTING PAVEMENT MARKINGS
 SURVEY SR 25 (US 27)
 STA. 2814+00.00

LEGEND
 MILLING AND RESURFACING

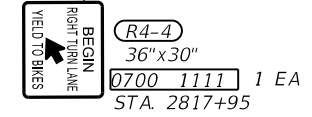
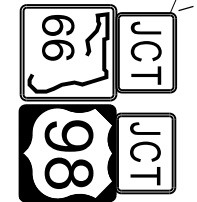

4/24/2026 3:55:24 PM USER: kyle.southwell c:\pw\workdir\patel\greene-pw-01\pw_user\dms02462\PLAN\SP01.dgn

THE OFFICIAL RECORD OF THIS SHEET IS THE ELECTRONIC FILE DIGITALLY SIGNED AND SEALED UNDER RULE 61G15-23.004, F.A.C.

REVISIONS				ENGINEER OF RECORD		STATE OF FLORIDA DEPARTMENT OF TRANSPORTATION			SHEET NO. S-3
DATE	DESCRIPTION	DATE	DESCRIPTION	GERALDO J. SANCHEZ, P.E. LICENSE NUMBER 74538 PATEL, GREENE & ASSOCIATES, LLC 200 E ROBINSON ST., SUITE 300 ORLANDO, FL 32801		ROAD NO.	COUNTY	FINANCIAL PROJECT ID	
						SR 25	HIGHLANDS	439750-2-52-01	
SIGNING AND PAVEMENT MARKING PLAN (1)									

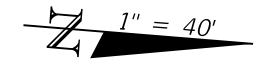

SIGN PANEL SP-1
7'-6" X 3'-0"
0700 2113 1 EA
0700 2600 1 EA
STA 2823+95

Lake Placid 10
Miami 158

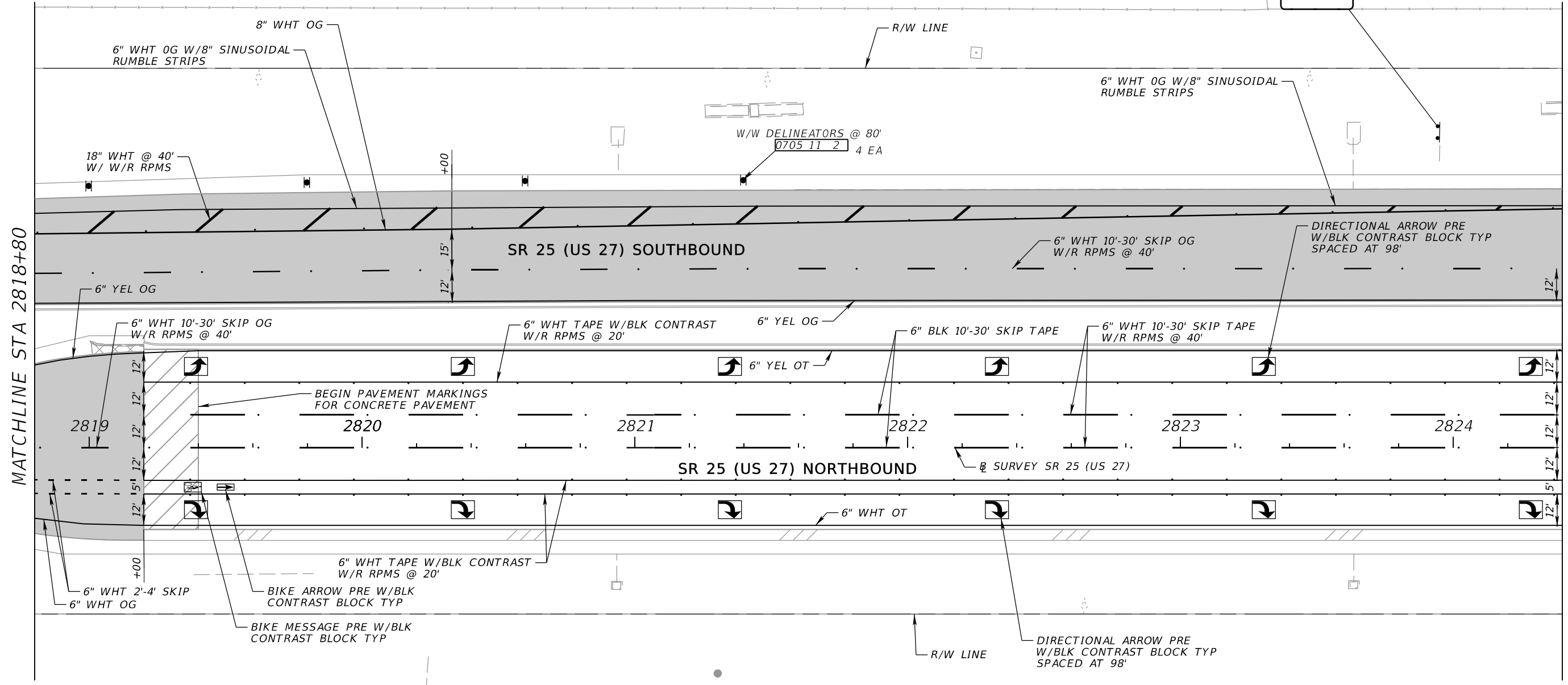

MATCHLINE STA 2818+80

MATCHLINE STA 2824+40

LEGEND

	MILLING AND RESURFACING
	CONCRETE REMOVAL
	PAVEMENT TRANSITION

4/24/2026 3:55:24 PM USER: kyle.southwell c:\pw_wor\kair\patel\greene-pw-01\pw_user\dms02462\PLAN\SP01.dgn

THE OFFICIAL RECORD OF THIS SHEET IS THE ELECTRONIC FILE DIGITALLY SIGNED AND SEALED UNDER RULE 61G15-23.004, F.A.C.

REVISIONS				ENGINEER OF RECORD			STATE OF FLORIDA DEPARTMENT OF TRANSPORTATION			SHEET NO.
DATE	DESCRIPTION	DATE	DESCRIPTION	GERALDO J. SANCHEZ, P.E. LICENSE NUMBER 74538 PATEL, GREENE & ASSOCIATES, LLC 200 E ROBINSON ST., SUITE 300 ORLANDO, FL 32801			ROAD NO.	COUNTY	FINANCIAL PROJECT ID	
				SR 25	HIGHLANDS	439750-2-52-01	SIGNING AND PAVEMENT MARKING PLAN (2)			
										S-4

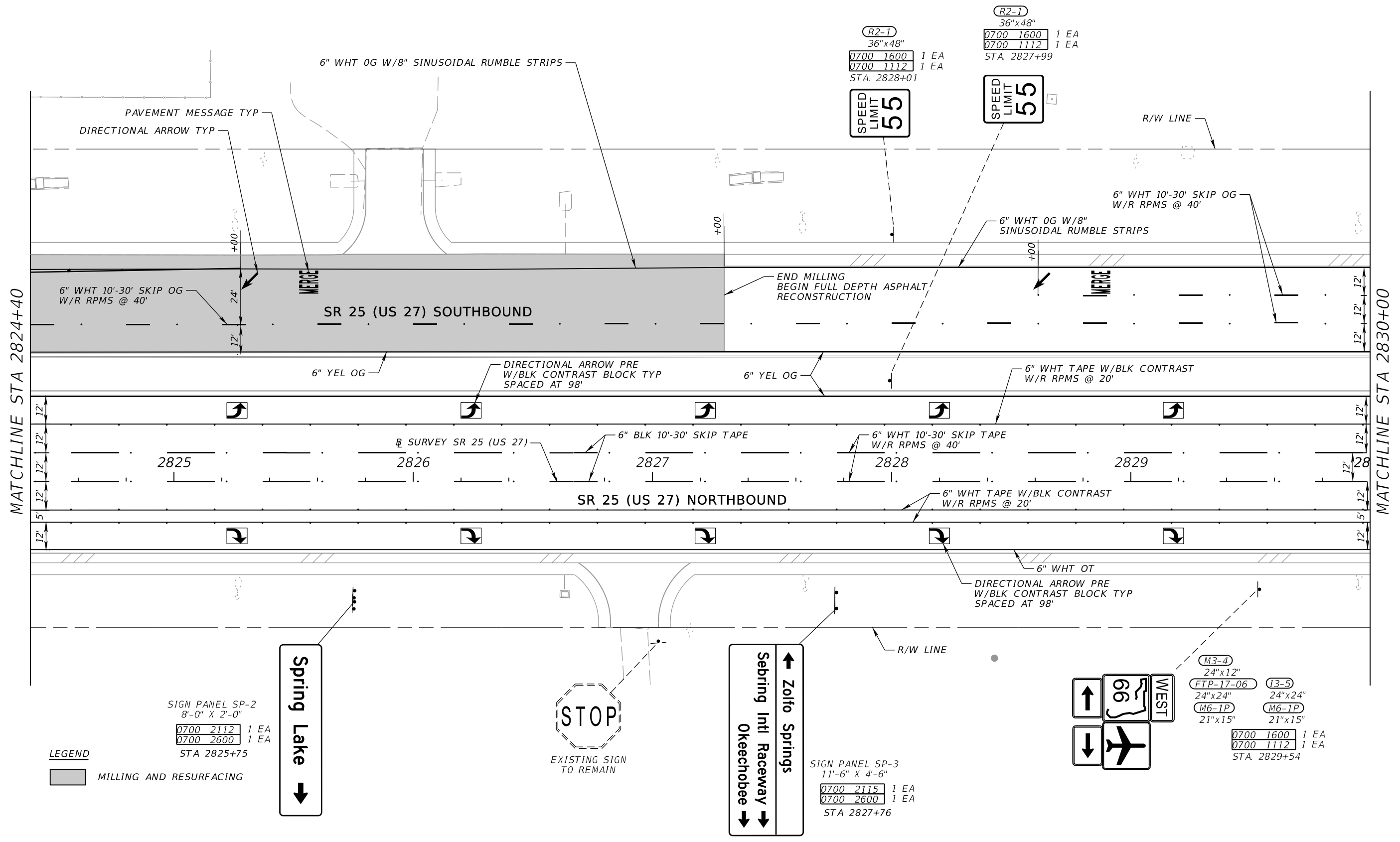
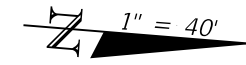

LEGEND
 [Shaded Box] MILLING AND RESURFACING

SIGN PANEL SP-2
 8'-0" X 2'-0"
 0700 2112 1 EA
 0700 2600 1 EA
 STA 2825+75

STOP
 EXISTING SIGN
 TO REMAIN

SIGN PANEL SP-3
 11'-6" X 4'-6"
 0700 2115 1 EA
 0700 2600 1 EA
 STA 2827+76

(M3-4) 24"x12"
 (FTP-17-06) 24"x24"
 (M6-1P) 21"x15"
 (13-5) 24"x24"
 (M6-1P) 21"x15"
 0700 1600 1 EA
 0700 1112 1 EA
 STA. 2829+54

4/24/2026 3:55:25 PM USER: kyle.southwell c:\pw\workdir\patel\greene-pw-01\pw_user\dms02462\PLANS\SP01.dgn

THE OFFICIAL RECORD OF THIS SHEET IS THE ELECTRONIC FILE DIGITALLY SIGNED AND SEALED UNDER RULE 61G15-23.004, F.A.C.

REVISIONS		ENGINEER OF RECORD		STATE OF FLORIDA DEPARTMENT OF TRANSPORTATION			SHEET NO.
DATE	DESCRIPTION	DATE	DESCRIPTION	ROAD NO.	COUNTY	FINANCIAL PROJECT ID	
				SR 25	HIGHLANDS	439750-2-52-01	
				SIGNING AND PAVEMENT MARKING PLAN (3)			S-5

LEGEND

PAVEMENT TRANSITION

1" = 40'

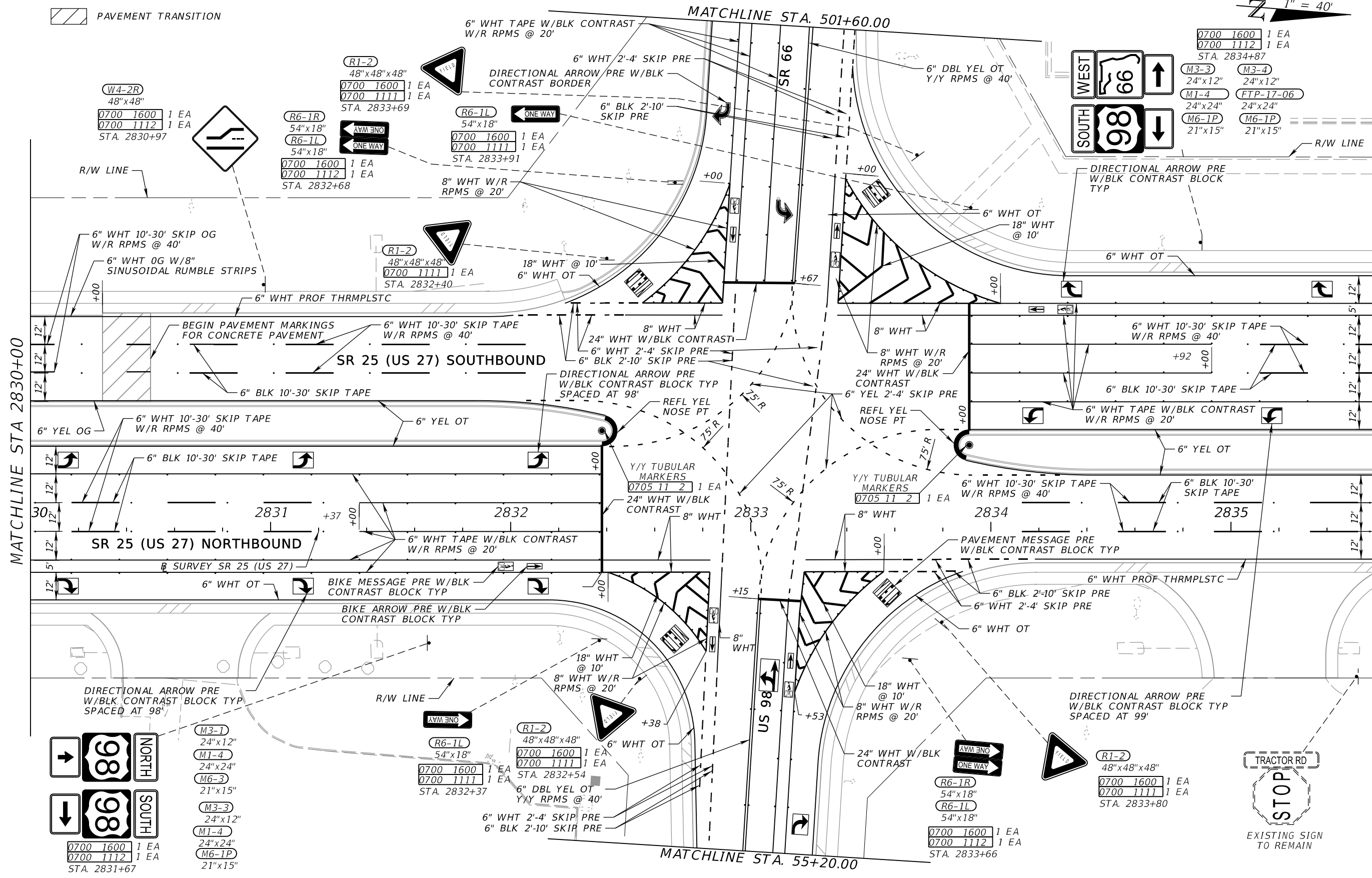

MATCHLINE STA 2830+00

MATCHLINE STA 2835+60

MATCHLINE STA. 501+60.00

MATCHLINE STA. 55+20.00

W4-2R
48"x48"
0700 1600 1 EA
0700 1112 1 EA
STA. 2830+97

R1-2
48"x48"x48"
0700 1600 1 EA
0700 1111 1 EA
STA. 2833+69

R6-1R
54"x18"
0700 1600 1 EA
0700 1112 1 EA
STA. 2832+68

R6-1L
54"x18"
0700 1600 1 EA
0700 1111 1 EA
STA. 2833+91

R1-2
48"x48"x48"
0700 1111 1 EA
STA. 2832+40

0700 1600 1 EA
0700 1112 1 EA
STA. 2834+87

M3-3 24"x12" 1 EA
M3-4 24"x12" 1 EA

M1-4 24"x24" 1 EA
FTP-17-06 24"x24" 1 EA

M6-1P 21"x15" 1 EA
M6-1P 21"x15" 1 EA

M3-1 24"x12" 1 EA
M1-4 24"x24" 1 EA
M6-3 21"x15" 1 EA
M3-3 24"x12" 1 EA
M1-4 24"x24" 1 EA
M6-1P 21"x15" 1 EA
0700 1600 1 EA
0700 1112 1 EA
STA. 2831+67

R6-1L
54"x18"
0700 1600 1 EA
0700 1111 1 EA
STA. 2832+37

R1-2
48"x48"x48"
0700 1600 1 EA
0700 1111 1 EA
STA. 2832+54

R6-1R
54"x18"
0700 1600 1 EA
0700 1112 1 EA
STA. 2833+66

R1-2
48"x48"x48"
0700 1600 1 EA
0700 1111 1 EA
STA. 2833+80

4/24/2026 3:55:26 PM USER: kyle.southwell c:\pwworkdir\patel@greene-pw-01\pwworkdir\user\dms02462\PLANS\SP01.dgn

THE OFFICIAL RECORD OF THIS SHEET IS THE ELECTRONIC FILE DIGITALLY SIGNED AND SEALED UNDER RULE 61G15-23.004, F.A.C.

REVISIONS		ENGINEER OF RECORD		STATE OF FLORIDA DEPARTMENT OF TRANSPORTATION			SHEET NO.
DATE	DESCRIPTION	DATE	DESCRIPTION	ROAD NO.	COUNTY	FINANCIAL PROJECT ID	
				SR 25	HIGHLANDS	439750-2-52-01	

SIGNING AND PAVEMENT MARKING PLAN (4)

SHEET NO.
S-6

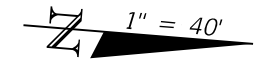

Spring Lake

SIGN PANEL SP-5
8'-0" X 2'-0"
0700 2112 1 EA
0700 2600 1 EA
STA 2841+91

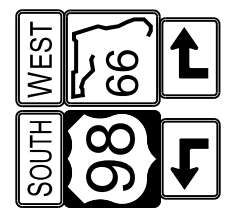

M3-3 24"x12"
M1-4 24"x24"
M5-1P 21"x15"
M3-4 24"x12"
FTP-17-06 24"x24"
M5-1P 21"x15"

0700 1600 1 EA
0700 1112 1 EA
STA. 2843+77

R4-4 36"x30"
0700 1111 1 EA
STA. 2845+46

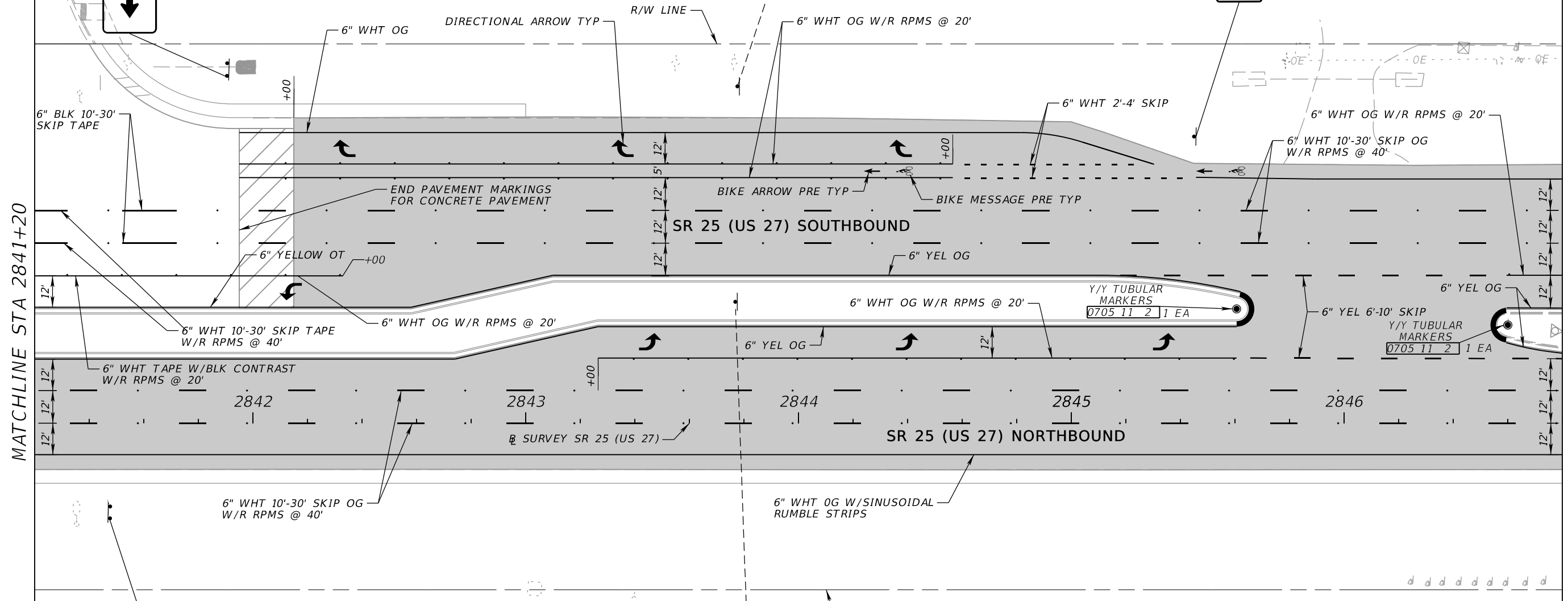

MATCHLINE STA 2841+20

MATCHLINE STA 2846+80

**Sebring
Haines City 53
4**

SIGN PANEL SP-6
7'-6" X 3'-0"
0700 2113 1 EA
0700 2600 1 EA
STA 2841+48

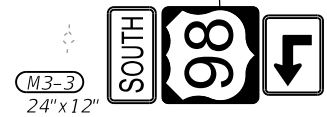

M3-3 24"x12"
M1-4 24"x24"
M5-1P 21"x15"
0700 1600 1 EA
0700 1111 1 EA
STA. 2843+77

LEGEND
 MILLING AND RESURFACING
 PAVEMENT TRANSITION

4/24/2026 3:55:27 PM USER: kyle.southwell c:\pw\workdir\patel\greene-pw-01\pw_user\dms02462\PLAN\SP01.dgn

THE OFFICIAL RECORD OF THIS SHEET IS THE ELECTRONIC FILE DIGITALLY SIGNED AND SEALED UNDER RULE 61G15-23.004, F.A.C.

REVISIONS		ENGINEER OF RECORD		STATE OF FLORIDA DEPARTMENT OF TRANSPORTATION			SHEET NO.
DATE	DESCRIPTION	DATE	DESCRIPTION	ROAD NO.	COUNTY	FINANCIAL PROJECT ID	
			GERALDO J. SANCHEZ, P.E. LICENSE NUMBER 74538 PATEL, GREENE & ASSOCIATES, LLC 200 E ROBINSON ST., SUITE 300 ORLANDO, FL 32801	SR 25	HIGHLANDS	439750-2-52-01	S-8
				SIGNING AND PAVEMENT MARKING PLAN (6)			

EXISTING SIGN TO REMAIN

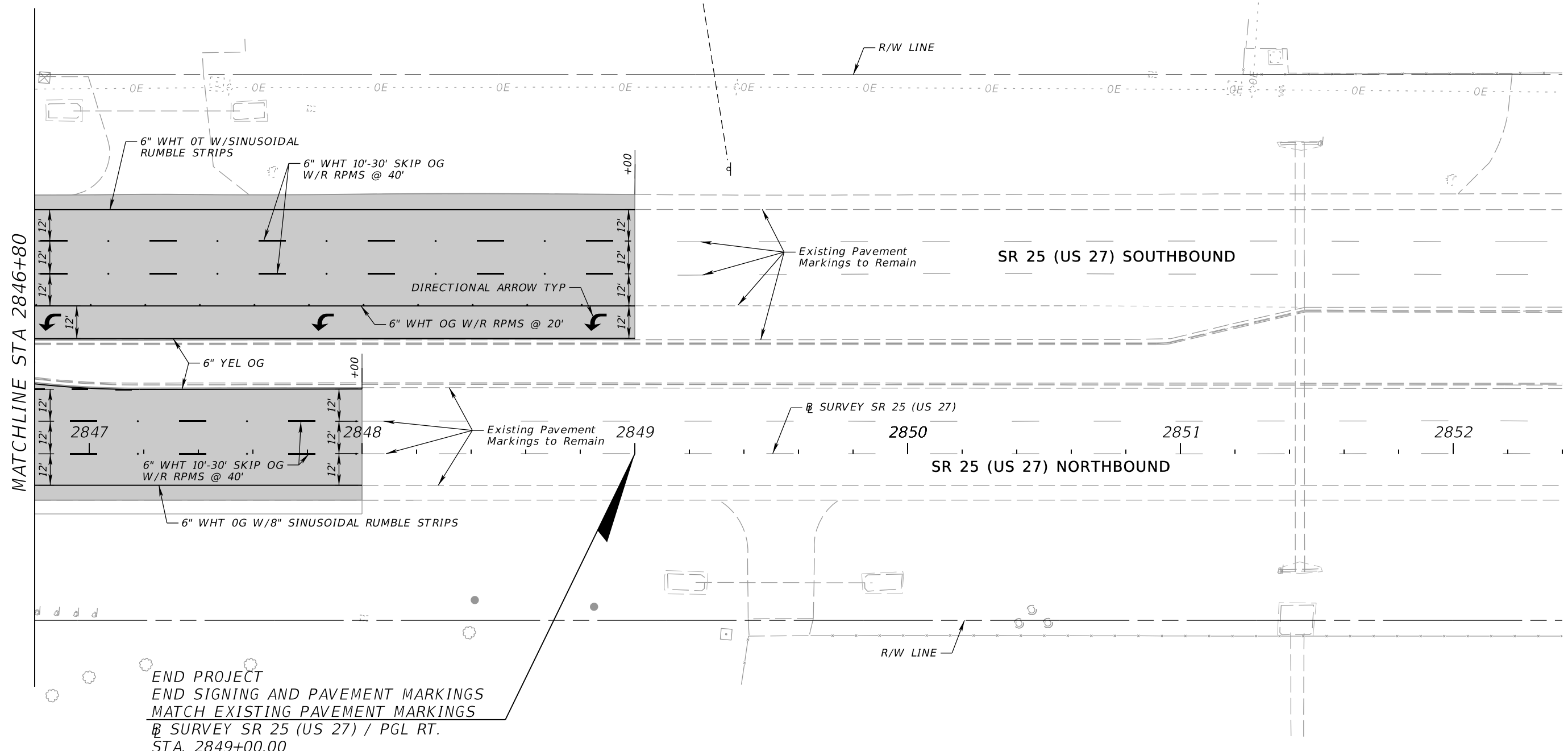
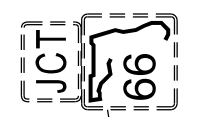

MATCHLINE STA 2846+80

LEGEND

MILLING AND RESURFACING

4/24/2026 3:55:28 PM USER: kyle.southwell
c:\pw\workdir\patel\greene-pw-01\pw_user\dms02462\PLAN\SP01.dgn

REVISIONS				ENGINEER OF RECORD			STATE OF FLORIDA DEPARTMENT OF TRANSPORTATION			SHEET NO. S-9
DATE	DESCRIPTION	DATE	DESCRIPTION	GERALDO J. SANCHEZ, P.E. LICENSE NUMBER 74538 PATEL, GREENE & ASSOCIATES, LLC 200 E ROBINSON ST., SUITE 300 ORLANDO, FL 32801			ROAD NO.	COUNTY	FINANCIAL PROJECT ID	
				SR 25	HIGHLANDS	439750-2-52-01	SIGNING AND PAVEMENT MARKING PLAN (7)			

THE OFFICIAL RECORD OF THIS SHEET IS THE ELECTRONIC FILE DIGITALLY SIGNED AND SEALED UNDER RULE 61G15-23.004, F.A.C.

BEGIN SIGNING AND PAVEMENT MARKINGS
MATCH EXISTING PAVEMENT MARKINGS
SURVEY SR 66 (US 98)
STA. 497+23.00

RELOCATE PANEL
FROM EXISTING
ROUTE MARKER
0700 3 507 1 EA



M3-4
24"x12"
FTP-17-06
24"x24"
0700 1600 1 EA
0700 1111 1 EA
STA. 500+70

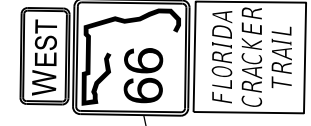

BEGIN PAVEMENT MARKINGS
FOR CONCRETE PAVEMENT

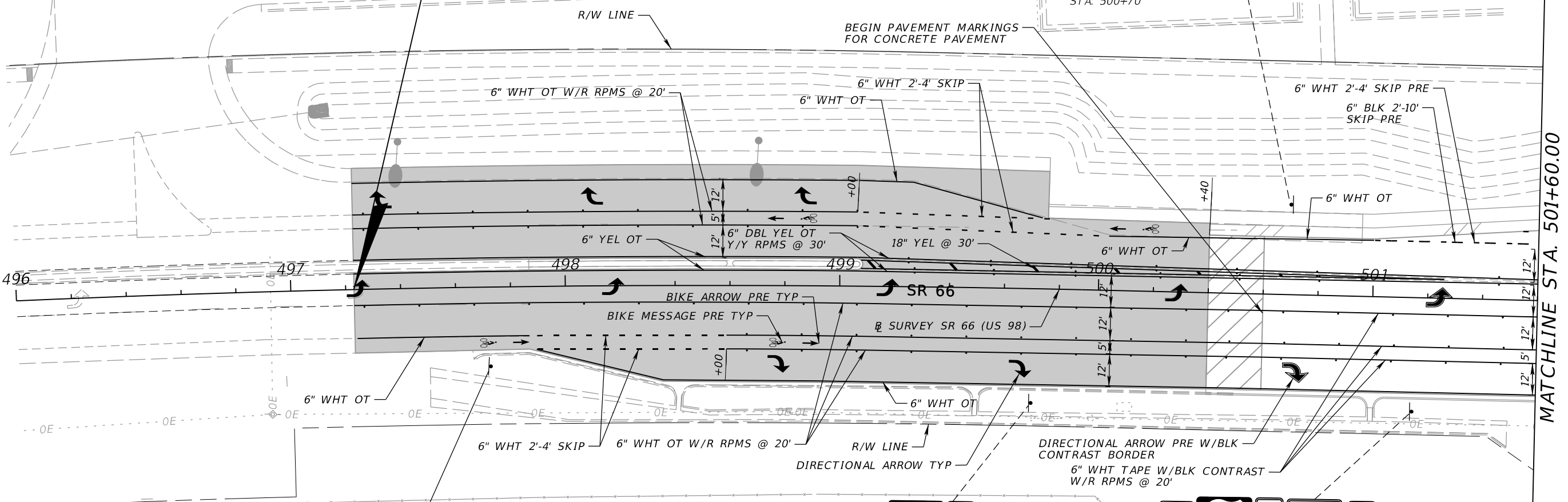

R4-4
36"x30"
0700 1111 1 EA
STA. 497+72

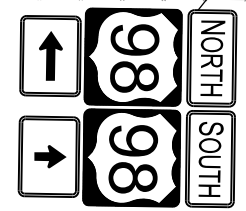

M3-1
24"x12"
M1-4
24"x24"
M6-1P
21"x15"
0700 1600 1 EA
0700 1112 1 EA
STA. 499+70

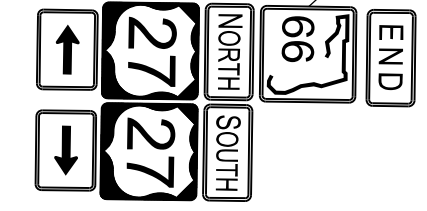

M4-6
24"x12"
FTP-17-06
24"x24"
M3-1
24"x12"
M1-4
24"x24"
M6-1P
21"x15"
0700 1600 1 EA
0700 1113 1 EA
STA. 501+15

MATCHLINE STA. 501+60.00

4/24/2026 3:55:46 PM USER: kyle.southwell c:\pw\work\kair\patel\greene-pw-01\pw_user\dms02462\PLANS\p02.dgn

THE OFFICIAL RECORD OF THIS SHEET IS THE ELECTRONIC FILE DIGITALLY SIGNED AND SEALED UNDER RULE 61G15-23.004, F.A.C.

REVISIONS		ENGINEER OF RECORD		STATE OF FLORIDA DEPARTMENT OF TRANSPORTATION			SIGNING AND PAVEMENT MARKING PLAN (8)	SHEET NO. S-10
DATE	DESCRIPTION	DATE	DESCRIPTION	ROAD NO.	COUNTY	FINANCIAL PROJECT ID		
				SR 25	HIGHLANDS	439750-2-52-01		

GERALDO J. SANCHEZ, P.E.
LICENSE NUMBER 74538
PATEL, GREENE & ASSOCIATES, LLC
200 E ROBINSON ST., SUITE 300
ORLANDO, FL 32801

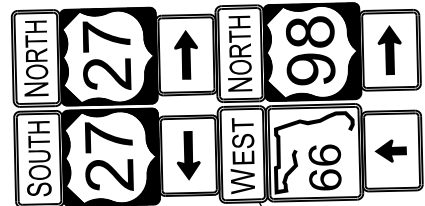

- M3-3 24"x12"
- M1-4 24"x24"
- M6-1P 21"x15"
- M3-4 24"x12"
- FTP-17-06 24"x24"
- M6-3P 21"x15"
- M3-1 24"x12"
- M1-4 24"x24"
- M6-1P 21"x15"
- M3-1 24"x12"
- M1-4 24"x24"
- M6-1P 21"x15"

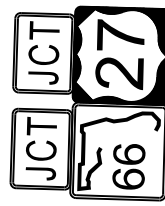

- M2-1 21"x15"
- FTP-17-06 24"x24"
- M2-1 21"x15"
- M1-4 24"x24"
- 0700 1600 1 EA
- 0700 1112 1 EA
- STA. 60+17



MATCHLINE STA. 55+20.00

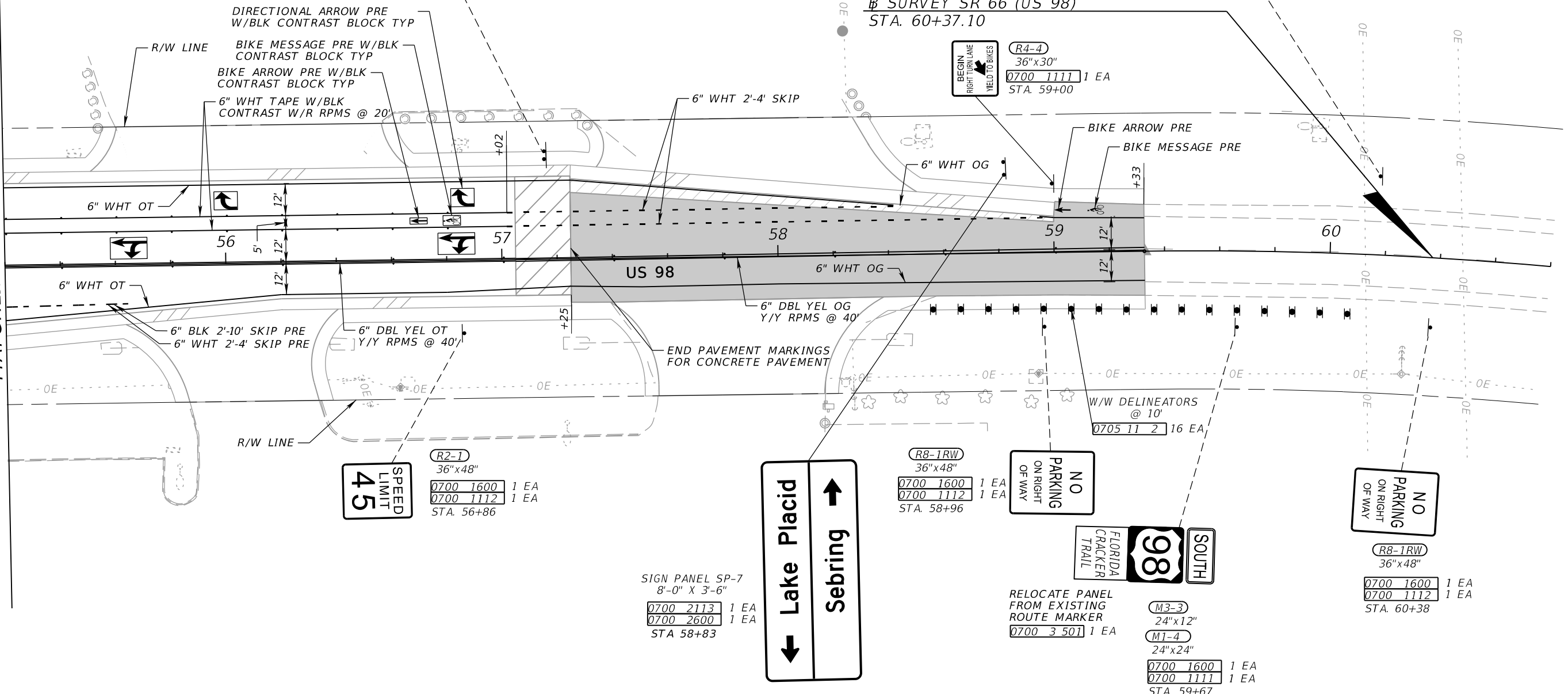

- R2-1 36"x48"
- 0700 1600 1 EA
- 0700 1112 1 EA
- STA. 56+86

- SIGN PANEL SP-7 8'-0" X 3'-6"
- 0700 2113 1 EA
- 0700 2600 1 EA
- STA. 58+83

- R8-1RW 36"x48"
- 0700 1600 1 EA
- 0700 1112 1 EA
- STA. 58+96

- M3-3 24"x12"
- M1-4 24"x24"
- 0700 1600 1 EA
- 0700 1111 1 EA
- STA. 59+67

- R8-1RW 36"x48"
- 0700 1600 1 EA
- 0700 1112 1 EA
- STA. 60+38

4/24/2026 3:55:46 PM USER: kyle.southwell c:\pw\workdir\patel\greene-pw-01\pw_user\dms02462\PLAN\SP02.dgn

THE OFFICIAL RECORD OF THIS SHEET IS THE ELECTRONIC FILE DIGITALLY SIGNED AND SEALED UNDER RULE 61G15-23.004, F.A.C.

REVISIONS		ENGINEER OF RECORD		STATE OF FLORIDA DEPARTMENT OF TRANSPORTATION			SIGNING AND PAVEMENT MARKING PLAN (9)	SHEET NO. S-11
DATE	DESCRIPTION	DATE	DESCRIPTION	ROAD NO.	COUNTY	FINANCIAL PROJECT ID		
				SR 25	HIGHLANDS	439750-2-52-01		

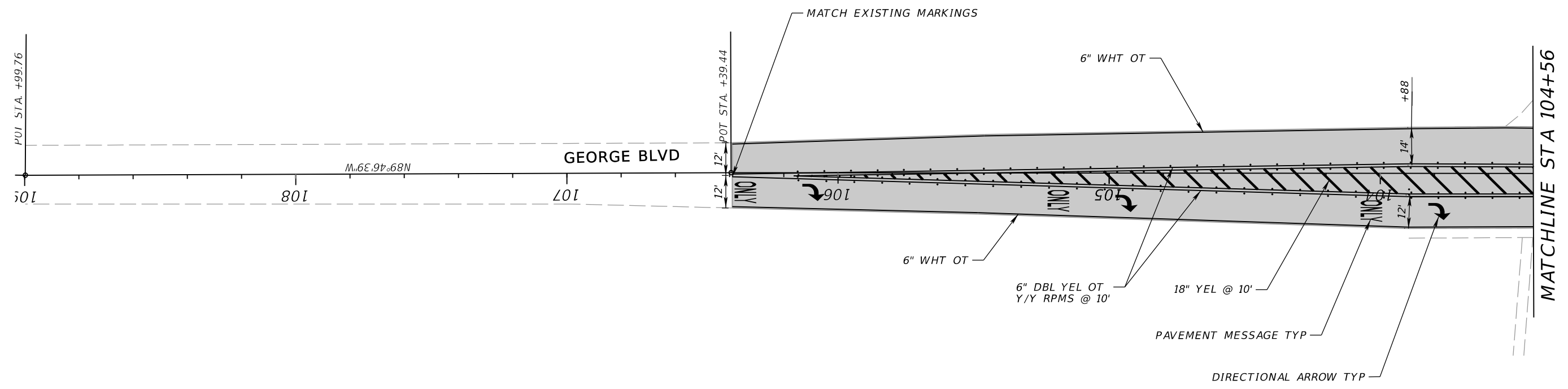

4/24/2026 3:56:01 PM USER: kyle.southwell
 c:\pw\workdir\patel\greene-pw-01\pw_user\dms02462\PLANSP03.dgn

THE OFFICIAL RECORD OF THIS SHEET IS THE ELECTRONIC FILE DIGITALLY SIGNED AND SEALED UNDER RULE 61G15-23.004, F.A.C.

REVISIONS				ENGINEER OF RECORD			STATE OF FLORIDA DEPARTMENT OF TRANSPORTATION			SIGNING AND PAVEMENT MARKING PLAN (10)	SHEET NO.
DATE	DESCRIPTION	DATE	DESCRIPTION	GERALDO J. SANCHEZ, P.E. LICENSE NUMBER 74538 PATEL, GREENE & ASSOCIATES, LLC 200 E ROBINSON ST., SUITE 300 ORLANDO, FL 32801			ROAD NO.	COUNTY	FINANCIAL PROJECT ID		S-12
				SR 25	HIGHLANDS	439750-2-52-01					

4/24/2026 3:56:02 PM USER: kyle.southwell
 c:\pw\work\kair\patel\greene-pw-01\pw_user\dms02462\PLAN\SP03.dgn

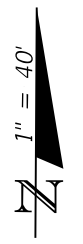
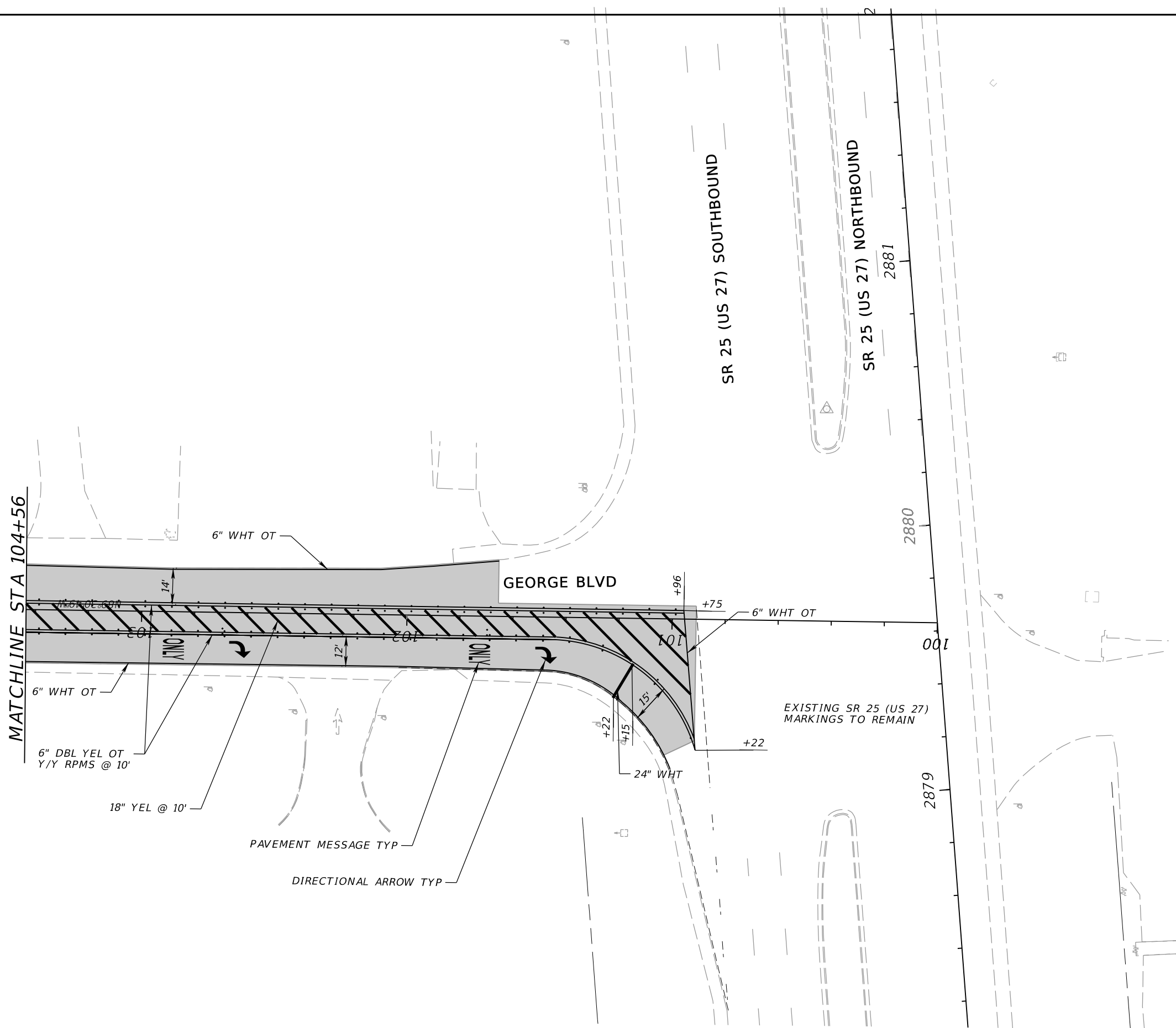

REVISIONS				ENGINEER OF RECORD		STATE OF FLORIDA DEPARTMENT OF TRANSPORTATION			SHEET NO.
DATE	DESCRIPTION	DATE	DESCRIPTION	GERALDO J. SANCHEZ, P.E. LICENSE NUMBER 74538 PATEL, GREENE & ASSOCIATES, LLC 200 E ROBINSON ST., SUITE 300 ORLANDO, FL 32801		ROAD NO.	COUNTY	FINANCIAL PROJECT ID	
						SR 25	HIGHLANDS	439750-2-52-01	S-13
						SIGNING AND PAVEMENT MARKING PLAN (11)			

THE OFFICIAL RECORD OF THIS SHEET IS THE ELECTRONIC FILE DIGITALLY SIGNED AND SEALED UNDER RULE 61G15-23.004, F.A.C.

