

NOTES  
1. LIMITS OF CONSTRUCTION ARE LIMITED TO THE PAVEMENT ONLY.

- LEGEND
- SEDIMENT BARRIER
  - PROJECT DISCHARGE LOCATIONS

REVISIONS				ENGINEER OF RECORD	STATE OF FLORIDA DEPARTMENT OF TRANSPORTATION			STORMWATER RUNOFF CONTROL CONCEPT WORKSHEET	SHEET NO.
DATE	DESCRIPTION	DATE	DESCRIPTION	JAMES M. WINTER, JR., P.E. LICENSE NUMBER: 55514 SCALAR CONSULTING GROUP, LLC 12620 TELECOM DRIVE TEMPLE TERRACE, FLORIDA 33637	ROAD NO.	COUNTY	FINANCIAL PROJECT ID		2
					SR 93	LEE	452793-1-52-01		

THE OFFICIAL RECORD OF THIS SHEET IS THE ELECTRONIC FILE DIGITALLY SIGNED AND SEALED UNDER RULE 61G15-23.004, F.A.C.

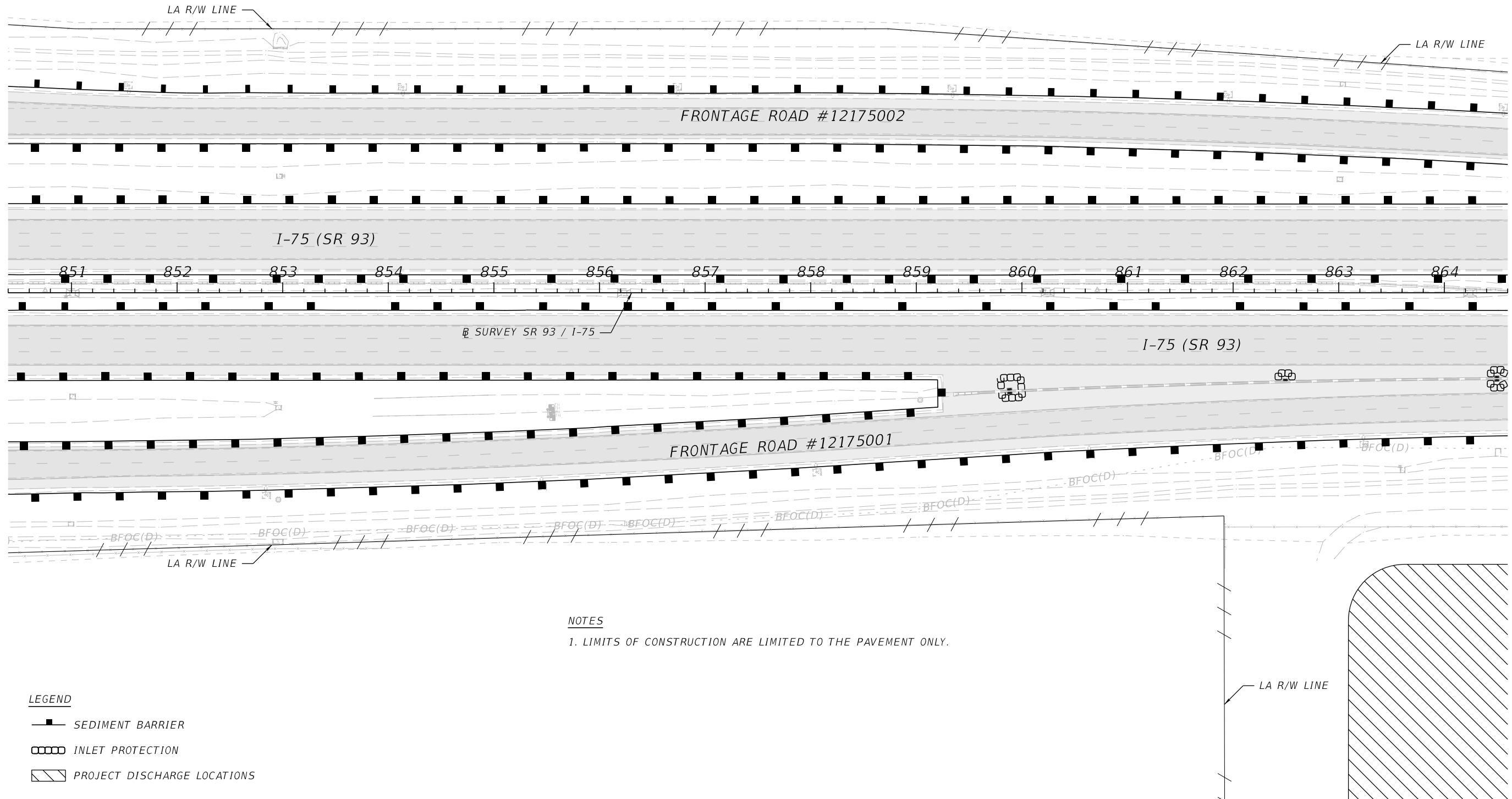

NOTES  
1. LIMITS OF CONSTRUCTION ARE LIMITED TO THE PAVEMENT ONLY.

- LEGEND
- SEDIMENT BARRIER
  - INLET PROTECTION
  - PROJECT DISCHARGE LOCATIONS

REVISIONS				ENGINEER OF RECORD			STATE OF FLORIDA DEPARTMENT OF TRANSPORTATION			STORMWATER RUNOFF CONTROL CONCEPT WORKSHEET		SHEET NO.
DATE	DESCRIPTION	DATE	DESCRIPTION	JAMES M. WINTER, JR., P.E. LICENSE NUMBER: 55514 SCALAR CONSULTING GROUP, LLC 12620 TELECOM DRIVE TEMPLE TERRACE, FLORIDA 33637			ROAD NO.	COUNTY	FINANCIAL PROJECT ID			
							SR 93	LEE	452793-1-52-01			3

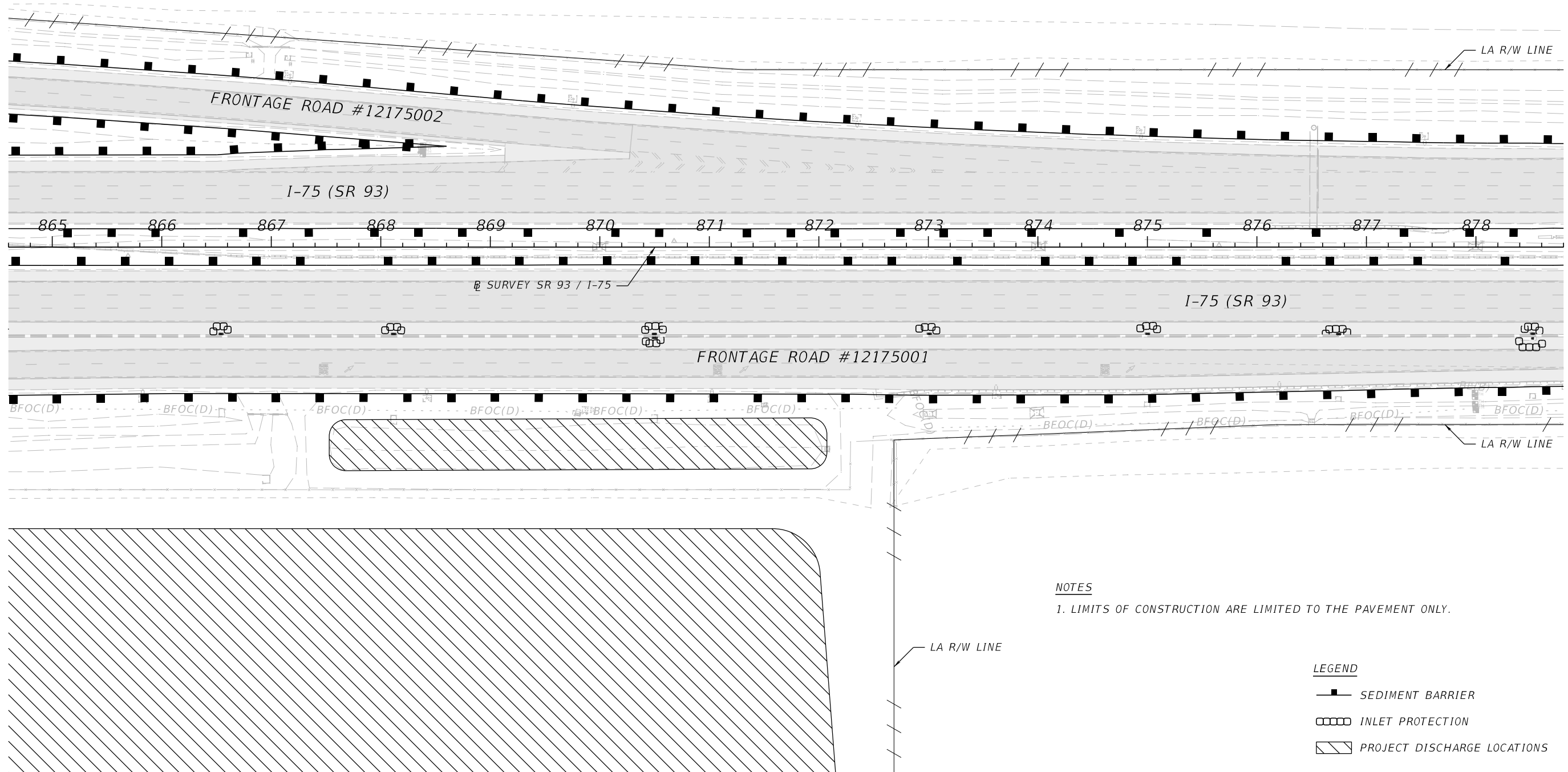

REVISIONS				ENGINEER OF RECORD		STATE OF FLORIDA DEPARTMENT OF TRANSPORTATION		STORMWATER RUNOFF CONTROL CONCEPT WORKSHEET	SHEET NO.  4
DATE	DESCRIPTION	DATE	DESCRIPTION	JAMES M. WINTER, JR., P.E. LICENSE NUMBER: 55514 SCALAR CONSULTING GROUP, LLC 12620 TELECOM DRIVE TEMPLE TERRACE, FLORIDA 33637		ROAD NO.	COUNTY		
						SR 93	LEE	FINANCIAL PROJECT ID 452793-1-52-01	

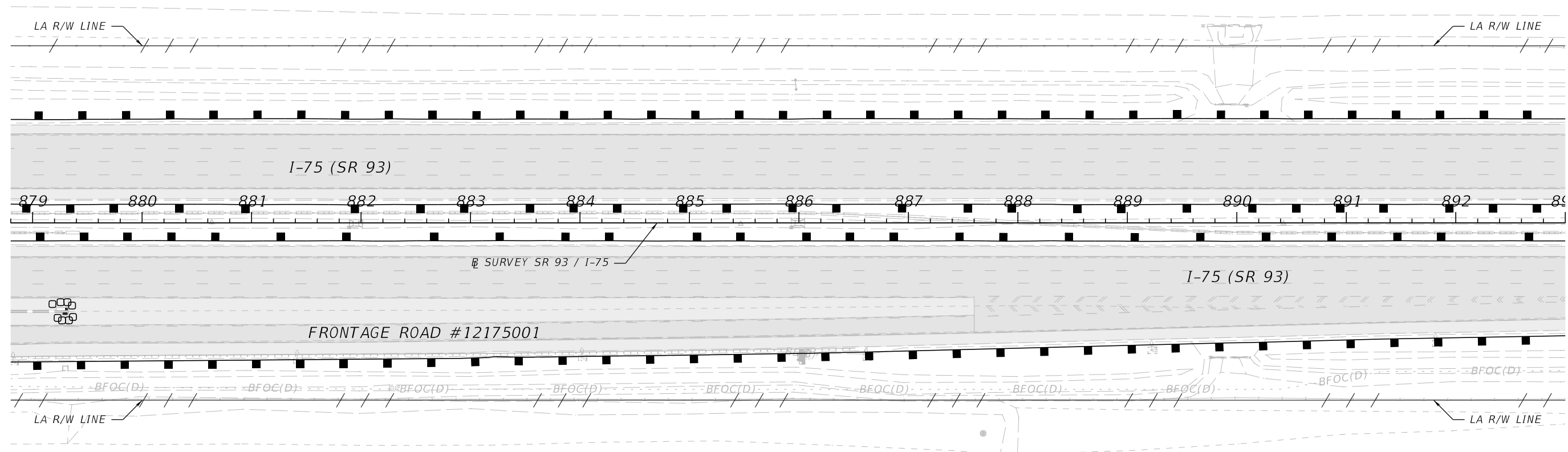

NOTES

1. LIMITS OF CONSTRUCTION ARE LIMITED TO THE PAVEMENT ONLY.

LEGEND

 SEDIMENT BARRIER

□□□□ INLET PROTECTION

REVISIONS				ENGINEER OF RECORD	STATE OF FLORIDA DEPARTMENT OF TRANSPORTATION			STORMWATER RUNOFF CONTROL CONCEPT WORKSHEET	SHEET NO.
DATE	DESCRIPTION	DATE	DESCRIPTION	JAMES M. WINTER, JR., P.E. LICENSE NUMBER: 55514 SCALAR CONSULTING GROUP, LLC 12620 TELECOM DRIVE TEMPLE TERRACE, FLORIDA 33637	ROAD NO.	COUNTY	FINANCIAL PROJECT ID		5
					SR 93	LEE	452793-1-52-01		

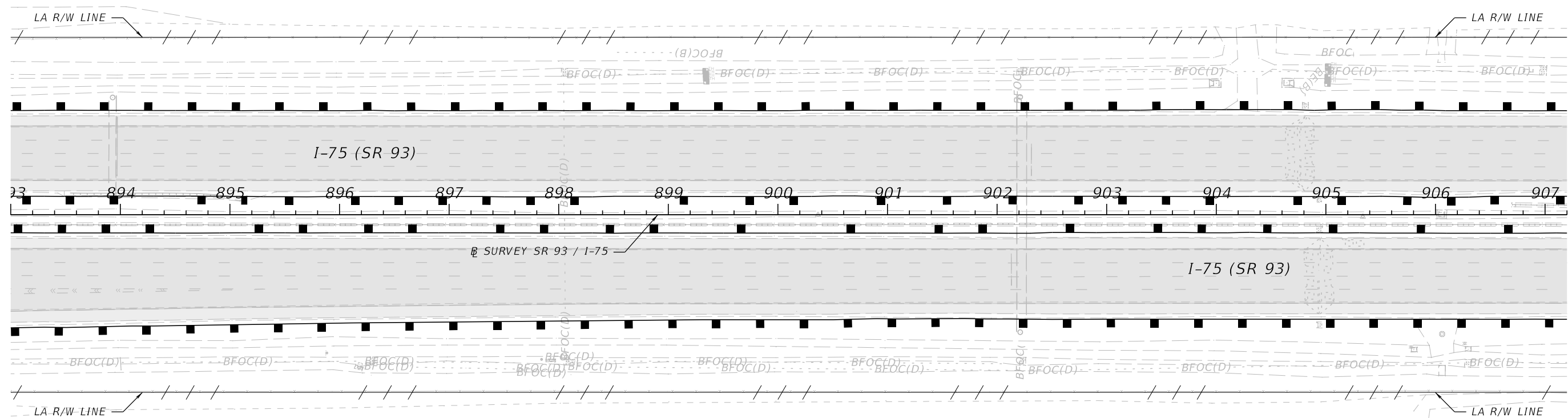

NOTES

1. LIMITS OF CONSTRUCTION ARE LIMITED TO THE PAVEMENT ONLY.

LEGEND

—■— SEDIMENT BARRIER

REVISIONS				ENGINEER OF RECORD	STATE OF FLORIDA DEPARTMENT OF TRANSPORTATION			<i>STORMWATER RUNOFF CONTROL CONCEPT WORKSHEET</i>	SHEET NO.
DATE	DESCRIPTION	DATE	DESCRIPTION	JAMES M. WINTER, JR., P.E. LICENSE NUMBER: 55514 SCALAR CONSULTING GROUP, LLC 12620 TELECOM DRIVE TEMPLE TERRACE, FLORIDA 33637	ROAD NO.	COUNTY	FINANCIAL PROJECT ID		6
					SR 93	LEE	452793-1-52-01		

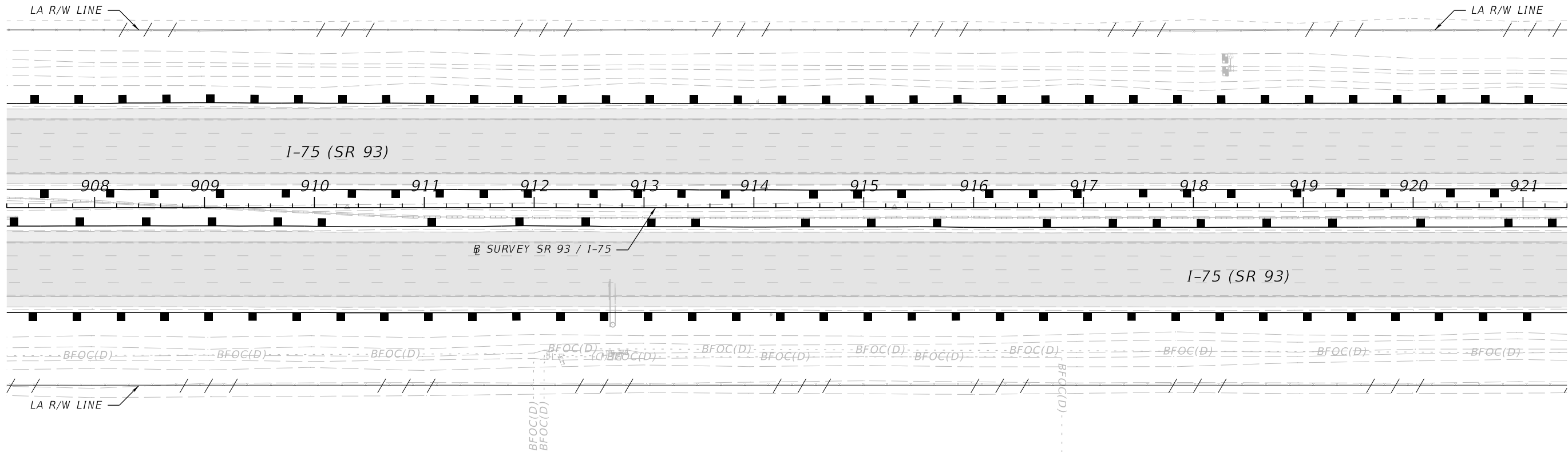

NOTES  
1. LIMITS OF CONSTRUCTION ARE LIMITED TO THE PAVEMENT ONLY.

LEGEND  
—■— SEDIMENT BARRIER

REVISIONS				ENGINEER OF RECORD	STATE OF FLORIDA DEPARTMENT OF TRANSPORTATION			STORMWATER RUNOFF CONTROL CONCEPT WORKSHEET	SHEET NO.
DATE	DESCRIPTION	DATE	DESCRIPTION	JAMES M. WINTER, JR., P.E. LICENSE NUMBER: 55514 SCALAR CONSULTING GROUP, LLC 12620 TELECOM DRIVE TEMPLE TERRACE, FLORIDA 33637	ROAD NO.	COUNTY	FINANCIAL PROJECT ID		7
					SR 93	LEE	452793-1-52-01		

THE OFFICIAL RECORD OF THIS SHEET IS THE ELECTRONIC FILE DIGITALLY SIGNED AND SEALED UNDER RULE 61G15-23.004, F.A.C.

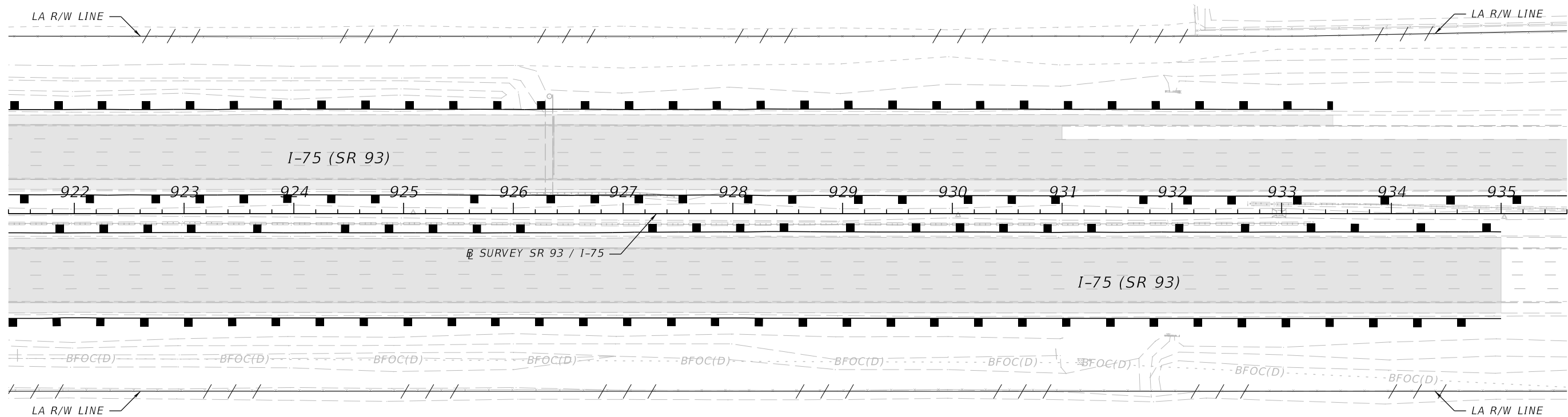

**NOTES**  
1. LIMITS OF CONSTRUCTION ARE LIMITED TO THE PAVEMENT ONLY.

**LEGEND**

—■— SEDIMENT BARRIER

REVISIONS				ENGINEER OF RECORD	STATE OF FLORIDA DEPARTMENT OF TRANSPORTATION			STORMWATER RUNOFF CONTROL CONCEPT WORKSHEET	SHEET NO.
DATE	DESCRIPTION	DATE	DESCRIPTION	JAMES M. WINTER, JR., P.E. LICENSE NUMBER: 55514 SCALAR CONSULTING GROUP, LLC 12620 TELECOM DRIVE TEMPLE TERRACE, FLORIDA 33637	ROAD NO.	COUNTY	FINANCIAL PROJECT ID		8
					SR 93	LEE	452793-1-52-01		

THE OFFICIAL RECORD OF THIS SHEET IS THE ELECTRONIC FILE DIGITALLY SIGNED AND SEALED UNDER RULE 61G15-23.004, F.A.C.



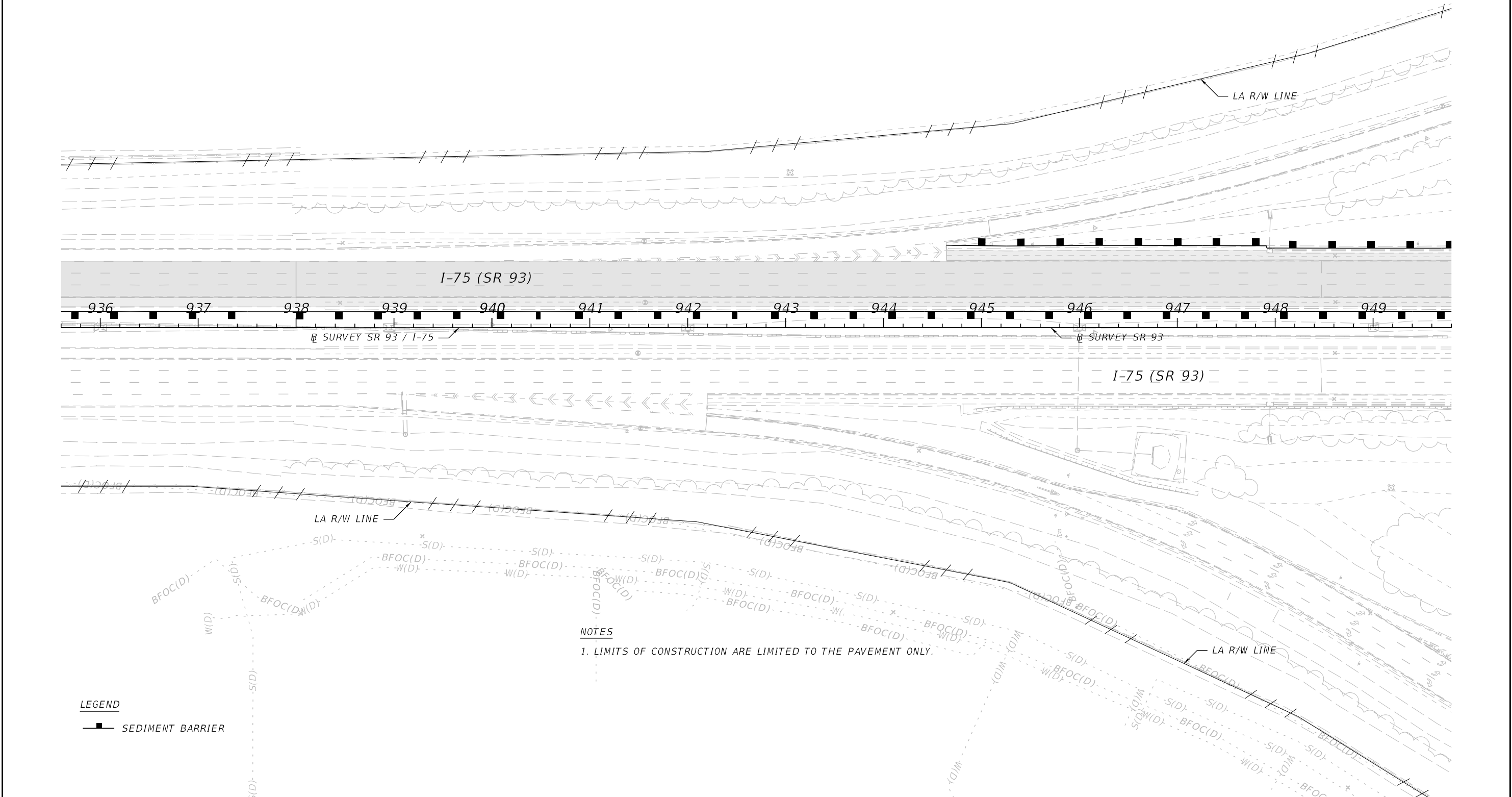

REVISIONS				ENGINEER OF RECORD	STATE OF FLORIDA DEPARTMENT OF TRANSPORTATION			STORMWATER RUNOFF CONTROL CONCEPT WORKSHEET	SHEET NO.
DATE	DESCRIPTION	DATE	DESCRIPTION	JAMES M. WINTER, JR., P.E. LICENSE NUMBER: 55514 SCALAR CONSULTING GROUP, LLC 12620 TELECOM DRIVE TEMPLE TERRACE, FLORIDA 33637	ROAD NO.	COUNTY	FINANCIAL PROJECT ID		9
					SR 93	LEE	452793-1-52-01		

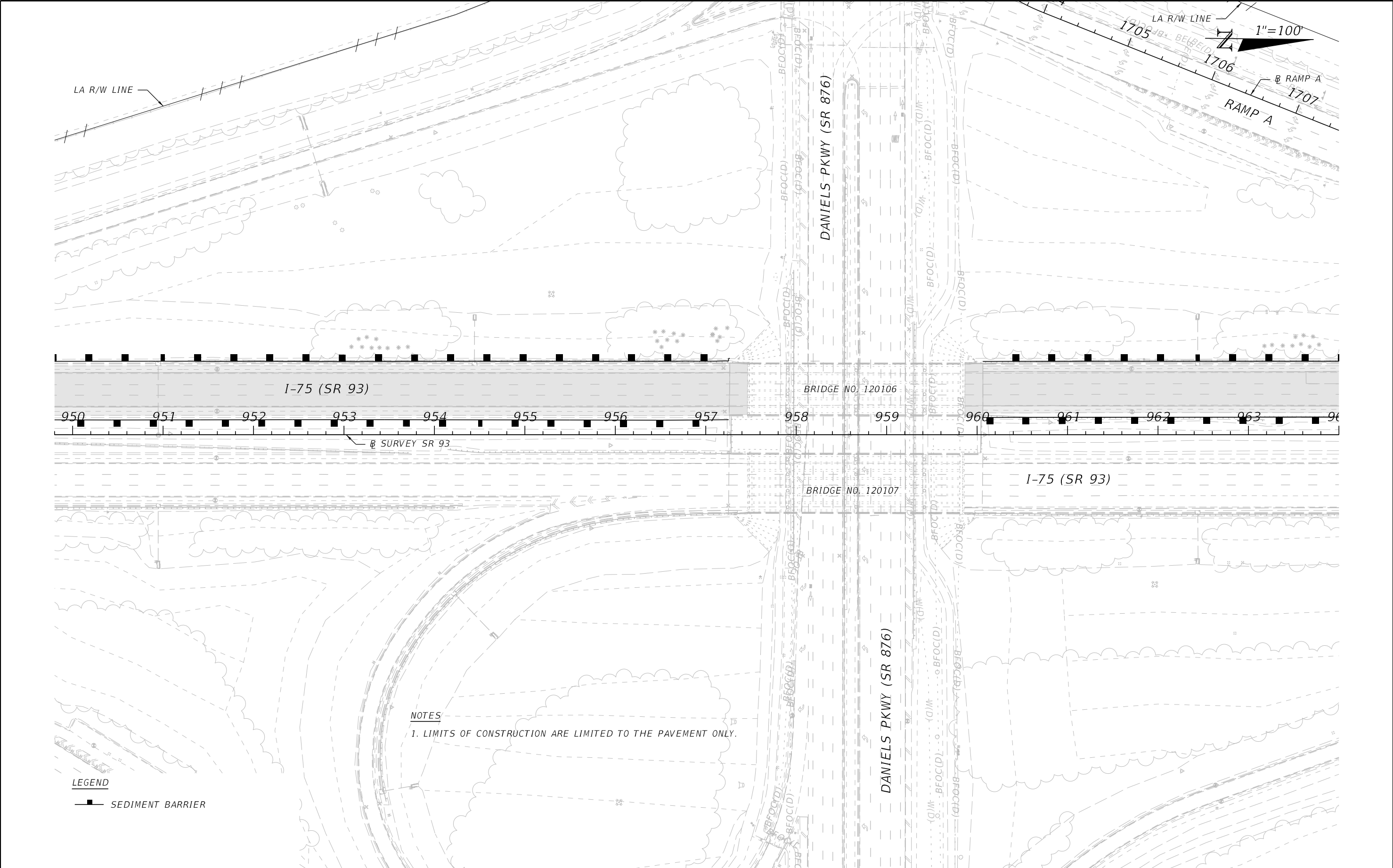

REVISIONS				ENGINEER OF RECORD		STATE OF FLORIDA DEPARTMENT OF TRANSPORTATION			STORMWATER RUNOFF CONTROL CONCEPT WORKSHEET	SHEET NO.  10
DATE	DESCRIPTION	DATE	DESCRIPTION	JAMES M. WINTER, JR., P.E. LICENSE NUMBER: 55514 SCALAR CONSULTING GROUP, LLC 12620 TELECOM DRIVE TEMPLE TERRACE, FLORIDA 33637		ROAD NO.	COUNTY	FINANCIAL PROJECT ID		
						SR 93	LEE	452793-1-52-01		

THE OFFICIAL RECORD OF THIS SHEET IS THE ELECTRONIC FILE DIGITALLY SIGNED AND SEALED UNDER RULE 61G15-23.004, F.A.C.

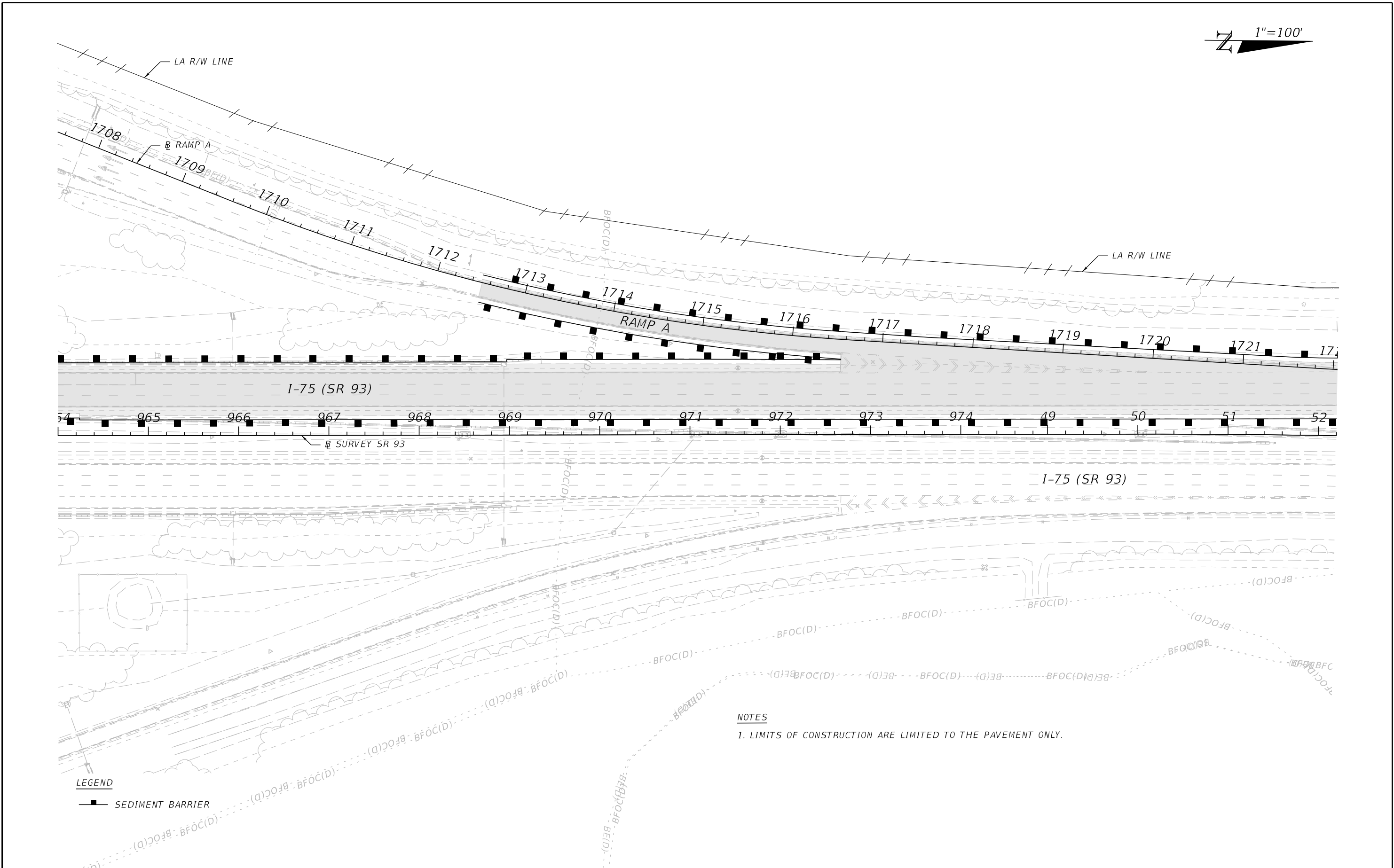

NOTES  
1. LIMITS OF CONSTRUCTION ARE LIMITED TO THE PAVEMENT ONLY.

REVISIONS				ENGINEER OF RECORD	STATE OF FLORIDA DEPARTMENT OF TRANSPORTATION			STORMWATER RUNOFF CONTROL CONCEPT WORKSHEET	SHEET NO.
DATE	DESCRIPTION	DATE	DESCRIPTION	JAMES M. WINTER, JR., P.E. LICENSE NUMBER: 55514 SCALAR CONSULTING GROUP, LLC 12620 TELECOM DRIVE TEMPLE TERRACE, FLORIDA 33637	ROAD NO.	COUNTY	FINANCIAL PROJECT ID		11
					SR 93	LEE	452793-1-52-01		

JAMES M. WINTER, JR., P.E.  
LICENSE NUMBER: 55514  
SCALAR CONSULTING GROUP, LLC  
12620 TELECOM DRIVE  
TEMPLE TERRACE, FLORIDA 33637

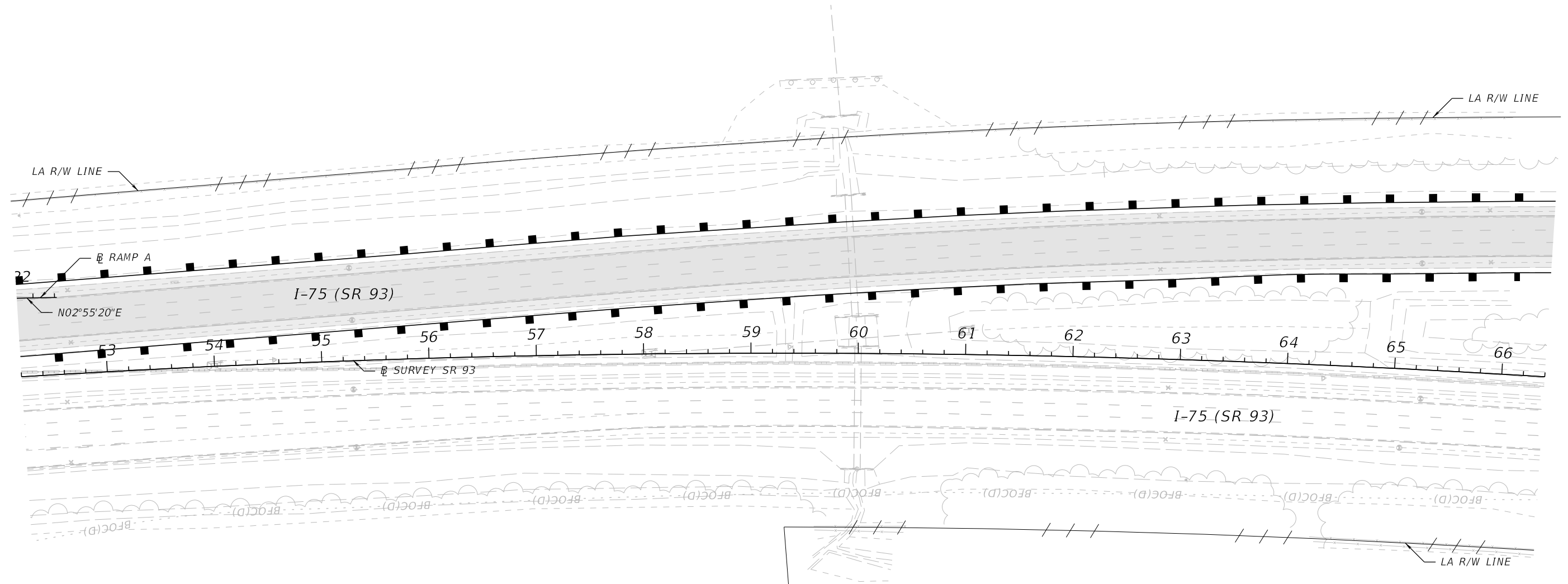

NOTES

1. LIMITS OF CONSTRUCTION ARE LIMITED TO THE PAVEMENT ONLY.

LEGEND

—■— SEDIMENT BARRIER

REVISIONS				ENGINEER OF RECORD  JAMES M. WINTER, JR., P.E. LICENSE NUMBER: 55514 SCALAR CONSULTING GROUP, LLC 12620 TELECOM DRIVE TEMPLE TERRACE, FLORIDA 33637	STATE OF FLORIDA DEPARTMENT OF TRANSPORTATION			STORMWATER RUNOFF CONTROL CONCEPT WORKSHEET	SHEET NO.
DATE	DESCRIPTION	DATE	DESCRIPTION		ROAD NO.	COUNTY	FINANCIAL PROJECT ID		12
					SR 93	LEE	452793-1-52-01		

JAMES M. WINTER, JR., P.E.  
LICENSE NUMBER: 55514  
SCALAR CONSULTING GROUP, LLC  
12620 TELECOM DRIVE  
TEMPLE TERRACE, FLORIDA 33637

1"=100'

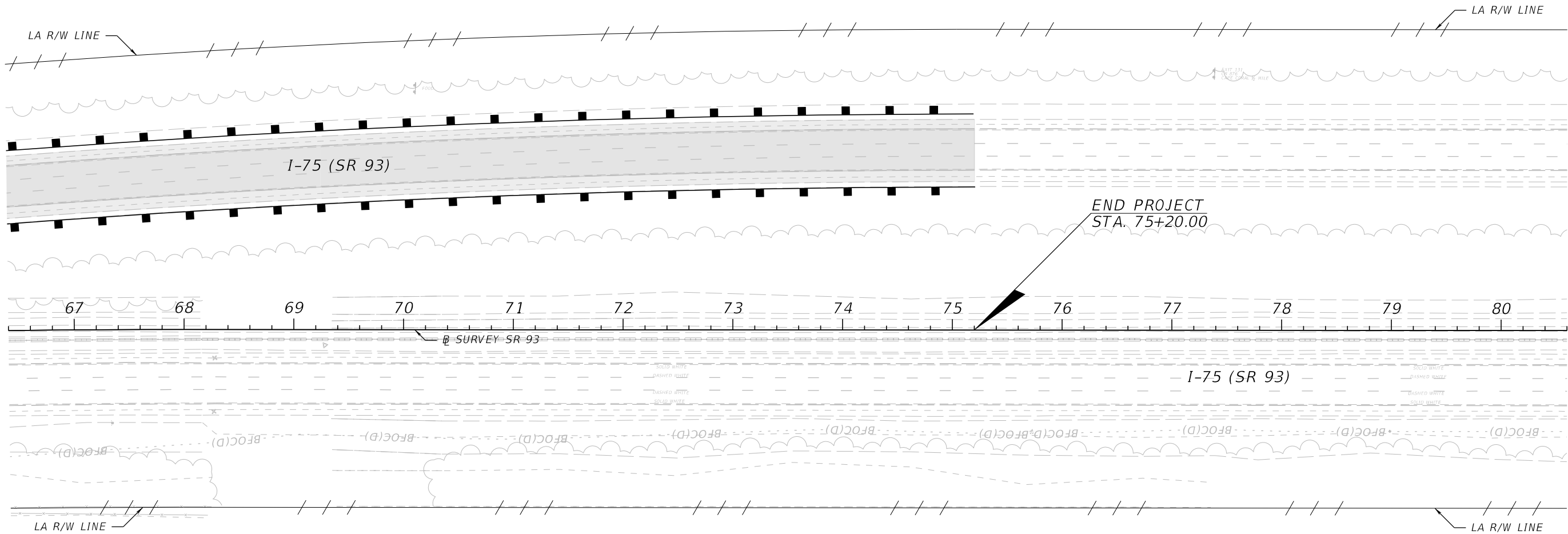

NOTES

1. LIMITS OF CONSTRUCTION ARE LIMITED TO THE PAVEMENT ONLY.

LEGEND

—■— SEDIMENT BARRIER

REVISIONS				ENGINEER OF RECORD		STATE OF FLORIDA DEPARTMENT OF TRANSPORTATION			STORMWATER RUNOFF CONTROL CONCEPT WORKSHEET	SHEET NO.  13
DATE	DESCRIPTION	DATE	DESCRIPTION	JAMES M. WINTER, JR., P.E. LICENSE NUMBER: 55514 SCALAR CONSULTING GROUP, LLC 12620 TELECOM DRIVE TEMPLE TERRACE, FLORIDA 33637		ROAD NO.	COUNTY	FINANCIAL PROJECT ID		
						SR 93	LEE	452793-1-52-01		

THE OFFICIAL RECORD OF THIS SHEET IS THE ELECTRONIC FILE DIGITALLY SIGNED AND SEALED UNDER RULE 61G15-23.004, F.A.C.