

**CONTRACT PLANS COMPONENTS**

ROADWAY PLANS  
SIGNING AND PAVEMENT MARKING PLANS  
SIGNALIZATION PLANS  
LIGHTING PLANS

A DETAILED INDEX APPEARS ON THE  
KEY SHEET OF EACH COMPONENT

**INDEX OF SIGNING AND  
PAVEMENT MARKING PLANS**

SHEET NO.	SHEET DESCRIPTION
S-1	KEY SHEET
S-2	GENERAL NOTES
S-3	SIGNING AND PAVEMENT MARKING PLAN

*STATE OF FLORIDA*  
**DEPARTMENT OF TRANSPORTATION**  
**SIGNING AND PAVEMENT MARKING PLANS**

**FINANCIAL PROJECT ID 449656-1-52-01**  
**(FEDERAL FUNDS)**  
**OKEECHOBEE COUNTY (91020)**  
**STATE ROAD NO. 15**  
**SR 15 (US 441) AT 28TH STREET SAFETY IMPROVEMENTS**

PROJECT LOCATION URL:	<a href="https://tinyurl.com/2s6jx3w6">https://tinyurl.com/2s6jx3w6</a>
PROJECT LIMITS:	BEGIN MP 1.369 - END MP 1.373
EXCEPTIONS:	NONE
BRIDGE LIMITS:	NONE
RAILROAD CROSSING:	NONE

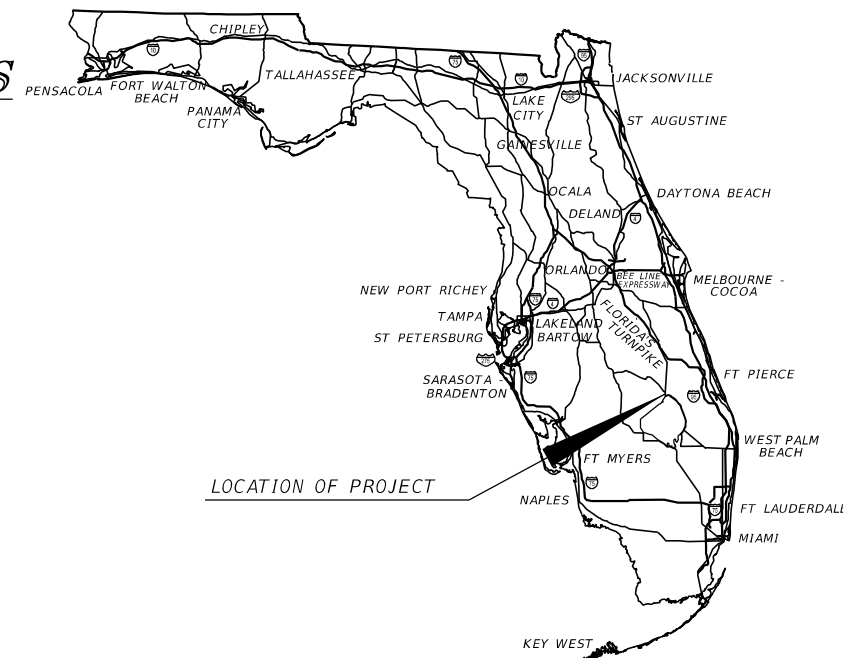

THIS ITEM HAS BEEN DIGITALLY  
SIGNED AND SEALED BY

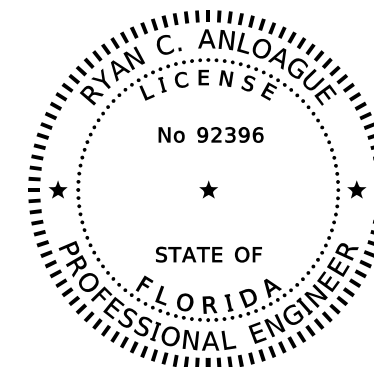

ON THE DATE ADJACENT TO THE SEAL

PRINTED COPIES OF THIS DOCUMENT ARE  
NOT CONSIDERED SIGNED AND SEALED  
AND THE SIGNATURE MUST BE VERIFIED  
ON ANY ELECTRONIC COPIES.

**SIGNING AND  
PAVEMENT MARKING PLANS  
ENGINEER OF RECORD:**

RYAN C. ANLOAGUE, P.E.  
P.E. LICENSE NUMBER 92396  
FLORIDA TRANSPORTATION ENGINEERING, INC.  
11458 N 53RD STREET  
TAMPA, FLORIDA, 33617.  
(813) 989-0729, EXT. 113.  
CONTRACT NO.: CA148  
VENDOR NO.: F65-0183924

**FDOT PROJECT MANAGER:**

JEFFREY MEDNICK

**GOVERNING STANDARD PLANS:**

Florida Department of Transportation, FY2023-24 Standard Plans for Road and Bridge Construction and applicable Interim Revisions (IRs).

Standard Plans for Road Construction and associated IRs are available at the following website: <http://www.fdot.gov/design/standardplans>

**GOVERNING STANDARD SPECIFICATIONS:**

Florida Department of Transportation, FY2023-24 Standard Specifications for Road and Bridge Construction at the following website: <http://www.fdot.gov/programmanagement/Implemented/SpecBooks>

**PHASE IIR SUBMITTAL  
DECEMBER 2023**

CONSTRUCTION CONTRACT NO.	FISCAL YEAR	SHEET NO.
	25	S-1

GENERAL NOTES

1. PROPOSED DESIGN ELEMENTS AND LABELS ARE REFERENCING  $\mathcal{B}$  SURVEY SR 15.

12/16/2023 11:48:46 AM RyanAnloague  
 S:\Projects\FDOT\44965615201\SigningAndMarking\GWT\SP01.dgn

REVISIONS				ENGINEER OF RECORD	STATE OF FLORIDA DEPARTMENT OF TRANSPORTATION			GENERAL NOTES	SHEET NO.
DATE	DESCRIPTION	DATE	DESCRIPTION	RYAN C. ANLOAGUE, P.E. LICENSE NUMBER: 92396 FLORIDA TRANSPORTATION ENGINEERING, INC. 11458 NORTH 53RD STREET TAMPA, FLORIDA 33617	ROAD NO.	COUNTY	FINANCIAL PROJECT ID		S-2
						SR 15	OKEECHOBEE		

THE OFFICIAL RECORD OF THIS SHEET IS THE ELECTRONIC FILE DIGITALLY SIGNED AND SEALED UNDER RULE 61G15-23.004, F.A.C.

12/16/2023 11:48:55 AM RyanAnloague  
 S:\Projects\FDOT\44965615201\SigningAndMarking\PLANS\01.dgn

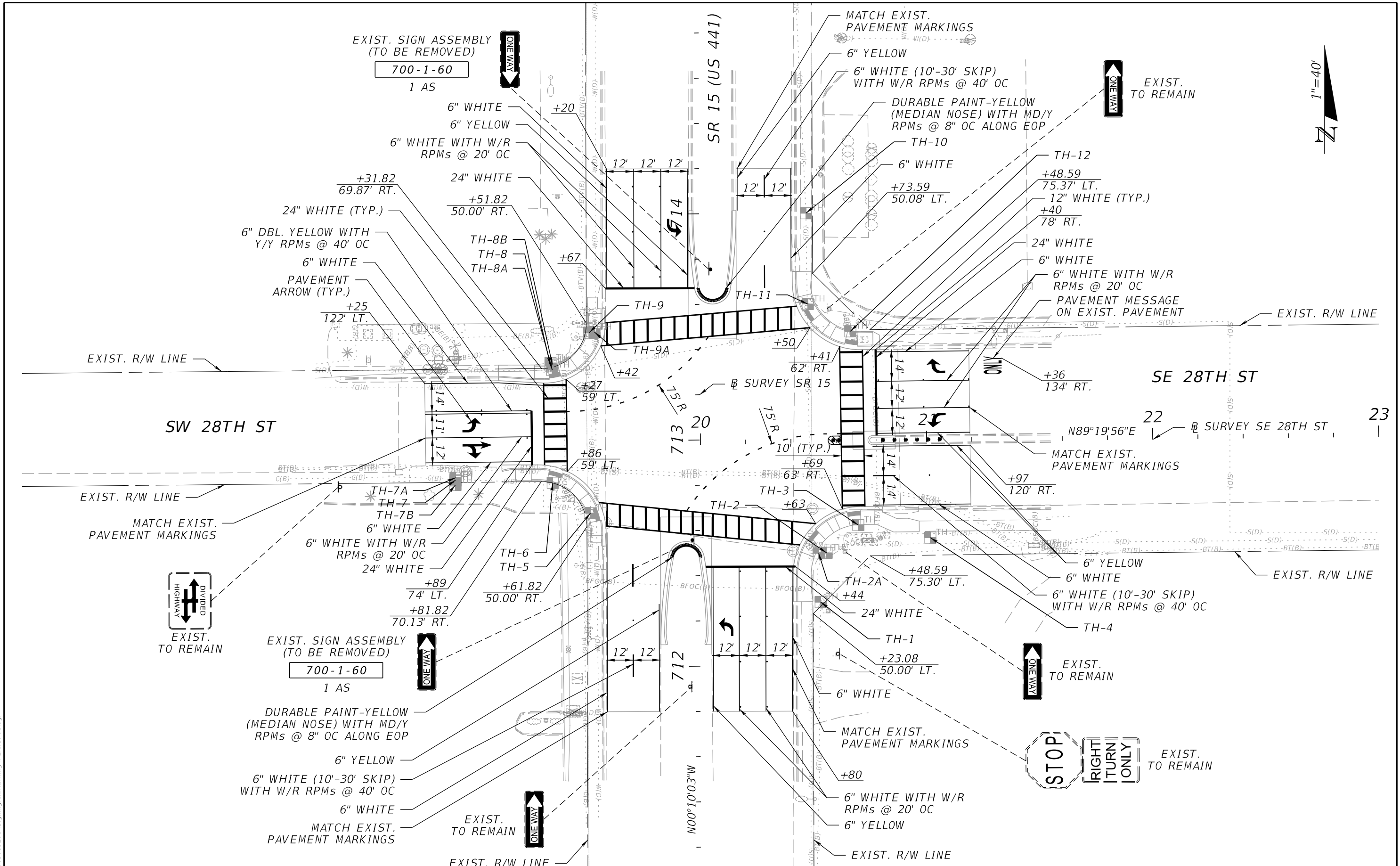

REVISIONS		ENGINEER OF RECORD		STATE OF FLORIDA DEPARTMENT OF TRANSPORTATION			SHEET NO.
DATE	DESCRIPTION	DATE	DESCRIPTION	ROAD NO.	COUNTY	FINANCIAL PROJECT ID	
				SR 15	OKEECHOBEE	449656-1-52-01	S-3

RYAN C. ANLOAGUE, P.E.  
 LICENSE NUMBER: 92396  
 FLORIDA TRANSPORTATION ENGINEERING, INC.  
 11458 NORTH 53RD STREET  
 TAMPA, FLORIDA 33617

**SIGNNG AND PAVEMENT  
 MARKING PLAN**

THE OFFICIAL RECORD OF THIS SHEET IS THE ELECTRONIC FILE DIGITALLY SIGNED AND SEALED UNDER RULE 61G15-23.004, F.A.C.