

CONTRACT PLANS COMPONENTS

- ROADWAY PLANS
- SIGNING AND PAVEMENT MARKING PLANS
- SIGNALIZATION PLANS
- LIGHTING PLANS

STATE OF FLORIDA
DEPARTMENT OF TRANSPORTATION

SIGNALIZATION PLANS

FINANCIAL PROJECT ID 447379-1-52-01
(FEDERAL FUNDS)
MANATEE COUNTY (13130)

STATE ROAD NO. 55 (S TAMiami TRAIL)
RRR FROM 23RD AVE W TO 39TH ST E

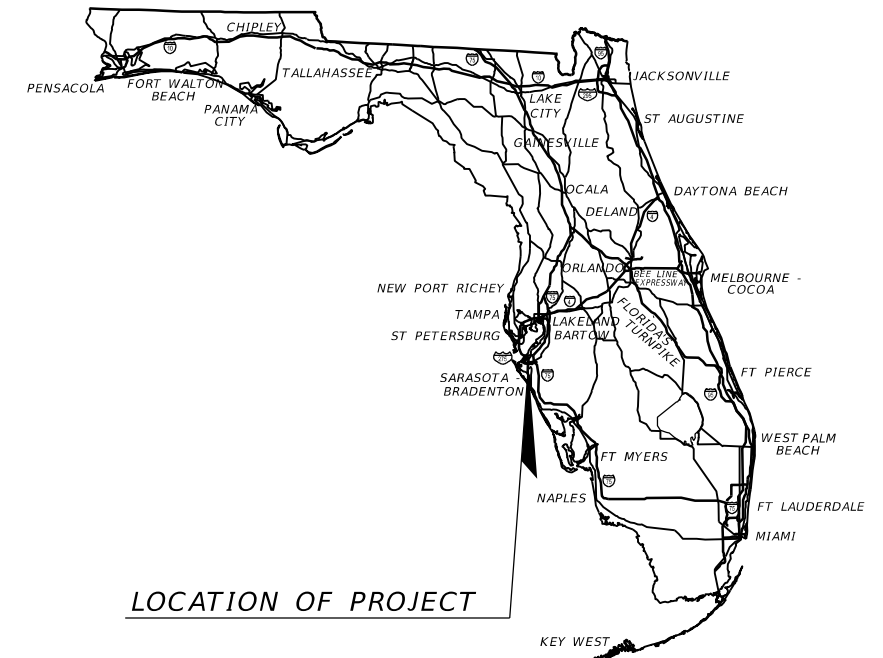

THIS ITEM HAS BEEN DIGITALLY
SIGNED AND SEALED BY

ON THE DATE ADJACENT TO THE SEAL
PRINTED COPIES OF THIS DOCUMENT ARE
NOT CONSIDERED SIGNED AND SEALED
AND THE SIGNATURE MUST BE VERIFIED
ON ANY ELECTRONIC COPIES.

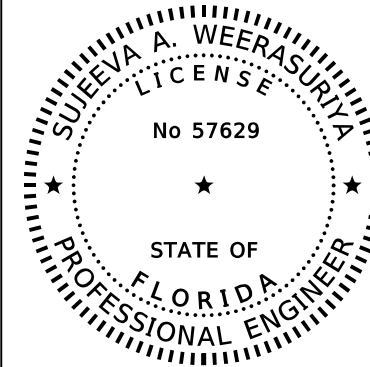

PHASE IV
SEPTEMBER 2024

**SIGNALIZATION PLANS
ENGINEER OF RECORD:**

SUJEEVA A. WEERASURIYA, P.E.
P.E. LICENSE NUMBER 57629
PATEL, GREENE & ASSOCIATES, LLC
12570 TELECOM DRIVE
TEMPLE TERRACE, FL 33637
(813) 978-3100
CONTRACT NO.: CAK18
VENDOR NO.: F452209743-001

FDOT PROJECT MANAGER:
SCOTT MCCALL, P.E.

CONSTRUCTION CONTRACT NO.	FISCAL YEAR	SHEET NO.
T1910	25	T-1

PROJECT LOCATION URL: <https://tinyurl.com/2nvfs7yc>
PROJECT LIMITS: BEGIN MP 1.126 - END MP 6.000
EXCEPTIONS: MP 1.661 - MP 1.738
 MP 2.143 - MP 2.181
BRIDGE LIMITS: BR#130053 MP 2.617 - MP 3.038
 BR#130002 MP 4.032 - MP 4.065
 BR#130008 MP 4.261 - MP 4.293
 BR#130009 MP 5.342 - MP 5.408
RAILROAD CROSSING: DOT/AAR CROSSING NO.624712-B
 CSX MP AZA 917.00, CSXT, INC.
 MP 1.661
 DOT/AAR CROSSING NO. 624612-W
 CSX MP SWC 870.56, CSXT, INC.
 MP 4.264
 DOT/AAR CROSSING NO. 624730-Y
 CSX MP AZA 913.1, CSXT, INC.
 MP 5.342

GOVERNING STANDARD PLANS:

Florida Department of Transportation, FY 2024-25 Standard Plans for Road and Bridge Construction and applicable Interim Revisions (IRs).

Standard Plans for Road Construction and associated IRs are available at the following website: <http://www.fdot.gov/design/standardplans>

Standard Plans for Bridge Construction are included in the Structures Plans Component

GOVERNING STANDARD SPECIFICATIONS:

Florida Department of Transportation, FY 2024-25 Standard Specifications for Road and Bridge Construction at the following website: <http://www.fdot.gov/programmanagement/Implemented/SpecBooks>

GENERAL NOTES:

1. MANATEE COUNTY IS THE MAINTAINING AGENCY FOR THE SIGNALIZATION.

MANATEE COUNTY TRAFFIC ENGINEERING DIVISION
 VISHAL KAKKAD
 2101 47TH TERRACE EAST
 BRADENTON, FLORIDA 34203
 PH: 941-749-3500 EXT. 7812
 VISHAL.KAKKAD@MYMANATEE.ORG

2. COAT ALL THREADED HARDWARE AND MECHANICAL/ELECTRICAL CONNECTION TERMINATIONS WITH AN OXIDE INHIBITOR.

3. WEATHERPROOF IRREGULAR MATTING SURFACES SUCH AS AREAS INCLUDING SEPARATED SIGNAL COUPLINGS, CONTROLLER CABINET FOUNDATION, PEDESTRIAN PUSH BUTTONS, AND ANY OTHER AREAS TYPICALLY PRONE TO MOISTURE INFILTRATION BY APPLYING A BEAD OF SILICONE CAULK.

4. REQUEST UPDATED SIGNAL TIMINGS FROM FDOT TSM&O ENGINEER-ARTERIALS (863-519-2216) WHEN ALL LANES, STRIPING AND SIGNALS ARE IN THEIR FINAL CONFIGURATION AND THE SIGNAL IS OPERATING AS DESIGNED, PROVIDE FDOT WITH ALL 'AS-BUILT' INFORMATION NECESSARY TO DEVELOP THE BASIC SIGNAL TIMING PARAMETERS AND ALLOW THREE (3) WEEKS FOLLOWING THE REQUEST FOR FDOT TO DEVELOP THE UPDATED TIMINGS, PROGRAM THE CONTROLLER PER THE TIMINGS PROVIDED BY THE FDOT.

5. COORDINATE WITH THE ENGINEER, IN CONJUNCTION WITH MANATEE COUNTY'S TRAFFIC ENGINEERING DIVISION (941-749-3502 EXT. 7812), AT LEAST TWO WEEKS BEFORE ANY CABINET MODIFICATIONS ARE TO BE PERFORMED. THE ENGINEER, IN CONJUNCTION WITH MANATEE COUNTY ENGINEERING DIVISION PERSONNEL, WILL REVIEW, ASSIST AND PROVIDE TECHNICAL SUPPORT RELEVANT TO ANY FIELD MODIFICATIONS THAT ARE NECESSARY.

6. NOTIFY THE ENGINEER ONE WEEK PRIOR TO THE BEGINNING OF THE TRAFFIC SIGNAL INSTALLATION OR TURN ON OF A NEW SIGNAL.

RESIDENT UTILITY COORDINATOR
 FLORIDA DEPARTMENT OF TRANSPORTATION
 MANATEE OPERATIONS CENTER
 14000 FL-64
 BRADENTON, FL 34212
 PH: 941-708-4400

MANATEE COUNTY TRAFFIC ENGINEERING DIVISION
 VISHAL KAKKAD
 2101 47TH TERRACE EAST
 BRADENTON, FLORIDA 34203
 PH: 941-749-3500 EXT. 7812

7. DELIVER THREE SETS OF RECORD DRAWINGS, TWO SETS OF IMSA INSPECTION FORMS AND ONE COMPACT DISC OF RECORD DRAWINGS TO MR. AARON BURKETT, THE MANATEE COUNTY TRAFFIC OPERATIONS DIVISION MANAGER AT 2904 12TH ST CT E, BRADENTON, FL 34208. RECORD DRAWINGS MUST BE DELIVERED TO THE COUNTY FIVE (5) BUSINESS DAYS PRIOR TO SCHEDULING THE FINAL INSPECTION.

8. UPON PASSING THE FINAL INSPECTION, SEND A WRITTEN REQUEST TO THE PROJECT MANAGEMENT DIVISION AND THE TRAFFIC OPERATIONS DIVISION TO TRANSFER MAINTENANCE FROM THE CONTRACTOR TO MANATEE COUNTY. MANATEE COUNTY WILL RESPOND WITHIN 5 WORKING DAYS TO ESTABLISH A TIME TABLE FOR THE TRANSFER OF MAINTENANCE RESPONSIBILITY.

9. PROVIDE SIGNAL MAINTENANCE, TIMING AND OPERATION OF ALL SIGNAL AND SIGNAGE FROM COMMENCEMENT TO ACCEPTANCE OF THE PROJECT (I.E. EXISTING LOOP CUTS, SYSTEM COMMUNICATION TERMINATED, LANE OR PAVEMENT MODIFICATIONS, PEDESTRIAN MODIFICATIONS, TRAFFIC SIGNAL SCHOOL FLASHER, WARNING FLASHER, ROADWAY LIGHTING, COUNT STATIONS, AND ANY OTHER TRAFFIC RELATED WITHIN THE CONSTRUCTION ZONE).

10. AT THE COMPLETION OF THE PROJECT, PROVIDE AS-BUILT PLANS IN ELECTRONIC FORM (PDF) TO:

FDOT TRAFFIC OPERATIONS
 NEAL TURNER, P.E., TSM&O ENGINEER - ARTERIALS
 801 N. BROADWAY AVE
 P.O. BOX 1249
 BARTOW, FL 33830-1249
 EMAIL: NEAL.TURNER@DOT.STATE.FL.US
 PH: 863-519-2216

PAY ITEM NOTES:

1. 630-2-11 & 630-2-12:
 ALL CONDUIT RUNS SHOWN ON THE PLANS ARE SCHEMATIC AND FIELD ADJUSTMENTS MAY BE NECESSARY.

2. 635-2-11:
 PULL BOXES ARE TO BE PLACED BEHIND CURB AND GUTTER. IF THERE IS NO CURB AND GUTTER, PULL BOXES SHALL BE PLACED A MINIMUM OF 7' FROM THE EDGE OF PAVEMENT.

3. 660-2-102 & 660-2-106:
 PERMANENTLY MARK EACH LOOP PER PHASE AND PER VEHICLE MOVEMENT AT EACH SPLICE POINT AND AT THE CABINET TERMINATION POINT.

FOR INCREASED SENSITIVITY, INDUCTANCE LOOPS TO HAVE A MINIMUM OF THREE TURNS OF WIRE.

4. 676-1-500:
 INCLUDE THE LABOR AND MATERIAL TO CORE-DRILL EXISTING CONTROLLER CABINET BASE AND INSTALL NEW CONDUITS IF SPARE CONDUIT STUB-OUTS CANNOT BE USED. INSTALL NEW CONDUITS INTO THE EXISTING FOUNDATION AS RECORDED IN THE PLANS. LOCATE NEW CONDUITS SO THEY WILL NOT OBSTRUCT THE MAINTENANCE OF EQUIPMENT IN THE CABINET OR THE ANCHORING OF THE CABINET FLANGE TO THE CONCRETE FOUNDATION. PROTECT INTERNAL CABINET EQUIPMENT FROM DUST AND DEBRIS CAUSED BY CORE DRILLING.

9/30/2024 5:32:42 PM USER: craig.gregory c:\pw\workdir\patel@greene-pw-01\pw_user\dmis13899\GNWT5G01.dgn

REVISIONS				ENGINEER OF RECORD		STATE OF FLORIDA DEPARTMENT OF TRANSPORTATION			SHEET NO.	
DATE	DESCRIPTION	DATE	DESCRIPTION				ROAD NO.	COUNTY		FINANCIAL PROJECT ID
				SUJEEVA A. WEERASURIYA, P.E. LICENSE NUMBER: 57629 PATEL, GREENE & ASSOCIATES, LLC 12570 TELECOM DRIVE TEMPLE TERRACE, FL 33637						
GENERAL NOTES										
T-2										

THE OFFICIAL RECORD OF THIS SHEET IS THE ELECTRONIC FILE DIGITALLY SIGNED AND SEALED UNDER RULE 61G15-23.004, F.A.C.



SIGN DETAILS

1ST ST / US 301 SP1

EXISTING TO REMAIN

13TH AV SP5

EXISTING TO REMAIN

EXISTING TO REMAIN

EXISTING TO REMAIN

EXISTING TO REMAIN

EXISTING TO REMAIN

[2] [3] [4] [6] [7] [8]

[1] [5]

NOTES:

- MAJOR STREET IS US 301, MOVEMENTS 2 AND 6
MINOR STREET IS 13TH AVE, MOVEMENTS 4 AND 8
- POSTED SPEEDS: US 301 = 45 MPH; 13TH AVE = 25 MPH
- ALL TYPE "F" LOOPS SHALL BE 6'X40' AND PLACED 2' INFRONT OF THE STOP BAR.
ALL TYPE "B" LOOPS SHALL BE 6'X6' AND PLACED 40' BEHIND THE STOP BAR.
- REQUEST UPDATED SIGNAL TIMINGS FROM FDOT TSM&O ENGINEER - ARTERIALS (863-519-2216) WHEN ALL LANES, STRIPING, SIGNALS AND PEDESTRIAN FACILITIES ARE IN THEIR FINAL CONFIGURATION AND THE SIGNAL IS OPERATING AS DESIGNED. PROVIDE FDOT WITH ALL 'AS-BUILT' INFORMATION NECESSARY TO DEVELOP THE BASIC SIGNAL TIMING PARAMETERS AND ALLOW THREE (3) WEEKS FOLLOWING THE REQUEST FOR FDOT TO DEVELOP THE UPDATED TIMINGS. PROGRAM THE CONTROLLER PER THE TIMINGS PROVIDED BY FDOT.
- WHEN SIGNAL IS IN FLASHING MODE, MOVEMENTS 2 AND 6 SHALL FLASH YELLOW. ALL OTHER VEHICLE MOVEMENTS SHALL FLASH RED.
- CONTROLLER, MAST ARMS, PEDESTRIAN SIGNALS AND PEDESTRIAN DETECTORS ARE EXISTING TO REMAIN.
- FOR RECONNECTION OF LOOP LEAD-INS FOR STOP BAR LOOPS, UTILIZE EXISTING PULL BOXES AND CONDUITS FOR HOME RUN BACK TO THE EXISTING CONTROLLER. MULTIPLE POINT DETECTION ZONE LOOPS TO UTILIZE NEW PULL BOX AND CONDUITS FOR HOME RUN BACK TO THE EXISTING CONTROLLER.

CONTROLLER TIMINGS								
MOVEMENT NUMBER	1	2	3	4	5	6	7	8
DIRECTION	NBLT	SB		WB	SBLT	NB		EB
TURN TYPE	Prot				Prot			
MINIMUM GREEN	5	10		7	5	10		7
EXTENSION	3.0	5.0		3.0	3.0	5.0		3.0
MAX I	25	70		45	25	75		45
MAX II	35	125		65	25	130		65
MAX LIMIT								
YELLOW CLEARANCE	4.8	4.8		3.4	4.8	4.8		3.4
ALL RED	2.5	2.0		3.3	2.5	2.0		3.3
WALK		7		7		7		7
FLASHING DON'T WALK		12		29		10		29
DET. MEMORY								
DET. CROSS SWITCH								
DUAL ENTRY		ON		ON		ON		ON
RECALL		MIN PED				MIN PED		
REST IN WALK		ON				ON		

DETECTORS FOR LOOPS				
LOOP	NO. OF LOOPS	NO. OF NEW DETS.	NO. OF EXIST. DETS.	DELAY TIME (SEC)
L-1	1	N/A	1	
L-5	1	N/A	1	
L-6A	1	N/A	1	
L-6B	1	N/A	1	
L-6C	1	N/A	1	
L-6D	1	N/A	1	
L-2A	1	N/A	1	
L-2B	1	N/A	1	
L-2C	1	N/A	1	
L-8	1	N/A	1	
L-3	1	N/A	1	
L-7	1	N/A	1	
L-4D	1	N/A	1	8
L-8D	1	N/A	1	8
L-2D	1	1	N/A	
L-2E	1	1	N/A	
L-2F	1	1	N/A	
L-2G	1	1	N/A	
L-2H	1	1	N/A	
L-2I	1	1	N/A	
L-6E	1	1	N/A	
L-6F	1	1	N/A	
L-6G	1	1	N/A	
L-6H	1	1	N/A	
L-6I	1	1	N/A	
L-6J	1	1	N/A	
L-6K	1	1	N/A	
L-6L	1	1	N/A	

DELAY TIME IS INITIAL AND MAY REQUIRE FIELD ADJUSTING AS DIRECTED BY PROJECT ENGINEER.

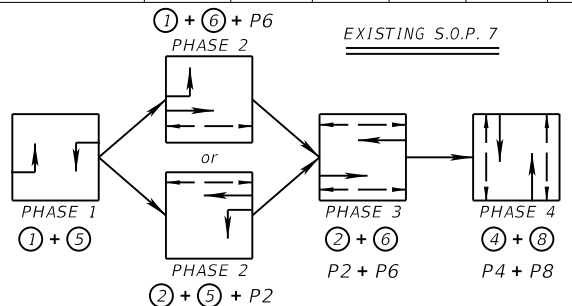

REVISIONS			
DATE	DESCRIPTION	DATE	DESCRIPTION

ENGINEER OF RECORD
 SUJEEVA A. WEERASURIYA, P.E.
 LICENSE NUMBER: 57629
 PATEL, GREENE & ASSOCIATES, LLC
 12570 TELECOM DRIVE
 TEMPLE TERRACE, FL 33637

STATE OF FLORIDA
 DEPARTMENT OF TRANSPORTATION

ROAD NO.	COUNTY	FINANCIAL PROJECT ID
SR 55	MANATEE	447379-1-52-01

SIGNALIZATION PLANS

SHEET NO. T-3

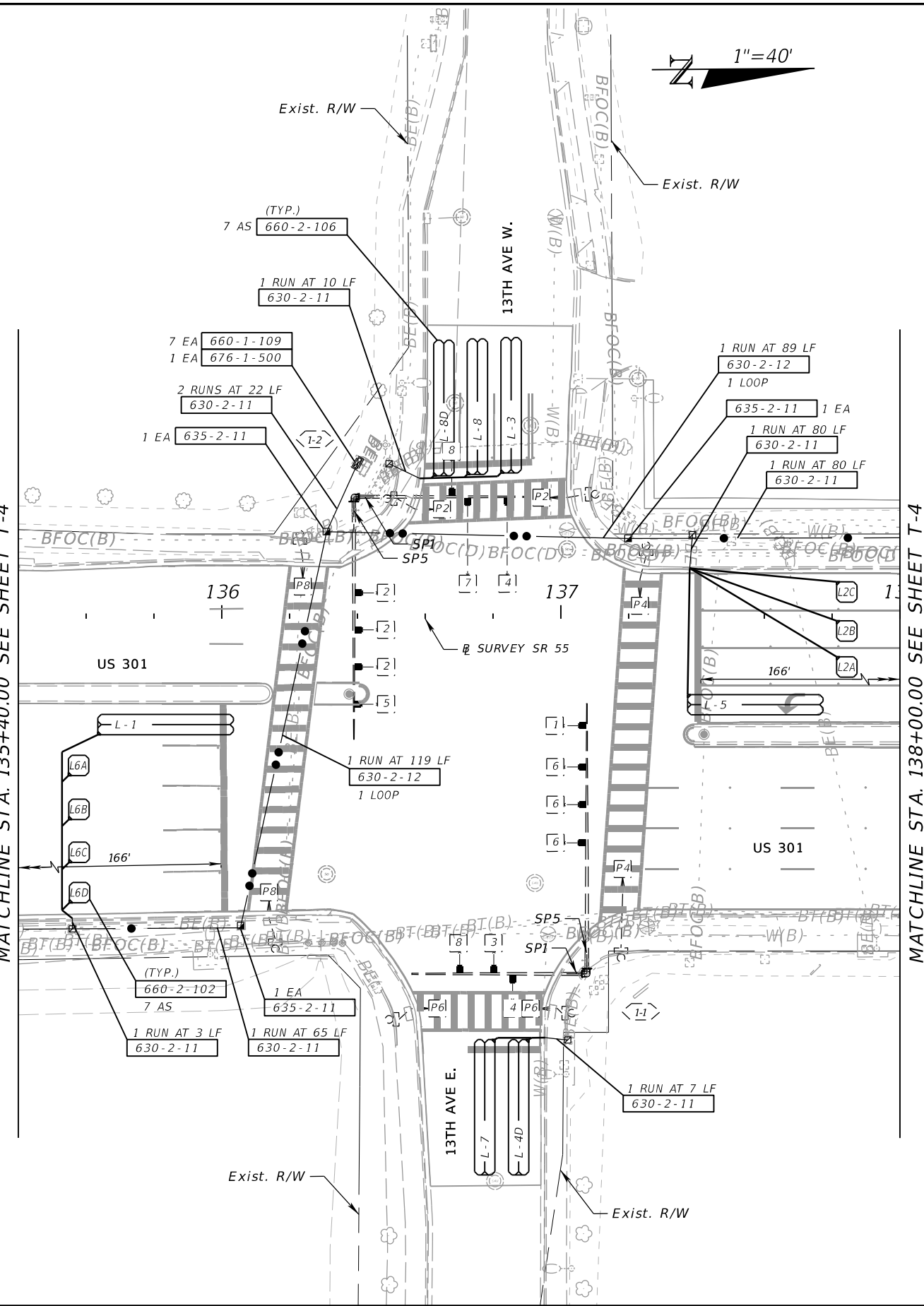

9/30/2024 5:33:09 PM USER: craig.gregory c:\pwworkdir\pate@greene-pw-01\pwworkdir\dmis13899\PLAN501.dgn

THE OFFICIAL RECORD OF THIS SHEET IS THE ELECTRONIC FILE DIGITALLY SIGNED AND SEALED UNDER RULE 61G15-23.004, F.A.C.

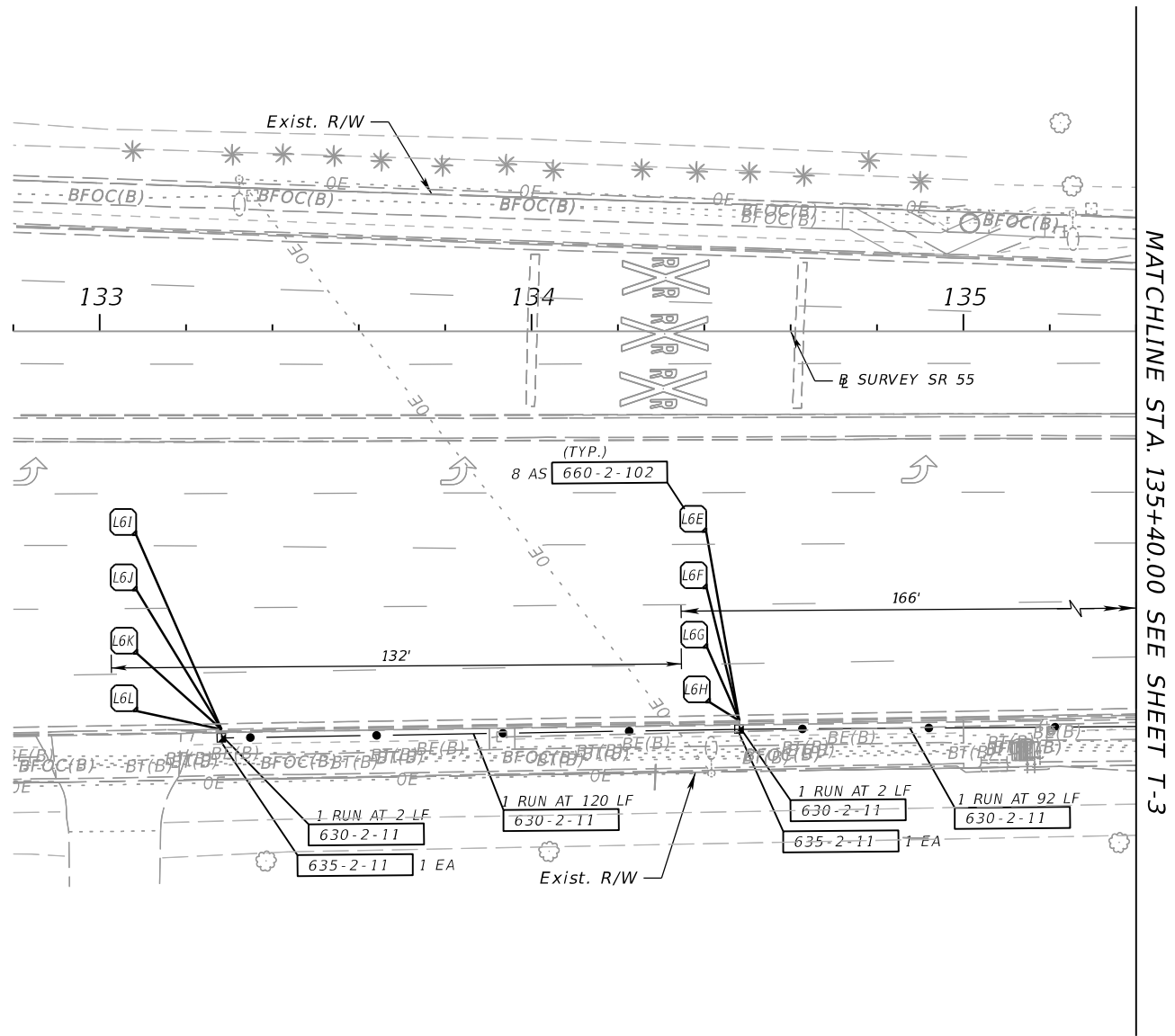
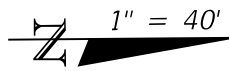

MATCHLINE STA. 135+40.00 SEE SHEET T-3

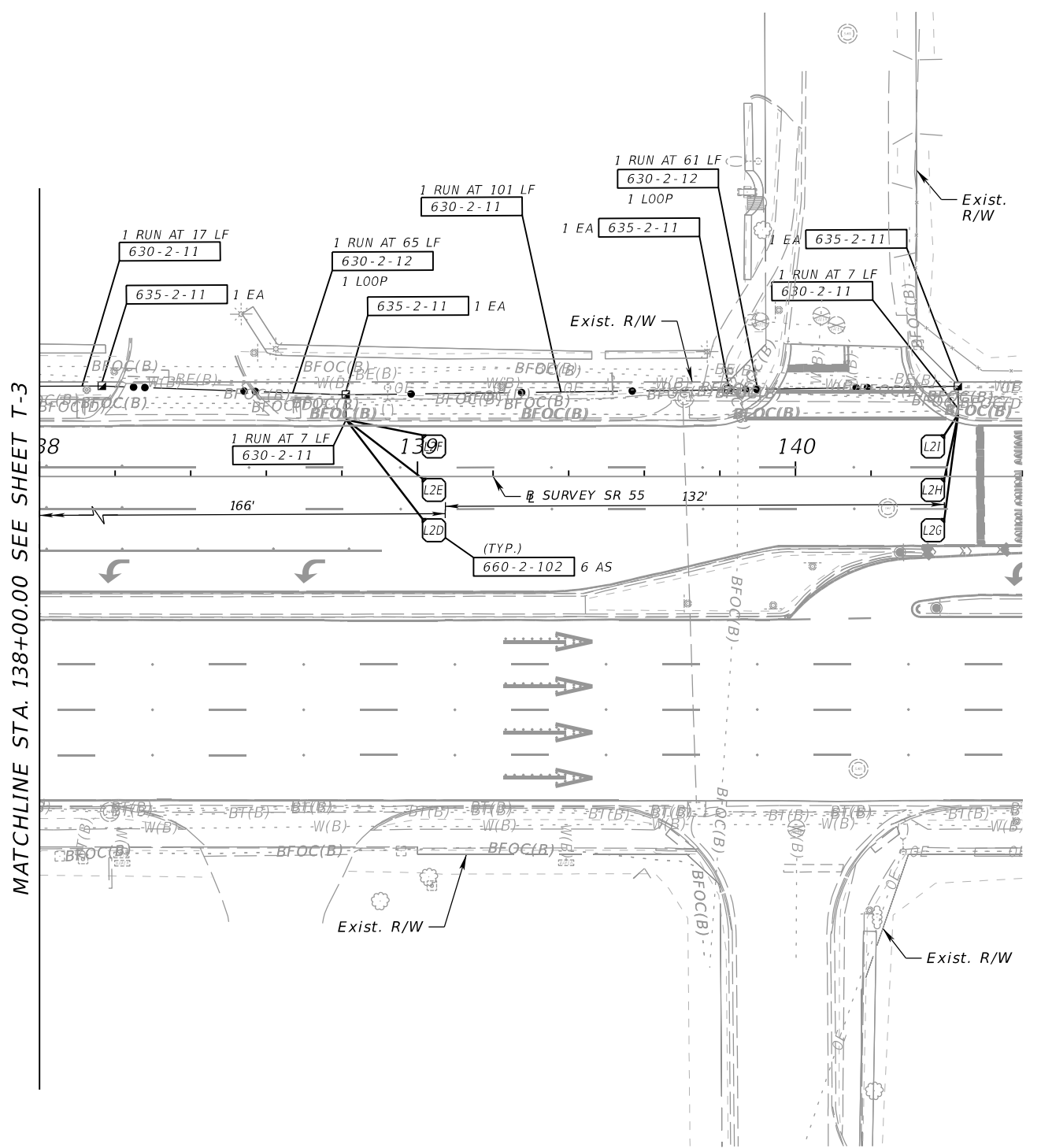
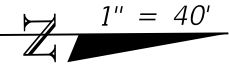

MATCHLINE STA. 138+00.00 SEE SHEET T-3

9/30/2024 5:33:21 PM USER: craig.gregory
c:\pw\workdir\patel@greene-pw-01\pw_user\dms13899\PLAN5002.dgn

REVISIONS			
DATE	DESCRIPTION	DATE	DESCRIPTION

ENGINEER OF RECORD
 SUJEEVA A. WEERASURIYA, P.E.
 LICENSE NUMBER: 57629
 PATEL, GREENE & ASSOCIATES, LLC
 12570 TELECOM DRIVE
 TEMPLE TERRACE, FL 33637

STATE OF FLORIDA DEPARTMENT OF TRANSPORTATION		
ROAD NO.	COUNTY	FINANCIAL PROJECT ID
SR 55	MANATEE	447379-1-52-01

SIGNALIZATION PLANS

SHEET NO.
T-4

THE OFFICIAL RECORD OF THIS SHEET IS THE ELECTRONIC FILE DIGITALLY SIGNED AND SEALED UNDER RULE 61G15-23.004, F.A.C.

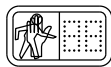
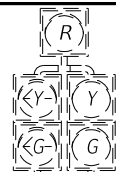

EXISTING TO REMAIN

EXISTING TO REMAIN

EXISTING TO REMAIN

EXISTING TO REMAIN

EXISTING TO REMAIN

PED. SIGNAL COUNT-DOWN 1-SECT., 1-WAY

2 AS

653-1-11

P2 P4

SIGN DETAILS

1ST ST / US 301 SP1

EXISTING TO REMAIN

DR MLK^{JR} AV SP2

EXISTING TO REMAIN

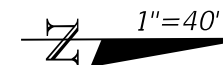

NOTES:

- MAJOR STREET IS US 301, MOVEMENTS 2 AND 6 MINOR STREET IS DR MLK^{JR} AVE., MOVEMENTS 4 AND 8
- POSTED SPEEDS: US 301 = 45 MPH; DR MLK^{JR} AVE. = 30 MPH
- ALL TYPE "F" LOOPS SHALL BE 6'X40' AND PLACED 2' INFRONT OF THE STOP BAR. ALL TYPE "B" LOOPS SHALL BE 6'X6' AND PLACED 40' BEHIND THE STOP BAR.
- REQUEST UPDATED SIGNAL TIMINGS FROM FDOT TSM&O ENGINEER - ARTERIALS (863-519-2216) WHEN ALL LANES, STRIPING, SIGNALS AND PEDESTRIAN FACILITIES ARE IN THEIR FINAL CONFIGURATION AND THE SIGNAL IS OPERATING AS DESIGNED. PROVIDE FDOT WITH ALL 'AS-BUILT' INFORMATION NECESSARY TO DEVELOP THE BASIC SIGNAL TIMING PARAMETERS AND ALLOW THREE (3) WEEKS FOLLOWING THE REQUEST FOR FDOT TO DEVELOP THE UPDATED TIMINGS. PROGRAM THE CONTROLLER PER THE TIMINGS PROVIDED BY FDOT.
- WHEN SIGNAL IS IN FLASHING MODE, MOVEMENTS 2 AND 6 SHALL FLASH YELLOW. ALL OTHER VEHICLE MOVEMENTS SHALL FLASH RED. FLASH THE 5-SECTION HEADS AS THE SAME COLOR AS THE ADJACENT THROUGH LANE.
- CONTROLLER, MAST ARMS, PEDESTRIAN SIGNALS AND PEDESTRIAN DETECTORS (NE, SE & SW) ARE EXISTING TO REMAIN.
- FOR RECONNECTION OF LOOP LEAD-INS FOR STOP BAR LOOPS AT THE NE, SE & SW RETURNS, UTILIZE EXISTING PULL BOXES AND CONDUITS FOR HOME RUN BACK TO THE EXISTING CONTROLLER. MULTIPLE POINT DETECTION ZONE-LOOPS TO UTILIZE NEW PULL BOX AND CONDUITS FOR HOME RUN BACK TO THE EXISTING CONTROLLER.

CONTROLLER TIMINGS

MOVEMENT NUMBER	1	2	3	4	5	6	7	8
DIRECTION	SBLT	NB	EBLT	WB	NBLT	SB	WBLT	EB
TURN TYPE	Prot		Prot/Perm		Prot		Prot/Perm	
MINIMUM GREEN	5	10	5	7	5	10	5	7
EXTENSION	5.0	5.0	3.0	3.0	3.0	5.0	3.0	3.0
MAX I	15	75	15	25	20	75	15	25
MAX II	30	120	30	45	30	120	35	40
MAX LIMIT								
YELLOW CLEARANCE	4.8	4.8	3.7	3.7	4.8	4.8	3.7	3.7
ALL RED	2.0	2.0	2.0	2.3	2.0	2.0	2.0	2.3
WALK		7		7		7		7
FLASHING DON'T WALK		26		33		25		32
DET. MEMORY								
DET. CROSS SWITCH			08				04	
DUAL ENTRY		ON		ON		ON		ON
RECALL		MIN				MIN		
REST IN WALK								

DETECTORS FOR LOOPS

LOOP	NO. OF LOOPS	NO. OF NEW DETS.	NO. OF EXIST. DETS.	DELAY TIME (SEC)
L-1	1	N/A	1	
L-5	1	N/A	1	
L-6A	1	N/A	1	
L-6B	1	N/A	1	
L-6C	1	N/A	1	
L-6D	1	N/A	1	
L-2A	1	N/A	1	
L-2B	1	N/A	1	
L-3	1	N/A	1	
L-8	1	N/A	1	
L-4	1	N/A	1	
L-7	1	N/A	1	
L-4D	1	N/A	1	8
L-8D	1	N/A	1	8
L-2C	1			
L-2D	1	1	N/A	
L-2E	1			
L-2F	1	1	N/A	
L-2G	1	1	N/A	
L-2H	1	1	N/A	
L-2I	1	1	N/A	
L-6E	1	1	N/A	
L-6F	1	1	N/A	
L-6G	1	1	N/A	
L-6H	1	1	N/A	
L-6I	1	1	N/A	
L-6J	1	1	N/A	
L-6K	1	1	N/A	
L-6L	1	1	N/A	

DELAY TIME IS INITIAL AND MAY REQUIRE FIELD ADJUSTING AS DIRECTED BY PROJECT ENGINEER.

REMOVAL ITEMS:

646-1-60 1 EA (NW RETURN)

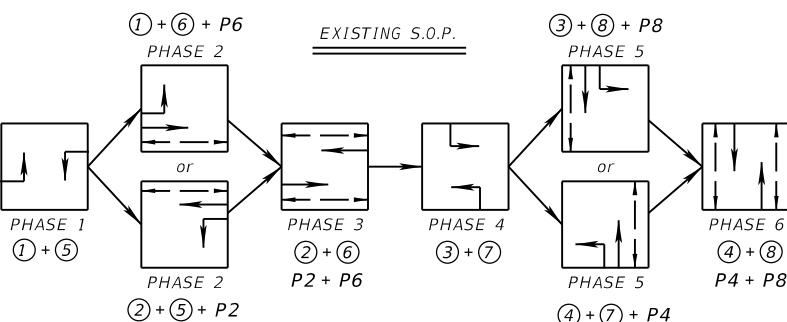

MATCHLINE STA. 148+75.00 SEE SHEET T-6

MATCHLINE STA. 151+40.00 SEE SHEET T-6

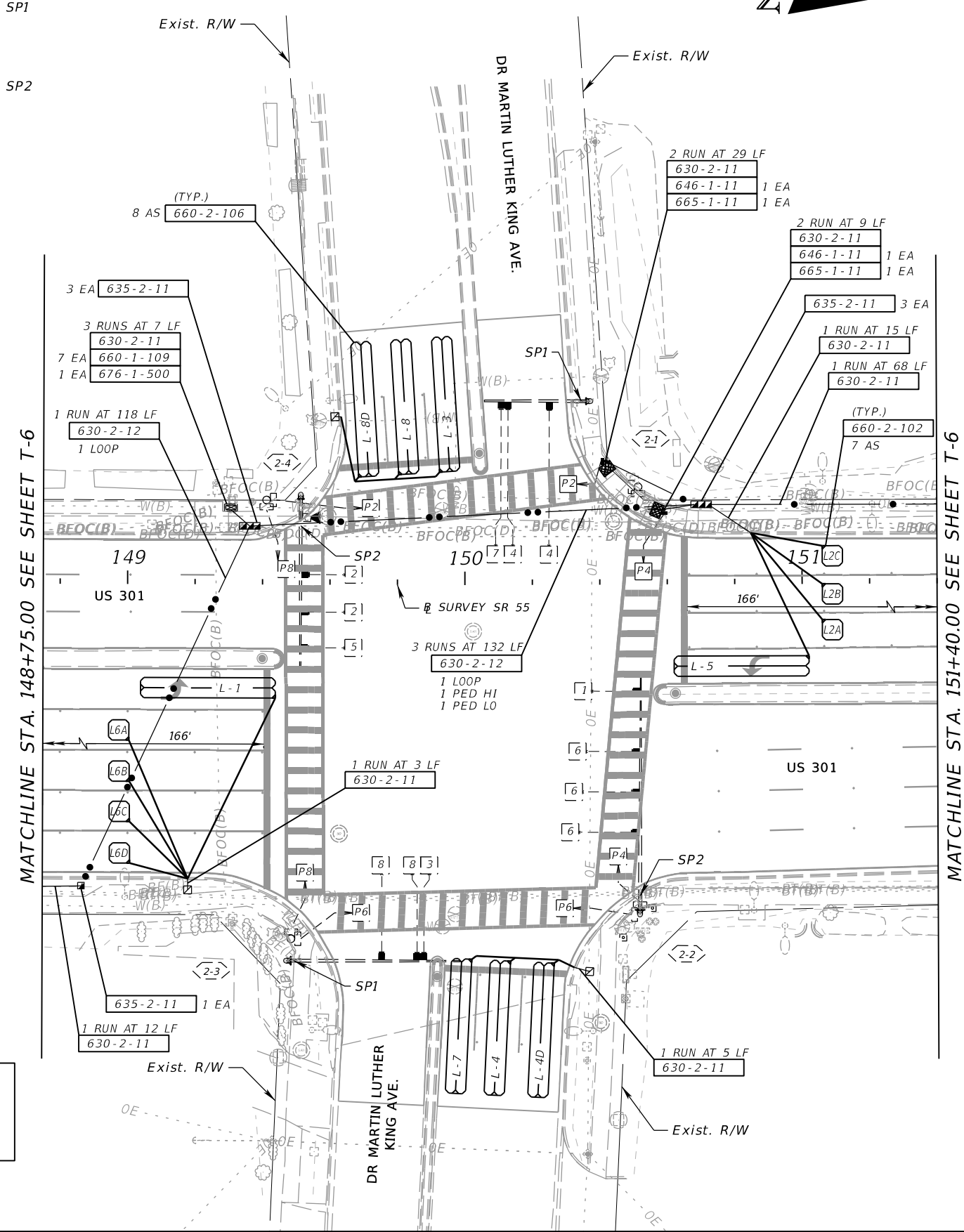

9/30/2024 5:33:33 PM USER: craig.gregory c:\pwworkdir\patel@greene-pw.com\dms13899\PLAN5001.dgn

THE OFFICIAL RECORD OF THIS SHEET IS THE ELECTRONIC FILE DIGITALLY SIGNED AND SEALED UNDER RULE 61G15-23.004, F.A.C.

REVISIONS				ENGINEER OF RECORD		STATE OF FLORIDA DEPARTMENT OF TRANSPORTATION			SHEET NO.
DATE	DESCRIPTION	DATE	DESCRIPTION			ROAD NO.	COUNTY	FINANCIAL PROJECT ID	
				SUJEEVA A. WEERASURIYA, P.E. LICENSE NUMBER: 57629 PATEL, GREENE & ASSOCIATES, LLC 12570 TELECOM DRIVE TEMPLE TERRACE, FL 33637		SR 55	MANATEE	447379-1-52-01	T-5

SIGNALIZATION PLANS

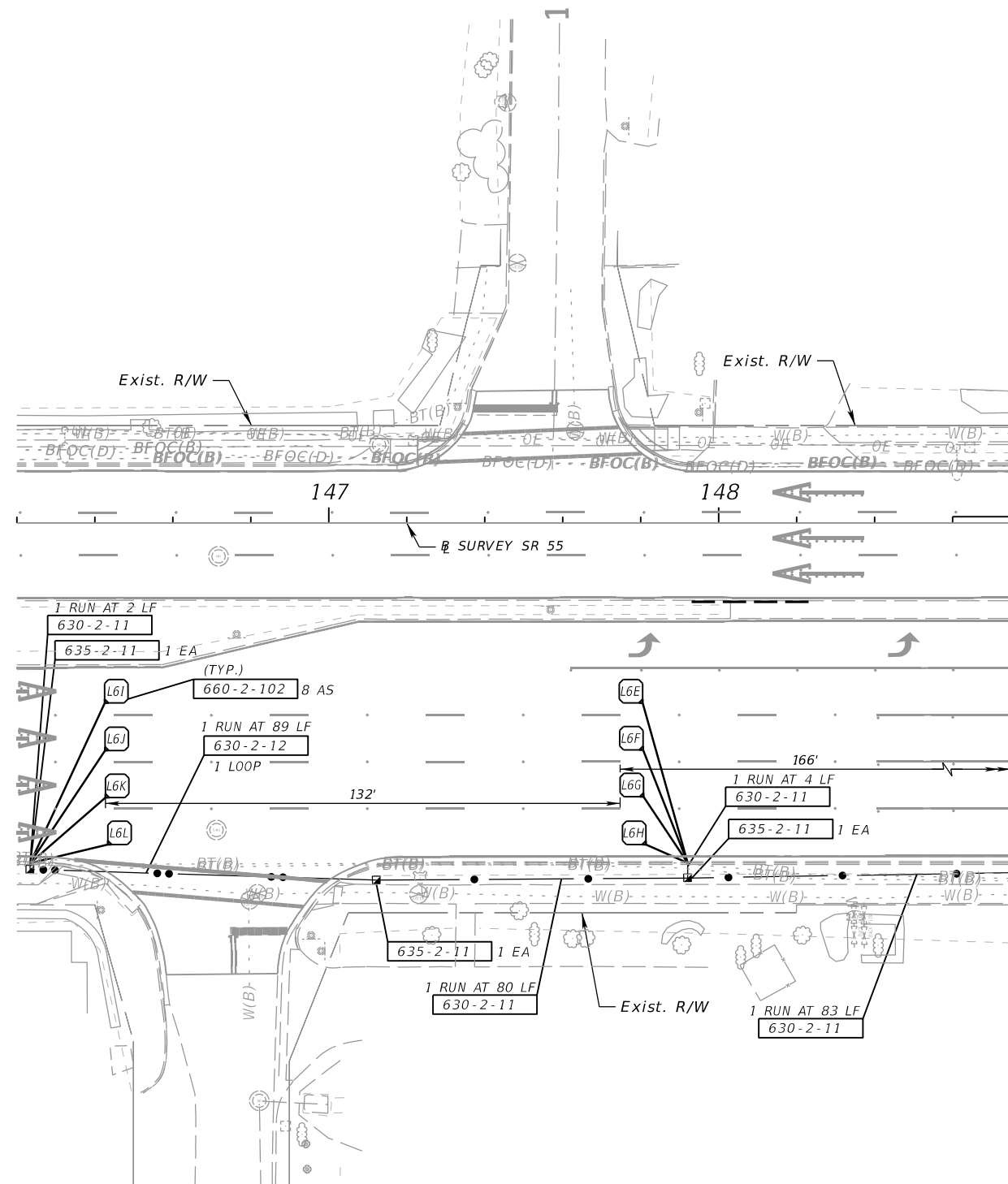
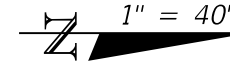
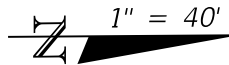

MATCHLINE STA. 148+75.00 SEE SHEET T-5

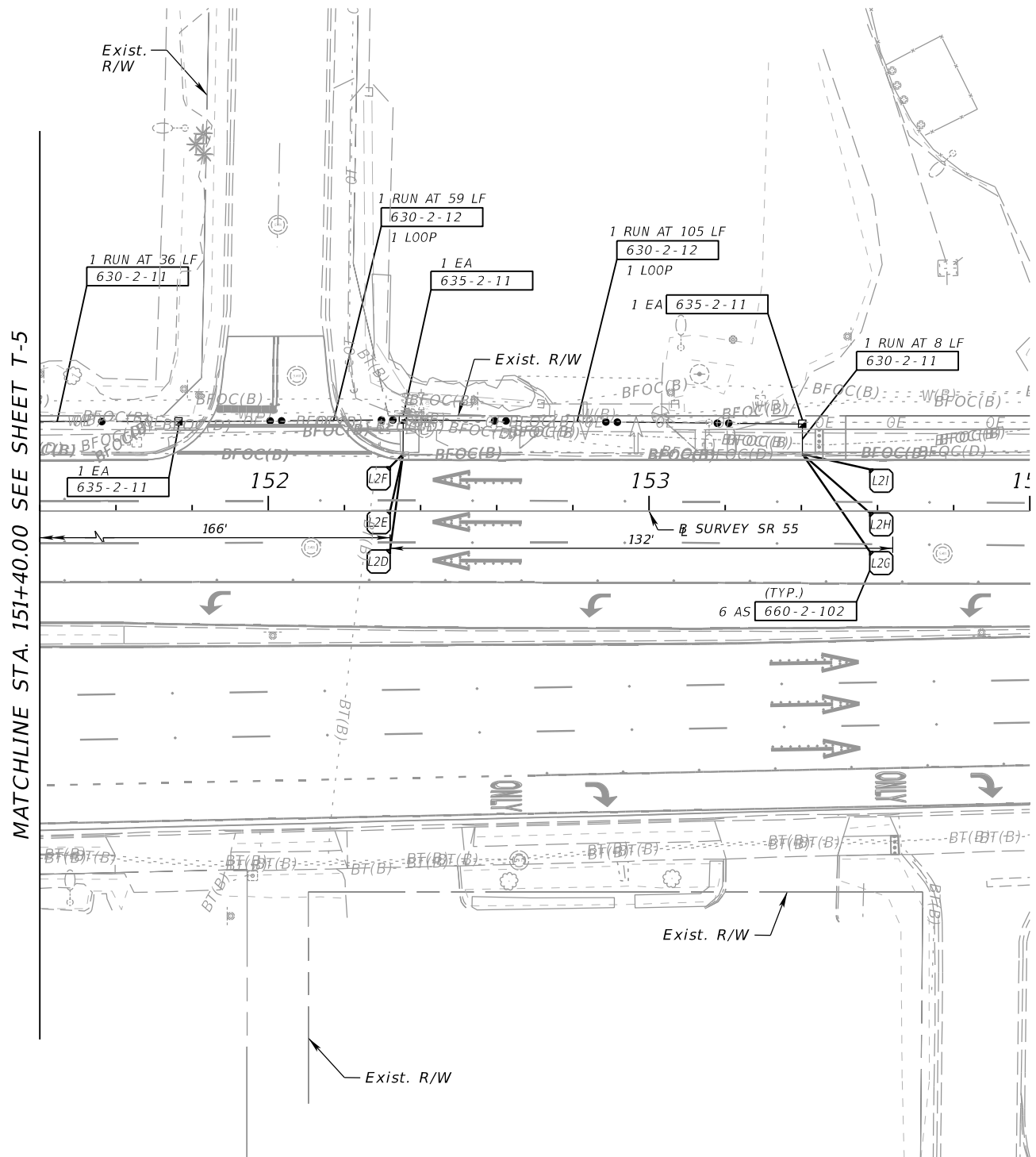

MATCHLINE STA. 151+40.00 SEE SHEET T-5

9/30/2024 5:33:47 PM USER: craig.gregory
c:\pw\workdir\patel@greene-pw-01\pw_user\dms13699\PLAN5602.dgn

REVISIONS				ENGINEER OF RECORD		STATE OF FLORIDA DEPARTMENT OF TRANSPORTATION			SHEET NO.
DATE	DESCRIPTION	DATE	DESCRIPTION	SUJEEVA A. WEERASURIYA, P.E. LICENSE NUMBER: 57629 PATEL, GREENE & ASSOCIATES, LLC 12570 TELECOM DRIVE TEMPLE TERRACE, FL 33637		ROAD NO.	COUNTY	FINANCIAL PROJECT ID	
						SR 55	MANATEE	447379-1-52-01	T-6

SIGNALIZATION PLANS

THE OFFICIAL RECORD OF THIS SHEET IS THE ELECTRONIC FILE DIGITALLY SIGNED AND SEALED UNDER RULE 61G15-23.004, F.A.C.

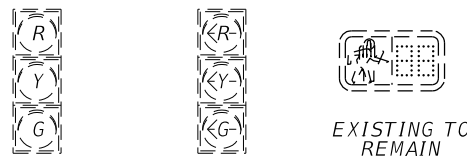

EXISTING TO REMAIN
 [2] [3] [6] [8]
 [5]
 [P2] [P6] [P8]

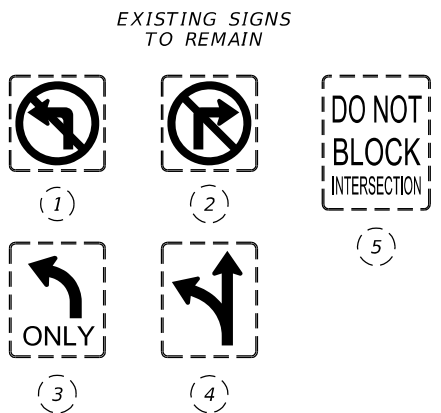
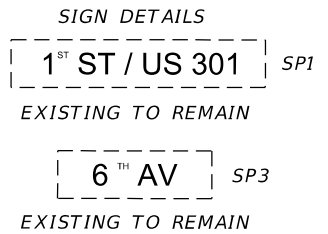

- NOTES:**
- MAJOR STREET IS US 301, MOVEMENTS 2 AND 6 MINOR STREET IS 6TH AVE, MOVEMENTS 8
 - POSTED SPEEDS: US 301 = 45 MPH; 6TH AVE = 30 MPH
 - ALL TYPE "F" LOOPS ARE EXISTING TO REMAIN. ALL TYPE "B" LOOPS SHALL BE 6'X6' AND PLACED 40' BEHIND THE STOP BAR.
 - REQUEST UPDATED SIGNAL TIMINGS FROM FDOT TSM&O ENGINEER - ARTERIALS (863-519-2216) WHEN ALL LANES, STRIPING, SIGNALS AND PEDESTRIAN FACILITIES ARE IN THEIR FINAL CONFIGURATION AND THE SIGNAL IS OPERATING AS DESIGNED. PROVIDE FDOT WITH ALL 'AS-BUILT' INFORMATION NECESSARY TO DEVELOP THE BASIC SIGNAL TIMING PARAMETERS AND ALLOW THREE (3) WEEKS FOLLOWING THE REQUEST FOR FDOT TO DEVELOP THE UPDATED TIMINGS. PROGRAM THE CONTROLLER PER THE TIMINGS PROVIDED BY FDOT.
 - WHEN SIGNAL IS IN FLASHING MODE, MOVEMENTS 2 AND 6 SHALL FLASH YELLOW. ALL OTHER VEHICLE MOVEMENTS SHALL FLASH RED.
 - CONTROLLER, MAST ARMS, PEDESTRIAN SIGNALS AND PEDESTRIAN DETECTORS ARE EXISTING TO REMAIN.
 - FOR RECONNECTION OF LOOP LEAD-INS FOR STOP BAR LOOPS, UTILIZE EXISTING PULL BOXES AND CONDUITS FOR HOME RUN BACK TO THE EXISTING CONTROLLER.

CONTROLLER TIMINGS								
MOVEMENT NUMBER	1	2	3	4	5	6	7	8
DIRECTION		SB			SBLT	NB		EB
TURN TYPE					PROT			
MINIMUM GREEN		15			5	15		7
EXTENSION		2.0			3.0	2.0		3.0
MAX I		65			30	65		40
MAX II		110			40	110		60
MAX LIMIT								
YELLOW CLEARANCE		4.7			4.7	4.8		4.0
ALL RED		4.2			3.4	4.2		3.9
WALK		7				7		7
FLASHING DON'T WALK		21				16		29
DET. MEMORY								
DET. CROSS SWITCH								
DUAL ENTRY								
RECALL		MIN				MIN		
REST IN WALK								

DETECTORS FOR LOOPS				
LOOP	NO. OF LOOPS	NO. OF NEW DETS.	NO. OF EXIST. DETS.	DELAY TIME (SEC)
L-5A	1		1	
L-5B	1	N/A	1	
L-8A	1	N/A	1	
L-8B	1	N/A	1	
L-8C	1	N/A	1	
L-8D	1	N/A	1	
L-8R	1	N/A	1	8
L-6R	1	N/A	1	5
L-6A	1	N/A	1	
L-6B	1	N/A	1	
L-6C	1	N/A	1	
L-2A	1	N/A	1	
L-2B	1	N/A	1	
L-6D	1	N/A	1	
L-6E	1	N/A	1	
L-6F	1	N/A	1	
L-6G	1	N/A	1	
L-6H	1	N/A	1	
L-6I	1	N/A	1	
L-2C	1	N/A	1	
L-2D	1	N/A	1	
L-2E	1	N/A	1	
L-2F	1	N/A	1	

DELAY TIME IS INITIAL AND MAY REQUIRE FIELD ADJUSTING AS DIRECTED BY PROJECT ENGINEER.

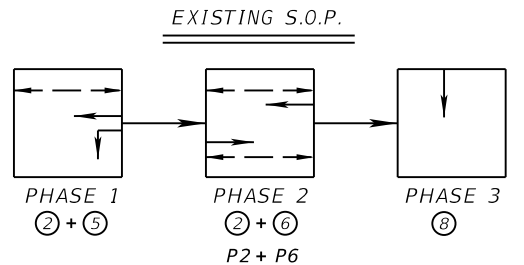

NOTE TO REVIEWER:
 EXISTING MAST ARM LOCATIONS SHOWN DO NOT REFLECT CURRENT MAST ARM LOCATIONS. REQUEST FOR CADD FILES FOR INFORMATION ON CURRENT LOCATIONS ARE PENDING FROM PROJECT 441535-1-52-01.

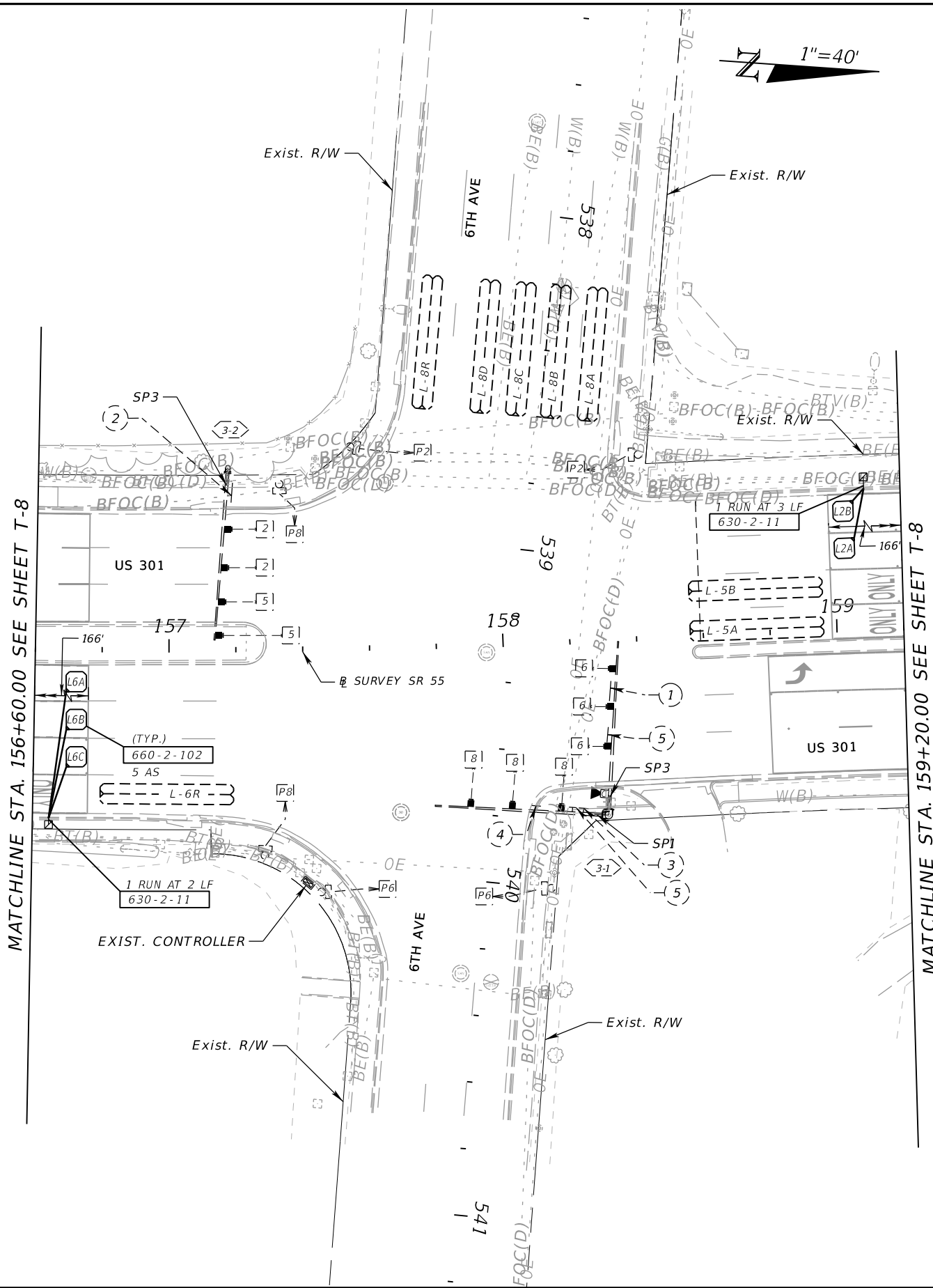

9/30/2024 5:34:00 PM USER: craig.gregory c:\pw\workdir\patel@greene-pw-01\pw_user\dms13899\PLAN501.dgn

REVISIONS				ENGINEER OF RECORD		STATE OF FLORIDA DEPARTMENT OF TRANSPORTATION			SHEET NO.
DATE	DESCRIPTION	DATE	DESCRIPTION			ROAD NO.	COUNTY	FINANCIAL PROJECT ID	
				SUJEEVA A. WEERASURIYA, P.E. LICENSE NUMBER: 57629 PATEL, GREENE & ASSOCIATES, LLC 12570 TELECOM DRIVE TEMPLE TERRACE, FL 33637		SR 55	MANATEE	447379-1-52-01	T-7

SIGNALIZATION PLANS

THE OFFICIAL RECORD OF THIS SHEET IS THE ELECTRONIC FILE DIGITALLY SIGNED AND SEALED UNDER RULE 61G15-23.004, F.A.C.

1" = 40'

1" = 40'

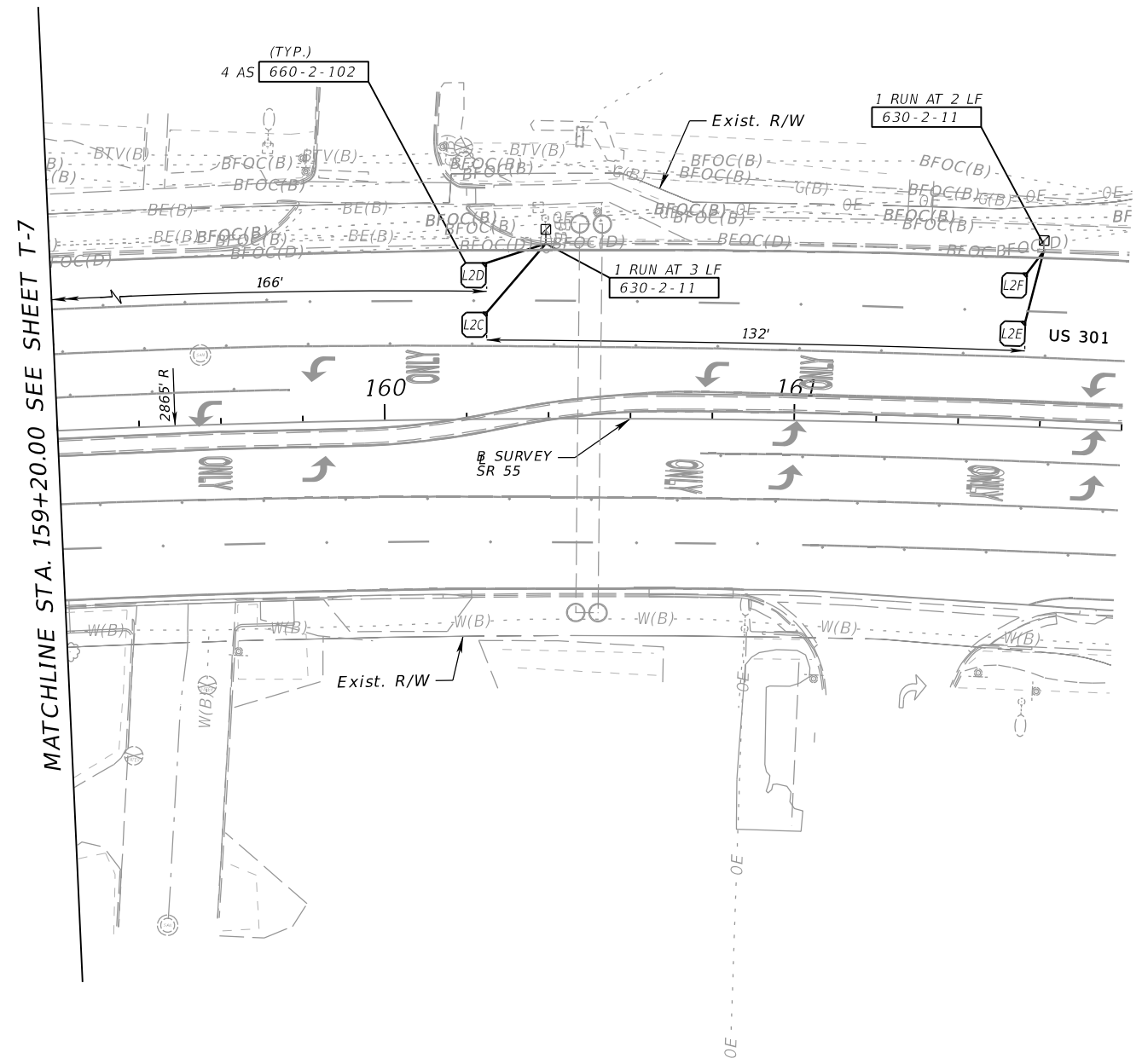
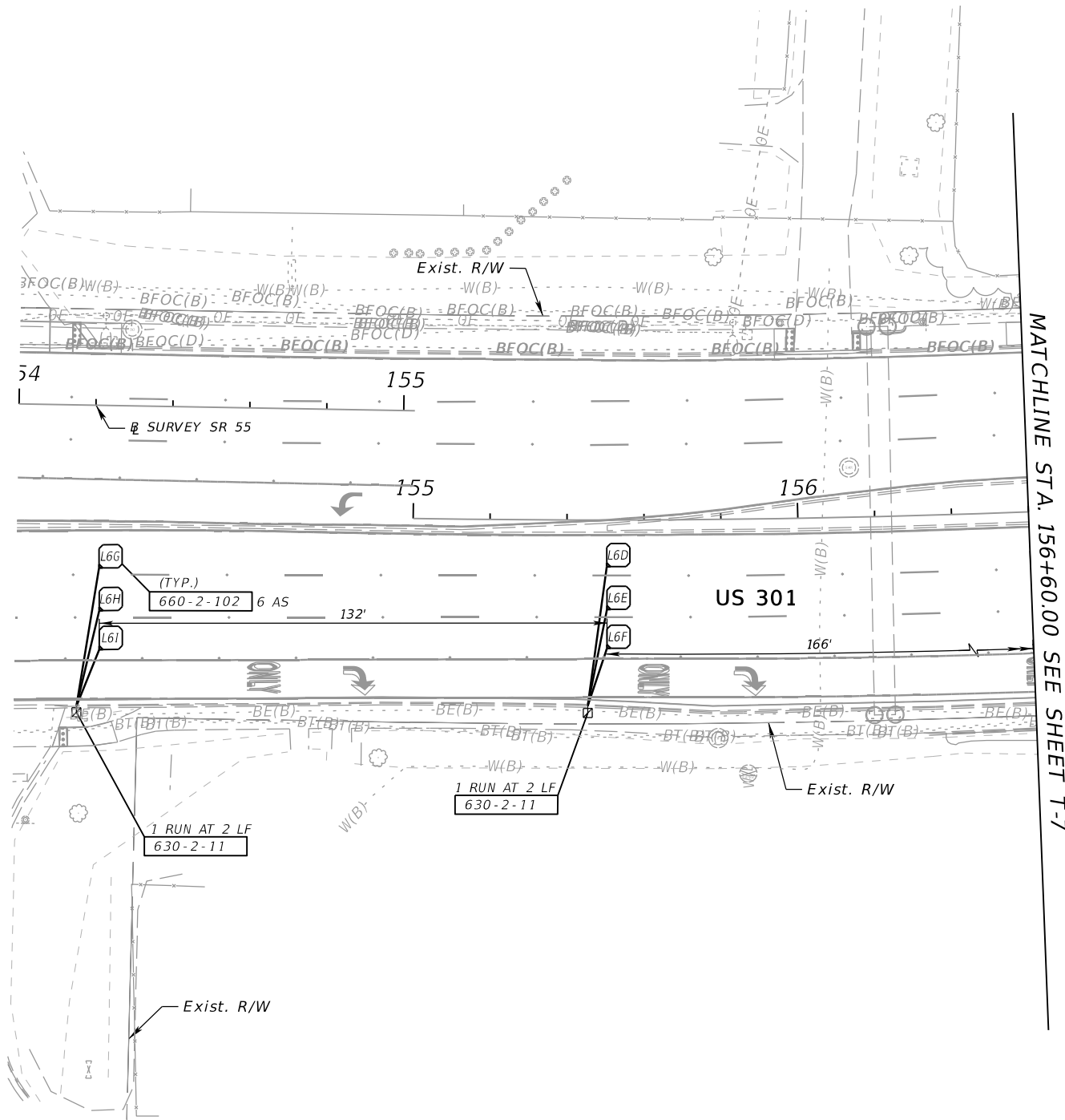

9/30/2024 5:34:13 PM USER: craig.gregory c:\pw\workdir\patel@greene-pw-01\pw_user\dms13899\PLAN502.dgn

REVISIONS		REVISIONS	
DATE	DESCRIPTION	DATE	DESCRIPTION

ENGINEER OF RECORD
 SUJEEVA A. WEERASURIYA, P.E.
 LICENSE NUMBER: 57629
 PATEL, GREENE & ASSOCIATES, LLC
 12570 TELECOM DRIVE
 TEMPLE TERRACE, FL 33637

STATE OF FLORIDA DEPARTMENT OF TRANSPORTATION		
ROAD NO.	COUNTY	FINANCIAL PROJECT ID
SR 55	MANATEE	447379-1-52-01

SIGNALIZATION PLANS

SHEET NO.
T-8

THE OFFICIAL RECORD OF THIS SHEET IS THE ELECTRONIC FILE DIGITALLY SIGNED AND SEALED UNDER RULE 61G15-23.004, F.A.C.

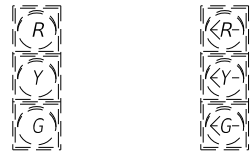

EXISTING TO REMAIN
[2][4][6]
EXISTING TO REMAIN
[1][7]

SIGN DETAILS
1ST ST / US 301 SP1
EXISTING TO REMAIN
MANATEE AVE SP4
EXISTING TO REMAIN

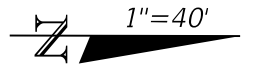
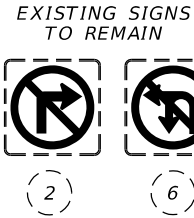

NOTES:

- MAJOR STREET IS US 301, MOVEMENTS 2 AND 6
MINOR STREET IS MANATEE AVE, MOVEMENT 4
- POSTED SPEEDS: US 301 = 45 MPH; MANATEE AVE = 30 MPH
- WESTBOUND TYPE "F" LOOPS ARE EXISTING TO REMAIN.
NORTHBOUND TYPE "F" LOOPS SHALL BE 6'X40' AND PLACED 2' IN FRONT OF THE STOP BAR.
ALL TYPE "B" LOOPS SHALL BE 6'X6' AND PLACED 40' BEHIND THE STOP BAR.
- REQUEST UPDATED SIGNAL TIMINGS FROM FDOT TSM&O ENGINEER - ARTERIALS (863-519-2216) WHEN ALL LANES, STRIPING, SIGNALS AND PEDESTRIAN FACILITIES ARE IN THEIR FINAL CONFIGURATION AND THE SIGNAL IS OPERATING AS DESIGNED. PROVIDE FDOT WITH ALL 'AS-BUILT' INFORMATION NECESSARY TO DEVELOP THE BASIC SIGNAL TIMING PARAMETERS AND ALLOW THREE (3) WEEKS FOLLOWING THE REQUEST FOR FDOT TO DEVELOP THE UPDATED TIMINGS. PROGRAM THE CONTROLLER PER THE TIMINGS PROVIDED BY FDOT.
- WHEN SIGNAL IS IN FLASHING MODE, MOVEMENTS 2 AND 6 SHALL FLASH YELLOW. ALL OTHER VEHICLE MOVEMENTS SHALL FLASH RED.
- CONTROLLER, MAST ARMS, PEDESTRIAN SIGNALS AND PEDESTRIAN DETECTORS ARE EXISTING TO REMAIN.
- FOR RECONNECTION OF LOOP LEAD-INS FOR STOP BAR LOOPS, UTILIZE EXISTING PULL BOXES AND CONDUITS FOR HOME RUN BACK TO THE EXISTING CONTROLLER. PROJECT 444807-1 TO ADD RADAR DETECTION FOR STOP BAR AND MULTIPLE POINT DETECTION.

CONTROLLER TIMINGS								
MOVEMENT NUMBER	1	2	3	4	5	6	7	8
DIRECTION	NBLT	SB		WB		NB	WBLT	PED
TURN TYPE	PROT						PROT	
MINIMUM GREEN	5	10		7		10	5	7
EXTENSION	3.0	5.0		3.0		5.0	3.0	
MAX I	40	110		55		155	35	20
MAX II	45	110		65		145	30	45
MAX LIMIT								
YELLOW CLEARANCE	4.9	4.9		4.1		4.9	4.1	4.1
ALL RED	2.0	2.0		2.0		2.0	2.0	2.0
WALK		7		7		7		7
FLASHING DON'T WALK		9		26		16		27
DET. MEMORY								
DET. CROSS SWITCH								
DUAL ENTRY		ON		ON		ON	ON	
RECALL		MIN				MIN		
REST IN WALK								

DETECTORS FOR LOOPS				
LOOP	NO. OF LOOPS	NO. OF NEW DETS.	NO. OF EXIST. DETS.	DELAY TIME (SEC)
L-1A	1	N/A	1	
L-1B	1	N/A	1	
L-6A	1	N/A	1	
L-6B	1	N/A </td <td>1</td> <td></td>	1	
L-4A	1	N/A	1	
L-4B	1	N/A	1	
L-7A	1	N/A	1	
L-7B	1	N/A	1	
L-2A	1	N/A	1	
L-2B	1	N/A	1	
L-2C	1	N/A	1	

DELAY TIME IS INITIAL AND MAY REQUIRE FIELD ADJUSTING AS DIRECTED BY PROJECT ENGINEER.

EXISTING S.O.P.

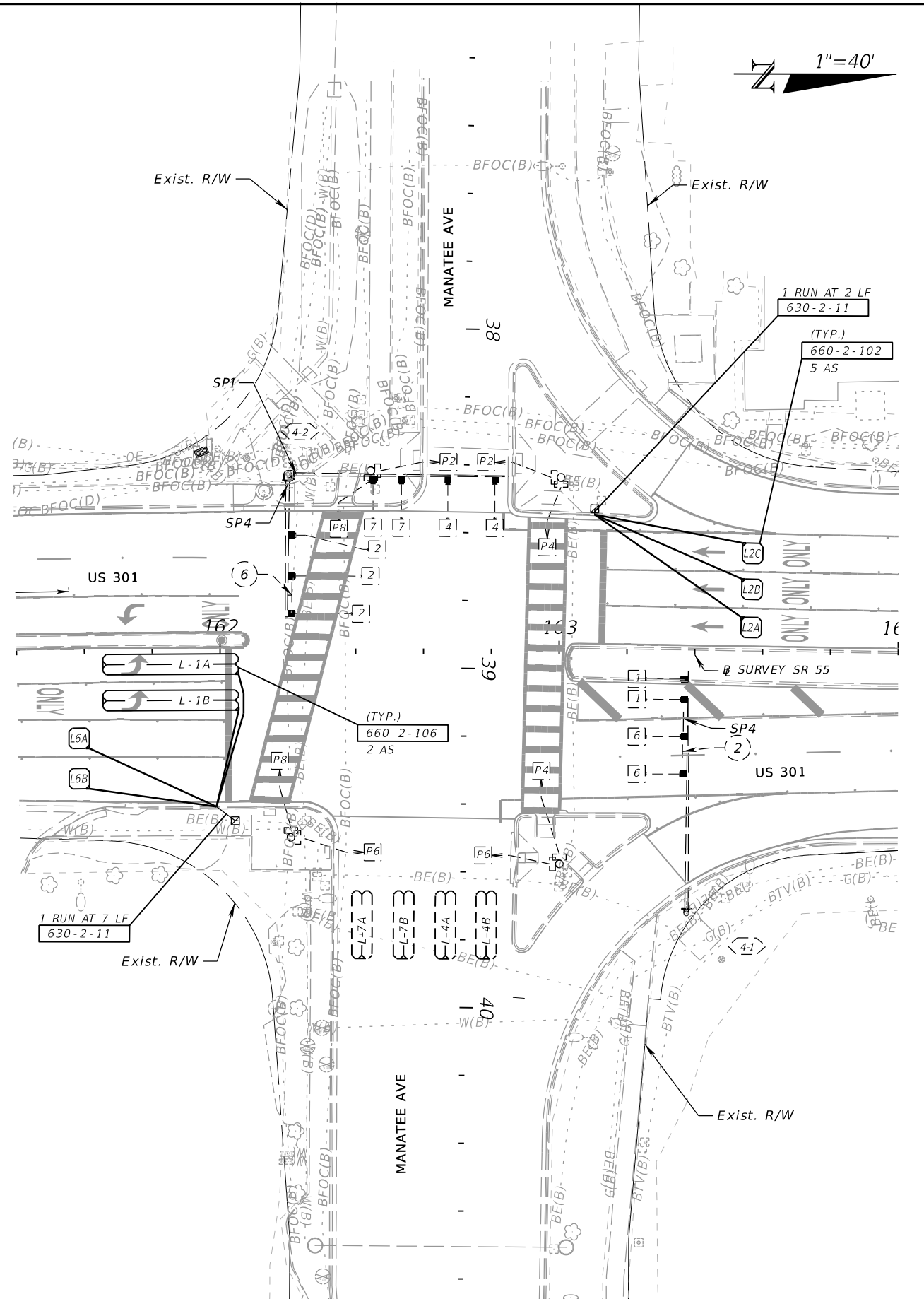
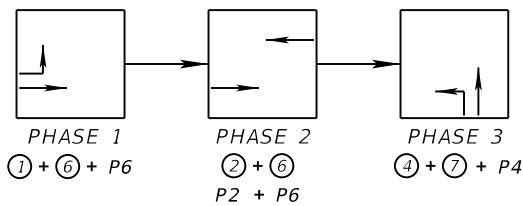

9/30/2024 5:34:26 PM USER: craig.gregory c:\pwworkdir\patel@greene-pw-01\pwworkdir\dm13699\PLAN5001.dgn

REVISIONS		ENGINEER OF RECORD	
DATE	DESCRIPTION	DATE	DESCRIPTION
			SUJEEVA A. WEERASURIYA, P.E. LICENSE NUMBER: 57629 PATEL, GREENE & ASSOCIATES, LLC 12570 TELECOM DRIVE TEMPLE TERRACE, FL 33637

STATE OF FLORIDA DEPARTMENT OF TRANSPORTATION		
ROAD NO.	COUNTY	FINANCIAL PROJECT ID
SR 55	MANATEE	447379-1-52-01

SIGNALIZATION PLANS

SHEET NO.
T-9

THE OFFICIAL RECORD OF THIS SHEET IS THE ELECTRONIC FILE DIGITALLY SIGNED AND SEALED UNDER RULE 61G15-23.004, F.A.C.

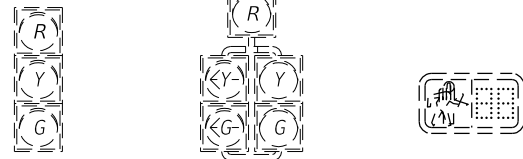

EXISTING TO REMAIN
 [2] [4] [6] [2] [5] [4] [4R] [6] [6R] [P4] [P6]

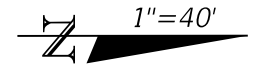
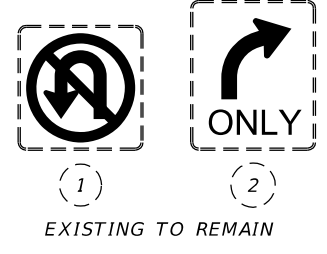
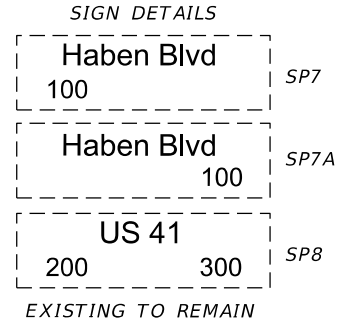

- NOTES:**
- MAJOR STREET IS US 301, MOVEMENTS 2 AND 6 MINOR STREET IS HABEN BLVD., MOVEMENT 4
 - POSTED SPEEDS:
 US 301 = 50 MPH
 HABEN BLVD. = 35 MPH
 - REQUEST UPDATED SIGNAL TIMINGS FROM FDOT TSM&O ENGINEER - ARTERIALS (863-519-2216) WHEN ALL LANES, STRIPING, SIGNALS AND PEDESTRIAN FACILITIES ARE IN THEIR FINAL CONFIGURATION AND THE SIGNAL IS OPERATING AS DESIGNED. PROVIDE FDOT WITH ALL 'AS-BUILT' INFORMATION NECESSARY TO DEVELOP THE BASIC SIGNAL TIMING PARAMETERS AND ALLOW THREE (3) WEEKS FOLLOWING THE REQUEST FOR FDOT TO DEVELOP THE UPDATED TIMINGS. PROGRAM THE CONTROLLER PER THE TIMINGS PROVIDED BY FDOT.
 - WHEN SIGNAL IS IN FLASHING MODE, MOVEMENTS 2 AND 6 SHALL FLASH YELLOW. ALL OTHER VEHICLE MOVEMENTS SHALL FLASH RED. FLASH THE 5-SECTION HEADS AS THE SAME COLOR AS THE ADJACENT THROUGH LANE.
 - EXISTING STOP BAR VIDEO DETECTION SHALL REMAIN.
 - CONTROLLER, MAST ARMS, PEDESTRIAN SIGNALS AND PEDESTRIAN DETECTORS ARE EXISTING TO REMAIN.
 - STOP BAR VEHICLE DETECTION IS CONTROLLED BY VIDEO DETECTION. MULTIPLE POINT DETECTION ZONE LOOPS TO UTILIZE NEW PULL BOX AND CONDUITS FOR HOME RUN BACK TO THE EXISTING CONTROLLER.

CONTROLLER TIMINGS								
MOVEMENT NUMBER	1	2	3	4	5	6	7	8
DIRECTION		SB		WBL	SBL	NB		
TURN TYPE					PROT/PERM			
MINIMUM GREEN		15		7	5	15		
EXTENSION		5.0		3.0	3.0	5.0		
MAX I		90		40	15	90		
MAX II		250		50	20	250		
MAX LIMIT								
YELLOW CLEARANCE		5.1		4.0	5.1	5.1		
ALL RED		3.0		2.0	3.0	3.0		
WALK		7		7		7		
FLASHING DON'T WALK				27		27		
DET. MEMORY				ON				
DET. CROSS SWITCH					Ø 2			
DUAL ENTRY		ON				ON		
RECALL		MAX				MAX		
REST IN WALK								

EXISTING VIDEO VEHICLE DETECTION ASSIGNMENTS			
CAMERA DETECTOR	DETECTION ZONE	MOVEMENT	DELAY TIME (SECS.)
CD1	DZ 6A	6	
	DZ 6B	6	
	DZ 6C	6	
CD2	DZ 5	5	
	DZ 2A	2	
	DZ 2B	2	
CD3	DZ 4A	4	
	DZ 4B	4	
	DZ 4R	4	8

DELAY TIME IS INITIAL AND MAY REQUIRE FIELD ADJUSTING AS DIRECTED BY THE ENGINEER.

DETECTORS FOR LOOPS				
LOOP	NO. OF LOOPS	NO. OF NEW DETS.	NO. OF EXIST. DETS.	DELAY TIME (SEC)
L-6C	1			
L-6D	1	1	N/A	
L-6E	1			
L-6F	1	1	N/A	
L-2C	1			
L-2D	1	1	N/A	
L-2E	1			
L-2F	1	1	N/A	

DELAY TIME IS INITIAL AND MAY REQUIRE FIELD ADJUSTING AS DIRECTED BY PROJECT ENGINEER.

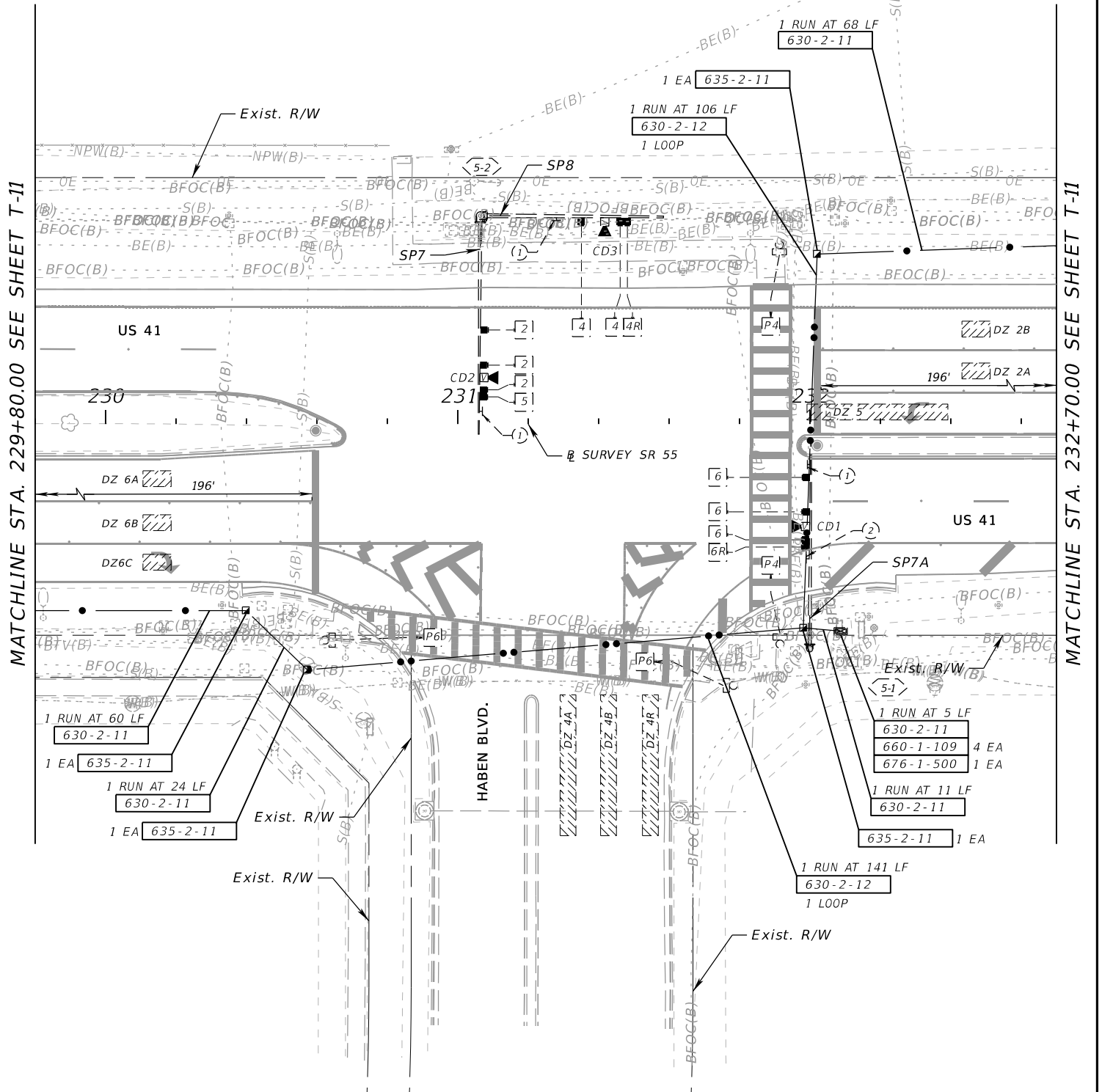
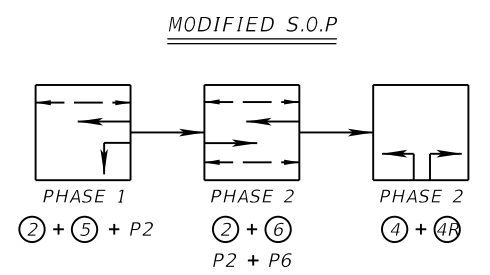

MATCHLINE STA. 229+80.00 SEE SHEET T-11

MATCHLINE STA. 232+70.00 SEE SHEET T-11

9/30/2024 5:34:27 PM USER: craig.gregory c:\pwworkdir\patel@greene-pw-01.pw_user\dmis13899\PLAN\SG01.dgn

THE OFFICIAL RECORD OF THIS SHEET IS THE ELECTRONIC FILE DIGITALLY SIGNED AND SEALED UNDER RULE 61G15-23.004, F.A.C.

REVISIONS				ENGINEER OF RECORD		STATE OF FLORIDA DEPARTMENT OF TRANSPORTATION			SHEET NO.
DATE	DESCRIPTION	DATE	DESCRIPTION			ROAD NO.	COUNTY	FINANCIAL PROJECT ID	
				SUJEEVA A. WEERASURIYA, P.E. LICENSE NUMBER: 57629 PATEL, GREENE & ASSOCIATES, LLC 12570 TELECOM DRIVE TEMPLE TERRACE, FL 33637		SR 55	MANATEE	447379-1-52-01	T-10

SIGNALIZATION PLANS

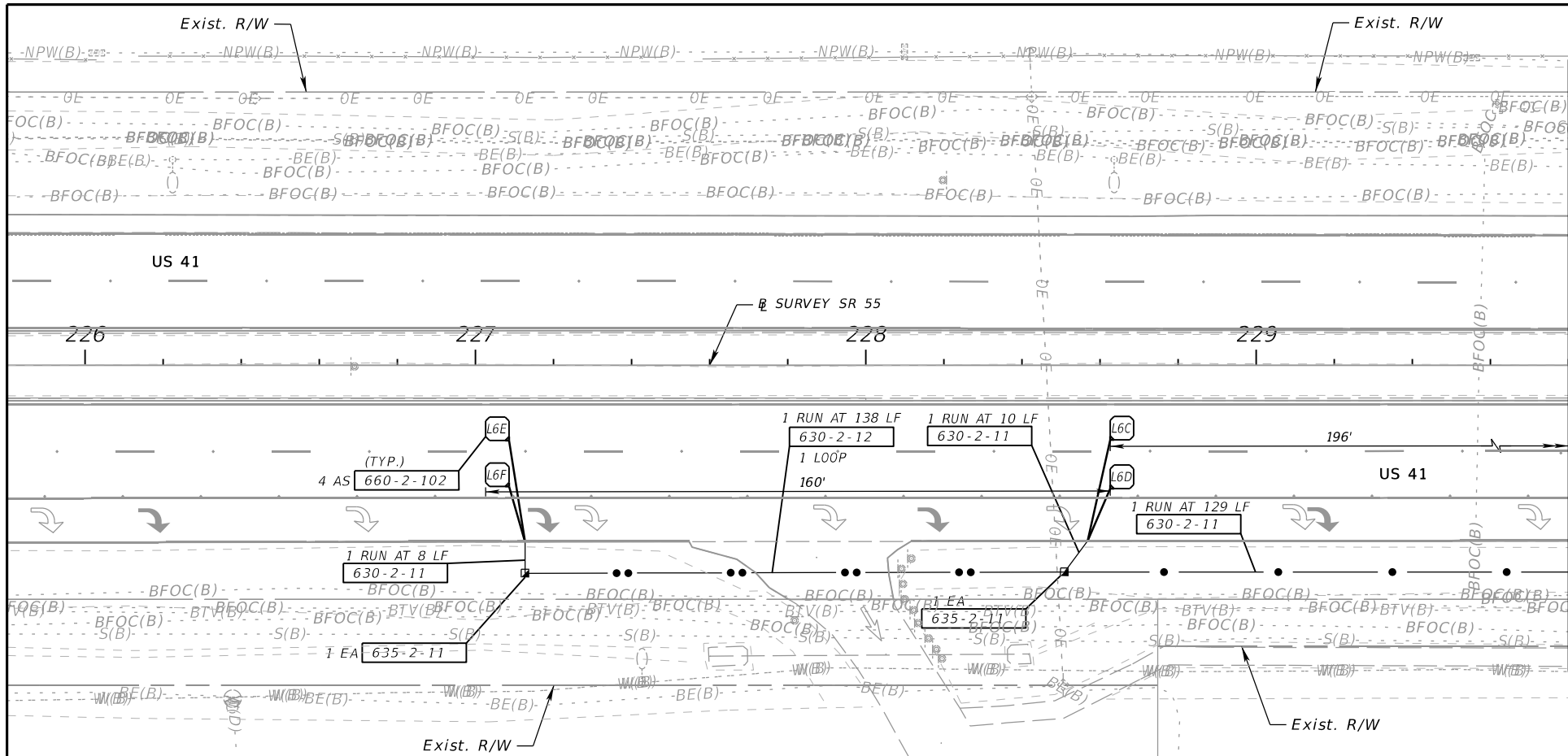
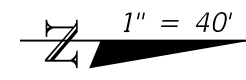

MATCHLINE STA. 229+80.00 SEE SHEET T-10

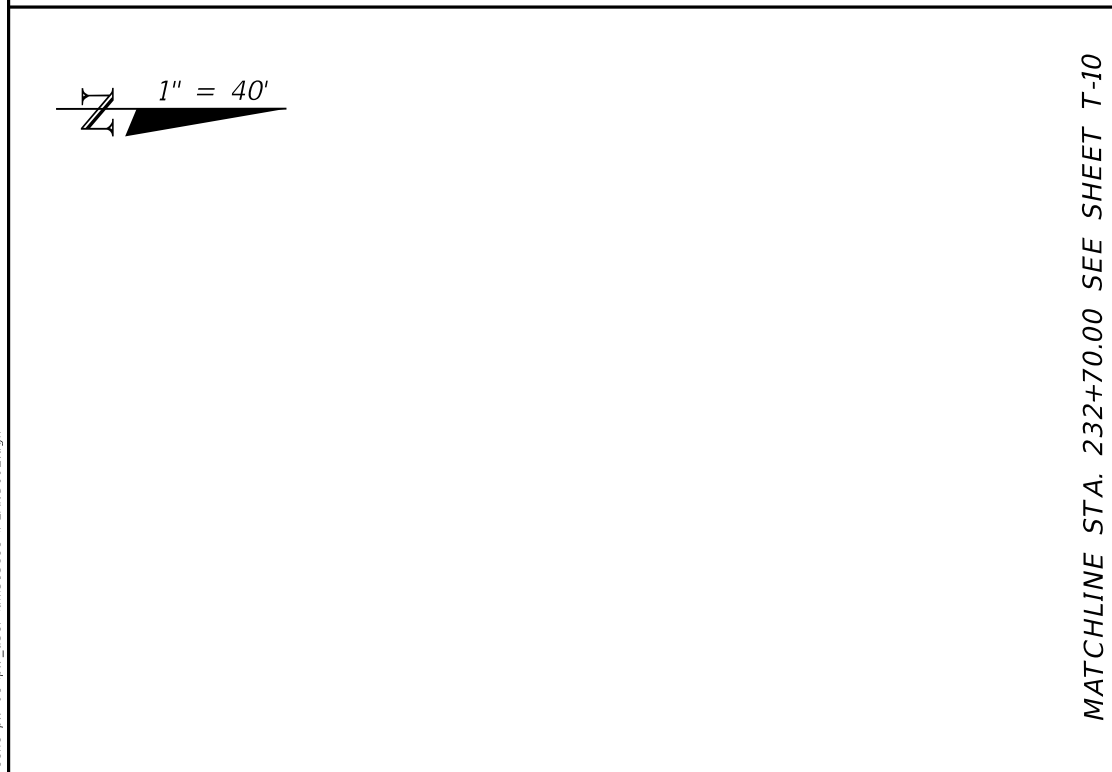

MATCHLINE STA. 232+70.00 SEE SHEET T-10

REVISIONS			
DATE	DESCRIPTION	DATE	DESCRIPTION

ENGINEER OF RECORD
 SUJEEVA A. WEERASURIYA, P.E.
 LICENSE NUMBER: 57629
 PATEL, GREENE & ASSOCIATES, LLC
 12570 TELECOM DRIVE
 TEMPLE TERRACE, FL 33637

STATE OF FLORIDA DEPARTMENT OF TRANSPORTATION		
ROAD NO.	COUNTY	FINANCIAL PROJECT ID
SR 55	MANATEE	447379-1-52-01

SIGNALIZATION PLANS

SHEET NO.
T-11

9/30/2024 5:34:40 PM USER: craig.gregory
 c:\pw\workdir\patel@greene-pw-01\pw_user\dmis13899\PLAN5602.dgn

THE OFFICIAL RECORD OF THIS SHEET IS THE ELECTRONIC FILE DIGITALLY SIGNED AND SEALED UNDER RULE 61G15-23.004, F.A.C.

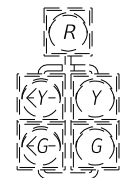

EXISTING TO REMAIN
[1] [6] [2] [5] [3] [8] [4] [7]

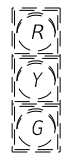

EXISTING TO REMAIN
[2] [4] [6] [8]

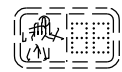

EXISTING TO REMAIN

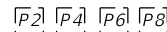

SIGN DETAILS

17th St E

SP8

EXISTING TO REMAIN

US 41

SP6

EXISTING TO REMAIN

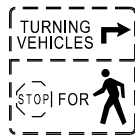

(1)

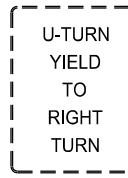

(2)

EXISTING TO REMAIN

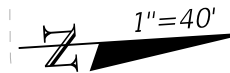

NOTES:

- MAJOR STREET IS US 301, MOVEMENTS 2 AND 6
MINOR STREET IS 17TH AVE., MOVEMENTS 8
- POSTED SPEEDS: US 301 = 50 MPH; 17TH AVE. = 30 MPH
- ALL TYPE "F" LOOPS SHALL BE 6'X40' AND PLACED 2' IN FRONT OF THE STOP BAR.
ALL TYPE "B" LOOPS SHALL BE 6'X6' AND PLACED 40' BEHIND THE STOP BAR.
- REQUEST UPDATED SIGNAL TIMINGS FROM FDOT TSM&O ENGINEER - ARTERIALS (863-519-2216) WHEN ALL LANES, STRIPING, SIGNALS AND PEDESTRIAN FACILITIES ARE IN THEIR FINAL CONFIGURATION AND THE SIGNAL IS OPERATING AS DESIGNED. PROVIDE FDOT WITH ALL "AS-BUILT" INFORMATION NECESSARY TO DEVELOP THE BASIC SIGNAL TIMING PARAMETERS AND ALLOW THREE (3) WEEKS FOLLOWING THE REQUEST FOR FDOT TO DEVELOP THE UPDATED TIMINGS. PROGRAM THE CONTROLLER PER THE TIMINGS PROVIDED BY FDOT.
- WHEN SIGNAL IS IN FLASHING MODE, MOVEMENTS 2 AND 6 SHALL FLASH YELLOW. ALL OTHER VEHICLE MOVEMENTS SHALL FLASH RED. FLASH THE 5-SECTION HEADS AS THE SAME COLOR AS THE ADJACENT THROUGH LANE.
- EXISTING MULTIPLE POINT RADAR DETECTION SHALL REMAIN. FOR RECONNECTION OF LOOP LEAD-INS FOR STOP BAR LOOPS UTILIZE EXISTING PULL BOXES AND CONDUITS FOR HOME RUN BACK TO THE EXISTING CONTROLLER.
- CONTROLLER, MAST ARMS, PEDESTRIAN SIGNALS AND PEDESTRIAN DETECTORS ARE EXISTING TO REMAIN.

NOTE TO REVIEWER:
FOR THE WEST LEG OF 17TH ST. E., CURRENT TOPOGRAPHY AND AERIAL IMAGERY ARE NOT AVAILABLE FOR PHASE 4 SUBMITTAL. ACTIONS ARE IN PROGRESS TO OBTAIN THE LATEST TOPOGRAPHY TO BE SHOWN FOR FINAL SUBMITTAL.

CONTROLLER TIMINGS								
MOVEMENT NUMBER	1	2	3	4	5	6	7	8
DIRECTION	NBL	SB	EBL	WB	SBL	NB	WBL	EB
TURN TYPE	PROT/PERM		PROT/PERM		PROT/PERM		PROT/PERM	
MINIMUM GREEN	5	15	5	7	5	15	5	7
EXTENSION	3.0	5.0	3.0	3.0	3.0	5.0	3.0	3.0
MAX I	15	60	15	20	15	60	15	20
MAX II	30	120	25	50	30	120	30	50
MAX LIMIT								
YELLOW CLEARANCE	5.1	5.1	3.7	4.4	5.1	5.1	4.4	4.4
ALL RED	2.0	2.5	3.3	3.3	2.5	2.5	2.6	3.3
WALK		10		10		10		10
FLASHING DON'T WALK		18		25		24		30
DET. MEMORY								
DET. CROSS SWITCH	Ø6		Ø8		Ø2		Ø4	
DUAL ENTRY		ON				ON		
RECALL		MIN				MIN		
REST IN WALK								

DETECTORS FOR LOOPS				
LOOP	NO. OF LOOPS	NO. OF NEW DETS.	NO. OF EXIST. DETS.	DELAY TIME (SEC)
L-1	1			
L-5	1	N/A	1	
L-6A	1	N/A	1	
L-6B	1	N/A	1	
L-2A	1			
L-2B	1	N/A	1	
L-3	1	N/A	1	3
L-8	1	N/A	1	
L-4	1	N/A	1	
L-7	1	N/A	1	3
L-4D	1	N/A	1	8
L-8R	1	N/A	1	

DELAY TIME IS INITIAL AND MAY REQUIRE FIELD ADJUSTING AS DIRECTED BY PROJECT ENGINEER.

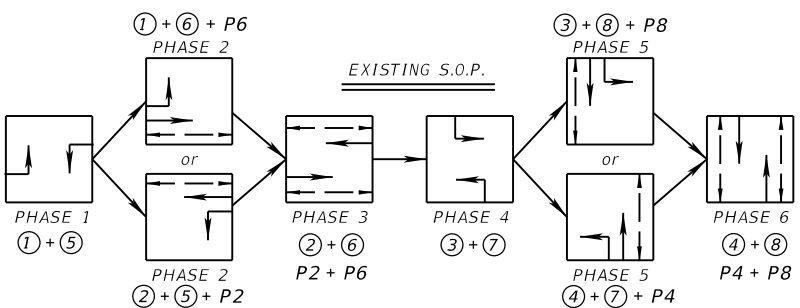
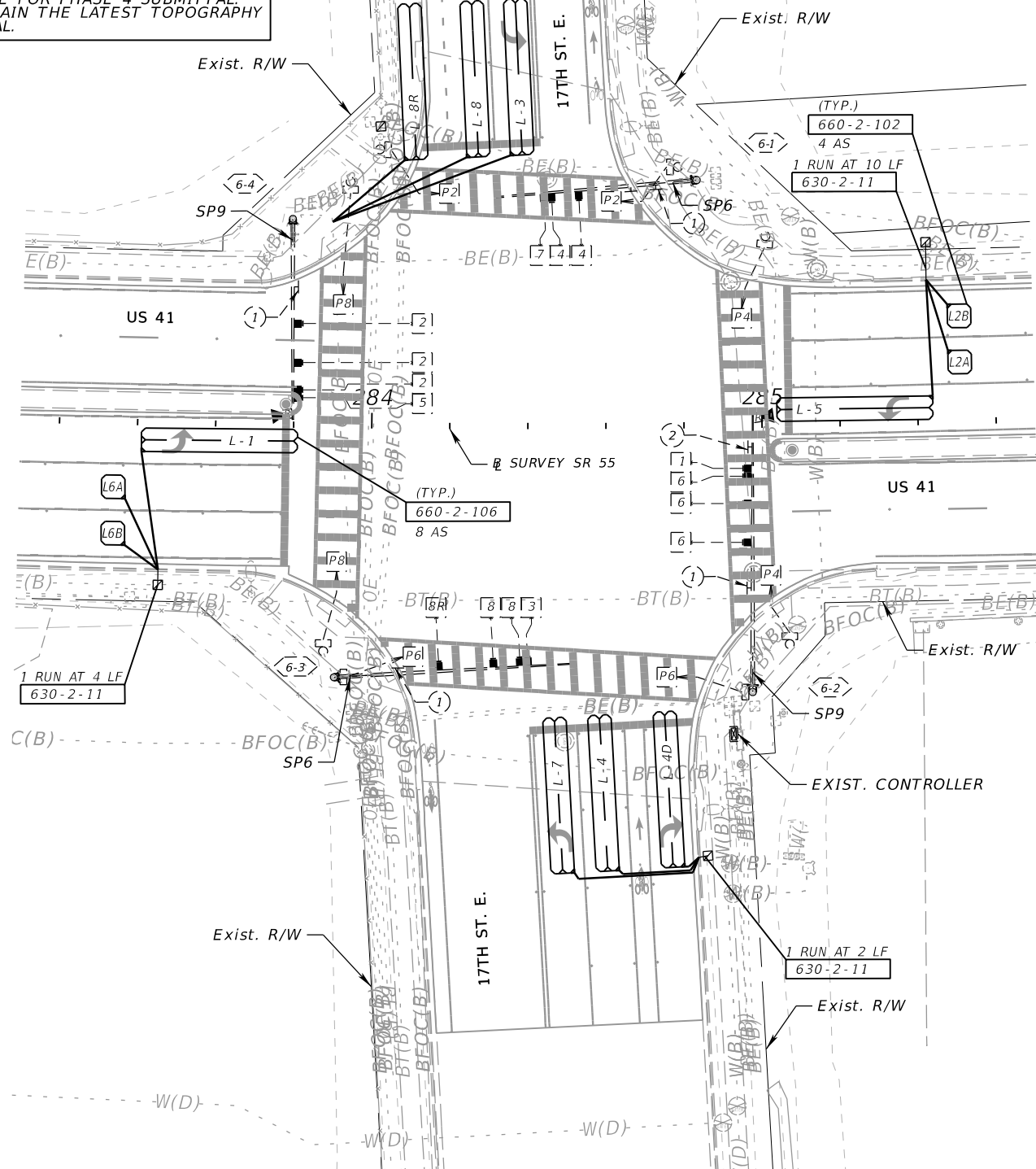

9/30/2024 5:34:54 PM USER: craig.gregory c:\pwworkdir\patelgreene-pw-01\pwworkdir\13899\PLAN501.dgn

REVISIONS				S.O.P. ENGINEER OF RECORD		STATE OF FLORIDA DEPARTMENT OF TRANSPORTATION			SHEET NO.
DATE	DESCRIPTION	DATE	DESCRIPTION	SUJEEVA A. WEERASURIYA, P.E. LICENSE NUMBER: 57629 PATEL, GREENE & ASSOCIATES, LLC 12570 TELECOM DRIVE TEMPLE TERRACE, FL 33637		ROAD NO.	COUNTY	FINANCIAL PROJECT ID	
						SR 55	MANATEE	447379-1-52-01	T-12

SIGNALIZATION PLANS

THE OFFICIAL RECORD OF THIS SHEET IS THE ELECTRONIC FILE DIGITALLY SIGNED AND SEALED UNDER RULE 61G15-23.004, F.A.C.

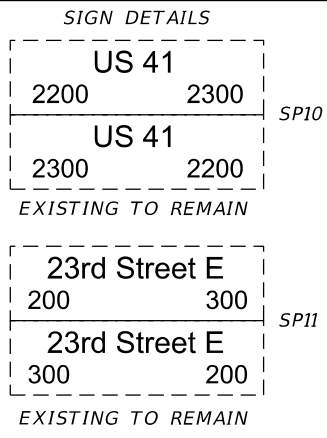
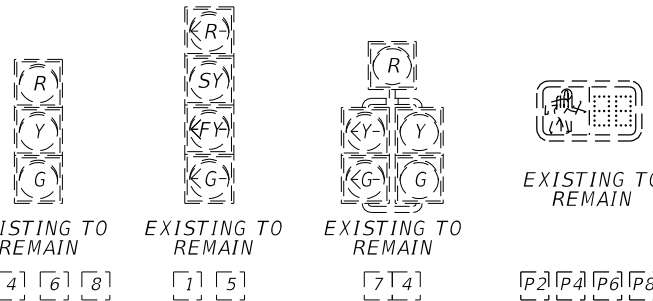

- NOTES:**
- MAJOR STREET IS US 301, MOVEMENTS 2 AND 6
MINOR STREET IS 23RD ST. E., MOVEMENTS 4 AND 8
 - POSTED SPEEDS: US 301 = 50 MPH; 23RD ST. E. = 25 MPH
 - REQUEST UPDATED SIGNAL TIMINGS FROM FDOT TSM&O ENGINEER - ARTERIALS (863-519-2216) WHEN ALL LANES, STRIPING, SIGNALS AND PEDESTRIAN FACILITIES ARE IN THEIR FINAL CONFIGURATION AND THE SIGNAL IS OPERATING AS DESIGNED. PROVIDE FDOT WITH ALL 'AS-BUILT' INFORMATION NECESSARY TO DEVELOP THE BASIC SIGNAL TIMING PARAMETERS AND ALLOW THREE (3) WEEKS FOLLOWING THE REQUEST FOR FDOT TO DEVELOP THE UPDATED TIMINGS. PROGRAM THE CONTROLLER PER THE TIMINGS PROVIDED BY FDOT.
 - WHEN SIGNAL IS IN FLASHING MODE, MOVEMENTS 2 AND 6 SHALL FLASH YELLOW. ALL OTHER VEHICLE MOVEMENTS SHALL FLASH RED. FLASH THE 5-SECTION HEADS AS THE SAME COLOR AS THE ADJACENT THROUGH LANE.
 - STOP BAR VEHICLE DETECTION IS CONTROLLED BY VIDEO DETECTION. MULTIPLE POINT DETECTION ZONE LOOPS TO UTILIZE NEW PULL BOX AND CONDUITS FOR HOME RUN BACK TO THE EXISTING CONTROLLER.
 - CONTROLLER, MAST ARMS, PEDESTRIAN SIGNALS AND PEDESTRIAN DETECTORS ARE EXISTING TO REMAIN.

CONTROLLER TIMINGS

MOVEMENT NUMBER	1	2	3	4	5	6	7	8
DIRECTION	NBL	SB	WB	SBL	NB	WBL	EB	
TURN TYPE	PROT/PERM			PROT/PERM		PROT/PERM		
MINIMUM GREEN	5	15	7	5	15	5	7	
EXTENSION	3.0	5.0	3.0	3.0	5.0	3.0	3.0	
MAX I	20	60	20	20	60	15	20	
MAX II	30	150	45	30	150	30	50	
MAX LIMIT								
YELLOW CLEARANCE	5.2	5.2	3.4	5.2	5.2	4.4	4.4	
ALL RED	3.9	3.9	2.9	3.9	3.9	2.6	3.3	
WALK		7	7		7		10	
FLASHING DON'T WALK		13	24		18		30	
DET. MEMORY								
DET. CROSS SWITCH							Ø 4	
DUAL ENTRY		ON	ON		ON		ON	
RECALL		MIN			MIN			
REST IN WALK								

EXISTING VIDEO VEHICLE DETECTION ASSIGNMENTS

CAMERA DETECTOR	DETECTION ZONE	MOVEMENT	DELAY TIME (SECS.)
CD1	DZ 1	6	
	DZ 6A	6	
	DZ 6B	6	
CD2	DZ 5	5	
	DZ 2A	2	
CD3	DZ 3	4	
	DZ 8D	4	8
CD4	DZ 4D	4	8
	DZ 7	4	

DELAY TIME IS INITIAL AND MAY REQUIRE FIELD ADJUSTING AS DIRECTED BY THE ENGINEER.

DETECTORS FOR LOOPS

LOOP	NO. OF LOOPS	NO. OF NEW DETS.	NO. OF EXIST. DETS.	DELAY TIME (SEC)
L-6C	1	1	N/A	
L-6D	1	1	N/A	
L-6E	1	1	N/A	
L-6F	1	1	N/A	
L-2C	1	1	N/A	
L-2D	1	1	N/A	
L-2E	1	1	N/A	
L-2F	1	1	N/A	

DELAY TIME IS INITIAL AND MAY REQUIRE FIELD ADJUSTING AS DIRECTED BY PROJECT ENGINEER.

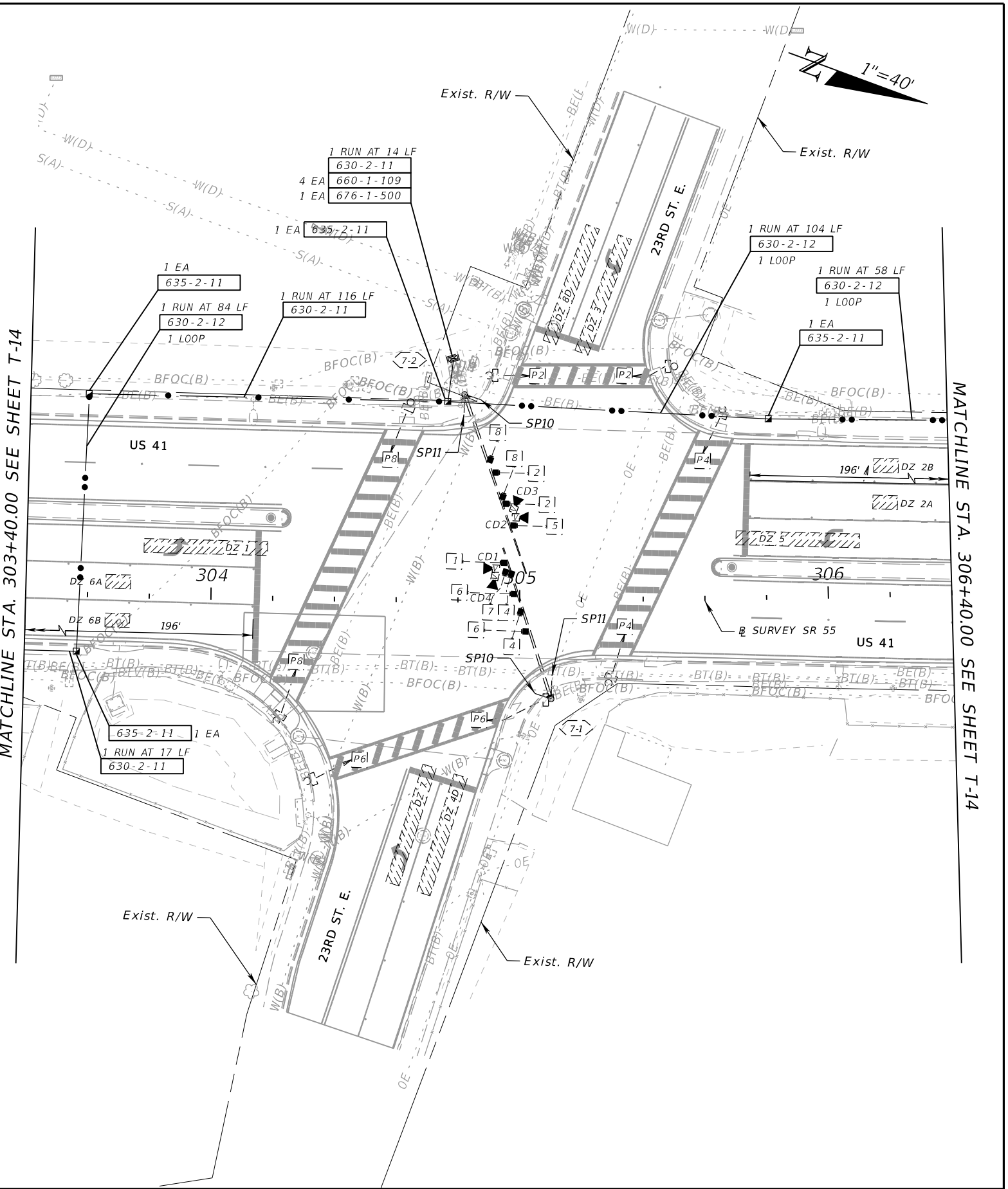
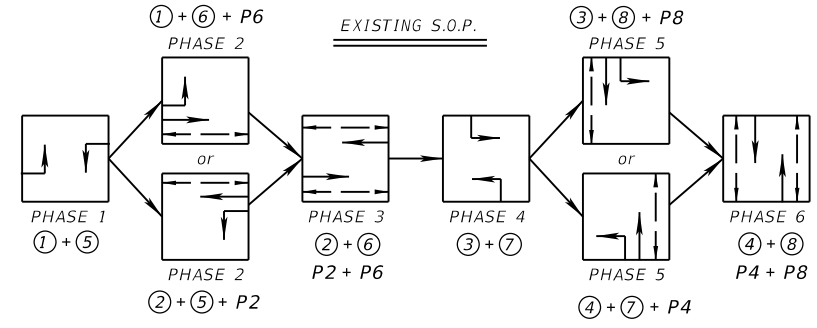

9/30/2024 5:34:55 PM USER: craig.gregory c:\pwworkdir\patelgreene-pw-01\pwworkdir\dmis13899\PLAN5001.dgn

REVISIONS		ENGINEER OF RECORD		STATE OF FLORIDA DEPARTMENT OF TRANSPORTATION			SHEET NO.
DATE	DESCRIPTION	DATE	DESCRIPTION	ROAD NO.	COUNTY	FINANCIAL PROJECT ID	
				SR 55	MANATEE	447379-1-52-01	T-13

SIGNALIZATION PLANS

THE OFFICIAL RECORD OF THIS SHEET IS THE ELECTRONIC FILE DIGITALLY SIGNED AND SEALED UNDER RULE 61G15-23.004, F.A.C.

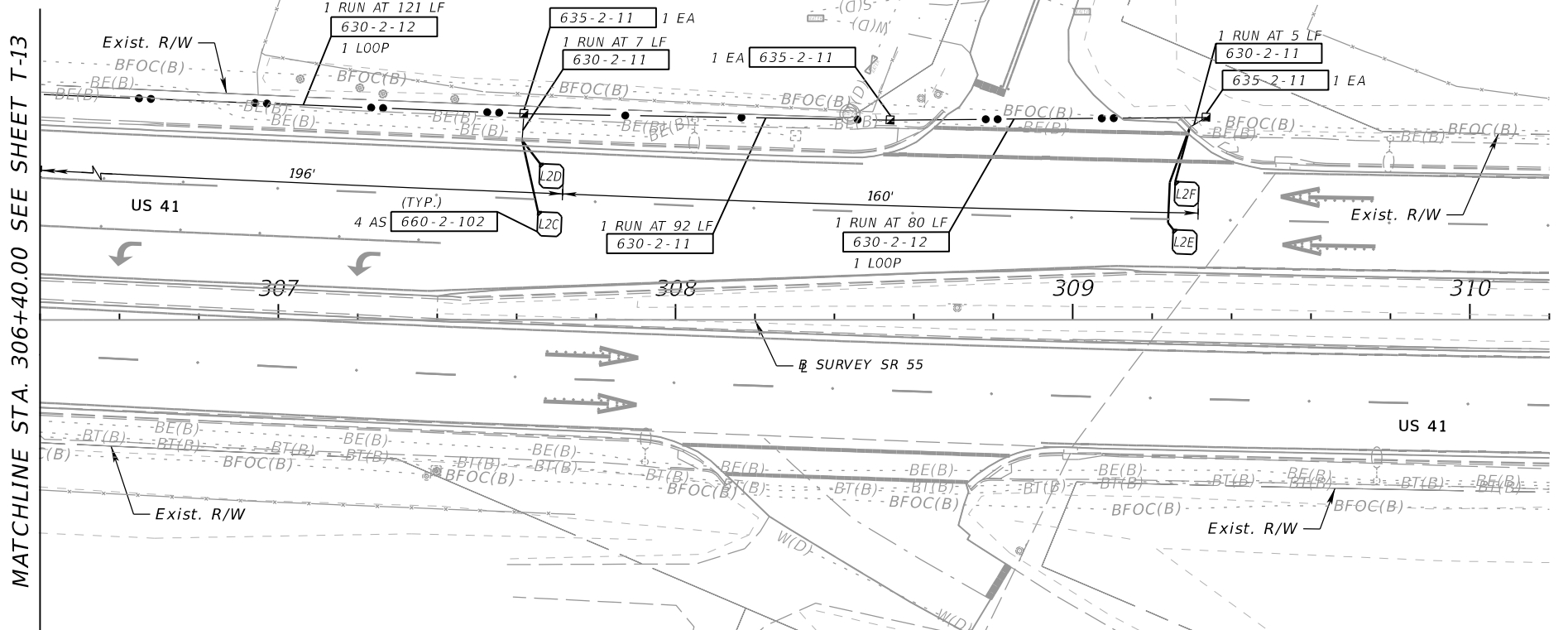
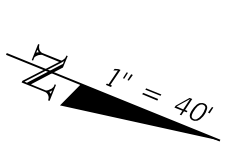
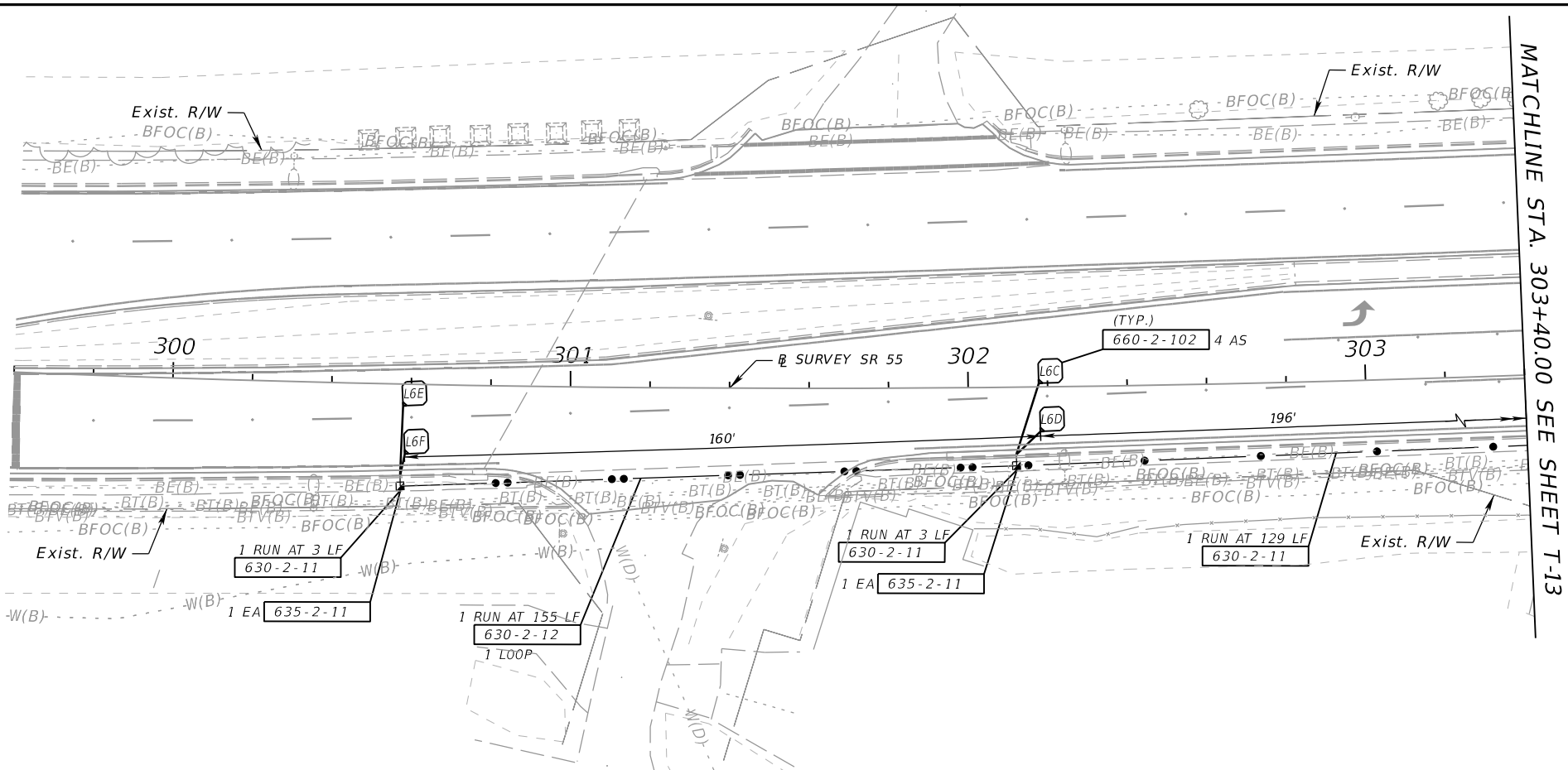
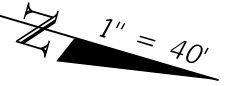

9/30/2024 5:35:09 PM USER: craig.gregory c:\pw_work\kair\patel@greene-pw-01\pw_user\dmis13899\PLAN502.dgn

REVISIONS		ENGINEER OF RECORD		STATE OF FLORIDA DEPARTMENT OF TRANSPORTATION			SHEET NO.
DATE	DESCRIPTION	DATE	DESCRIPTION	ROAD NO.	COUNTY	FINANCIAL PROJECT ID	
				SR 55	MANATEE	447379-1-52-01	T-14

SIGNALIZATION PLANS

THE OFFICIAL RECORD OF THIS SHEET IS THE ELECTRONIC FILE DIGITALLY SIGNED AND SEALED UNDER RULE 61G15-23.004, F.A.C.