

DATE	BY	DESCRIPTION	DATE	BY	DESCRIPTION
176			2827+00		
174			2828+00		
172			2829+00		
170			2830+00		
168			2831+00		
166					
164					
162					

Curve = NB3
 PI STA. = 1826+24.99
 Delta = 65° 53' 35" (RT.)
 D = 9' 00' 00"
 T = 412.58
 L = 732.14
 R = 636.62
 PC STA. 1822+12.41
 PT STA. 1829+44.55
 e = 0.03

Curve = C4
 PI STA. = 826+46.41
 Delta = 65° 53' 35" (RT.)
 D = 8' 00' 00"
 T = 464.16
 L = 823.67
 R = 716.20
 PC STA. 821+82.25
 PT STA. 830+05.92
 e = N/A

Curve = SB6
 PI STA. = 2827+74.83
 Delta = 32° 20' 47" 27" (RT.)
 D = 8' 00' 00.00"
 T = 207.71
 L = 404.33
 R = 716.20
 PC STA. 2825+67.12
 PT STA. 2829+71.45
 e = R.C.

PLAN - PROFILE SOUTHBOUND

STATE OF FLORIDA
 DEPARTMENT OF TRANSPORTATION

ROADWAY ENGINEER OF RECORD:
 EDUARDO A. PONCE, P.E. (56881)
 FLORIDA DEPARTMENT OF TRANSPORTATION
 801 N. BROADWAY AVENUE
 P.O. BOX 1249
 BARTON, FLORIDA 33830-3809/33831-1249

ROAD NO. 600 COUNTY POLK FINANCIAL PROJECT ID 197593-1-52-01

REVISIONS

DATE BY DESCRIPTION

SHEET NO. 58

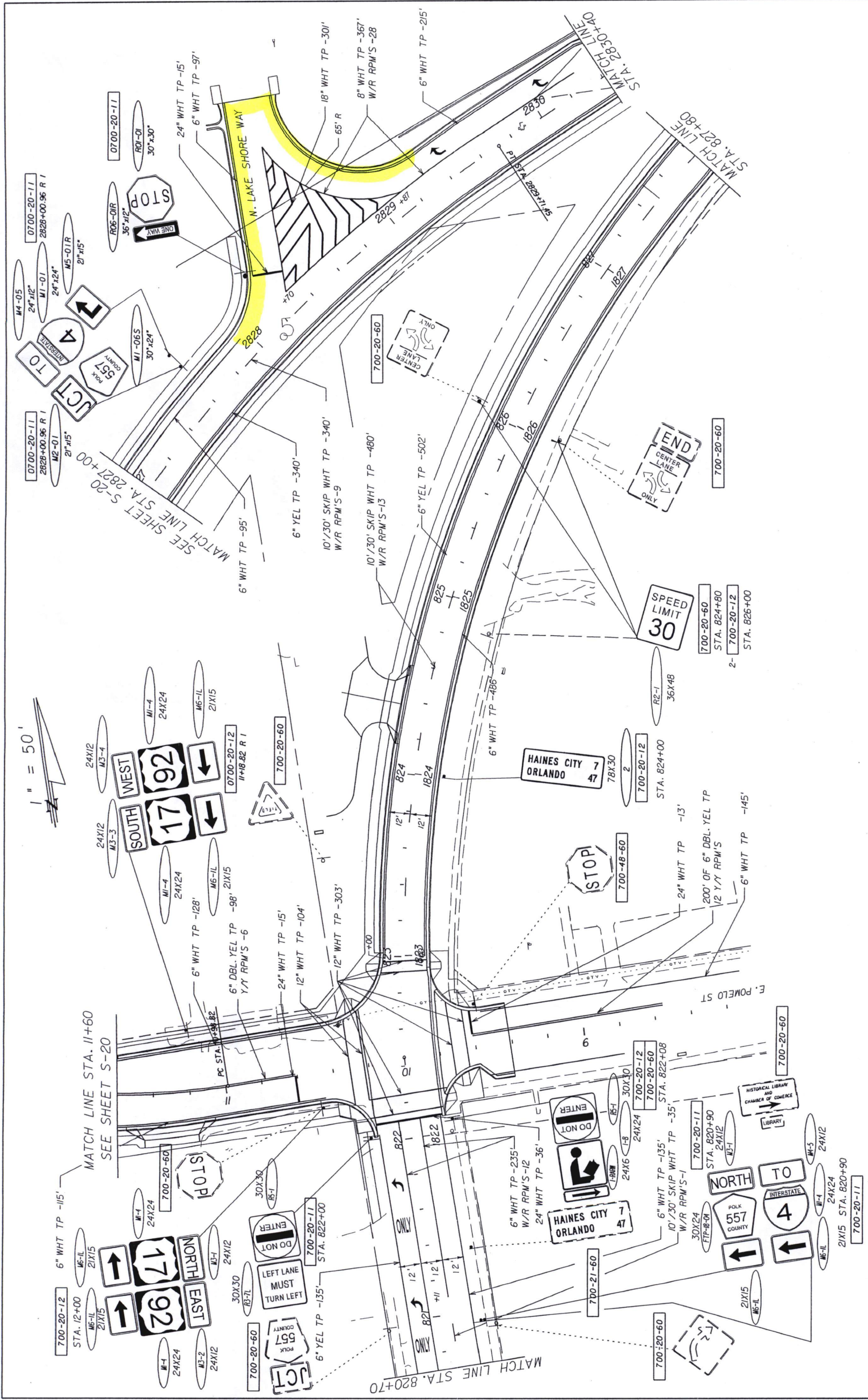

REVISIONS		SIGNING AND MARKING PLANS ENGINEER OF RECORD		STATE OF FLORIDA		SHEET	
DATE	BY	DESCRIPTION	DATE	DESCRIPTION	DEPARTMENT OF TRANSPORTATION	ROAD NO.	NO.
			AMY J. SHAFER, PE 5328	FLORIDA DEPARTMENT OF TRANSPORTATION	600		
			FLORIDA DEPARTMENT OF TRANSPORTATION	DISTRICT 10 OFFICE	COUNTY		
			P.O. BOX 1249	POLK	197593-1-52-01		
			BARTON, FL. 33831-1249	FINANCIAL PROJECT ID			
							S-14

PLAN SHEET
SIGNING & PAVEMENT MARKING

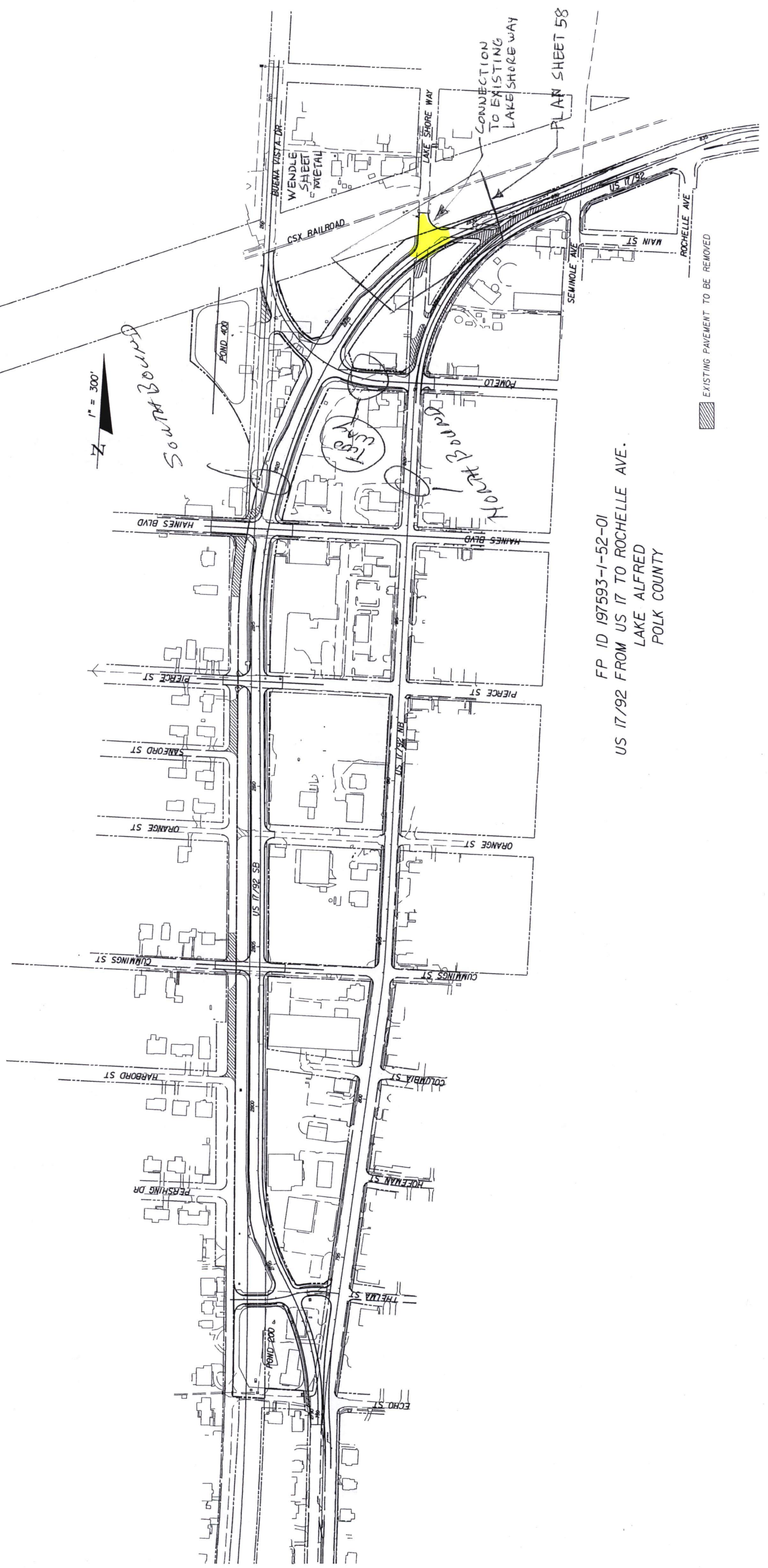

1" = 300'

South Bound

North Bound

CONNECTION TO EXISTING LAKE SHORE WAY

PLAN SHEET 58

FP ID 197593-1-52-01
 US 17/92 FROM US 17 TO ROCHELLE AVE.
 LAKE ALFRED
 POLK COUNTY

EXISTING PAVEMENT TO BE REMOVED