

CONTRACT PLANS COMPONENTS

- ROADWAY
- SIGNING AND PAVEMENT MARKING
- SIGNALIZATION
- INTELLIGENT TRANSPORTATION SYSTEMS
- LIGHTING

STATE OF FLORIDA
DEPARTMENT OF TRANSPORTATION

SIGNALIZATION PLANS

FINANCIAL PROJECT ID 446296-2-52-01

LEE COUNTY (12075)

I-75 (SR 93) AT CR 876 / SR 876 / DANIELS PARKWAY

THIS PROJECT TO BE LET TO
CONTRACT WITH FINANCIAL PROJECT
ID(S): 446296-2-56-01

INDEX OF SIGNALIZATION PLANS

SHEET NO.	SHEET DESCRIPTION
T-1	KEY SHEET
T-2	SIGNATURE SHEET
T-3	GENERAL NOTES
T-4	PROJECT LAYOUT
T-5 - T-12	SIGNALIZATION PLANS
T-13	STANDARD MAST ARM TABULATION
T-14	STANDARD MAST ARM ASSEMBLIES DATA TABLE (NOT INCLUDED)
T-15 - T-16	SPECIAL DETAILS
T-17	GUIDESIGN WORKSHEET
T-18	REPORT OF CORE BORINGS (NOT INCLUDED)

PROJECT LOCATION URL: <https://tinyurl.com/uubsb6pn>

PROJECT LIMITS: BEGIN MP 7.112 - END MP 7.709
BEGIN MP 15.898 - END MP 17.265

EXCEPTIONS: NONE

BRIDGE LIMITS: #120106 MP 16.399 - MP 16.445
#120107 MP 16.399 - MP 16.445

RAILROAD CROSSING: NONE

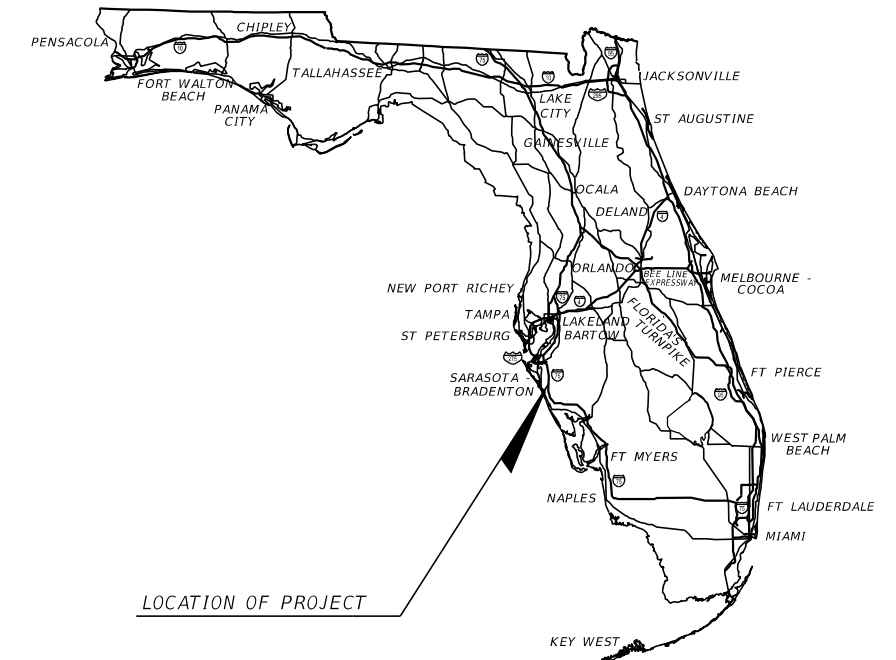

**SIGNALIZATION PLANS
ENGINEER OF RECORD:**

ARTEM A. STRUNNIKOV, P.E.
P.E. LICENSE NUMBER 84785
KIMLEY-HORN AND ASSOCIATES, INC.
2 ALHAMBRA PLAZA, SUITE 500
CORAL GABLES, FLORIDA 33134
CONTRACT NO.: CAG74
VENDOR NO.: F560885615-001

G.E.C. PROJECT MANAGER

MICHAEL VAN DER HEYDEN, P.E.

FDOT PROJECT MANAGER:

KIMBERLY ABATE

CONSTRUCTION CONTRACT NO.	FISCAL YEAR	SHEET NO.
E1W98	25	T-1

GOVERNING STANDARD PLANS:

Florida Department of Transportation, FY2024-25 Standard Plans for Road and Bridge Construction and applicable Interim Revisions (IRs).

Standard Plans for Road Construction and associated IRs are available at the following website: <http://www.fdot.gov/design/standardplans>

APPLICABLE IRs: N/A

Standard Plans for Bridge Construction are included in the Structures Plans Component

GOVERNING STANDARD SPECIFICATIONS:

Florida Department of Transportation, FY2024-25 Standard Specifications for Road and Bridge Construction at the following website: <http://www.fdot.gov/programmanagement/Implemented/SpecBooks>

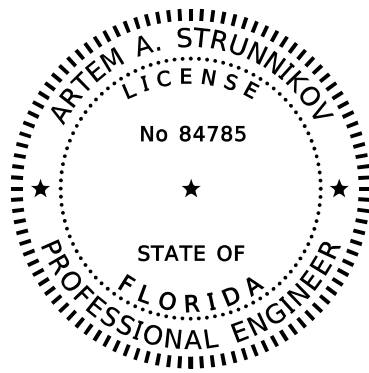

THIS ITEM HAS BEEN DIGITALLY SIGNED AND SEALED BY

ON THE DATE ADJACENT TO THE SEAL

PRINTED COPIES OF THIS DOCUMENT ARE NOT CONSIDERED SIGNED AND SEALED AND THE SIGNATURE MUST BE VERIFIED ON ANY ELECTRONIC COPIES.

KIMLEY-HORN AND ASSOCIATES, INC.
2 ALHAMBRA PLAZA, SUITE 500
CORAL GABLES, FLORIDA 33134
(305) 673-2025
ARTEM A. STRUNNIKOV, P.E. NO. 84785

THE ABOVE NAMED PROFESSIONAL ENGINEER SHALL BE RESPONSIBLE FOR THE FOLLOWING SHEETS IN ACCORDANCE WITH RULE 61G15-23.004, F.A.C.

SHEET DESCRIPTION

- T-1 KEY SHEET
- T-2 SIGNATURE SHEET
- T-3 GENERAL NOTES
- T-4 PROJECT LAYOUT
- T-5 - T-12 SIGNALIZATION PLANS
- T-13 STANDARD MAST ARM TABULATION
- T-15 - T-16 SPECIAL DETAILS
- T-17 GUIDESIGN WORKSHEET

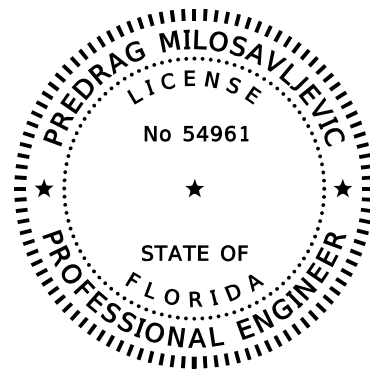

THIS ITEM HAS BEEN DIGITALLY SIGNED AND SEALED BY

ON THE DATE ADJACENT TO THE SEAL

PRINTED COPIES OF THIS DOCUMENT ARE NOT CONSIDERED SIGNED AND SEALED AND THE SIGNATURE MUST BE VERIFIED ON ANY ELECTRONIC COPIES.

SCALAR CONSULTING GROUP INC.
5713 CORPORATE WAY, SUITE 200
WEST PALM BEACH, FLORIDA 33407
(561) 429-5065
PREDRAG MILOSAVLJEVIC, P.E. NO. 54961

THE ABOVE NAMED PROFESSIONAL ENGINEER SHALL BE RESPONSIBLE FOR THE FOLLOWING SHEETS IN ACCORDANCE WITH RULE 61G15-23.004, F.A.C.

SHEET DESCRIPTION

- T-2 SIGNATURE SHEET
- T-14 STANDARD MAST ARM ASSEMBLIES DATA TABLE (NOT INCLUDED)

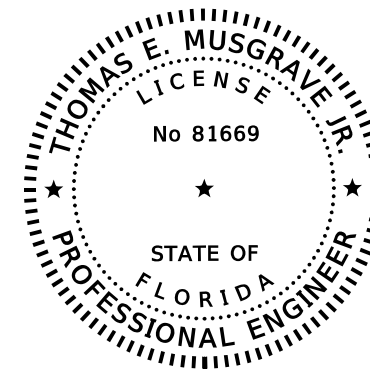

THIS ITEM HAS BEEN DIGITALLY SIGNED AND SEALED BY

ON THE DATE ADJACENT TO THE SEAL

PRINTED COPIES OF THIS DOCUMENT ARE NOT CONSIDERED SIGNED AND SEALED AND THE SIGNATURE MUST BE VERIFIED ON ANY ELECTRONIC COPIES.

TIERRA, INC.
7351 TEMPLE TERRACE HIGHWAY
TAMPA, FLORIDA 33637
(813) 989-1354
THOMAS E. MUSGRAVE, JR., P.E. NO. 81669

THE ABOVE NAMED PROFESSIONAL ENGINEER SHALL BE RESPONSIBLE FOR THE FOLLOWING SHEETS IN ACCORDANCE WITH RULE 61G15-23.004, F.A.C.

SHEET DESCRIPTION

- T-2 SIGNATURE SHEET
- T-18 REPORT OF CORE BORINGS (NOT INCLUDED)

5/14/2024 1:13:30 PM Maille.Spang c:\pwworking\100166322\51GWSG01.dgn

REVISIONS				ENGINEER OF RECORD		STATE OF FLORIDA DEPARTMENT OF TRANSPORTATION			SHEET NO.
DATE	DESCRIPTION	DATE	DESCRIPTION	ARTEM A. STRUNNIKOV, P.E. LICENSE NUMBER: 84785 KIMLEY-HORN AND ASSOCIATES, INC. 2 ALHAMBRA PLAZA, SUITE 500 CORAL GABLES, FLORIDA 33134		ROAD NO.	COUNTY	FINANCIAL PROJECT ID	
						SR 93	LEE	446296-2-52-01	T-2

SIGNATURE SHEET

GENERAL NOTES

1. THE MAINTAINING AGENCY FOR THE SIGNAL IS LEE COUNTY. THE MAINTAINING AGENCY CONTACT INFORMATION FOR THE SIGNALIZED INTERSECTIONS IS AS FOLLOWS:

LEE COUNTY DEPARTMENT OF TRANSPORTATION
 EMAIL: LCDOTPROJECTS@LEEGOV.COM
 PHONE: (239) 533-9500

2. CONTACT THE LEE COUNTY TRAFFIC SIGNAL/STREET LIGHTING INSPECTOR/LIAISON AT LEAST TWO (2) FULL BUSINESS DAYS PRIOR TO BEGINNING THE TRAFFIC SIGNAL INSTALLATION.

JAMES FENCIL
 LEE COUNTY DEPARTMENT OF TRANSPORTATION
 5650 ENTERPRISE PKWY
 FORT MYERS, FL 33905
 PHONE: (239) 533-9500
 EMAIL: LCDOTPROJECTS@LEEGOV.COM

3. ALL REMOVED SIGNAL EQUIPMENT SHALL BE DELIVERED TO THE MAINTAINING AGENCY/LEE COUNTY (JAMES FENCIL).

4. AT THE COMPLETION OF THE PROJECT, PROVIDE AS-BUILT PLANS IN ELECTRONIC FORM (PDF) TO:

NEAL TURNER, P.E., TSM&O ENGINEER - ARTERIALS
 801 N. BROADWAY AVE
 P.O. BOX 1249
 BARTOW, FL 33830-1249
 EMAIL: NEAL.TURNER@DOT.STATE.FL.US
 PHONE: 863-519-2216

LEE COUNTY DOT TRAFFIC
 RYAN KIRSCH
 LEE COUNTY DEPARTMENT OF TRANSPORTATION
 5650 ENTERPRISE PKWY
 FORT MYERS, FL 33905
 PHONE: (239) 533-9500
 EMAIL: LCDOTPROJECTS@LEEGOV.COM
 RKIRSCH@LEEGOV.COM

7. LIST OF UTILITY OWNERS:

CITY OF FORT MYERS	RENE BRITO	(239) 321-7464
COMCAST	ZIEMSKI DALLAS	(239) 989-2111
CROWN CASTLE	CHRISTOPHER PERKINS	(717) 856-6486
FP&L	MICHAEL MARTINEZ	(239) 353-6047
HOTWIRE	WALTER SANCHO-DAVILA	(954) 248-7396
LEE COUNTY BCC	ADAM BOISSIERE	(239) 980-9043
LEE COUNTY IRRIGATION	PATRICK MCFADDEN	(239) 822-3864
LEE COUNTY SIGNAL DEPT.	JAMES FENCIL	(239) 533-9500
LEE COUNTY UTILITIES	DARRIN WOOD	(239) 533-8178
LUMEN (CENTURY LINK) LOCAL	TRAY INNISS	(239) 920-5925
LUMEN (CENTURY LINK) NATIONAL	FRANCISCO AZURI	(786) 266-1713
SUMMIT BROADBAND	MICHELLE DANIEL	(407) 996-1183
TECO PEOPLES GAS	TIM FOURNIER	(256) 612-2730

PHASE IIR NOTES FOR REVIEWERS

1. MSP'S AND TSP'S WILL BE PROVIDED IN THE PHASE III SUBMITTAL DOCUMENTS

PAY ITEM NOTES

630-2-11:
 A. GENERAL SIGNALIZATION AND STREET LIGHTING CONDUIT SHALL BE PVC CONDUIT AND BE SCHEDULE 40 OR SCHEDULE 80 APPROVED FOR ELECTRICAL USE (GRAY) HDPE CONDUIT IS PROHIBITED FOR TRENCHED IN CONDUIT.

630-2-12:
 A. DIRECTIONAL BORE CONDUIT FOR GENERAL SIGNALIZATION AND STREET LIGHTING SHALL BE TWO (2) INCH CONTINUOUS HDPE SDR 11 AND SHALL BE GRAY IN COLOR. NO OTHER CONDUIT COLORS CAN BE USED UNLESS COORDINATED THROUGH THE ENGINEER AND APPROVED BY LEE COUNTY DOT TRAFFIC IN WRITING.

632-7-1:
 A. ALL THREE (3) SECTION HEADS SHALL HAVE A MINIMUM SEVEN (7) CONDUCTOR SIGNAL CABLE INSTALLED CONTINUOUS FROM THE MAST ARM HAND HOLE COMPARTMENT TO SIGNAL HEAD TERMINATION BLOCK.
 B. EACH ONE-WAY MAST ARM (NEAR SIDE OR FAR SIDE) SHALL HAVE A MINIMUM NINETEEN (19) CONDUCTOR SIGNAL CABLE INSTALLED CONTINUOUS FROM CONTROLLER CABINET TO MAST ARM HAND HOLE COMPARTMENT FOR VEHICULAR SIGNAL INDICATIONS.
 C. ALL THREE (3) AND/OR FOUR (4) SECTION HEADS SHALL HAVE A MINIMUM SEVEN (7) CONDUCTOR SIGNAL CABLE INSTALLED FROM SIGNAL HEAD TERMINATION BLOCK TO PEDESTAL BASE HAND HOLE AND SHALL HAVE A MINIMUM NINE (9) CONDUCTOR SIGNAL CABLE INSTALLED CONTINUOUS FROM CONTROLLER CABINET TO PEDESTAL BASE HAND HOLE.
 D. ALL PEDESTRIAN SIGNAL HEADS SHALL HAVE A MINIMUM FIVE (5) CONDUCTOR SIGNAL CABLE INSTALLED CONTINUOUS FROM PEDESTRIAN SIGNAL HEAD TERMINATION BLOCK TO PEDESTAL BASE HAND HOLE.
 E. EACH ONE (1) WAY PEDESTRIAN SIGNAL HEAD PEDESTAL SHALL HAVE A MINIMUM SEVEN (7) CONDUCTOR SIGNAL CABLE INSTALLED CONTINUOUS FROM CONTROLLER CABINET TO PEDESTAL BASE HAND HOLE.
 F. VERIFY THE COLOR CODE OF SIGNAL CABLE WITH THE MAINTAINING AGENCY PRIOR TO WIRING INTERSECTION.

635-2-14:
 A. PULL BOXES SHALL BE POLYMER CONCRETE CONSTRUCTION, HAVE ANSI TIER RATING OF T22 AND DESIGN LOAD RATING OF 22,500 LBS., NO EXCEPTIONS WILL BE PERMITTED. (POLYOLEFIN BLEND AND CONCRETE IS PROHIBITED) MINIMUM PULL BOX SIZE SHALL BE AS FOLLOWS:
 i. TRAFFIC SIGNAL AND STREET LIGHTING 17" X 30" X 12"

PAY ITEM NOTES (CONT.)

635-2-14 (CONT.):
 B. PULL BOX COVERS SHALL BE POLYMER CONCRETE CONSTRUCTION, HAVE ANSI TIER RATING OF T22 AND DESIGN LOAD RATING OF 22,500 LBS., AND MARKED APPROPRIATELY, "TRAFFIC SIGNAL" OR "STREET LIGHTING", NO EXCEPTIONS WILL BE PERMITTED. (POLYOLEFIN BLEND AND STEEL IS PROHIBITED)
 i. 17" X 30" COVER - "TRAFFIC SIGNAL", "STREET LIGHTING"

639-1-122, 639-3-11:
 ELECTRICAL SERVICE SHALL BE 120/240 VAC - THREE WIRE. TRAFFIC SIGNAL ELECTRICAL SERVICE SHALL BE METERED. METER SOCKET SHALL BE 200 AMP LEVER BYPASS NEMA 3R ALUMINUM ENCLOSURE RATED FOR OUTDOOR USE. MAIN LUG LOAD CENTER SHALL BE 125 AMP 4 SPACES/8 CIRCUITS RATED FOR OUTDOOR USE. SURGE PROTECTION DEVICE (SPD) SHALL BE RATED 120/240 VAC AND BE FDOT APL APPROVED. ALL CIRCUIT BREAKERS SHALL BE ASSIGNED AS FOLLOWS:
 i. SPACE 1-2 SHALL BE A DOUBLE POLE 100 AMP FOR SECONDARY DISCONNECT
 ii. SPACE 3-4 SHALL BE A DOUBLE POLE 30 AMP FOR SPD

SECONDARY DISCONNECT:
 MAIN LUG LOAD CENTER SHALL BE 125 AMP 24 SPACES/34 CIRCUITS RATED FOR OUTDOOR USE. SURGE PROTECTION DEVICE (SPD) SHALL BE RATED 120/240 VAC AND BE FDOT APL APPROVED. ALL CIRCUIT BREAKERS SHALL BE ASSIGNED AS FOLLOWS:
 i. SPACE 1 SHALL BE A SINGLE POLE 30 AMP FOR TRAFFIC SIGNAL CABINET
 ii. SPACE 3-5 SHALL BE A DOUBLE POLE 30 AMP FOR SPD

639-2-1:
 SERVICE WIRE FROM (POINT OF SERVICE) TO METER ENCLOSURE SHALL BE (3) #2 AWG AND (1) #2 AWG GND. SERVICE WIRE FROM MAIN ELECTRICAL SERVICE TO SECONDARY DISCONNECT SHALL BE (3) #2 AWG AND (1) #2 AWG GND.

646-1-11:
 ALL PEDESTAL POLES SHALL BE INSTALLED WITH SQUARE BREAKAWAY BASE FOR ALUMINUM FOUR (4) INCH PEDESTAL POLE WITH ALUMINUM DOOR AND GROUND LUG, PEDESTAL POLE SHALL FOUR (4) INCH POLE SCHEDULE 80 SPUN ALUMINUM POLE AND HAVE A POLE & BASE COLLAR LOCKING ASSEMBLY.

649-21-XX:
 ALL MAST ARM FOUNDATIONS SHALL HAVE MINIMUM - FIVE (5) EACH TWO (2) INCH CONDUIT AND ONE (1) EACH (3/4) INCH CONDUIT. CONDUIT STUB OUT LOCATION TO BE DETERMINED BY LEE COUNTY DOT TRAFFIC IN FIELD. STUB OUTS SHALL BE A MINIMUM OF THIRTY (30) INCHES DEEP. (INTERSECTION LIGHTING SHALL BE SEPARATE FROM STANDARD STREET LIGHTING CIRCUIT, HAVING 480 VAC POWER IN A SIGNAL UPRIGHT IS STRICTLY PROHIBITED)
 • TWO - 2" CONDUIT FOR SIGNAL HIGH VOLTAGE
 • ONE - 2" CONDUIT FOR PED HIGH VOLTAGE
 • ONE - 2" CONDUIT FOR POWER (240 VAC MAXIMUM)- INTERSECTION LIGHTING
 • ONE - 2" CONDUIT FOR DETECTION
 • ONE - 3/4" CONDUIT FOR #6 AWG GREEN GROUND WIRE

CONDUITS SHALL BE PLUMBED AND CENTERED IN FOUNDATION AND SHALL BE SIX (6) INCHES - TEN (10) INCHES ABOVE THE FOUNDATION. TOP OF THE CONDUITS SHALL BE CUT FLAT, NOT ANGLED.

CONDUITS SHALL BE PLUMBED AND CENTERED IN FOUNDATION AND SHALL BE SIX (6) INCHES - TEN (10) INCHES ABOVE THE FOUNDATION. TOP OF THE CONDUITS SHALL BE CUT FLAT, NOT ANGLED.

650-1-14:
 ALL TRAFFIC SIGNAL HEADS SHALL BE BLACK TWELVE (12) INCH DIAMETER ALUMINUM HOUSING; POLYCARBONATE HOUSING HEADS ARE PROHIBITED. ALL TRAFFIC SIGNAL HEADS SHALL HAVE ONE-PIECE BLACK LOUVERED ALUMINUM RETROREFLECTIVE BORDERED BACKPLATES INSTALLED UNLESS THE PLANS SPECIFY FLEXIBLE BACKPLATES. ALL TRAFFIC SIGNAL LED MODULES SHALL BE TWELVE (12) INCH LONG LIFE 15 YEAR FULL PERFORMANCE WARRANTY.

653-1-11
 ALL PEDESTRIAN SIGNAL HEADS SHALL BE BLACK SIXTEEN (16) INCH ALUMINUM HOUSING WITH EGG CRATE VISOR; POLYCARBONATE HOUSING HEADS ARE PROHIBITED. ALL PEDESTRIAN LED SIGNAL MODULES SHALL BE INTERNATIONAL SYMBOL AND COUNTDOWN; USE OF WORDS IN PLACE OF SYMBOLS ARE PROHIBITED.

MOUNTING HEIGHT OF PEDESTRIAN SIGNAL HEAD SHALL BE NINE (9) FEET SIX (6) INCHES ABOVE GRADE TO BOTTOM OF HEAD.

REVISIONS				ENGINEER OF RECORD	STATE OF FLORIDA DEPARTMENT OF TRANSPORTATION			SHEET NO.
DATE	DESCRIPTION	DATE	DESCRIPTION	ARTEM A. STRUNNIKOV, P.E. LICENSE NUMBER: 84785 KIMLEY-HORN AND ASSOCIATES, INC. 2 ALHAMBRA PLAZA, SUITE 500 CORAL GABLES, FLORIDA 33134	ROAD NO.	COUNTY	FINANCIAL PROJECT ID	
						SR 93	LEE	
GENERAL NOTES								T-3

THE OFFICIAL RECORD OF THIS SHEET IS THE ELECTRONIC FILE DIGITALLY SIGNED AND SEALED UNDER RULE 61G15-23.004, F.A.C.

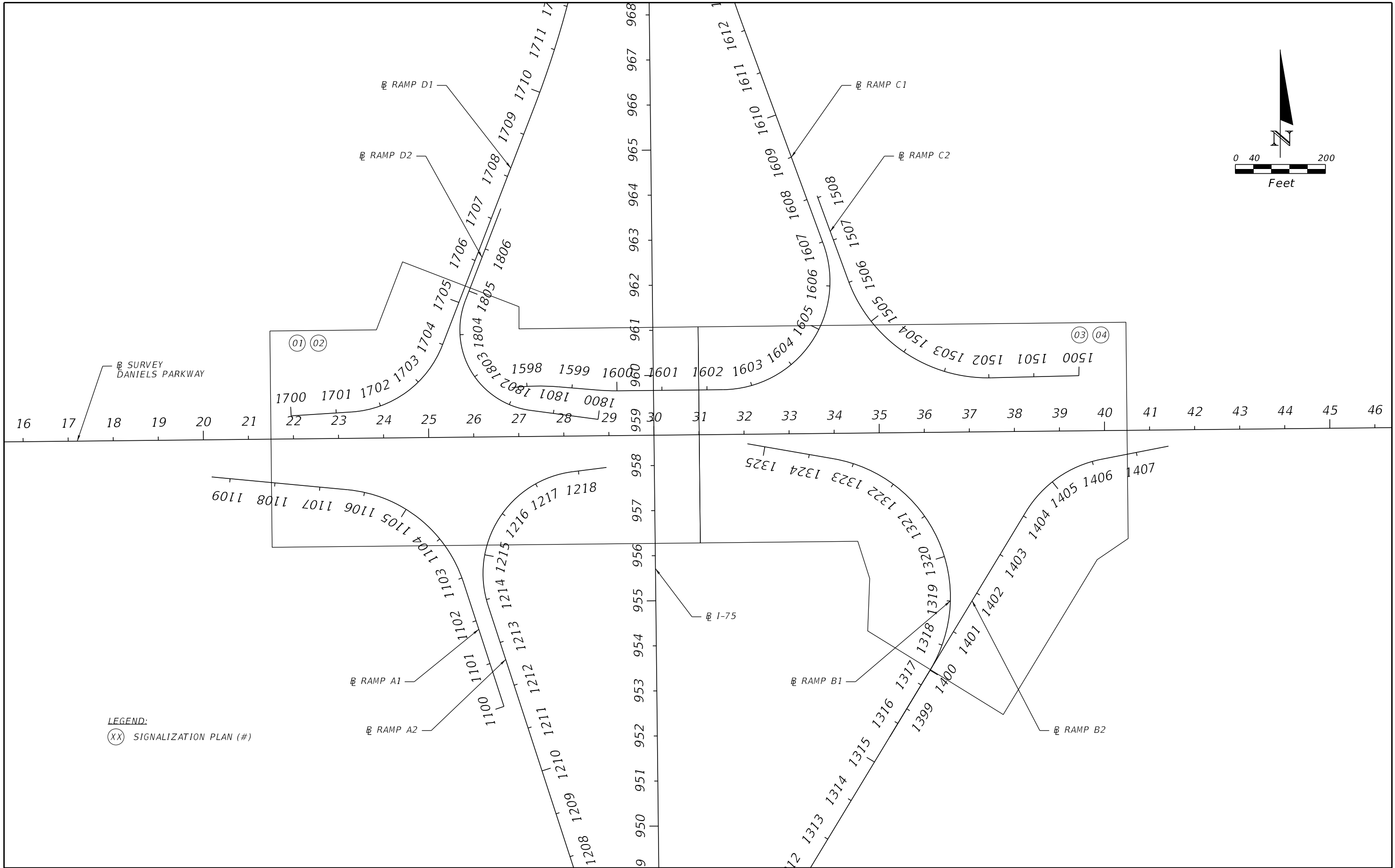
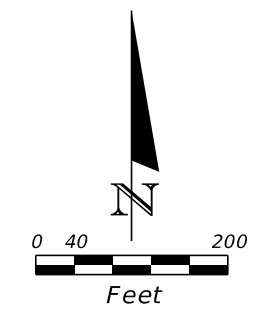

LEGEND:
 (XX) SIGNALIZATION PLAN (#)

REVISIONS				ENGINEER OF RECORD			STATE OF FLORIDA DEPARTMENT OF TRANSPORTATION			PROJECT LAYOUT	SHEET NO. T-4
DATE	DESCRIPTION	DATE	DESCRIPTION	ARTEM A. STRUNNIKOV, P.E. LICENSE NUMBER: 84785 KIMLEY-HORN AND ASSOCIATES, INC. 2 ALHAMBRA PLAZA, SUITE 500 CORAL GABLES, FLORIDA 33134			ROAD NO.	COUNTY	FINANCIAL PROJECT ID		
							SR 93	LEE	446296-2-52-01		

THE OFFICIAL RECORD OF THIS SHEET IS THE ELECTRONIC FILE DIGITALLY SIGNED AND SEALED UNDER RULE 61G15-23.004, F.A.C.

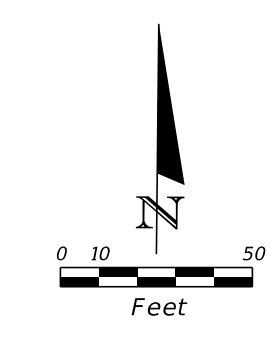

DETECTORS FOR LOOPS					
LOOP	NO. OF LOOPS	NO. OF WIRE	CHANNEL NO.	CONNECT TO	DETECT TYPE
L-18	1	1	1		
L-20	1	1	2		
L-22	1	1	3		
L-24	1	1	4		

ALL OTHER LOOPS NOT SHOWN ARE EXISTING TO REMAIN.

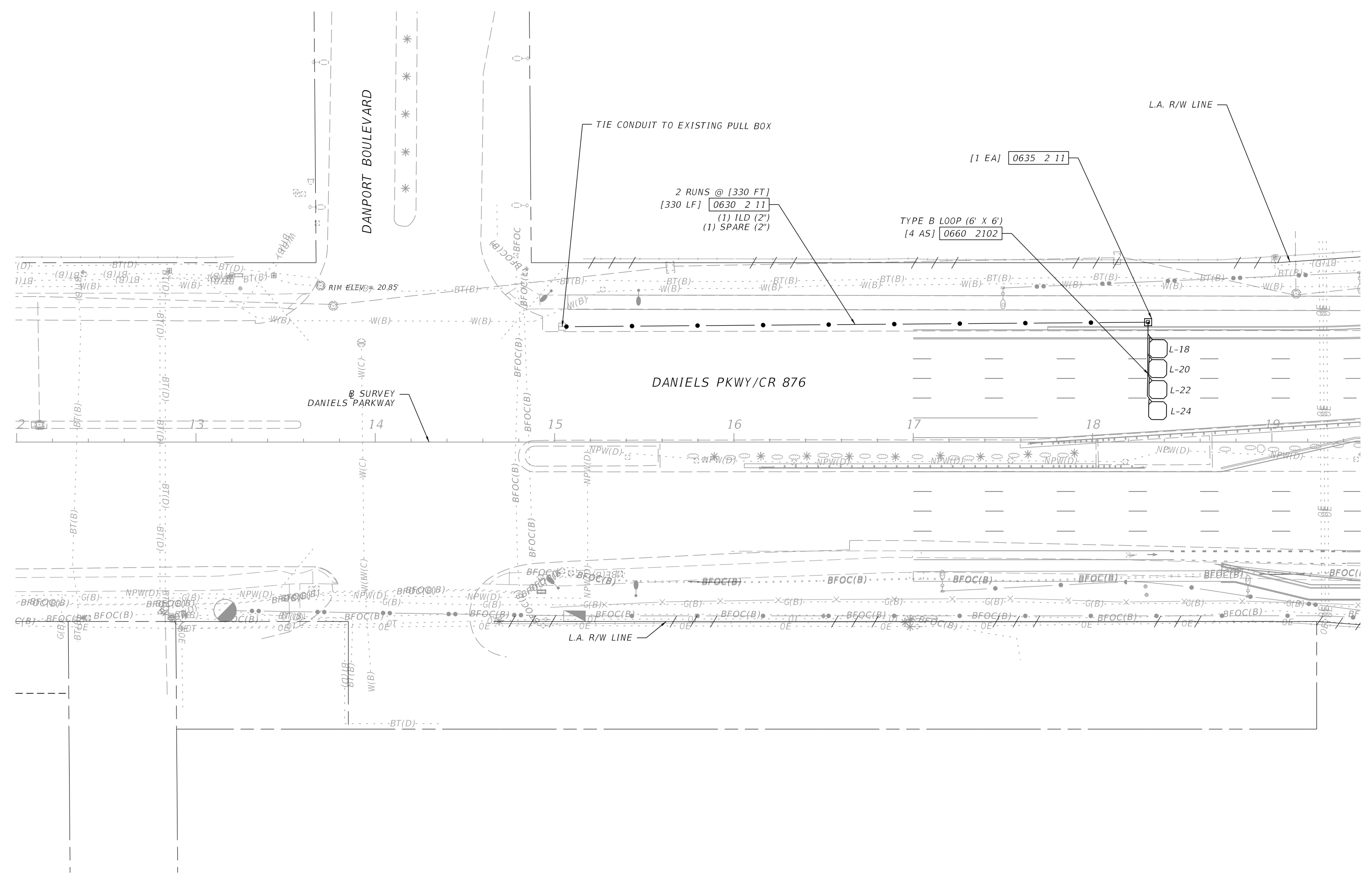

THE OFFICIAL RECORD OF THIS SHEET IS THE ELECTRONIC FILE DIGITALLY SIGNED AND SEALED UNDER RULE 61G15-23.004, F.A.C.	ENGINEER OF RECORD ARTEM A. STRUNNIKOV, P.E. LICENSE NUMBER 04795 KIMLEY-HORN AND ASSOCIATES, INC. 2 ALHAMBRA PLAZA, SUITE 500 CORAL GABLES, FLORIDA 33134	STATE OF FLORIDA DEPARTMENT OF TRANSPORTATION			SIGNALIZATION PLAN (01)	SHEET NO. T-5
	ROAD NO. SR 93	COUNTY LEE	FINANCIAL PROJECT ID 446296-2-52-01	DATE 7/10/2024		

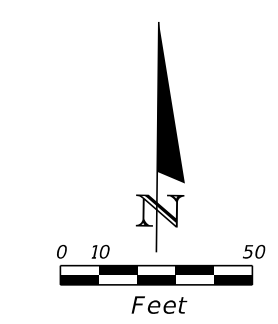

STATIC SIGN DETAILS

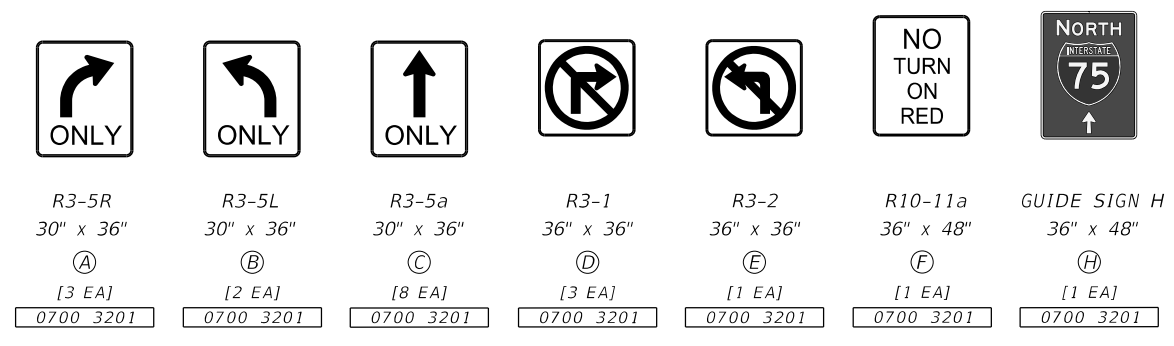

STATIC STREET NAME SIGN DETAILS

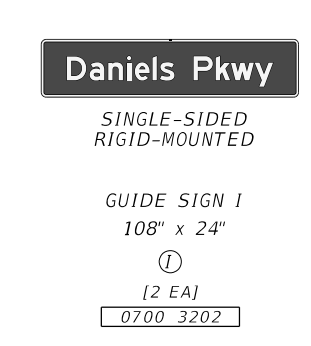

SIGNALS

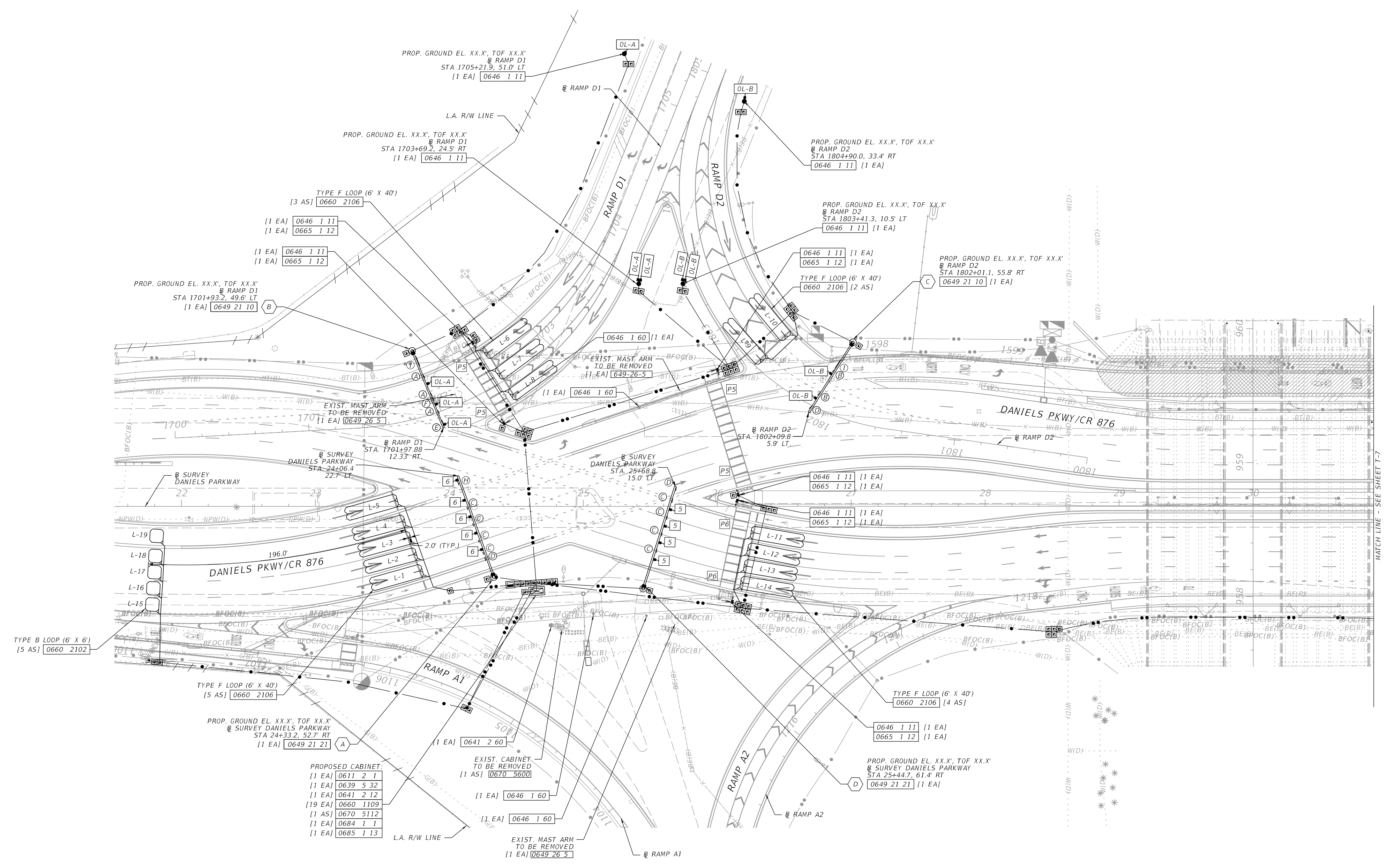
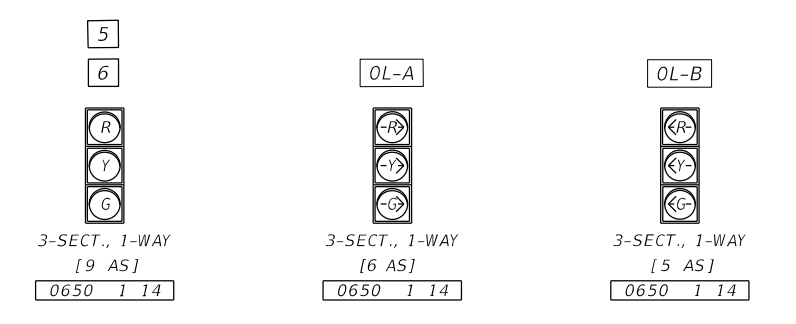

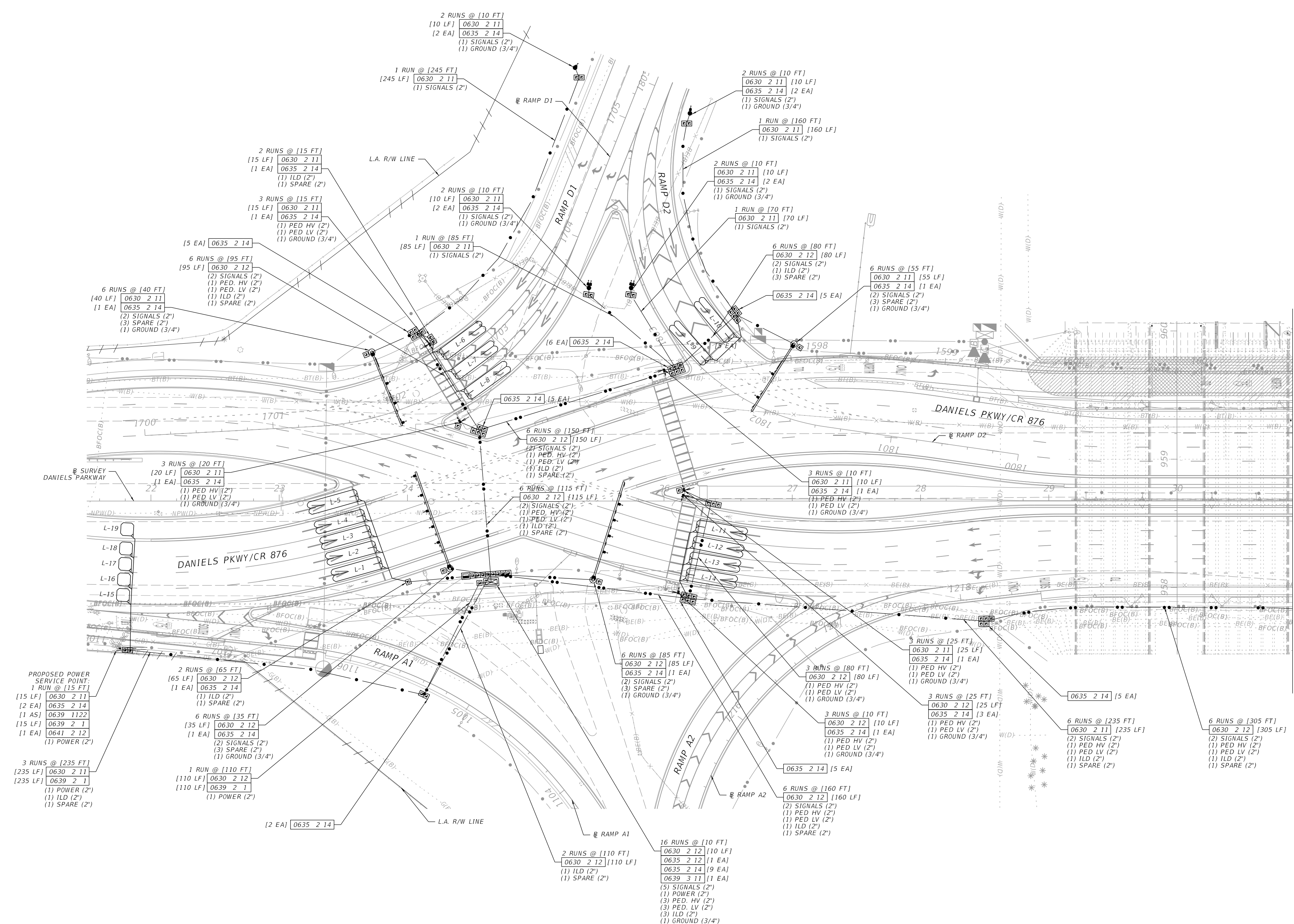
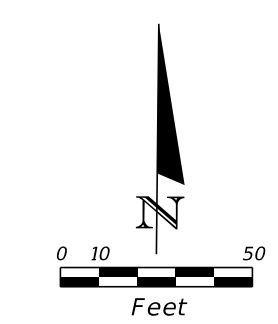

THE OFFICIAL RECORD OF THIS SHEET IS THE ELECTRONIC FILE DIGITALLY SIGNED AND SEALED UNDER RULE 61G15-23.004, F.A.C.	ENGINEER OF RECORD ARTEM A. STRUNNIKOV, P.E. LICENSE NUMBER 04995 KIMLEY-HORN AND ASSOCIATES, INC. 2 ALHAMBRA PLAZA, SUITE 500 CORAL GABLES, FLORIDA 33134		STATE OF FLORIDA DEPARTMENT OF TRANSPORTATION		SIGNALIZATION PLAN (05) SHEET NO. T-7
	ROAD NO. SR 93	COUNTY LEE	FINANCIAL PROJECT ID 446296-2-52-01	DATE 7/10/2024	

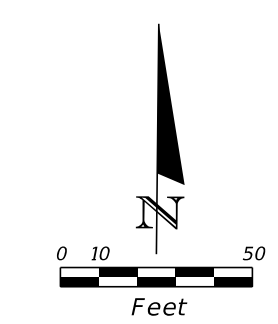

STATIC SIGN DETAILS

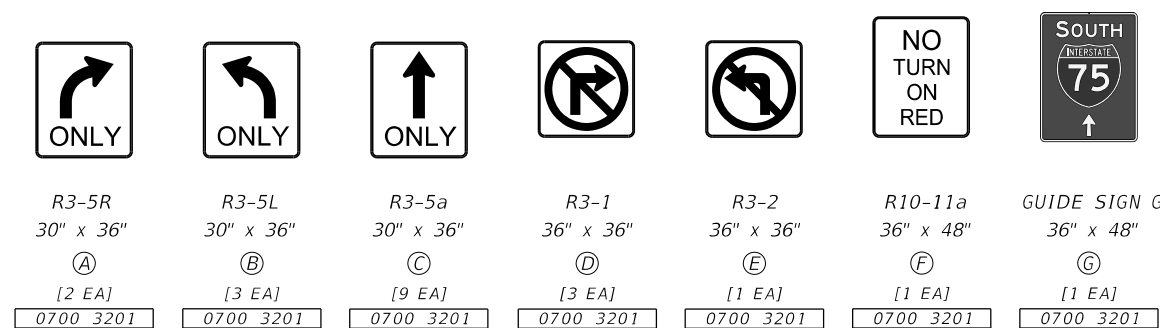

STATIC STREET NAME SIGN DETAILS

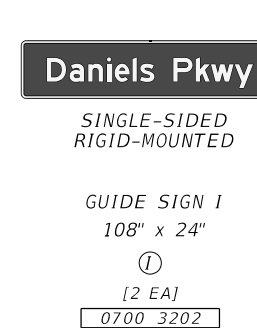

SIGNALS

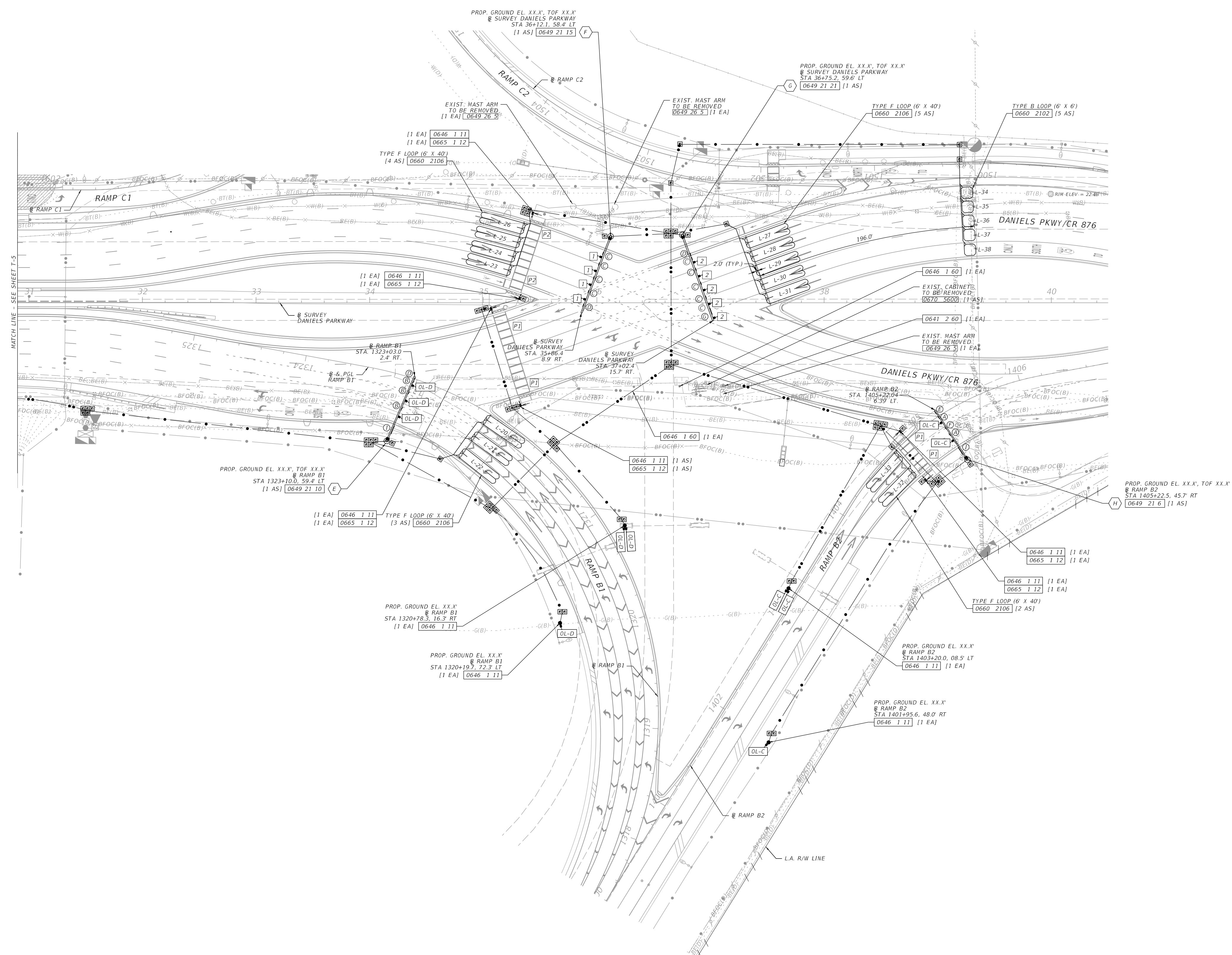
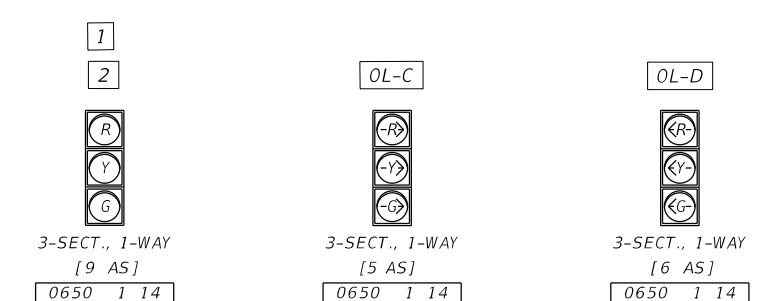

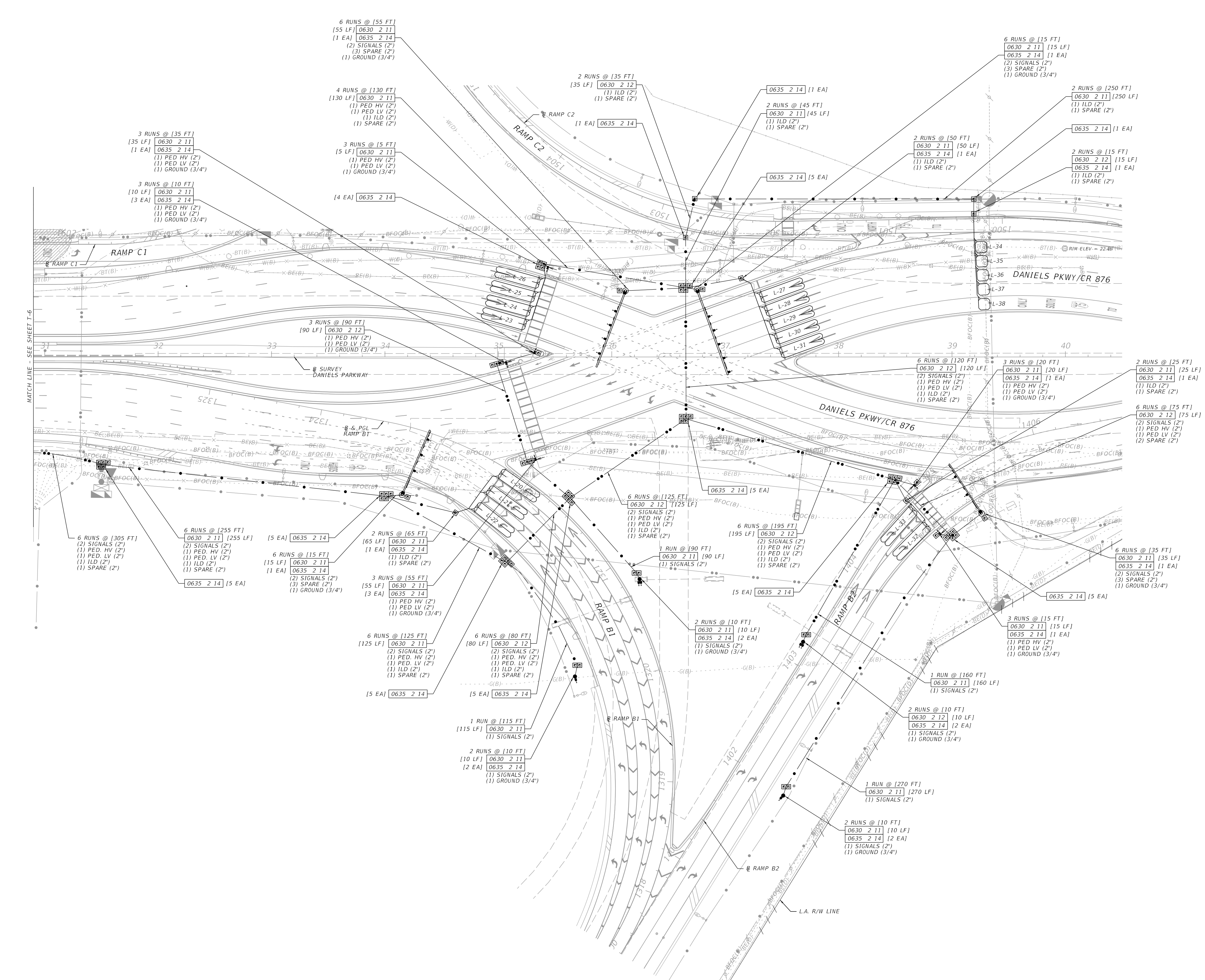
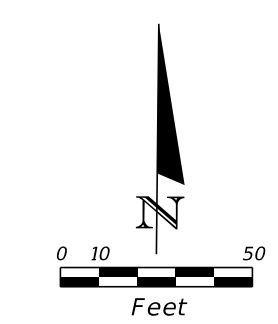

S.O.P. & RING SEQUENCE

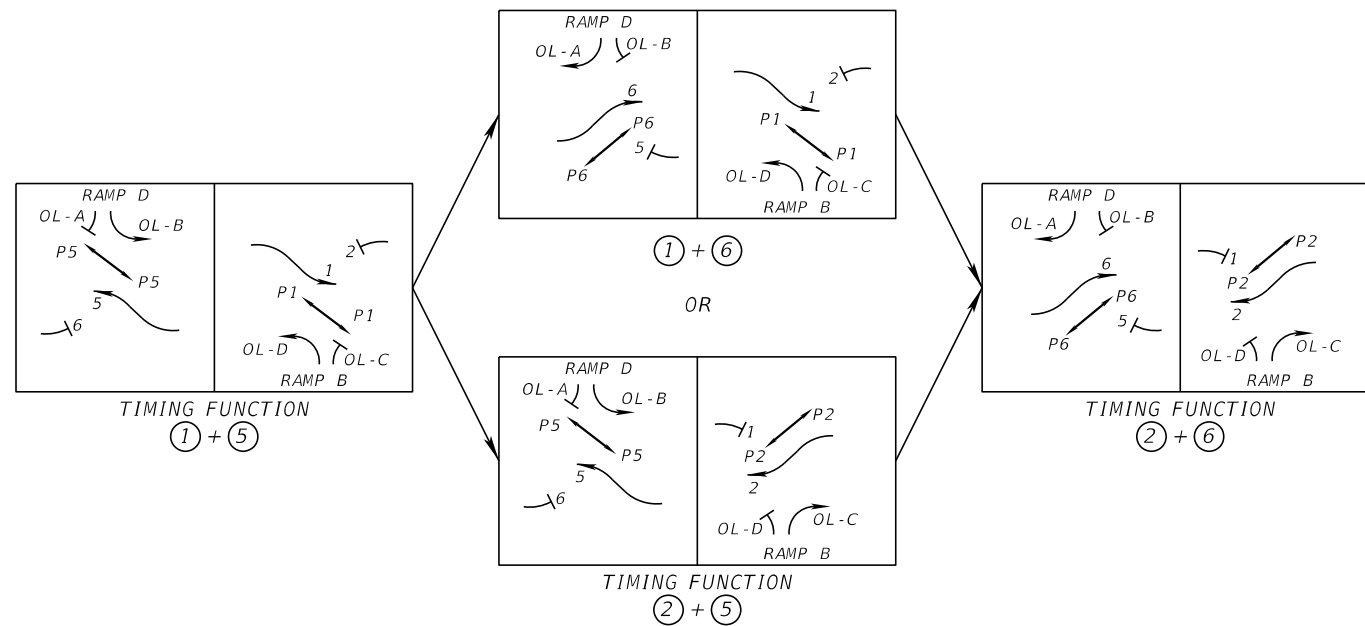

CONTROLLER OPERATIONS:

1. MAJOR STREET IS DANIELS PARKWAY (SPEED LIMIT OF 35 MPH). MINOR STREETS ARE THE I-75 RAMPS (SPEED LIMIT OF 25 MPH).
2. FLASHING OPERATION: ALL MOVEMENTS SHALL FLASH RED.
4. CONTROLLER CABINET SHALL BE WIRED AND OPERATED WITH SPECIAL S.O.P AS SHOWN ABOVE.
5. REQUEST UPDATED SIGNAL TIMINGS FROM LEE COUNTY WHEN ALL LANES, STRIPING, SIGNALS AND PEDESTRIAN FACILITIES ARE IN THEIR FINAL CONFIGURATION AND THE SIGNAL IS OPERATING AS DESIGNED. PROVIDE LEE COUNTY WITH ALL 'AS-BUILT' INFORMATION NECESSARY TO DEVELOP THE BASIC SIGNAL TIMING PARAMETERS AND ALLOW THREE (3) WEEKS FOLLOWING THE REQUEST FOR LEE COUNTY TO DEVELOP THE UPDATED TIMINGS. PROGRAM THE CONTROLLER PER THE TIMINGS PROVIDED BY LEE COUNTY.

VEHICLE OVERLAP PHASES AND NOTES

1. OL-A TO RUN WITH VEHICULAR PHASE 6 WITH YELLOW = 3.9 SEC., ALL RED = 7.2 SEC.
2. OL-B TO RUN WITH VEHICULAR PHASE 5 WITH YELLOW = 3.8 SEC., ALL RED = 3.8 SEC.
3. OL-C TO RUN WITH VEHICULAR PHASE 2 WITH YELLOW = 4.2 SEC., ALL RED = 5.1 SEC.
4. OL-D TO RUN WITH VEHICULAR PHASE 1 WITH YELLOW = 4.5 SEC., ALL RED = 6.2 SEC.
5. PROGRAM ALL OVERLAP TYPES AS 'NORMAL'.

CONTROLLER TIMINGS

MOVEMENT NUMBER	1	2	5	6
DIRECTION	EB	WB	WB	EB
TURN TYPE				
MINIMUM GREEN	15	15	15	15
EXTENSION	5	5	5	5
YELLOW CLEARANCE	4.0	4.0	4.0	4.0
ALL RED	10.0	8.3	7.5	7.7
MAX I	74	96	96	74
MAX II	72	98	98	72
MAX LIMIT				
ADJUST BY				
WALK	7	7	7	7
FLASHING DON'T WALK	22	19	24	19
DETECTOR MEMORY				
DETECTOR CROSS SWITCH				
DUAL ENTRY				
RECALL		MIN		MIN
VEHICLE RECALL				
CNA				
REST IN WALK				

*INITIAL TIMINGS MAY BE FIELD ADJUSTED DURING CONSTRUCTION.

DETECTORS FOR LOOPS

LOOP	NO. OF LOOPS	NO. OF NEW DETS.	CHANNEL NO.	CONNECT TO MOVEMENT	DELAY TIME (SEC)
1	1		1	6	
2	1	1	2		
3	1		1		
4	1	1	2		
5	1		1		
6	1	1	2		
7	1		1		
8	1	1	2		
9	1		1		
10	1	1	2		
11	1		1		
12	1	1	2		
13	1		1		
14	1	1	2		
15	1		1		
16	1	1	2		
17	1		1		
18	1	1	2		
19	1		1		
20	1	1	2		
21	1		1		
22	1	1	2		
23	1		1		
24	1	1	2		
25	1		1		
26	1	1	2		
27	1		1		
28	1	1	2		
29	1		1		
30	1	1	2		
31	1		1		
32	1	1	2		
33	1		1		
34	1	1	2		
35	1		1		
36	1	1	2		
37	1		1		
38	1	1	2		

CONTROLLER TIMINGS SHEET

REVISIONS				ENGINEER OF RECORD			STATE OF FLORIDA DEPARTMENT OF TRANSPORTATION			SHEET NO.
DATE	DESCRIPTION	DATE	DESCRIPTION	ARTEM A. STRUNNIKOV, P.E. LICENSE NUMBER: 84785 KIMLEY-HORN AND ASSOCIATES, INC. 2 ALHAMBRA PLAZA, SUITE 500 CORAL GABLES, FLORIDA 33134			ROAD NO.	COUNTY	FINANCIAL PROJECT ID	
				SR 93	LEE	446296-2-52-01	SIGNALIZATION PLAN (06)			

THE OFFICIAL RECORD OF THIS SHEET IS THE ELECTRONIC FILE DIGITALLY SIGNED AND SEALED UNDER RULE 61G15-23.004, F.A.C.

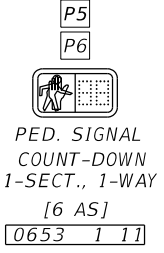
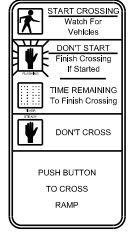
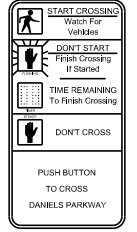
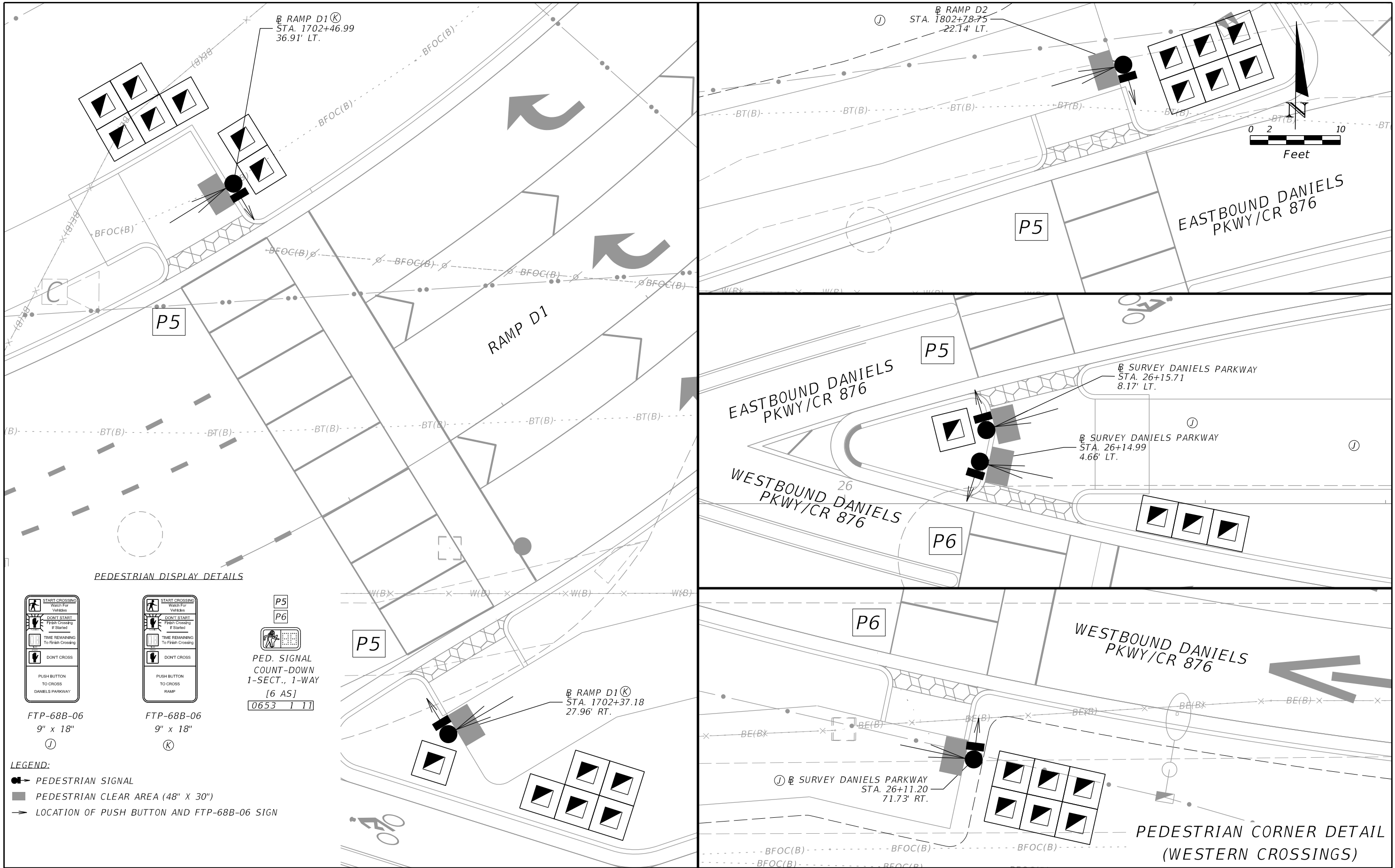

- LEGEND:**
- PEDESTRIAN SIGNAL
 - PEDESTRIAN CLEAR AREA (48" X 30")
 - LOCATION OF PUSH BUTTON AND FTP-68B-06 SIGN

REVISIONS		REVISIONS	
DATE	DESCRIPTION	DATE	DESCRIPTION

ENGINEER OF RECORD
 ARTEM A. STRUNNIKOV, P.E.
 LICENSE NUMBER: 84785
 KIMLEY-HORN AND ASSOCIATES, INC.
 2 ALHAMBRA PLAZA, SUITE 500
 CORAL GABLES, FL 33134

STATE OF FLORIDA DEPARTMENT OF TRANSPORTATION		
ROAD NO.	COUNTY	FINANCIAL PROJECT ID
SR 93	LEE	446296-2-52-01

SIGNALIZATION PLAN (07)

SHEET NO.
T-11

THE OFFICIAL RECORD OF THIS SHEET IS THE ELECTRONIC FILE DIGITALLY SIGNED AND SEALED UNDER RULE 61G15-23.004, F.A.C.

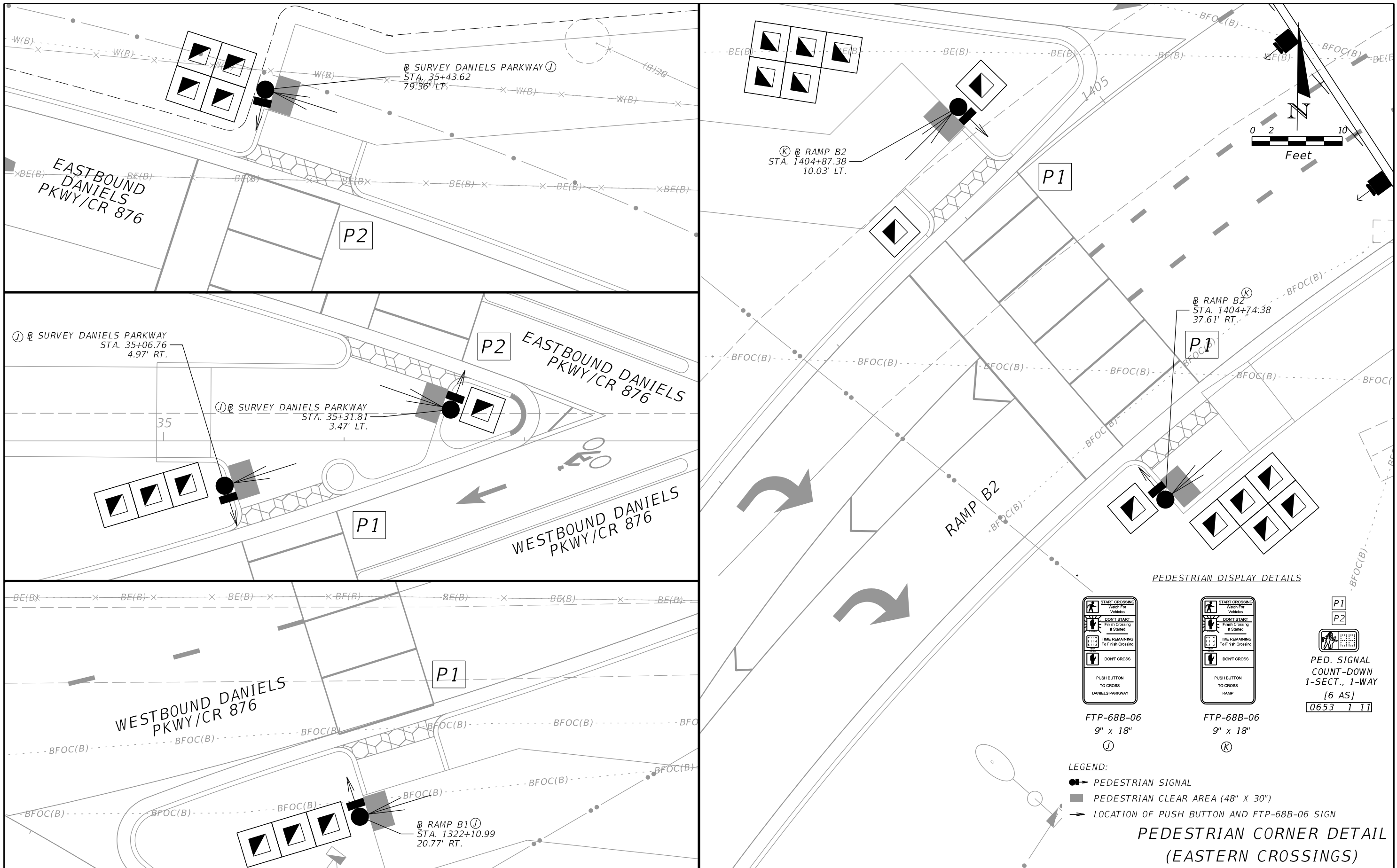

REVISIONS		REVISIONS	
DATE	DESCRIPTION	DATE	DESCRIPTION

ENGINEER OF RECORD
 ARTEM A. STRUNNIKOV, P.E.
 LICENSE NUMBER: 84785
 KIMLEY-HORN AND ASSOCIATES, INC.
 2 ALHAMBRA PLAZA, SUITE 500
 CORAL GABLES, FLORIDA 33134

STATE OF FLORIDA DEPARTMENT OF TRANSPORTATION		
ROAD NO.	COUNTY	FINANCIAL PROJECT ID
SR 93	LEE	446296-2-52-01

SIGNALIZATION PLAN (08)

SHEET NO.
T-12

THE OFFICIAL RECORD OF THIS SHEET IS THE ELECTRONIC FILE DIGITALLY SIGNED AND SEALED UNDER RULE 61G15-23.004, F.A.C.

LOCATIONS:

- Ⓜ RAMP D1 STA 1705+21.9; 51.0' LT
- Ⓜ RAMP D2 STA 1804+90.0; 33.4' RT
- Ⓜ RAMP B1 STA 1320+19.7; 72.3' LT
- Ⓜ RAMP B2 STA 1401+95.6; 48.0' RT

NOTES:

1. WORK THIS DETAIL WITH FDOT STANDARD PLANS INDICES 646-001, 700-120 AND SPECIFICATION 646.
2. ENSURE THAT THE LOWEST POINT ON PEDESTAL-MOUNTED SIGNAL HEADS IS 12 FEET ABOVE FINISHED GRADE FROM THE ROADWAY AT THE POINT OF THEIR INSTALLATION.
3. ENGAGE ALL THREADS ON THE TRANSFORMER BASE AND POST UNLESS THE ALUMINUM POST IS FULLY SEATED INTO BASE.
4. DESIGN WIND SPEED = 170 MPH (LEE COUNTY).
5. USE APL APPROVED SIGNAL MOUNTING ASSEMBLY.

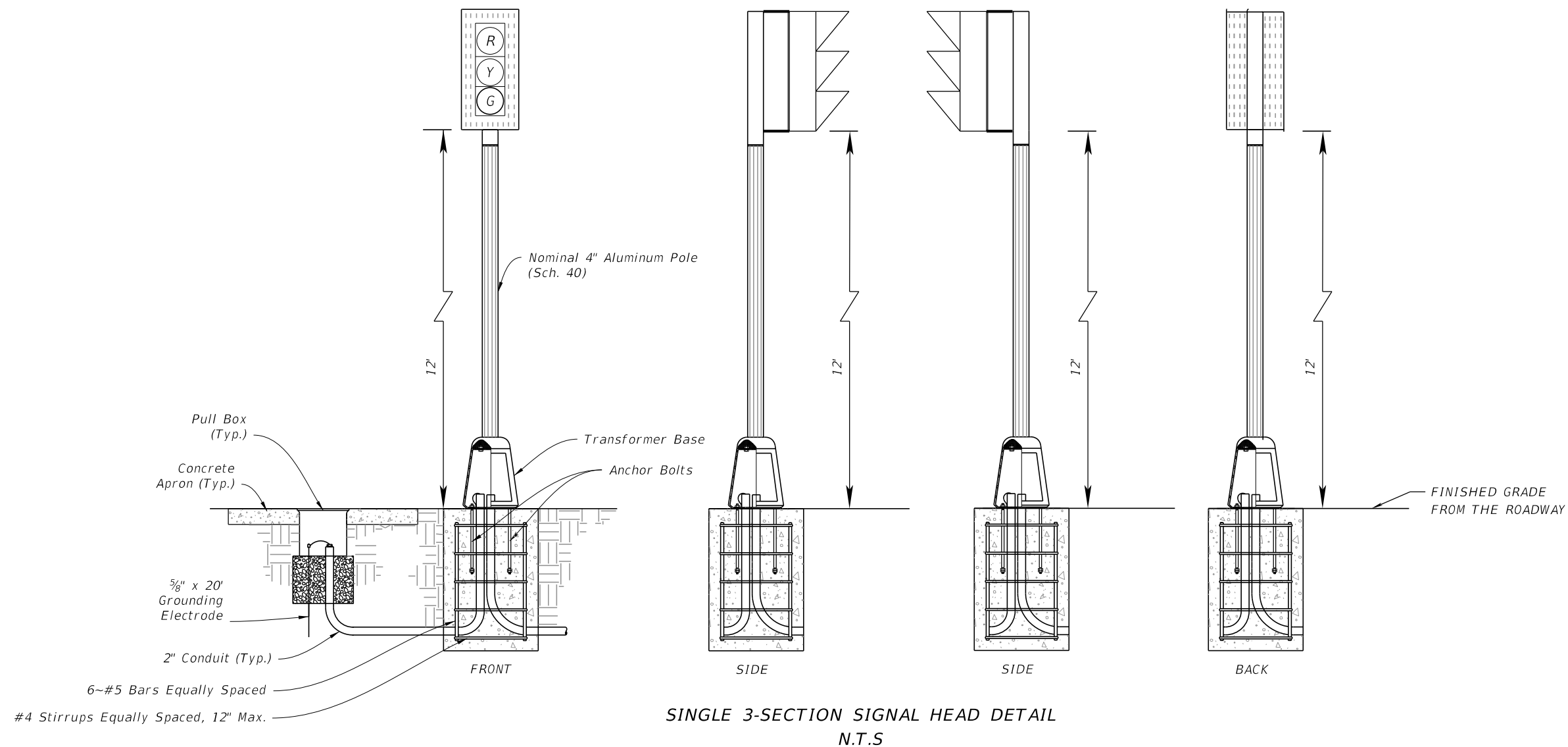

REVISIONS				ENGINEER OF RECORD			STATE OF FLORIDA DEPARTMENT OF TRANSPORTATION			SPECIAL DETAIL (01)	SHEET NO. T-15
DATE	DESCRIPTION	DATE	DESCRIPTION	ARTEM A. STRUNNIKOV, P.E. LICENSE NUMBER: 84785 KIMLEY-HORN AND ASSOCIATES, INC. 2 ALHAMBRA PLAZA, SUITE 500 CORAL GABLES, FLORIDA 33134			ROAD NO.	COUNTY	FINANCIAL PROJECT ID		
							SR 93	LEE	446296-2-52-01		

THE OFFICIAL RECORD OF THIS SHEET IS THE ELECTRONIC FILE DIGITALLY SIGNED AND SEALED UNDER RULE 61G15-23.004, F.A.C.

LOCATIONS:

- Ⓜ RAMP D1 STA 1703+69.2; 24.5' RT
- Ⓜ RAMP D2 STA 1803+41.3; 10.5' LT
- Ⓜ RAMP B1 STA 1320+78.3; 16.3' RT
- Ⓜ RAMP B2 STA 1403+20.0; 08.5' LT

NOTES:

1. WORK THIS DETAIL WITH FDOT STANDARD PLANS INDICES 646-001, 700-120 AND SPECIFICATION 646.
2. ENSURE THAT THE LOWEST POINT ON PEDESTAL-MOUNTED SIGNAL HEADS IS 12 FEET ABOVE FINISHED GRADE FROM THE ROADWAY AT THE POINT OF THEIR INSTALLATION.
3. ENGAGE ALL THREADS ON THE TRANSFORMER BASE AND POST UNLESS THE ALUMINUM POST IS FULLY SEATED INTO BASE.
4. DESIGN WIND SPEED = 170 MPH (LEE COUNTY).
5. USE APL APPROVED SIGNAL MOUNTING ASSEMBLY.

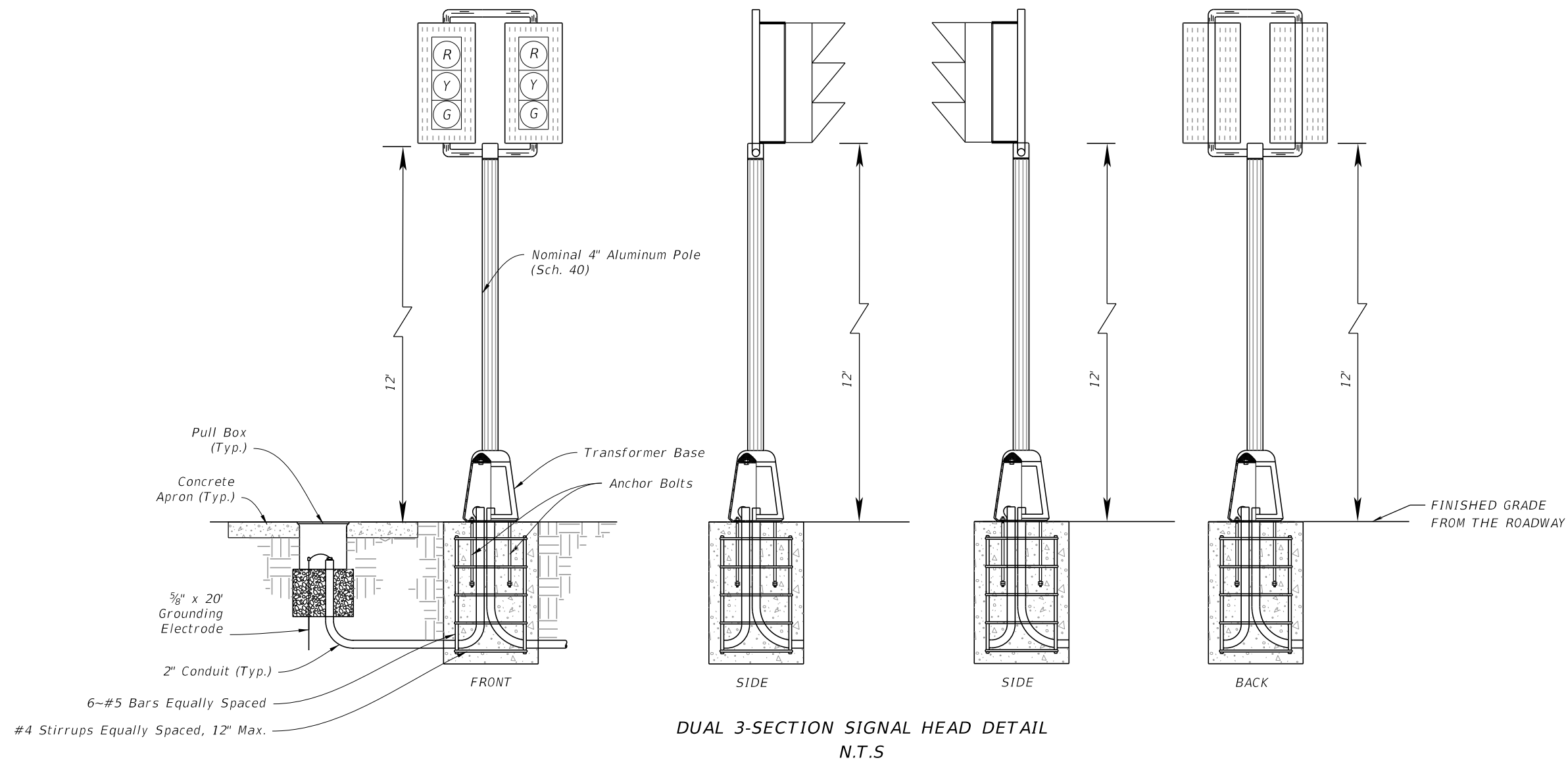

REVISIONS				ENGINEER OF RECORD		STATE OF FLORIDA DEPARTMENT OF TRANSPORTATION			SHEET NO.
DATE	DESCRIPTION	DATE	DESCRIPTION	ARTEM A. STRUNNIKOV, P.E. LICENSE NUMBER: 84785 KIMLEY-HORN AND ASSOCIATES, INC. 2 ALHAMBRA PLAZA, SUITE 500 CORAL GABLES, FLORIDA 33134		ROAD NO.	COUNTY	FINANCIAL PROJECT ID	
								SR 93	LEE
									T-16

THE OFFICIAL RECORD OF THIS SHEET IS THE ELECTRONIC FILE DIGITALLY SIGNED AND SEALED UNDER RULE 61G15-23.004, F.A.C.

SIGN NAME	GS I	QTY	4	SIGN NUMBER	1701+93.22
PANEL	BORDER				
WIDTH	9'-0"	WIDTH	1.0"	1802+01.10	
HEIGHT	2'-0"	RADII	0.0"	1323+10.04	
LEGEND	White	COLOR	White	1405+22.45	
COLOR	Green				
SYMBOL(S)	ANGLE	X	Y	WID	HT
SIGN NUMBER	NUMBER OF POSTS	CLEARANCE Edge Of Land	COLUMN SIZE	AVERAGE LENGTH	

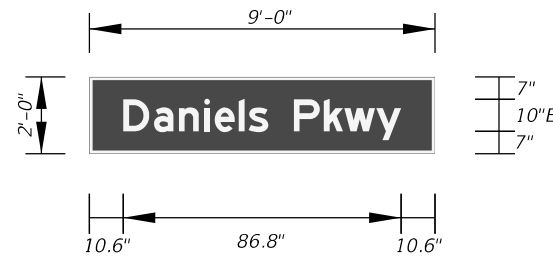

NO. OF LIGHT FIXTURES	FIXTURE SPACING	PHOTOMETRIC CURVE	WATT	VOLTAGE

COPY	D	A	N	I	E	L	S	P	K	W	Y	L							
SPACE	10.6	20.2	28	35.9	39.2	46.7	49.8	63.9	73.3	79.7	89.7	86.8							
COPY																			
SPACE																			
COPY																			
SPACE																			
COPY																			
SPACE																			
COPY																			
SPACE																			
COPY																			
SPACE																			

SIGN NAME	GS H	QTY	1	SIGN NUMBER	24+33.23
PANEL	BORDER				
WIDTH	3'-0"	WIDTH	0.5"		
HEIGHT	4'-0"	RADII	1.5"		
LEGEND	White	COLOR	White		
COLOR	Green				
SYMBOL(S)	ANGLE	X	Y	WID	HT
M1_1	0	6	12.5	24	24
AR_Type A	0	15.5	2	5.1	8
SIGN NUMBER	NUMBER OF POSTS	CLEARANCE Edge Of Land	COLUMN SIZE	AVERAGE LENGTH	

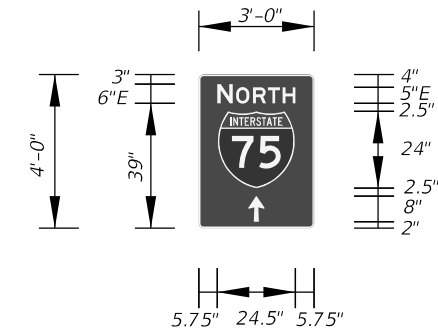

NO. OF LIGHT FIXTURES	FIXTURE SPACING	PHOTOMETRIC CURVE	WATT	VOLTAGE

COPY	N	O	R	T	H	L													
SPACE	5.8	11.6	17	21.6	26.2	24.5													
COPY																			
SPACE																			
COPY																			
SPACE																			
COPY																			
SPACE																			
COPY																			
SPACE																			
COPY																			
SPACE																			

SIGN NAME	GS G	QTY	1	SIGN NUMBER	36+75.15
PANEL	BORDER				
WIDTH	3'-0"	WIDTH	0.5"		
HEIGHT	4'-0"	RADII	1.5"		
LEGEND	White	COLOR	White		
COLOR	Green				
SYMBOL(S)	ANGLE	X	Y	WID	HT
M1_1	0	6	12.5	24	24
AR_Type A	0	15.5	2	5.1	8
SIGN NUMBER	NUMBER OF POSTS	CLEARANCE Edge Of Land	COLUMN SIZE	AVERAGE LENGTH	

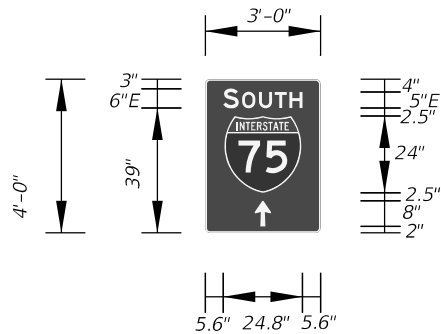

NO. OF LIGHT FIXTURES	FIXTURE SPACING	PHOTOMETRIC CURVE	WATT	VOLTAGE

SIGN NAME	QTY	SIGN NUMBER	STATION(S)		
PANEL	BORDER				
WIDTH	WIDTH				
HEIGHT	RADII				
LEGEND	COLOR				
COLOR					
SYMBOL(S)	ANGLE	X	Y	WID	HT
SIGN NUMBER	NUMBER OF POSTS	CLEARANCE Edge Of Land	COLUMN SIZE	AVERAGE LENGTH	

NO. OF LIGHT FIXTURES	FIXTURE SPACING	PHOTOMETRIC CURVE	WATT	VOLTAGE

COPY	S	O	U	T	H	L													
SPACE	5.6	11.5	16.8	21.7	26.3	24.8													
COPY																			
SPACE																			
COPY																			
SPACE																			
COPY																			
SPACE																			
COPY																			
SPACE																			

COPY																		
SPACE																		
COPY																		
SPACE																		
COPY																		
SPACE																		
COPY																		
SPACE																		
COPY																		
SPACE																		

REVISIONS		ENGINEER OF RECORD		STATE OF FLORIDA DEPARTMENT OF TRANSPORTATION			GUIDESIGN WORKSHEET	SHEET NO. T-17
DATE	DESCRIPTION	DATE	DESCRIPTION	ROAD NO.	COUNTY	FINANCIAL PROJECT ID		
				SR 93	LEE	446296-2-52-01		

ARTEM A. STRUNNIKOV, P.E.
 LICENSE NUMBER: 84785
 KIMLEY-HORN AND ASSOCIATES, INC.
 2 ALHAMBRA PLAZA, SUITE 500
 CORAL GABLES, FLORIDA 33134

THE OFFICIAL RECORD OF THIS SHEET IS THE ELECTRONIC FILE DIGITALLY SIGNED AND SEALED UNDER RULE 61G15-23.004, F.A.C.