

STATE OF FLORIDA
DEPARTMENT OF TRANSPORTATION

CONTRACT PLANS

FINANCIAL PROJECT ID 444008-4-52-01

COLLIER COUNTY (03175)
STATE ROAD NO. 93 (INTERSTATE 75)

SIGNING AND PAVEMENT MARKING PLANS

INDEX OF SIGNING AND
PAVEMENT MARKING PLANS

SHEET NO.	SHEET DESCRIPTION
S-1	KEY SHEET
S-2	SIGNATURE SHEET
S-3 - S-4	TABULATION OF QUANTITIES
S-5	GENERAL NOTES
S-6 - S-21	SIGNING AND PAVEMENT MARKING PLAN
S-22	GUIDE SIGN WORK SHEET
S-23	SIGN CROSS SECTION SHEET

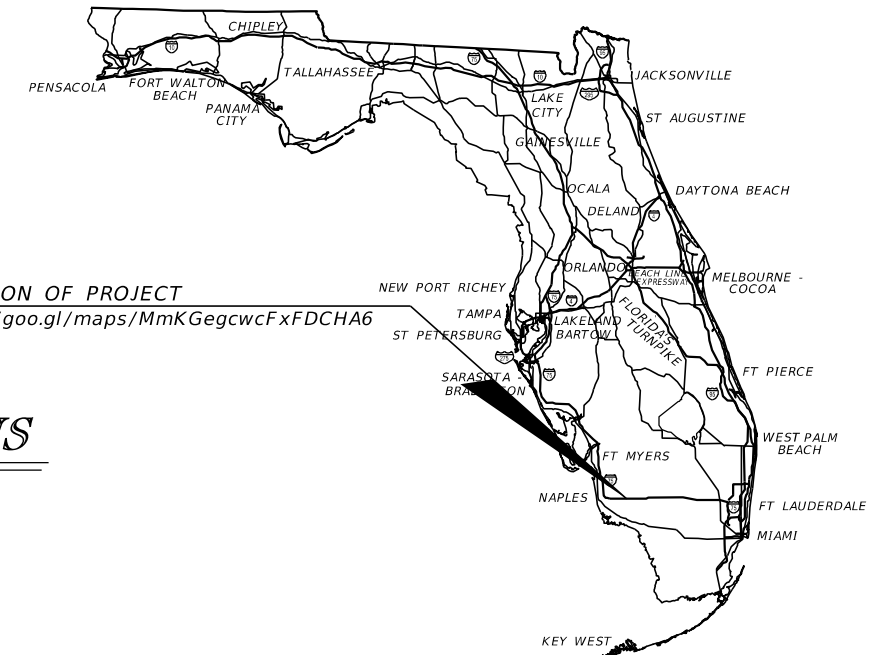

LOCATION OF PROJECT

<https://goo.gl/maps/MmKGegcwcFxFDCHA6>

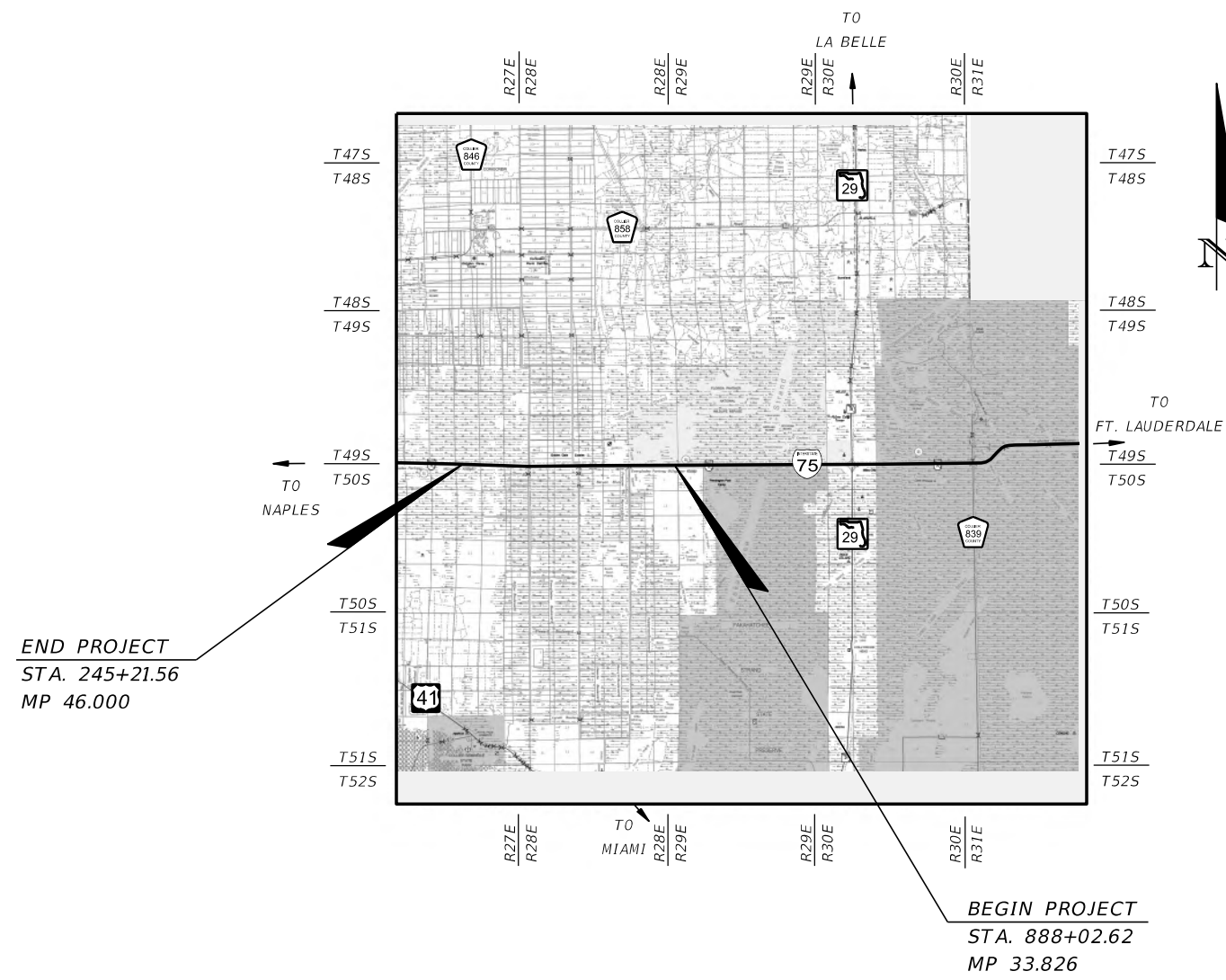

**SIGNING AND
PAVEMENT MARKING PLANS
ENGINEER OF RECORD:**

PATRICIA T. CHRISTIE, P.E. NO.: 60049
FALLER, DAVIS & ASSOCIATES, INC.
4200 W. CYPRESS ST., SUITE 500
TAMPA, FLORIDA 33607-4168
(813) 261-5136
CONTRACT NO. C9W44
VENDOR NO. F592594956001

FDOT PROJECT MANAGER:

JEFFREY JONES, P.E.

PHASE IIR SUBMITTAL
OCTOBER 20, 2022

CONSTRUCTION CONTRACT NO.	FISCAL YEAR	SHEET NO.
	25	S-1

THE OFFICIAL RECORD OF THIS SHEET IS THE ELECTRONIC FILE DIGITALLY SIGNED AND SEALED UNDER RULE 61G15-23.004, F.A.C.

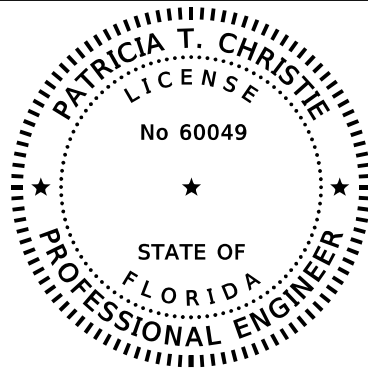

THIS ITEM HAS BEEN DIGITALLY
SIGNED AND SEALED BY

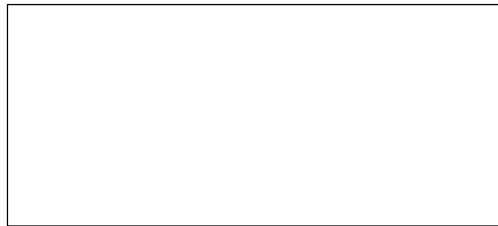

ON THE DATE ADJACENT TO THE SEAL

PRINTED COPIES OF THIS DOCUMENT ARE
NOT CONSIDERED SIGNED AND SEALED
AND THE SIGNATURE MUST BE VERIFIED
ON ANY ELECTRONIC COPIES.

FALLER, DAVIS & ASSOCIATES, INC
4200 W. CYPRESS ST., SUITE 500
TAMPA, FLORIDA 33607-4168
PATRICIA T. CHRISTIE, P.E. NO.: 60049

THE ABOVE NAMED PROFESSIONAL ENGINEER SHALL BE RESPONSIBLE FOR THE
FOLLOWING SHEETS IN ACCORDANCE WITH RULE 61G15-23.004, F.A.C.

<u>SHEET NO.</u>	<u>SHEET DESCRIPTION</u>
S-1	KEY SHEET
S-2	SIGNATURE SHEET
S-3 - S-4	TABULATION OF QUANTITIES
S-5	GENERAL NOTES
S-6 - S-21	SIGNING AND PAVEMENT MARKING PLAN
S-22	GUIDE SIGN WORK SHEET
S-23	SIGN CROSS SECTION SHEET

REVISIONS				PATRICIA T. CHRISTIE, P.E. P.E. NO.: 60049 FALLER, DAVIS & ASSOCIATES, INC. 4200 W. CYPRESS ST., SUITE 500 TAMPA, FLORIDA 33607-4168	STATE OF FLORIDA DEPARTMENT OF TRANSPORTATION			SIGNATURE SHEET	SHEET NO.
DATE	DESCRIPTION	DATE	DESCRIPTION		ROAD NO.	COUNTY	FINANCIAL PROJECT ID		S-2
					SR 93	COLLIER	444008-4-52-01		

TABULATION OF QUANTITIES

PAY ITEM NO.	DESCRIPTION	UNIT	SHEET NUMBERS																TOTAL THIS SHEET	
			S-6		S-7		S-8		S-9		S-10		S-11		S-12		S-13		PLAN	FINAL
			PLAN	FINAL	PLAN	FINAL	PLAN	FINAL	PLAN	FINAL	PLAN	FINAL	PLAN	FINAL	PLAN	FINAL	PLAN	FINAL		
700-1-11	SINGLE POST SIGN (F&I) (UP TO 12 SF)	AS	15		16		10		8		2		2				2		55	
700-1-12	SINGLE POST SIGN (F&I) (12-20 SF)	AS	6		2														8	
700-1-14	SINGLE POST SIGN (F&I) (31+ SF)	AS			1														1	
700-1-60	SINGLE POST SIGN (REMOVE)	AS	17		5		4		4								1		31	
700-2-15	MULTI-POST SIGN (F&I) (51-100 SF)	AS															1		1	
700-3-106	SIGN PANEL (F&I GROUND MOUNT) (101-200 SF)	EA	1																1	
700-3-606	SIGN PANEL (REMOVE) (101-200 SF)	EA	1																1	
700-13-15	RETROREFLECTIVE SIGN STRIP (F&I) (5')	EA	8											2			3		13	
701-18-101	PROFILED THERMOPLASTIC (STD) (ASPHALT) (WHITE) (SOLID) (6")	GM	1.908		2.121		2.121		1.801		0.215		0.133		0.005		0.179		8.483	
701-18-201	PROFILED THERMOPLASTIC (STD) (ASPHALT) (YELLOW) (SOLID) (6")	GM	1.908		2.121		2.121		1.801		0.265		0.265		0.265		0.265		9.011	
705-10-3	OBJECT MARKER (TYPE 3)	EA							4										4	
705-11-2	DELINEATOR (NON-FLEXIBLE)	EA	2																2	
706-1-3	RAISED PAVEMENT MARKER (TYPE B) (W/R)	EA	252		280		280		240		41		79		117		78		1367	
	RAISED PAVEMENT MARKER (TYPE B) (Y/Y)	EA	12														3		15	
710-90	PAINTED PAVEMENT MARKINGS - FINAL SURFACE	LS																		
*	PAINTED PAVEMENT MARKINGS (WHITE) (SOLID) (12")	GM												0.016		0.040			0.056	
*	PAINTED PAVEMENT MARKINGS (WHITE) (SOLID) (18")	LF														61			61	
*	PAINTED PAVEMENT MARKINGS (WHITE) (SOLID) (6")	GM	1.908		2.121		2.121		1.801		0.265		0.265		0.265		0.262		9.008	
*	PAINTED PAVEMENT MARKINGS (WHITE) (SOLID) (8")	GM												0.036		0.059			0.095	
*	PAINTED PAVEMENT MARKINGS (WHITE) (SKIP) (6") (10'-30')	GM	1.908		2.121		2.121		1.801		0.265		0.265		0.265		0.265		9.011	
*	PAINTED PAVEMENT MARKINGS (WHITE) (SKIP) (6") (3'-9')	GM											0.115		0.148				0.263	
*	PAINTED PAVEMENT MARKINGS (YELLOW) (SOLID) (6")	GM	1.908		2.121		2.121		1.801		0.265		0.265		0.265		0.265		9.011	
711-11-102	THERMOPLASTIC (STD) (WHITE) (SOLID) (8" FOR INTERCHANGE AND URBAN ISLAND)	GM													0.036		0.059		0.095	
711-11-103	THERMOPLASTIC (STD) (WHITE) (SOLID) (12" FOR INTERCHANGE MARKINGS)	GM												0.016		0.040			0.056	
711-11-124	THERMOPLASTIC (STD) (WHITE) (SOLID) (18")	LF														61			61	
711-15-101	THERMOPLASTIC (STD-OPEN) (WHITE) (SOLID) (6")	GM									0.050		0.133		0.260		0.083		0.526	
711-15-102	THERMOPLASTIC (STD-OPEN) (WHITE) (SOLID) (8")	GM														0.095			0.095	
711-15-131	THERMOPLASTIC (STD-OPEN) (WHITE) (SKIP) (6") (10'-30')	GM	1.908		2.121		2.121		1.801		0.265		0.265		0.265		0.265		9.011	
	THERMOPLASTIC (STD-OPEN) (WHITE) (SKIP) (6") (3'-9')	GM											0.115		0.148				0.263	
713-103-101	PERMANENT TAPE (WHITE) (SOLID) (6")	GM							0.017										0.017	
713-103-201	PERMANENT TAPE (YELLOW) (SOLID) (6")	GM							0.017										0.017	
713-103-131	PERMANENT TAPE (WHITE) (SKIP/DOTTED) (6" FOR CONCRETE SURFACES)	GM							0.009										0.009	
713-103-331	PERMANENT TAPE (BLACK) (SKIP/DOTTED) (6" FOR CONCRETE SURFACES)	GM							0.009										0.009	

* THESE QUANTITIES ARE PAID FOR UNDER PAINTED PAVEMENT MARKINGS (FINAL SURFACE) LUMP SUM - ITEM NO. 710-90. THE QUANTITIES SHOWN ARE FOR ONE APPLICATION; SEE SPECIFICATION 710 FOR THE NUMBER OF APPLICATIONS REQUIRED.

<table border="1"> <thead> <tr> <th colspan="4">REVISIONS</th> </tr> <tr> <th>DATE</th> <th>DESCRIPTION</th> <th>DATE</th> <th>DESCRIPTION</th> </tr> </thead> <tbody> <tr> <td> </td> <td> </td> <td> </td> <td> </td> </tr> </tbody> </table>				REVISIONS				DATE	DESCRIPTION	DATE	DESCRIPTION					PATRICIA T. CHRISTIE, P.E. P.E. NO.: 60049 FALLER, DAVIS & ASSOCIATES, INC. 4200 W. CYPRESS ST., SUITE 500 TAMPA, FLORIDA 33607-4168	STATE OF FLORIDA DEPARTMENT OF TRANSPORTATION <table border="1"> <tr> <th>ROAD NO.</th> <th>COUNTY</th> <th>FINANCIAL PROJECT ID</th> </tr> <tr> <td>SR 93</td> <td>COLLIER</td> <td>444008-4-52-01</td> </tr> </table>	ROAD NO.	COUNTY	FINANCIAL PROJECT ID	SR 93	COLLIER	444008-4-52-01	TABULATION OF QUANTITIES (1)	SHEET NO. S-3
REVISIONS																									
DATE	DESCRIPTION	DATE	DESCRIPTION																						
ROAD NO.	COUNTY	FINANCIAL PROJECT ID																							
SR 93	COLLIER	444008-4-52-01																							

TABULATION OF QUANTITIES

PAY ITEM NO.	DESCRIPTION	UNIT	SHEET NUMBERS																TOTAL THIS SHEET		GRAND TOTAL	
			S-14		S-15		S-16		S-17		S-18		S-19		S-20		S-21		PLAN	FINAL	PLAN	FINAL
			PLAN	FINAL	PLAN	FINAL	PLAN	FINAL	PLAN	FINAL	PLAN	FINAL	PLAN	FINAL	PLAN	FINAL						
700-1-11	SINGLE POST SIGN (F&I) (UP TO 12 SF)	AS	10		12		10		14		12		10		10		10		88		143	
700-1-12	SINGLE POST SIGN (F&I) (12-20 SF)	AS	6					6						2		6		20		28		
700-1-14	SINGLE POST SIGN (F&I) (31+ SF)	AS												1				1		2		
700-1-60	SINGLE POST SIGN (REMOVE)	AS	6		4		6		8		4		16		7		4		55		86	
700-2-15	MULTI-POST SIGN (F&I) (51-100 SF)	AS																		1		
700-3-106	SIGN PANEL (F&I GROUND MOUNT) (101-200 SF)	EA								1								1		2		
700-3-606	SIGN PANEL (REMOVE) (101-200 SF)	EA								1								1		2		
700-13-15	RETROREFLECTIVE SIGN STRIP (F&I) (5')	EA	8						8								8		24		37	
701-18-101	PROFILED THERMOPLASTIC (STD) (ASPHALT) (WHITE) (SOLID) (6")	GM	1.364		2.102		2.121		2.121		2.121		2.121		2.121		1.246		15.317		23.800	
701-18-201	PROFILED THERMOPLASTIC (STD) (ASPHALT) (YELLOW) (SOLID) (6")	GM	1.364		2.102		2.121		2.121		2.121		2.121		2.121		1.246		15.317		24.328	
705-10-3	OBJECT MARKER (TYPE 3)	EA			4				4		4		4		4		2		22		26	
705-11-2	DELINEATOR (NON-FLEXIBLE)	EA	2						2									4		6		
706-1-3	RAISED PAVEMENT MARKER (TYPE B) (W/R)	EA	180		280		280		280		280		280		280		170		2030		3445	
	RAISED PAVEMENT MARKER (TYPE B) (Y/Y)	EA	9						12						5		7		33			
710-90	PAINTED PAVEMENT MARKINGS - FINAL SURFACE	LS																			1	
*	PAINTED PAVEMENT MARKINGS (WHITE) (SOLID) (12")	GM																			0.056	
*	PAINTED PAVEMENT MARKINGS (WHITE) (SOLID) (18")	LF																			61	
*	PAINTED PAVEMENT MARKINGS (WHITE) (SOLID) (6")	GM	1.364		2.102		2.121		2.121		2.121		2.121		2.121		1.246		15.317		24.325	
*	PAINTED PAVEMENT MARKINGS (WHITE) (SOLID) (8")	GM																	0.095		0.190	
*	PAINTED PAVEMENT MARKINGS (WHITE) (SKIP) (6") (10'-30')	GM	1.364		2.102		2.121		2.121		2.121		2.121		2.121		1.246		15.317		24.328	
*	PAINTED PAVEMENT MARKINGS (WHITE) (SKIP) (6") (3'-9')	GM																			0.263	
*	PAINTED PAVEMENT MARKINGS (YELLOW) (SOLID) (6")	GM	1.364		2.102		2.121		2.121		2.121		2.121		2.121		1.246		15.317		24.328	
711-11-102	THERMOPLASTIC (STD) (WHITE) (SOLID) (8" FOR INTERCHANGE AND URBAN ISLAND)	GM																			0.095	
711-11-103	THERMOPLASTIC (STD) (WHITE) (SOLID) (12" FOR INTERCHANGE MARKINGS)	GM																			0.082	
711-11-124	THERMOPLASTIC (STD) (WHITE) (SOLID) (18")	LF																			61	
711-15-101	THERMOPLASTIC (STD-OPEN) (WHITE) (SOLID) (6")	GM																			0.526	
711-15-102	THERMOPLASTIC (STD-OPEN) (WHITE) (SOLID) (8")	GM																			0.095	
711-15-131	THERMOPLASTIC (STD-OPEN) (WHITE) (SKIP) (6") (10'-30')	GM	1.364		2.102		2.121		2.121		2.121		2.121		2.121		1.246		15.317		24.591	
	THERMOPLASTIC (STD-OPEN) (WHITE) (SKIP) (6") (3'-9')	GM																				
713-103-101	PERMANENT TAPE (WHITE) (SOLID) (6")	GM			0.019												0.046		0.065		0.082	
713-103-201	PERMANENT TAPE (YELLOW) (SOLID) (6")	GM			0.019												0.046		0.065		0.082	
713-103-131	PERMANENT TAPE (WHITE) (SKIP/DOTTED) (6" FOR CONCRETE SURFACES)	GM			0.009												0.046		0.055		0.064	
713-103-331	PERMANENT TAPE (BLACK) (SKIP/DOTTED) (6" FOR CONCRETE SURFACES)	GM			0.009												0.046		0.055		0.064	

* THESE QUANTITIES ARE PAID FOR UNDER PAINTED PAVEMENT MARKINGS (FINAL SURFACE) LUMP SUM - ITEM NO. 710-90. THE QUANTITIES SHOWN ARE FOR ONE APPLICATION; SEE SPECIFICATION 710 FOR THE NUMBER OF APPLICATIONS REQUIRED.

<table border="1"> <thead> <tr> <th colspan="4">REVISIONS</th> </tr> <tr> <th>DATE</th> <th>DESCRIPTION</th> <th>DATE</th> <th>DESCRIPTION</th> </tr> </thead> <tbody> <tr> <td> </td> <td> </td> <td> </td> <td> </td> </tr> </tbody> </table>				REVISIONS				DATE	DESCRIPTION	DATE	DESCRIPTION					PATRICIA T. CHRISTIE, P.E. P.E. NO.: 60049 FALLER, DAVIS & ASSOCIATES, INC. 4200 W. CYPRESS ST., SUITE 500 TAMPA, FLORIDA 33607-4168	STATE OF FLORIDA DEPARTMENT OF TRANSPORTATION <table border="1"> <tr> <th>ROAD NO.</th> <th>COUNTY</th> <th>FINANCIAL PROJECT ID</th> </tr> <tr> <td>SR 93</td> <td>COLLIER</td> <td>444008-4-52-01</td> </tr> </table>	ROAD NO.	COUNTY	FINANCIAL PROJECT ID	SR 93	COLLIER	444008-4-52-01	TABULATION OF QUANTITIES (2)	SHEET NO. S-4
REVISIONS																									
DATE	DESCRIPTION	DATE	DESCRIPTION																						
ROAD NO.	COUNTY	FINANCIAL PROJECT ID																							
SR 93	COLLIER	444008-4-52-01																							

GENERAL NOTES:

1. REFERENCE THE ROADWAY GENERAL NOTES FOR LIST OF UTILITY OWNERS.
2. ALL LANES ARE 12 FEET WIDE UNLESS OTHERWISE NOTED.

PAY ITEM NOTES:

1. 705-11-2:
INSTALL OR REPLACE IF MISSING OR DAMAGED FROM LOCATIONS SHOWN IN THE PLANS.
REMOVAL OF EXISTING DELINEATORS ARE INCLUDED IN THE COST OF INSTALLING PROPOSED DELINEATORS.
2. 700-13-15:
PROVIDE A RED RETROREFLECTIVE SIGN STRIP FOR "WRONG WAY" AND "DO NOT ENTER" SIGNS AND WHITE FOR "ONE WAY" SIGNS.

ABBREVIATIONS:

PERM. PERMANENT
THERMO THERMOPLASTIC

BRIDGE DATA

Bridge No.	Direction	Start Station	End Station	Deck Surface
030214	I-75 NB	440+66.34	441+66.34	Asphalt
030217	I-75 NB	545+04.62	546+14.62	Asphalt
030218	I-75 NB	651+77.25	653+07.25	Asphalt
030219	I-75 NB	728+40.00	729+60.00	Asphalt
030220	I-75 NB	791+40.00	792+60.00	Asphalt
030222	I-75 NB	844+20.00	845+40.00	Asphalt
030223	I-75 NB	885+62.62	888+02.62	Concrete
030225	I-75 NB	900+40.00	901+60.00	Asphalt
030227	I-75 NB	932+40.00	933+60.00	Asphalt
030229	I-75 NB	955+50.00	956+70.00	Concrete
030230	I-75 NB	983+94.12	986+34.12	Concrete
030232	I-75 NB	1016+40.00	1017+60.00	Asphalt
030233	I-75 NB	1044+49.84	1045+79.84	Concrete
030235	I-75 NB	1077+40.00	1078+60.00	Asphalt
030239	I-75 NB	1242+40.00	1243+60.00	Asphalt
030241	I-75 NB	1294+40.00	1295+60.00	Concrete
030243	I-75 NB	1345+40.00	1346+60.00	Concrete

Bridge No.	Direction	Begin Station	End Station	Deck Surface
030001	I-75 SB	440+76.34	441+66.34	Concrete
030002	I-75 SB	545+14.62	546+14.62	Concrete
030003	I-75 SB	651+77.25	653+07.25	Asphalt
030215	I-75 SB	728+40.00	729+60.00	Asphalt
030216	I-75 SB	791+40.00	792+60.00	Asphalt
030221	I-75 SB	844+20.00	845+40.00	Asphalt
030005	I-75 SB	885+62.62	888+02.62	Asphalt
030224	I-75 SB	900+40.00	901+60.00	Asphalt
030226	I-75 SB	932+40.00	933+60.00	Asphalt
030228	I-75 SB	955+50.00	956+70.00	Asphalt
030006	I-75 SB	983+94.12	986+34.12	Asphalt
030231	I-75 SB	1016+40.00	1017+60.00	Asphalt
030007	I-75 SB	1044+49.84	1045+79.84	Concrete
030234	I-75 SB	1077+40.00	1078+60.00	Concrete
030240	I-75 SB	1242+40.00	1243+60.00	Asphalt
030242	I-75 SB	1294+40.00	1295+60.00	Asphalt
030244	I-75 SB	1345+40.00	1346+60.00	Asphalt

REVISIONS				PATRICIA T. CHRISTIE, P.E. P.E. NO.: 60049 FALLER, DAVIS & ASSOCIATES, INC. 4200 W. CYPRESS ST., SUITE 500 TAMPA, FLORIDA 33607-4168	STATE OF FLORIDA DEPARTMENT OF TRANSPORTATION			GENERAL NOTES	SHEET NO.
DATE	DESCRIPTION	DATE	DESCRIPTION		ROAD NO.	COUNTY	FINANCIAL PROJECT ID		
						SR 93	COLLIER		444008-4-52-01

THE OFFICIAL RECORD OF THIS SHEET IS THE ELECTRONIC FILE DIGITALLY SIGNED AND SEALED UNDER RULE 61G15-23.004, F.A.C.

BEGIN CONSTRUCTION
 BEGIN SIGNING AND PAVEMENT MARKINGS SB
 MEET AND MATCH EXISTING MARKINGS

STA. 242+00.00 @ SURVEY SR 93

SR 93 (I-75)

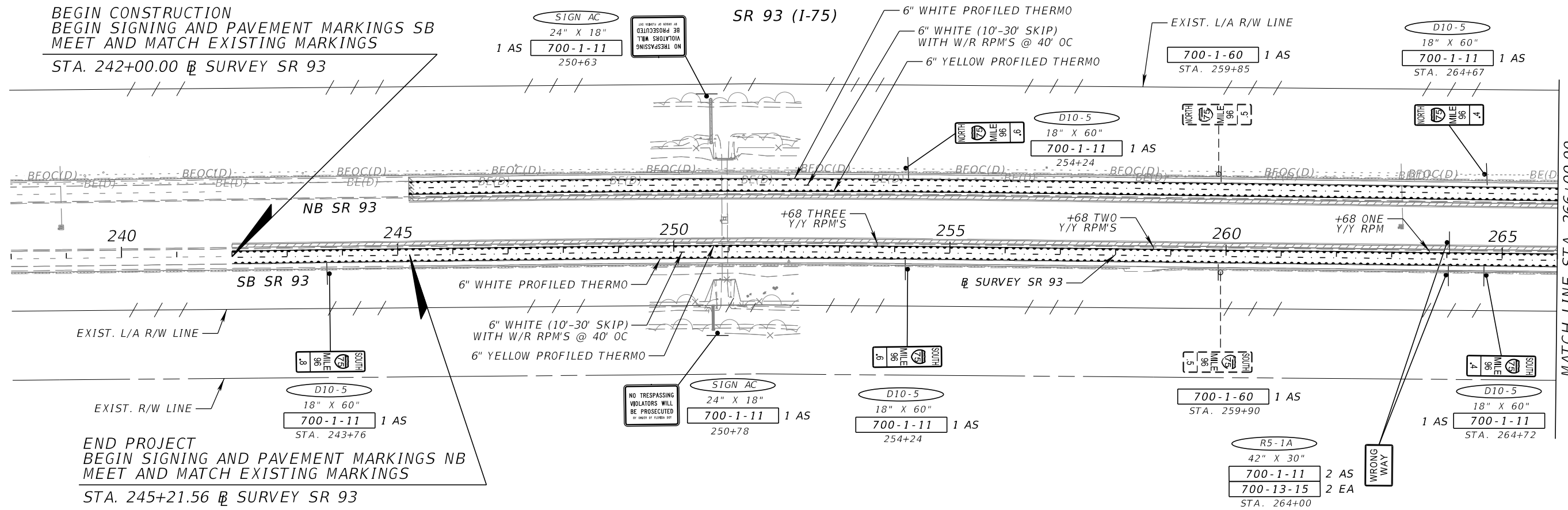

END PROJECT
 BEGIN SIGNING AND PAVEMENT MARKINGS NB
 MEET AND MATCH EXISTING MARKINGS

STA. 245+21.56 @ SURVEY SR 93

MATCH LINE STA. 266+00.00



SR 93 (I-75)

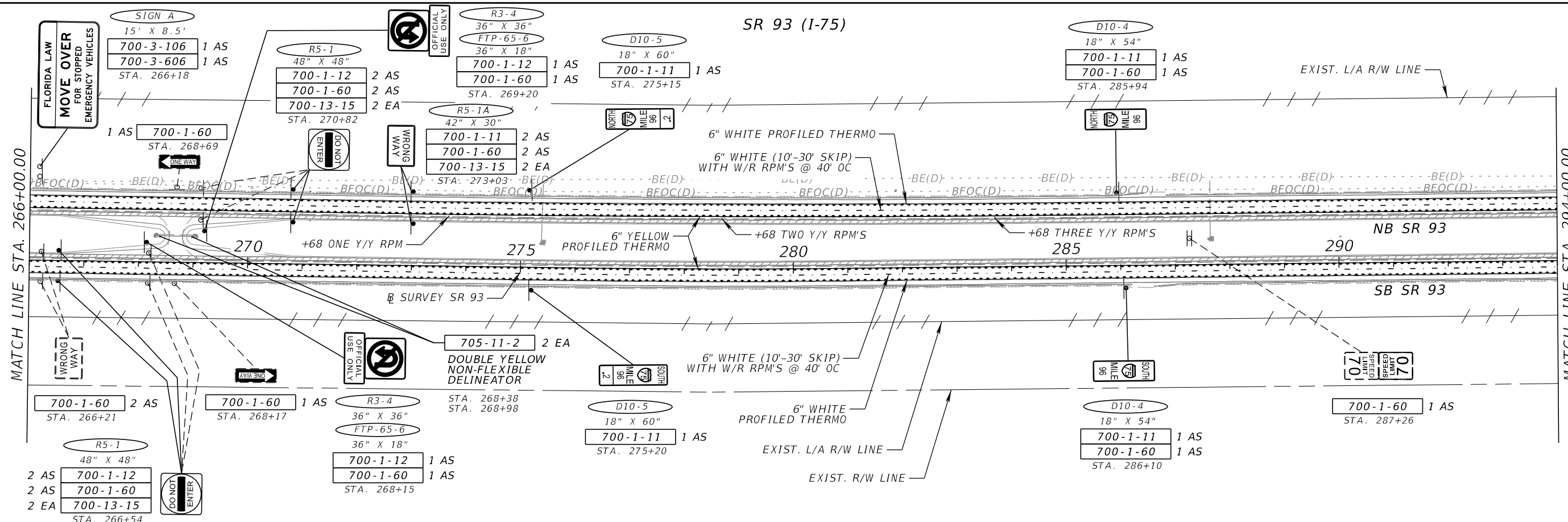

MATCH LINE STA. 266+00.00

MATCH LINE STA. 294+00.00



REVISIONS			
DATE	DESCRIPTION	DATE	DESCRIPTION

PATRICIA T. CHRISTIE, P.E.
 P.E. NO.: 60049
 FALLER, DAVIS & ASSOCIATES, INC.
 4200 W. CYPRESS ST., SUITE 500
 TAMPA, FLORIDA 33607-4168

STATE OF FLORIDA DEPARTMENT OF TRANSPORTATION		
ROAD NO.	COUNTY	FINANCIAL PROJECT ID
SR 93	COLLIER	444008-4-52-01

**SIGNING AND PAVEMENT
 MARKING PLAN (1)**

SHEET NO.
 S-6

THE OFFICIAL RECORD OF THIS SHEET IS THE ELECTRONIC FILE DIGITALLY SIGNED AND SEALED UNDER RULE 61G15-23.004, F.A.C.

MATCH LINE STA. 294+00.00

MATCH LINE STA. 322+00.00

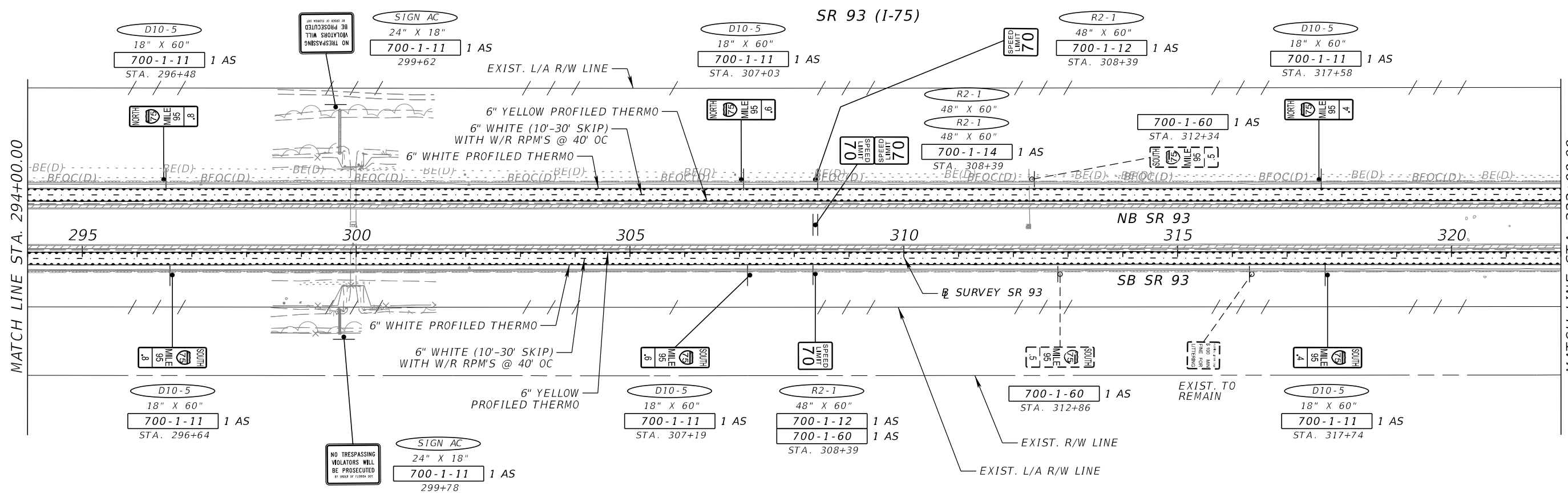

MATCH LINE STA. 322+00.00

MATCH LINE STA. 350+00.00

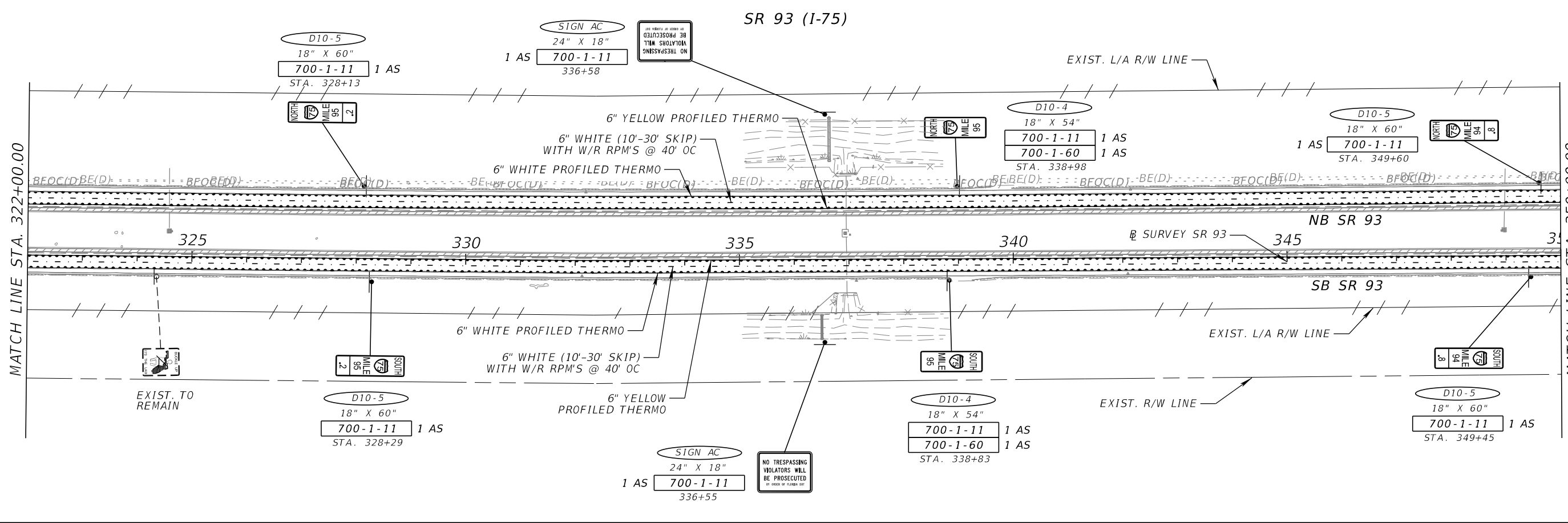

REVISIONS			
DATE	DESCRIPTION	DATE	DESCRIPTION

PATRICIA T. CHRISTIE, P.E.
 P.E. NO.: 60049
 FALLER, DAVIS & ASSOCIATES, INC.
 4200 W. CYPRESS ST., SUITE 500
 TAMPA, FLORIDA 33607-4168

STATE OF FLORIDA DEPARTMENT OF TRANSPORTATION		
ROAD NO.	COUNTY	FINANCIAL PROJECT ID
SR 93	COLLIER	444008-4-52-01

**SIGNING AND PAVEMENT
MARKING PLAN (2)**

SHEET NO.
S-7

THE OFFICIAL RECORD OF THIS SHEET IS THE ELECTRONIC FILE DIGITALLY SIGNED AND SEALED UNDER RULE 61G15-23.004, F.A.C.

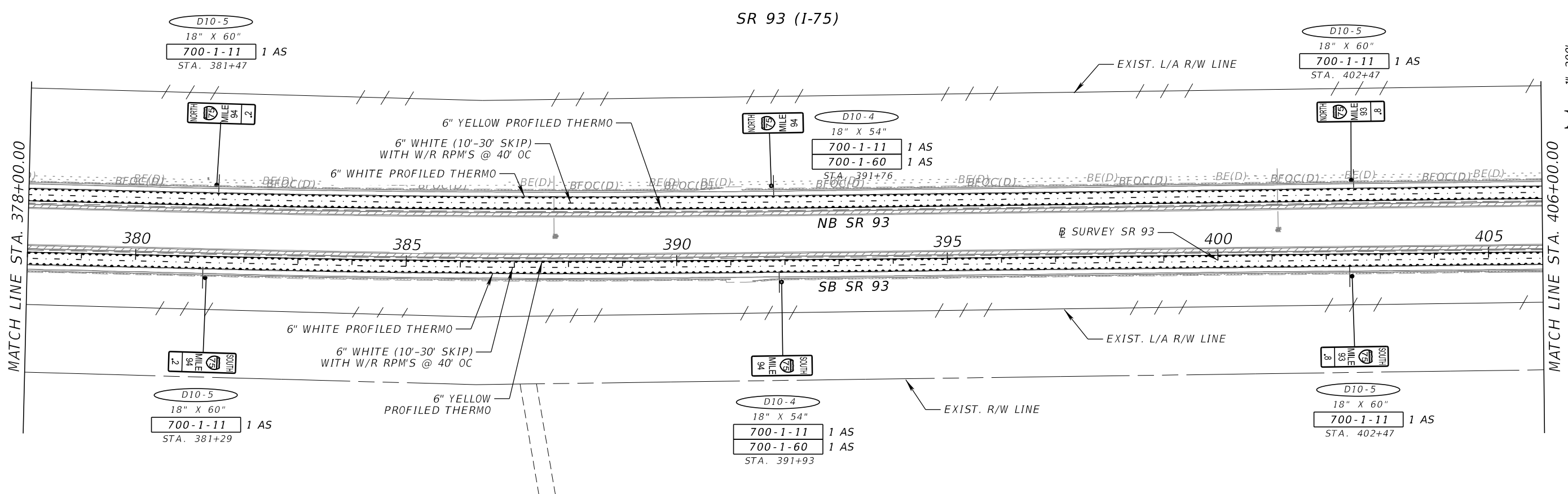
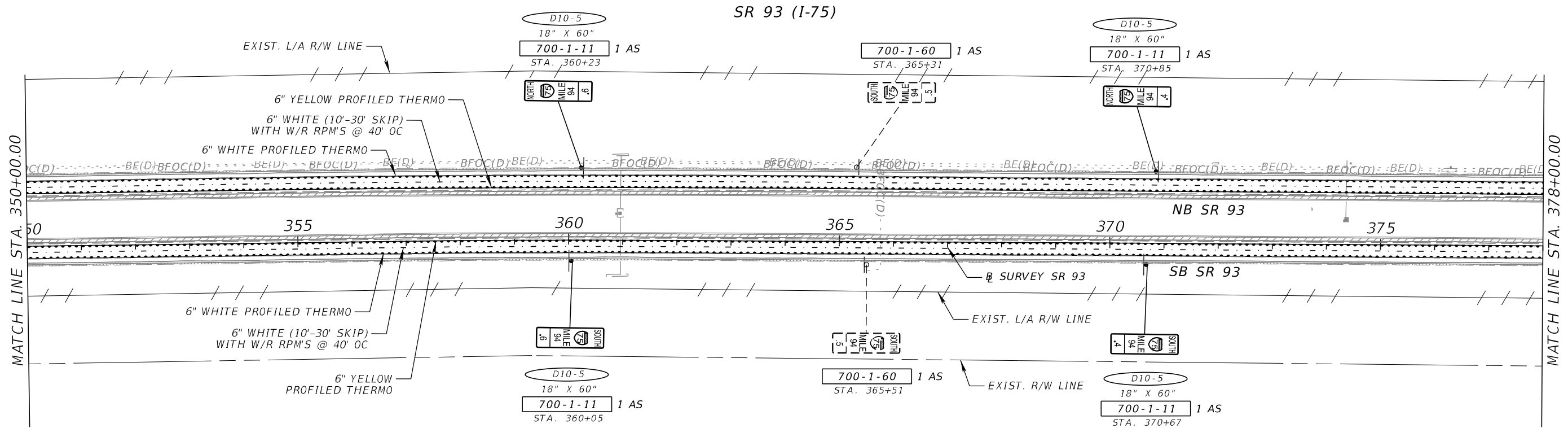

REVISIONS			
DATE	DESCRIPTION	DATE	DESCRIPTION

PATRICIA T. CHRISTIE, P.E.
P.E. NO.: 60049
FALLER, DAVIS & ASSOCIATES, INC.
4200 W. CYPRESS ST., SUITE 500
TAMPA, FLORIDA 33607-4168

STATE OF FLORIDA DEPARTMENT OF TRANSPORTATION		
ROAD NO.	COUNTY	FINANCIAL PROJECT ID
SR 93	COLLIER	444008-4-52-01

**SIGNING AND PAVEMENT
MARKING PLAN (3)**

SHEET NO.
S-8

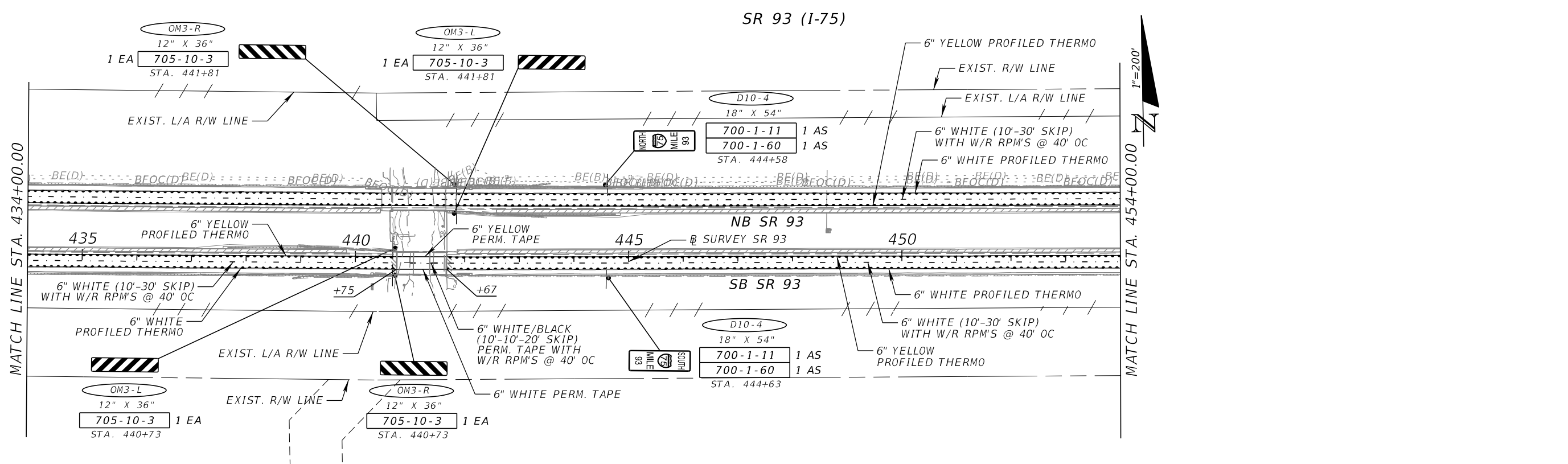
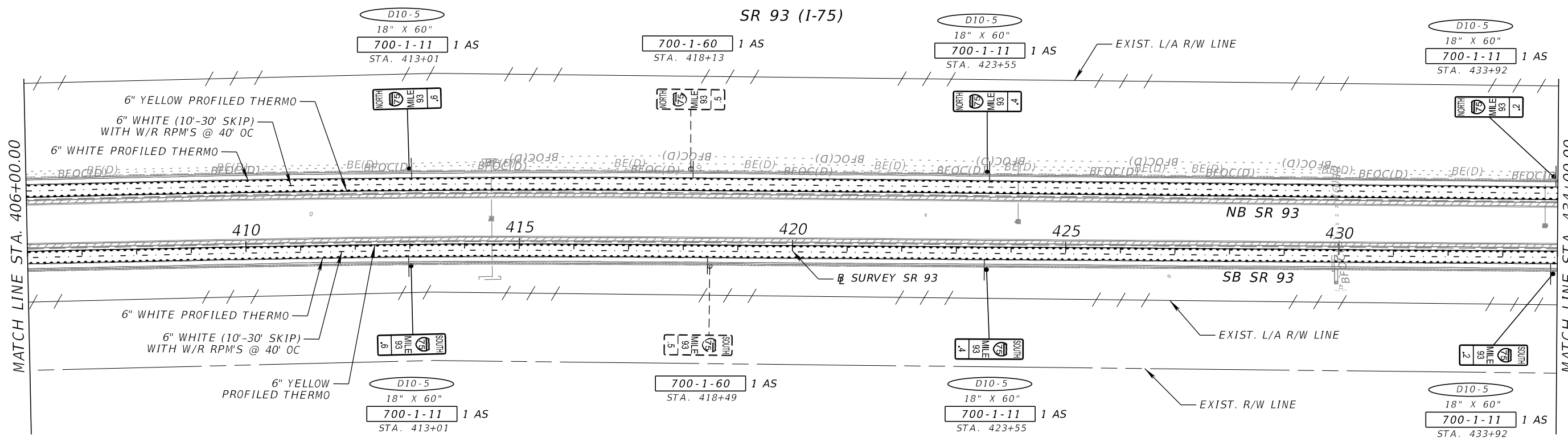

REVISIONS			
DATE	DESCRIPTION	DATE	DESCRIPTION

PATRICIA T. CHRISTIE, P.E.
P.E. NO.: 60049
FALLER, DAVIS & ASSOCIATES, INC.
4200 W. CYPRESS ST., SUITE 500
TAMPA, FLORIDA 33607-4168

STATE OF FLORIDA DEPARTMENT OF TRANSPORTATION		
ROAD NO.	COUNTY	FINANCIAL PROJECT ID
SR 93	COLLIER	444008-4-52-01

**SIGNING AND PAVEMENT
MARKING PLAN (4)**

SHEET NO.
S-9

THE OFFICIAL RECORD OF THIS SHEET IS THE ELECTRONIC FILE DIGITALLY SIGNED AND SEALED UNDER RULE 61G15-23.004, F.A.C.

EXIST. L/A R/W LINE

SR 93 (I-75)

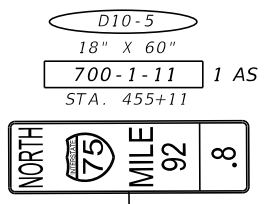

6" WHITE PROFILED THERMO
6" WHITE (10'-30' SKIP)
WITH W/R RPM'S @ 40' OC

+34 END 6" PROFILED WHITE
BEGIN 6" WHITE

6" WHITE WITH W/R
RPM'S @ 40' OC

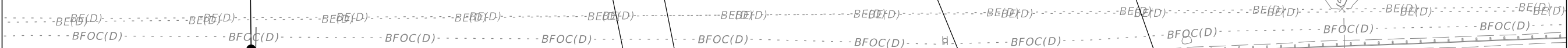

MATCH LINE STA. 454+00.00

MATCH LINE STA. 461+00.00

NB SR 93

6" YELLOW
PROFILED THERMO



SB SR 93

6" WHITE (10'-30' SKIP)
WITH W/R RPM'S @ 40' OC
6" WHITE PROFILED THERMO

⊕ SURVEY SR 93

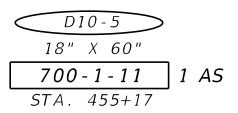
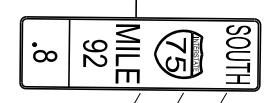

EXIST. L/A R/W LINE

REVISIONS				PATRICIA T. CHRISTIE, P.E. P.E. NO.: 60049 FALLER, DAVIS & ASSOCIATES, INC. 4200 W. CYPRESS ST., SUITE 500 TAMPA, FLORIDA 33607-4168	STATE OF FLORIDA DEPARTMENT OF TRANSPORTATION			SIGNING AND PAVEMENT MARKING PLAN (5)	SHEET NO.
DATE	DESCRIPTION	DATE	DESCRIPTION		ROAD NO.	COUNTY	FINANCIAL PROJECT ID		S-10
					SR 93	COLLIER	444008-4-52-01		

SR 93 (I-75)

EXIST. L/A R/W LINE



D10-5
18" X 60"
700-1-11 1 AS
STA. 465+65



6" WHITE WITH W/R
RPM'S @ 40' OC

6" WHITE (3'-9" SKIP) WITH
W/R RPM'S @ 24' OC

6" WHITE (10'-30" SKIP)
WITH W/R RPM'S @ 40' OC



+91
12'

NB SR 93

MATCH LINE STA. 461+00.00

MATCH LINE STA. 468+00.00

6" YELLOW
PROFILED THERMO

⊕ SURVEY SR 93



SB SR 93

6" WHITE (10'-30" SKIP)
WITH W/R RPM'S @ 40' OC

6" WHITE PROFILED THERMO

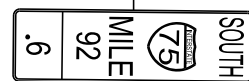

D10-5
18" X 60"
700-1-11 1 AS
STA. 465+71

EXIST. L/A R/W LINE

REVISIONS			
DATE	DESCRIPTION	DATE	DESCRIPTION

PATRICIA T. CHRISTIE, P.E.
P.E. NO.: 60049
FALLER, DAVIS & ASSOCIATES, INC.
4200 W. CYPRESS ST., SUITE 500
TAMPA, FLORIDA 33607-4168

STATE OF FLORIDA DEPARTMENT OF TRANSPORTATION		
ROAD NO.	COUNTY	FINANCIAL PROJECT ID
SR 93	COLLIER	444008-4-52-01

**SIGNING AND PAVEMENT
MARKING PLAN (6)**

SHEET
NO.
S-11

SR 93 (I-75)

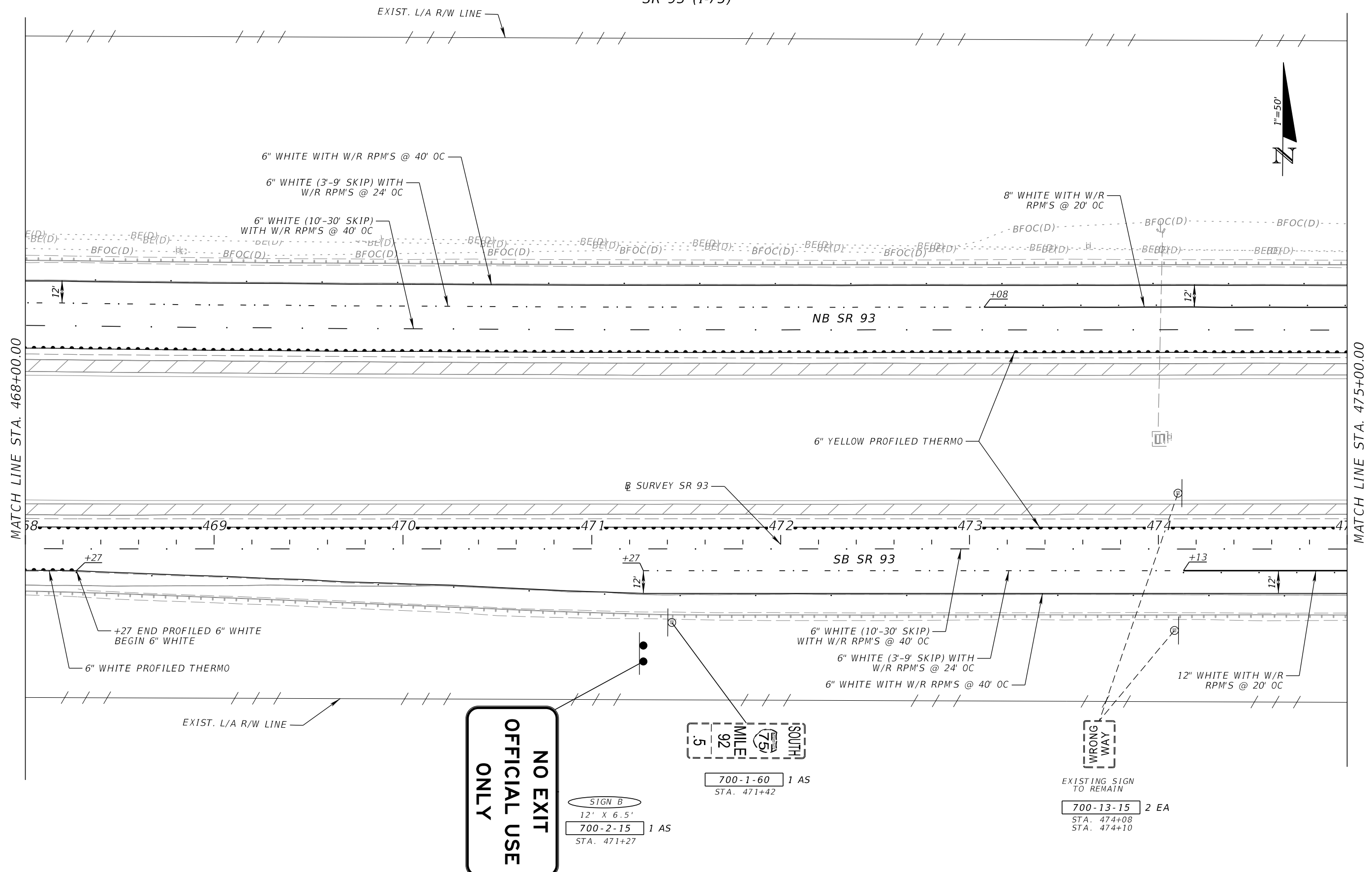

**NO EXIT
OFFICIAL USE
ONLY**

SIGN B
12' X 6.5'
700-2-15 1 AS
STA. 471+27

5
MILE
92
SOUTH
75
700-1-60 1 AS
STA. 471+42

EXISTING SIGN
TO REMAIN
700-13-15 2 EA
STA. 474+08
STA. 474+10

REVISIONS			
DATE	DESCRIPTION	DATE	DESCRIPTION

PATRICIA T. CHRISTIE, P.E.
P.E. NO.: 60049
FALLER, DAVIS & ASSOCIATES, INC.
4200 W. CYPRESS ST., SUITE 500
TAMPA, FLORIDA 33607-4168

STATE OF FLORIDA DEPARTMENT OF TRANSPORTATION		
ROAD NO.	COUNTY	FINANCIAL PROJECT ID
SR 93	COLLIER	444008-4-52-01

**SIGNING AND PAVEMENT
MARKING PLAN (7)**

SHEET
NO.
S-12

THE OFFICIAL RECORD OF THIS SHEET IS THE ELECTRONIC FILE DIGITALLY SIGNED AND SEALED UNDER RULE 61G15-23.004, F.A.C.

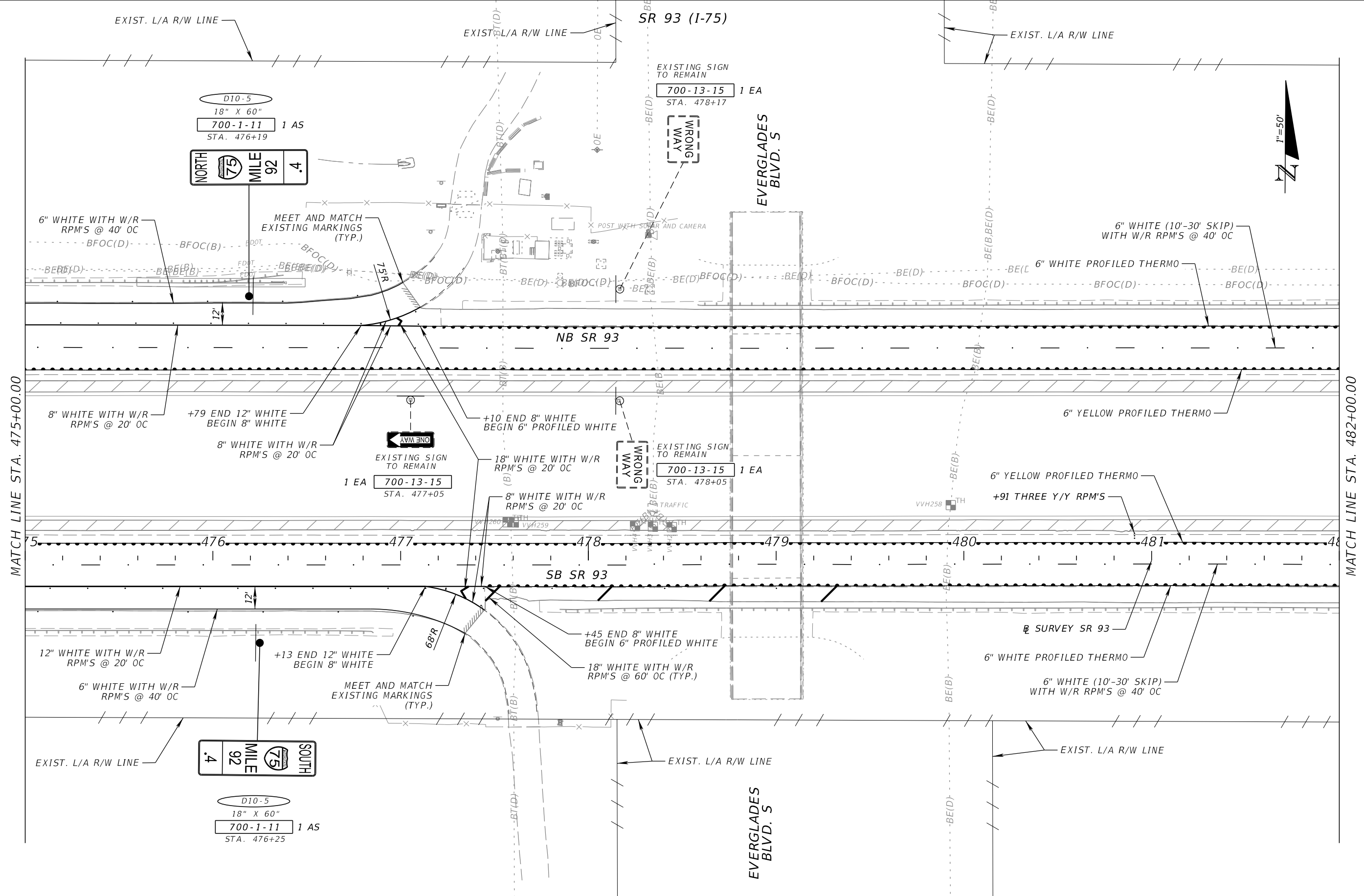

MATCH LINE STA. 475+00.00

MATCH LINE STA. 482+00.00

REVISIONS			
DATE	DESCRIPTION	DATE	DESCRIPTION

PATRICIA T. CHRISTIE, P.E.
P.E. NO.: 60049
FALLER, DAVIS & ASSOCIATES, INC.
4200 W. CYPRESS ST., SUITE 500
TAMPA, FLORIDA 33607-4168

STATE OF FLORIDA DEPARTMENT OF TRANSPORTATION		
ROAD NO.	COUNTY	FINANCIAL PROJECT ID
SR 93	COLLIER	444008-4-52-01

**SIGNING AND PAVEMENT
MARKING PLAN (8)**

SHEET NO.
S-13

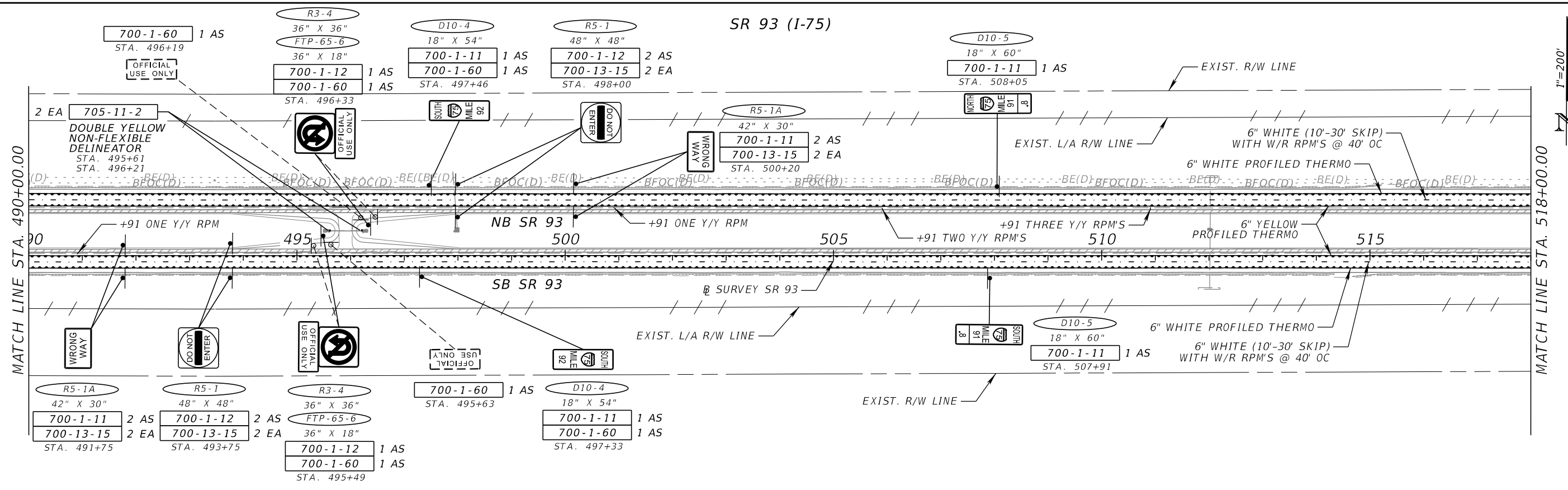
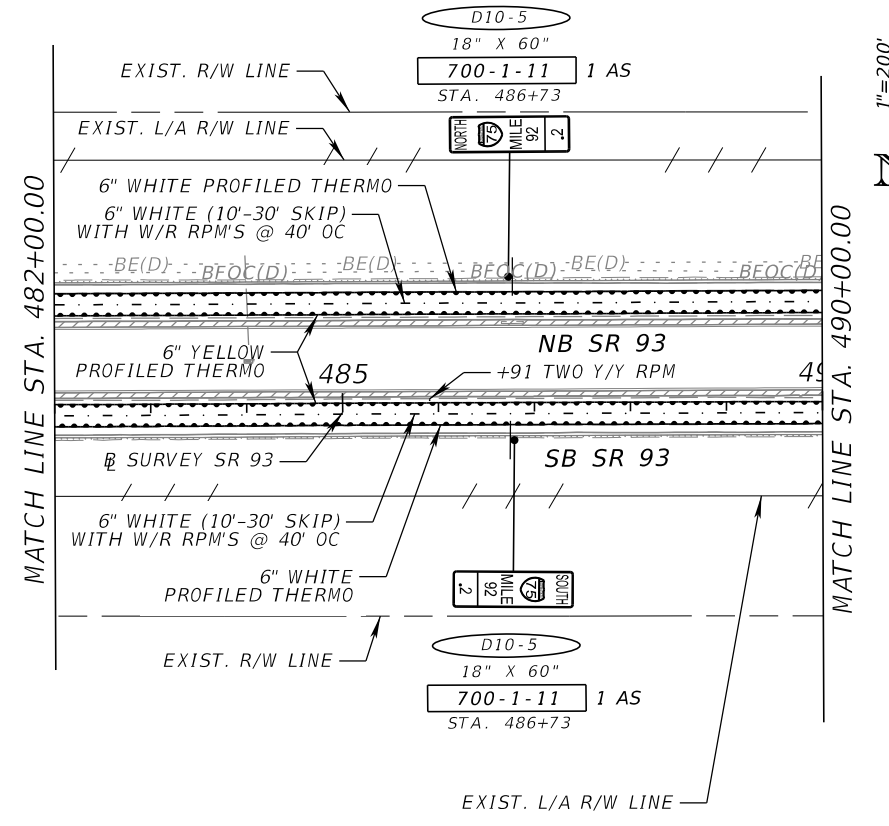

REVISIONS			
DATE	DESCRIPTION	DATE	DESCRIPTION

PATRICIA T. CHRISTIE, P.E.
 P.E. NO.: 60049
 FALLER, DAVIS & ASSOCIATES, INC.
 4200 W. CYPRESS ST., SUITE 500
 TAMPA, FLORIDA 33607-4168

STATE OF FLORIDA DEPARTMENT OF TRANSPORTATION		
ROAD NO.	COUNTY	FINANCIAL PROJECT ID
SR 93	COLLIER	444008-4-52-01

**SIGNING AND PAVEMENT
 MARKING PLAN (9)**

SHEET NO.
S-14

THE OFFICIAL RECORD OF THIS SHEET IS THE ELECTRONIC FILE DIGITALLY SIGNED AND SEALED UNDER RULE 61G15-23.004, F.A.C.

SR 93 (I-75)

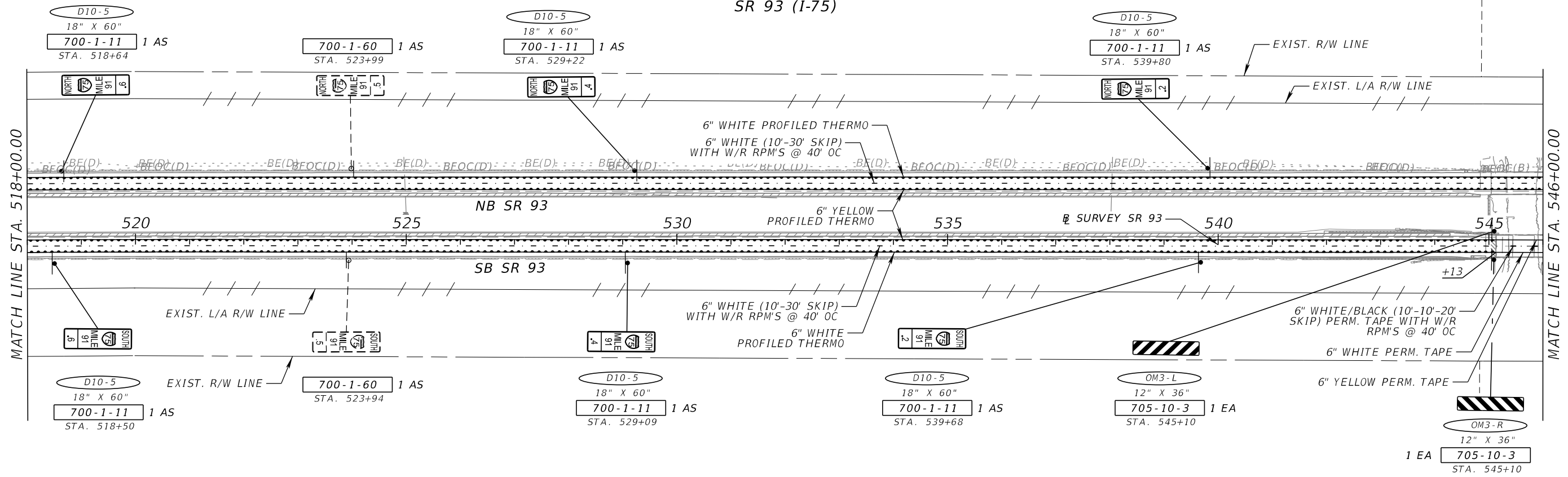

SR 93 (I-75)

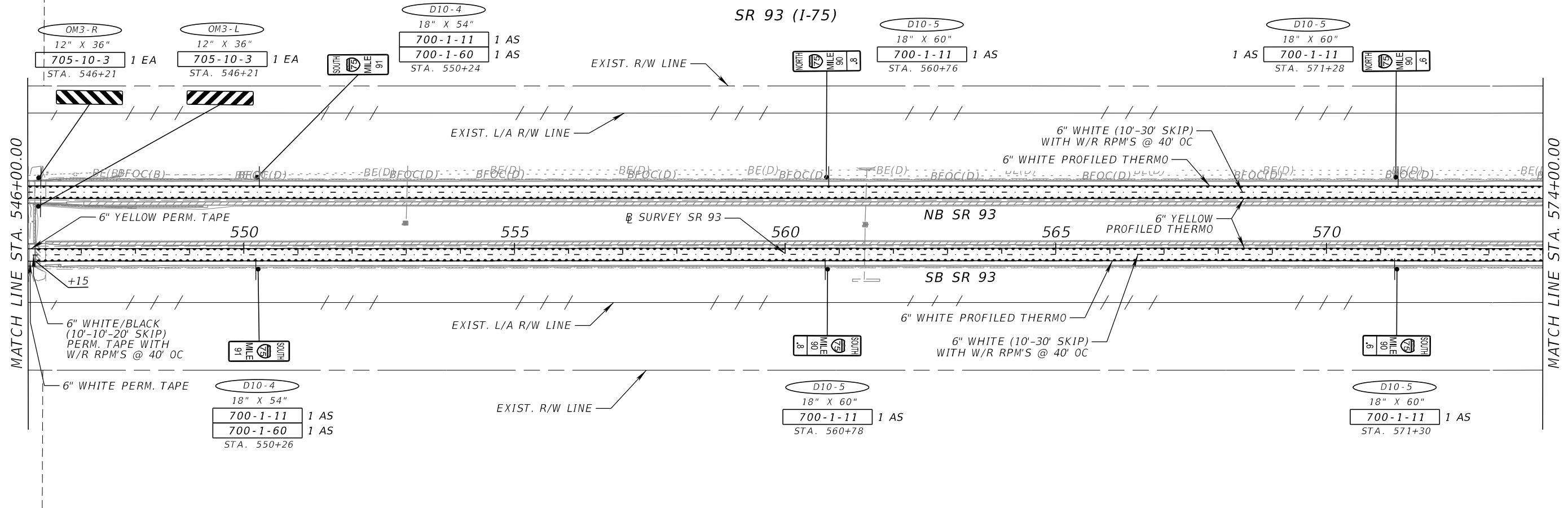

REVISIONS			
DATE	DESCRIPTION	DATE	DESCRIPTION

PATRICIA T. CHRISTIE, P.E.
 P.E. NO.: 60049
 FALLER, DAVIS & ASSOCIATES, INC.
 4200 W. CYPRESS ST., SUITE 500
 TAMPA, FLORIDA 33607-4168

STATE OF FLORIDA DEPARTMENT OF TRANSPORTATION		
ROAD NO.	COUNTY	FINANCIAL PROJECT ID
SR 93	COLLIER	444008-4-52-01

**SIGNING AND PAVEMENT
 MARKING PLAN (10)**

SHEET NO.
 S-15

THE OFFICIAL RECORD OF THIS SHEET IS THE ELECTRONIC FILE DIGITALLY SIGNED AND SEALED UNDER RULE 61G15-23.004, F.A.C.

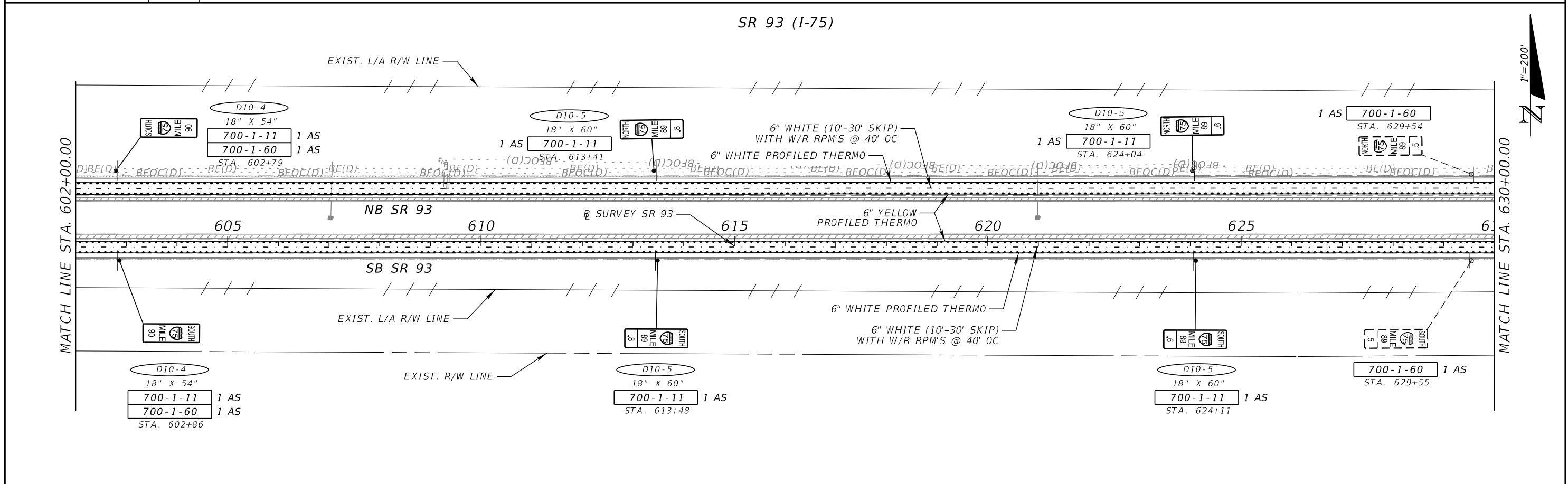
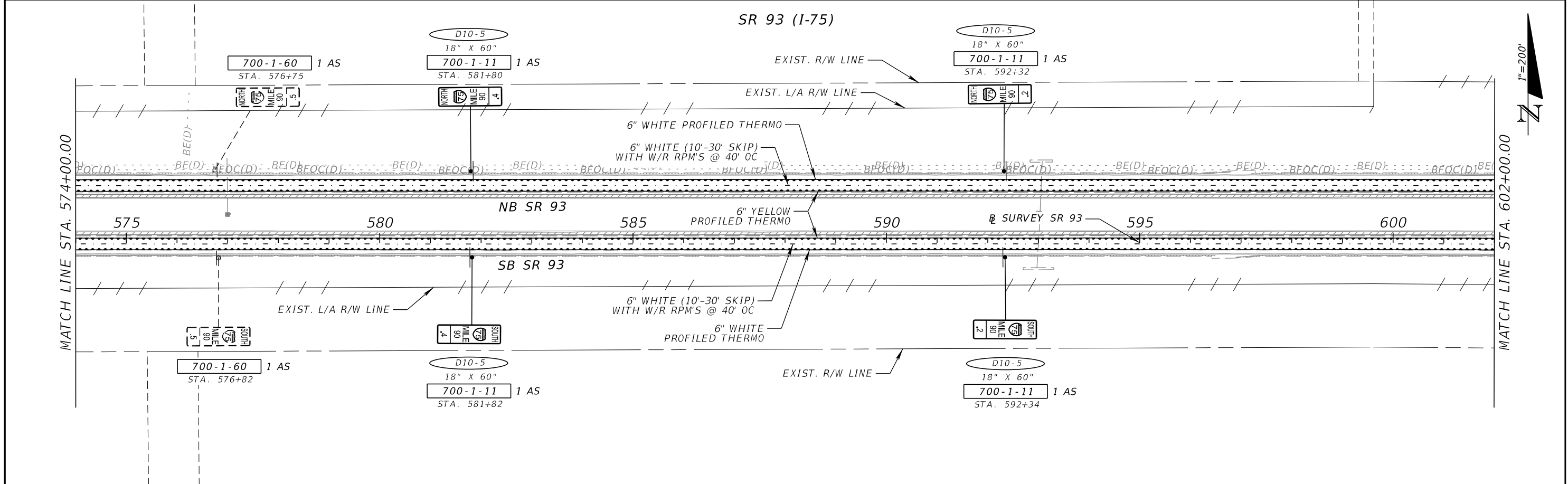

REVISIONS				PATRICIA T. CHRISTIE, P.E. P.E. NO.: 60049 FALLER, DAVIS & ASSOCIATES, INC. 4200 W. CYPRESS ST., SUITE 500 TAMPA, FLORIDA 33607-4168	STATE OF FLORIDA DEPARTMENT OF TRANSPORTATION			SIGNING AND PAVEMENT MARKING PLAN (11)	SHEET NO.
DATE	DESCRIPTION	DATE	DESCRIPTION		ROAD NO.	COUNTY	FINANCIAL PROJECT ID		
					SR 93	COLLIER	444008-4-52-01		S-16

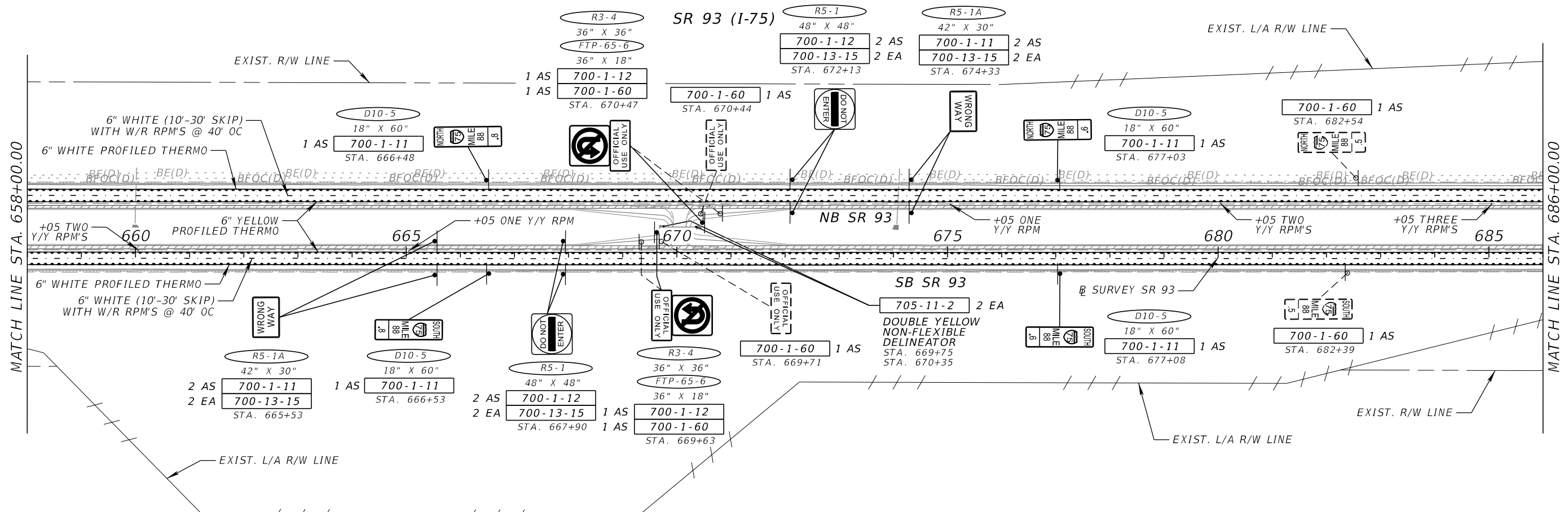
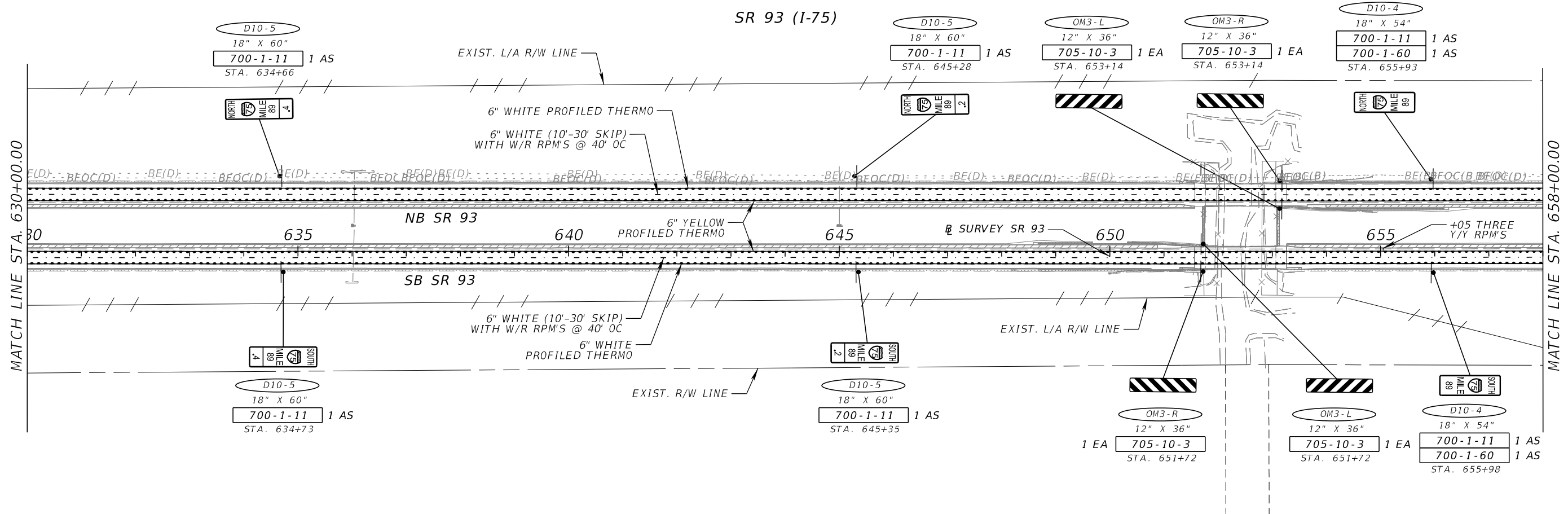

REVISIONS			
DATE	DESCRIPTION	DATE	DESCRIPTION

PATRICIA T. CHRISTIE, P.E.
P.E. NO.: 60049
FALLER, DAVIS & ASSOCIATES, INC.
4200 W. CYPRESS ST., SUITE 500
TAMPA, FLORIDA 33607-4168

STATE OF FLORIDA DEPARTMENT OF TRANSPORTATION		
ROAD NO.	COUNTY	FINANCIAL PROJECT ID
SR 93	COLLIER	444008-4-52-01

**SIGNING AND PAVEMENT
MARKING PLAN (12)**

SHEET NO.
S-17

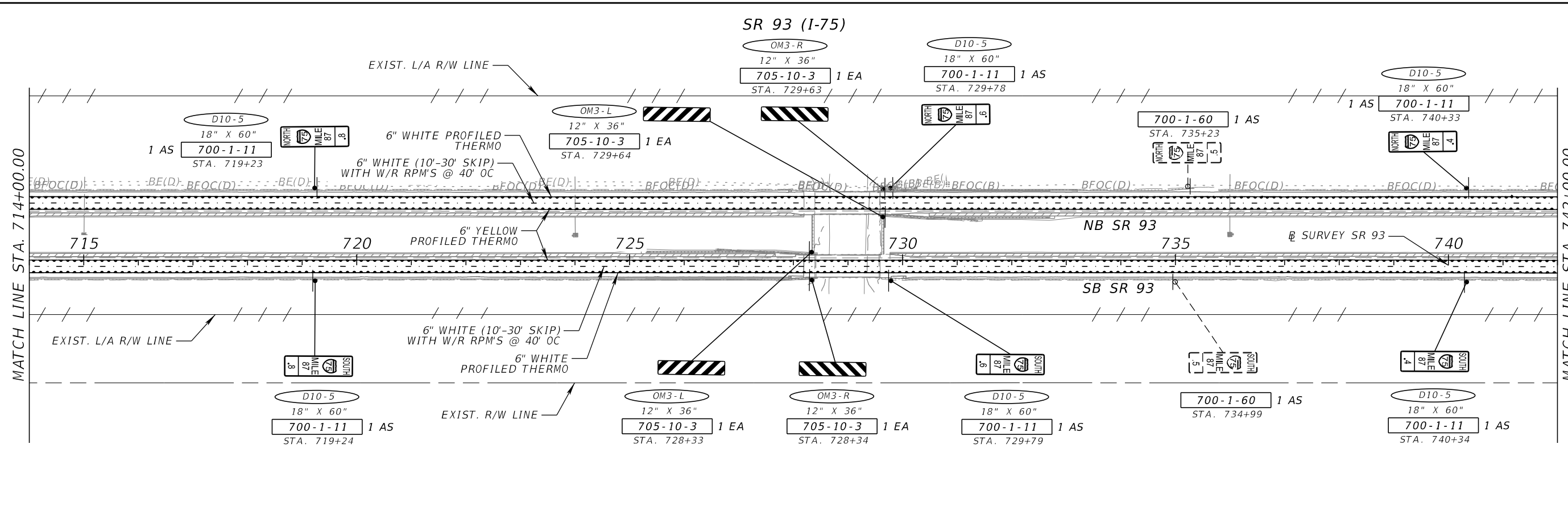
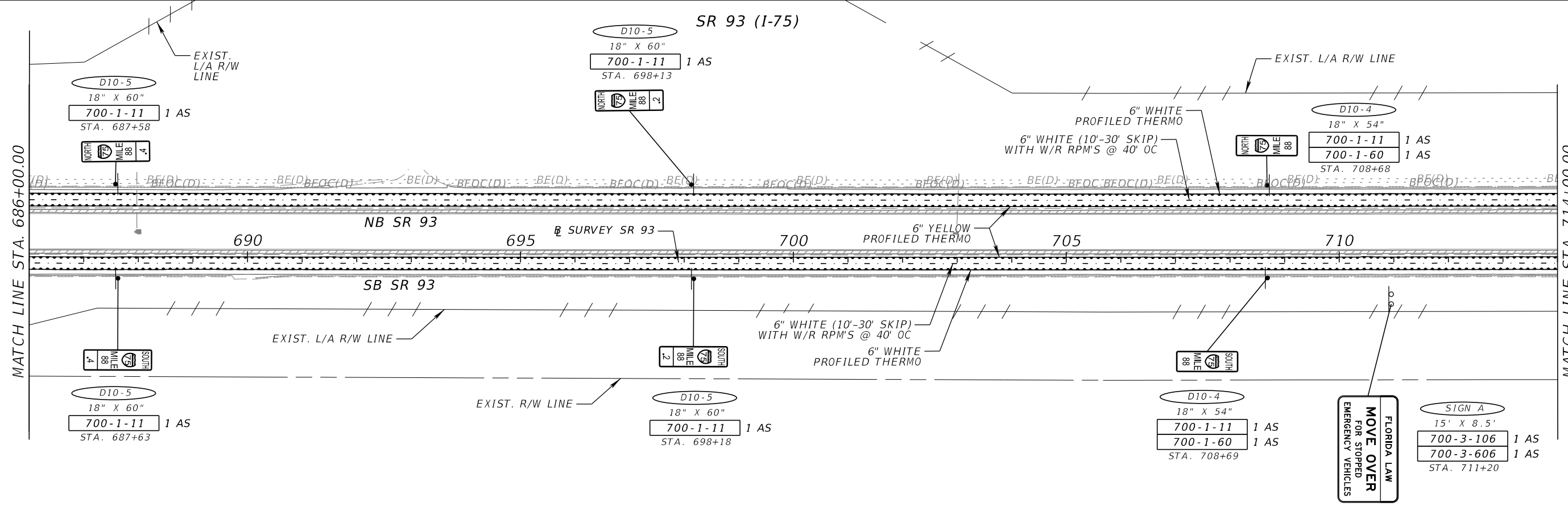

REVISIONS			
DATE	DESCRIPTION	DATE	DESCRIPTION

PATRICIA T. CHRISTIE, P.E.
 P.E. NO.: 60049
 FALLER, DAVIS & ASSOCIATES, INC.
 4200 W. CYPRESS ST., SUITE 500
 TAMPA, FLORIDA 33607-4168

STATE OF FLORIDA DEPARTMENT OF TRANSPORTATION		
ROAD NO.	COUNTY	FINANCIAL PROJECT ID
SR 93	COLLIER	444008-4-52-01

SIGNING AND PAVEMENT MARKING PLAN (13)

SHEET NO.
S-18

SR 93 (I-75)

MATCH LINE STA. 742+00.00

MATCH LINE STA. 770+00.00

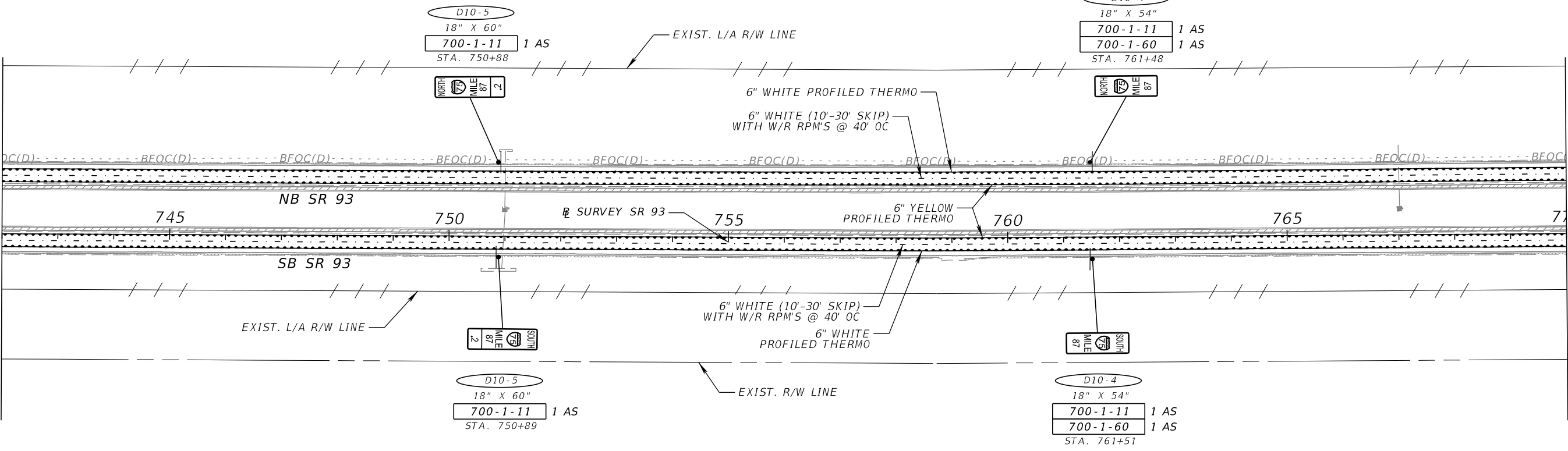

SR 93 (I-75)

MATCH LINE STA. 770+00.00

MATCH LINE STA. 798+00.00

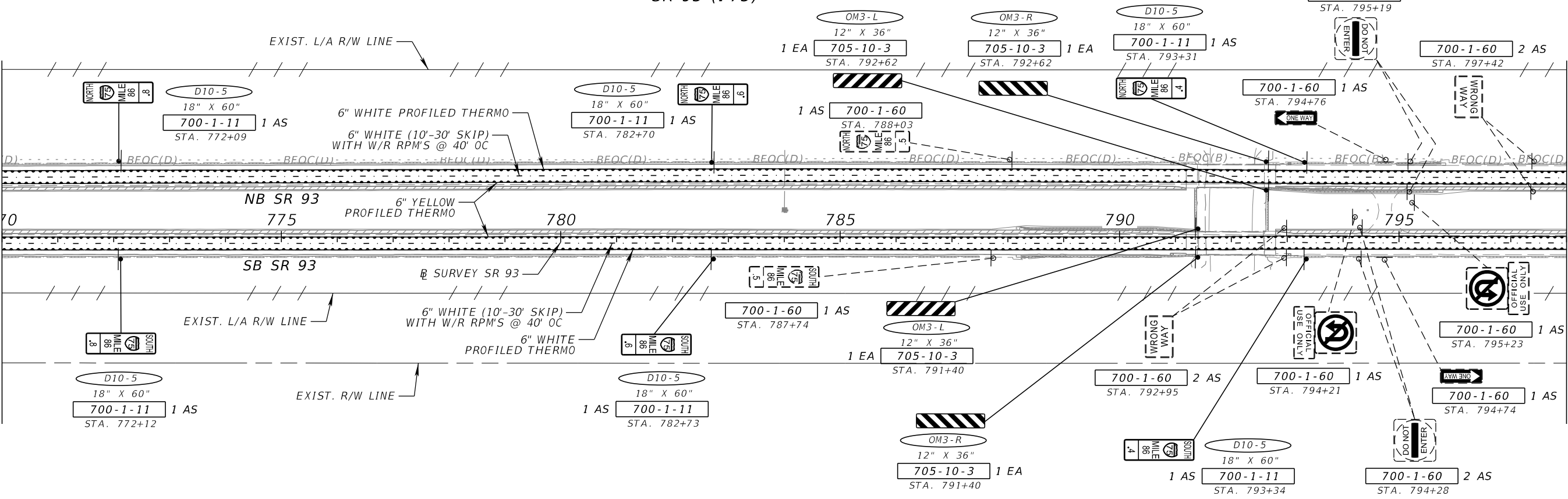

REVISIONS			
DATE	DESCRIPTION	DATE	DESCRIPTION

PATRICIA T. CHRISTIE, P.E.
 P.E. NO.: 60049
 FALLER, DAVIS & ASSOCIATES, INC.
 4200 W. CYPRESS ST., SUITE 500
 TAMPA, FLORIDA 33607-4168

STATE OF FLORIDA DEPARTMENT OF TRANSPORTATION		
ROAD NO.	COUNTY	FINANCIAL PROJECT ID
SR 93	COLLIER	444008-4-52-01

**SIGNING AND PAVEMENT
 MARKING PLAN (14)**

SHEET NO.
 S-19

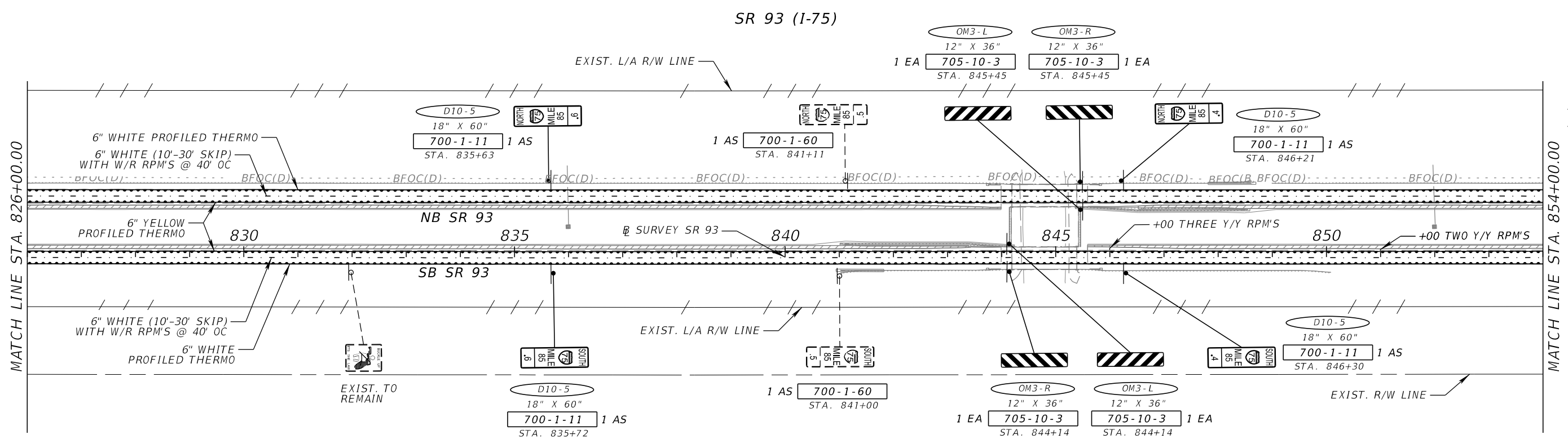
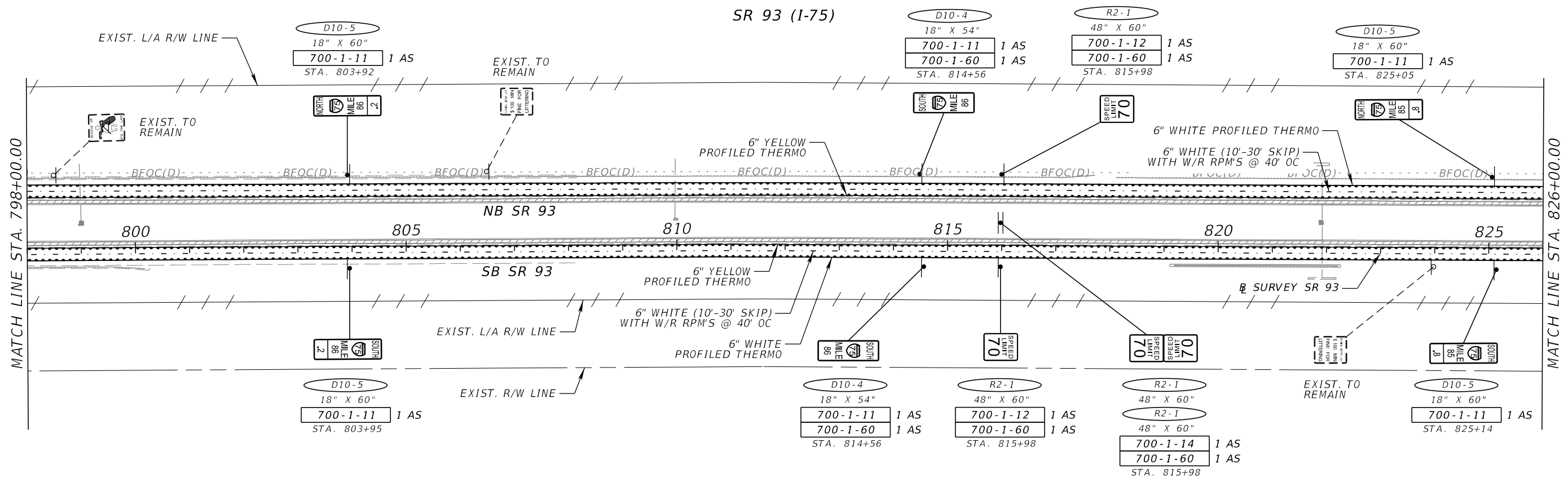

REVISIONS			
DATE	DESCRIPTION	DATE	DESCRIPTION

PATRICIA T. CHRISTIE, P.E.
P.E. NO.: 60049
FALLER, DAVIS & ASSOCIATES, INC.
4200 W. CYPRESS ST., SUITE 500
TAMPA, FLORIDA 33607-4168

STATE OF FLORIDA DEPARTMENT OF TRANSPORTATION		
ROAD NO.	COUNTY	FINANCIAL PROJECT ID
SR 93	COLLIER	444008-4-52-01

**SIGNING AND PAVEMENT
MARKING PLAN (15)**

SHEET NO.
S-20

THE OFFICIAL RECORD OF THIS SHEET IS THE ELECTRONIC FILE DIGITALLY SIGNED AND SEALED UNDER RULE 61G15-23.004, F.A.C.

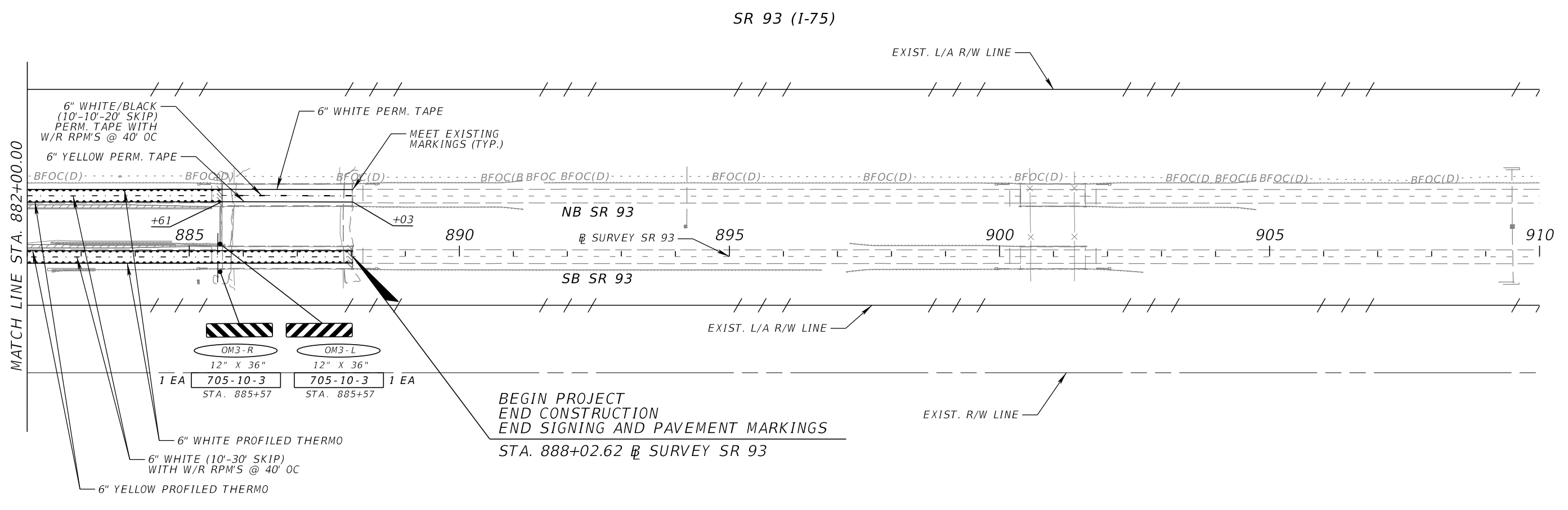
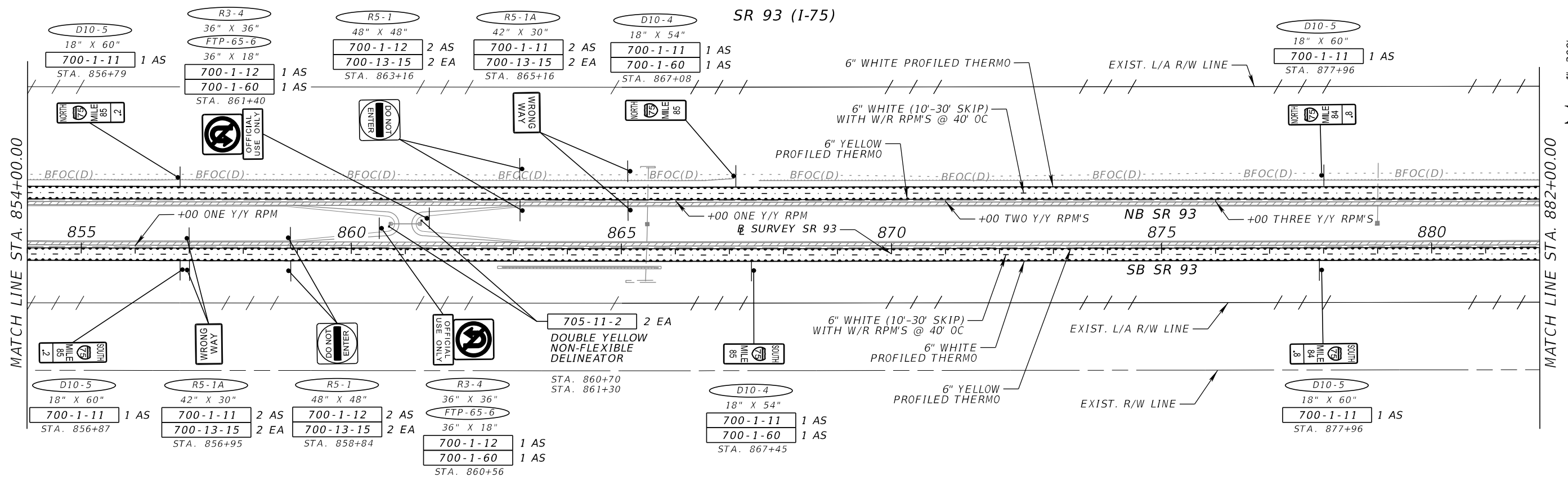

REVISIONS			
DATE	DESCRIPTION	DATE	DESCRIPTION

PATRICIA T. CHRISTIE, P.E.
P.E. NO.: 60049
FALLER, DAVIS & ASSOCIATES, INC.
4200 W. CYPRESS ST., SUITE 500
TAMPA, FLORIDA 33607-4168

STATE OF FLORIDA DEPARTMENT OF TRANSPORTATION		
ROAD NO.	COUNTY	FINANCIAL PROJECT ID
SR 93	COLLIER	444008-4-52-01

**SIGNING AND PAVEMENT
MARKING PLAN (16)**

SHEET NO.
S-21

THE OFFICIAL RECORD OF THIS SHEET IS THE ELECTRONIC FILE DIGITALLY SIGNED AND SEALED UNDER RULE 61G15-23.004, F.A.C.

SIGN NAME	A		QTY	2	SIGN NUMBER	266+18	STATION(S)	
PANEL	BORDER							
WIDTH	15'-0"	WIDTH	1.5"	711+20				
HEIGHT	8'-6"	RADII	9"					
LEGEND	Black	COLOR	Black					
COLOR	White/Yellow							
SYMBOL(S)	ANGLE	X	Y	WID	HT			
SIGN NUMBER	NUMBER OF POSTS	CLEARANCE Edge Of Land	COLUMN SIZE	AVERAGE LENGTH				

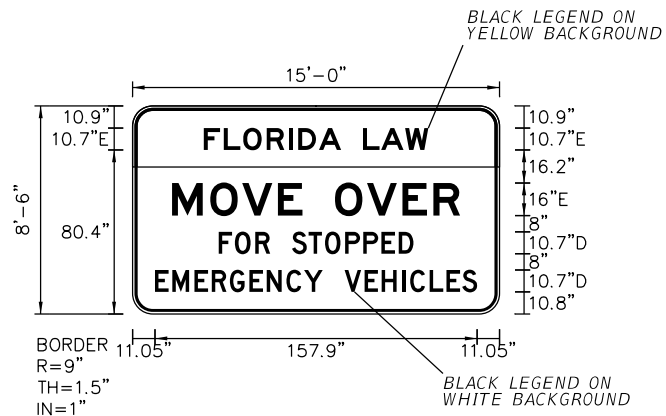

NO. OF LIGHT FIXTURES	FIXTURE SPACING	PHOTOMETRIC CURVE	WATT	VOLTAGE

COPY SPACE	34.9	F	9.8	L	9.5	O	11.4	R	10.8	I	4.7	D	10.2	A	10.9	L	10.7	A	8.9	L	11.8	W	11.3	L	34.9	110.1
COPY SPACE	19.4	M	18.7	O	15.7	V	17.4	E	12		16	O	15.7	V	17.4	E	15.2	R	13	L	19.4	141.1				
COPY SPACE	42.2	F	8	O	10	R	7.3		10.7	S	8.1	T	8	O	10	P	8.9	P	8.9	E	8.5	D	7.3	L	42.2	95.6
COPY SPACE	11	E	8.5	M	10.9	E	8.5	R	8.9	G	9.6	E	8.5	N	9.6	C	8.7	Y	9.2	V	10.7	E	9.7	H	8.5	9.8
COPY SPACE																										
COPY SPACE																										

SIGN NAME	B		QTY	1	SIGN NUMBER	471+27	STATION(S)	
PANEL	BORDER							
WIDTH	12'-0"	WIDTH	2"					
HEIGHT	6'-6"	RADII	10"					
LEGEND	Black/Red	COLOR	Black					
COLOR	White							
SYMBOL(S)	ANGLE	X	Y	WID	HT			
SIGN NUMBER	NUMBER OF POSTS	CLEARANCE Edge Of Land	COLUMN SIZE	AVERAGE LENGTH				
	2	5' FACE OF GR	WBX18	16.05'				

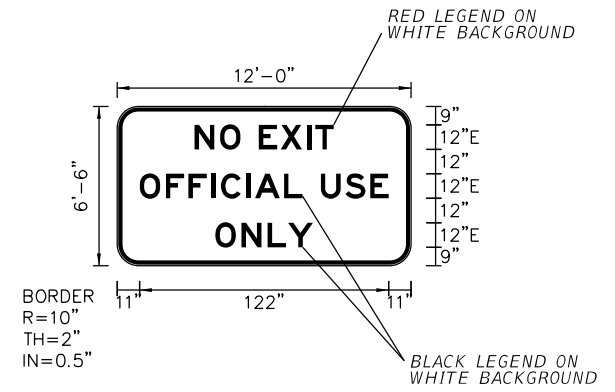

NO. OF LIGHT FIXTURES	FIXTURE SPACING	PHOTOMETRIC CURVE	WATT	VOLTAGE

COPY SPACE	37.9	N	12.5	O	10.1	E	9	X	10.7	I	12.8	T	4.2	L	9	37.9	68.3									
COPY SPACE	11	O	12.8	F	11	F	11	I	4.9	C	12.5	I	4.2	A	14.3	9	9	12.1	12.1	9	11	122				
COPY SPACE	48.1	O	12.8	N	12.8	L	10	Y	12.2	L	48.1	47.9														
COPY SPACE																										
COPY SPACE																										

SIGN NAME			QTY		SIGN NUMBER		STATION(S)	
PANEL	BORDER							
WIDTH	WIDTH							
HEIGHT	RADII							
LEGEND	COLOR							
COLOR								
SYMBOL(S)	ANGLE	X	Y	WID	HT			
SIGN NUMBER	NUMBER OF POSTS	CLEARANCE Edge Of Land	COLUMN SIZE	AVERAGE LENGTH				

THIS SPACE INTENTIONALLY LEFT BLANK

NO. OF LIGHT FIXTURES	FIXTURE SPACING	PHOTOMETRIC CURVE	WATT	VOLTAGE

SIGN NAME			QTY		SIGN NUMBER		STATION(S)	
PANEL	BORDER							
WIDTH	WIDTH							
HEIGHT	RADII							
LEGEND	COLOR							
COLOR								
SYMBOL(S)	ANGLE	X	Y	WID	HT			
SIGN NUMBER	NUMBER OF POSTS	CLEARANCE Edge Of Land	COLUMN SIZE	AVERAGE LENGTH				

THIS SPACE INTENTIONALLY LEFT BLANK

NO. OF LIGHT FIXTURES	FIXTURE SPACING	PHOTOMETRIC CURVE	WATT	VOLTAGE

COPY SPACE																										
COPY SPACE																										
COPY SPACE																										
COPY SPACE																										
COPY SPACE																										

COPY SPACE																										
COPY SPACE																										
COPY SPACE																										
COPY SPACE																										
COPY SPACE																										

<table border="1"> <thead> <tr> <th colspan="4">REVISIONS</th> </tr> <tr> <th>DATE</th> <th>DESCRIPTION</th> <th>DATE</th> <th>DESCRIPTION</th> </tr> </thead> <tbody> <tr> <td></td> <td></td> <td></td> <td></td> </tr> </tbody> </table>				REVISIONS				DATE	DESCRIPTION	DATE	DESCRIPTION					PATRICIA T. CHRISTIE, P.E. P.E. NO.: 60049 FALLER, DAVIS & ASSOCIATES, INC. 4200 W. CYPRESS ST., SUITE 500 TAMPA, FLORIDA 33607-4168	STATE OF FLORIDA DEPARTMENT OF TRANSPORTATION <table border="1"> <tr> <td>ROAD NO.</td> <td>COUNTY</td> <td>FINANCIAL PROJECT ID</td> </tr> <tr> <td>SR 93</td> <td>COLLIER</td> <td>444008-4-52-01</td> </tr> </table>	ROAD NO.	COUNTY	FINANCIAL PROJECT ID	SR 93	COLLIER	444008-4-52-01	SHEET NO. S-22
REVISIONS																								
DATE	DESCRIPTION	DATE	DESCRIPTION																					
ROAD NO.	COUNTY	FINANCIAL PROJECT ID																						
SR 93	COLLIER	444008-4-52-01																						
GUIDE SIGN WORK SHEET																								

THE OFFICIAL RECORD OF THIS SHEET IS THE ELECTRONIC FILE DIGITALLY SIGNED AND SEALED UNDER RULE 61G15-23.004, F.A.C.

34
32
30
28
26
24
22
20
18
16
14
12
10
8

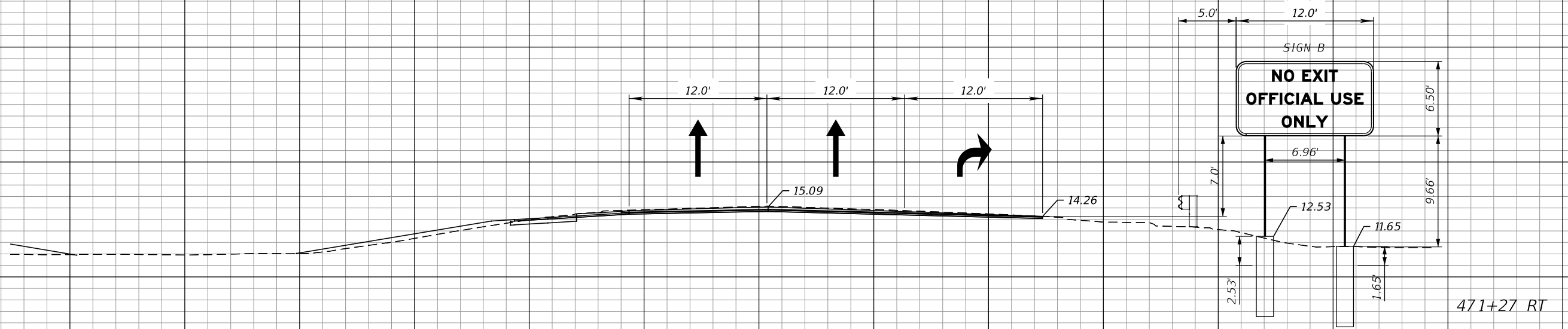

1" = 10' Horizontal
1" = 10' Vertical

REVISIONS		DESCRIPTION	
DATE	DESCRIPTION	DATE	DESCRIPTION

PATRICIA T. CHRISTIE, P.E.
P.E. NO.: 60049
FALLER, DAVIS & ASSOCIATES, INC.
4200 W. CYPRESS ST., SUITE 500
TAMPA, FLORIDA 33607-4168

STATE OF FLORIDA DEPARTMENT OF TRANSPORTATION		
ROAD NO.	COUNTY	FINANCIAL PROJECT ID
SR 93	COLLIER	444008-4-52-01

SIGN CROSS SECTION SHEET

SHEET NO.
S-23

THE OFFICIAL RECORD OF THIS SHEET IS THE ELECTRONIC FILE DIGITALLY SIGNED AND SEALED UNDER RULE 61G15-23.004, F.A.C.