

CONTRACT PLANS COMPONENTS

ROADWAY
SIGNING AND PAVEMENT MARKING
INTELLIGENT TRANSPORTATION SYSTEMS
STRUCTURES

STATE OF FLORIDA
DEPARTMENT OF TRANSPORTATION

SIGNING AND PAVEMENT MARKING PLANS

INDEX OF SIGNING AND PAVEMENT MARKING PLANS

SHEET NO.	SHEET DESCRIPTION
S-1	KEY SHEET
S-2	SIGNATURE SHEET
S-3 - S-4	TABULATION OF QUANTITIES
S-5	GENERAL NOTES
S-6 - S-21	SIGNING AND PAVEMENT MARKING PLAN
S-22 - S-23	GUIDE SIGN WORK SHEET
S-24	SIGN CROSS SECTION SHEET

FINANCIAL PROJECT ID 444008-4-52-01

COLLIER COUNTY (03175)
STATE ROAD NO. 93 (INTERSTATE 75)

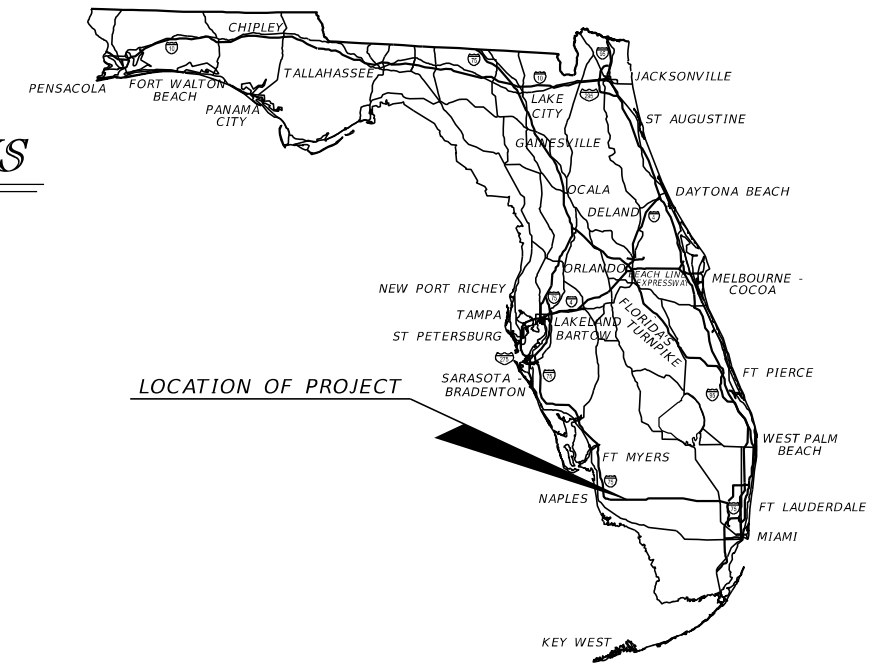

PROJECT LOCATION URL: <http://tinyurl.com/y76ppjyp>

PROJECT LIMITS: BEGIN MP 33.989 - END MP 46.000

EXCEPTIONS: NONE

BRIDGE LIMITS: SEE THE BRIDGE DATA TABLES IN THE GENERAL NOTES

RAILROAD CROSSING: NONE

GOVERNING STANDARD PLANS:

Florida Department of Transportation, FY 2024-25 Standard Plans for Road and Bridge Construction and applicable Interim Revisions (IRs).

Standard Plans for Road Construction and associated IRs are available at the following website: <http://www.fdot.gov/design/standardplans>

APPLICABLE IRs: NONE

Standard Plans for Bridge Construction are included in the Structures Plans Component

GOVERNING STANDARD SPECIFICATIONS:

Florida Department of Transportation, FY 2024-25 Standard Specifications for Road and Bridge Construction at the following website: <http://www.fdot.gov/programmanagement/Implemented/SpecBooks>

PHASE IV SUBMITTAL
APRIL 16, 2024

SIGNING AND PAVEMENT MARKING PLANS
ENGINEER OF RECORD:

PATRICIA T. CHRISTIE, P.E. NO.: 60049
FALLER, DAVIS & ASSOCIATES, INC.
1150 ASSEMBLY DRIVE, SUITE 400
TAMPA, FLORIDA 33607-4874
(813) 261-5136
CONTRACT NO. CA632
VENDOR NO. F592594956001

FDOT PROJECT MANAGER:

JEFFREY JONES, P.E.

CONSTRUCTION CONTRACT NO.	FISCAL YEAR	SHEET NO.
EIW80	25	S-1

THE OFFICIAL RECORD OF THIS SHEET IS THE ELECTRONIC FILE DIGITALLY SIGNED AND SEALED UNDER RULE 61G15-23.004, F.A.C.

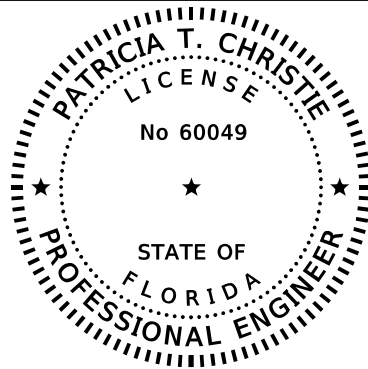

THIS ITEM HAS BEEN DIGITALLY
SIGNED AND SEALED BY

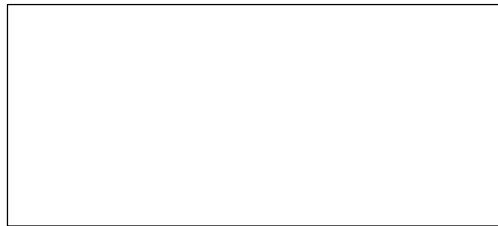

ON THE DATE ADJACENT TO THE SEAL

PRINTED COPIES OF THIS DOCUMENT ARE
NOT CONSIDERED SIGNED AND SEALED.
THE SIGNATURE MUST BE VERIFIED
ON ANY ELECTRONIC COPIES.

FALLER, DAVIS & ASSOCIATES, INC
1150 ASSEMBLY DRIVE, SUITE 400
TAMPA, FLORIDA 33607-4874
PATRICIA T. CHRISTIE, P.E. NO.: 60049

THE ABOVE NAMED PROFESSIONAL ENGINEER SHALL BE RESPONSIBLE FOR THE
FOLLOWING SHEETS IN ACCORDANCE WITH RULE 61G15-23.004, F.A.C.

<u>SHEET NO.</u>	<u>SHEET DESCRIPTION</u>
S-1	KEY SHEET
S-2	SIGNATURE SHEET
S-3 - S-4	TABULATION OF QUANTITIES
S-5	GENERAL NOTES
S-6 - S-21	SIGNING AND PAVEMENT MARKING PLAN
S-22 - S-23	GUIDE SIGN WORK SHEET
S-24	SIGN CROSS SECTION SHEET

REVISIONS				PATRICIA T. CHRISTIE, P.E. P.E. NO.: 60049 FALLER, DAVIS & ASSOCIATES, INC. 1150 ASSEMBLY DRIVE, SUITE 400 TAMPA, FLORIDA 33607-4874	STATE OF FLORIDA DEPARTMENT OF TRANSPORTATION			SIGNATURE SHEET	SHEET NO.
DATE	DESCRIPTION	DATE	DESCRIPTION		ROAD NO.	COUNTY	FINANCIAL PROJECT ID		S-2
					SR 93	COLLIER	444008-4-52-01		

TABULATION OF QUANTITIES

PAY ITEM NO.	DESCRIPTION	UNIT	SHEET NUMBERS																TOTAL THIS SHEET	
			S-6		S-7		S-8		S-9		S-10		S-11		S-12		S-13		PLAN	FINAL
			PLAN	FINAL	PLAN	FINAL	PLAN	FINAL	PLAN	FINAL	PLAN	FINAL	PLAN	FINAL	PLAN	FINAL	PLAN	FINAL		
546-72-3	GROUND-IN RUMBLE STRIPS, 8" SINUSOIDAL - SKIP ARRAY	GM	3.505		4.242		4.242		2.777		0.480		0.398		0.270		0.335		16.249	
	GROUND-IN RUMBLE STRIPS, 8" SINUSOIDAL - CONTINUOUS ARRAY	GM						0.758											0.758	
700-1-111	SINGLE COLUMN GROUND SIGN ASSEMBLY, F&I GROUND MOUNT, LESS THAN 12 SF	EA	15		16		10		8		2		2					2		55
700-1-112	SINGLE COLUMN GROUND SIGN ASSEMBLY, F&I GROUND MOUNT, 12.0-20.0 SF	EA	6		2															8
700-1-114	SINGLE COLUMN GROUND SIGN ASSEMBLY, F&I GROUND MOUNT, 30.1+ SF SHEETING AREA FOR BACK TO BACK SIGNS	EA			1															1
700-1-600	SINGLE COLUMN GROUND SIGN ASSEMBLY, REMOVE	EA	17		5		4		4						1					31
700-2-115	MULTI-COLUMN GROUND SIGN ASSEMBLY, F&I GROUND MOUNT, 50.1-100.0 SF	EA												1						1
700-3-106	SIGN PANEL (F&I GROUND MOUNT) (101-200 SF)	EA	1																	1
700-3-606	SIGN PANEL (REMOVE) (101-200 SF)	EA	1																	1
700-13-15	RETROREFLECTIVE SIGN STRIP (F&I) (5')	EA	8											2		3				13
705-10-3	OBJECT MARKER (TYPE 3)	EA							4											4
705-11-2	DELINEATOR (NON-FLEXIBLE)	EA	2																	2
706-1-3	RAISED PAVEMENT MARKER (TYPE B) (W/R)	EA	252		280		280		240		41		79		117		78			1367
	RAISED PAVEMENT MARKER (TYPE B) (Y/Y)	EA	12														3			15
710-90	PAINTED PAVEMENT MARKINGS - FINAL SURFACE	LS																		
*	PAINTED PAVEMENT MARKINGS (WHITE) (SOLID) (12")	GM												0.016		0.040				0.056
*	PAINTED PAVEMENT MARKINGS (WHITE) (SOLID) (18")	LF															61			61
*	PAINTED PAVEMENT MARKINGS (WHITE) (SOLID) (6")	GM	1.909		2.121		2.121		1.801		0.265		0.265		0.265		0.262			9.009
*	PAINTED PAVEMENT MARKINGS (WHITE) (SOLID) (8")	GM												0.036		0.059				0.095
*	PAINTED PAVEMENT MARKINGS (WHITE) (SKIP) (6") (10'-30')	GM	1.909		2.121		2.121		1.801		0.265		0.265		0.265		0.265			9.012
*	PAINTED PAVEMENT MARKINGS (WHITE) (SKIP) (6") (3'-9')	GM											0.115		0.148					0.263
*	PAINTED PAVEMENT MARKINGS (YELLOW) (SOLID) (6")	GM	1.909		2.121		2.121		1.801		0.265		0.265		0.265		0.265			9.012
711-11-102	THERMOPLASTIC (STD) (WHITE) (SOLID) (8" FOR INTERCHANGE AND URBAN ISLAND)	GM												0.036		0.059				0.095
711-11-103	THERMOPLASTIC (STD) (WHITE) (SOLID) (12" FOR INTERCHANGE MARKINGS)	GM												0.016		0.040				0.056
711-11-124	THERMOPLASTIC (STD) (WHITE) (SOLID) (18")	LF															61			61
711-15-101	THERMOPLASTIC (STD-OPEN) (WHITE) (SOLID) (6")	GM	1.909		2.121		2.121		1.801		0.265		0.265		0.265		0.262			9.009
711-15-131	THERMOPLASTIC (STD-OPEN) (WHITE) (SKIP) (6") (10'-30')	GM	1.909		2.121		2.121		1.801		0.265		0.265		0.265		0.265			9.012
	THERMOPLASTIC (STD-OPEN) (WHITE) (SKIP) (6") (3'-9')	GM											0.115		0.148					0.263
711-15-201	THERMOPLASTIC (STD-OPEN) (YELLOW) (SOLID) (6")	GM	1.909		2.121		2.121		1.801		0.265		0.265		0.265		0.265			9.012
713-103-101	PERMANENT TAPE, WHITE, SOLID, 6" FOR CONCRETE BRIDGES	GM							0.017											0.017
713-103-181	PERMANENT TAPE, WHITE, 10-30 SKIP, 6" WIDE, FOR CONCRETE SURFACES	GM							0.010											0.010
713-103-201	PERMANENT TAPE, YELLOW, SOLID, 6" FOR CONCRETE BRIDGES	GM							0.017											0.017
713-103-381	PERMANENT TAPE, BLACK, 10-30 SKIP, 6" WIDE, FOR CONCRETE SURFACES	GM							0.010											0.010

* THESE QUANTITIES ARE PAID FOR UNDER PAINTED PAVEMENT MARKINGS (FINAL SURFACE) LUMP SUM - ITEM NO. 710-90. THE QUANTITIES SHOWN ARE FOR ONE APPLICATION; SEE SPECIFICATION 710 FOR THE NUMBER OF APPLICATIONS REQUIRED.

REVISIONS				PATRICIA T. CHRISTIE, P.E. P.E. NO.: 60049 FALLER, DAVIS & ASSOCIATES, INC. 1150 ASSEMBLY DRIVE, SUITE 400 TAMPA, FLORIDA 33607-4874	STATE OF FLORIDA DEPARTMENT OF TRANSPORTATION			TABULATION OF QUANTITIES (1)	SHEET NO.
DATE	DESCRIPTION	DATE	DESCRIPTION		ROAD NO.	COUNTY	FINANCIAL PROJECT ID		
					SR 93	COLLIER	444008-4-52-01		

TABULATION OF QUANTITIES

PAY ITEM NO.	DESCRIPTION	UNIT	SHEET NUMBERS														TOTAL THIS SHEET		GRAND TOTAL			
			S-14		S-15		S-16		S-17		S-18		S-19		S-20		S-21		PLAN	FINAL	PLAN	FINAL
			PLAN	FINAL	PLAN	FINAL	PLAN	FINAL	PLAN	FINAL	PLAN	FINAL	PLAN	FINAL	PLAN	FINAL						
546-72-3	GROUND-IN RUMBLE STRIPS, 8" SINUSOIDAL - SKIP ARRAY	GM	2.414		3.375		4.242		3.054		3.364		3.545		3.243		1.683		24.920		46.096	
	GROUND-IN RUMBLE STRIPS, 8" SINUSOIDAL - CONTINUOUS ARRAY	GM			0.758				0.758		0.758		0.576		0.879		0.440		4.169			
700-1-111	SINGLE COLUMN GROUND SIGN ASSEMBLY, F&I GROUND MOUNT, LESS THAN 12 SF	EA	10		12		10		14		12		10		10		10		88		143	
700-1-112	SINGLE COLUMN GROUND SIGN ASSEMBLY, F&I GROUND MOUNT, 12.0-20.0 SF	EA	6						6						2		6		20		28	
700-1-114	SINGLE COLUMN GROUND SIGN ASSEMBLY, F&I GROUND MOUNT, 30.1+ SF SHEETING AREA FOR BACK TO BACK SIGNS	EA													1				1		2	
700-1-600	SINGLE COLUMN GROUND SIGN ASSEMBLY, REMOVE	EA	6		4		6		8		4		16		7		4		55		86	
700-2-115	MULTI-COLUMN GROUND SIGN ASSEMBLY, F&I GROUND MOUNT, 50.1-100.0 SF	EA																			1	
700-3-106	SIGN PANEL (F&I GROUND MOUNT) (101-200 SF)	EA									1								1		2	
700-3-606	SIGN PANEL (REMOVE) (101-200 SF)	EA									1								1		2	
700-13-15	RETROREFLECTIVE SIGN STRIP (F&I) (5')	EA	8						8								8		24		37	
705-10-3	OBJECT MARKER (TYPE 3)	EA			4				4		4		4		4		2		22		26	
705-11-2	DELINEATOR (NON-FLEXIBLE)	EA	2						2								2		6		8	
706-1-3	RAISED PAVEMENT MARKER (TYPE B) (W/R)	EA	180		280		280		280		280		280		280		170		2030		3445	
	RAISED PAVEMENT MARKER (TYPE B) (Y/Y)	EA	9						12						5		7		33			
710-90	PAINTED PAVEMENT MARKINGS - FINAL SURFACE	LS																			1	
*	PAINTED PAVEMENT MARKINGS (WHITE) (SOLID) (12")	GM																			0.056	
*	PAINTED PAVEMENT MARKINGS (WHITE) (SOLID) (18")	LF																			61	
*	PAINTED PAVEMENT MARKINGS (WHITE) (SOLID) (6")	GM	1.364		2.121		2.121		2.121		2.121		2.121		2.121		1.244		15.334		24.343	
*	PAINTED PAVEMENT MARKINGS (WHITE) (SOLID) (8")	GM																			0.095	
*	PAINTED PAVEMENT MARKINGS (WHITE) (SKIP) (6") (10'-30')	GM	1.364		2.121		2.121		2.121		2.121		2.121		2.121		1.244		15.334		24.346	
*	PAINTED PAVEMENT MARKINGS (WHITE) (SKIP) (6") (3'-9')	GM																			0.263	
*	PAINTED PAVEMENT MARKINGS (YELLOW) (SOLID) (6")	GM	1.364		2.121		2.121		2.121		2.121		2.121		2.121		1.244		15.334		24.346	
711-11-102	THERMOPLASTIC (STD) (WHITE) (SOLID) (8" FOR INTERCHANGE AND URBAN ISLAND)	GM																			0.095	
711-11-103	THERMOPLASTIC (STD) (WHITE) (SOLID) (12" FOR INTERCHANGE MARKINGS)	GM																			0.082	
711-11-124	THERMOPLASTIC (STD) (WHITE) (SOLID) (18")	LF																			61	
711-15-101	THERMOPLASTIC (STD-OPEN) (WHITE) (SOLID) (6")	GM	1.364		2.121		2.121		2.121		2.121		2.121		2.121		1.244		15.334		24.343	
711-15-131	THERMOPLASTIC (STD-OPEN) (WHITE) (SKIP) (6") (10'-30')	GM	1.364		2.121		2.121		2.121		2.121		2.121		2.121		1.244		15.334		24.609	
	THERMOPLASTIC (STD-OPEN) (WHITE) (SKIP) (6") (3'-9')	GM																				
711-15-201	THERMOPLASTIC (STD-OPEN) (YELLOW) (SOLID) (6")	GM	1.364		2.121		2.121		2.121		2.121		2.121		2.121		1.244		15.334		24.346	
713-103-101	PERMANENT TAPE, WHITE, SOLID, 6" FOR CONCRETE BRIDGES	GM			0.019												0.046		0.065		0.082	
713-103-181	PERMANENT TAPE, WHITE, 10-30 SKIP, 6" WIDE, FOR CONCRETE SURFACES	GM			0.010												0.046		0.056		0.066	
713-103-201	PERMANENT TAPE, YELLOW, SOLID, 6" FOR CONCRETE BRIDGES	GM			0.019												0.046		0.065		0.082	
713-103-381	PERMANENT TAPE, BLACK, 10-30 SKIP, 6" WIDE, FOR CONCRETE SURFACES	GM			0.016												0.046		0.062		0.072	

* THESE QUANTITIES ARE PAID FOR UNDER PAINTED PAVEMENT MARKINGS (FINAL SURFACE) LUMP SUM - ITEM NO. 710-90. THE QUANTITIES SHOWN ARE FOR ONE APPLICATION; SEE SPECIFICATION 710 FOR THE NUMBER OF APPLICATIONS REQUIRED.

<table border="1"> <thead> <tr> <th colspan="4">REVISIONS</th> </tr> <tr> <th>DATE</th> <th>DESCRIPTION</th> <th>DATE</th> <th>DESCRIPTION</th> </tr> </thead> <tbody> <tr> <td> </td> <td> </td> <td> </td> <td> </td> </tr> </tbody> </table>				REVISIONS				DATE	DESCRIPTION	DATE	DESCRIPTION					PATRICIA T. CHRISTIE, P.E. P.E. NO.: 60049 FALLER, DAVIS & ASSOCIATES, INC. 1150 ASSEMBLY DRIVE, SUITE 400 TAMPA, FLORIDA 33607-4874	STATE OF FLORIDA DEPARTMENT OF TRANSPORTATION <table border="1"> <tr> <th>ROAD NO.</th> <th>COUNTY</th> <th>FINANCIAL PROJECT ID</th> </tr> <tr> <td>SR 93</td> <td>COLLIER</td> <td>444008-4-52-01</td> </tr> </table>	ROAD NO.	COUNTY	FINANCIAL PROJECT ID	SR 93	COLLIER	444008-4-52-01	TABULATION OF QUANTITIES (2)	SHEET NO. S-4
REVISIONS																									
DATE	DESCRIPTION	DATE	DESCRIPTION																						
ROAD NO.	COUNTY	FINANCIAL PROJECT ID																							
SR 93	COLLIER	444008-4-52-01																							

GENERAL NOTES:

1. REFERENCE THE ROADWAY GENERAL NOTES FOR LIST OF UTILITY OWNERS.
2. ALL LANES ARE 12 FEET WIDE UNLESS OTHERWISE NOTED.

PAY ITEM NOTES:

1. 705-11-2:
INSTALL OR REPLACE IF MISSING OR DAMAGED FROM LOCATIONS SHOWN IN THE PLANS.
REMOVAL OF EXISTING DELINEATORS ARE INCLUDED IN THE COST OF INSTALLING PROPOSED DELINEATORS.
2. 700-13-15:
PROVIDE A RED RETROREFLECTIVE SIGN STRIP FOR "WRONG WAY" AND "DO NOT ENTER" SIGNS AND WHITE FOR "ONE WAY" SIGNS.

ABBREVIATIONS:

AVT AUDIBLE AND VIBRATORY TREATMENT
 CONT. CONTINUOUS
 PERM. PERMANENT
 THERMO THERMOPLASTIC

BRIDGE DATA

Bridge No.	Direction	Start Station	End Station	Deck Surface
030214	I-75 NB	440+66.34	441+66.34	Asphalt
030217	I-75 NB	545+04.62	546+14.62	Asphalt
030218	I-75 NB	651+77.25	653+07.25	Asphalt
030219	I-75 NB	728+40.00	729+60.00	Asphalt
030220	I-75 NB	791+40.00	792+60.00	Asphalt
030222	I-75 NB	844+20.00	845+40.00	Asphalt
030223	I-75 NB	885+62.62	888+02.62	Concrete

Bridge No.	Direction	Begin Station	End Station	Deck Surface
030001	I-75 SB	440+76.34	441+66.34	Concrete
030002	I-75 SB	545+14.62	546+14.62	Concrete
030003	I-75 SB	651+77.25	653+07.25	Asphalt
030215	I-75 SB	728+40.00	729+60.00	Asphalt
030216	I-75 SB	791+40.00	792+60.00	Asphalt
030221	I-75 SB	844+20.00	845+40.00	Asphalt
030005	I-75 SB	885+62.62	888+02.62	Asphalt

REVISIONS				PATRICIA T. CHRISTIE, P.E. P.E. NO.: 60049 FALLER, DAVIS & ASSOCIATES, INC. 1150 ASSEMBLY DRIVE, SUITE 400 TAMPA, FLORIDA 33607-4874	STATE OF FLORIDA DEPARTMENT OF TRANSPORTATION			GENERAL NOTES	SHEET NO.
DATE	DESCRIPTION	DATE	DESCRIPTION		ROAD NO.	COUNTY	FINANCIAL PROJECT ID		
						SR 93	COLLIER		444008-4-52-01

BEGIN CONSTRUCTION
 BEGIN SIGNING AND PAVEMENT MARKINGS SB
 MEET AND MATCH EXISTING MARKINGS

STA. 242+00.00 @ SURVEY SR 93

SR 93 (I-75)

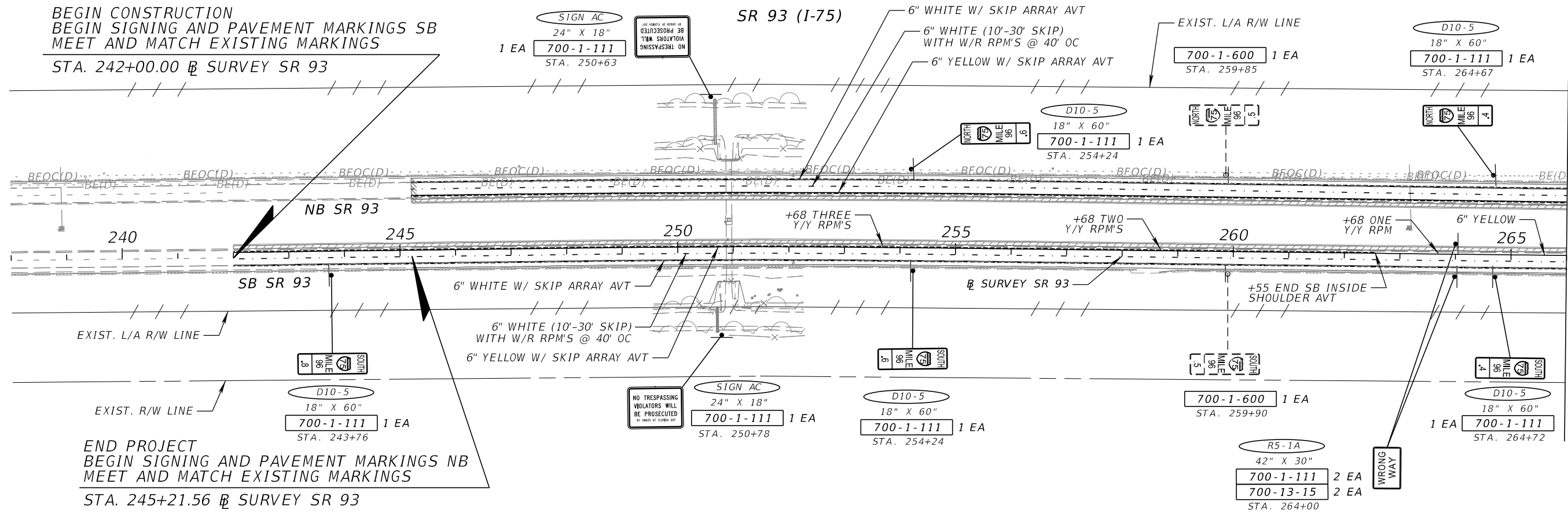

END PROJECT
 BEGIN SIGNING AND PAVEMENT MARKINGS NB
 MEET AND MATCH EXISTING MARKINGS

STA. 245+21.56 @ SURVEY SR 93

MATCH LINE STA. 266+00.00

1"=200'

MATCH LINE STA. 266+00.00

SR 93 (I-75)

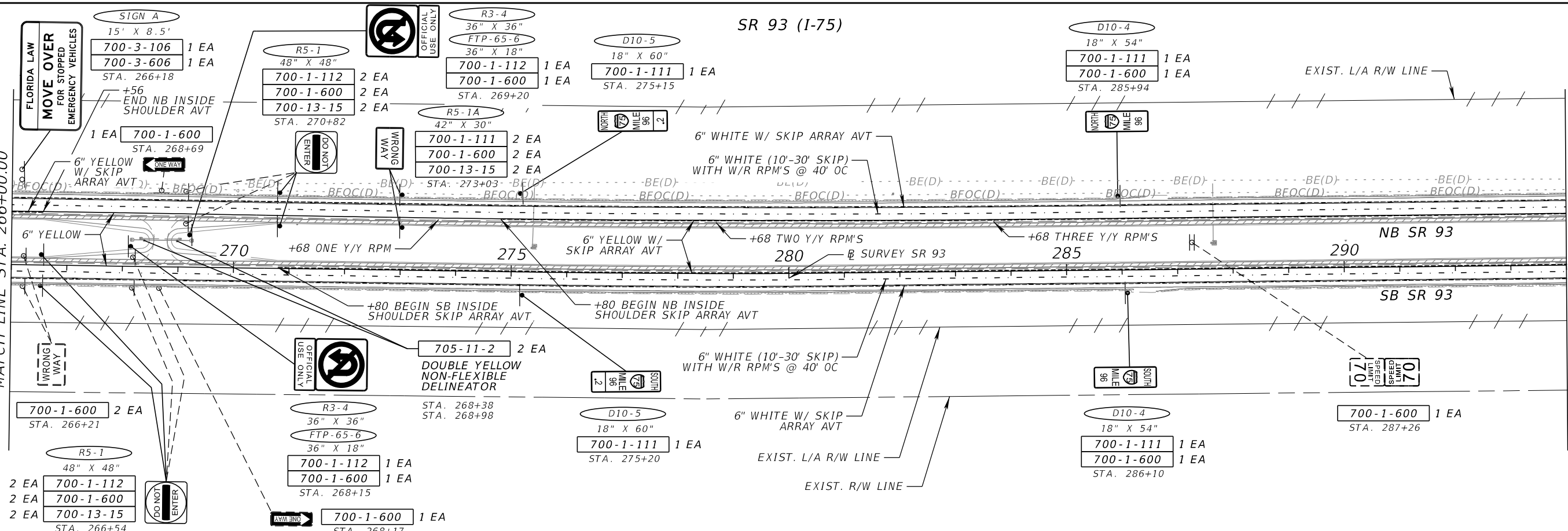

MATCH LINE STA. 294+00.00

1"=200'

REVISIONS			
DATE	DESCRIPTION	DATE	DESCRIPTION

PATRICIA T. CHRISTIE, P.E.
 P.E. NO.: 60049
 FALLER, DAVIS & ASSOCIATES, INC.
 1150 ASSEMBLY DRIVE, SUITE 400
 TAMPA, FLORIDA 33607-4874

STATE OF FLORIDA DEPARTMENT OF TRANSPORTATION		
ROAD NO.	COUNTY	FINANCIAL PROJECT ID
SR 93	COLLIER	444008-4-52-01

**SIGNING AND PAVEMENT
 MARKING PLAN (1)**

SHEET NO.
S-6

THE OFFICIAL RECORD OF THIS SHEET IS THE ELECTRONIC FILE DIGITALLY SIGNED AND SEALED UNDER RULE 61G15-23.004, F.A.C.

MATCH LINE STA. 294+00.00

MATCH LINE STA. 322+00.00

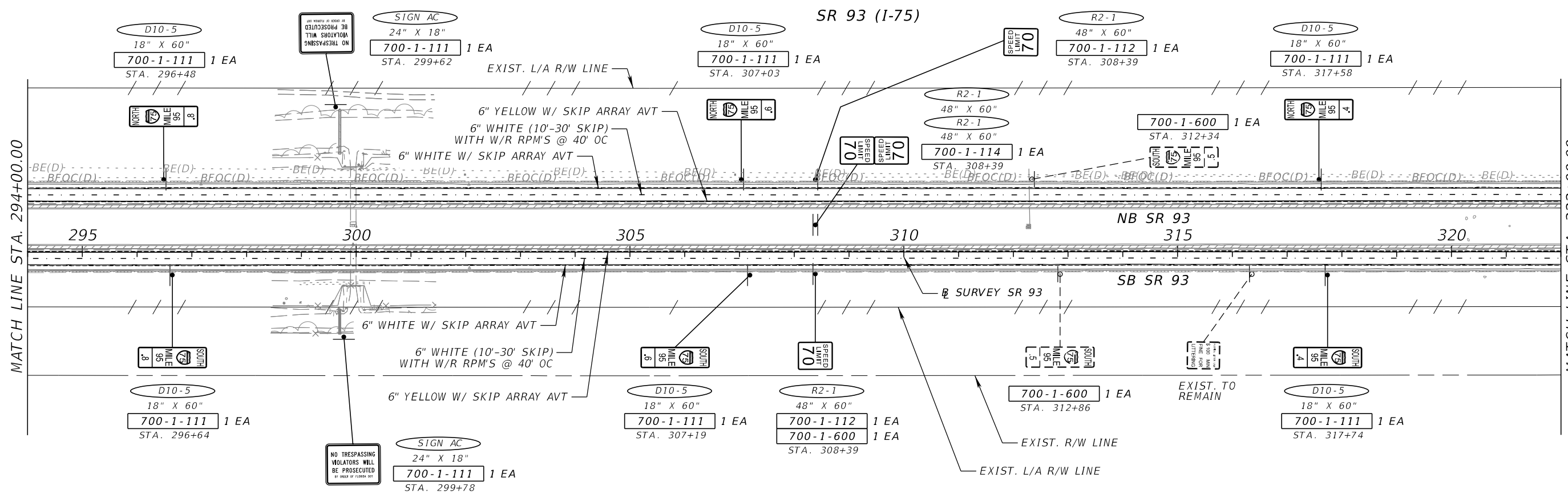

MATCH LINE STA. 322+00.00

MATCH LINE STA. 350+00.00

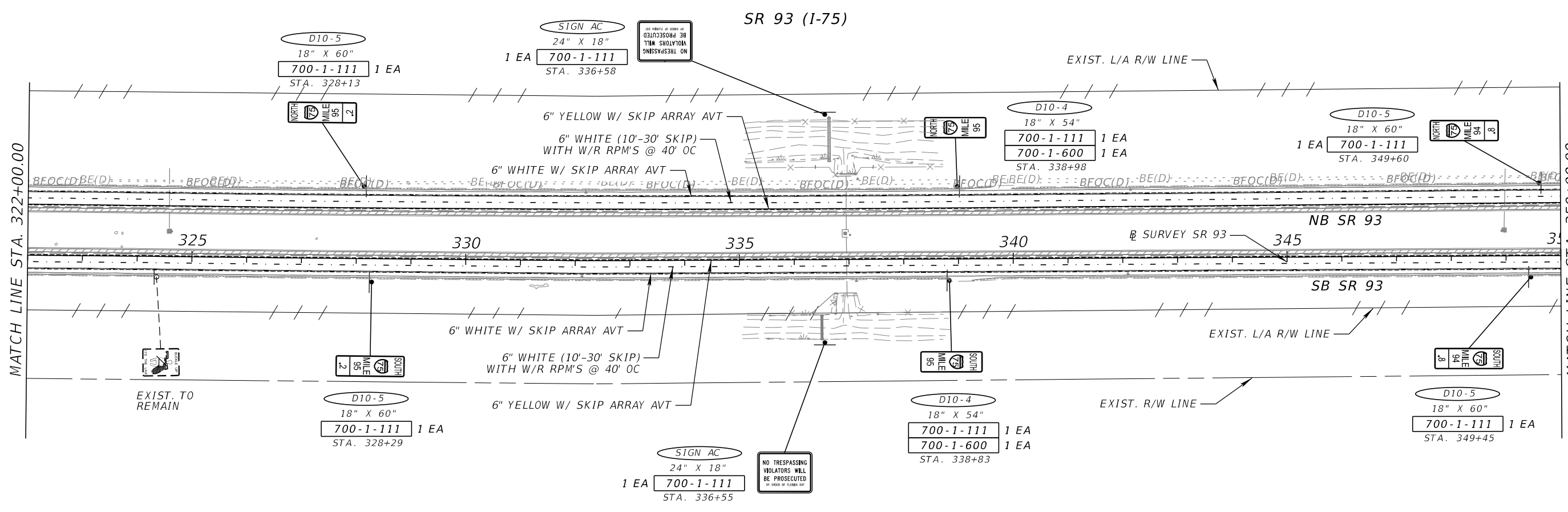

REVISIONS			
DATE	DESCRIPTION	DATE	DESCRIPTION

PATRICIA T. CHRISTIE, P.E.
 P.E. NO.: 60049
 FALLER, DAVIS & ASSOCIATES, INC.
 1150 ASSEMBLY DRIVE, SUITE 400
 TAMPA, FLORIDA 33607-4874

STATE OF FLORIDA DEPARTMENT OF TRANSPORTATION		
ROAD NO.	COUNTY	FINANCIAL PROJECT ID
SR 93	COLLIER	444008-4-52-01

**SIGNING AND PAVEMENT
 MARKING PLAN (2)**

SHEET NO.
 S-7

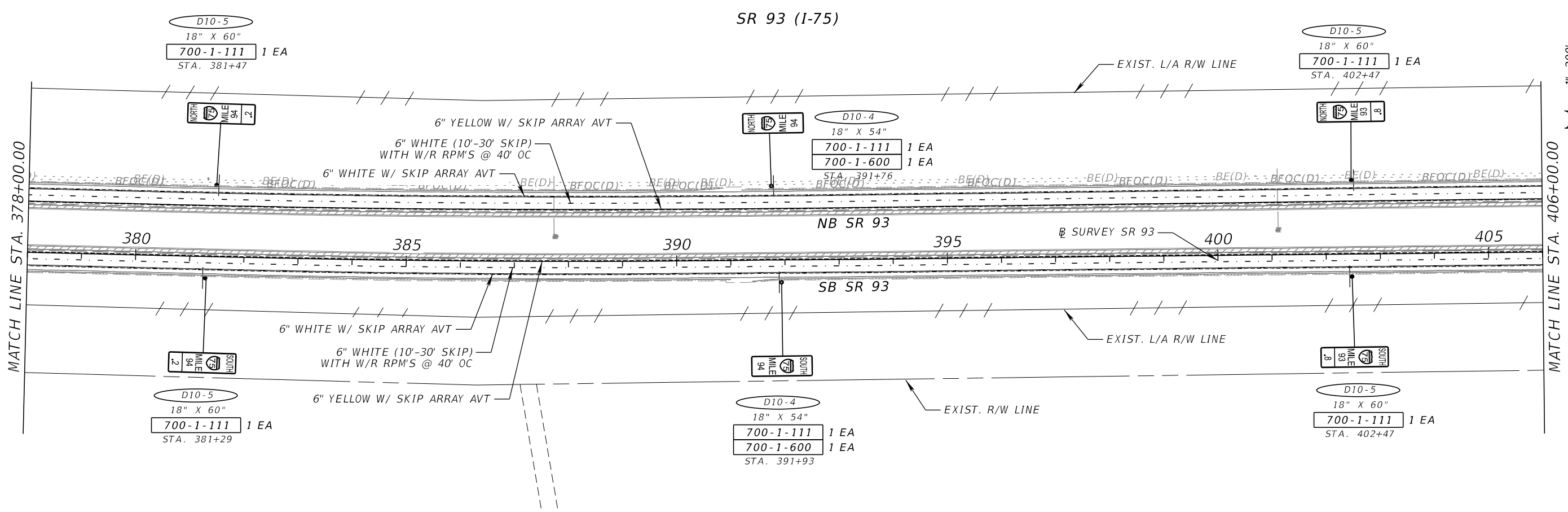
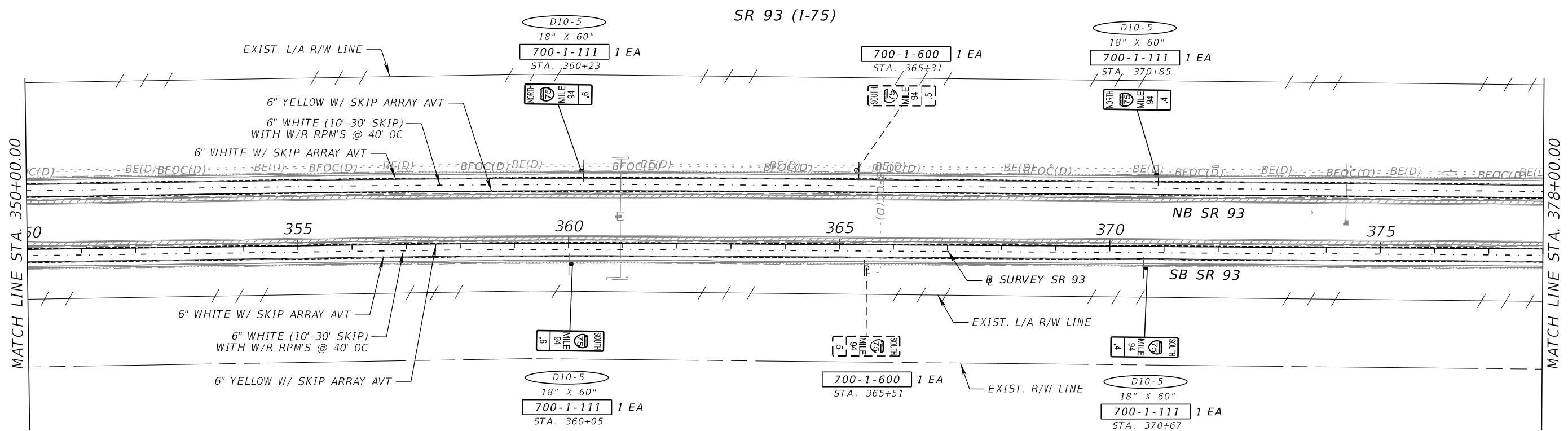

REVISIONS			
DATE	DESCRIPTION	DATE	DESCRIPTION

PATRICIA T. CHRISTIE, P.E.
P.E. NO.: 60049
FALLER, DAVIS & ASSOCIATES, INC.
1150 ASSEMBLY DRIVE, SUITE 400
TAMPA, FLORIDA 33607-4874

STATE OF FLORIDA DEPARTMENT OF TRANSPORTATION		
ROAD NO.	COUNTY	FINANCIAL PROJECT ID
SR 93	COLLIER	444008-4-52-01

**SIGNING AND PAVEMENT
MARKING PLAN (3)**

SHEET NO.
S-8

THE OFFICIAL RECORD OF THIS SHEET IS THE ELECTRONIC FILE DIGITALLY SIGNED AND SEALED UNDER RULE 61G15-23.004, F.A.C.

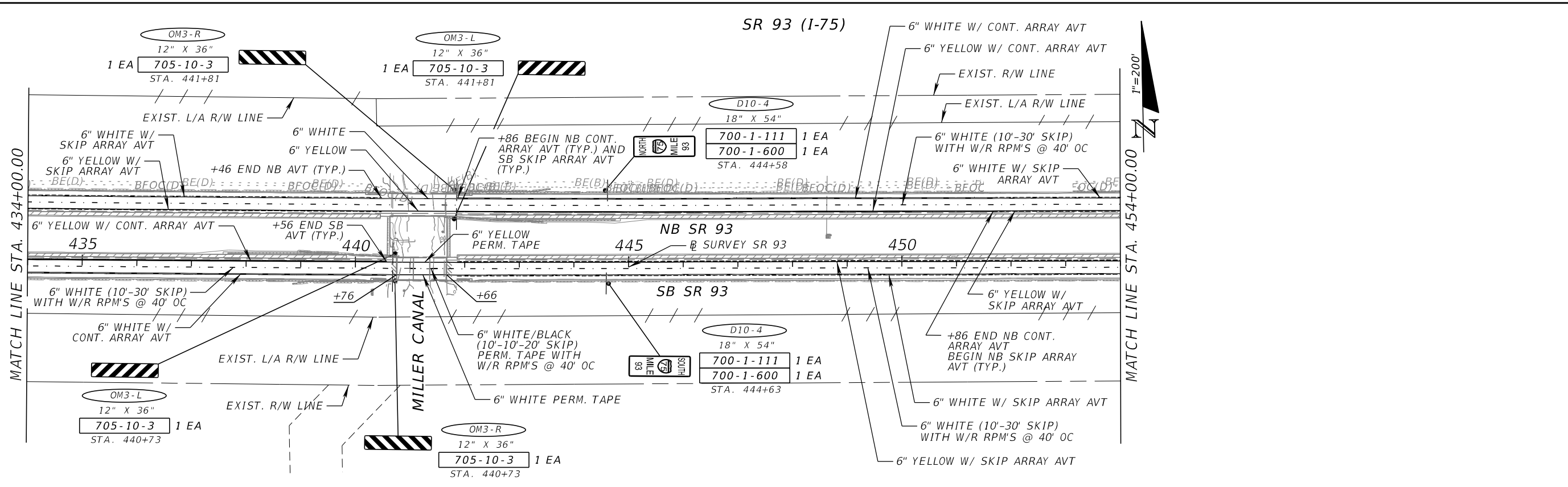
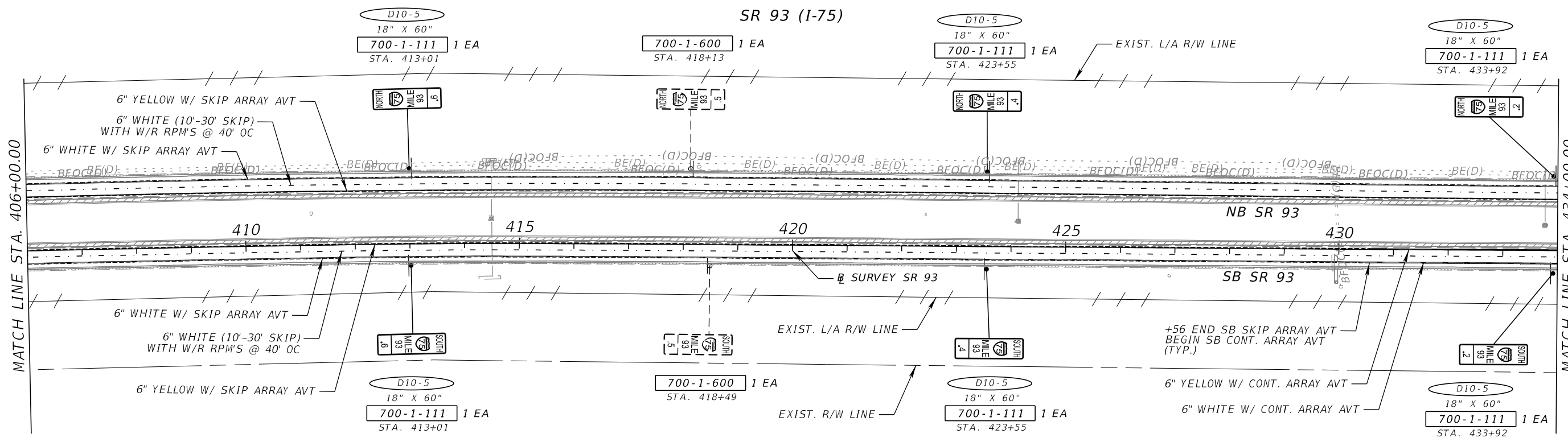

NOTE: APPROACH SLABS TO HAVE 6" THERMO WITH NO AVT

REVISIONS			
DATE	DESCRIPTION	DATE	DESCRIPTION

PATRICIA T. CHRISTIE, P.E.
P.E. NO.: 60049
FALLER, DAVIS & ASSOCIATES, INC.
1150 ASSEMBLY DRIVE, SUITE 400
TAMPA, FLORIDA 33607-4874

STATE OF FLORIDA DEPARTMENT OF TRANSPORTATION		
ROAD NO.	COUNTY	FINANCIAL PROJECT ID
SR 93	COLLIER	444008-4-52-01

**SIGNING AND PAVEMENT
MARKING PLAN (4)**

SHEET NO.
S-9

THE OFFICIAL RECORD OF THIS SHEET IS THE ELECTRONIC FILE DIGITALLY SIGNED AND SEALED UNDER RULE 61G15-23.004, F.A.C.

EXIST. L/A R/W LINE

SR 93 (I-75)

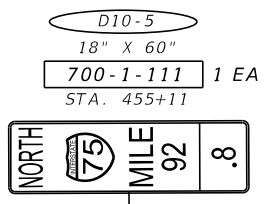

6" WHITE W/ SKIP ARRAY AVT
 6" WHITE (10'-30' SKIP)
 WITH W/R RPM'S @ 40' OC

+34 END NB OUTSIDE
 SHOULDER AVT

6" WHITE WITH W/R
 RPM'S @ 40' OC

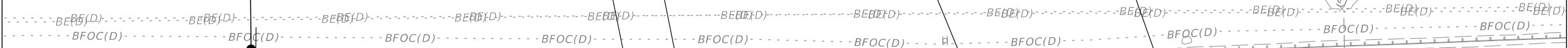

NB SR 93

6" YELLOW W/ SKIP ARRAY AVT

MATCH LINE STA. 454+00.00

MATCH LINE STA. 461+00.00



SB SR 93

6" WHITE (10'-30' SKIP)
 WITH W/R RPM'S @ 40' OC
 6" WHITE W/ SKIP ARRAY AVT

⊕ SURVEY SR 93

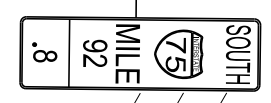

EXIST. L/A R/W LINE

REVISIONS				PATRICIA T. CHRISTIE, P.E. P.E. NO.: 60049 FALLER, DAVIS & ASSOCIATES, INC. 1150 ASSEMBLY DRIVE, SUITE 400 TAMPA, FLORIDA 33607-4874	STATE OF FLORIDA DEPARTMENT OF TRANSPORTATION			SIGNING AND PAVEMENT MARKING PLAN (5)	SHEET NO.
DATE	DESCRIPTION	DATE	DESCRIPTION		ROAD NO.	COUNTY	FINANCIAL PROJECT ID		
					SR 93	COLLIER	444008-4-52-01		S-10

SR 93 (I-75)

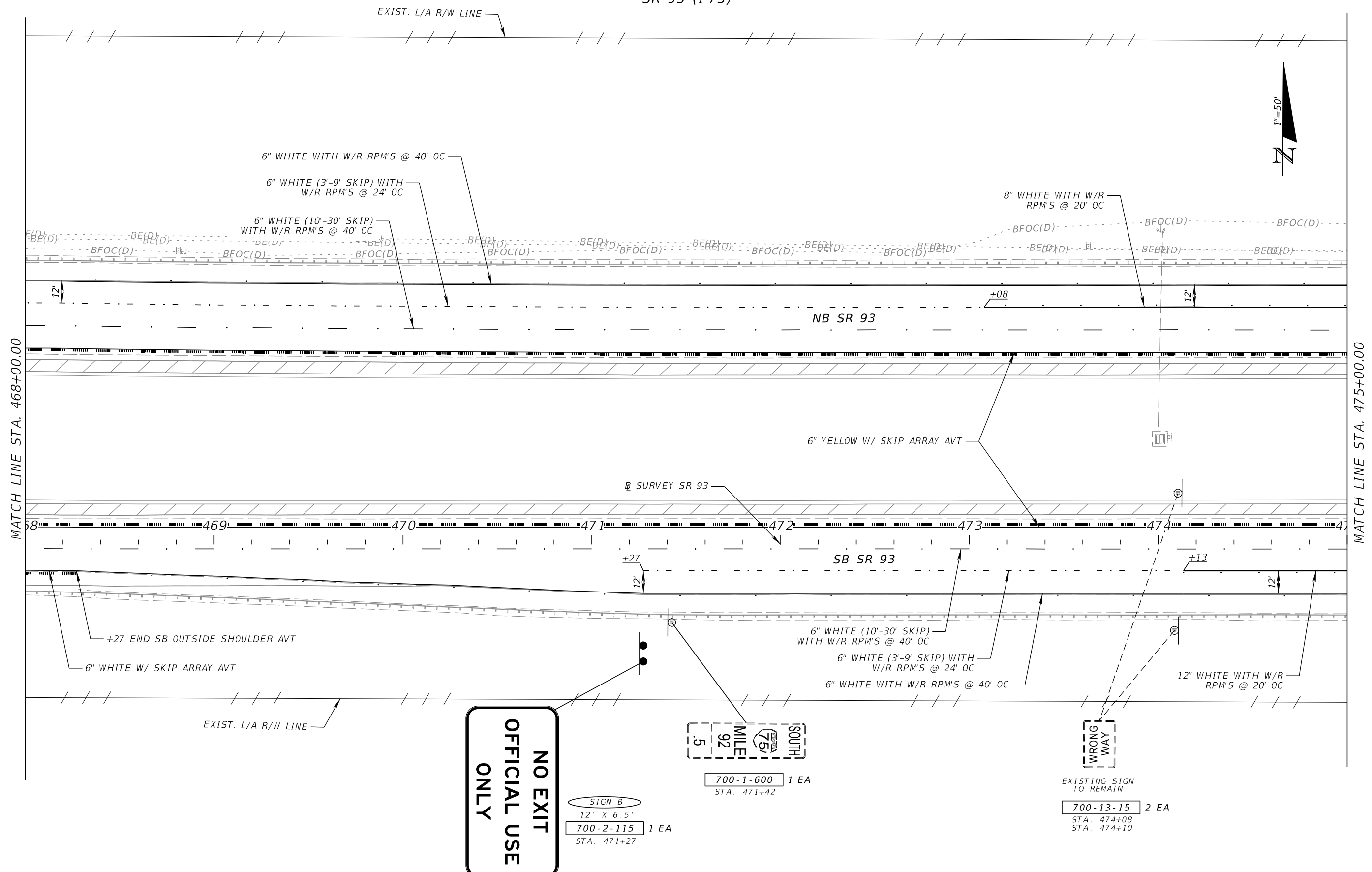

MATCH LINE STA. 468+00.00

MATCH LINE STA. 475+00.00

**NO EXIT
OFFICIAL USE
ONLY**

SIGN B
12' X 6.5'
700-2-115 1 EA
STA. 471+27

5
MILE
92
SOUTH
75
700-1-600 1 EA
STA. 471+42

EXISTING SIGN
TO REMAIN
700-13-15 2 EA
STA. 474+08
STA. 474+10

REVISIONS				PATRICIA T. CHRISTIE, P.E. P.E. NO.: 60049 FALLER, DAVIS & ASSOCIATES, INC. 1150 ASSEMBLY DRIVE, SUITE 400 TAMPA, FLORIDA 33607-4874	STATE OF FLORIDA DEPARTMENT OF TRANSPORTATION			SIGNING AND PAVEMENT MARKING PLAN (7)	SHEET NO.
DATE	DESCRIPTION	DATE	DESCRIPTION		ROAD NO.	COUNTY	FINANCIAL PROJECT ID		S-12
					SR 93	COLLIER	444008-4-52-01		

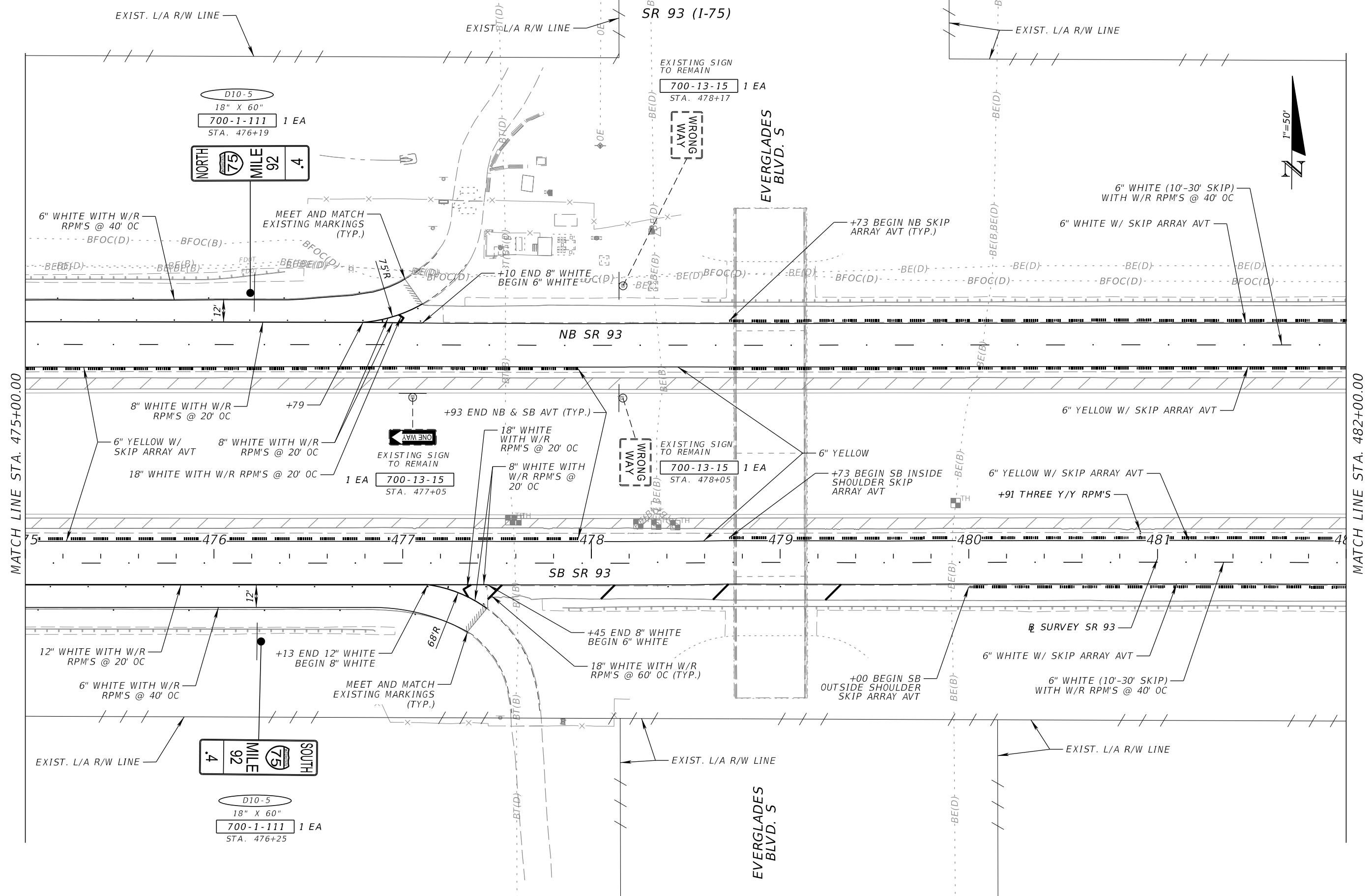

REVISIONS			
DATE	DESCRIPTION	DATE	DESCRIPTION

PATRICIA T. CHRISTIE, P.E.
P.E. NO.: 60049
FALLER, DAVIS & ASSOCIATES, INC.
1150 ASSEMBLY DRIVE, SUITE 400
TAMPA, FLORIDA 33607-4874

STATE OF FLORIDA DEPARTMENT OF TRANSPORTATION		
ROAD NO.	COUNTY	FINANCIAL PROJECT ID
SR 93	COLLIER	444008-4-52-01

**SIGNING AND PAVEMENT
MARKING PLAN (8)**

SHEET NO.
S-13

THE OFFICIAL RECORD OF THIS SHEET IS THE ELECTRONIC FILE DIGITALLY SIGNED AND SEALED UNDER RULE 61G15-23.004, F.A.C.

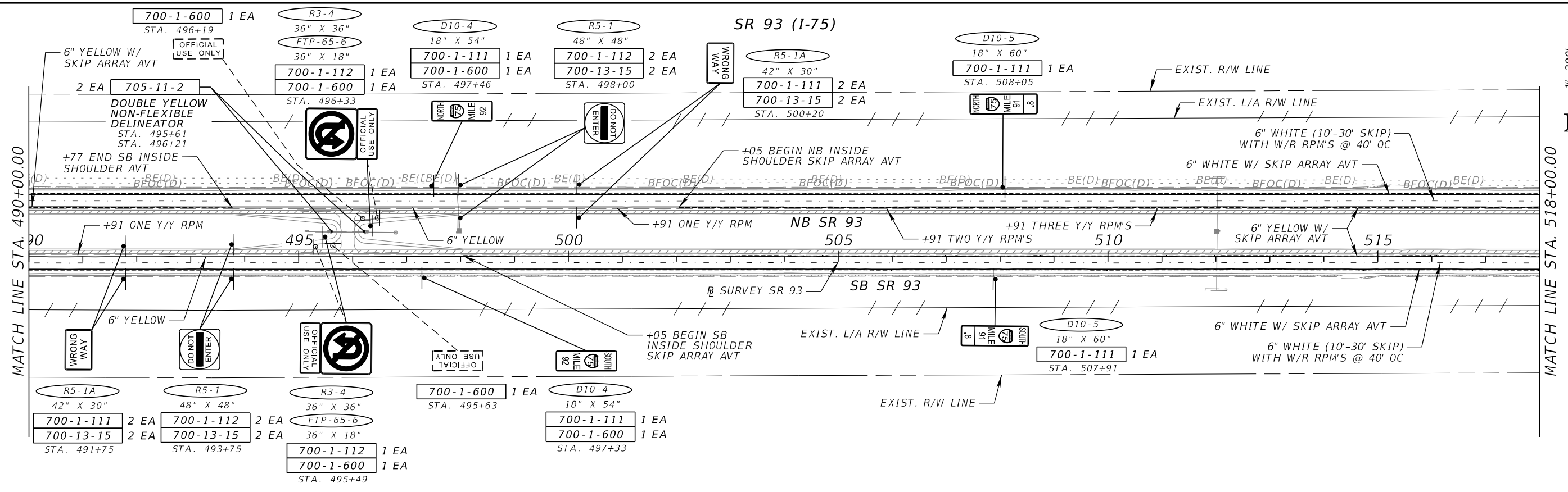
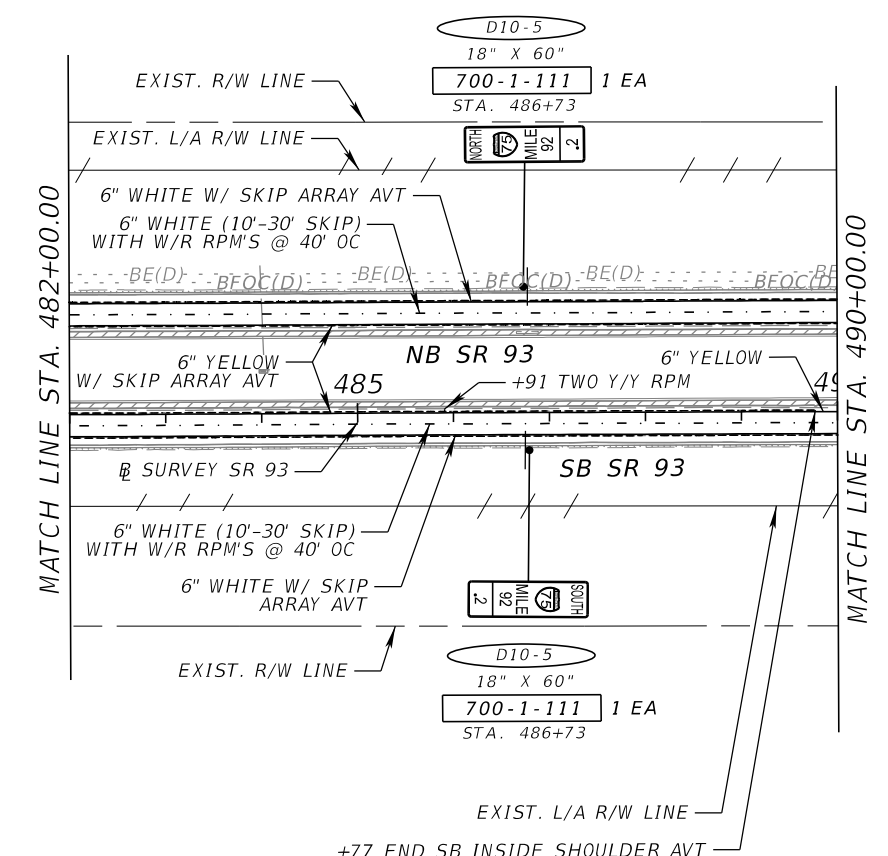

REVISIONS			
DATE	DESCRIPTION	DATE	DESCRIPTION

PATRICIA T. CHRISTIE, P.E.
P.E. NO.: 60049
FALLER, DAVIS & ASSOCIATES, INC.
1150 ASSEMBLY DRIVE, SUITE 400
TAMPA, FLORIDA 33607-4874

STATE OF FLORIDA DEPARTMENT OF TRANSPORTATION		
ROAD NO.	COUNTY	FINANCIAL PROJECT ID
SR 93	COLLIER	444008-4-52-01

**SIGNING AND PAVEMENT
MARKING PLAN (9)**

SHEET NO.
S-14

THE OFFICIAL RECORD OF THIS SHEET IS THE ELECTRONIC FILE DIGITALLY SIGNED AND SEALED UNDER RULE 61G15-23.004, F.A.C.

SR 93 (I-75)

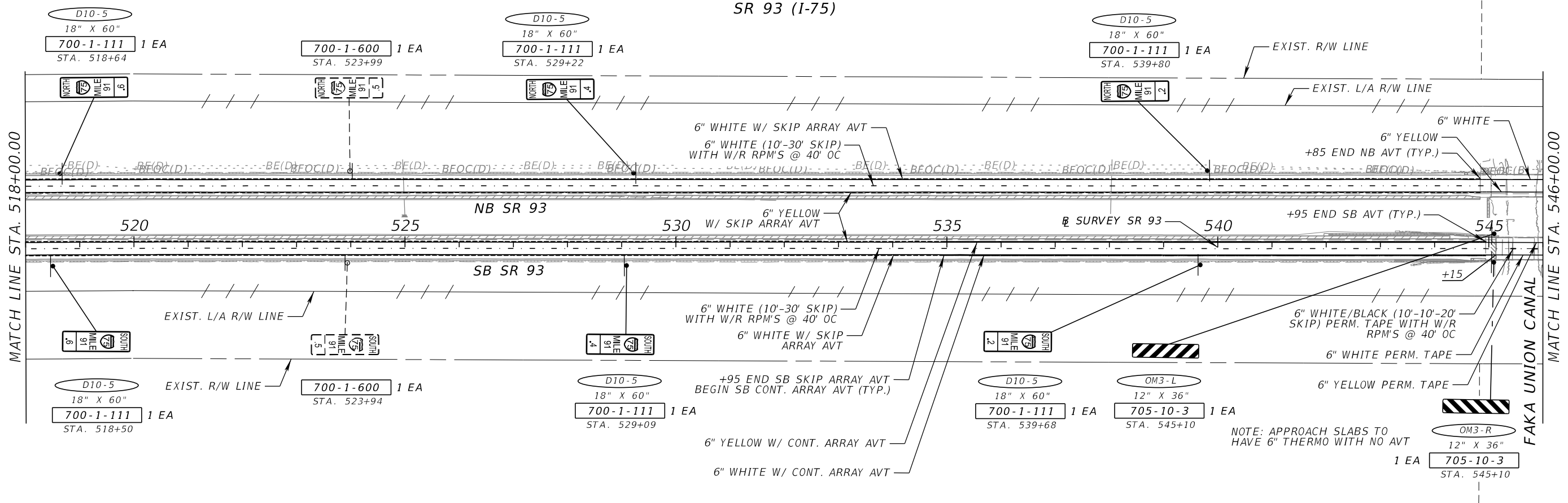

SR 93 (I-75)

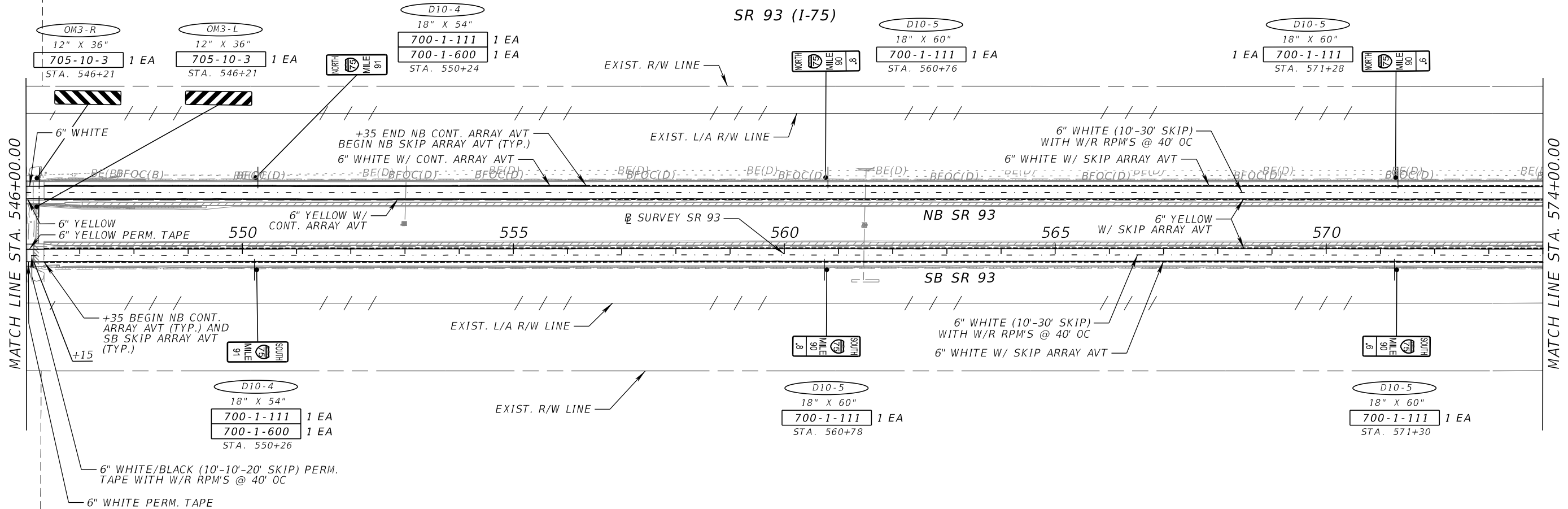

REVISIONS			
DATE	DESCRIPTION	DATE	DESCRIPTION

PATRICIA T. CHRISTIE, P.E.
 P.E. NO.: 60049
 FALLER, DAVIS & ASSOCIATES, INC.
 1150 ASSEMBLY DRIVE, SUITE 400
 TAMPA, FLORIDA 33607-4874

STATE OF FLORIDA DEPARTMENT OF TRANSPORTATION		
ROAD NO.	COUNTY	FINANCIAL PROJECT ID
SR 93	COLLIER	444008-4-52-01

**SIGNING AND PAVEMENT
 MARKING PLAN (10)**

SHEET NO.
 S-15

THE OFFICIAL RECORD OF THIS SHEET IS THE ELECTRONIC FILE DIGITALLY SIGNED AND SEALED UNDER RULE 61G15-23.004, F.A.C.

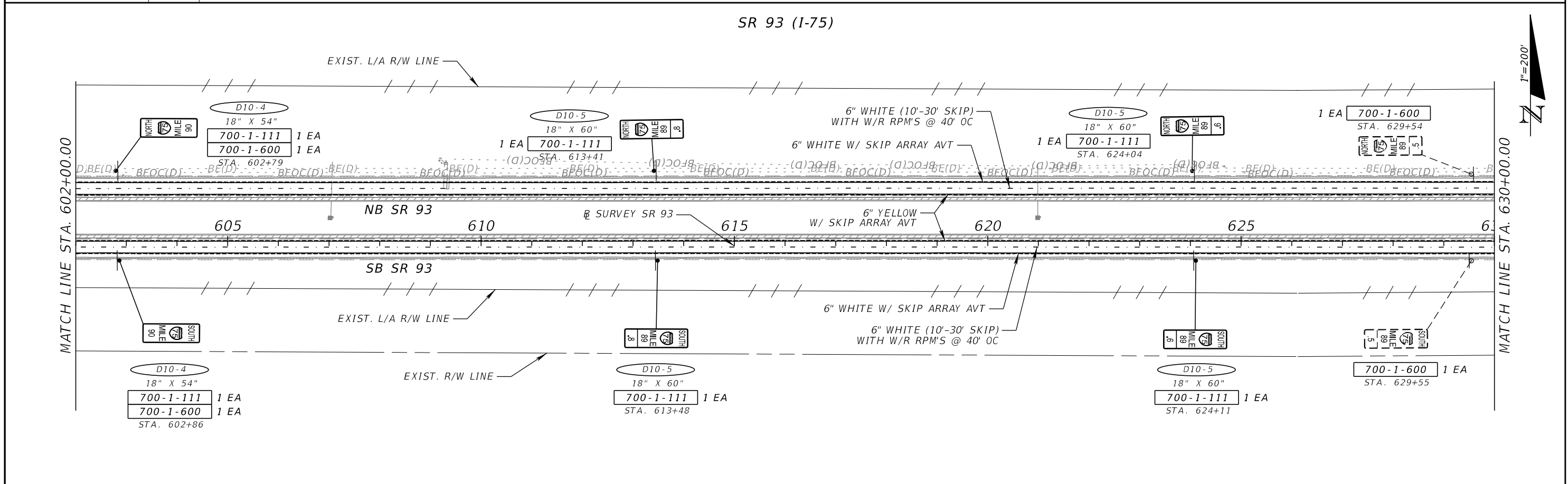
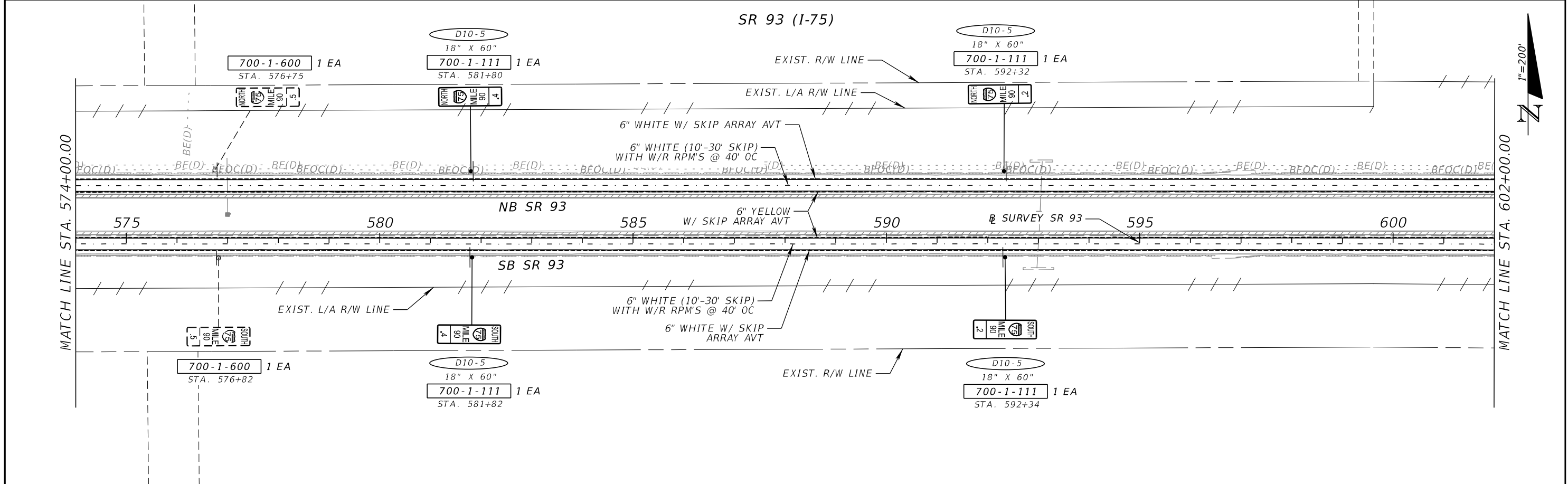

REVISIONS				PATRICIA T. CHRISTIE, P.E. P.E. NO.: 60049 FALLER, DAVIS & ASSOCIATES, INC. 1150 ASSEMBLY DRIVE, SUITE 400 TAMPA, FLORIDA 33607-4874	STATE OF FLORIDA DEPARTMENT OF TRANSPORTATION			SIGNING AND PAVEMENT MARKING PLAN (11)	SHEET NO. S-16
DATE	DESCRIPTION	DATE	DESCRIPTION		ROAD NO.	COUNTY	FINANCIAL PROJECT ID		
					SR 93	COLLIER	444008-4-52-01		

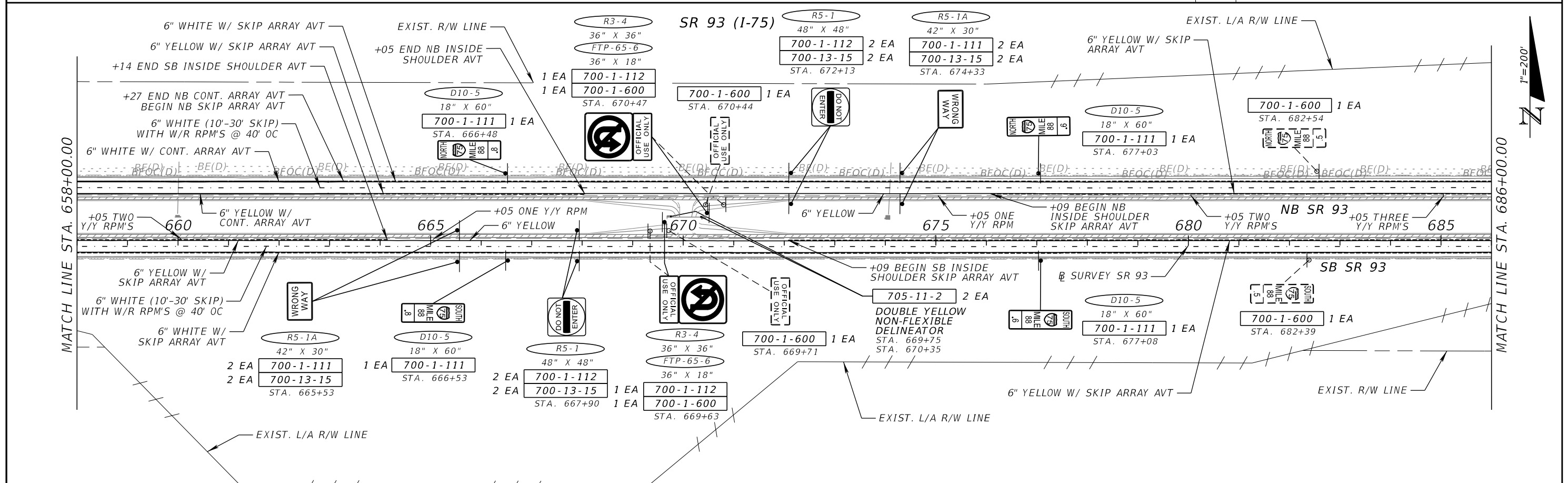
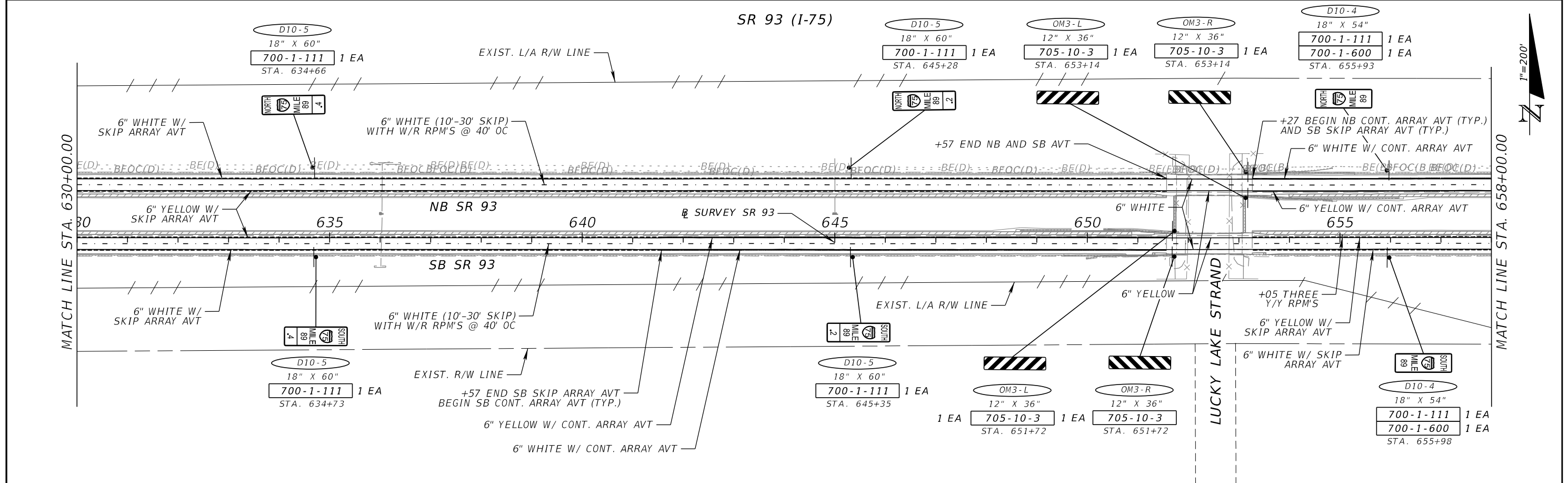

REVISIONS				PATRICIA T. CHRISTIE, P.E. P.E. NO.: 60049 FALLER, DAVIS & ASSOCIATES, INC. 1150 ASSEMBLY DRIVE, SUITE 400 TAMPA, FLORIDA 33607-4874	STATE OF FLORIDA DEPARTMENT OF TRANSPORTATION			SIGNING AND PAVEMENT MARKING PLAN (12)	SHEET NO. S-17
DATE	DESCRIPTION	DATE	DESCRIPTION		ROAD NO.	COUNTY	FINANCIAL PROJECT ID		
					SR 93	COLLIER	444008-4-52-01		

THE OFFICIAL RECORD OF THIS SHEET IS THE ELECTRONIC FILE DIGITALLY SIGNED AND SEALED UNDER RULE 61G15-23.004, F.A.C.

SR 93 (I-75)

MATCH LINE STA. 742+00.00

MATCH LINE STA. 770+00.00

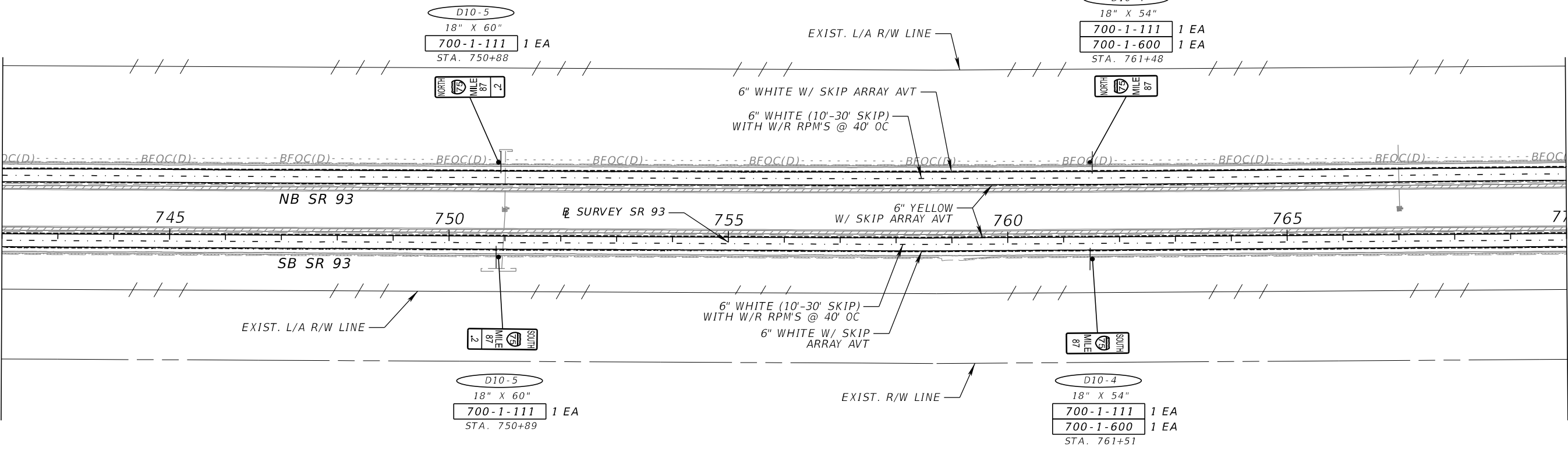

SR 93 (I-75)

MATCH LINE STA. 770+00.00

MATCH LINE STA. 798+00.00

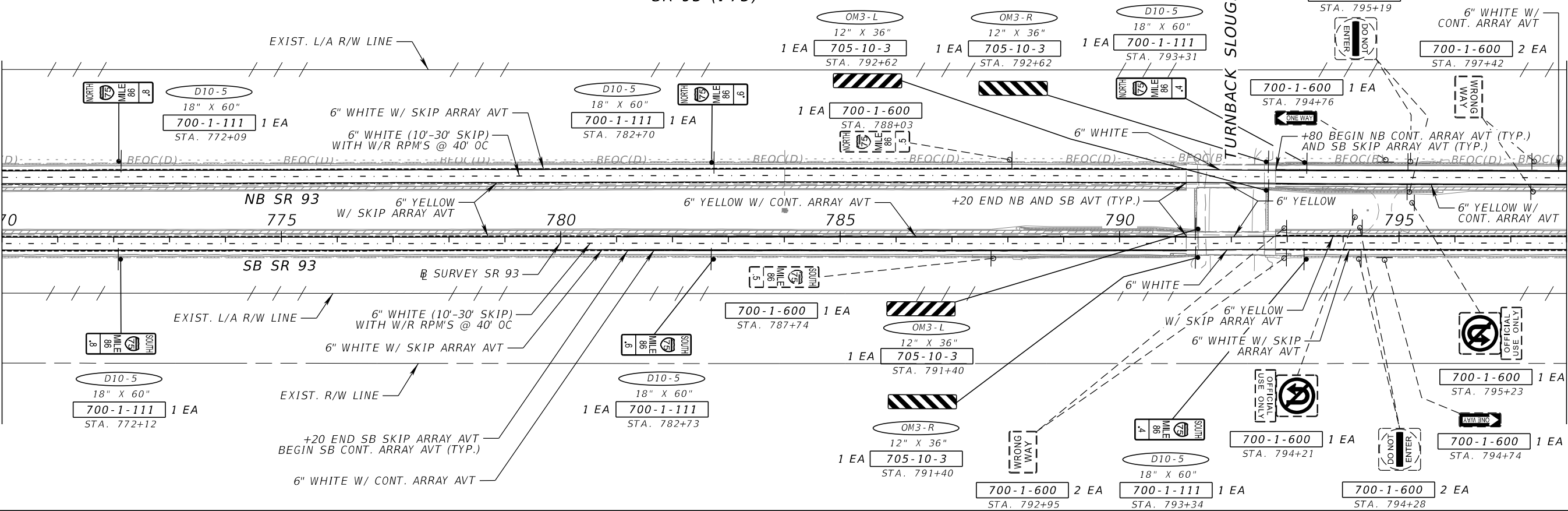

REVISIONS			
DATE	DESCRIPTION	DATE	DESCRIPTION

PATRICIA T. CHRISTIE, P.E.
 P.E. NO.: 60049
 FALLER, DAVIS & ASSOCIATES, INC.
 1150 ASSEMBLY DRIVE, SUITE 400
 TAMPA, FLORIDA 33607-4874

STATE OF FLORIDA DEPARTMENT OF TRANSPORTATION		
ROAD NO.	COUNTY	FINANCIAL PROJECT ID
SR 93	COLLIER	444008-4-52-01

SIGNING AND PAVEMENT MARKING PLAN (14)

SHEET NO.
S-19

THE OFFICIAL RECORD OF THIS SHEET IS THE ELECTRONIC FILE DIGITALLY SIGNED AND SEALED UNDER RULE 61G15-23.004, F.A.C.

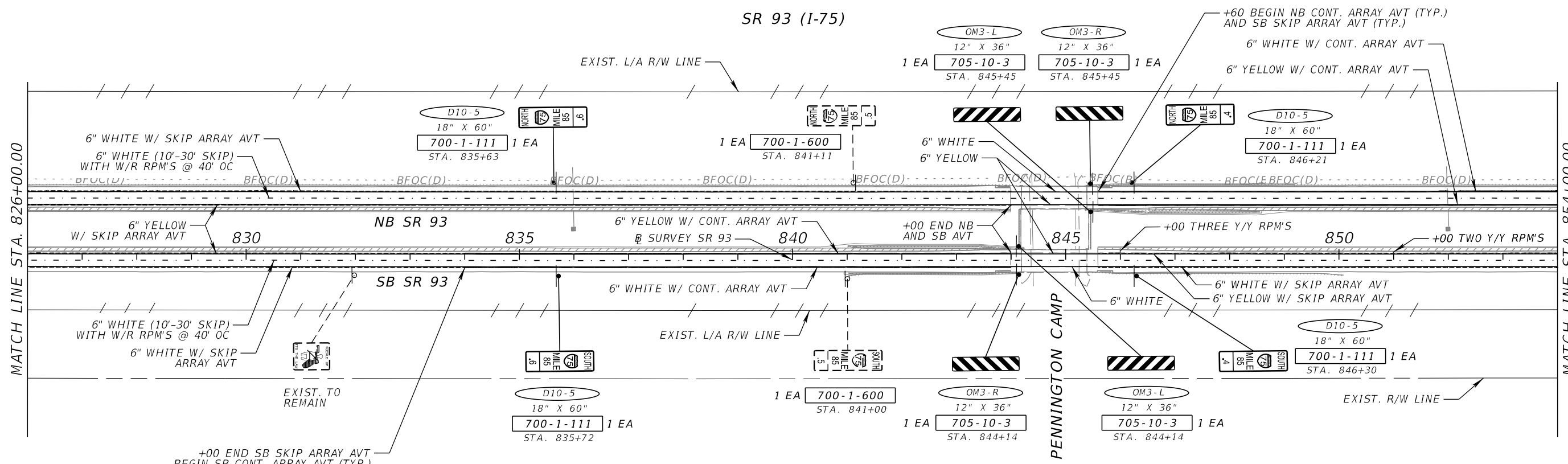
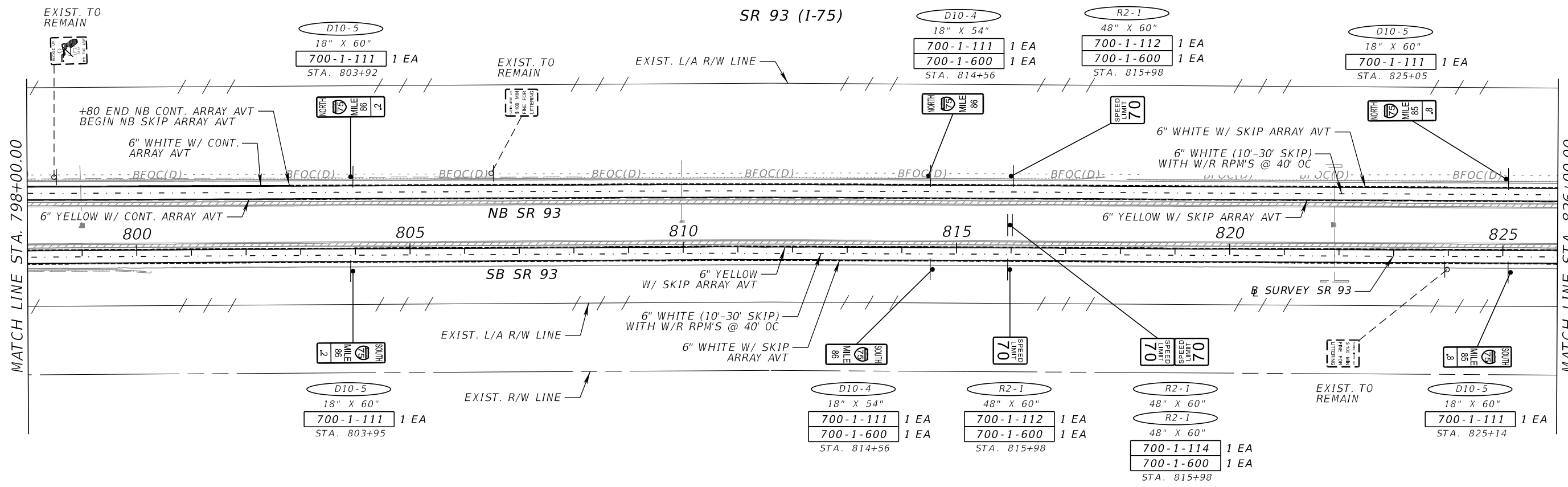

REVISIONS			
DATE	DESCRIPTION	DATE	DESCRIPTION

PATRICIA T. CHRISTIE, P.E.
P.E. NO.: 60049
FALLER, DAVIS & ASSOCIATES, INC.
1150 ASSEMBLY DRIVE, SUITE 400
TAMPA, FLORIDA 33607-4874

STATE OF FLORIDA DEPARTMENT OF TRANSPORTATION		
ROAD NO.	COUNTY	FINANCIAL PROJECT ID
SR 93	COLLIER	444008-4-52-01

**SIGNING AND PAVEMENT
MARKING PLAN (15)**

SHEET NO.
S-20

THE OFFICIAL RECORD OF THIS SHEET IS THE ELECTRONIC FILE DIGITALLY SIGNED AND SEALED UNDER RULE 61G15-23.004, F.A.C.

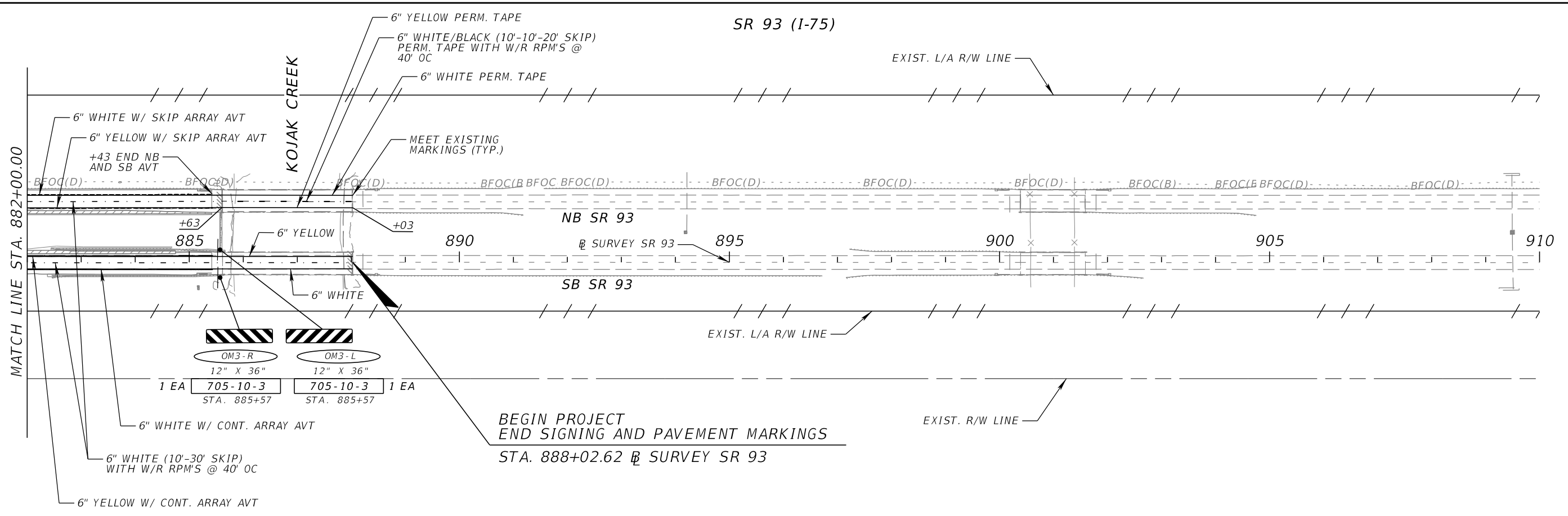
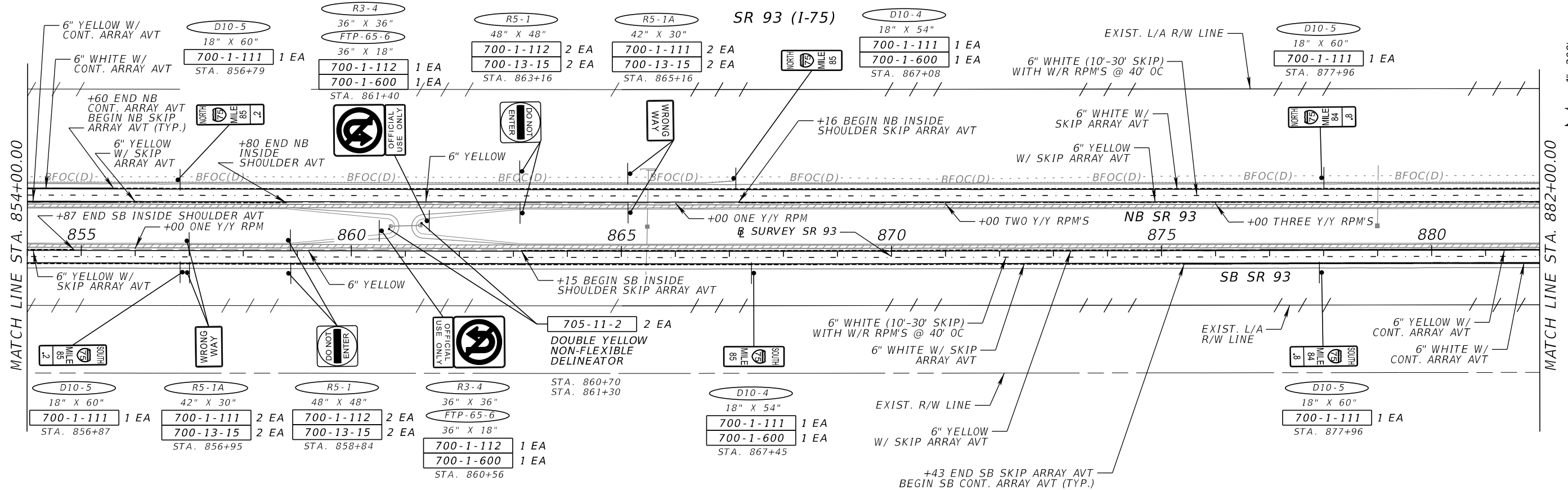

REVISIONS			
DATE	DESCRIPTION	DATE	DESCRIPTION

PATRICIA T. CHRISTIE, P.E.
P.E. NO.: 60049
FALLER, DAVIS & ASSOCIATES, INC.
1150 ASSEMBLY DRIVE, SUITE 400
TAMPA, FLORIDA 33607-4874

STATE OF FLORIDA DEPARTMENT OF TRANSPORTATION		
ROAD NO.	COUNTY	FINANCIAL PROJECT ID
SR 93	COLLIER	444008-4-52-01

**SIGNING AND PAVEMENT
MARKING PLAN (16)**

SHEET NO.
S-21

THE OFFICIAL RECORD OF THIS SHEET IS THE ELECTRONIC FILE DIGITALLY SIGNED AND SEALED UNDER RULE 61G15-23.004, F.A.C.

SIGN NAME A		QTY	2	SIGN NUMBER	266+18	STATION(S)
PANEL	BORDER					
WIDTH	15'-0"	WIDTH	1.5"		711+20	
HEIGHT	8'-6"	RADII	9"			
LEGEND	Black	COLOR	Black			
COLOR	White/Yellow					
SYMBOL(S)	ANGLE	X	Y	WID	HT	
SIGN NUMBER	NUMBER OF POSTS	CLEARANCE Edge Of Land	COLUMN SIZE	AVERAGE LENGTH		

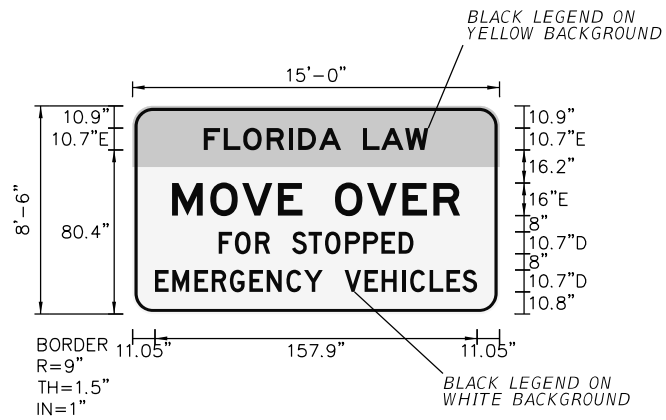

NO. OF LIGHT FIXTURES	FIXTURE SPACING	PHOTOMETRIC CURVE	WATT	VOLTAGE
-----------------------	-----------------	-------------------	------	---------

COPY		F	L	O	R	I	D	A	L	A	W	L									
SPACE	34.9	9.8	9.5	11.4	10.8	4.7	10.2	10.9	10.7	8.9	11.8	11.3	34.9	110.1							
COPY		M	O	V	E		O	V	E	R	L										
SPACE	19.4	18.7	15.7	17.4	12	16	15.7	17.4	15.2	13	19.4	141.1									
COPY		F	O	R		S	T	O	P	P	E	D	L								
SPACE	42.2	8	10	7.3	10.7	8.1	8	10	8.9	8.9	8.5	7.3	42.2	95.6							
COPY		E	M	E	R	G	E	N	C	Y		V	E	H	I	C	L	E	S	L	
SPACE	11	8.5	10.9	8.5	8.9	9.6	8.5	9.6	8.7	9.2	10.7	9.7	8.5	9.8	4.1	9.6	8.2	7.7	7.3	11	157.9
COPY																					
SPACE																					
COPY																					
SPACE																					

SIGN NAME B		QTY	1	SIGN NUMBER	471+27	STATION(S)
PANEL	BORDER					
WIDTH	12'-0"	WIDTH	2"			
HEIGHT	6'-6"	RADII	10"			
LEGEND	Black/Red	COLOR	Black			
COLOR	White					
SYMBOL(S)	ANGLE	X	Y	WID	HT	
SIGN NUMBER	NUMBER OF POSTS	CLEARANCE Edge Of Land	COLUMN SIZE	AVERAGE LENGTH		
	2	5' FACE OF GR	W6X12	14.9'		

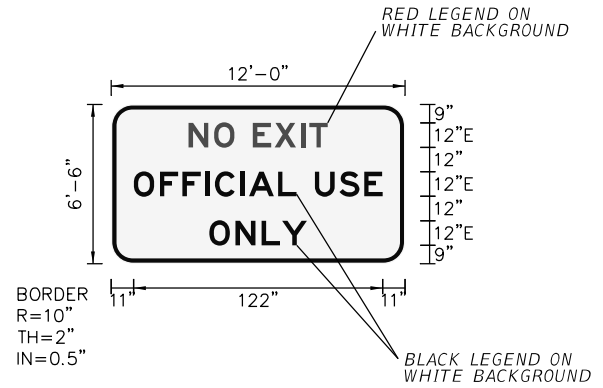

NO. OF LIGHT FIXTURES	FIXTURE SPACING	PHOTOMETRIC CURVE	WATT	VOLTAGE
-----------------------	-----------------	-------------------	------	---------

COPY		N	O	E	X	I	T	L											
SPACE	37.9	12.5	10.1	9	10.7	12.8	4.2	9	37.9	68.3									
COPY		O	F	F	I	C	I	A	L		U	S	E	L					
SPACE	11	12.8	11	11	4.9	12.5	4.2	14.3	9	9	12.1	12.1	9	11	122				
COPY		O	N	L	Y	L													
SPACE	48.1	12.8	12.8	10	12.2	48.1	47.9												
COPY																			
SPACE																			
COPY																			
SPACE																			

SIGN NAME		QTY		SIGN NUMBER		STATION(S)
PANEL	BORDER					
WIDTH	WIDTH					
HEIGHT	RADII					
LEGEND	COLOR					
COLOR						
SYMBOL(S)	ANGLE	X	Y	WID	HT	
SIGN NUMBER	NUMBER OF POSTS	CLEARANCE Edge Of Land	COLUMN SIZE	AVERAGE LENGTH		

THIS SPACE INTENTIONALLY LEFT BLANK

NO. OF LIGHT FIXTURES	FIXTURE SPACING	PHOTOMETRIC CURVE	WATT	VOLTAGE
-----------------------	-----------------	-------------------	------	---------

COPY																			
SPACE																			
COPY																			
SPACE																			
COPY																			
SPACE																			
COPY																			
SPACE																			

SIGN NAME		QTY		SIGN NUMBER		STATION(S)
PANEL	BORDER					
WIDTH	WIDTH					
HEIGHT	RADII					
LEGEND	COLOR					
COLOR						
SYMBOL(S)	ANGLE	X	Y	WID	HT	
SIGN NUMBER	NUMBER OF POSTS	CLEARANCE Edge Of Land	COLUMN SIZE	AVERAGE LENGTH		

THIS SPACE INTENTIONALLY LEFT BLANK

NO. OF LIGHT FIXTURES	FIXTURE SPACING	PHOTOMETRIC CURVE	WATT	VOLTAGE
-----------------------	-----------------	-------------------	------	---------

COPY																			
SPACE																			
COPY																			
SPACE																			
COPY																			
SPACE																			
COPY																			
SPACE																			

REVISIONS			
DATE	DESCRIPTION	DATE	DESCRIPTION

PATRICIA T. CHRISTIE, P.E.
P.E. NO.: 60049
FALLER, DAVIS & ASSOCIATES, INC.
1150 ASSEMBLY DRIVE, SUITE 400
TAMPA, FLORIDA 33607-4874

STATE OF FLORIDA DEPARTMENT OF TRANSPORTATION		
ROAD NO.	COUNTY	FINANCIAL PROJECT ID
SR 93	COLLIER	444008-4-52-01

GUIDE SIGN WORK SHEET (1)

SHEET NO.
S-22

