

CONTRACT PLANS COMPONENTS

ROADWAY
SIGNING AND PAVEMENT MARKING
SIGNALIZATION
LIGHTING

STATE OF FLORIDA
DEPARTMENT OF TRANSPORTATION

CONTRACT PLANS

FINANCIAL PROJECT ID 444612-1-52-01,
444612-1-52-02, and 444612-1-52-03

(FEDERAL FUNDS)

MANATEE COUNTY (13010000)

STATE ROAD NO. 45 (US 41)

MILL AND RESURFACE EDWARDS DRIVE TO MAGELLAN DRIVE

SIGNALIZATION PLANS

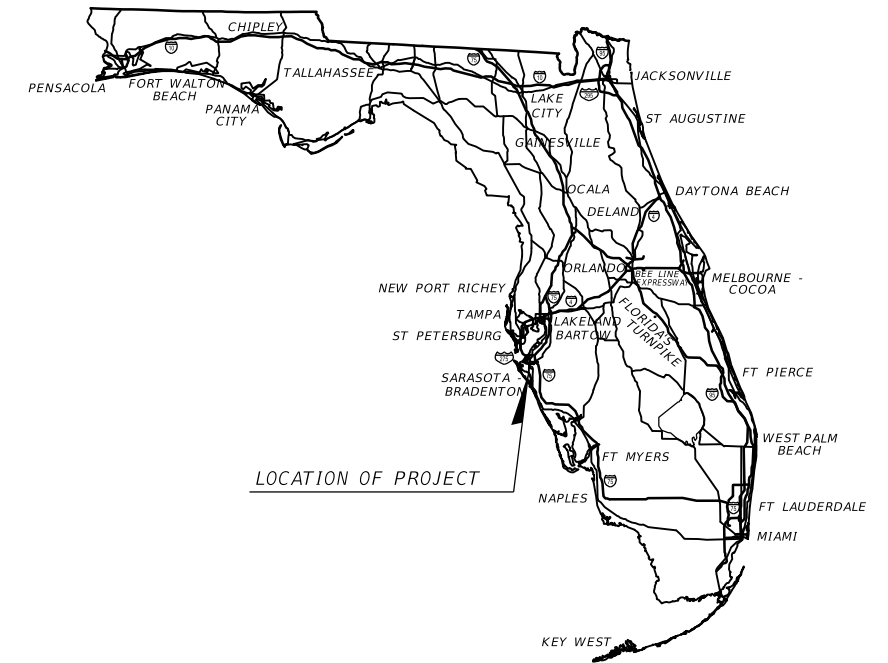

INDEX OF SIGNALIZATION PLANS

SHEET NO.	SHEET DESCRIPTION
T-1	KEY SHEET
T-2	SIGNATURE SHEET
T-3	GENERAL NOTES
T-4 - T-15	SIGNALIZATION PLAN
T-16 - T-19	PEDESTRIAN SIGNAL DETAIL
T-20 - T-23	SPLICING DIAGRAM
T-24 - T-25	GUIDE SIGN WORK SHEET
T-26 - T-29	STANDARD MAST ARM TABULATION
T-30 - T-33	SIGNAL TIMING PLANS (NOT INCLUDED)
T-34 - T-37	STANDARD MAST ARM ASSEMBLIES DATA TABLE (NOT INCLUDED)
T-38 - T-41	REPORT OF CORE BORINGS FOR SIGNALS (NOT INCLUDED)

PROJECT LOCATION URL:	https://tinyurl.com/yysx5m6c
PROJECT LIMITS:	BEGIN MP 0.000 - END MP 2.095
EXCEPTIONS:	NONE
BRIDGE LIMITS:	NONE
RAILROAD CROSSING:	NONE

SIGNALIZATION SHOP DRAWINGS
TO BE SUBMITTED TO:

MARK L. PERONTO, P.E.
FLORIDA DEPARTMENT OF TRANSPORTATION
DISTRICT ONE STRUCTURES DESIGN ENGINEER
801 N. BROADWAY AVENUE
BARTOW, FLORIDA 33830-3809
TELEPHONE: 863-519-2281

**SIGNALIZATION PLANS
ENGINEER OF RECORD:**

ISAMARIE L. MONREAL, P.E.
P.E. LICENSE NUMBER 72029
FLORIDA DEPARTMENT OF TRANSPORTATION
801 N. BROADWAY AVENUE
BARTOW, FL 33830-3809
TELEPHONE: 863-519-2368

FDOT PROJECT MANAGER:
ISAMARIE L. MONREAL, P.E.

GOVERNING STANDARD PLANS:

Florida Department of Transportation, FY 2023-24 Standard Plans for Road and Bridge Construction and applicable Interim Revisions (IRs).

Standard Plans for Road Construction and associated IRs are available at the following website: <http://www.fdot.gov/design/standardplans>

GOVERNING STANDARD SPECIFICATIONS:

Florida Department of Transportation, FY 2023-24 Standard Specifications for Road and Bridge Construction at the following website: <http://www.fdot.gov/programmanagement/Implemented/SpecBooks>

PHASE II PLANS
05/22/2024

CONSTRUCTION CONTRACT NO.	FISCAL YEAR	SHEET NO.
T1813	26	T-1

5/22/2024 8:18:41 AM C:\Projects\FDOT\44461215201\Signalization\KEY55G01.dgn KWHNTST

THE OFFICIAL RECORD OF THIS SHEET IS THE ELECTRONIC FILE DIGITALLY SIGNED AND SEALED UNDER RULE 61G15-23.004, F.A.C.

PAY ITEM NOTES:

- 630-2-11, 630-2-12:
USE A MINIMUM OF 3" DIAMETER CONDUIT FOR FIBER OPTIC INTERCONNECT CABLE.
- 632-7-1:
COMPLETELY REWIRE INTERSECTION AT ALL SIGNAL LOCATIONS. VERIFY THE COLOR CODE OF SIGNAL CABLE WITH THE MAINTAINING AGENCY PRIOR TO WIRING INTERSECTION. USE A MINIMUM OF 7 CONDUCTOR SIGNAL CABLE FOR SIGNAL HEADS AND PEDESTRIAN HEADS.
- 635-2-11:
PULL BOXES ARE TO BE PLACED BEHIND CURB AND GUTTER. IF THERE IS NO CURB AND GUTTER, PULL BOXES SHALL BE PLACED A MINIMUM OF 7' FROM THE EDGE OF PAVEMENT. PULL BOXES COVER LOGOS TO BE STAMPED "MANATEE COUNTY TRAFFIC SIGNAL".
- 635-2-12:
USE POLYMER CONCRETE CONSTRUCTION PULL BOX WITH A POLYMER CONCRETE COVER MARKED "MANATEE COUNTY FIBEROPTIC SYSTEM" FOR FIBER OPTIC COMMUNICATION. PULL BOXES ARE TO BE PLACED BEHIND CURB AND GUTTER. IF THERE IS NO CURB AND GUTTER, PULL BOXES SHALL BE PLACED A MINIMUM OF 7' FROM THE EDGE OF PAVEMENT.
- 639-1-122:
USE ALUMINUM RIGID ABOVEGROUND CONDUIT FOR ELECTRICAL POWER SERVICE.
- 639-2-1:
USE A BONDING WIRE FROM ELECTRICAL SERVICE POINT TO CONTROLLER.
- 639-3-11:
ELECTRICAL SERVICE DISCONNECT IS 100 AMP, COMPRISING OF SIX (6) CIRCUIT DISCONNECT BOX WITH THREE CIRCUIT BREAKERS - ONE 40 AMP/120 VOLT FOR CONTROLLER CABINET, ONE 15 AMP/120 VOLT FOR INTERNALLY ILLUMINATED STREET NAME SIGNS AND ONE 15 AMP/120 VOLT FOR FUTURE USE.
- 646-1-11, 646-1-12:
USE LOCKING COLLARS WHEN MOUNTING ALUMINUM PEDESTRIAN POLES TO PEDESTRIAN PEDESTAL BASES. USE BREAKAWAY ALUMINUM SQUARE BASE ASSEMBLIES WITH ALUMINUM DOORS FOR PEDESTRIAN PEDESTALS.
- 649-21-1, 649-21-10:
USE TWO 2" AND ONE 1" CONDUITS STUBBED OUT THROUGH THE MAST ARM POLE FOUNDATION AND TEMPORARILY SEAL. ALL MAST ARMS ASSEMBLIES SHALL HAVE A TERMINAL COMPARTMENT.
- 650-1-14, 650-1-16:
USE RED, YELLOW, GREEN, AND WHITE THHN #14 COPPER WIRES FROM DISCONNECT TO SIGNAL HEAD. PLACE A PERMANENT MARKING ON THE WIRE DESIGNATING THE PHASE USED. USE FLEXIBLE SIGNAL HEAD BACK PLATES.
- 653-1-11, 653-1-12:
PEDESTRIAN SIGNAL HEADS TO BE 16" INTERNATIONAL SYMBOL, LED COUNTDOWN TYPE.
- 663-1-111, 663-1-112:
SEE PLAN SHEET FOR THE NUMBER OF INFRARED DETECTORS INCLUDED FOR PREEMPTION DETECTION. INSTALL DETECTORS COMPATIBLE WITH MAINTAINING AGENCY'S EXISTING SYSTEM.
- 665-1-11:
USE PEDESTRIAN BUTTON SIGNAL SIGN FTP-68B-06. STREET NAME SHALL BE IN ACCORDANCE WITH THE STREET NAMES SHOWN ON THE SIGNALIZATION PLAN SHEETS.

- 670-5-111:
ALL CONTROLLER EQUIPMENT AND CABINETS SHALL BE FULLY COMPATIBLE WITH MANATEE COUNTY'S ATMS (NAZTEC'S ATMS.NOW). THE CONTROLLER SUPPLIED WITH THE CABINET SHALL BE A NAZTEC 980 ATC. THE CABINETS SHALL COME EQUIPPED WITH ALL THE NECESSARY SYSTEM COMPONENTS FOR INTEGRATION INTO ETHERNET BASED FIBER OPTIC NETWORK.

CONTROLLER MMU (MALFUNCTIONATION MANAGEMENT UNIT) TO BE COMPATIBLE WITH FOUR SECTION HEAD OPERATION/LOGIC.

USE A MINIMUM OF FOUR (4) PREEMPTION PLANS FOR CONTROLLER.
- 684-1-11:
INCLUDE A MANAGED FIELD ETHERNET SWITCH (MFES). THE CABINETS SHALL BE EQUIPPED WITH A RSG920P ETHERNET FIELD SWITCH WITH NECESSARY SYSTEM COMPONENTS FOR INTERGRATION INTO MAINTAINING AGENCY'S EXISTING SYSTEM. INSTALL MFES UNIT IN ACCORDANCE WITH MANUFACTURER'S RECOMMENDATIONS.
- 685-1-11:
INCLUDE AN UNINTERRUPTIBLE POWER SUPPLY UNIT (UPS). ATTACH UPS TO THE OUTSIDE OF THE CONTROLLER CABINET. INSTALL UPS UNIT IN ACCORDANCE WITH MANUFACTURER'S RECOMMENDATIONS. UPS EQUIPMENT TO BE COMPATIBLE WITH MAINTAINING AGENCY'S EXISTING SYSTEM.
- 700-5-21, 700-5-22:
USE LED INTERNALLY ILLUMINATED STREET NAME SIGNS. ALL INTERNALLY ILLUMINATED STREET NAME SIGNS TO BE MOUNTED RIGIDLY ON MAST ARM UNLESS NOTED OTHERWISE IN THE PLANS.

INSTALL PHOTOELECTRIC CELL FOR INTERNALLY ILLUMINATED STREET NAME SIGNS ON TRAFFIC SIGNAL ELECTRICAL SERVICE DISCONNECT. CONNECT INTERNALLY ILLUMINATED STREET NAME SIGN CONDUCTOR TO PHOTOELECTRIC CELL LOCATED OUTSIDE THE ELECTRICAL SERVICE DISCONNECT BOX AND PHOTOELECTRIC CELL CONDUCTORS TO DEDICATED 15 AMP/120 VOLT CIRCUIT BREAKER LOCATED INSIDE THE ELECTRICAL SERVICE DISCONNECT BOX.

GENERAL NOTES:

- WHERE MAST ARM OR ANY OTHER SIGNAL EQUIPMENT REQUIRING FOUNDATIONS ARE PROPOSED WITHIN 4 FEET OF ANY UNDERGROUND UTILITY, THE UTILITY SHALL BE LOCATED, EXPOSED AND PROTECTED. THE INITIAL 5 FEET OF THE SHAFT INSTALLATION SHALL BE EXPOSED USING NON MECHANIZED EQUIPMENT.
- FOR REMOVED SIGNAL EQUIPMENT CLAIMED BY MAINTAINING AGENCY, CONTACT MANATEE COUNTY.
- MAINTAINING AGENCY: MANATEE COUNTY, TRAFFIC DIVISION MANAGER
P.O. BOX 1000
BRADENTON, FL 34206-1000
PH: 941-749-3502
- PAVEMENT MARKINGS ARE SHOWN FOR REFERENCE PURPOSES ONLY. FOR PAVEMENT MARKING DESIGN INFORMATION, SEE PAVEMENT MARKING PLANS.
- CONTRACTOR TO COORDINATE WITH FLORIDA POWER & LIGHT (FPL) IN PERFORMING ALL NECESSARY WORK UNDER THEIR POWER LINES, SUCH AS INSTALLATION OF MAST ARM, SIGNAL CABLE, FIBERGLASS INSULATORS AND SIGNAL POLES. NOTIFY THE POWER COMPANY AT LEAST THREE (3) FULL BUSINESS DAYS PRIOR TO INSTALLATION.
- COORDORINATE WITH CEDAR HAMMOCK FIRE STATION TO TEST PREEMPTION AT TALLEVAST/GAINES AND WHITFIELD AVE PRIOR TO PROJECT CLOSEOUT.
- AT LEAST TWO (2) FULL BUSINESS DAYS PRIOR TO BEGINING THE TRAFFIC SIGNAL INSTALLATION, CONTACT THE TRAFFIC SIGNAL INSPECTOR/LIASON:

MANATEE COUNTY TRAFFIC OPERATIONS DIVISION
AARON BURKETT
TRAFFIC OPERATIONS DIVISION
2904 12TH STREET COURT EAST
BRADENTON, FL 34208
PH: 941-708-7509
- WHEN CONSTRUCTION IS COMPLETE, PROVIDE A SET OF "AS-BUILT" PLANS IN ELECTRONIC FORM (PDF) TO:

FDOT TRAFFIC OPERATIONS
NEAL TURNER, TSM&O ENGINEER-ARTERIALS
801 N. BROADWAY AVE.
BARTOW, FL 33830-1249
EMAIL: NEAL.TURNER@DOT.STATE.FL.US
PHONE: 863-519-2216
- THE LOCATIONS OF THE UTILITIES SHOWN IN THE PLANS (INCLUDING THOSE DESIGNATED Vv, Vh AND Vvh) ARE BASED ON LIMITED INVESTIGATION TECHNIQUES AND SHOULD BE CONSIDERED APPROXIMATELY ONLY. THE VERIFIED LOCATION/ELEVATIONS APPLY ONLY AT THE POINTS SHOWN. INTERPOLATIONS BETWEEN POINTS HAVE NOT BEEN VERIFIED.

5/22/2024 8:18:48 AM KINHNTST C:\Projects\FDOT\44461215201\Signalization\GNWT\SC01.dgn

THE OFFICIAL RECORD OF THIS SHEET IS THE ELECTRONIC FILE DIGITALLY SIGNED AND SEALED UNDER RULE 61G15-23.004, F.A.C.

REVISIONS				ENGINEER OF RECORD		STATE OF FLORIDA DEPARTMENT OF TRANSPORTATION			SHEET NO.
DATE	DESCRIPTION	DATE	DESCRIPTION			ROAD NO.	COUNTY	FINANCIAL PROJECT ID	
				ISAMARIE L. MONREAL, P.E. LICENSE NUMBER 72029 FLORIDA DEPARTMENT OF TRANSPORTATION 801 N. BROADWAY AVENUE BARTOW, FL 33830-3809		SR 45	MANATEE	444612-1-52-01	GENERAL NOTES
									T-3

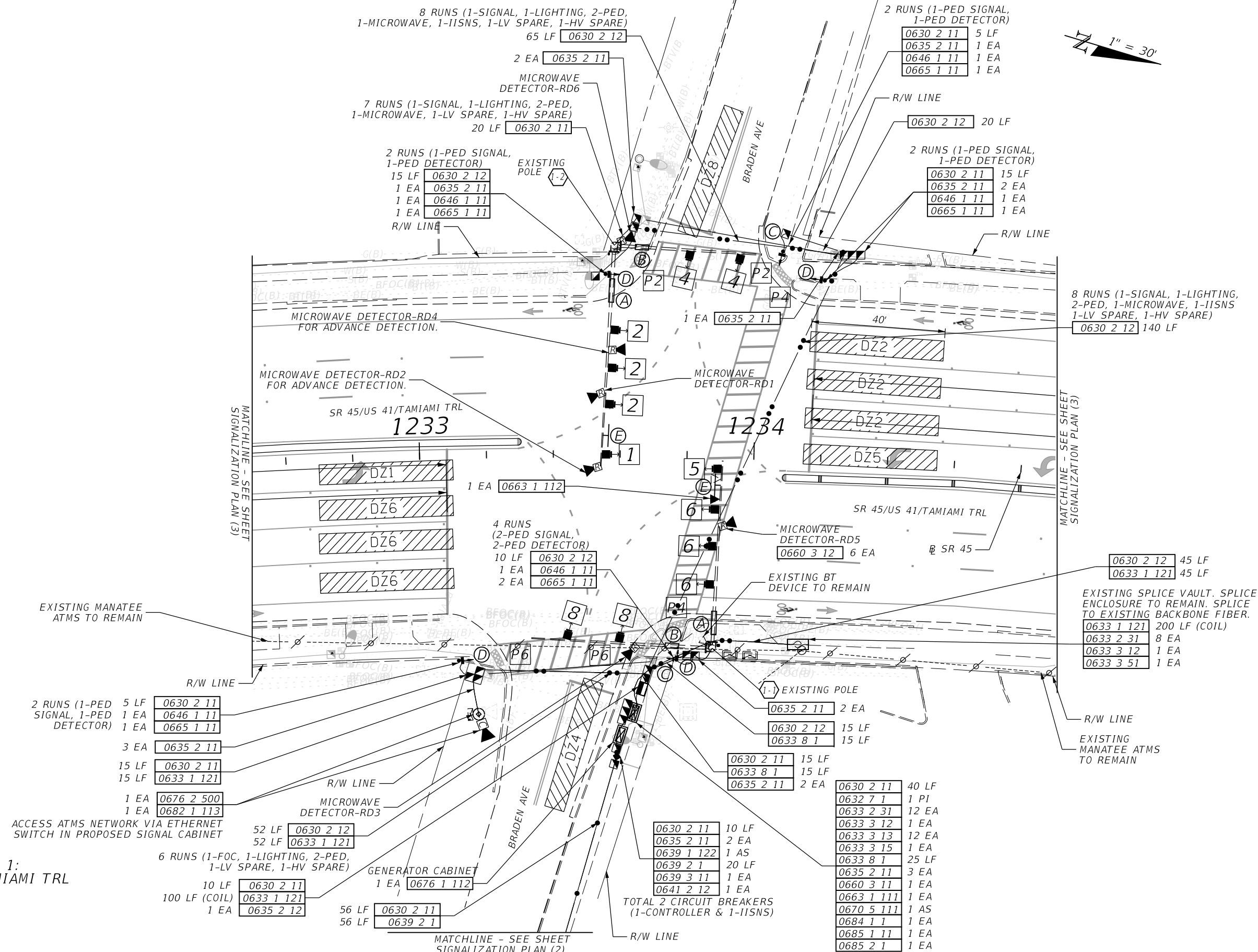
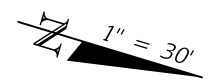

SIGNAL LOCATION 1:
 SR 45/US 41/TAMIAMI TRL
 AT BRADEN AVE
 13010 MP 0.560
 SIGNAL ID: 389

2 RUNS (1-PED SIGNAL, 1-PED DETECTOR) 5 LF 0630 2 11
 1 EA 0646 1 11
 1 EA 0665 1 11
 3 EA 0635 2 11
 15 LF 0630 2 11
 15 LF 0633 1 121
 1 EA 0676 2 500
 1 EA 0682 1 113
 ACCESS ATMS NETWORK VIA ETHERNET SWITCH IN PROPOSED SIGNAL CABINET

6 RUNS (1-FOC, 1-LIGHTING, 2-PED, 1-LV SPARE, 1-HV SPARE) 10 LF 0630 2 11
 100 LF (COIL) 0633 1 121
 1 EA 0635 2 12
 52 LF 0630 2 12
 52 LF 0633 1 121
 GENERATOR CABINET 1 EA 0676 1 112
 56 LF 0630 2 11
 56 LF 0639 2 1

4 RUNS (2-PED SIGNAL, 2-PED DETECTOR) 10 LF 0630 2 12
 1 EA 0646 1 11
 2 EA 0665 1 11

0630 2 11 10 LF
 0635 2 11 2 EA
 0639 1 122 1 AS
 0639 2 1 20 LF
 0639 3 11 1 EA
 0641 2 12 1 EA
 TOTAL 2 CIRCUIT BREAKERS (1-CONTROLLER & 1-IISNS)

0630 2 11 40 LF
 0632 7 1 1 PI
 0633 2 31 12 EA
 0633 3 12 1 EA
 0633 3 13 12 EA
 0633 3 15 1 EA
 0633 8 1 25 LF
 0635 2 11 3 EA
 0660 3 11 1 EA
 0663 1 111 1 EA
 0670 5 111 1 AS
 0684 1 1 1 EA
 0685 1 11 1 EA
 0685 2 1 1 EA

EXISTING SPLICE VAULT. SPLICE ENCLOSURE TO REMAIN. SPLICE TO EXISTING BACKBONE FIBER.
 0633 1 121 200 LF (COIL)
 0633 2 31 8 EA
 0633 3 12 1 EA
 0633 3 51 1 EA

REVISIONS	
DATE	DESCRIPTION

ENGINEER OF RECORD
 ISAMARIE L. MONREAL, P.E.
 LICENSE NUMBER 72029
 FLORIDA DEPARTMENT OF TRANSPORTATION
 801 N. BROADWAY AVENUE
 BARTOW, FL 33830-3809

STATE OF FLORIDA
 DEPARTMENT OF TRANSPORTATION

ROAD NO.	COUNTY	FINANCIAL PROJECT ID
SR 45	MANATEE	444612-1-52-01

SIGNALIZATION PLAN (1)

SHEET NO.
 T-4

5/22/2024 8:19:08 AM KINHNTST C:\Projects\FDOT\444612-1-52-01-Signalization\PLANS\COI.dgn

THE OFFICIAL RECORD OF THIS SHEET IS THE ELECTRONIC FILE DIGITALLY SIGNED AND SEALED UNDER RULE 61G15-23.004, F.A.C.

SIGNAL HEAD DETAILS

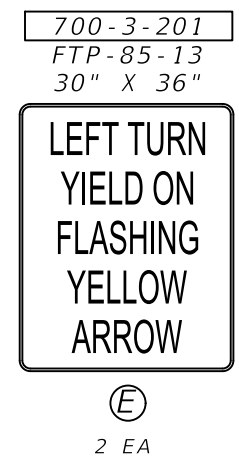
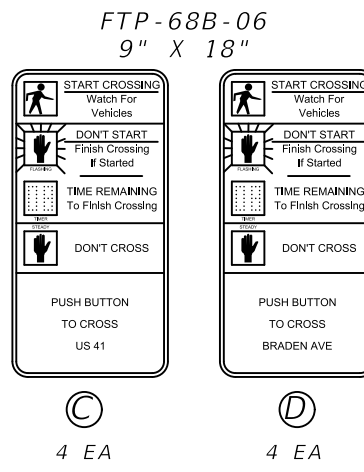
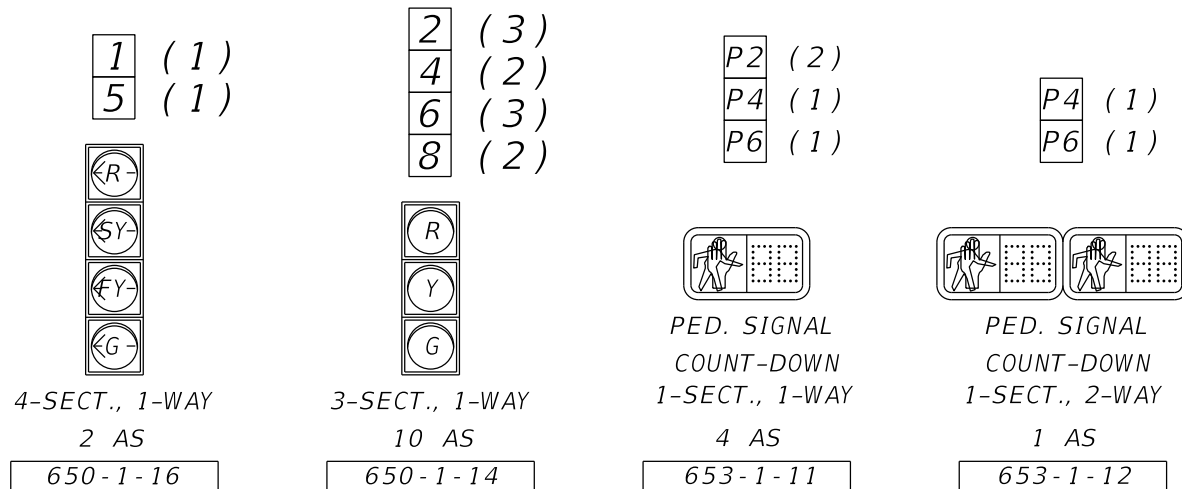

REMOVAL ITEMS:

632-7-6	1 PI
639-1-610	1 AS
641-2-60	1 EA
646-1-60	3 EA
650-1-60	10 EA
653-1-60	3 EA
663-1-600	1 EA
665-1-60	3 EA
670-5-600	1 AS
676-1-600	1 EA
682-1-600	1 EA
700-5-60	4 EA
700-3-601	3 EA

RELOCATE ITEMS

660-6-421	1 EA
-----------	------

(RELOCATE BLUE TOOTH CABINET EQUIPMENT FROM OLD CONTROLLER CABINET TO PROPOSED CONTROLLER CABINET)

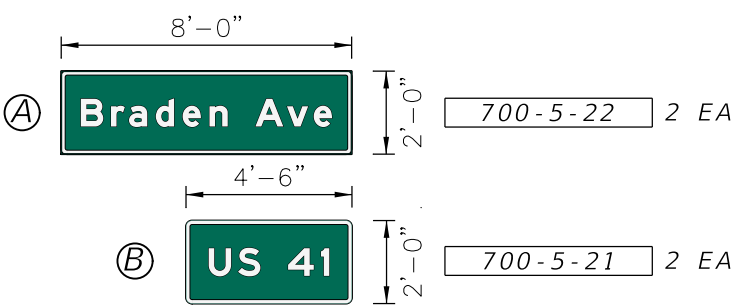

SEE GUIDE SIGN WORK SHEETS FOR INTERNALLY ILLUMINATED STREET NAME SIGN DETAILS.

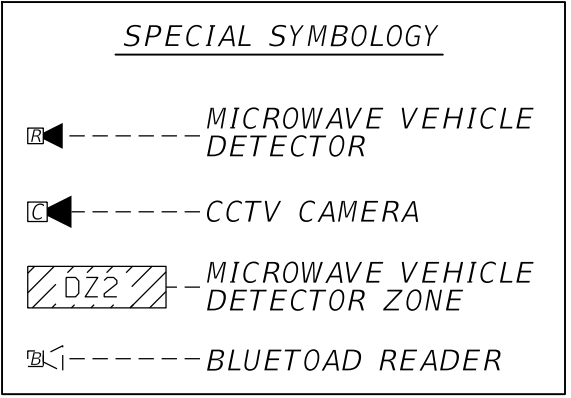
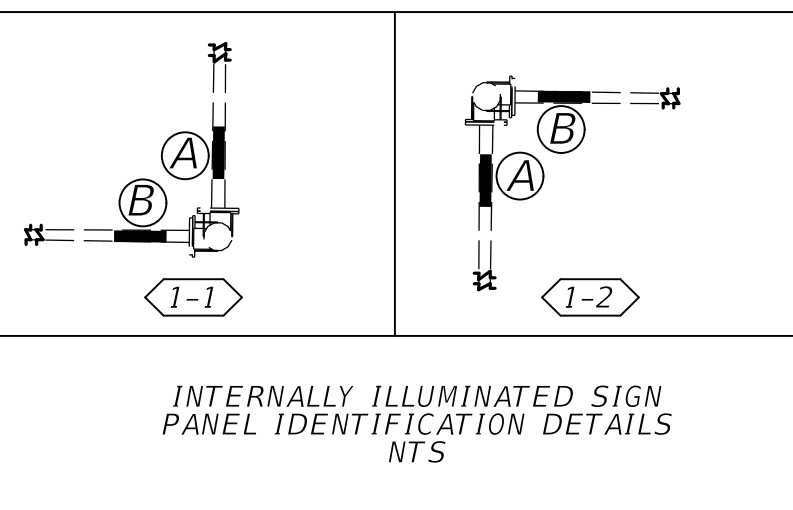
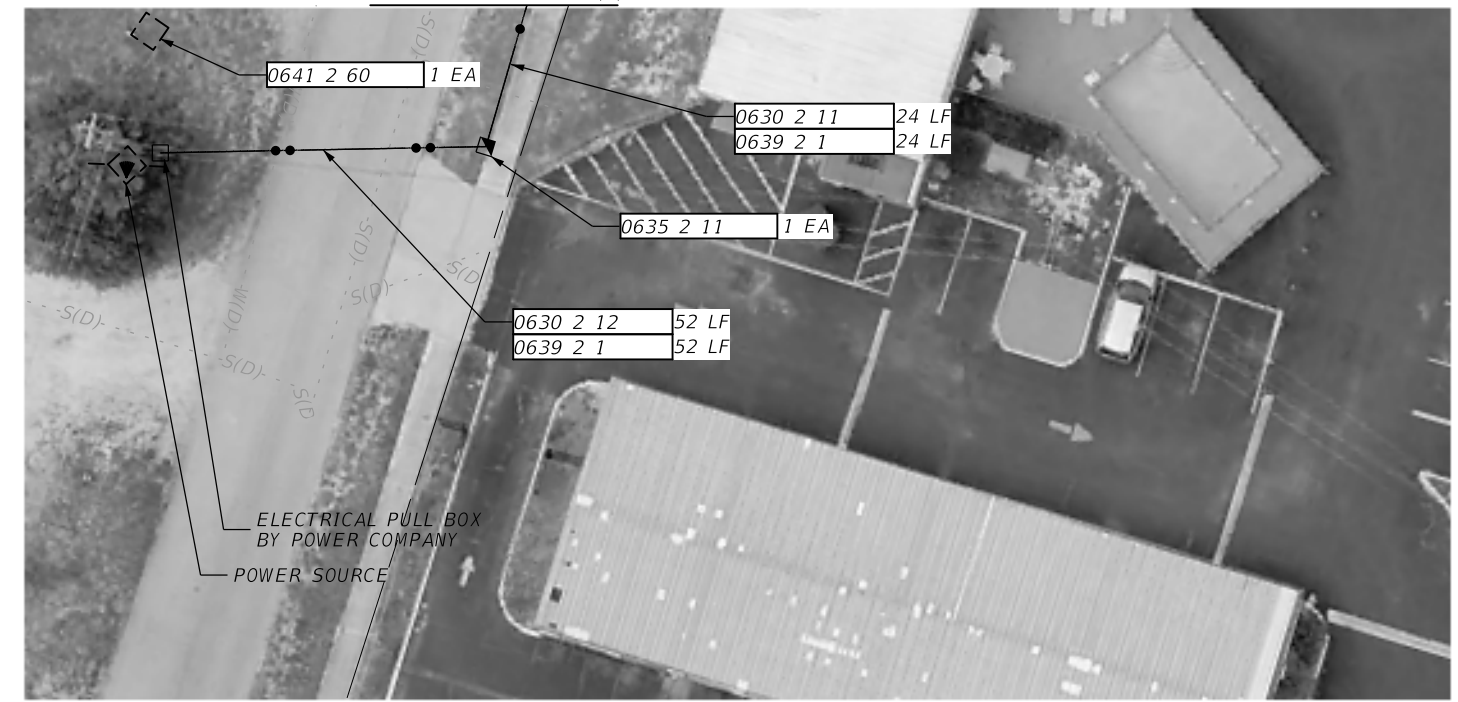

SIGNAL LOCATION 1:
SR 45/US 41/TAMIAMI TRL
AT BRADEN AVE
13010 MP 0.560
SIGNAL ID: 389

RADAR VEHICLE DETECTION ASSIGNMENTS

RADAR DETECTION	DETECTION ZONE	CONNECT TO MOVEMENT	DELAY TIME (SECS.)
RD1	DZ1		
	DZ6		
RD2	DZ6A		
	DZ6B		
RD3	DZ4		8
RD5	DZ5		
	DZ2		
RD4	DZ2A		
	DZ2B		
RD6	DZ8		8

5/22/2024 8:19:18 AM KINHNTST C:\Projects\FDOT\44461215201\Signalization\HPLP501.dgn

THE OFFICIAL RECORD OF THIS SHEET IS THE ELECTRONIC FILE DIGITALLY SIGNED AND SEALED UNDER RULE 61G15-23.004, F.A.C.

REVISIONS				ENGINEER OF RECORD		STATE OF FLORIDA DEPARTMENT OF TRANSPORTATION			SHEET NO.
DATE	DESCRIPTION	DATE	DESCRIPTION			ROAD NO.	COUNTY	FINANCIAL PROJECT ID	
				ISAMARIE L. MONREAL, P.E. LICENSE NUMBER 72029 FLORIDA DEPARTMENT OF TRANSPORTATION 801 N. BROADWAY AVENUE BARTOW, FL 33830-3809		SR 45	MANATEE	444612-1-52-01	T-5

SIGNALIZATION PLAN (2)

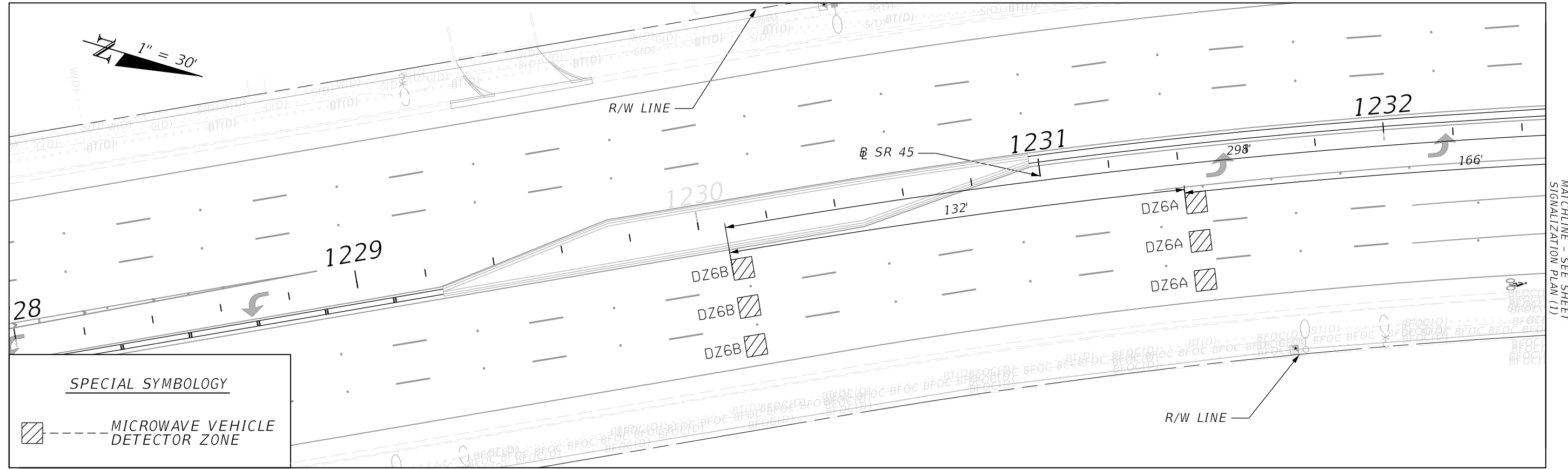
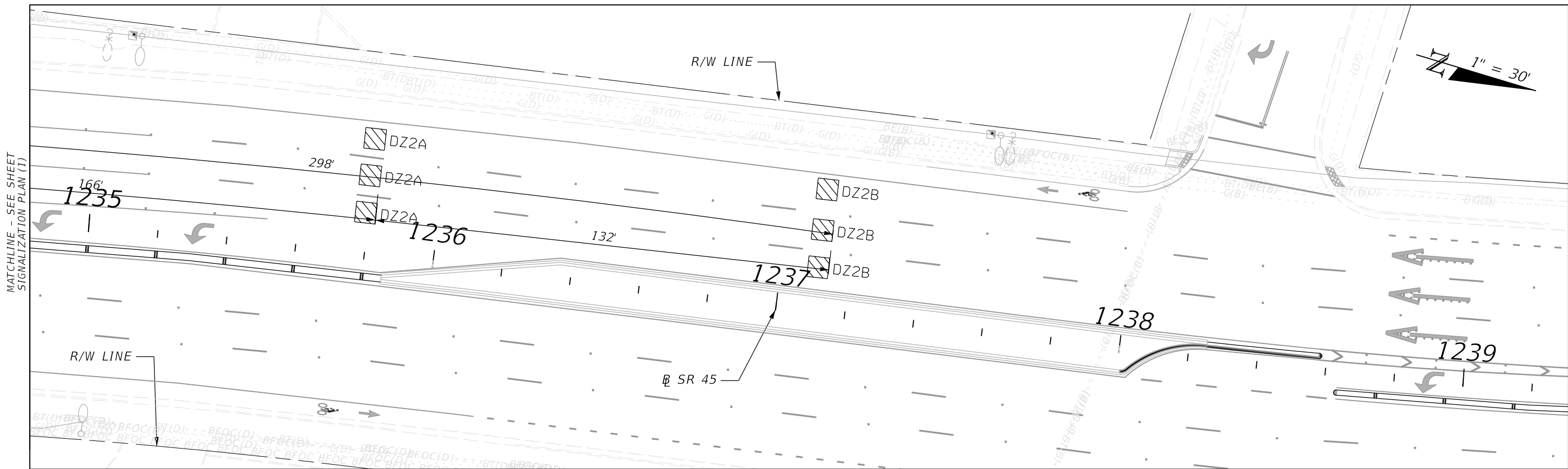

SPECIAL SYMBOLOGY

 --- MICROWAVE VEHICLE DETECTOR ZONE

REVISIONS				ENGINEER OF RECORD		STATE OF FLORIDA DEPARTMENT OF TRANSPORTATION			SHEET NO.
DATE	DESCRIPTION	DATE	DESCRIPTION	ISAMARIE L. MONREAL, P.E. LICENSE NUMBER 72029 FLORIDA DEPARTMENT OF TRANSPORTATION 801 N. BROADWAY AVENUE BARTOW, FL 33830-3809		ROAD NO.	COUNTY	FINANCIAL PROJECT ID	
						SR 45	MANATEE	444612-1-52-01	T-6

SIGNALIZATION PLAN (3)

5/22/2024 8:19:26 AM KNHWST C:\Projects\FDOT\44461215201_Signalization\HLPSC01.dgn

THE OFFICIAL RECORD OF THIS SHEET IS THE ELECTRONIC FILE DIGITALLY SIGNED AND SEALED UNDER RULE 61G15-23.004, F.A.C.

5/22/2024 8:19:38 AM KINHNTST
 C:\Projects\FDOT\44461215201_Signalization\PLAN\SC02.dgn

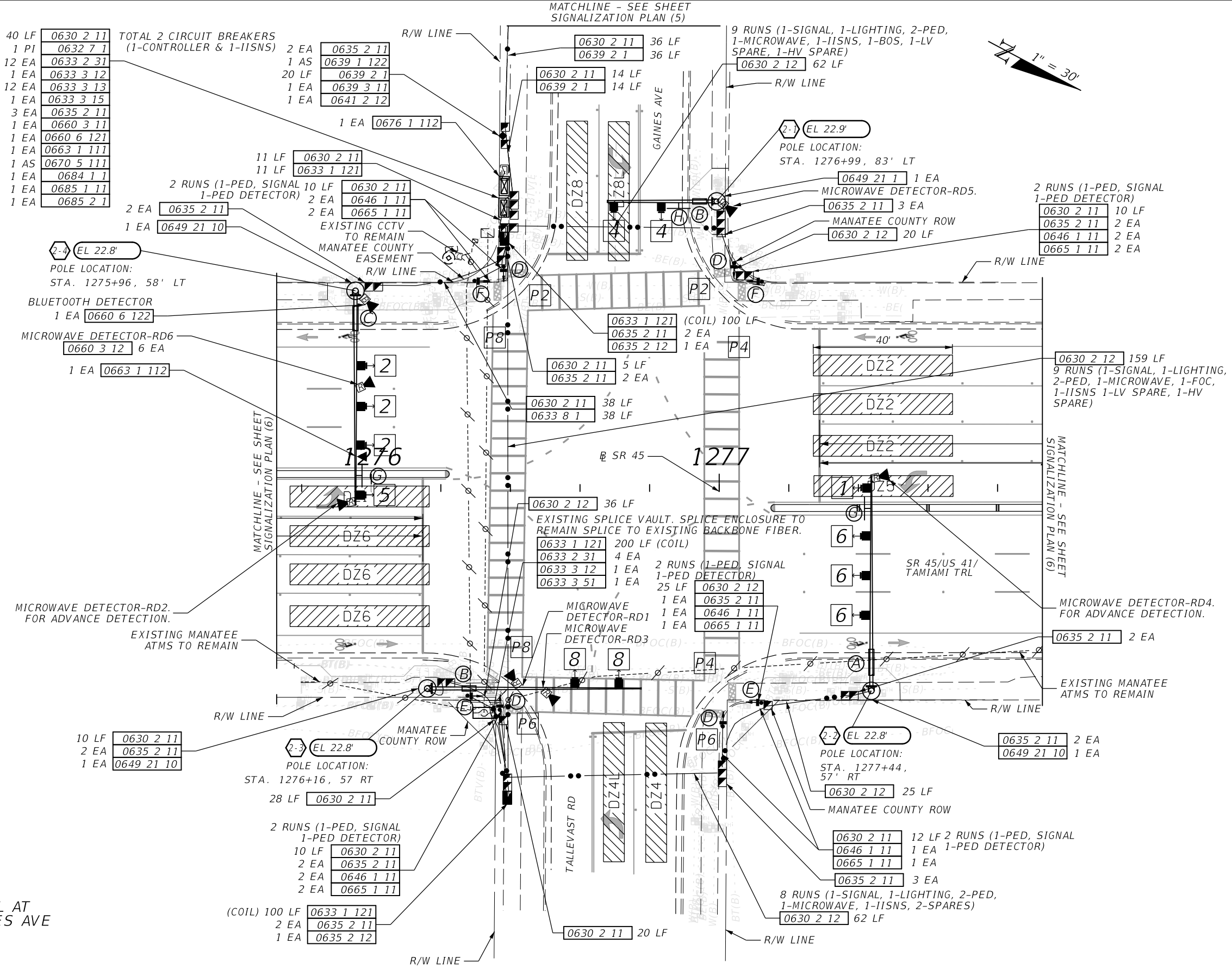

REVISIONS		REVISIONS	
DATE	DESCRIPTION	DATE	DESCRIPTION

ENGINEER OF RECORD
 ISAMARIE L. MONREAL, P.E.
 LICENSE NUMBER 72029
 FLORIDA DEPARTMENT OF TRANSPORTATION
 801 N. BROADWAY AVENUE
 BARTOW, FL 33830-3809

STATE OF FLORIDA DEPARTMENT OF TRANSPORTATION		
ROAD NO.	COUNTY	FINANCIAL PROJECT ID
SR 45	MANATEE	444612-1-52-01

SIGNALIZATION PLAN (4)

SHEET NO.
T-7

THE OFFICIAL RECORD OF THIS SHEET IS THE ELECTRONIC FILE DIGITALLY SIGNED AND SEALED UNDER RULE 61G15-23.004, F.A.C.

SIGNAL HEAD DETAILS

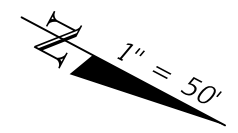
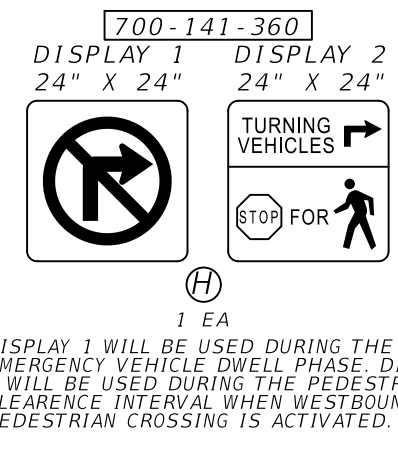
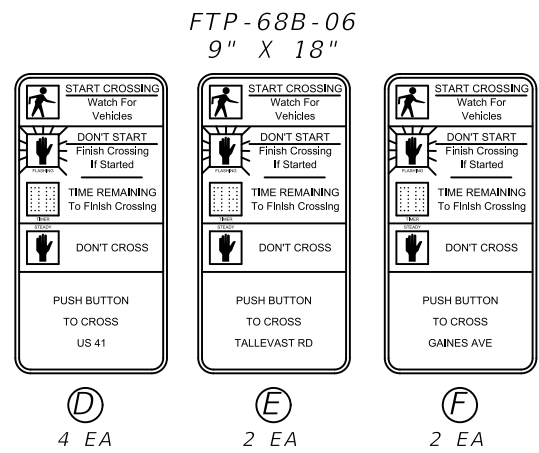
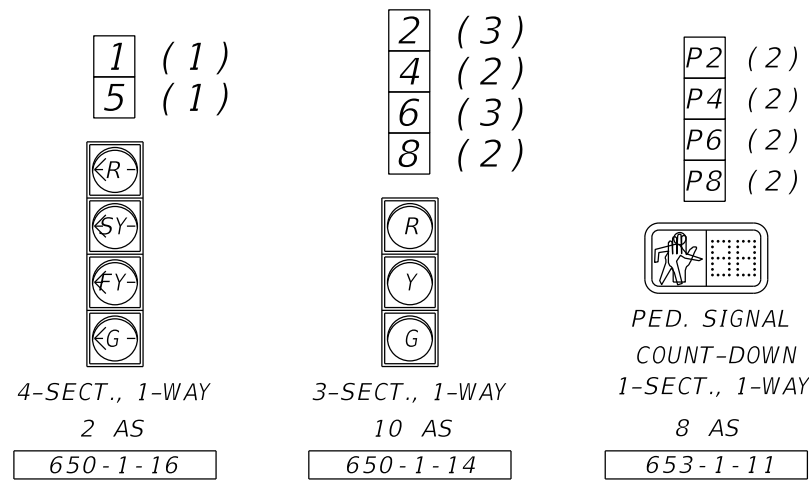

REMOVAL ITEMS:

632-7-6	1 PI
639-1-610	1 AS
641-2-60	1 EA
646-1-60	8 EA
649-26-5	4 EA
660-6-600	1 EA
670-5-600	1 AS
676-1-600	1 EA

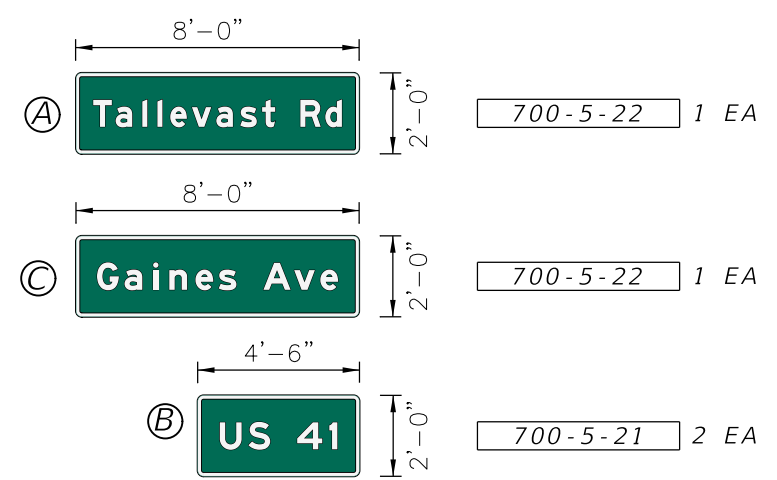

SEE GUIDE SIGN WORK SHEETS FOR INTERNALLY ILLUMINATED STREET NAME SIGN DETAILS.

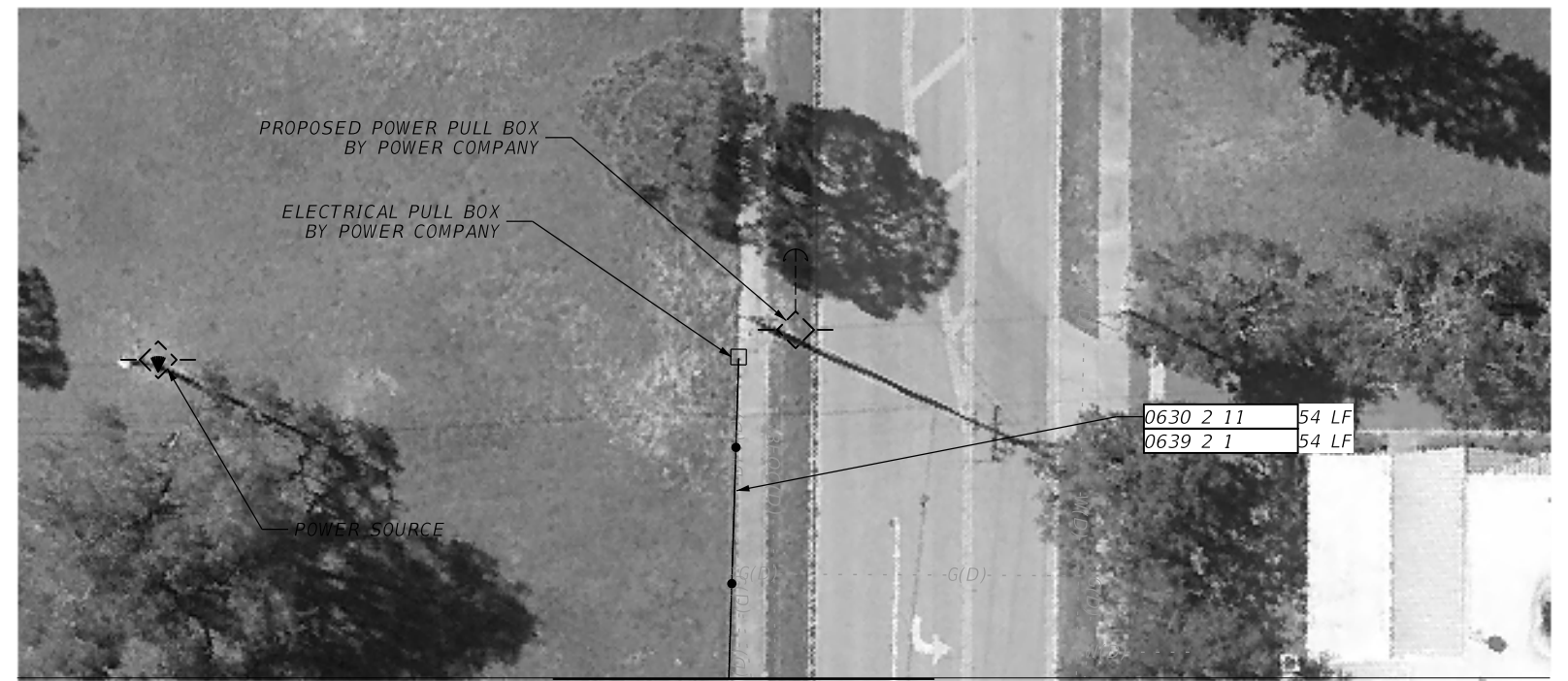

MATCHLINE - SEE SHEET SIGNALIZATION PLAN (4)

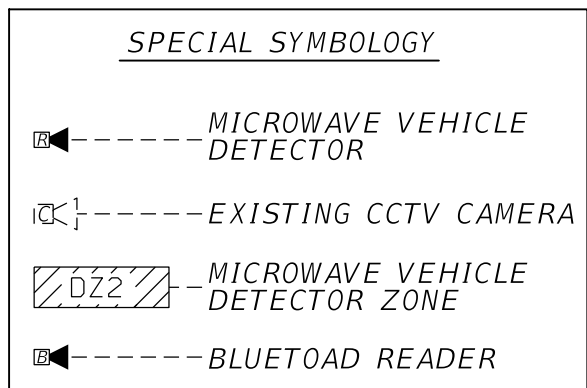
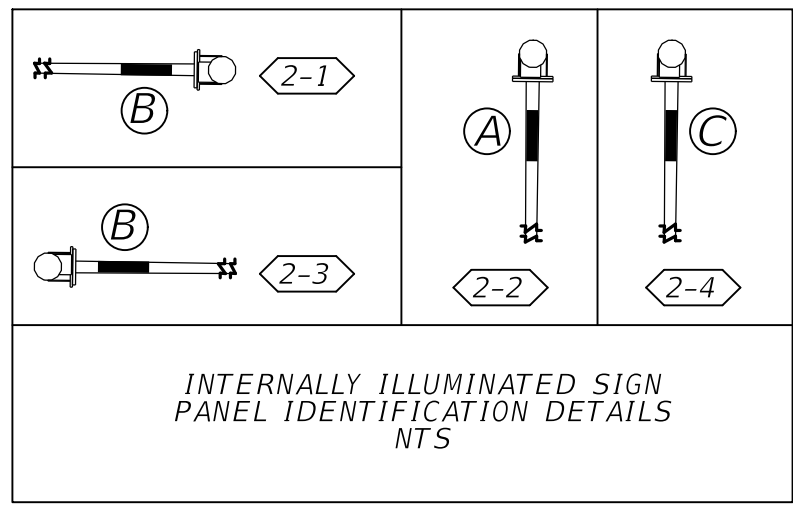

SIGNAL LOCATION 2:
SR 45/US 41/TAMIAMI TRL AT
TALLEVAST RD AND GAINES AVE
13010 MP 1.378
SIGNAL ID: 390

RADAR VEHICLE DETECTION ASSIGNMENTS

RADAR DETECTION	DETECTION ZONE	CONNECT TO MOVEMENT	DELAY TIME (SECS.)
RD1	DZ1		
	DZ6		
RD2	DZ6A		
	DZ6B		
RD3	DZ4		8
	DZ4L		3
RD5	DZ5		
	DZ2		
RD4	DZ2A		
	DZ2B		
RD6	DZ8		8
	DZ8L		3

5/22/2024 8:19:52 AM KNHWT5T C:\Projects\FDOT\44461215201_Signalization\HPLPSG01.dgn

REVISIONS				ENGINEER OF RECORD		STATE OF FLORIDA DEPARTMENT OF TRANSPORTATION			SHEET NO.
DATE	DESCRIPTION	DATE	DESCRIPTION			ROAD NO.	COUNTY	FINANCIAL PROJECT ID	
				ISAMARIE L. MONREAL, P.E. LICENSE NUMBER 72029 FLORIDA DEPARTMENT OF TRANSPORTATION 801 N. BROADWAY AVENUE BARTOW, FL 33830-3809		SR 45	MANATEE	444612-1-52-01	T-8

SIGNALIZATION PLAN (5)

THE OFFICIAL RECORD OF THIS SHEET IS THE ELECTRONIC FILE DIGITALLY SIGNED AND SEALED UNDER RULE 61G15-23.004, F.A.C.

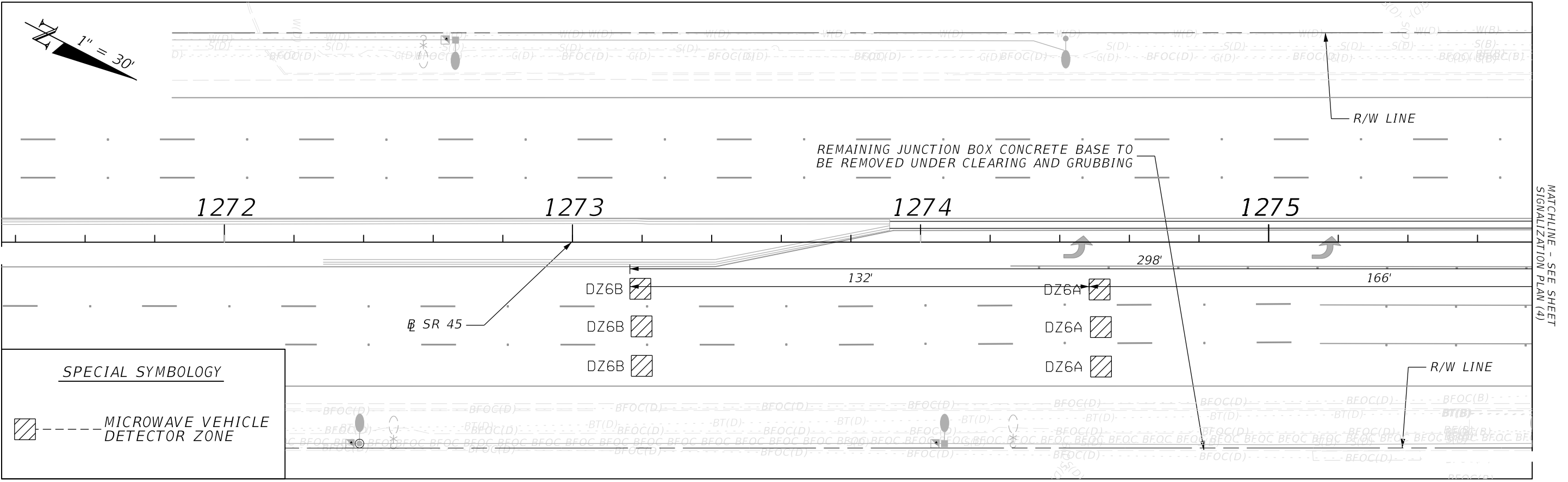
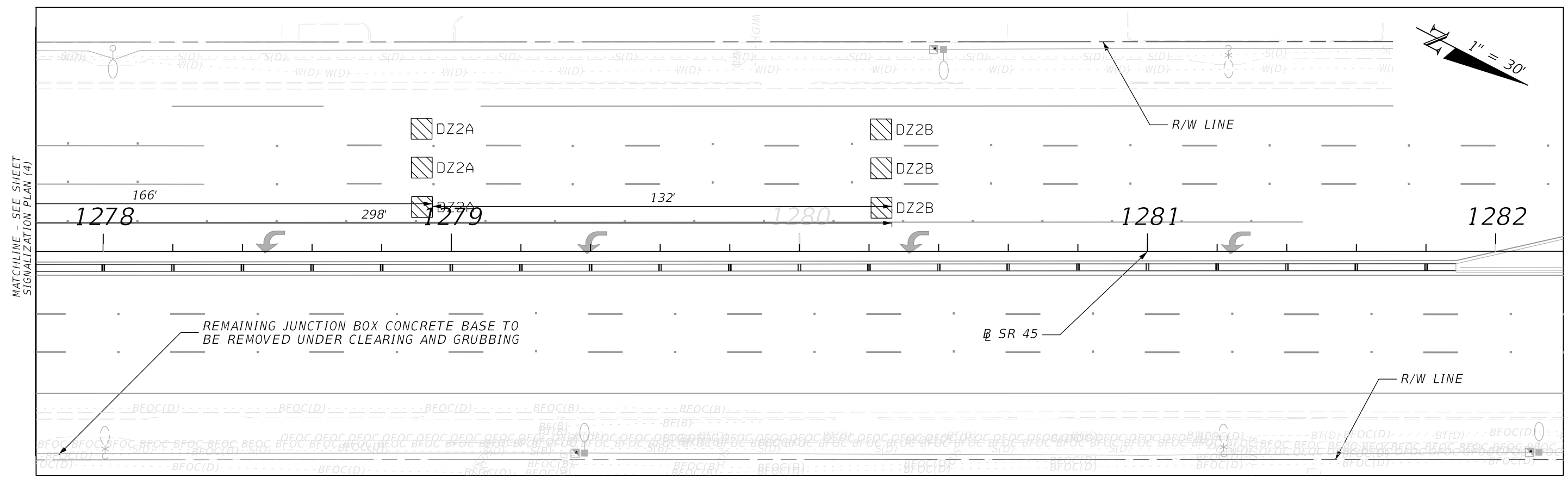
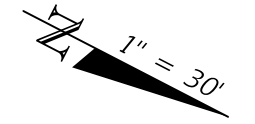

SPECIAL SYMBOLOGY

--- MICROWAVE VEHICLE DETECTOR ZONE

5/22/2024 8:20:02 AM KINHWT5T C:\Projects\FDOT\44461215201_Signalization\HLP502.dgn

REVISIONS				ENGINEER OF RECORD		STATE OF FLORIDA DEPARTMENT OF TRANSPORTATION			SHEET NO.
DATE	DESCRIPTION	DATE	DESCRIPTION			ROAD NO.	COUNTY	FINANCIAL PROJECT ID	
				ISAMARIE L. MONREAL, P.E. LICENSE NUMBER 72029 FLORIDA DEPARTMENT OF TRANSPORTATION 801 N. BROADWAY AVENUE BARTOW, FL 33830-3809		SR 45	MANATEE	444612-1-52-01	T-9

SIGNALIZATION PLAN (6)

THE OFFICIAL RECORD OF THIS SHEET IS THE ELECTRONIC FILE DIGITALLY SIGNED AND SEALED UNDER RULE 61G15-23.004, F.A.C.

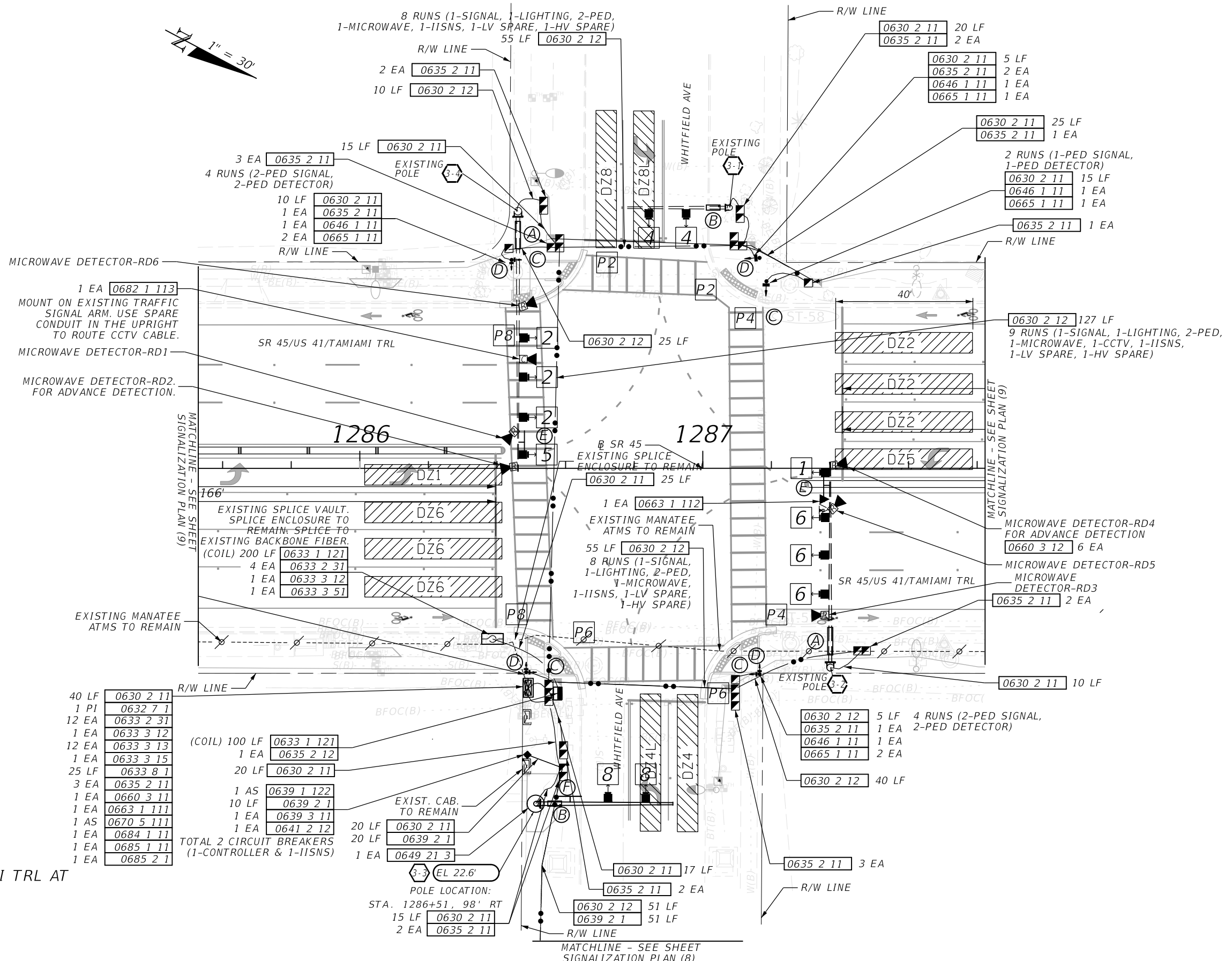
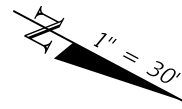

SIGNAL LOCATION 3:
 SR 45/US 41/TAMIAMI TRL AT
 WHITFIELD AVE
 13010 MP 1.570
 SIGNAL ID: 391

- 40 LF 0630 2 11
- 1 PI 0632 7 1
- 12 EA 0633 2 31
- 1 EA 0633 3 12
- 12 EA 0633 3 13
- 1 EA 0633 3 15
- 25 LF 0633 8 1
- 3 EA 0635 2 11
- 1 EA 0660 3 11
- 1 EA 0663 1 111
- 1 AS 0670 5 111
- 1 EA 0684 1 11
- 1 EA 0685 1 11
- 1 EA 0685 2 1

- (COIL) 100 LF 0633 1 121
- 1 EA 0635 2 12
- 20 LF 0630 2 11
- 1 AS 0639 1 122
- 10 LF 0639 2 1
- 1 EA 0639 3 11
- 1 EA 0641 2 12
- TOTAL 2 CIRCUIT BREAKERS (1-CONTROLLER & 1-IISNS)

EXIST. CAB. TO REMAIN
 20 LF 0630 2 11
 20 LF 0639 2 1
 1 EA 0649 21 3
 3-3 EL 22.6'
 POLE LOCATION:
 STA. 1286+51, 98' RT
 15 LF 0630 2 11
 2 EA 0635 2 11

5/22/2024 8:20:14 AM KINHNTST C:\Projects\FDOT\44461215201_Signalization\PLAN\SC03.dgn

THE OFFICIAL RECORD OF THIS SHEET IS THE ELECTRONIC FILE DIGITALLY SIGNED AND SEALED UNDER RULE 61G15-23.004, F.A.C.

REVISIONS				ENGINEER OF RECORD		STATE OF FLORIDA DEPARTMENT OF TRANSPORTATION			SHEET NO.
DATE	DESCRIPTION	DATE	DESCRIPTION	ISAMARIE L. MONREAL, P.E. LICENSE NUMBER 72029 FLORIDA DEPARTMENT OF TRANSPORTATION 801 N. BROADWAY AVENUE BARTOW, FL 33830-3809		ROAD NO.	COUNTY	FINANCIAL PROJECT ID	
						SR 45	MANATEE	444612-1-52-01	T-10

SIGNALIZATION PLAN (7)

SIGNAL HEAD DETAILS

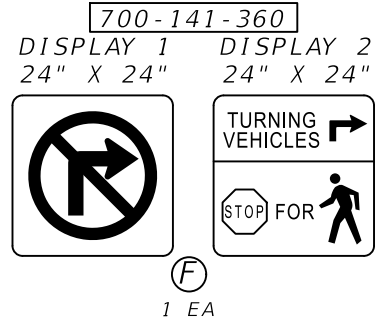
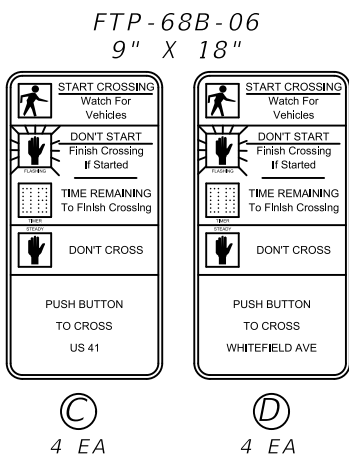
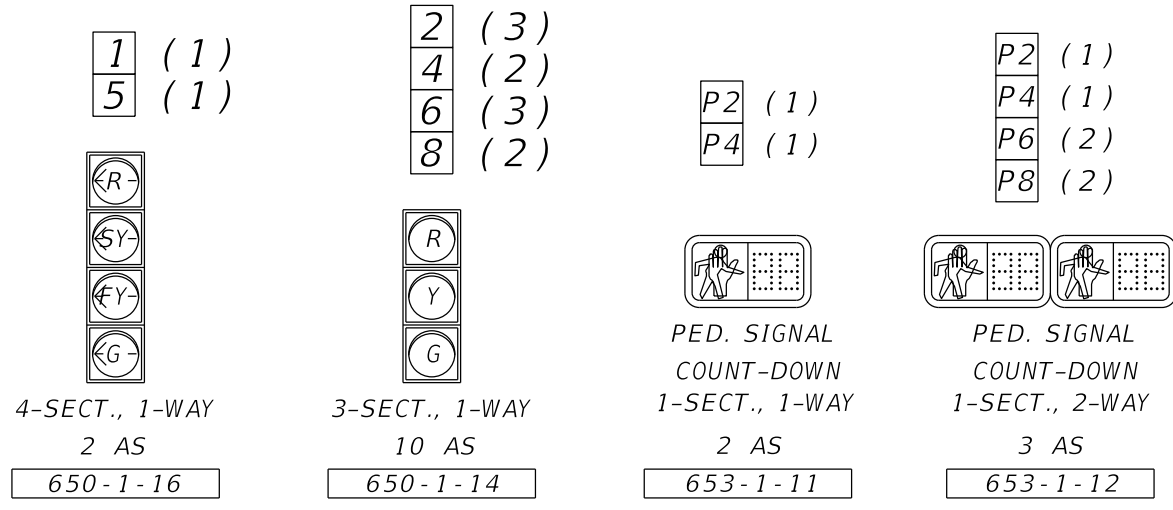

DISPLAY 1 WILL BE USED DURING THE EMERGENCY VEHICLE DWELL PHASE. DISPLAY 2 WILL BE USED DURING THE PEDESTRIAN CLEARANCE INTERVAL WHEN EASTBOUND PEDESTRIAN CROSSING IS ACTIVATED.

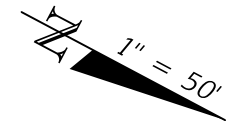

REMOVAL ITEMS:

632-7-6	1 PI
639-1-610	1 AS
641-2-60	1 EA
646-1-60	4 EA
649-26-5	1 EA
650-1-60	10 EA
663-1-600	1 EA
670-5-600	1 AS
700-5-60	4 EA

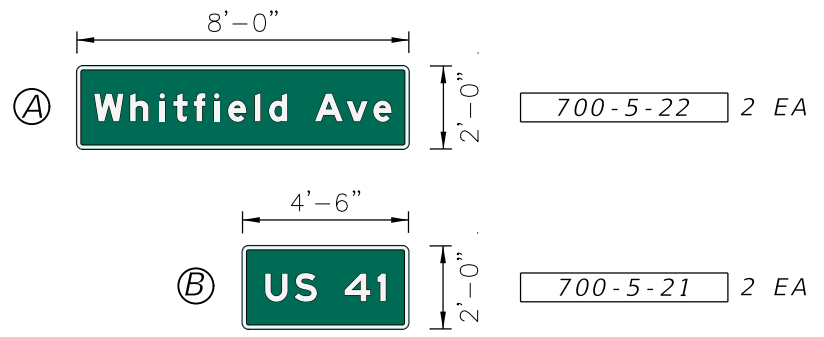

SEE GUIDE SIGN WORK SHEETS FOR INTERNALLY ILLUMINATED STREET NAME SIGN DETAILS.



RADAR VEHICLE DETECTION ASSIGNMENTS

RADAR DETECTION	DETECTION ZONE	CONNECT TO MOVEMENT	DELAY TIME (SECS.)
RD1	DZ1		
	DZ6		
RD2	DZ6A		
	DZ6B		
RD3	DZ4		8
	DZ4L		3
RD5	DZ5		
	DZ2		
RD4	DZ2A		
	DZ2B		
RD6	DZ8		8
	DZ8L		3

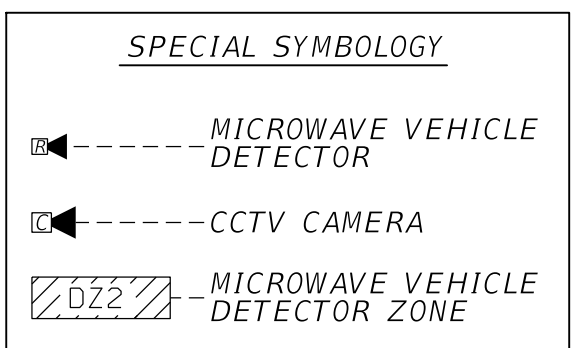
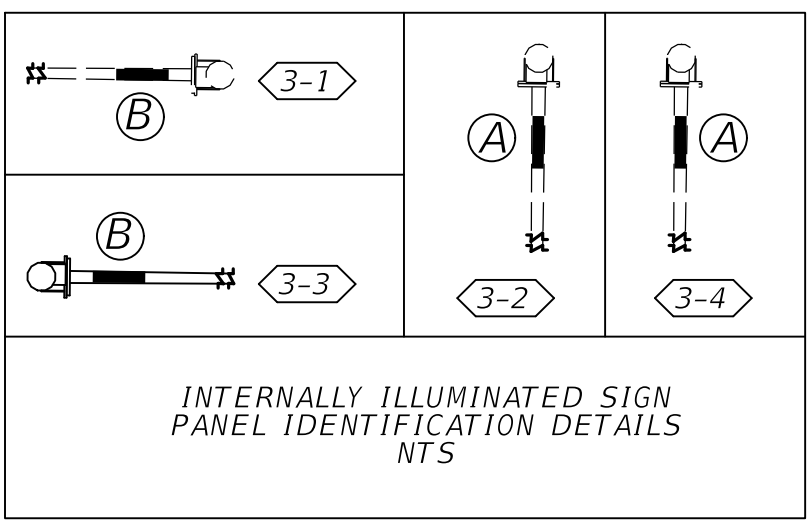

SIGNAL LOCATION 3:
SR 45/US 41/TAMIAMI TRL AT
WHITFIELD AVE
13010 MP 1.570
SIGNAL ID: 391

5/22/2024 8:20:30 AM KINHNT5T
C:\Projects\FDOT\44461215201_Signalization\VHLP501.dgn

REVISIONS				ENGINEER OF RECORD		STATE OF FLORIDA DEPARTMENT OF TRANSPORTATION			SHEET NO.
DATE	DESCRIPTION	DATE	DESCRIPTION			ROAD NO.	COUNTY	FINANCIAL PROJECT ID	
				ISAMARIE L. MONREAL, P.E. LICENSE NUMBER 72029 FLORIDA DEPARTMENT OF TRANSPORTATION 801 N. BROADWAY AVENUE BARTOW, FL 33830-3809		SR 45	MANATEE	444612-1-52-01	T-11

SIGNALIZATION PLAN (8)

THE OFFICIAL RECORD OF THIS SHEET IS THE ELECTRONIC FILE DIGITALLY SIGNED AND SEALED UNDER RULE 61G15-23.004, F.A.C.

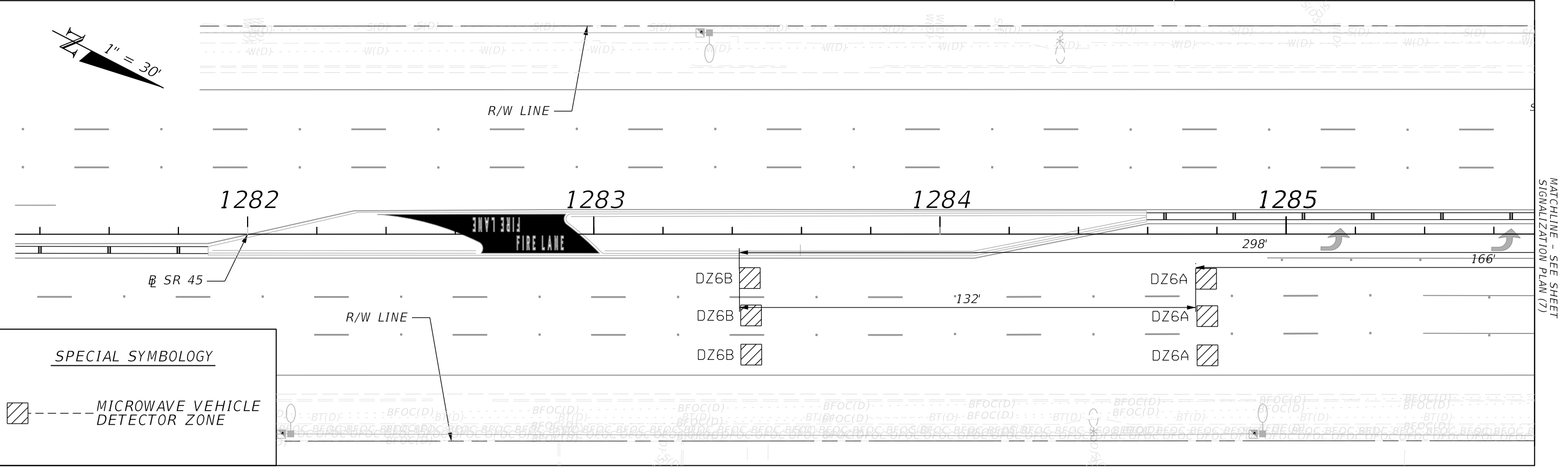
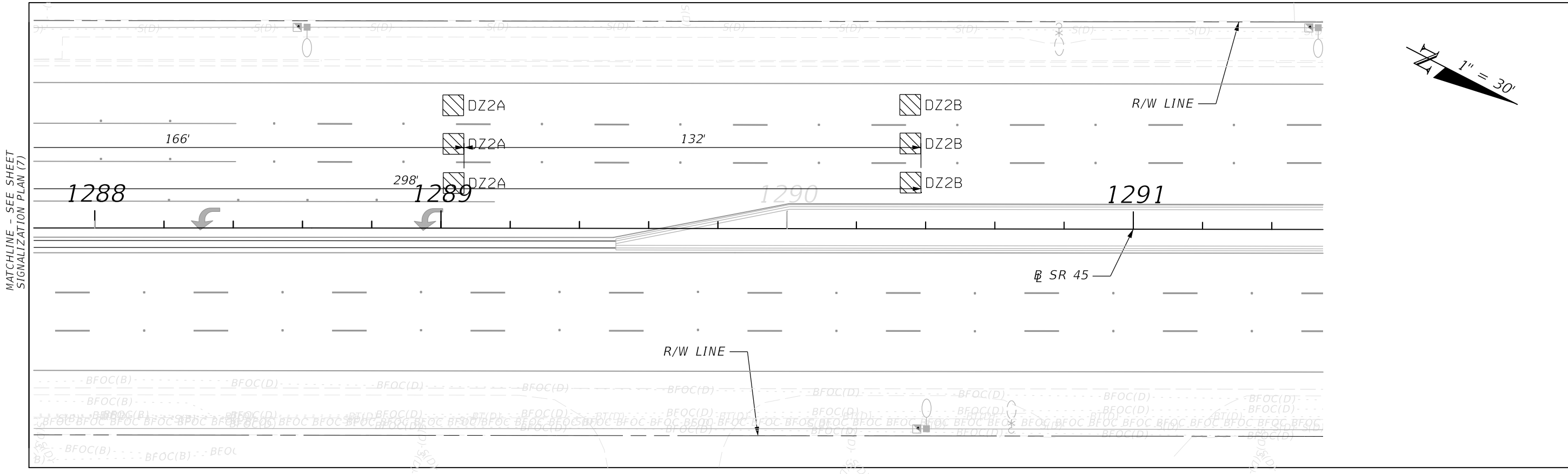
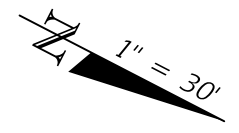

SPECIAL SYMBOLOGY

MICROWAVE VEHICLE DETECTOR ZONE

REVISIONS			
DATE	DESCRIPTION	DATE	DESCRIPTION

ENGINEER OF RECORD
 ISAMARIE L. MONREAL, P.E.
 LICENSE NUMBER 72029
 FLORIDA DEPARTMENT OF TRANSPORTATION
 801 N. BROADWAY AVENUE
 BARTOW, FL 33830-3809

STATE OF FLORIDA DEPARTMENT OF TRANSPORTATION		
ROAD NO.	COUNTY	FINANCIAL PROJECT ID
SR 45	MANATEE	444612-1-52-01

SIGNALIZATION PLAN (9)

SHEET NO.
T-12

5/22/2024 8:20:38 AM KINHWT5T C:\Projects\FDOT\444612\Signalization\HLP503.dgn

THE OFFICIAL RECORD OF THIS SHEET IS THE ELECTRONIC FILE DIGITALLY SIGNED AND SEALED UNDER RULE 61G15-23.004, F.A.C.

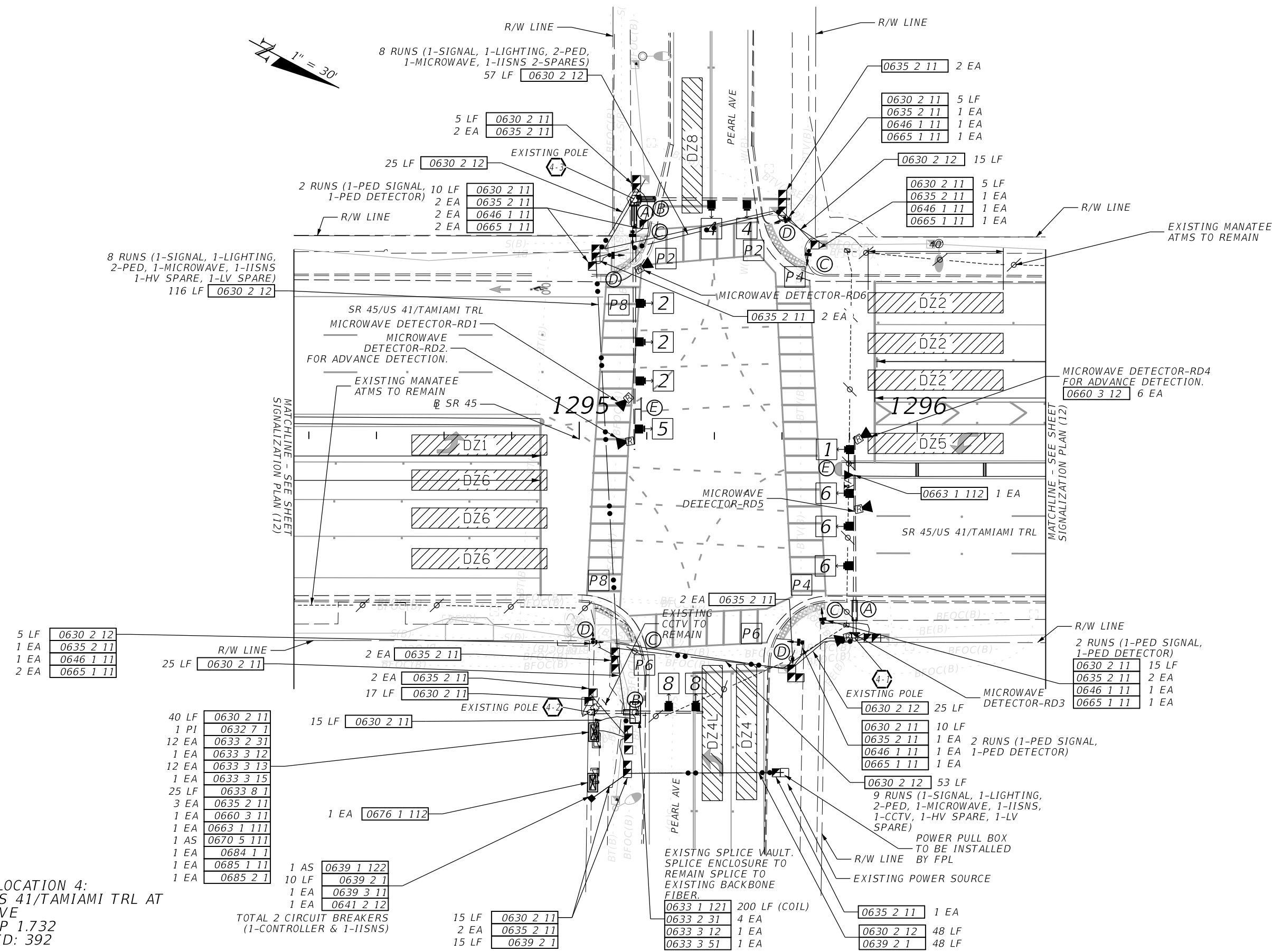
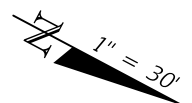

8 RUNS (1-SIGNAL, 1-LIGHTING, 2-PED, 1-MICROWAVE, 1-IISNS 2-SPARES)
116 LF 0630 2 12

8 RUNS (1-SIGNAL, 1-LIGHTING, 2-PED, 1-MICROWAVE, 1-IISNS 2-SPARES)
57 LF 0630 2 12

5 LF 0630 2 11
2 EA 0635 2 11

25 LF 0630 2 12

2 RUNS (1-PED SIGNAL, 1-PED DETECTOR)
10 LF 0630 2 11
2 EA 0635 2 11
2 EA 0646 1 11
2 EA 0665 1 11

0635 2 11 2 EA
0630 2 11 5 LF
0635 2 11 1 EA
0646 1 11 1 EA
0665 1 11 1 EA

0630 2 12 15 LF
0630 2 11 5 LF
0635 2 11 1 EA
0646 1 11 1 EA
0665 1 11 1 EA

EXISTING MANATEE ATMS TO REMAIN

SR 45/US 41/TAMIAMI TRL
MICROWAVE DETECTOR-RD1
MICROWAVE DETECTOR-RD2
FOR ADVANCE DETECTION.

EXISTING MANATEE ATMS TO REMAIN

MICROWAVE DETECTOR-RD6
0635 2 11 2 EA

MICROWAVE DETECTOR-RD4 FOR ADVANCE DETECTION.
0660 3 12 6 EA

MATCHLINE - SEE SHEET SIGNALIZATION PLAN (12)

MATCHLINE - SEE SHEET SIGNALIZATION PLAN (12)

5 LF 0630 2 12
1 EA 0635 2 11
1 EA 0646 1 11
2 EA 0665 1 11

25 LF 0630 2 11

40 LF 0630 2 11
1 PI 0632 7 1
12 EA 0633 2 31
1 EA 0633 3 12
12 EA 0633 3 13
1 EA 0633 3 15
25 LF 0633 8 1
3 EA 0635 2 11
1 EA 0660 3 11
1 EA 0663 1 111
1 AS 0670 5 111
1 EA 0684 1 1
1 EA 0685 1 11
1 EA 0685 2 1

2 EA 0635 2 11
2 EA 0635 2 11
17 LF 0630 2 11

1 EA 0676 1 112

1 AS 0639 1 122
10 LF 0639 2 1
1 EA 0639 3 11
1 EA 0641 2 12

TOTAL 2 CIRCUIT BREAKERS (1-CONTROLLER & 1-IISNS)

15 LF 0630 2 11
2 EA 0635 2 11
15 LF 0639 2 1

2 EA 0635 2 11
EXISTING CCTV TO REMAIN

2 RUNS (1-PED SIGNAL, 1-PED DETECTOR)
0630 2 11 15 LF
0635 2 11 2 EA
0646 1 11 1 EA
0665 1 11 1 EA

EXISTING POLE
0630 2 12 25 LF
0630 2 11 10 LF
0635 2 11 1 EA
0646 1 11 1 EA
0665 1 11 1 EA

0630 2 12 53 LF
9 RUNS (1-SIGNAL, 1-LIGHTING, 2-PED, 1-MICROWAVE, 1-IISNS, 1-CCTV, 1-HV SPARE, 1-LV SPARE)

POWER PULL BOX TO BE INSTALLED BY FPL

EXISTING POWER SOURCE

EXISTING SPLICE VAULT. SPLICE ENCLOSURE TO REMAIN SPLICE TO EXISTING BACKBONE FIBER.

0633 1 121 200 LF (COIL)
0633 2 31 4 EA
0633 3 12 1 EA
0633 3 51 1 EA

0635 2 11 1 EA
0630 2 12 48 LF
0639 2 1 48 LF

SIGNAL LOCATION 4:
SR 45/US 41/TAMIAMI TRL AT PEARL AVE
13010 MP 1.732
SIGNAL ID: 392

REVISIONS	
DATE	DESCRIPTION

ENGINEER OF RECORD
ISAMARIE L. MONREAL, P.E.
LICENSE NUMBER 72029
FLORIDA DEPARTMENT OF TRANSPORTATION
801 N. BROADWAY AVENUE
BARTOW, FL 33830-3809

STATE OF FLORIDA DEPARTMENT OF TRANSPORTATION		
ROAD NO.	COUNTY	FINANCIAL PROJECT ID
SR 45	MANATEE	444612-1-52-01

SIGNALIZATION PLAN (10)

SHEET NO.
T-13

SIGNAL HEAD DETAILS

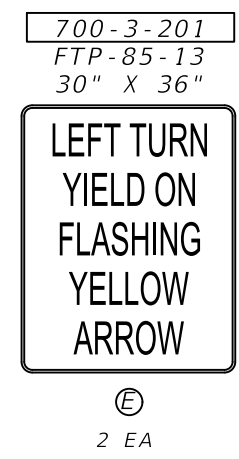
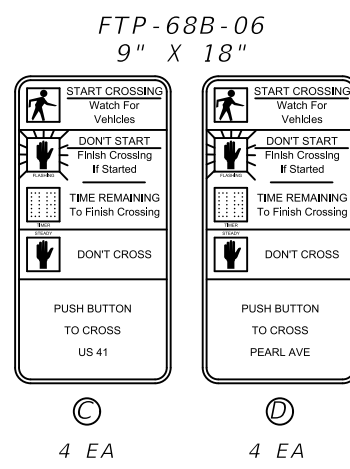
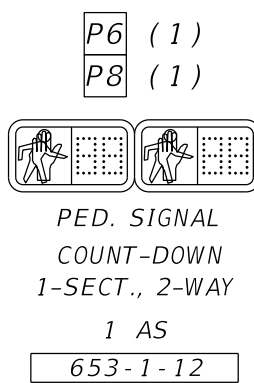
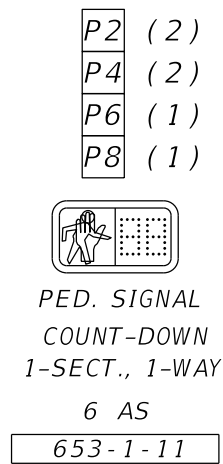
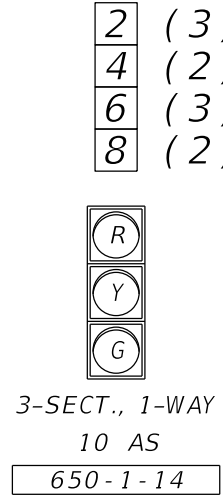
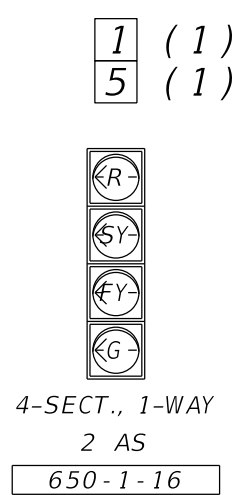

REMOVAL ITEMS:

632-7-6	1 PI
639-1-610	1 AS
641-2-60	1 EA
646-1-60	4 EA
650-1-60	10 EA
663-1-600	1 EA
670-5-600	1 AS
676-1-600	1 EA
700-5-60	4 EA

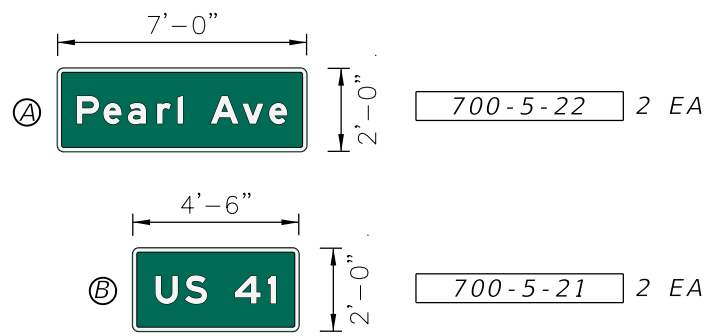

SEE GUIDE SIGN WORK SHEETS FOR INTERNALLY ILLUMINATED STREET NAME SIGN DETAILS.

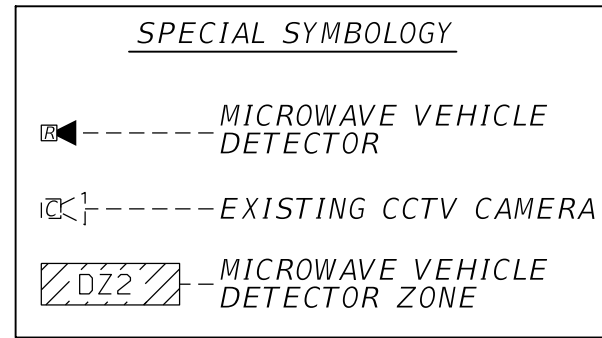
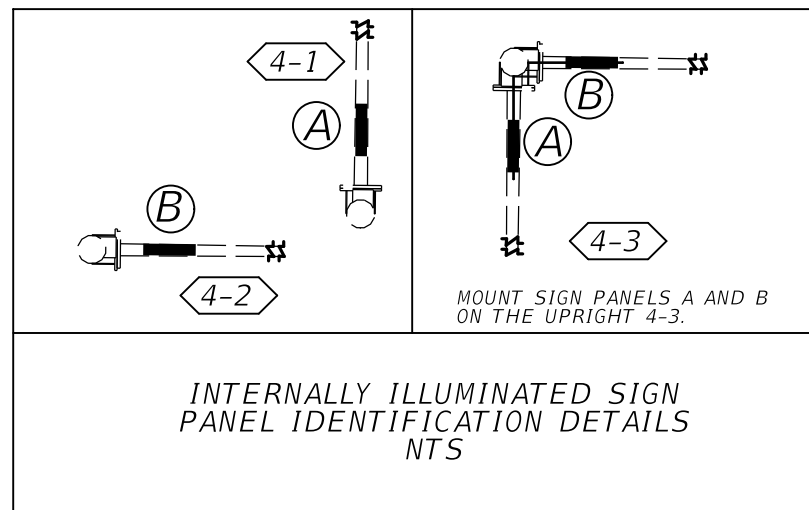

SIGNAL LOCATION 4:
SR 45/US 41/TAMIAMI TRL AT PEARL AVE
13010 MP 1.732
SIGNAL ID: 392

RADAR VEHICLE DETECTION ASSIGNMENTS

RADAR DETECTION	DETECTION ZONE	CONNECT TO MOVEMENT	DELAY TIME (SECS.)
RD1	DZ1		
	DZ6		
RD2	DZ6A		
	DZ6B		
RD3	DZ4		8
	DZ4L		3
RD5	DZ5		
	DZ2		
RD4	DZ2A		
	DZ2B		
RD6	DZ8		8

5/22/2024 8:20:49 AM KINHNTST C:\Projects\FDOT\44461215201\Signalization\HPLP508_PEARL.dgn

THE OFFICIAL RECORD OF THIS SHEET IS THE ELECTRONIC FILE DIGITALLY SIGNED AND SEALED UNDER RULE 61G15-23.004, F.A.C.

REVISIONS				ENGINEER OF RECORD		STATE OF FLORIDA DEPARTMENT OF TRANSPORTATION			SHEET NO.
DATE	DESCRIPTION	DATE	DESCRIPTION	ISAMARIE L. MONREAL, P.E. LICENSE NUMBER 72029 FLORIDA DEPARTMENT OF TRANSPORTATION 801 N. BROADWAY AVENUE BARTOW, FL 33830-3809		ROAD NO.	COUNTY	FINANCIAL PROJECT ID	
						SR 45	MANATEE	444612-1-52-01	SIGNALIZATION PLAN (11) S-14

5/22/2024 8:20:58 AM KINHWTST
 C:\Projects\FDOT\44461215201_Signalization\VHLP504.dgn

MATCHLINE - SEE SHEET
 SIGNALIZATION PLAN (10)

MATCHLINE - SEE SHEET
 SIGNALIZATION PLAN (10)

THE OFFICIAL RECORD OF THIS SHEET IS THE ELECTRONIC FILE DIGITALLY SIGNED AND SEALED UNDER RULE 61G15-23.004, F.A.C.

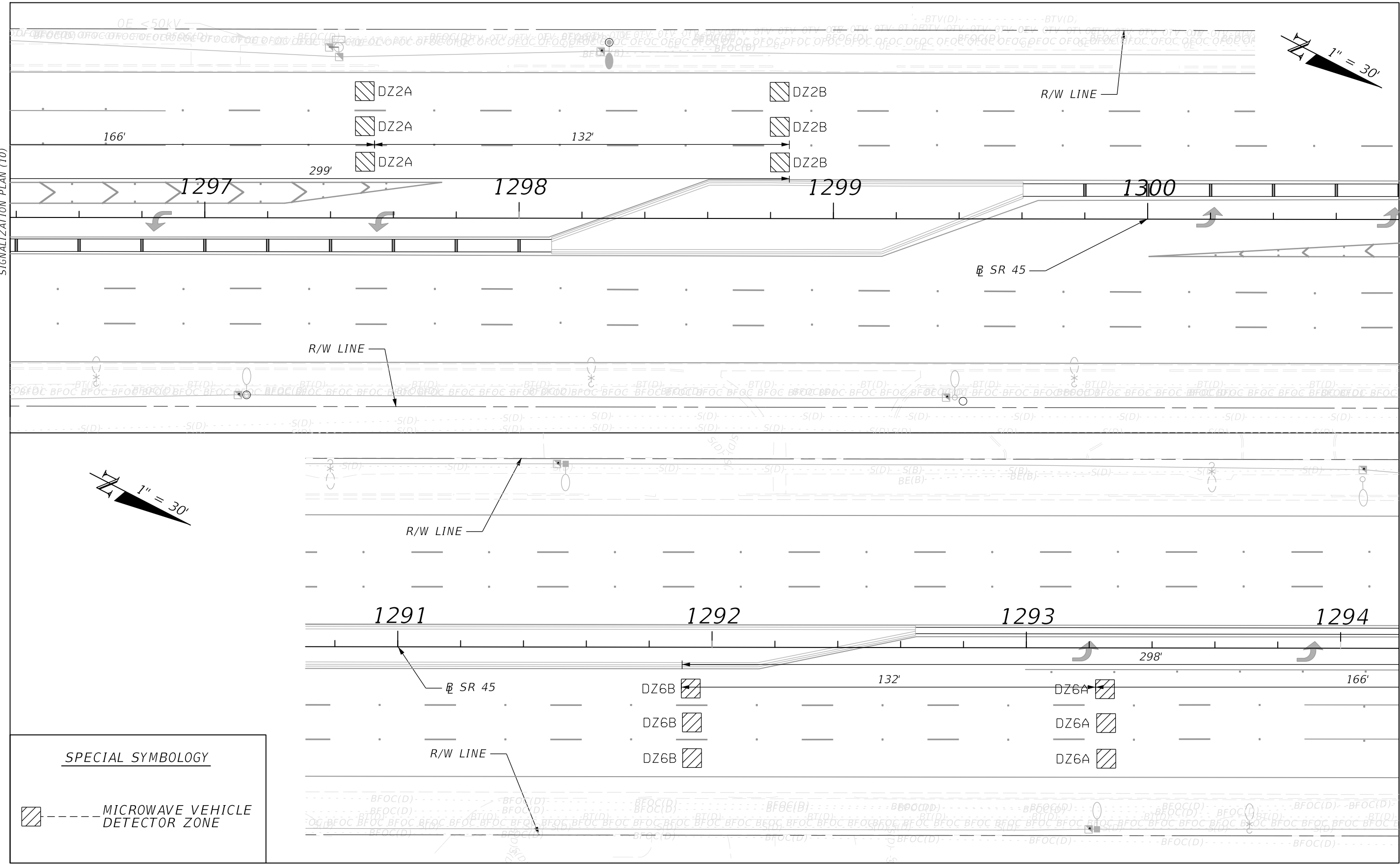

SPECIAL SYMBOLOGY

 --- MICROWAVE VEHICLE DETECTOR ZONE

REVISIONS				ENGINEER OF RECORD		STATE OF FLORIDA DEPARTMENT OF TRANSPORTATION			SHEET NO.
DATE	DESCRIPTION	DATE	DESCRIPTION			ROAD NO.	COUNTY	FINANCIAL PROJECT ID	
				ISAMARIE L. MONREAL, P.E. LICENSE NUMBER 72029 FLORIDA DEPARTMENT OF TRANSPORTATION 801 N. BROADWAY AVENUE BARTOW, FL 33830-3809		SR 45	MANATEE	444612-1-52-01	<p>SIGNALIZATION PLAN (12)</p> <p>T-15</p>



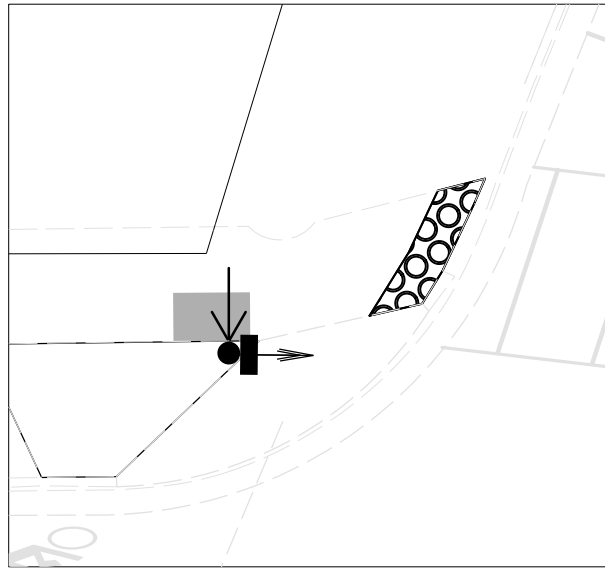

DETAIL 1" = 10'
SOUTHWEST QUADRANT
SR 45 (US 41/TAMIAMI TRAIL)
AT BRADEN AVENUE

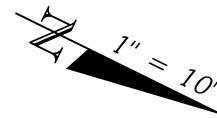
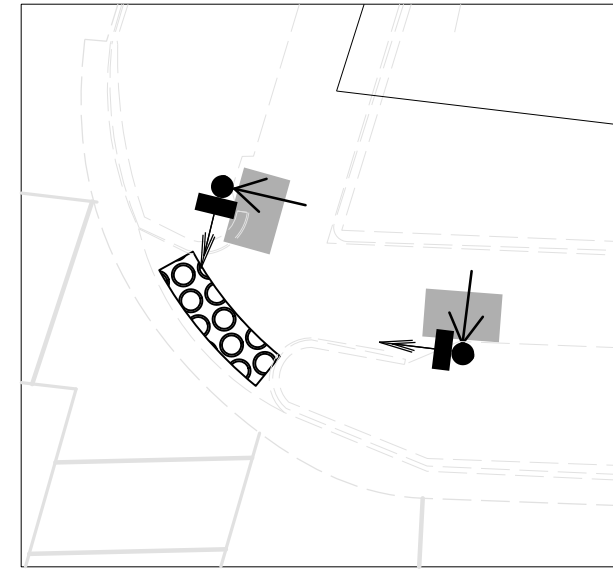

DETAIL 1" = 10'
NORTHWEST QUADRANT
SR 45 (US 41/TAMIAMI TRAIL)
AT BRADEN AVENUE



SYMBOLOLOGY

-  ONE WAY PEDESTRIAN SIGNAL ON PEDESTAL WITH DETECTOR
-  TWO WAY PEDESTRIAN SIGNAL ON PEDESTAL WITH DETECTORS
-  ARROW POINTS TO THE INTENDED LOCATION OF THE DETECTOR
-  2.5' X 4' PEDESTRIAN LANDING PAD

SIGNAL LOCATION 1:
SR 45/US 41/TAMIAMI TRL
AT BRADEN AVE
13010 MP 0.560
SIGNAL ID: 389

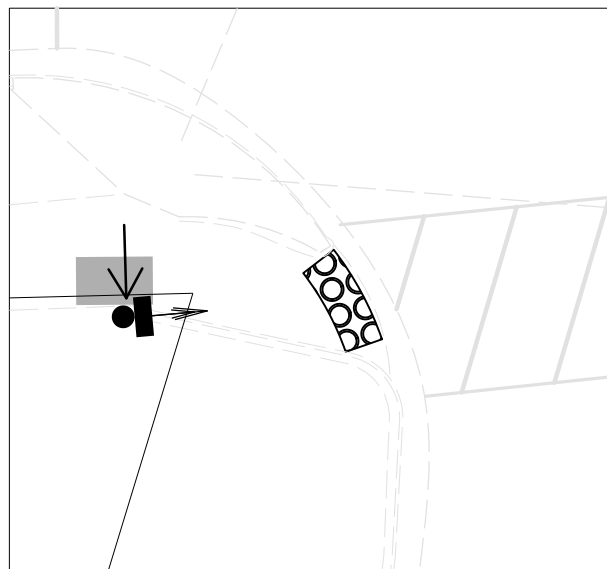

DETAIL 1" = 10'
SOUTHEAST QUADRANT
SR 45 (US 41/TAMIAMI TRAIL)
AT BRADEN AVENUE

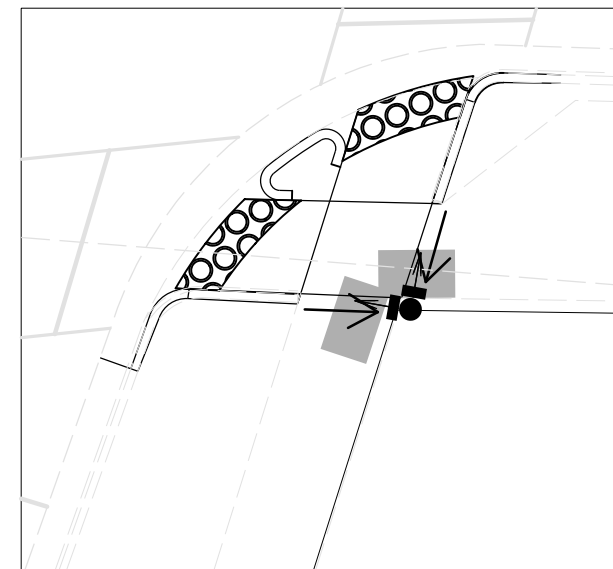

DETAIL 1" = 10'
NORTHEAST QUADRANT
SR 45 (US 41/TAMIAMI TRAIL)
AT BRADEN AVENUE

5/22/2024 8:21:00 AM KINHWTST C:\Projects\FDOT\44461215201\Signalization\SSDTS02.dgn

REVISIONS				ENGINEER OF RECORD	STATE OF FLORIDA DEPARTMENT OF TRANSPORTATION			SHEET NO.
DATE	DESCRIPTION	DATE	DESCRIPTION		ROAD NO.	COUNTY	FINANCIAL PROJECT ID	
				ISAMARIE L. MONREAL, P.E. LICENSE NUMBER: 72029 FLORIDA DEPARTMENT OF TRANSPORTATION 801 N. BROADWAY AVENUE BARTOW, FL 33830-3809	SR 45	MANATEE	444612-1-52-01	PEDESTRIAN SIGNAL DETAIL (01) T-16

THE OFFICIAL RECORD OF THIS SHEET IS THE ELECTRONIC FILE DIGITALLY SIGNED AND SEALED UNDER RULE 61G15-23.004, F.A.C.

DETAIL 1" = 10'
SOUTHWEST QUADRANT
SR 45 (US 41/TAMIAMI TRAIL)
AT TALLEVAST ROAD

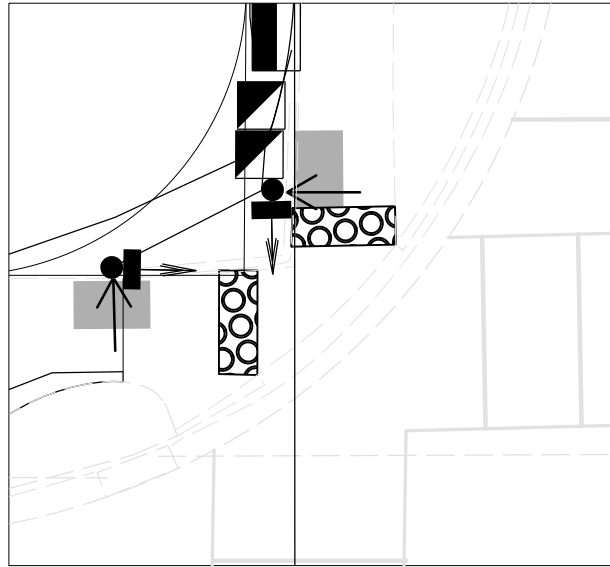

DETAIL 1" = 10'
NORTHWEST QUADRANT
SR 45 (US 41/TAMIAMI TRAIL)
AT TALLEVAST ROAD

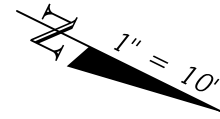
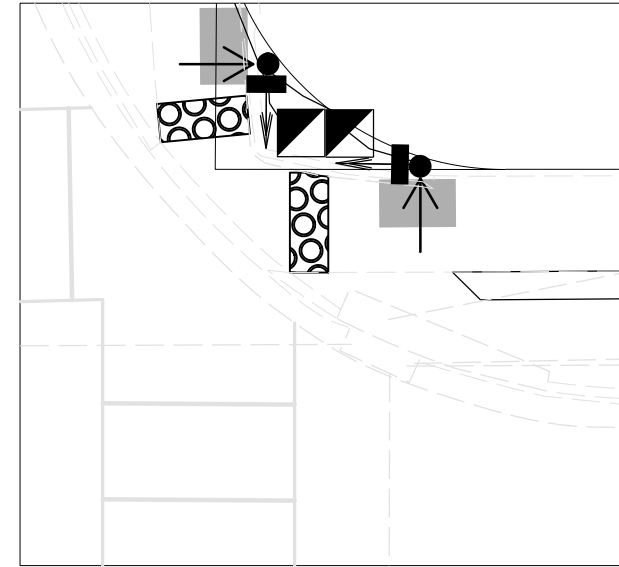

SYMBOLOLOGY

- ONE WAY PEDESTRIAN SIGNAL ON PEDESTAL WITH DETECTOR
- ARROW POINTS TO THE INTENDED LOCATION OF THE DETECTOR
- 2.5' X 4' PEDESTRIAN LANDING PAD

SIGNAL LOCATION 2:
SR 45/US 41/TAMIAMI TRL
AT TALLEVAST RD AND GAINES AVE
13010 MP 1.378
SIGNAL ID: 390

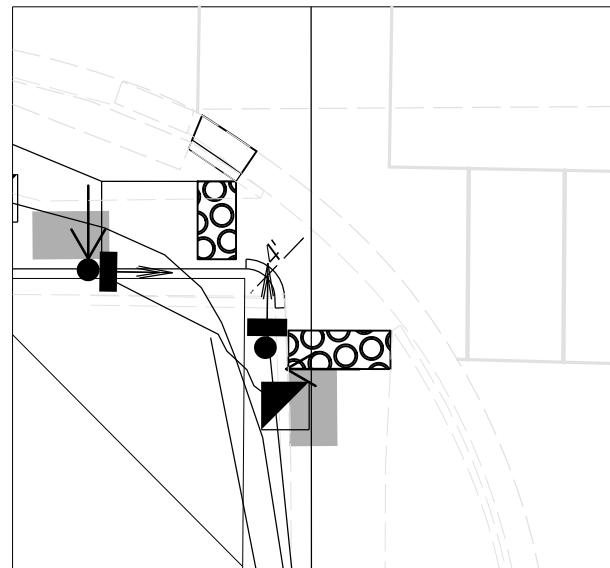

DETAIL 1" = 10'
SOUTHEAST QUADRANT
SR 45 (US 41/TAMIAMI TRAIL)
AT TALLEVAST ROAD

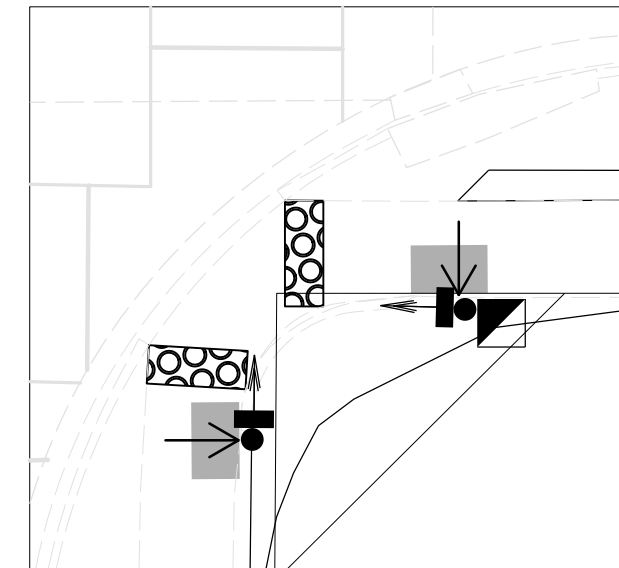

DETAIL 1" = 10'
NORTHEAST QUADRANT
SR 45 (US 41/TAMIAMI TRAIL)
AT TALLEVAST ROAD

5/22/2024 8:21:02 AM KINHNTST C:\Projects\FDOT\44461215201\Signalization\SSDTS602.dgn

REVISIONS				ENGINEER OF RECORD		STATE OF FLORIDA DEPARTMENT OF TRANSPORTATION			SHEET NO.
DATE	DESCRIPTION	DATE	DESCRIPTION	ISAMARIE L. MONREAL, P.E. LICENSE NUMBER: 72029 FLORIDA DEPARTMENT OF TRANSPORTATION 801 N. BROADWAY AVENUE BARTOW, FL 33830-3809		ROAD NO.	COUNTY	FINANCIAL PROJECT ID	
						SR 45	MANATEE	444612-1-52-01	PEDESTRIAN SIGNAL DETAIL (02) T-17

THE OFFICIAL RECORD OF THIS SHEET IS THE ELECTRONIC FILE DIGITALLY SIGNED AND SEALED UNDER RULE 61G15-23.004, F.A.C.

DETAIL 1" = 10'
SOUTHWEST QUADRANT
SR 45 (US 41/TAMIAMI TRAIL)
AT WHITFIELD AVENUE

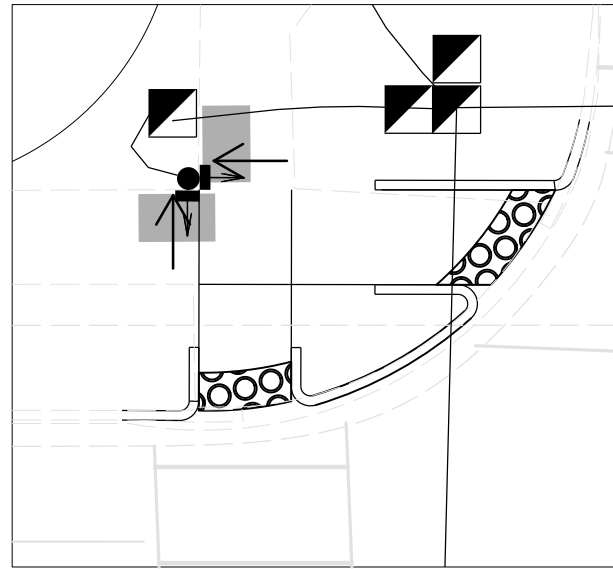

DETAIL 1" = 10'
NORTHWEST QUADRANT
SR 45 (US 41/TAMIAMI TRAIL)
AT WHITFIELD AVENUE

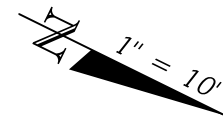
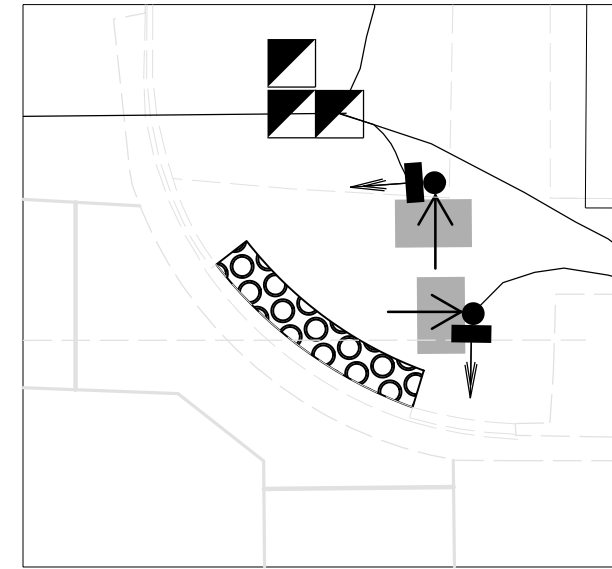

SYMBOLOLOGY

- ONE WAY PEDESTRIAN SIGNAL ON PEDESTAL WITH DETECTOR
- TWO WAY PEDESTRIAN SIGNAL ON PEDESTAL WITH DETECTORS
- ARROW POINTS TO THE INTENDED LOCATION OF THE DETECTOR
- 2.5' X 4' PEDESTRIAN LANDING PAD

SIGNAL LOCATION 3:
SR 45/US 41/TAMIAMI TRL
AT WHITFIELD AVE
13010 MP 1.570
SIGNAL ID: 391

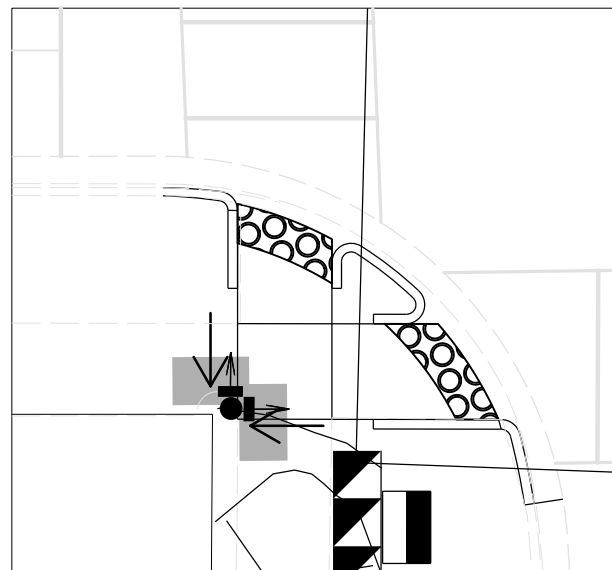

DETAIL 1" = 10'
SOUTHEAST QUADRANT
SR 45 (US 41/TAMIAMI TRAIL)
AT WHITFIELD AVENUE

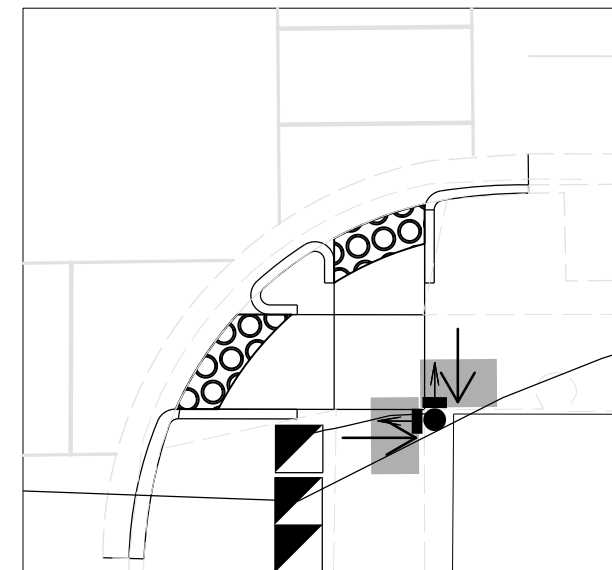

DETAIL 1" = 10'
NORTHEAST QUADRANT
SR 45 (US 41/TAMIAMI TRAIL)
AT WHITFIELD AVENUE

5/22/2024 8:21:05 AM KINHNTST C:\Projects\FDOT\44461215201\Signalization\SSDTS02.dgn

REVISIONS				ENGINEER OF RECORD		STATE OF FLORIDA DEPARTMENT OF TRANSPORTATION			PEDESTRIAN SIGNAL DETAIL (03)	SHEET NO.
DATE	DESCRIPTION	DATE	DESCRIPTION	ISAMARIE L. MONREAL, P.E. LICENSE NUMBER: 72029 FLORIDA DEPARTMENT OF TRANSPORTATION 801 N. BROADWAY AVENUE BARTOW, FL 33830-3809		ROAD NO.	COUNTY	FINANCIAL PROJECT ID		T-18
								SR 45		MANATEE

THE OFFICIAL RECORD OF THIS SHEET IS THE ELECTRONIC FILE DIGITALLY SIGNED AND SEALED UNDER RULE 61G15-23.004, F.A.C.

DETAIL 1" = 10'
SOUTHWEST QUADRANT
SR 45 (US 41/TAMIAMI TRAIL)
AT PEARL AVENUE

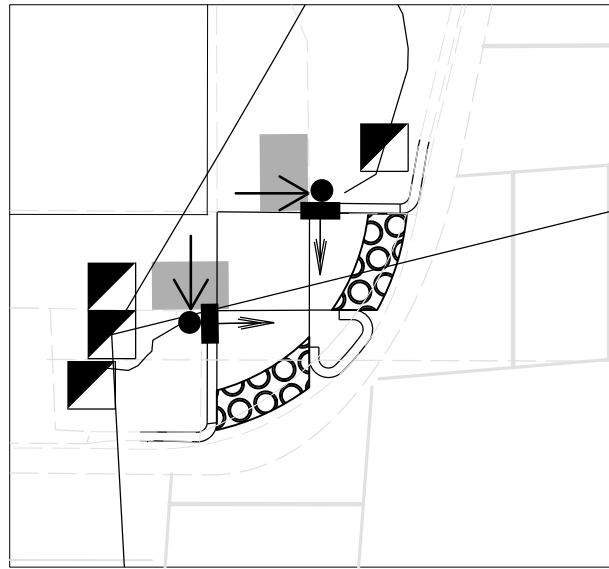

DETAIL 1" = 10'
NORTHWEST QUADRANT
SR 45 (US 41/TAMIAMI TRAIL)
AT PEARL AVENUE

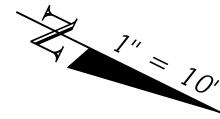
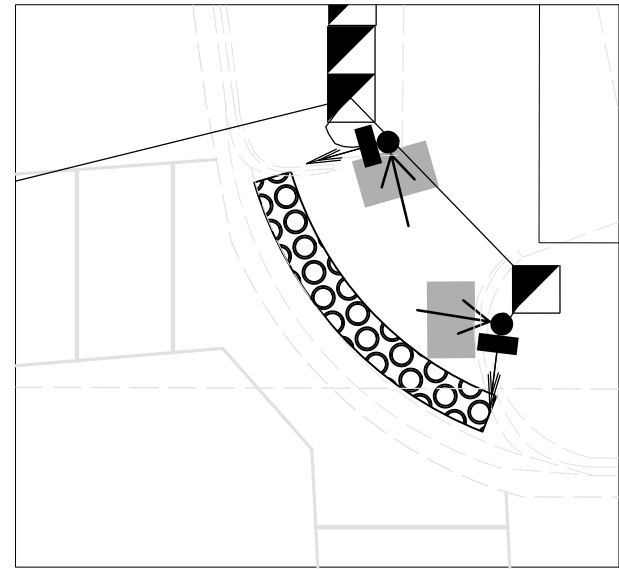

SYMBOLGY

- ONE WAY PEDESTRIAN SIGNAL ON PEDESTAL WITH DETECTOR
- TWO WAY PEDESTRIAN SIGNAL ON PEDESTAL WITH DETECTORS
- ARROW POINTS TO THE INTENDED LOCATION OF THE DETECTOR
- 2.5' X 4' PEDESTRIAN LANDING PAD

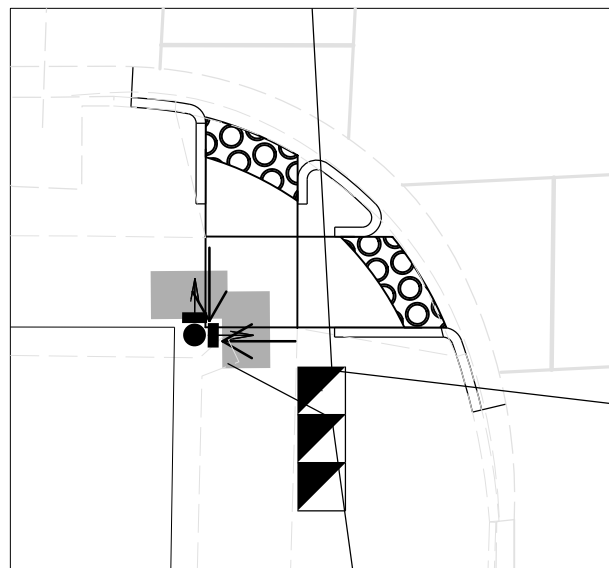

DETAIL 1" = 10'
SOUTHEAST QUADRANT
SR 45 (US 41/TAMIAMI TRAIL)
AT PEARL AVENUE

SIGNAL LOCATION 4:
SR 45/US 41/TAMIAMI TRL
AT PEARL AVE
13010 MP 1.732
SIGNAL ID: 392

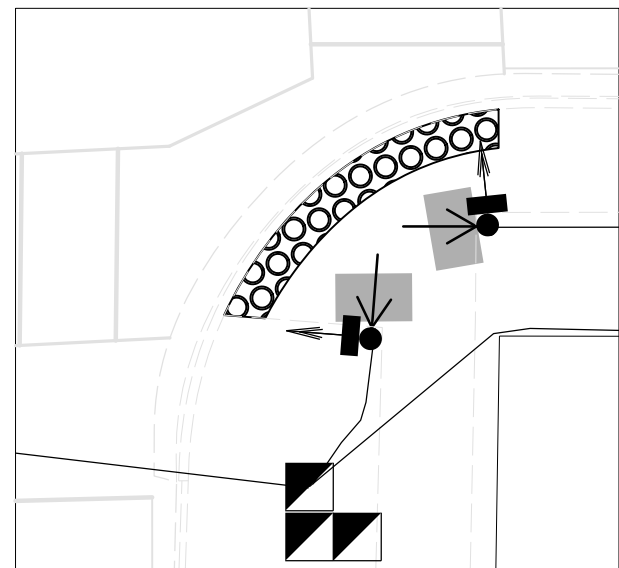

DETAIL 1" = 10'
NORTHEAST QUADRANT
SR 45 (US 41/TAMIAMI TRAIL)
AT PEARL AVENUE

5/22/2024 8:21:07 AM KINHNTST C:\Projects\FDOT\44461215201\Signalization\SSDTS02.dgn

REVISIONS				ENGINEER OF RECORD		STATE OF FLORIDA DEPARTMENT OF TRANSPORTATION			SHEET NO.
DATE	DESCRIPTION	DATE	DESCRIPTION	ISAMARIE L. MONREAL, P.E. LICENSE NUMBER: 72029 FLORIDA DEPARTMENT OF TRANSPORTATION 801 N. BROADWAY AVENUE BARTOW, FL 33830-3809		ROAD NO.	COUNTY	FINANCIAL PROJECT ID	
						SR 45	MANATEE	444612-1-52-01	
PEDESTRIAN SIGNAL DETAIL (04)									T-19

THE OFFICIAL RECORD OF THIS SHEET IS THE ELECTRONIC FILE DIGITALLY SIGNED AND SEALED UNDER RULE 61G15-23.004, F.A.C.

LEGEND

- BUFFER TUBE
- FIBER
- - - EXISTING FIBER
- ⊥ UNTERMINATED FIBER
- PROPOSED FUSION SPLICE
- EXISTING FUSION SPLICE
- ⊗ EXISTING SPLICE (TO BE REMOVED)
- PROPOSED PRETERMINATED CONNECTOR ASSEMBLY

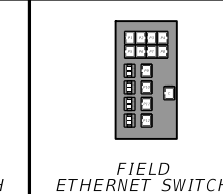
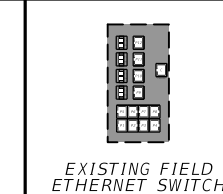
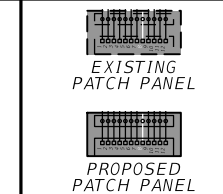
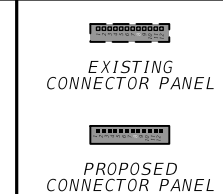
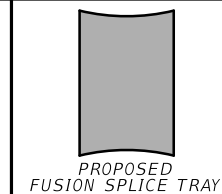
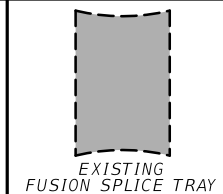
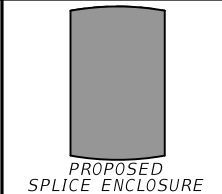
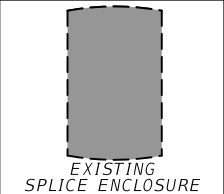

SIGNAL LOCATION 1
SR 45/US 41/TAMIAMI TRAIL
AT BRADEN AVE
13010 MP 0.560
SIGNAL ID 389

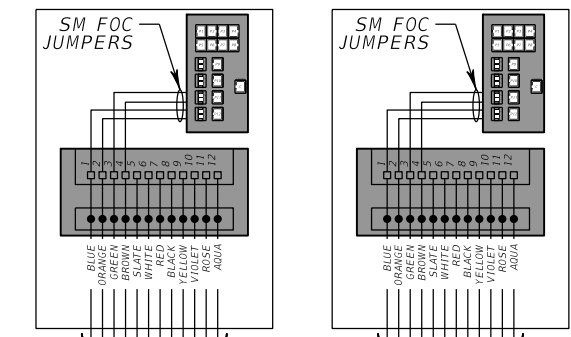

PROPOSED 12 SM FOC FIBER DROP

PROPOSED 12 SM FOC FIBER DROP

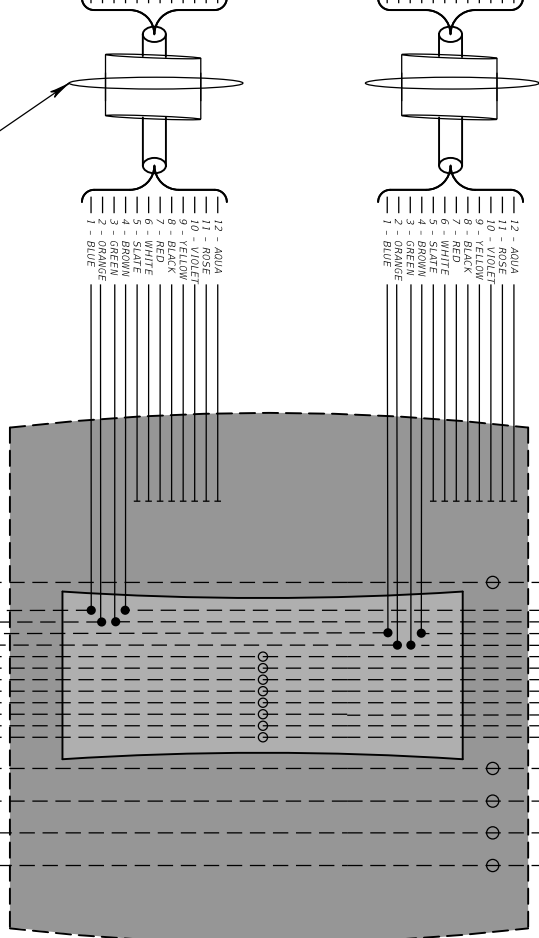

EXISTING 72 SM FOC

BL (1-12)

OR (13-24)

GR (25-36)

BR (37-48)

SL (49-60)

WH (61-72)

- 1 - BLUE
- 2 - ORANGE
- 3 - GREEN
- 4 - BROWN
- 5 - SLATE
- 6 - WHITE
- 7 - RED
- 8 - BLACK
- 9 - YELLOW
- 10 - VIOLET
- 11 - ROSE
- 12 - AQUA

EXISTING 72 SM FOC

BL (1-12)

OR (13-24)

GR (25-36)

BR (37-48)

SL (49-60)

WH (61-72)

- 1 - BLUE
- 2 - ORANGE
- 3 - GREEN
- 4 - BROWN
- 5 - SLATE
- 6 - WHITE
- 7 - RED
- 8 - BLACK
- 9 - YELLOW
- 10 - VIOLET
- 11 - ROSE
- 12 - AQUA

5/22/2024 8:21:12 AM KNHWTST \\NTmaw00\pimwork\3\JOBS\76194_444612_US41\444612_1\signalization\SPDTS001.dgn

REVISIONS		REVISIONS	
DATE	DESCRIPTION	DATE	DESCRIPTION

ENGINEER OF RECORD

ISAMARIE L. MONREAL, P.E.
LICENSE NUMBER 72029
FLORIDA DEPARTMENT OF TRANSPORTATION
801 N. BROADWAY AVENUE
BARTOW, FL 33830-3809

STATE OF FLORIDA DEPARTMENT OF TRANSPORTATION		
ROAD NO.	COUNTY	FINANCIAL PROJECT ID
SR 45	MANATEE	444612-1-52-01

SPLICING DIAGRAM (01)

SHEET NO.
T-20

THE OFFICIAL RECORD OF THIS SHEET IS THE ELECTRONIC FILE DIGITALLY SIGNED AND SEALED UNDER RULE 61G15-23.004, F.A.C.

LEGEND

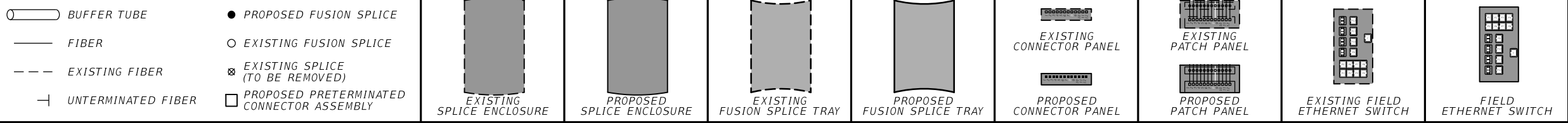

SIGNAL LOCATION 2
 SR 45/US 41/TAMIAMI TRAIL
 AT TALLEVAST RD AND GAINES AVE
 13010 MP 1.378
 SIGNAL ID 390

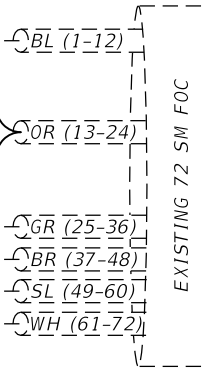
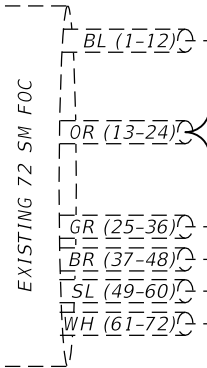
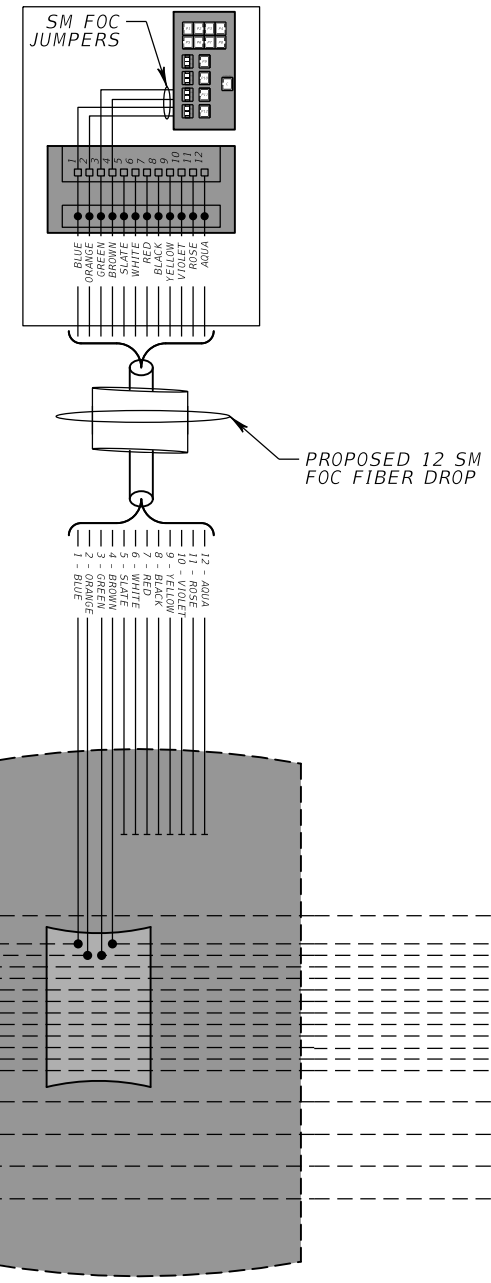

5/22/2024 8:21:16 AM KHHWTST \\NTmaw00\pimwork\3\JOBS\76194_444612_1\signalization\SPDTS001.dgn

REVISIONS				ENGINEER OF RECORD		STATE OF FLORIDA DEPARTMENT OF TRANSPORTATION			SPLICING DIAGRAM (02)	SHEET NO.
DATE	DESCRIPTION	DATE	DESCRIPTION			ROAD NO.	COUNTY	FINANCIAL PROJECT ID		
				ISAMARIE L. MONREAL, P.E. LICENSE NUMBER 72029 FLORIDA DEPARTMENT OF TRANSPORTATION 801 N. BROADWAY AVENUE BARTOW, FL 33830-3809		SR 45	MANATEE	444612-1-52-01		T-21

THE OFFICIAL RECORD OF THIS SHEET IS THE ELECTRONIC FILE DIGITALLY SIGNED AND SEALED UNDER RULE 61G15-23.004, F.A.C.

LEGEND

- BUFFER TUBE
- FIBER
- EXISTING FIBER
- UNTERMINATED FIBER
- PROPOSED FUSION SPLICE
- EXISTING FUSION SPLICE
- EXISTING SPLICE (TO BE REMOVED)
- PROPOSED PRETERMINATED CONNECTOR ASSEMBLY

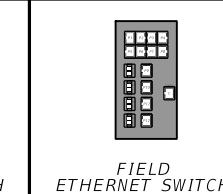
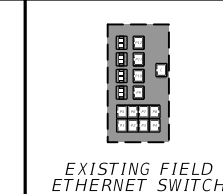
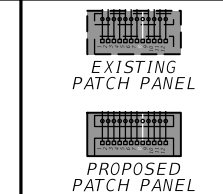
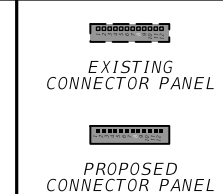
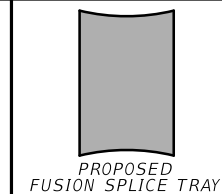
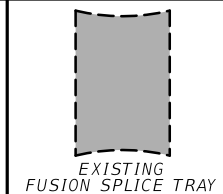
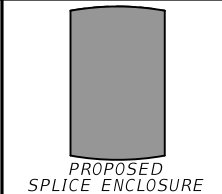
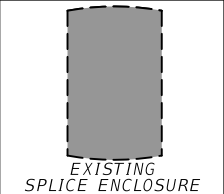

SIGNAL LOCATION 3
SR 45/US 41/TAMIAMI TRAIL
AT WHITFIELD AVE
13010 MP 1.570
SIGNAL ID 391

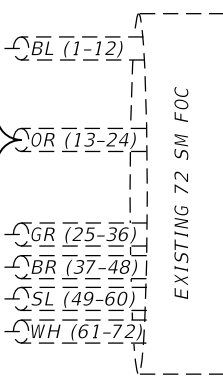
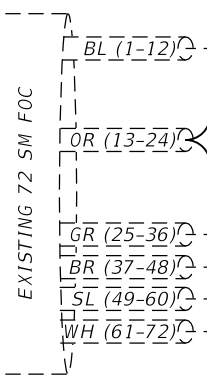
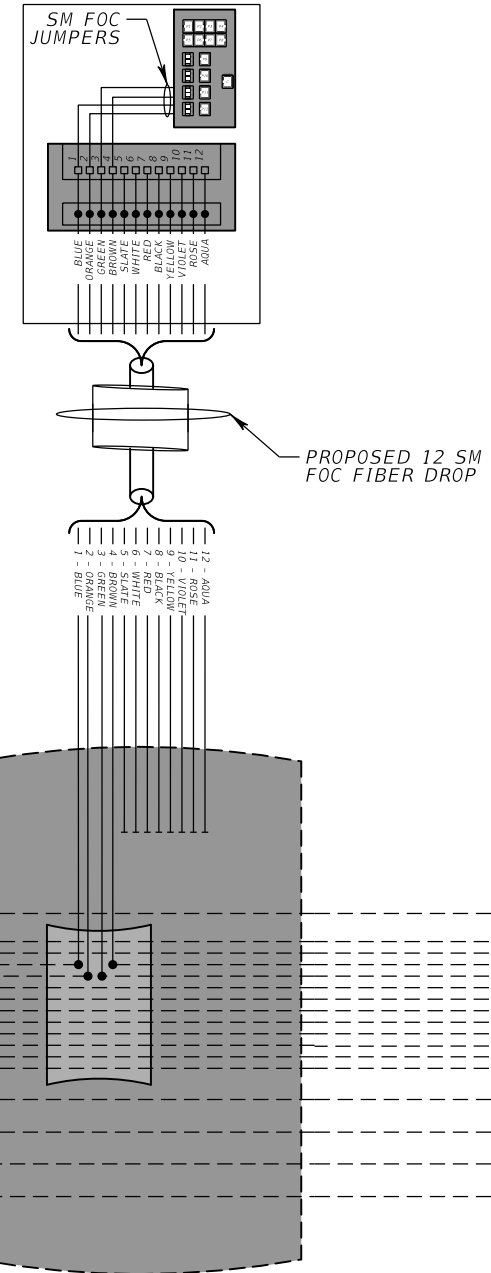





5/22/2024 8:21:19 AM KHHWTST \\NTmaw00\pimwork\3\JOBS\76194_444612_1\signalization\SPDTS001.dgn

REVISIONS				ENGINEER OF RECORD			STATE OF FLORIDA DEPARTMENT OF TRANSPORTATION			SPLICING DIAGRAM (03)	SHEET NO.
DATE	DESCRIPTION	DATE	DESCRIPTION				ROAD NO.	COUNTY	FINANCIAL PROJECT ID		
				ISAMARIE L. MONREAL, P.E. LICENSE NUMBER 72029 FLORIDA DEPARTMENT OF TRANSPORTATION 801 N. BROADWAY AVENUE BARTOW, FL 33830-3809			SR 45	MANATEE	444612-1-52-01		T-22

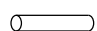
THE OFFICIAL RECORD OF THIS SHEET IS THE ELECTRONIC FILE DIGITALLY SIGNED AND SEALED UNDER RULE 61G15-23.004, F.A.C.

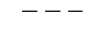
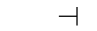
LEGEND

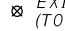
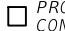
-  BUFFER TUBE
-  FIBER
-  EXISTING FIBER
-  UNTERMINATED FIBER
-  PROPOSED FUSION SPLICE
-  EXISTING FUSION SPLICE
-  EXISTING SPLICE (TO BE REMOVED)
-  PROPOSED PRETERMINATED CONNECTOR ASSEMBLY

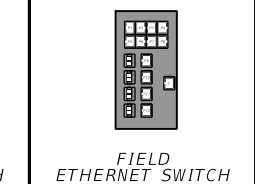
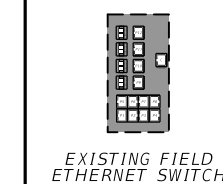
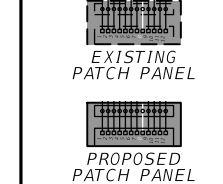
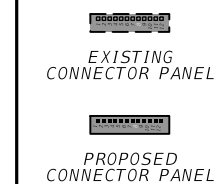
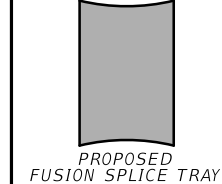
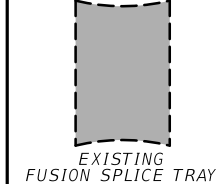
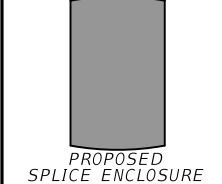
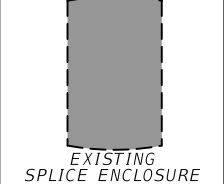

SIGNAL LOCATION 4
SR 45/US 41/TAMIAMI TRAIL
AT PEARL AVE
13010 MP 1.732
SIGNAL ID 392

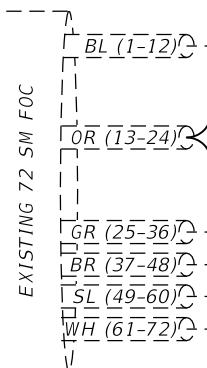
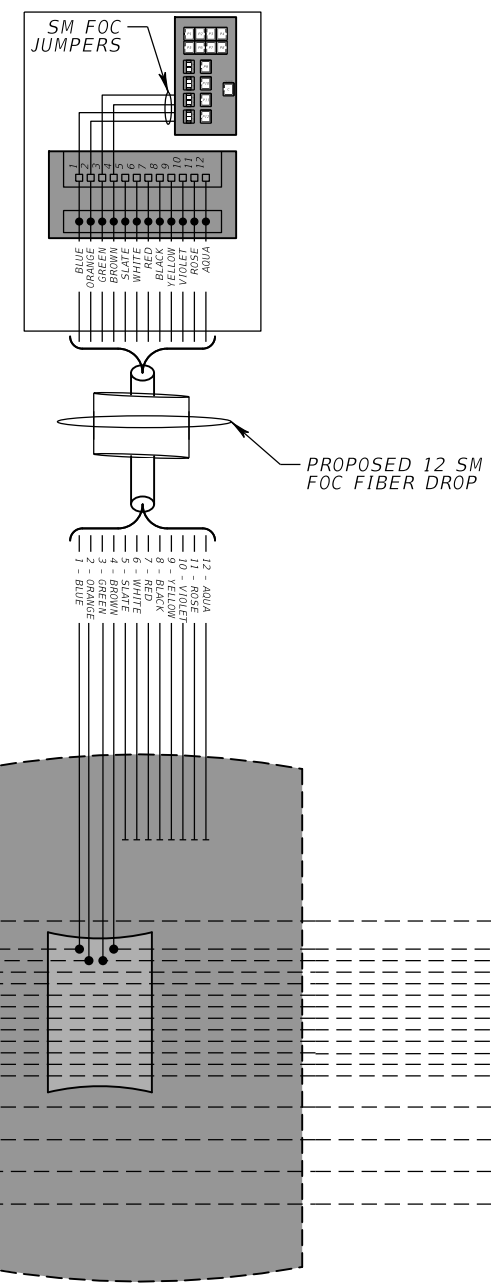

- 1 - BLUE
- 2 - ORANGE
- 3 - GREEN
- 4 - BROWN
- 5 - SLATE
- 6 - WHITE
- 7 - RED
- 8 - BLACK
- 9 - YELLOW
- 10 - VIOLET
- 11 - ROSE
- 12 - AQUA

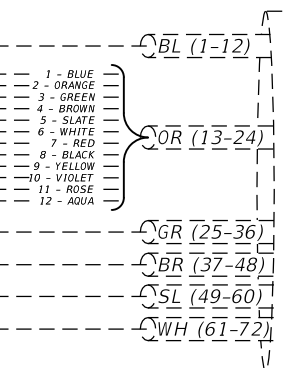

5/22/2024 8:21:22 AM KHHWTST \\NTmaw00\pimwork\3\JOBS\76194_444612_1\signalization\SPDTS001.dgn

REVISIONS				ENGINEER OF RECORD		STATE OF FLORIDA DEPARTMENT OF TRANSPORTATION			SPLICING DIAGRAM (04)	SHEET NO.
DATE	DESCRIPTION	DATE	DESCRIPTION							
				ISAMARIE L. MONREAL, P.E. LICENSE NUMBER 72029 FLORIDA DEPARTMENT OF TRANSPORTATION 801 N. BROADWAY AVENUE BARTOW, FL 33830-3809		ROAD NO.	COUNTY	FINANCIAL PROJECT ID		T-23
						SR 45	MANATEE	444612-1-52-01		

THE OFFICIAL RECORD OF THIS SHEET IS THE ELECTRONIC FILE DIGITALLY SIGNED AND SEALED UNDER RULE 61G15-23.004, F.A.C.

