

STATE OF FLORIDA
DEPARTMENT OF TRANSPORTATION

SIGNALIZATION PLANS

FINANCIAL PROJECT ID 445926-2-52-01, 445926-2-52-02 & 445926-2-52-03

SARASOTA COUNTY (17030)

STATE ROAD NO. SR 789
WIDENING AND RECONSTRUCTION OF SR 789 EAST OF BIRD KEY DR.
INTERSECTION TO WEST OF SUNSET DR. / GOLDEN GATE POINT INTERSECTION

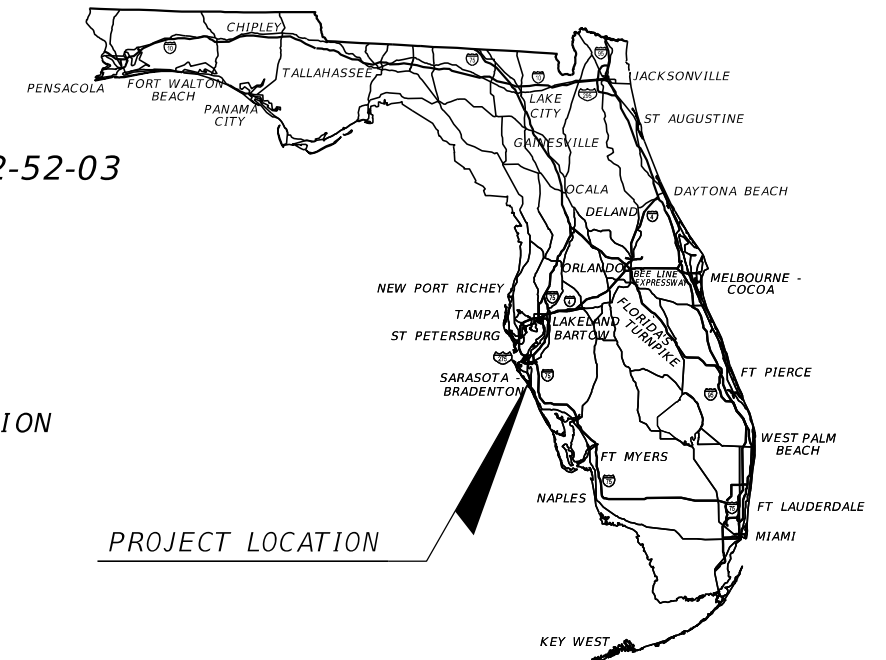

INDEX OF SIGNAL PLANS

SHEET NO.	SHEET DESCRIPTION
T-1	KEY SHEET
T-2	SIGNATURE SHEET
T-3	GENERAL NOTES
T-4	SIGNALIZATION MISCELLANEOUS DETAILS (01)
T-5	SIGNALIZATION MISCELLANEOUS DETAILS (02)
T-6	SIGNALIZATION PLAN (01)
T-7	SIGNALIZATION PLAN (02)
T-8	PEDESTRIAN DETAIL (01)
T-9	PEDESTRIAN DETAIL (02)
T-10	CONDUIT SCHEMATIC (01)
T-11	CONDUIT SCHEMATIC (02)
T-12	STANDARD MAST ARM ASSEMBLIES SHEET
T-13	MAST ARM TABULATION SHEET
T-14 - T-15	GUIDESIGN WORKSHEET
T-16	REPORT OF CORE BORINGS (FUTURE SUBMITTAL)
T-17	SOFT DIG SHEET (FUTURE SUBMITTAL)

PROJECT LOCATION URL: <https://tinyurl.com/yc7dvpe6>

PROJECT LIMITS: BEGIN STA. 121+00.00 - END STA. 133+65.23
BEGIN STA. 164+93.72 - END STA. 184+20.00

EXCEPTIONS: BEGIN STA. 133+65.23 - END STA. 164+93.72

BRIDGE LIMITS: BRIDGE NO. 170176
BEGIN STA. 133+65.23 - END STA. 164+93.72

RAILROAD CROSSING: NONE

SIGNALIZATION PLANS
ENGINEER OF RECORD:

NICOLE R. HECK, P.E.
P.E. LICENSE NUMBER 84306
KIMLEY HORN AND ASSOCIATES, INC.
189 SOUTH ORANGE AVENUE, SUITE 1000
ORLANDO, FLORIDA 32801
PHONE: (401) 898-1511
CONTRACT NO.: C9Q14
VENDOR NO.: F560885615-001

FDOT PROJECT MANAGER:

JEFF MEDNICK

CONSTRUCTION CONTRACT NO.	FISCAL YEAR	SHEET NO.
	25	T-1

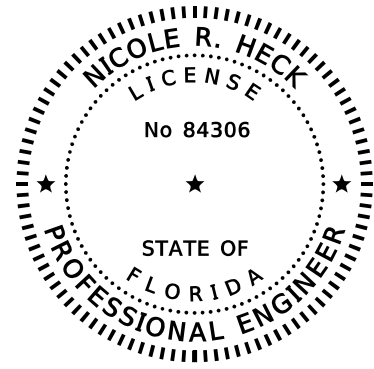

THIS DOCUMENT HAS BEEN DIGITALLY SIGNED AND SEALED BY:

PRINTED COPIES OF THIS DOCUMENT ARE NOT CONSIDERED SIGNED AND SEALED. THE SIGNATURE MUST BE VERIFIED ON ANY ELECTRONIC COPIES.

KIMLEY-HORN AND ASSOCIATES, INC.
189 SOUTH ORANGE AVENUE, SUITE 1000
ORLANDO, FLORIDA 32801
REGISTRY: 35106
NICOLE R. HECK, P.E. NO. 84306

THE ABOVE NAMED PROFESSIONAL ENGINEER SHALL BE RESPONSIBLE FOR THE FOLLOWING SHEETS IN ACCORDANCE WITH RULE 61G15-23.004, F.A.C.

<u>SHEET NO.</u>	<u>SHEET DESCRIPTION</u>
T-1	KEY SHEET
T-2	SIGNATURE SHEET
T-3	GENERAL NOTES
T-4	SIGNALIZATION MISCELLANEOUS DETAILS (01)
T-5	SIGNALIZATION MISCELLANEOUS DETAILS (02)
T-6	SIGNALIZATION PLAN (01)
T-7	SIGNALIZATION PLAN (02)
T-8	PEDESTRIAN DETAIL (01)
T-9	PEDESTRIAN DETAIL (02)
T-10	CONDUIT SCHEMATIC (01)
T-11	CONDUIT SCHEMATIC (02)
T-12	STANDARD MAST ARM ASSEMBLIES SHEET
T-14 - T-15	GUIDESIGN WORKSHEET
T-17	SOFT DIG SHEET (FUTURE SUBMITTAL)

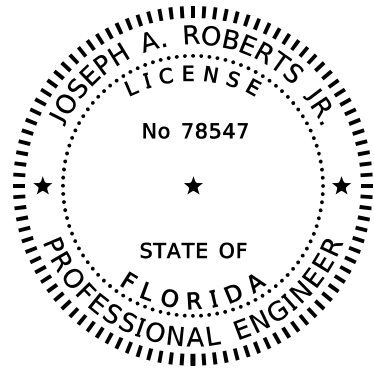

THIS DOCUMENT HAS BEEN DIGITALLY SIGNED AND SEALED BY:

PRINTED COPIES OF THIS DOCUMENT ARE NOT CONSIDERED SIGNED AND SEALED. THE SIGNATURE MUST BE VERIFIED ON ANY ELECTRONIC COPIES.

KIMLEY-HORN AND ASSOCIATES, INC.
189 SOUTH ORANGE AVENUE, SUITE 1000
ORLANDO, FLORIDA 32801
REGISTRY: 35106
JOSEPH A. ROBERTS JR., P.E. NO. 78547

THE ABOVE NAMED PROFESSIONAL ENGINEER SHALL BE RESPONSIBLE FOR THE FOLLOWING SHEETS IN ACCORDANCE WITH RULE 61G15-23.004, F.A.C.

<u>SHEET NO.</u>	<u>SHEET DESCRIPTION</u>
T-2	SIGNATURE SHEET
T-13	MAST ARM TABULATION SHEET

THIS DOCUMENT HAS BEEN DIGITALLY SIGNED AND SEALED BY:

PRINTED COPIES OF THIS DOCUMENT ARE NOT CONSIDERED SIGNED AND SEALED. THE SIGNATURE MUST BE VERIFIED ON ANY ELECTRONIC COPIES.

THE ABOVE NAMED PROFESSIONAL ENGINEER SHALL BE RESPONSIBLE FOR THE FOLLOWING SHEETS IN ACCORDANCE WITH RULE 61G15-23.004, F.A.C.

<u>SHEET NO.</u>	<u>SHEET DESCRIPTION</u>
T-2	SIGNATURE SHEET
T-16	REPORT OF CORE BORINGS (FUTURE SUBMITTAL)

12/21/2023 7:43:44 AM Steven.Hartl K:\SAR_Worksheets\FDOT\149748004_Gulfstream-Sunset\SIGNALIZATION\SIGNS001.dgn

REVISIONS				ENGINEER OF RECORD		STATE OF FLORIDA DEPARTMENT OF TRANSPORTATION			SHEET NO.	
DATE	DESCRIPTION	DATE	DESCRIPTION				ROAD NO.	COUNTY		FINANCIAL PROJECT ID
				NICOLE R. HECK, P.E. LICENSE NUMBER: 84306 KIMLEY-HORN AND ASSOCIATES, INC 189 SOUTH ORANGE AVENUE SUITE 100 ORLANDO, FLORIDA 32801					SR 789	

SIGNATURE SHEET

GENERAL NOTES

1. THE MAINTAINING AGENCY IS SARASOTA COUNTY.
2. WHERE MAST ARM OR ANY OTHER SIGNAL EQUIPMENT REQUIRING FOUNDATIONS ARE PROPOSED WITHIN 4 FEET OF ANY UNDERGROUND UTILITY, THE UTILITY SHALL BE LOCATED AND PROTECTED AND THE INITIAL 5 FEET OF THE SHAFT INSTALLATION SHALL BE HAND DUG.
3. AT LEAST TWO (2) FULL BUSINESS DAYS PRIOR TO BEGINNING THE TRAFFIC SIGNAL INSTALLATION, CONTACT THE SARASOTA COUNTY TRAFFIC SIGNAL INSPECTOR/LIAISON. SEND SARASOTA COUNTY A COPY OF "AS BUILT" PLANS WHEN CONSTRUCTION IS COMPLETE.
4. ALL REMOVED SIGNAL EQUIPMENT SHALL BE DELIVERED TO SARASOTA COUNTY.
5. AT THE COMPLETION OF THE PROJECT, PROVIDE AS-BUILT PLANS IN ELECTRONIC FORM (PDF) TO:
 FDOT TRAFFIC OPERATIONS
 RENJAN JOSEPH, P.E., TSM&O ENGINEER
 801 N. BROADWAY AVE, P.O. BOX 1249
 BARTOW, FL 33830-1249
 EMAIL: RENJAN.JOSEPH@DOT.STATE.FL.US
 PHONE: 863-519-2746
6. REQUEST UPDATED SIGNAL TIMINGS FROM FDOT TSM&O ENGINEER - ARTERIALS (863-519-2216) WHEN ALL LANES, STRIPING, SIGNALS, AND PEDESTRIAN FACILITIES ARE IN THEIR FINAL CONFIGURATION AND THE SIGNAL IS OPERATING AS DESIGNED. PROVIDE FDOT WITH ALL 'AS-BUILT' INFORMATION NECESSARY TO DEVELOP THE BASIC SIGNAL TIMING PARAMETERS AND ALL THREE (3) WEEKS FOLLOWING THE REQUEST FOR FDOT TO DEVELOP THE UPDATED TIMINGS. PROGRAM THE CONTROLLER PER THE TIMINGS PROVIDED BY FDOT.

12/21/2023 7:43:45 AM Steven.Hartl K:\SAR_Works\sets\FDOT\149748004_Gulfstream-Sunset\Signalization\GNWTS601.dgn

REVISIONS				ENGINEER OF RECORD		STATE OF FLORIDA DEPARTMENT OF TRANSPORTATION			GENERAL NOTES	SHEET NO.	
DATE	DESCRIPTION	DATE	DESCRIPTION	NICOLE R. HECK, P.E. LICENSE NUMBER: 84306 KIMLEY-HORN AND ASSOCIATES, INC 189 SOUTH ORANGE AVENUE SUITE 100 ORLANDO, FLORIDA 32801			ROAD NO.	COUNTY		FINANCIAL PROJECT ID	T-3
							SR 789	SARASOTA		445926-2-52-01	

THE OFFICIAL RECORD OF THIS SHEET IS THE ELECTRONIC FILE DIGITALLY SIGNED AND SEALED UNDER RULE 61G15-23.004, F.A.C.

RADAR DETECTOR ASSIGNMENTS				
CAMERA	DETECTION ZONE	SIZE	DETECTOR OPERATION	DELAY (SEC)
R1	1	6' X 40'	NORMAL	-
	6A, 6B, 6C, 6D	6' X 40'	NORMAL	-
R2	6E, 6F, 6G, 6H	6' X 6'	NORMAL	-
R3	3	6' X 40'	NORMAL	-
	8	6' X 40'	DELAY	8
R4	5	6' X 40'	NORMAL	-
	2A, 2B, 2C	6' X 40'	NORMAL	-
R5	2D, 2E, 2F, 2G	6' X 6'	NORMAL	-
R6	7	6' X 40'	NORMAL	-
	4	6' X 40'	DELAY	8

DETECTION ZONES AND CAMERAS NOT SHOWN ARE EXISTING TO REMAIN.

NOTES:

1. MAJOR STREET IS JOHN RINGLING CSWY. (35 MPH), MINOR STREET IS BIRD KEY DR (25 MPH).
2. FLASHING OPERATION: MOVEMENTS 6 YELLOW, ALL OTHER MOVEMENTS RED.

CONTROLLER TIMINGS								
CONTROLLER PHASE	1	2	3	4	5	6	7	8
DIRECTION	EBL	WBT	SBL	NBT	WBL	EBT	NBL	SBT
TURN TYPE	PROT.	-	PT/PM	-	PROT.	-	PT/PM	-
INITIAL GREEN (MIN)	5	15	5	10	5	15	5	10
EXTENSION (GAP)	3	5	3	3	3	5	3	3
YELLOW CLEARANCE	3.4	3.4	4.0	4.0	3.4	3.4	4.0	4.0
ALL RED CLEARANCE	2.2	2.8	2.9	2.0	2.6	2.5	2.0	2.0
MAXIMUM GREEN 1	15	50	15	30	15	50	15	30
MAXIMUM GREEN 2	-	-	-	-	-	-	-	-
MAXIMUM LIMIT	-	-	-	-	-	-	-	-
ADJUST BY	-	-	-	-	-	-	-	-
WALK	-	-	-	-	-	7	-	7
FLASHING DON'T WALK	-	-	-	-	-	27	-	23
DETECTOR MEMORY	-	-	-	-	-	-	-	-
DET. CROSS SWITCH	-	-	-	-	-	-	-	-
DUAL ENTRY	-	ON	-	ON	-	ON	-	ON
PHASE RECALL	-	MIN	-	-	-	MIN	-	-

1. SIGNAL TIMINGS ARE INITIAL AND MAY REQUIRE FIELD ADJUSTMENTS.

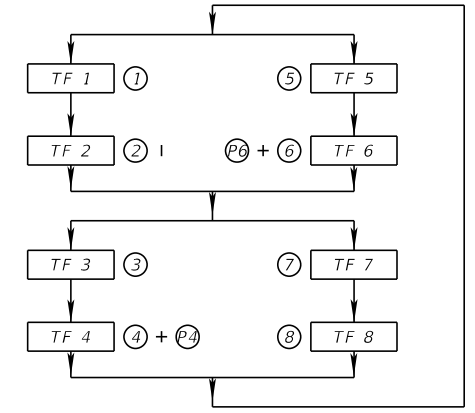
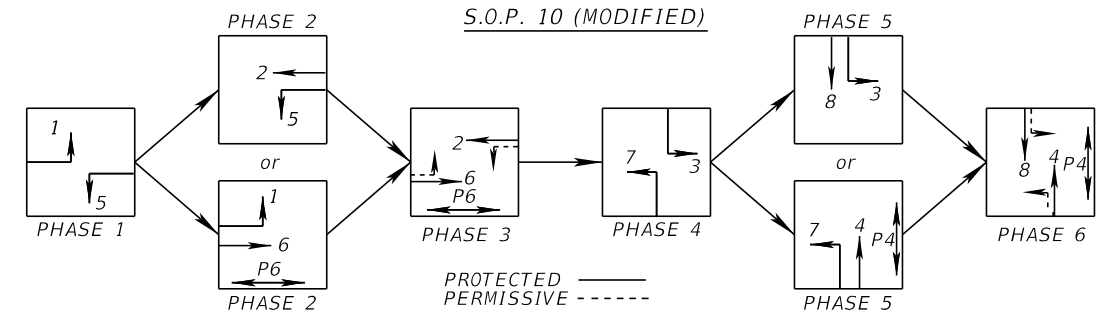

12/21/2023 7:43:54 AM Steven.Hartl K:\SAR_Works\ets\VDOT\149748004_Gulfstream-Sunset\SIGNALIZATION\PLANS\G01.dgn

REVISIONS				ENGINEER OF RECORD		STATE OF FLORIDA DEPARTMENT OF TRANSPORTATION			SIGNALIZATION MISCELLANEOUS DETAILS (01)	SHEET NO. T-4
DATE	DESCRIPTION	DATE	DESCRIPTION	NICOLE HECK, P.E. LICENSE NUMBER: 84306 KIMLEY-HORN AND ASSOCIATES, INC 189 SOUTH ORANGE AVENUE SUITE 100 ORLANDO, FLORIDA 32801		ROAD NO.	COUNTY	FINANCIAL PROJECT ID		
						SR 789	SARASOTA	445926-2-52-01		

THE OFFICIAL RECORD OF THIS SHEET IS THE ELECTRONIC FILE DIGITALLY SIGNED AND SEALED UNDER RULE 61G15-23.004, F.A.C.

RADAR DETECTOR ASSIGNMENTS				
CAMERA	DETECTION ZONE	SIZE	DETECTOR OPERATION	DELAY (SEC)
R1	3	6' X 40'	NORMAL	-
	8	6' X 40'	DELAY	8
R2	1	6' X 40'	NORMAL	-
	6A, 6B, 6C	6' X 40'	NORMAL	-
R3	6D, 6E, 6F, 6G	6' X 6'	NORMAL	-
R4	7	6' X 40'	NORMAL	-
	4	6' X 40'	DELAY	8
R5	5	6' X 40'	NORMAL	-
	2A, 2B, 2C, 2D	6' X 40'	NORMAL	-
R6	2E, 2F, 2G, 2H	6' X 6'	NORMAL	-

DETECTION ZONES AND CAMERAS NOT SHOWN ARE EXISTING TO REMAIN.

NOTES:

1. MAJOR STREET IS JOHN RINGLING CSWY. (35 MPH), MINOR STREET IS SUNSET DR / GOLDEN GATE PT (25 MPH).
2. FLASHING OPERATION: MOVEMENTS 6 YELLOW, ALL OTHER MOVEMENTS RED.

CONTROLLER TIMINGS								
CONTROLLER PHASE	1	2	3	4	5	6	7	8
DIRECTION	EBL	WBT	SBL	NBT	WBL	EBT	NBL	SBT
TURN TYPE	PROT.	-	PT/PM	-	PROT.	-	PT/PM	-
INITIAL GREEN (MIN)	5	15	5	10	5	15	5	10
EXTENSION (GAP)	3	5	3	3	3	5	3	3
YELLOW CLEARANCE	4.0	4.0	3.4	3.4	4.0	4.0	3.4	3.4
ALL RED CLEARANCE	3.0	2.0	2.2	3.0	3.0	2.0	2.1	2.8
MAXIMUM GREEN 1	15	50	15	30	15	50	15	30
MAXIMUM GREEN 2	-	-	-	-	-	-	-	-
MAXIMUM LIMIT	-	-	-	-	-	-	-	-
ADJUST BY	-	-	-	-	-	-	-	-
WALK	-	7	-	7	-	7	-	7
FLASHING DON'T WALK	-	20	-	30	-	13	-	28
DETECTOR MEMORY	-	-	-	-	-	-	-	-
DET. CROSS SWITCH	-	-	-	-	-	-	-	-
DUAL ENTRY	-	ON	-	ON	-	ON	-	ON
PHASE RECALL	-	MIN	-	-	-	MIN	-	-

1. SIGNAL TIMINGS ARE INITIAL AND MAY REQUIRE FIELD ADJUSTMENTS.

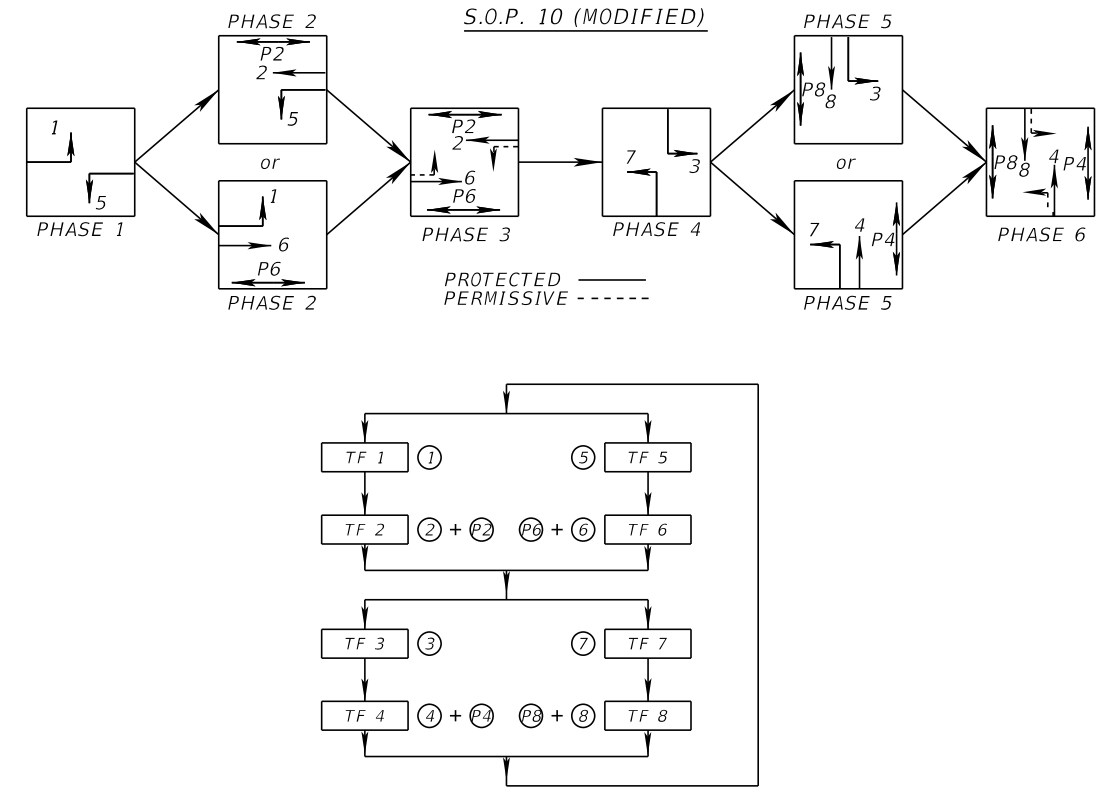

12/21/2023 7:43:55 AM Steven.Hart/K:\SAR_Works\svf\DOT\149748004_Gulfstream-Sunset\SIGNALIZATION\PLANS\G01.dgn

REVISIONS				ENGINEER OF RECORD		STATE OF FLORIDA DEPARTMENT OF TRANSPORTATION			SHEET NO.
DATE	DESCRIPTION	DATE	DESCRIPTION	NICOLE HECK, P.E. LICENSE NUMBER: 84306 KIMLEY-HORN AND ASSOCIATES, INC 189 SOUTH ORANGE AVENUE SUITE 100 ORLANDO, FLORIDA 32801		ROAD NO.	COUNTY	FINANCIAL PROJECT ID	
						SR 789	SARASOTA	445926-2-52-01	T-5

**SIGNALIZATION
MISCELLANEOUS DETAILS (02)**

THE OFFICIAL RECORD OF THIS SHEET IS THE ELECTRONIC FILE DIGITALLY SIGNED AND SEALED UNDER RULE 61G15-23.004, F.A.C.

SIGNAL DISPLAY DETAILS

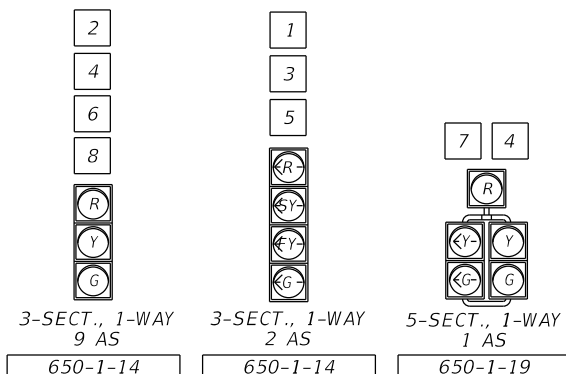

INTERNALLY ILLUMINATED OVERHEAD STREET NAME SIGN DETAILS

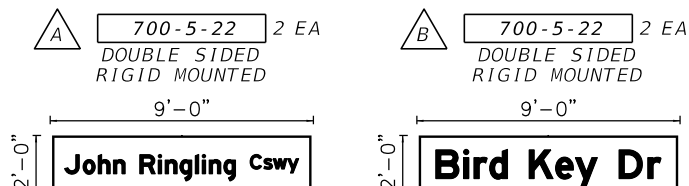

PEDESTRIAN SIGNAL DETAILS

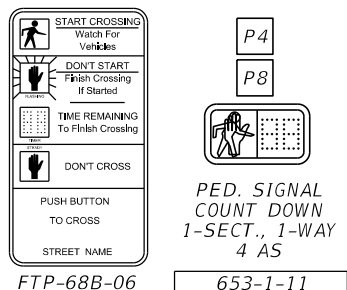

STATIC SIGN DETAILS

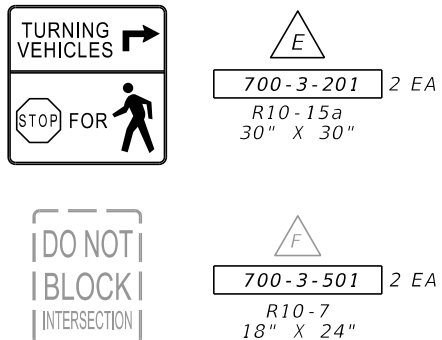

LEGEND:

- CCTV CAMERA
- RADAR DETECTION CAMERA
- RADAR DETECTION ZONE

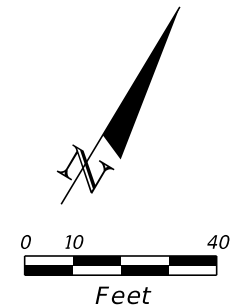
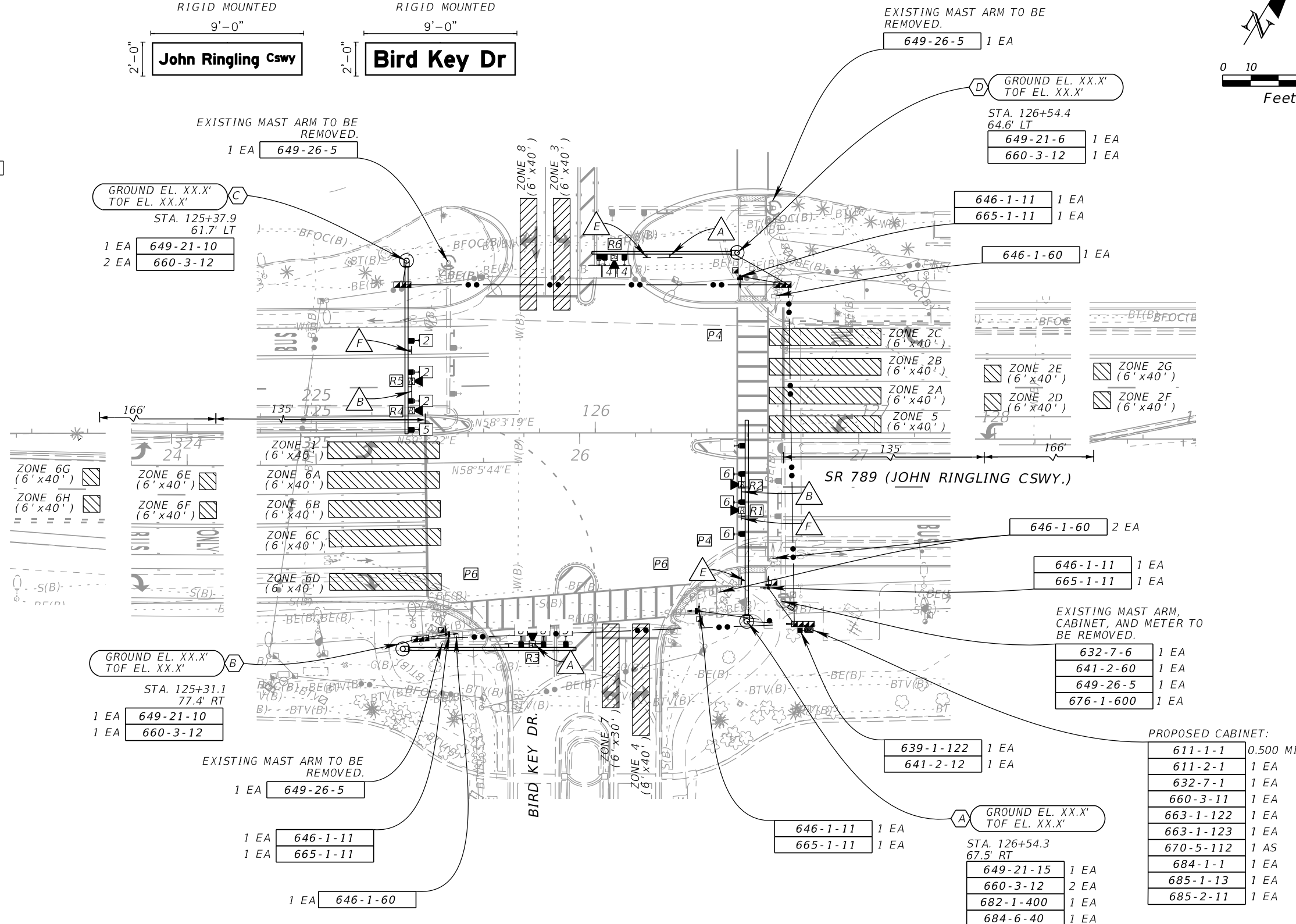

12/21/2023 7:43:57 AM Steven.Hartl K:\SAR_worksets\VDOT\149748004_Gulfstream-Sunset\SIGNALIZATION\PLANS\01.dgn

THE OFFICIAL RECORD OF THIS SHEET IS THE ELECTRONIC FILE DIGITALLY SIGNED AND SEALED UNDER RULE 61G15-23.004, F.A.C.

REVISIONS				ENGINEER OF RECORD		STATE OF FLORIDA DEPARTMENT OF TRANSPORTATION			SIGNALIZATION PLAN (01)	SHEET NO. T-6
DATE	DESCRIPTION	DATE	DESCRIPTION			ROAD NO.	COUNTY	FINANCIAL PROJECT ID		
				NICOLE R. HECK, P.E. LICENSE NUMBER: 84306 KIMLEY-HORN AND ASSOCIATES, INC 189 SOUTH ORANGE AVENUE SUITE 100 ORLANDO, FLORIDA 32801		SR 789	SARASOTA	445926-2-52-01		

PROPOSED CABINET:

611-1-1	0.500 MI
611-2-1	1 EA
632-7-1	1 EA
660-3-11	1 EA
663-1-122	1 EA
663-1-123	1 EA
670-5-112	1 AS
684-1-1	1 EA
685-1-13	1 EA
685-2-11	1 EA

SIGNAL DISPLAY DETAILS

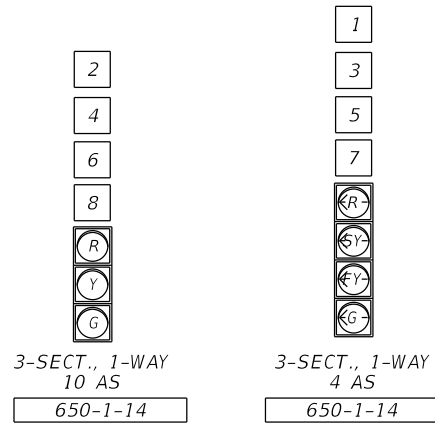

INTERNALLY ILLUMINATED OVERHEAD STREET NAME SIGN DETAILS

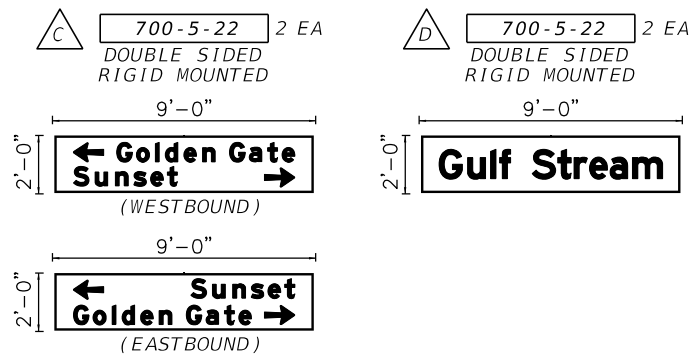

PEDESTRIAN SIGNAL DETAILS

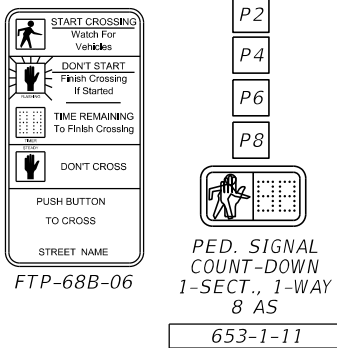

STATIC SIGN DETAILS

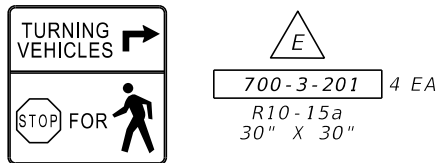

LEGEND:

- CCTV CAMERA
- RADAR DETECTION CAMERA
- RADAR DETECTION ZONE

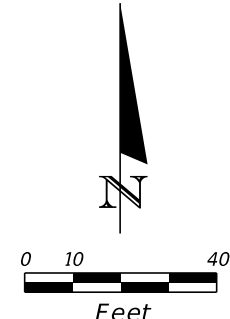
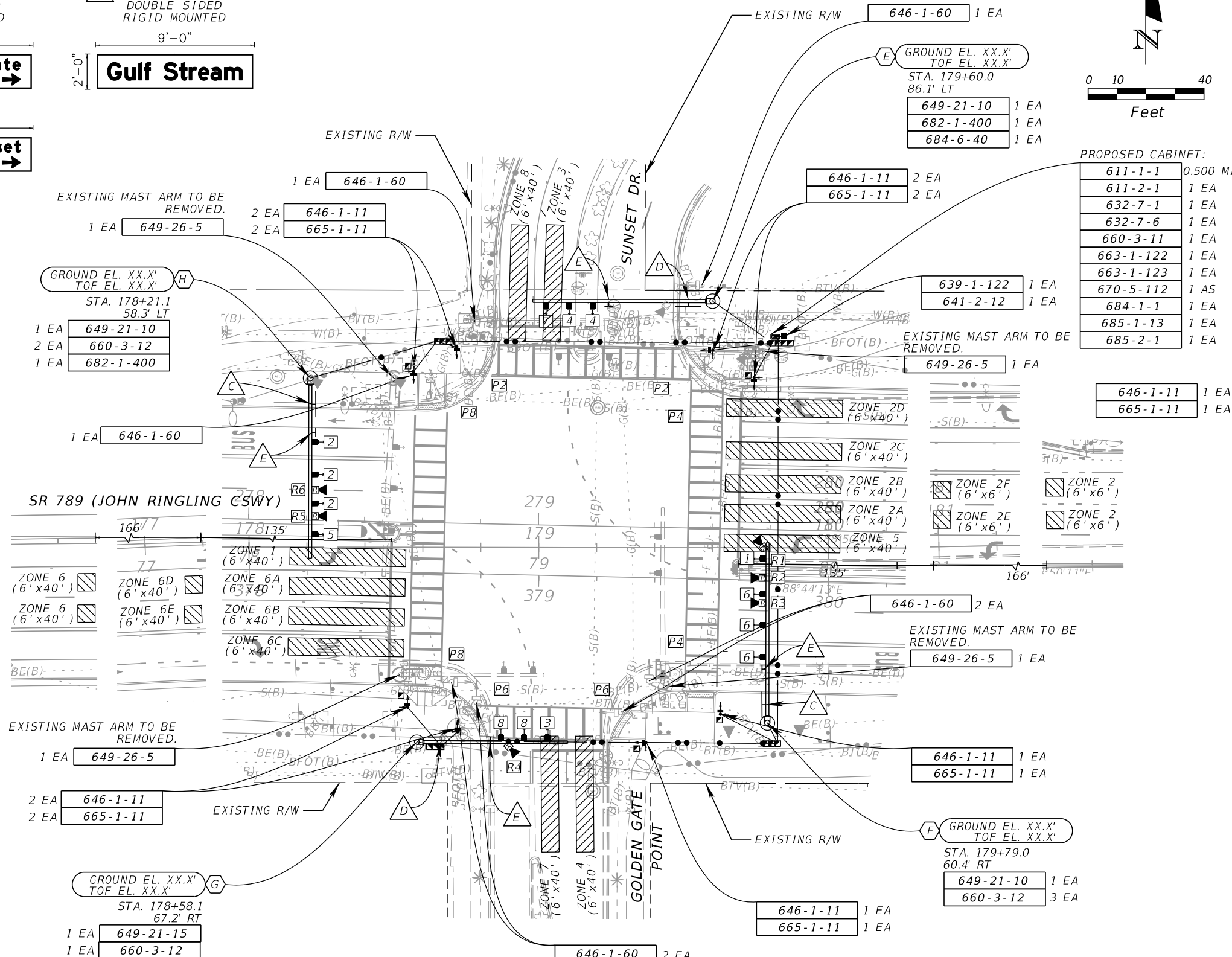

PROPOSED CABINET:

611-1-1	0.500 MI
611-2-1	1 EA
632-7-1	1 EA
632-7-6	1 EA
660-3-11	1 EA
663-1-122	1 EA
663-1-123	1 EA
670-5-112	1 AS
684-1-1	1 EA
685-1-13	1 EA
685-2-1	1 EA

646-1-11	1 EA
665-1-11	1 EA

12/21/2023 7:44:00 AM Steven.Hartl K:\SAR_worksets\VDOT\149748004_GulfStream-Sunset\SIGNALIZATION\PLANS\G01.dgn

THE OFFICIAL RECORD OF THIS SHEET IS THE ELECTRONIC FILE DIGITALLY SIGNED AND SEALED UNDER RULE 61G15-23.004, F.A.C.

REVISIONS				ENGINEER OF RECORD		STATE OF FLORIDA DEPARTMENT OF TRANSPORTATION			SHEET NO.
DATE	DESCRIPTION	DATE	DESCRIPTION			ROAD NO.	COUNTY	FINANCIAL PROJECT ID	
				NICOLE R. HECK, P.E. LICENSE NUMBER: 84306 KIMLEY-HORN AND ASSOCIATES, INC. 189 SOUTH ORANGE AVENUE SUITE 100 ORLANDO, FLORIDA 32801		SR 789	SARASOTA	445926-2-52-01	T-7

SIGNALIZATION PLAN (02)

12/21/2023 7:44:08 AM Steven.Hartl
 K:\SAR_worksets\VDOT\149748004_Gulfstream-Sunset\SIGNALIZATION\PLANS\G02.dgn

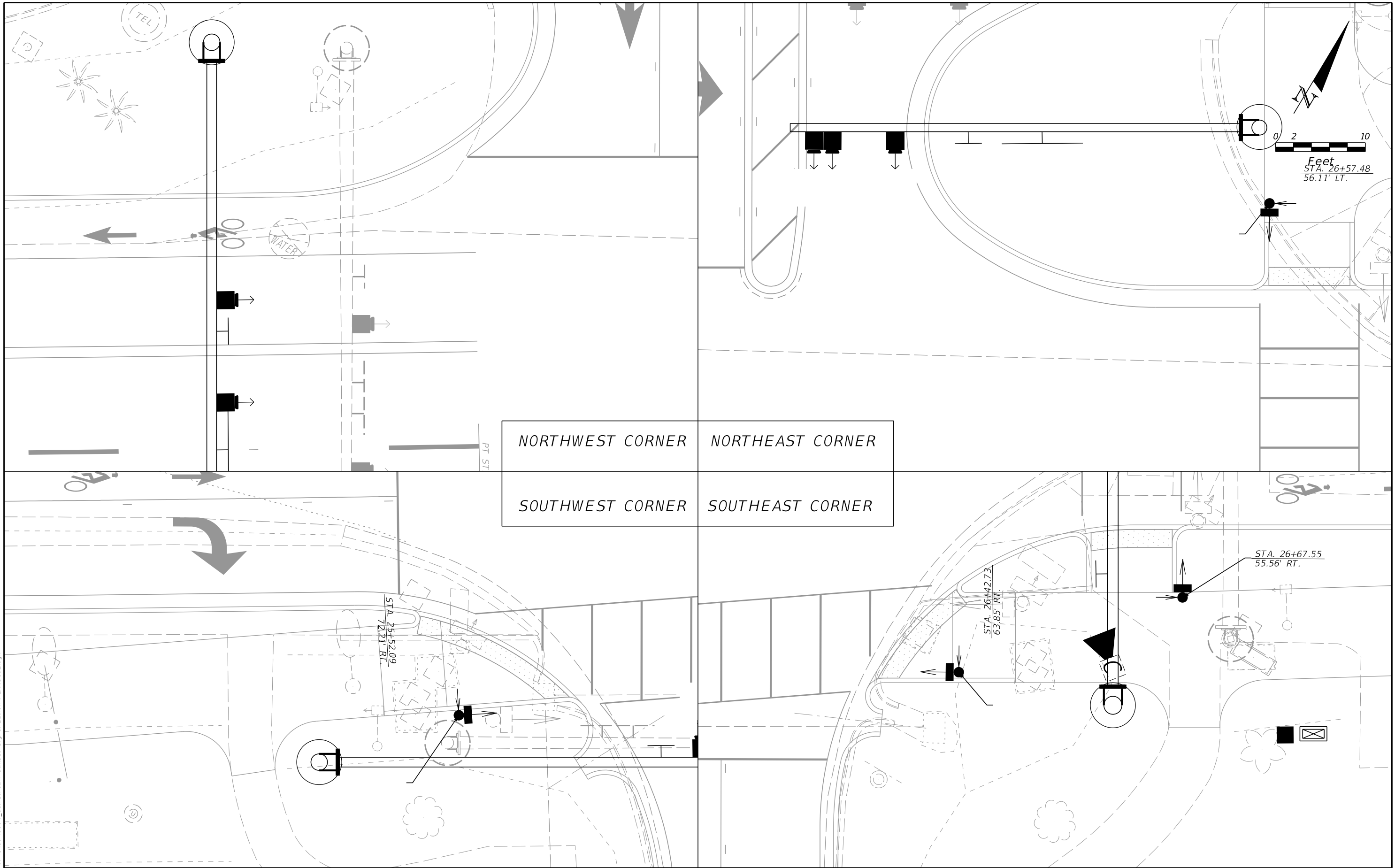

NORTHWEST CORNER	NORTHEAST CORNER
SOUTHWEST CORNER	SOUTHEAST CORNER

REVISIONS			
DATE	DESCRIPTION	DATE	DESCRIPTION

ENGINEER OF RECORD
 NICOLE R. HECK, P.E.
 LICENSE NUMBER: 84306
 KIMLEY-HORN AND ASSOCIATES, INC
 189 SOUTH ORANGE AVENUE SUITE 100
 ORLANDO, FLORIDA 32801

STATE OF FLORIDA DEPARTMENT OF TRANSPORTATION		
ROAD NO.	COUNTY	FINANCIAL PROJECT ID
SR 789	SARASOTA	445926-2-52-01

PEDESTRIAN DETAIL (01)

SHEET NO.
T-8

THE OFFICIAL RECORD OF THIS SHEET IS THE ELECTRONIC FILE DIGITALLY SIGNED AND SEALED UNDER RULE 61G15-23.004, F.A.C.

12/21/2023 7:44:10 AM Steven.Hartl
 K:\SAR_worksets\VDOT\149748004_Gulfstream-Sunset\SIGNALIZATION\PLANS\02.dgn

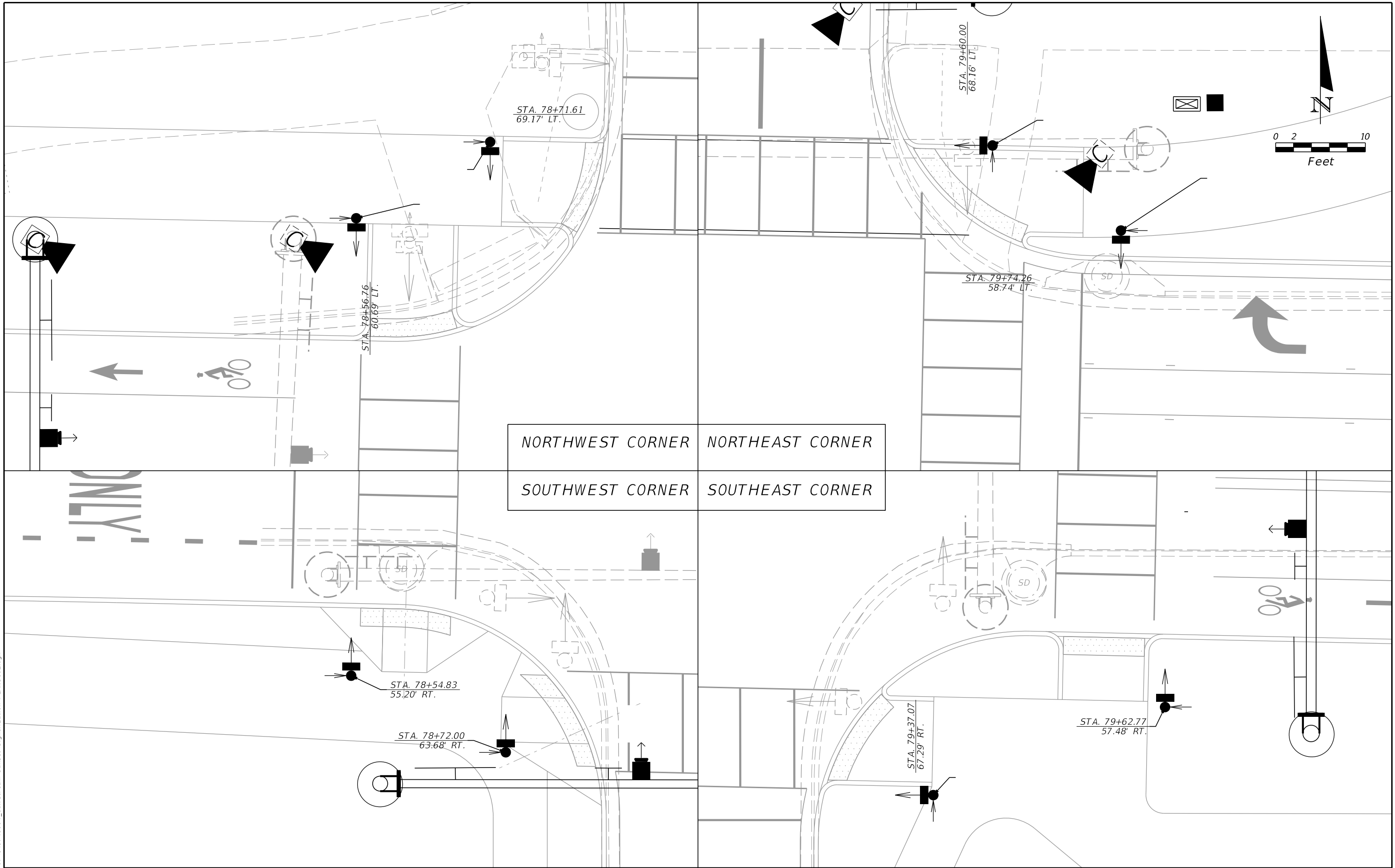

REVISIONS			
DATE	DESCRIPTION	DATE	DESCRIPTION

ENGINEER OF RECORD
 NICOLE R. HECK, P.E
 LICENSE NUMBER: 84306
 KIMLEY-HORN AND ASSOCIATES, INC
 189 SOUTH ORANGE AVENUE SUITE 100
 ORLANDO, FLORIDA 32801

STATE OF FLORIDA DEPARTMENT OF TRANSPORTATION		
ROAD NO.	COUNTY	FINANCIAL PROJECT ID
SR 789	SARASOTA	445926-2-52-01

PEDESTRIAN DETAIL (02)

SHEET NO.
T-9

THE OFFICIAL RECORD OF THIS SHEET IS THE ELECTRONIC FILE DIGITALLY SIGNED AND SEALED UNDER RULE 61G15-23.004, F.A.C.

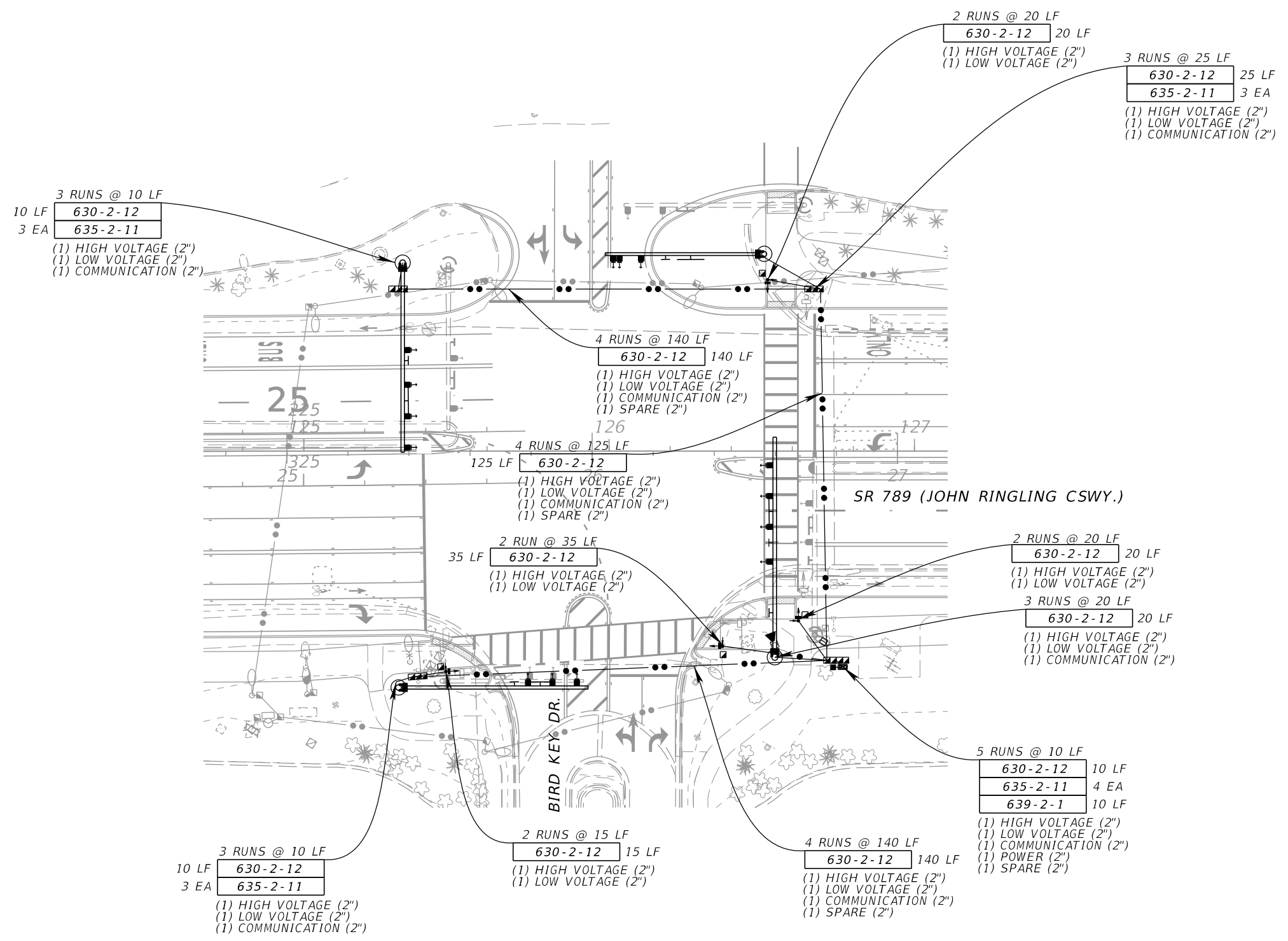
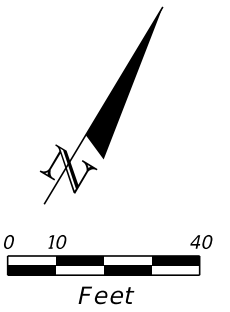

12/21/2023 7:44:13 AM Steven.Hartl K:\SAR_Worksheets\FDOT\149748004_Gulfstream-Sunset\SIGNALIZATION\PLANS\603.dgn

REVISIONS				ENGINEER OF RECORD		STATE OF FLORIDA DEPARTMENT OF TRANSPORTATION			SHEET NO.
DATE	DESCRIPTION	DATE	DESCRIPTION	NICOLE R. HECK, P.E. LICENSE NUMBER: 84306 KIMLEY-HORN AND ASSOCIATES, INC 189 SOUTH ORANGE AVENUE SUITE 100 ORLANDO, FLORIDA 32801		ROAD NO.	COUNTY	FINANCIAL PROJECT ID	
						SR 789	SARASOTA	445926-2-52-01	
CONDUIT SCHEMATIC (01)									T-10

THE OFFICIAL RECORD OF THIS SHEET IS THE ELECTRONIC FILE DIGITALLY SIGNED AND SEALED UNDER RULE 61G15-23.004, F.A.C.

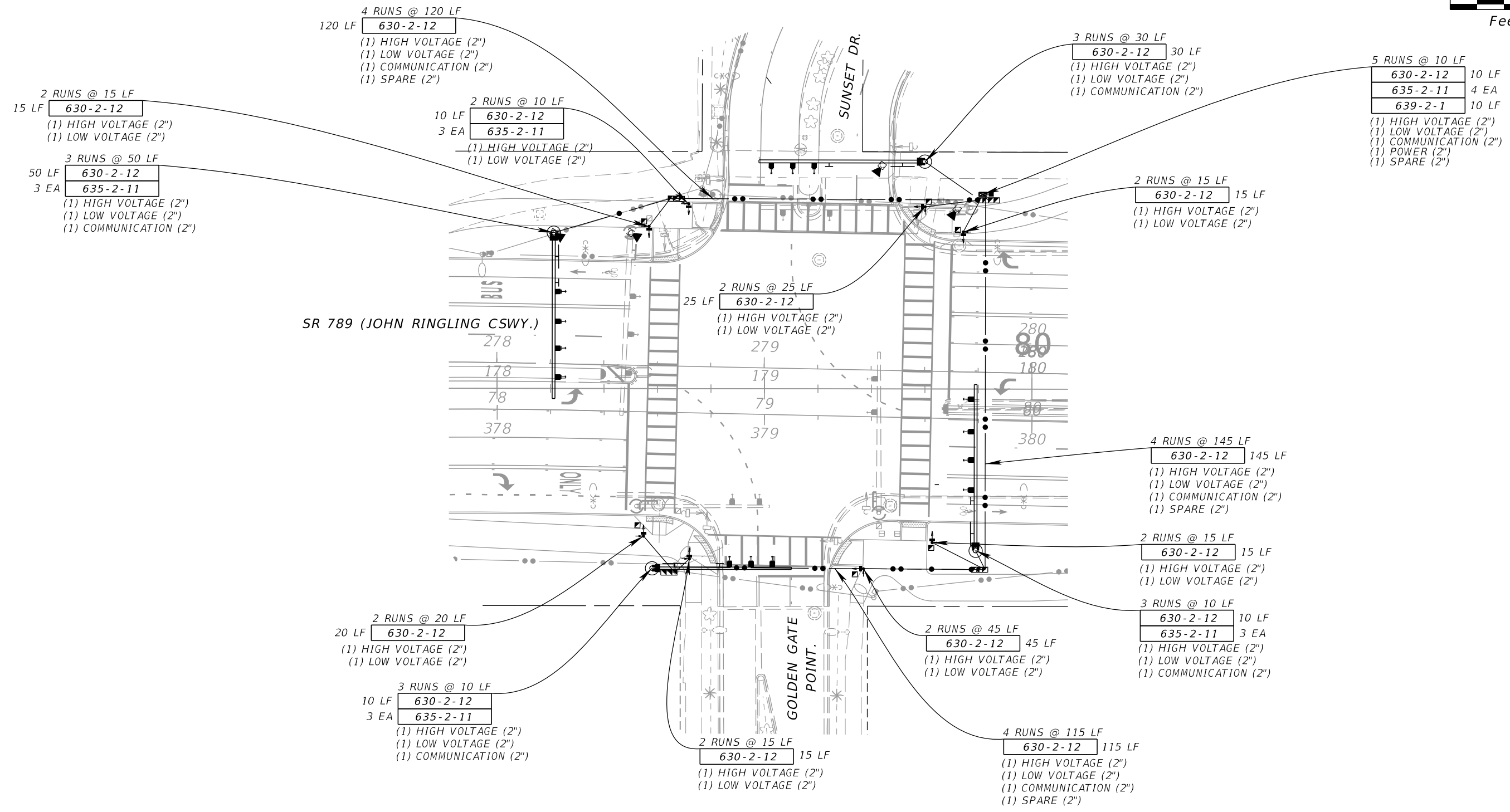
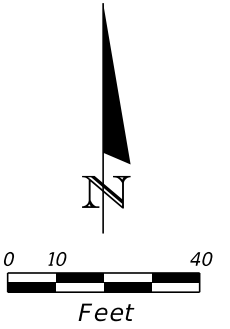

12/21/2023 7:44:15 AM Steven.Hartl K:\SAR_Worksheets\FDOT\149748004_Gulfstream-Sunset\SIGNALIZATION\PLANS\G03.dgn

THE OFFICIAL RECORD OF THIS SHEET IS THE ELECTRONIC FILE DIGITALLY SIGNED AND SEALED UNDER RULE 61G15-23.004, F.A.C.

REVISIONS				ENGINEER OF RECORD			STATE OF FLORIDA DEPARTMENT OF TRANSPORTATION			SHEET NO.
DATE	DESCRIPTION	DATE	DESCRIPTION				ROAD NO.	COUNTY	FINANCIAL PROJECT ID	
				NICOLE R. HECK, P.E. LICENSE NUMBER: 84306 KIMLEY-HORN AND ASSOCIATES, INC 189 SOUTH ORANGE AVENUE SUITE 100 ORLANDO, FLORIDA 32801			SR 789	SARASOTA	445926-2-52-01	

TO BE COMPLETED AT NEXT SUBMITTAL

12/21/2023 7:44:17 AM Steven.Hartl K:\SAR_Works\ets\FDOT\149748004_Gulfstream-Sunset\Signalization\MSS65601.dgn

REVISIONS				ENGINEER OF RECORD	STATE OF FLORIDA DEPARTMENT OF TRANSPORTATION			<i>STANDARD MAST ARM ASSEMBLIES SHEET</i>	SHEET NO.
DATE	DESCRIPTION	DATE	DESCRIPTION	ROAD NO.	COUNTY	FINANCIAL PROJECT ID	T-12		
				JOSEPH A. ROBERTS JR., P.E. LICENSE NUMBER: 78547 KIMLEY-HORN AND ASSOCIATES, INC 189 SOUTH ORANGE AVENUE SUITE 100 ORLANDO, FLORIDA 32801	SR 789	SARASOTA	445926-2-52-01		

THE OFFICIAL RECORD OF THIS SHEET IS THE ELECTRONIC FILE DIGITALLY SIGNED AND SEALED UNDER RULE 61G15-23.004, F.A.C.

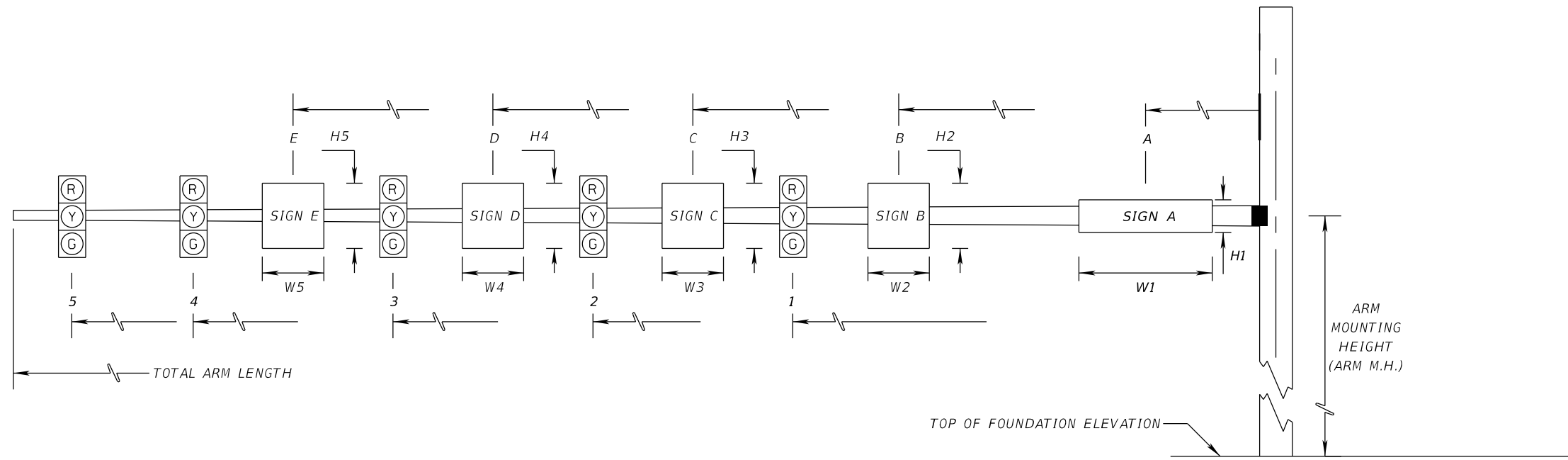

ID NO.	SHEET NO.	LOCATION BY STA.	TOP OF FOUND. ELEVATION	RDWY ARM NO.	CROWN ELEV.	LUMI-NAIRE Y/N	TERM. COMP. Y/N	SIGNAL DATA								TOTAL ARM LENGTH	ARM M.H.	ANGLE BETWEEN DUAL ARMS 90/270	SIGN DATA									DETECTION	PAINT COLOR			
								SIGNAL V/H	BACK PLATES Y/N	PED. SIGNAL Y/N	DISTANCE FROM POLE				DISTANCE FROM POLE/HEIGHT & WIDTH OF SIGN																	
											1	*	2	*	3				*	4	*	A	H1	W1	B	H2	W2			C	H3	W3
PROPOSED LOADING																																
A	T-4	126+54.3 67.5' RT	XX.X'	1	XX.X'	N	Y	V	Y	N	30.0'	3	41.0'	3	51.0'	3	61.0'	3	70.0'	XX'		13.0'	2.0'	9.0'	35.5'	3.0'	2.5'	46.0'	3.0'	2.5'	0', 38.0', 47.0'	GALVANIZED
B	T-4	125+31.1 77.4' RT	XX.X'	1	XX.X'	N	Y	V	Y	N	40.5'	3	48.5'	3	56.5'	3			60.0'	XX'		36.0'	3.0'	2.5'	44.5'	2.0'	9.0'				44.5'	GALVANIZED
C	T-4	125+37.9 61.7' LT	XX.X'	1	XX.X'	N	Y	V	Y	N	26.5'	3	38.0'	3	48.5'	3	58.5'	3	60.0'	XX'		30.0'	3.0'	2.5'	43.5'	2.0'	9.0'				41.5', 52.0'	GALVANIZED
D	T-4	126+54.4 64.6' LT	XX.X'	1	XX.X'	N	Y	V	Y	N	36.5'	3	44.5'	5					50.0'	XX'		20.5'	2.0'	9.0'	28.5'	3.0'	2.5'				40.0'	GALVANIZED
E	T-8	179+60.0 86.1' LT	XX.X'	1	XX.X'	N	Y	V	Y	N	39.5'	3	47.5'	3	55.5'	3			60.0'	XX'		6.5'	2.0'	9.0'	34.0'	3.0'	2.5'				6.5'	GALVANIZED
F	T-8	179+79.0 60.4' RT	XX.X'	1	XX.X'	N	Y	V	Y	N	23.0'	3	34.0'	3	44.5'	3	57.0'	3	60.0'	XX'		6.5'	2.0'	9.0'	19.0'	3.0'	2.5'				41.5', 50.5', 60.0'	GALVANIZED
G	T-8	178+58.1 67.2' RT	XX.X'	1	XX.X'	N	Y	V	Y	N	6.5'	3	23.5'	3					60.0'	XX'		6.5'	2.0'	9.0'	23.5'	3.0'	2.5'				29.0'	GALVANIZED
H	T-8	178+21.1 58.3' LT	XX.X'	1	XX.X'	N	Y	V	Y	N	20.0'	3	31.5'	3	41.5'	3	52.0'	3	60.0'	XX'		7.0'	2.0'	9.0'	17.0'	3.0'	2.5'				0', 36.5', 46.0'	GALVANIZED

* = DENOTES NUMBER OF SECTIONS IN SIGNAL HEAD ASSEMBLY

12/21/2023 7:44:17 AM Steven.Hartl K:\SAR_Worksets\VDOT\149748004_Gulfstream-Sunset\SIGNALIZATION\MSS65601.dgn

REVISIONS				ENGINEER OF RECORD				STATE OF FLORIDA DEPARTMENT OF TRANSPORTATION			MAST ARM TABULATION SHEET	SHEET NO.
DATE	DESCRIPTION	DATE	DESCRIPTION	NICOLE R. HECK, P.E. LICENSE NUMBER: 84306 KIMLEY-HORN AND ASSOCIATES, INC. 189 SOUTH ORANGE AVENUE SUITE 100 ORLANDO, FLORIDA 32801				ROAD NO.	COUNTY	FINANCIAL PROJECT ID		T-13
								SR 789	SARASOTA	445926-2-52-01		

THE OFFICIAL RECORD OF THIS SHEET IS THE ELECTRONIC FILE DIGITALLY SIGNED AND SEALED UNDER RULE 61G15-23.004, F.A.C.

SIGN NAME	A		QTY	2	SIGN NUMBER		STATION(S)	
PANEL	BORDER				125+31.1			
WIDTH	9'-0"	WIDTH	1"	126+54.4				
HEIGHT	2'-0"	RADII	0"					
LEGEND	White	COLOR	White					
COLOR	Green							
SYMBOL(S)	ANGLE	X	Y	WID	HT			
SIGN NUMBER	NUMBER OF POSTS	CLEARANCE Edge of Lane	COLUMN SIZE	AVERAGE LENGTH				

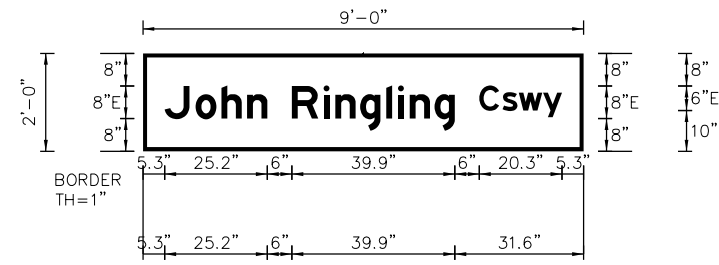

NO. OF LIGHT FIXTURES	FIXTURE SPACING	PHOTOMETRIC CURVE	WATT	VOLTAGE

COPY	J	o	h	n	R	I	n	g	I	I	n	g	C	s	w	y	L
SPACE	5.3	12.9	19.2	25.5	36.5	44.3	47.1	53.2	59.6	62.5	65.4	71.5	82.4	88.1	92.1	98.1	97.4
COPY																	
SPACE																	
COPY																	
SPACE																	
COPY																	
SPACE																	
COPY																	
SPACE																	
COPY																	
SPACE																	

SIGN NAME	C (WB)		QTY	2	SIGN NUMBER		STATION(S)	
PANEL	BORDER				178+21.1			
WIDTH	9'-0"	WIDTH	1"	none				
HEIGHT	2'-0"	RADII	0"					
LEGEND	White	COLOR	White					
COLOR	Green							
SYMBOL(S)	ANGLE	X	Y	WID	HT			
AR_Type A	90	8	13	8	12.6			
AR_Type A	270	87.4	2.5	8	12.6			
SIGN NUMBER	NUMBER OF POSTS	CLEARANCE Edge of Lane	COLUMN SIZE	AVERAGE LENGTH				

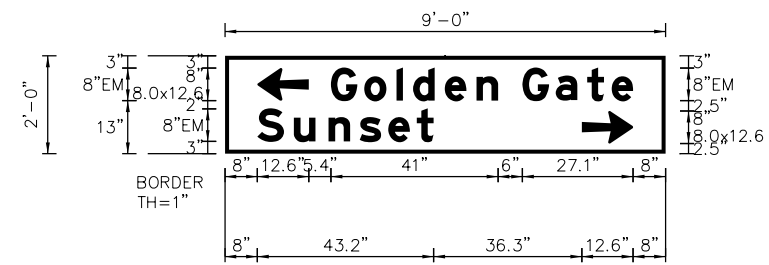

NO. OF LIGHT FIXTURES	FIXTURE SPACING	PHOTOMETRIC CURVE	WATT	VOLTAGE

COPY	G	o	I	d	e	n	G	a	t	e	L
SPACE	26	34.1	42	46.1	53.9	61.6	72.9	81.1	88.8	94.8	74.1
COPY	S	u	n	s	e	t	L				
SPACE	8	16.9	25.4	33	40	47	43.2				
COPY											
SPACE											
COPY											
SPACE											
COPY											
SPACE											
COPY											
SPACE											

DATE		DESCRIPTION		DATE		DESCRIPTION		ENGINEER OF RECORD			STATE OF FLORIDA DEPARTMENT OF TRANSPORTATION			SHEET NO.	
								NICOLE R. HECK, P.E. LICENSE NUMBER: 84306 KIMLEY-HORN AND ASSOCIATES, INC. 189 SOUTH ORANGE AVENUE SUITE 100 ORLANDO, FLORIDA 32801			ROAD NO. COUNTY FINANCIAL PROJECT ID			GUIDESIGN WORKSHEET (01)	
											SR 789 SARASOTA 445926-2-52-01			T-14	

SIGN NAME	B		QTY	2	SIGN NUMBER		STATION(S)	
PANEL	BORDER				125+37.9			
WIDTH	9'-0"	WIDTH	1"	126+54.3				
HEIGHT	2'-0"	RADII	0"					
LEGEND	White	COLOR	White					
COLOR	Green							
SYMBOL(S)	ANGLE	X	Y	WID	HT			
SIGN NUMBER	NUMBER OF POSTS	CLEARANCE Edge of Lane	COLUMN SIZE	AVERAGE LENGTH				

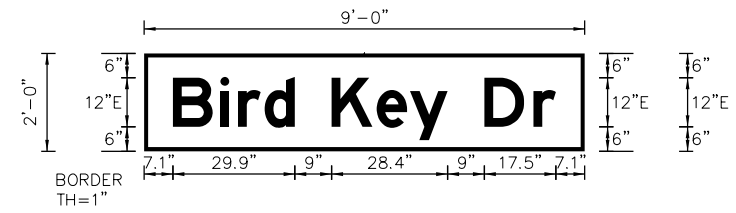

NO. OF LIGHT FIXTURES	FIXTURE SPACING	PHOTOMETRIC CURVE	WATT	VOLTAGE

COPY	B	I	r	d	K	e	y	D	r	L
SPACE	7.1	18.7	23	29.5	46	57	65.2	83.4	95.4	93.8
COPY										
SPACE										
COPY										
SPACE										
COPY										
SPACE										
COPY										
SPACE										
COPY										
SPACE										
COPY										
SPACE										

SIGN NAME	C (EB)		QTY	2	SIGN NUMBER		STATION(S)	
PANEL	BORDER				179+79.0			
WIDTH	9'-0"	WIDTH	1"	none				
HEIGHT	2'-0"	RADII	0"					
LEGEND	White	COLOR	White					
COLOR	Green							
SYMBOL(S)	ANGLE	X	Y	WID	HT			
AR_Type A	90	8	13	8	12.6			
AR_Type A	270	87.4	2.5	8	12.6			
SIGN NUMBER	NUMBER OF POSTS	CLEARANCE Edge of Lane	COLUMN SIZE	AVERAGE LENGTH				

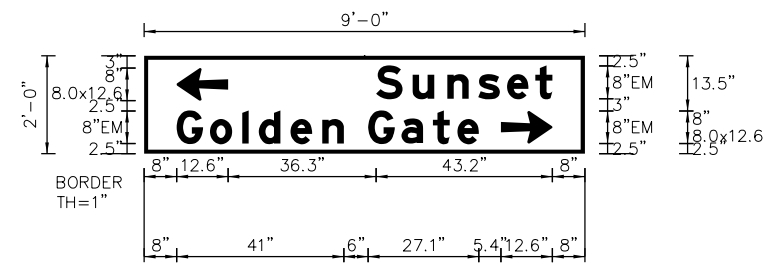

NO. OF LIGHT FIXTURES	FIXTURE SPACING	PHOTOMETRIC CURVE	WATT	VOLTAGE

COPY	S	u	n	s	e	t	L				
SPACE	56.8	65.8	74.3	81.9	88.9	95.9	43.2				
COPY	G	o	I	d	e	n	G	a	t	e	L
SPACE	8	16.1	24	28.1	35.9	43.6	54.9	63.1	70.8	76.8	74.1
COPY											
SPACE											
COPY											
SPACE											
COPY											
SPACE											
COPY											
SPACE											

DATE		DESCRIPTION		DATE		DESCRIPTION		ENGINEER OF RECORD			STATE OF FLORIDA DEPARTMENT OF TRANSPORTATION			SHEET NO.	
								NICOLE R. HECK, P.E. LICENSE NUMBER: 84306 KIMLEY-HORN AND ASSOCIATES, INC. 189 SOUTH ORANGE AVENUE SUITE 100 ORLANDO, FLORIDA 32801			ROAD NO. COUNTY FINANCIAL PROJECT ID			GUIDESIGN WORKSHEET (01)	
											SR 789 SARASOTA 445926-2-52-01			T-14	

12/21/2023 7:44:19 AM Steven.Hart/K:\SAR_worksets\VDOT\149748004_Gulfstream-Sunset\SIGNALIZATION\GSWK5G01.dgn

THE OFFICIAL RECORD OF THIS SHEET IS THE ELECTRONIC FILE DIGITALLY SIGNED AND SEALED UNDER RULE 61G15-23.004, F.A.C.

12/21/2023 7:44:20 AM Steven.Hartl
 K:\SAR_Worksheets\FDOT\149748004_GulfStream-Sunset\Signalization\GSWK5G01.dgn

SIGN NAME	D	QTY	SIGN NUMBER	STATION(S)	
PANEL	BORDER			178+58.1	
WIDTH	9'-0"	WIDTH	1'	179+60.0	
HEIGHT	2'-0"	RADII	0"		
LEGEND	White	COLOR	White		
COLOR	Green				
SYMBOL(S)	ANGLE	X	Y	WID	HT
SIGN NUMBER	NUMBER OF POSTS	CLEARANCE Edge of Lane	COLUMN SIZE	AVERAGE LENGTH	

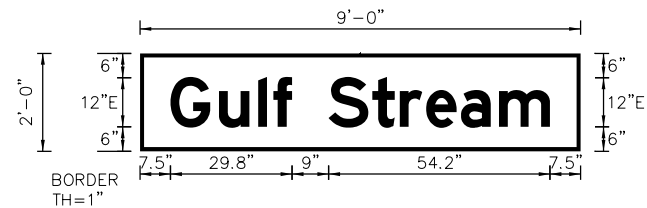

NO. OF LIGHT FIXTURES	FIXTURE SPACING	PHOTOMETRIC CURVE	WATT	VOLTAGE

COPY SPACE	G	u	I	f	S	t	r	e	a	m	L
	7.5	19.4	29	32.7	46.3	56.9	63.7	70.1	78.7	88	93
COPY SPACE											
COPY SPACE											
COPY SPACE											
COPY SPACE											
COPY SPACE											
COPY SPACE											

SIGN NAME	D	QTY	SIGN NUMBER	STATION(S)	
PANEL	BORDER				
WIDTH	WIDTH				
HEIGHT	RADII				
LEGEND	COLOR				
COLOR					
SYMBOL(S)	ANGLE	X	Y	WID	HT
SIGN NUMBER	NUMBER OF POSTS	CLEARANCE Edge of Lane	COLUMN SIZE	AVERAGE LENGTH	

NO. OF LIGHT FIXTURES	FIXTURE SPACING	PHOTOMETRIC CURVE	WATT	VOLTAGE

COPY SPACE											
COPY SPACE											
COPY SPACE											
COPY SPACE											
COPY SPACE											
COPY SPACE											
COPY SPACE											

REVISIONS		ENGINEER OF RECORD	
DATE	DESCRIPTION	DATE	DESCRIPTION

ENGINEER OF RECORD
 NICOLE R. HECK, P.E.
 LICENSE NUMBER: 84306
 KIMLEY-HORN AND ASSOCIATES, INC.
 189 SOUTH ORANGE AVENUE SUITE 100
 ORLANDO, FLORIDA 32801

SIGN NAME	D	QTY	SIGN NUMBER	STATION(S)	
PANEL	BORDER				
WIDTH	WIDTH				
HEIGHT	RADII				
LEGEND	COLOR				
COLOR					
SYMBOL(S)	ANGLE	X	Y	WID	HT
SIGN NUMBER	NUMBER OF POSTS	CLEARANCE Edge of Lane	COLUMN SIZE	AVERAGE LENGTH	

NO. OF LIGHT FIXTURES	FIXTURE SPACING	PHOTOMETRIC CURVE	WATT	VOLTAGE

COPY SPACE											
COPY SPACE											
COPY SPACE											
COPY SPACE											
COPY SPACE											
COPY SPACE											
COPY SPACE											

SIGN NAME	D	QTY	SIGN NUMBER	STATION(S)	
PANEL	BORDER				
WIDTH	WIDTH				
HEIGHT	RADII				
LEGEND	COLOR				
COLOR					
SYMBOL(S)	ANGLE	X	Y	WID	HT
SIGN NUMBER	NUMBER OF POSTS	CLEARANCE Edge of Lane	COLUMN SIZE	AVERAGE LENGTH	

NO. OF LIGHT FIXTURES	FIXTURE SPACING	PHOTOMETRIC CURVE	WATT	VOLTAGE

COPY SPACE											
COPY SPACE											
COPY SPACE											
COPY SPACE											
COPY SPACE											
COPY SPACE											
COPY SPACE											

STATE OF FLORIDA DEPARTMENT OF TRANSPORTATION		
ROAD NO.	COUNTY	FINANCIAL PROJECT ID
SR 789	SARASOTA	445926-2-52-01

GUIDESIGN WORKSHEET (02)
 SHEET NO.
 T-15

THE OFFICIAL RECORD OF THIS SHEET IS THE ELECTRONIC FILE DIGITALLY SIGNED AND SEALED UNDER RULE 61G15-23.004, F.A.C.