

# CENTRAL BROWARD EAST-WEST TRANSIT STUDY

## Parks and Public Land Technical Memorandum



July 2012



**JACOBS**

CENTRAL BROWARD



*This page intentionally left blank.*

## Table of Contents

1.0 Parks and Public Land.....	1
1.1 Legal and Regulatory Context .....	1
1.2 Methodology.....	1
1.3 Western Segment Parks and Public Land .....	1
1.4 Central Griffin Road Segment Parks and Public Land .....	4
1.5 Central SR 7/Broward Boulevard Segment Parks and Public Land .....	7
1.6 Eastern Segment Parks and Public Land .....	10

## List of Exhibits

Exhibit 1: Western Segment Parks and Public Land .....	1
Exhibit 2: Western Segment Parks and Public Land Map .....	3
Exhibit 3: Central Griffin Road Segment Parks and Public Land .....	4
Exhibit 4: Central Griffin Road Segment Parks and Public Land Map .....	6
Exhibit 5: Central SR 7/Broward Boulevard Segment Parks and Public Land .....	7
Exhibit 6: Central SR 7/Broward Boulevard Segment Parks and Public Land Map .....	9
Exhibit 7: Eastern Segment Parks and Public Land.....	10
Exhibit 8: Eastern Segment Parks and Public Land Map .....	11

*This page intentionally left blank.*

## 1.0 Parks and Public Land

### 1.1 Legal and Regulatory Context

The U.S. Department of Transportation Act of 1966, Section 4(f) prohibits the use of land from a significant publicly owned public park, recreation area, or wildlife and waterfowl refuge, or any significant historic site unless a determination is made that:

- There is no feasible and prudent alternative to the use of land from the property.
- The action includes all possible planning to minimize harm to the property resulting from such use.

### 1.2 Methodology

A database search was performed in January 2008, April 2010 and again in February 2012 to inventory all existing public lands within one-quarter mile of the study corridor, including community, neighborhood, urban use, county, and city parks. GIS data was retrieved from the City of Fort Lauderdale, Broward County, and the Florida Geographic Data Library (FGDL). These datasets were queried for one-quarter mile adjacency to the study corridor, and addresses were checked against parks information on Broward County, the City of Fort Lauderdale, the City of Plantation, and the City of Lauderdale's websites.

As the Study alignments have evolved and been modified, this report has been updated and revised to reflect parklands and recreation areas potentially affected by the addition of new study areas. Most of the parks are located on the east end of the study corridor, where the proposed transit route runs through a more suburban area and across several waterways. Amenities of the identified parks vary from boat ramps, basketball courts, and education facilities to small urban greenspaces with simple picnic areas.

### 1.3 Western Segment Parks and Public Land

Three park areas were identified immediately surrounding the Western Segment. All three are located on the west side of Hiatus Road with the largest, Markham Park, located on the edge of the Everglades. Despite its large size, only a small portion of Markham Park falls within the study corridor. The park is located on the west side of the Sawgrass Expressway, and would not be impacted by the proposed alignment. Exhibit 1 lists the parks and public land in the Western Segment, while Exhibit 2 shows their locations.

#### Exhibit 1: Western Segment Parks and Public Land

Map ID Number	Park Name	Address	Managing Agency	Acres	Adjacency to Corridor?
17	Markham Park	16001 W SR 84, Sunrise	Broward County	670	No
19	Melaleuca Isles	12500 SW 2nd St, Plantation	City of Plantation	0.2	No
23	Plantation Acres South Park (Tara Park)	11600 Tara Dr, Plantation	City of Plantation	3.8	Yes

Source: Broward County, the City of Fort Lauderdale, FGDL, and Quest Ecology, 2012.

*This page intentionally left blank.*



Exhibit 2: Western Segment Parks and Public Land Map

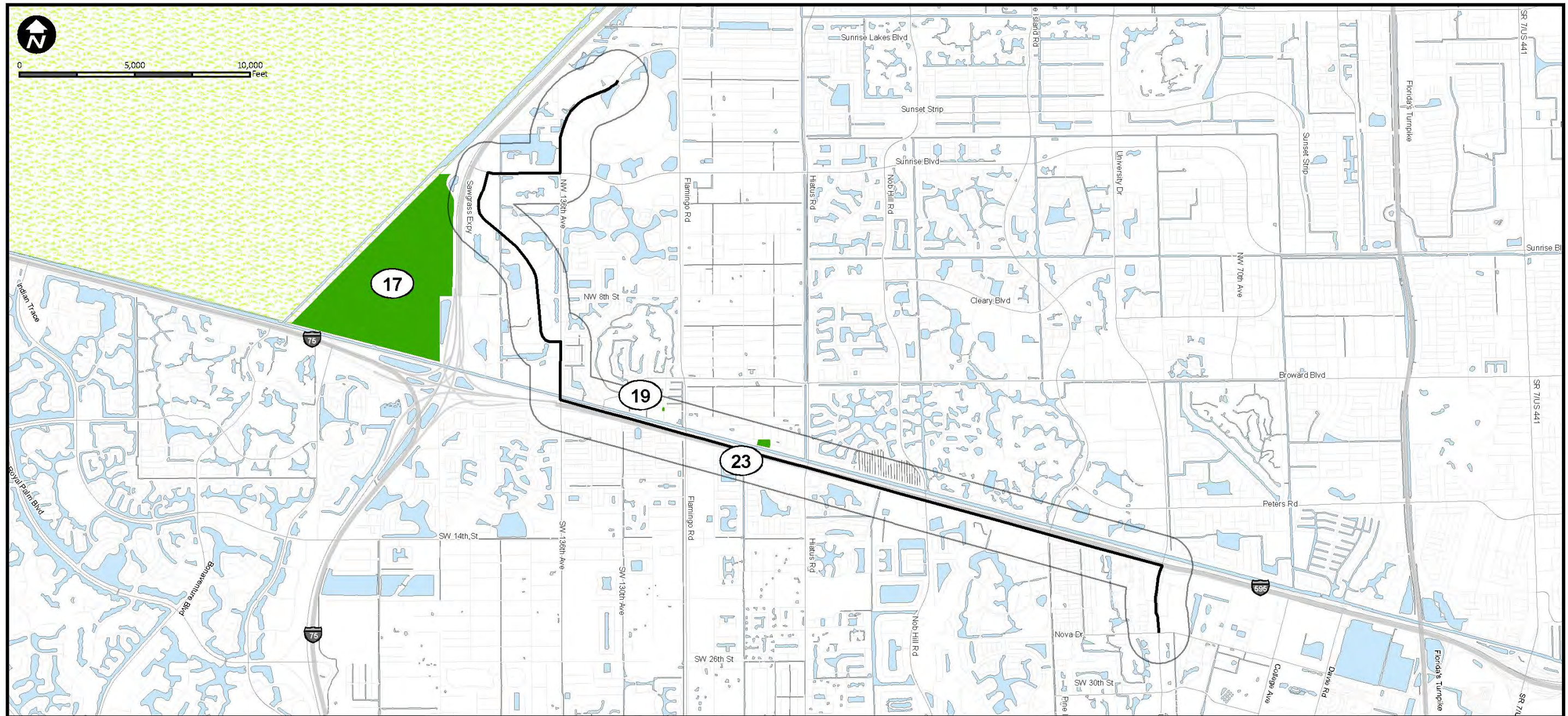

**Legend**

Alignment	Water
Broward County Major Roads	Everglades
Interstate/Toll Road	Parks and Public Land
Railroad	
Quarter-Mile Buffer	

\* Data taken from Ft. Lauderdale GIS, Broward County GIS, Florida Geographic Data Library, and Quest Ecology.



## 1.4 Central Griffin Road Segment Parks and Public Land

Eleven park areas were identified immediately surrounding the Central Griffin Road Segment. Most of these are relatively centrally located within the segment, and are found along both sides of Griffin Road. The two exceptions to this pattern are Wes Griffin Park Playground, located just north of Nova Drive, and Tigertail Park, located south of where Griffin Road crosses the CSX Rail Corridor. Exhibit 3 lists the parks and public land in the Central Griffin Road Segment, while Exhibit 4 shows their locations.

**Exhibit 3: Central Griffin Road Segment Parks and Public Land**

Map ID Number	Park Name	Address	Managing Agency	Acres	Adjacency to Corridor?
2	Bergeron Rodeo Grounds	4271 Davie Rd, Davie	Town of Davie	22.2	No
3	Betty Booth	4200 SW 61 <sup>st</sup> Ave, Davie	Town of Davie	5	No
14	Lange Park	6550 SW 47 <sup>th</sup> St, Davie	Town of Davie	3.2	No
16	Linear Park (C-11 Canal)	12300 Orange Drive, Davie	Town of Davie	6.6	Yes
26	Pond Apple Slough South	4100 Griffin Rd, Fort Lauderdale	Broward County	20.3	Yes
27	Potter Park	4300 SW 57 <sup>th</sup> Terrace, Davie	Town of Davie	2.7	No
34	South Fork Canoe Launch	SR 7, Dania Beach	Broward County	0.8	No
36	Sunny Lake Bird Sanctuary	5300 Griffin Rd, Davie	Town of Davie	16.6	Yes
39	SW 36th Court Park	SW 36 <sup>th</sup> Court, Davie	Town of Davie	0.3	Yes
41	Tigertail Park	580 Gulfstream Way, Dania Beach	City of Dania Beach	33.7	Yes
44	Wes Griffin Park Playground	2300 SW 71 <sup>st</sup> Terrace, Davie	Town of Davie	3.8	No

Source: Broward County, the City of Fort Lauderdale, FGDL, and Quest Ecology, 2012.



*This page intentionally left blank.*

Exhibit 4: Central Griffin Road Segment Parks and Public Land Map

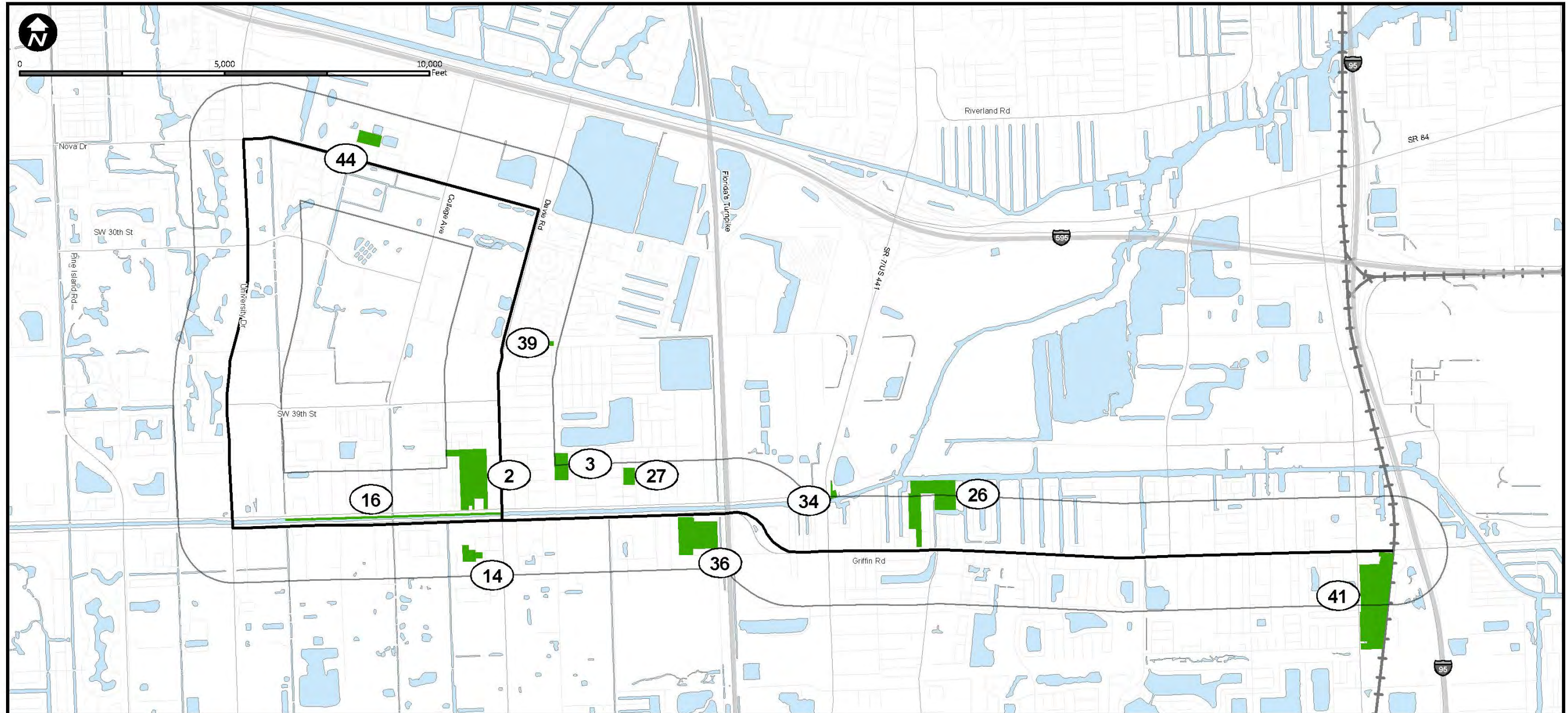

**Legend**

- Alignment
- Broward County Major Roads
- Interstate/Toll Road
- Railroad
- Quarter-Mile Buffer
- Water
- Parks and Public Land

\* Data taken from Ft. Lauderdale GIS, Broward County GIS, Florida Geographic Data Library, and Quest Ecology.

## 1.5 Central SR 7/Broward Boulevard Segment Parks and Public Land

Ten park areas were identified immediately surrounding the Central SR 7/Broward Boulevard Segment. These are found in three main areas along the corridor: the first being north of Nova Drive and west of Davie Road, the second on both sides of SR 7 south of Davie Boulevard, and the third on both sides of Broward Boulevard east of SW 31<sup>st</sup> Avenue. Pond Apple Slough, located to the southwest of the I-595/SR 7 interchange is another large park that falls only slightly within the study corridor, and would consequently not be impacted by the proposed alignment. Exhibit 5 lists the parks and public land in the Central SR 7/Broward Boulevard Segment, while Exhibit 6 shows their locations.

**Exhibit 5: Central SR 7/Broward Boulevard Segment Parks and Public Land**

Map ID Number	Park Name	Address	Managing Agency	Acres	Adjacency to Corridor?
4	Boulevard Gardens Park	313 NW 28th Terrace, Fort Lauderdale	Broward County	1	No
6	Civic Peoples Park	3781 SW Riverland Rd, Fort Lauderdale	City of Fort Lauderdale	2.5	No
8	Delevoe Park	2520 NW 6th St, Fort Lauderdale	Broward County	36	No
12	Guthrie-Blake Park	2800 SW 1st Ave, Fort Lauderdale	City of Fort Lauderdale	1.4	No
25	Pond Apple Slough	<i>No address available</i>	Broward County	229.2	No
28	Riverland Woods	3950 Riverland Rd, Fort Lauderdale	City of Fort Lauderdale	4.9	Yes
31	Sewell Lock	Davie Rd, Plantation	Broward County	4.2	No
37	Sunset School/Park	3775 SW 16th St, Fort Lauderdale	City of Fort Lauderdale	12.9	No
38	Sunview Park	1500 SW 42nd St, Fort Lauderdale	Broward County	21.3	No
44	Wes Giffin Park Playground	2300 SW 71st Terrace, Davie	Town of Davie	3.8	No

Source: Broward County, the City of Fort Lauderdale, FGDL, and Quest Ecology, 2012.

*This page intentionally left blank.*



Exhibit 6: Central SR 7/Broward Boulevard Segment Parks and Public Land Map

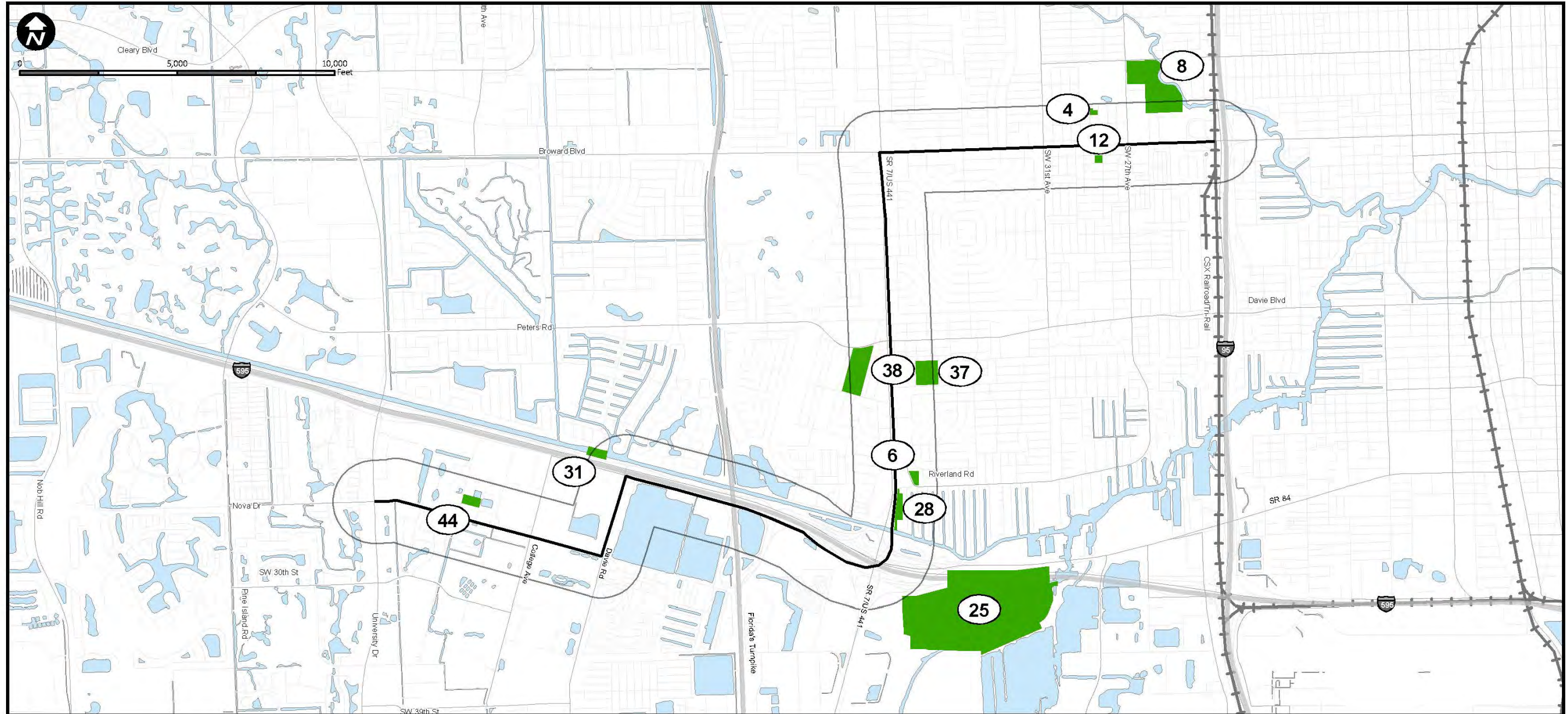

**Legend**

- Alignment
- Broward County Major Roads
- Interstate/Toll Road
- Railroad
- Quarter-Mile Buffer
- Water
- Parks and Public Land

\* Data taken from Ft. Lauderdale GIS, Broward County GIS, Florida Geographic Data Library, and Quest Ecology.

## 1.6 Eastern Segment Parks and Public Land

Twenty-two park areas were identified immediately surrounding the Eastern Segment. This is by far the segment with the most parks and public land. The majority of these are located in the northern part of the segment, in or around downtown Fort Lauderdale. Although fewer parks are located south of SR84, the parks that are found here are much bigger due to the less dense development patterns allowing for more open space. Exhibit 7 lists the parks and public land in the Eastern Segment, while Exhibit 8 shows their locations.

**Exhibit 7: Eastern Segment Parks and Public Land**

Map ID Number	Park Name	Address	Managing Agency	Acres	Adjacency to Corridor?
1	Aviation Greenspace	SW Perimeter Rd, Dania Beach	Broward County	30.1	Yes
5	Bryant Peney Park	2200 SW 4 <sup>th</sup> Ave, Fort Lauderdale	City of Fort Lauderdale	0.6	Yes
7	Croissant Park	1800 SW 4th Ave, Fort Lauderdale	City of Fort Lauderdale	16	Yes
9	Esplanade Park	201 SW 2nd St, Fort Lauderdale	City of Fort Lauderdale	2.5	No
10	Florence C. Hardy Park	25 SW 9th Ave, Fort Lauderdale	City of Fort Lauderdale	7.9	Yes
11	Floyd Hull Stadium	2800 SW 8 <sup>th</sup> Ave, Fort Lauderdale	City of Fort Lauderdale	10.9	No
13	Huizenga Park	32 East Las Olas Blvd, Fort Lauderdale	City of Fort Lauderdale	1.9	No
15	Las Olas Riverfront	20 N New River Dr, Fort Lauderdale	City of Fort Lauderdale	9.1	Yes
18	Marshall Point (New River Dockage)	14 S New River Dr East, Fort Lauderdale	City of Fort Lauderdale	1.1	No
20	North Fork River Front Park	200 NW 18th Ave, Fort Lauderdale	City of Fort Lauderdale	2	No
21	North Fork School/Park	101 SW 15th Ave, Fort Lauderdale	City of Fort Lauderdale	11.5	Yes
22	Northside Melaleuca Park	850 NW 10 <sup>th</sup> St, Dania Beach	City of Dania Beach	0.4	Yes
24	Poinciana Park	400 SE 21st St, Fort Lauderdale	City of Fort Lauderdale	1.8	No
29	Riverwalk Linear Park	20 N New River Dr, Fort Lauderdale	City of Fort Lauderdale	9.1	No
30	Sailboat Bend Preserve	1401 SW 2nd Ct, Fort Lauderdale	City of Fort Lauderdale	2.3	No
32	Smoker Park	500 S New River Dr, Fort Lauderdale	City of Fort Lauderdale	1.8	No
33	Snyder Park	3299 SW 4 <sup>th</sup> Ave, Fort Lauderdale	City of Fort Lauderdale	91.3	Yes
35	Stranahan Park	10 E Broward Blvd, Fort Lauderdale	City of Fort Lauderdale	1.3	Yes
40	Tarpon River Park	50 SW 11th Ct, Fort Lauderdale	City of Fort Lauderdale	0.9	Yes
41	Tigertail Park	580 Gulfstream Way, Dania Beach	City of Dania Beach	33.7	Yes

Map ID Number	Park Name	Address	Managing Agency	Acres	Adjacency to Corridor?
42	Townsend Park	1400 Argyle Dr, Fort Lauderdale	City of Fort Lauderdale	0.8	No
43	Welcome Park	2402 S Federal Hwy, Fort Lauderdale	City of Fort Lauderdale	2	No

Source: Broward County, the City of Fort Lauderdale, FGDL, and Quest Ecology, 2012.



Exhibit 8: Eastern Segment Parks and Public Land Map

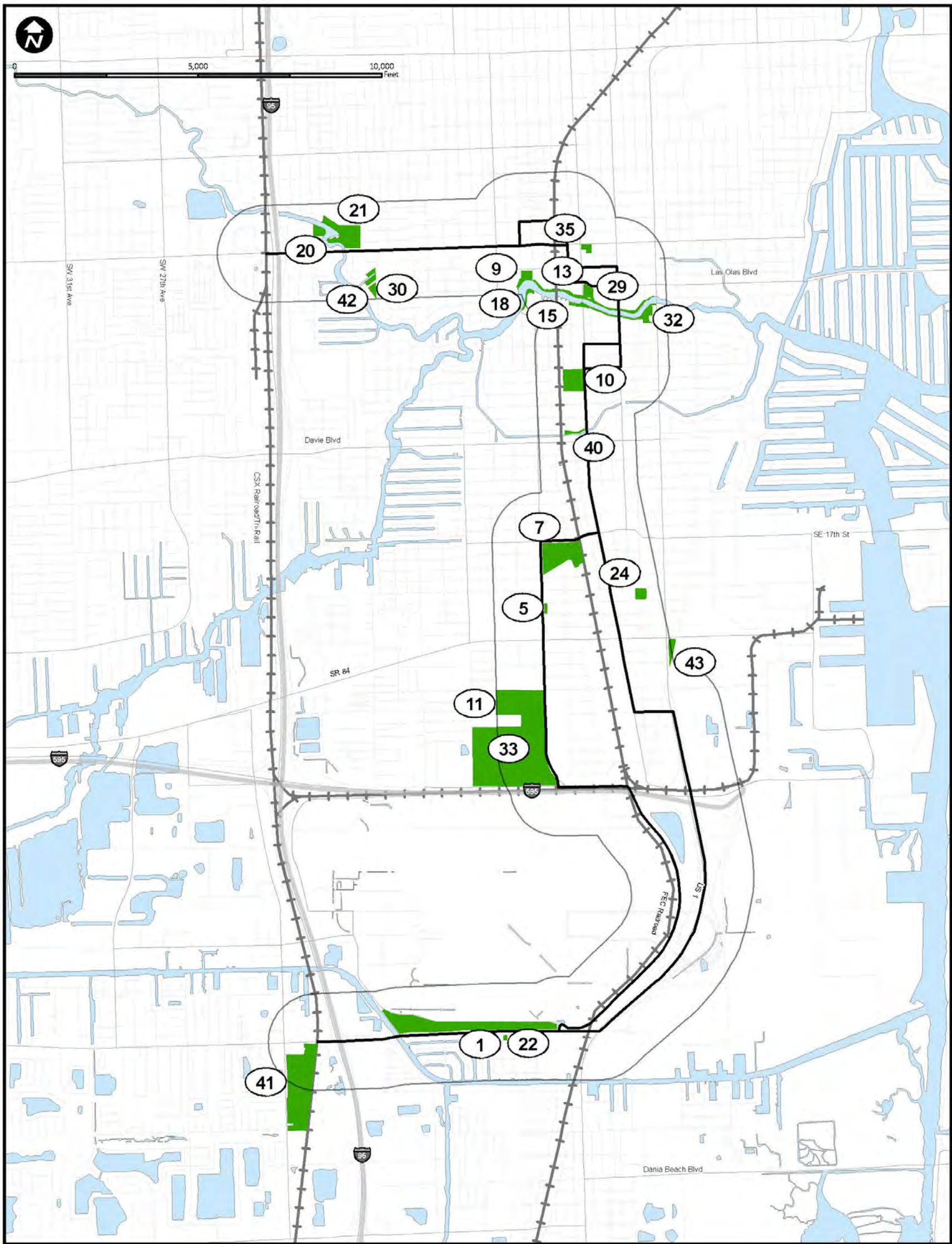

**Legend**

- Alignment
- Broward County Major Roads
- Interstate/Toll Road
- Railroad
- Quarter-Mile Buffer
- Parks and Public Land

\* Data taken from Ft. Lauderdale GIS, Broward County GIS, Florida Geographic Data Library, and Quest Ecology.