

October 28-29, 2025

Orlando, FL



**TRANSPORTATION
SYMPOSIUM**

S.R. 426 Community Engagement



Mark Trebitz, P.E. (FDOT – District 5)
Catalina Chacon, P.E. (FDOT – District 5)
Nick Harrison, P.E. (American Structure Point)

Transportation Symposium
Website



1

Agenda

- Project Background & Location
- Project Purpose & Goals
- Coalition Phase
- Design Phase
- Construction Phase

**TRANSPORTATION
SYMPOSIUM**

2

2

FDOT Compass

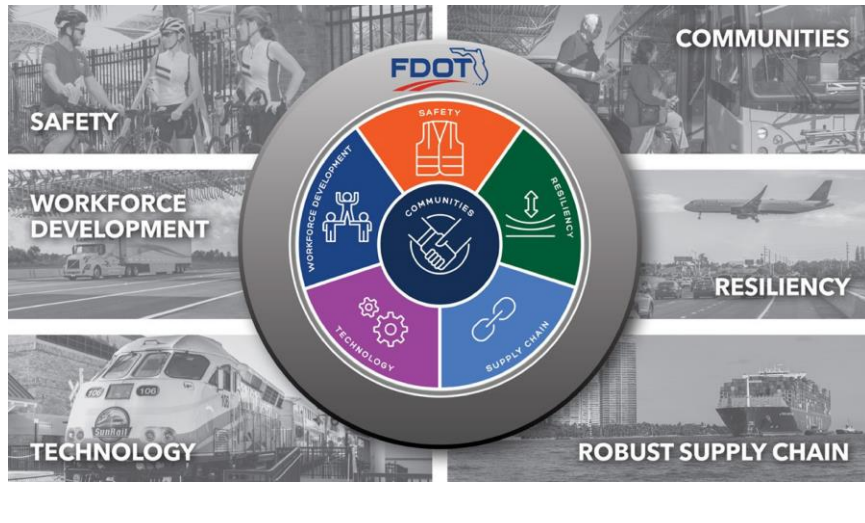

TRANSPORTATION
SYMPOSIUM

3

3

Project Background & Location

S.R. 426 from west of S. Park Avenue to east of N. Lakemont Avenue



- 1.7 Miles
- C5/C4 Context
- 35 MPH
- 40,000 AADT

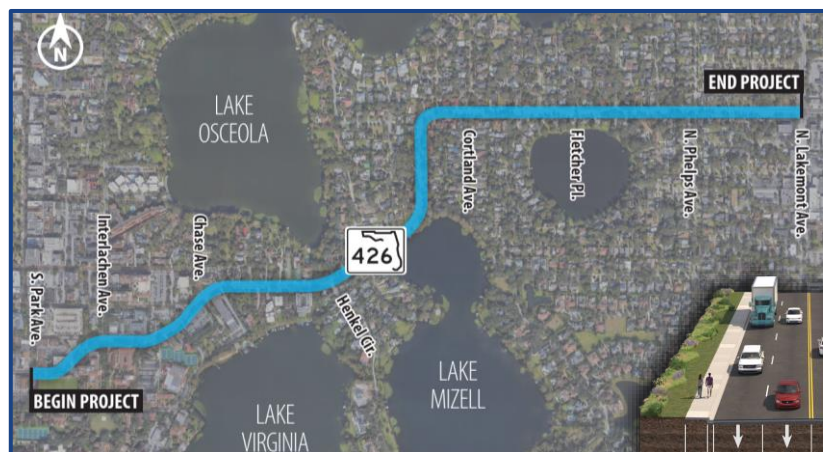

RRR: FY24 Design / FY26 Construction



4

4

Project Purpose & Goals

- **PURPOSE:** To evaluate a variety of factors including safety, pedestrian and bicyclist travel, speed management, and traffic operations.



Safety



Speed Management



Pedestrian & Bicyclist Travel



Traffic Operations

- **GOALS:** The goal of this RRR project was to rehabilitate the pavement while incorporating improvements within the existing right of way that will increase safe travel along the corridor for all users.

*Improve Mobility
for All Users*

*Reduces Crashes
& Speeding*

*Improve Safety
for All Users*

5

5

Coalition Phase

RRR PROJECT DEVELOPMENT PROCESS

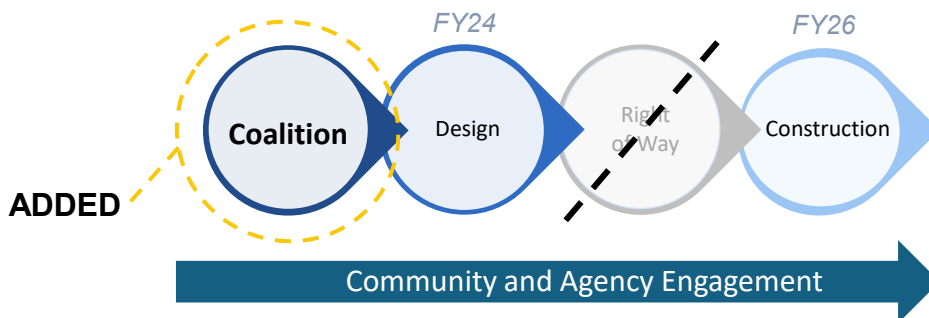

TRANSPORTATION
SYMPOSIUM

COALITION PHASE

6

6

What is a Coalition?



Improvements Incorporated into a Resurfacing Project (RRR)



Focused on Community Engagement



Implementation of Safety Improvements



Design and Construction Phases were Already Funded for this Coalition

TRANSPORTATION
SYMPOSIUM

COALITION PHASE

7

7

Project Visioning Team

Government Partners

City of
Winter
Park

MetroPlan
Orlando

FDOT

LYNX

Orange
County

Community Partners

Fix426

Winter Park
Chamber of
Commerce

Advent
Health

Rollins
College

Windsong
HOA

Lake
Virginia
Condo
Board

Park
Avenue
District

All Saints
Episcopal
Church

Polasek
Museum

The
Woman's
Club of
Winter Park

TRANSPORTATION
SYMPOSIUM

COALITION PHASE

8

8

Coalition Tools

Meetings, Lots of Meetings:

Proactively Engage

Involve Early

Seek Input

Gain Champions

- Facilitate Partnering - *Bring community into the project team*
- Discussion and collaboration
- Manage expectations
- Transparency in process and decisions
- Build Trust
- Gain project champions
- Achieve Consensus



IN-PERSON

**TRANSPORTATION
SYMPOSIUM**

COALITION PHASE

9

9

Coalition Tools

Materials & Methods:

Proactively Engage

Involve Early

Seek Input

Gain Champions

- PowerPoints
- Roll plots with Sticky Notes
- 3D renderings & videos
- Example project lists & infographic handouts
- Project brochures
- Icon concept boards & Palette Boards
- Photo realistic concept boards
- Before & after renderings
- Getting the community involved & informed
 - Post card mailer invitations
 - Social media
 - Leveraging partner communications
 - Flyers
 - Newspaper Ads



COALITION PHASE

10

10

Continuous Involvement

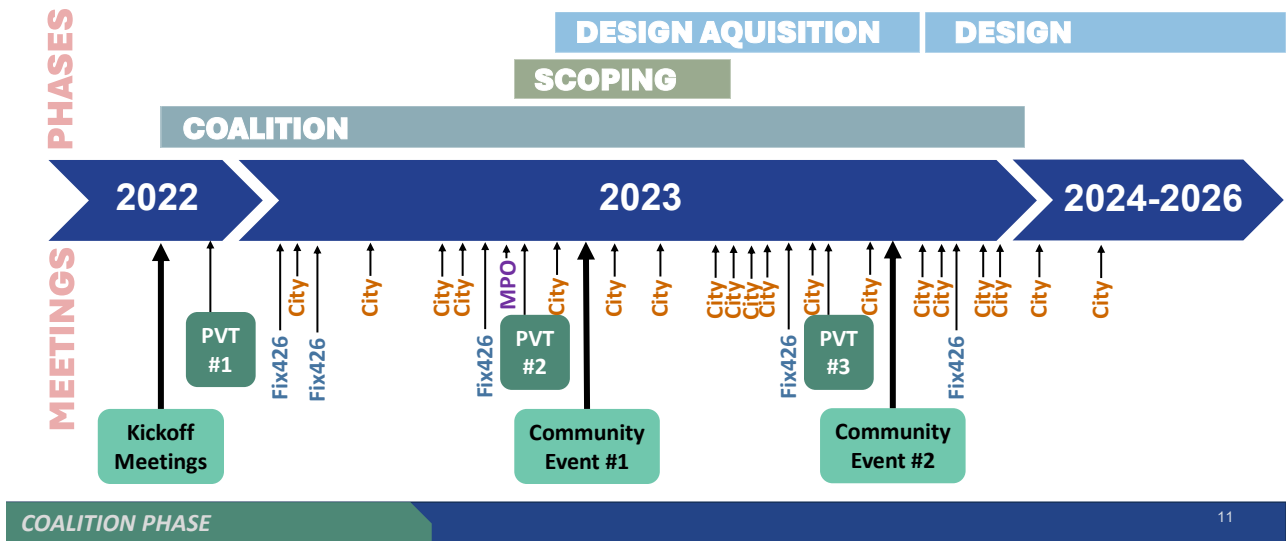

11

Listening & Building Trust

Kick-off Meetings:

LISTENING

- Listening Session
- Understand community concerns
- Goals for corridor
- Existing conditions review
- Corridor issues & opportunities brainstorming
- Who should be involved?
- FDOT process and next steps

PVT Meeting #1

INPUT

- What is a Coalition & PVT
- PVT role
- What we've heard on issues/needs
- Existing conditions
- Initial safety / traffic / speed
- Palette of potential solutions toolbox



12

Listening & Building Trust

Kick-off Meetings:

PVT Meeting #1

WHAT WE HEARD + ENGINEERING FINDINGS



TRANSPORTATION
SYMPOSIUM

COALITION PHASE

13

13

Listening & Building Trust

Kick-off Meetings:

PVT Meeting #1

PVT LED PROJECT PRIORITIES

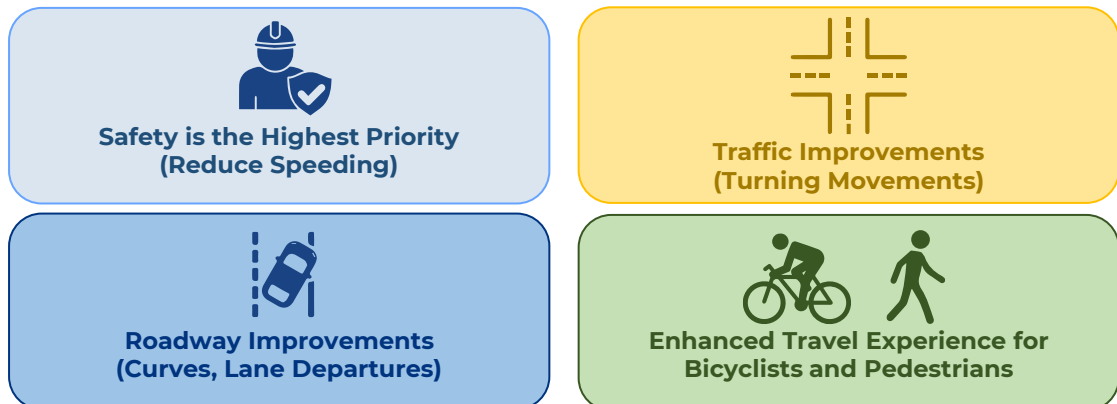

COALITION PHASE

14

14

Developing Solutions Together

PVT #2:

COLLABORATING

- Review project goals
- Review issues/ needs identified
- Investigation of solutions
 - *Speed Management*
 - *Bike / Ped Improvements*
 - *Safety Improvements*
 - *Extra Items:*
 - Signal Warrant Analysis
 - Lane Reduction Scenarios

Opportunities Toolbox

Issues to Address	Traffic Calming/Speed Reduction	Curve Safety	Bicycle, Pedestrian, Transit	Safer Turning Movements
Viable Countermeasures	<ul style="list-style-type: none"> » Raised Intersections » Lower posted speed limit » Curvature of the roadway » Speed tables » Narrower lanes » Enhanced signage » Alert lighting » Landscaping in medians » In-lane speed markings 	<ul style="list-style-type: none"> » Dynamic curve system » Angled lane markings » Narrow medians » Rumble strips » Internally illuminated raised pavement markers » Barriers through curves » In-lane pavement markings 	<ul style="list-style-type: none"> » Raised, mid-block crossings with pedestrian signals » Tightened turn radii » Pedestrian barrier wall through curves » High visibility crosswalks » Shorter pedestrian crossing length » Slip lane elimination at Chase Ave » Bus stop markings 	<ul style="list-style-type: none"> » New turn lane at Phelps Ave » Traffic signal timing improvements » Increased turn lane length at N. Lakemont Ave » Signal backplates » Advance warning signage at Henkel Cir » Landscape maintenance to improve visibility

COALITION PHASE

15

15

Developing Solutions Together

PVT #2:



TRANSPORTATION SYMPOSIUM

COALITION PHASE

16

16

Community Feedback & Input

Community Event #1

FEEDBACK

- Maximize outreach / invitations
- Open house workshop style (*in-person & virtual*)
 - 2 Alternatives
 - Looping presentation
 - Project boards + roll plots
- Brochure & infographic handouts
- Comments (written / post its)

120 Attendees
53 Comments



17

Community Feedback & Input

Community Event #1



West Section Alternative 2

East Section Alternative 1



Feedback:

Speeding

Sidewalk safety

Lane departures

SAFETY ISSUES

Input on Ped crossing locations

More signalized intersections

Liked proposed features

Favor Alt #1

COALITION PHASE

18

Refinement & Optimization

PVT #3:

COLLABORATING

- Consider & include community input
- Refinement/optimization of Alternative #1
- Considerations for project cost
- Maintenance discussions
- Designability/constructability check



COALITION PHASE

19

19

Refinement & Optimization

PVT #3:

Consensus Through Dialogue:

- **Community Wanted:** Safer Bike and Pedestrian Travel
- **Physical Constraints:** Lack of Additional Right of Way
- **Resolution:** Improving bicycle and pedestrian crossing across S.R. 426
 - Leading Pedestrian Intervals at existing signals
 - Raised Crosswalks
 - Pedestrian Hybrid Beacons
 - Concrete barrier in curves separating sidewalk

Existing Typical Section

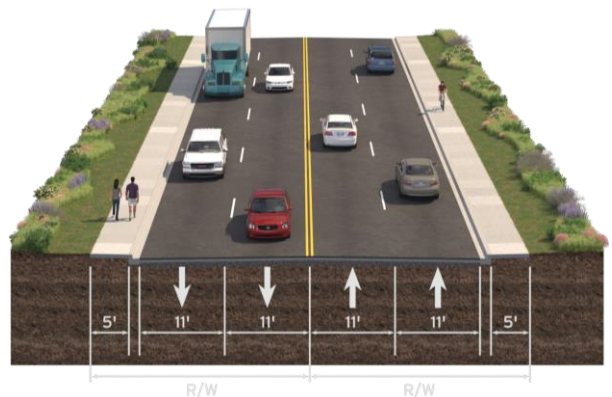

TRANSPORTATION
SYMPOSIUM

COALITION PHASE

20

20

Refinement & Optimization

PVT #3:

Consensus Through Dialogue:

- **Community Wanted:** Dedicated Left Turn Lane at N. Phelps Ave.
- **Constraints:** Only possible if all lane widths were reduced
- **Community Desire:** Do not reduce lane widths
- **Resolution:** Left turn lane not added, but intersection safety enhancements were provided:
 - Raised intersection to slow speeds
 - High visibility crosswalks and leading pedestrian intervals for bike/ped safety
 - Signal backplates to improve visibility



TRANSPORTATION
SYMPOSIUM

COALITION PHASE

21

21

Refinement & Optimization

PVT #3:

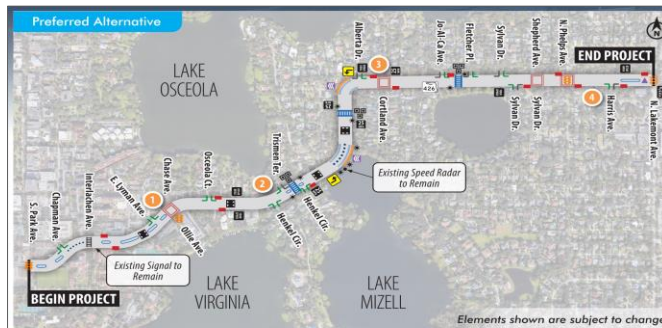

- Existing Median
- Dynamic Curve Warning System
- Raised Crosswalk with Pedestrian Hybrid Beacon & Advanced Signage
- Raised Crosswalk
- Posted Speed Sign
- Add/Extend Median
- Raised Intersection with High Visibility Crosswalks
- Tighten Curb Returns and add High Visibility Crosswalks
- Existing Curb Return to Remain
- Add Leading Pedestrian Interval & Signal Backplates
- Speed Radar Sign
- Add Left Turn Lane
- Pedestrian Barrier Wall (on Curb Line)
- In-Lane Curve Advisory Markings
- Internally Illuminated Raised Pavement Markers
- Lighting Upgrade/Roadway Light
- In-lane Markings at Existing Bus Stop Locations
- Raised Speed Table
- Turning Vehicles Stop for Pedestrians Sign

Preferred Alternative Renderings



COALITION PHASE

22

22

Continued Community Feedback & Input

Community Event #2

FEEDBACK

- Maximize outreach / invitations
- Open house workshop style (*in-person & virtual*)
 - 1 Preferred Alternative
 - Looping presentation
 - Project boards + roll plots
- Brochure & infographic handouts
- Comments (written / post its)



64 Attendees
13 Comments



23

Continued Community Feedback & Input

Community Event #2

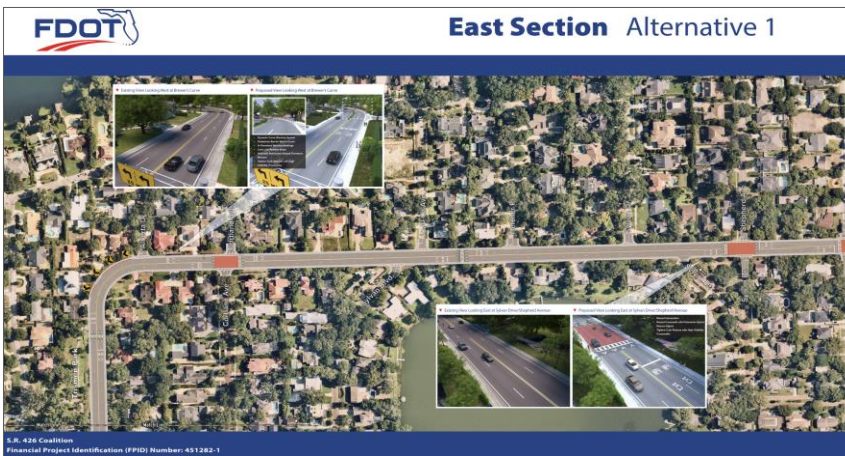

Feedback:

Accelerate project delivery
Landscaping
Like reduced speed
Like concrete ped barriers
Input on Ped crossing locations
Liked proposed features
Like medians
Like raised crossings & intersections
Like dynamic curve system
Support for PHBs
Like speed feedback signs
Lighting in curves

COALITION PHASE

24

Partnering with Design

Setting up for Success

- **Risk Management for Design:** *Scope, Schedule, Budget*
 - Community/Partner Consensus
 - Deeper dive into designability/constructability in Coalition
 - Cost estimates & programmed funds
 - Commitment Letters (*maintenance, financial*)
- **Documentation:**
 - Tech memos on decisions, design decisions meeting summaries, notes to PM, commitments, design recommendations, items investigated and not moving forward

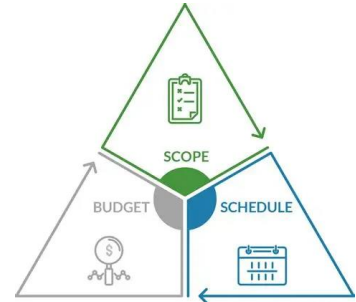

TRANSPORTATION
SYMPOSIUM

COALITION PHASE

25

25

Passing the Torch

Seamless Integration & Continuity

- **Identify Design PM early** - involve them in key meetings (continuation of relationships, key discussions)
- **Expedite Delivery** - overlap with design phase to expedite delivery and ensure continuity of engagement with community
- **Pass the Torch Meetings:**
 - With Design PM
 - With the Technical Review Committee (TRC) prior to acquisition (**prior to Ad*)
 - With Design consultant once on board but prior to scope/units/staff hour negotiations

TRANSPORTATION
SYMPOSIUM

COALITION PHASE

26

26

Passing The Torch

COALITION

DESIGN

Continued Engagement, Communication & Relationships

TRANSPORTATION
SYMPOSIUM

DESIGN PHASE

27

27

Turning Concepts into Construction Plans

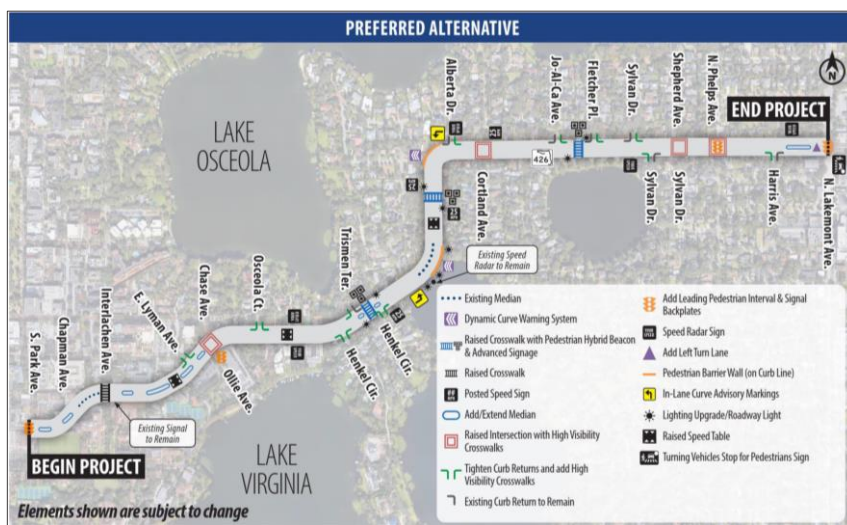

TRANSPORTATION
SYMPOSIUM

DESIGN PHASE

28

28

Items Addressed in Design

- Raised Crosswalk Detail
 - Field testing
 - Previous District projects
 - Dev. Std. Plan D520-030

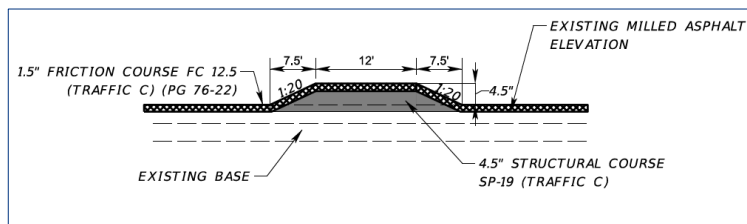
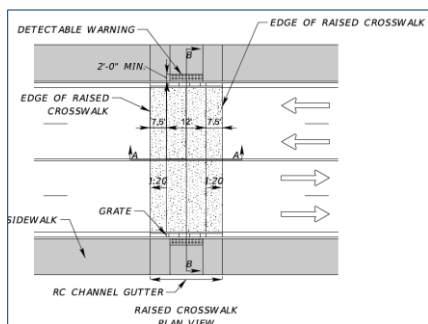

TRANSPORTATION
SYMPOSIUM

DESIGN PHASE

29

29

Items Addressed in Design

- Raised Crosswalk Location
 - Maintained general locations per coalition report
 - Worked with City to avoid conflict with adjacent City project
 - Shifted to reuse existing lighting



TRANSPORTATION
SYMPOSIUM

DESIGN PHASE

30

30

Items Addressed in Design

- Raised Intersection Detail
 - FDM 202.3.8.1 added in 2025; design variation required due to design speed
 - No FDOT Standard
 - Drainage & RC Channel Gutter limitations

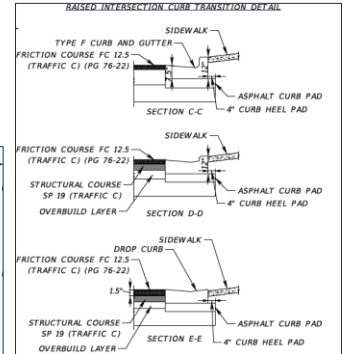
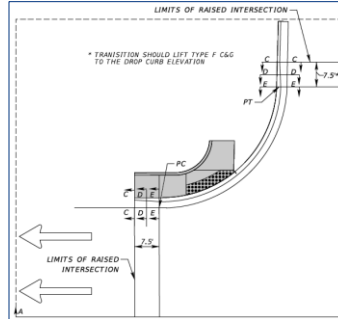

TRANSPORTATION
SYMPOSIUM

DESIGN PHASE

31

31

Items Addressed in Design

- Pedestrian Barrier Wall
 - Approval to use Standard Plan 521-001
 - Future painting by City

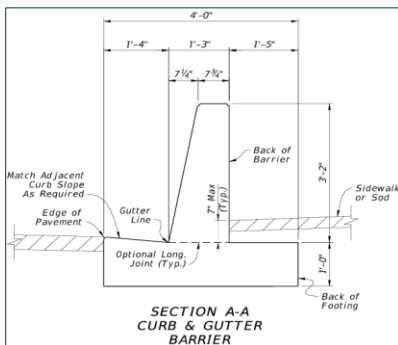

TRANSPORTATION
SYMPOSIUM

DESIGN PHASE

32

32

Items Addressed in Design

- The “Wall”
 - Collapsed early in the design phase, posed safety concern
 - Temporarily fixed and permanent fix became a part of the design project
 - Right-of-Way determination
 - Property owner and City coordination



TRANSPORTATION
SYMPOSIUM

DESIGN PHASE

33

33

Items Addressed in Design

- Temporary Traffic Control
 - Pedestrian detours
 - Lane closure periods
 - Mid-Block crossings
 - Point of emphasis for continued public engagement

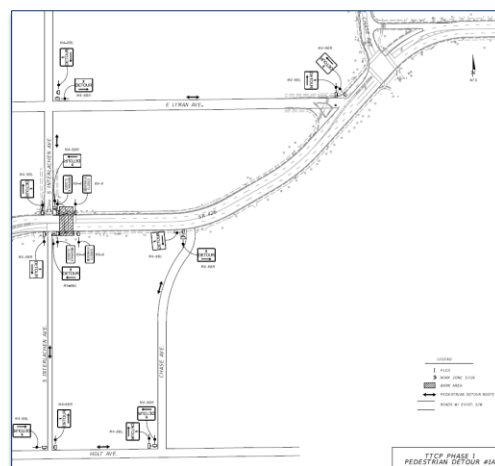

TRANSPORTATION
SYMPOSIUM

DESIGN PHASE

34

34

Continued Community Feedback & Input

Design Open House Public Meeting

- 118 in-person attendees
- 12 online attendees
- Planning & Design team representatives
- Consistent messaging between planning and design

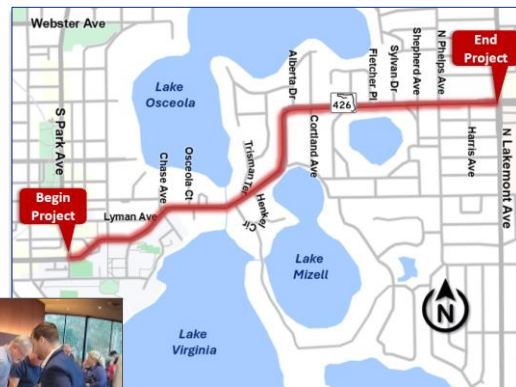

TRANSPORTATION
SYMPOSIUM

DESIGN PHASE

35

35

Continued Community Feedback & Input

Design Open House Public Meeting

- 38 comments received
- Majority positive response
- Primary concerns:
 - Adjacent City project signal
 - Signal timing
 - Turning movements from side roads
 - Reducing speeds
 - Wider sidewalks



DESIGN PHASE

36

36

Continued Community Feedback & Input

Design Open House Public Meeting

- Reinforce message from planning study
- Construction information:
 - Daytime and nighttime work
 - Nighttime lane closures
 - Maintaining access to property
 - Side road detours
- Schedule:
 - Letting and estimated construction duration



**TRANSPORTATION
SYMPOSIUM**

DESIGN PHASE

37

37

Additional Outreach

- City of Winter Park
 - City Commission presentation:
 - Used public meeting materials
 - Reviewed final design concept
 - Answered questions
 - Coordination with Staff:
 - Several virtual and in-person meetings
 - Local Funding Agreement
 - License Agreement



City Commission

agenda item
2.a

item type Discussion Item (s)	meeting date March 27, 2025
prepared by Hongmyung Lim, Engineer II	approved by Randy Knight, City Manager
subject SR 426 (Fairbanks Ave) from S. Park Ave to N. Lakemont Ave	
motion recommendation	
background This City Commission Work Session is to provide an overview of the final concepts that are currently in the design phase of the Florida Department of Transportation's (FDOT) State Road (SR) 426 resurfacing project. FDOT staff will be presenting this project at this work session and will answer any questions that the Commission may have.	
alternatives other considerations	
fiscal impact	
attachments 1. SR 426 Safety Improvements Icon Map 2. SR 426 Safety Improvements Roll Plot Bird View 3. SR 426 Safety Improvements Roll Plot Bird East 4. SR 426 Safety Imp Renderings Bds_250129	

**TRANSPORTATION
SYMPOSIUM**

DESIGN PHASE

38

38

Additional Outreach

- **Property Owners:**
 - Driveway letters
 - License agreements
 - Coordinated communication including City, District Construction, and Design n
- **Utilities:**
 - Extensive coordination with UAOs to finalize UWS



**TRANSPORTATION
SYMPOSIUM**

DESIGN PHASE

39

39

Outreach Next Steps

- **Pass the Torch to Construction**
 - Agreements
 - Property owner concerns
- **Construction Project Open House**
 - Continuing consistent messaging
 - Planning, design, and construction team
 - When/How construction will affect the public - MOT
- **Coffee with Construction**

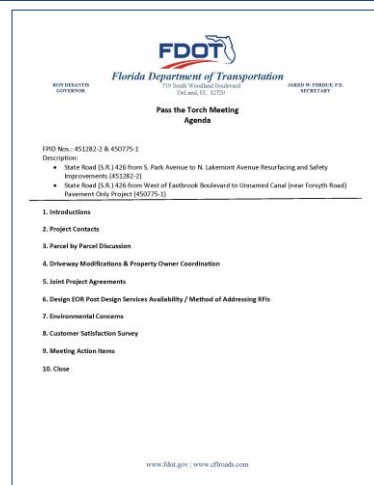

**TRANSPORTATION
SYMPOSIUM**

CONSTRUCTION PHASE

40

40

Safety Message



TRANSPORTATION
SYMPOSIUM

41

41

Contacts

- **Mark Trebitz, P.E.**
 - FDOT – District 5 – Intermodal Systems Development
 - Project Development Administrator
 - Phone: 386-943-5157
 - Email: mark.trebitz@dot.state.fl.us
- **Catalina Chacon, P.E.**
 - FDOT – District 5 – Consultant Project Management
 - District Consultant Project Management Engineer
 - Phone: 386.943.5039
 - Email: catalina.chacon@dot.state.fl.us
- **Nick Harrison, P.E.**
 - American Structure Point
 - Phone: 813-460-2622
 - Email: nharrison@structurepoint.com

What
Questions
Can We
Answer?

TRANSPORTATION
SYMPOSIUM

42

42