

**Origination Form**  
Proposed Revisions to a Standard Plans Index

<b>Originator:</b>	McGinnis, James	<b>Index Number:</b>	102-120
<b>Date:</b>	5/12/2026	<b>Sheet Number(s):</b>	2, 4, 5
<b>E-mail:</b>	James.McGinnis@dot.state.fl.us	<b>Index Title:</b>	Low Profile Barrier

**Summary of the changes:**

Sheet 2: Changed "Edge of Travel Way" callout to "Edge of Traffic Lane", Changed the "1'-2' " Dimension to a call out "Lateral Offset (See Table 1)", Added "(See Note 2)" to the Flexible or Rigid Pavement callout in the SETBACK DISTANCE AT DROP-OFFS detail; Updated the "Varies" dimension to "Lateral Offset (See Table 1)", Clarified the Tangent Extension dimension and added circle to denote point, to match Sheets 4 and 5, in the APPROACH END OFFSET detail; Added title "TABLE 1" to the Table .

Sheets 4 & 5: In all plan views, clarified the "Lateral Offset" distance between the Edge of Traffic Lane and the Tangent Extension Line per Sheet2.

**Commentary/Background:**

Districts advised that the details for "Barrier Openings at Driveways" did not show a large enough "Lateral Offset" distance between the Edge of Traffic Lane and barrier face, so this caused challenges interpreting the 6-foot measurement. These revisions will now clarify this concept by adding labels and showing the distances to scale.

Other Affected Documents/Offices	Person Contacted	Affected (Yes/No)
Other Standard Plans		No
FDOT Design Manual		No
Standard Specifications		No
Basis of Estimates Manual		No
Approved Product List		No
Construction Office		No
Maintenance Office		No

**Implementation**

["FY-Standard Plans (Next Release)"]

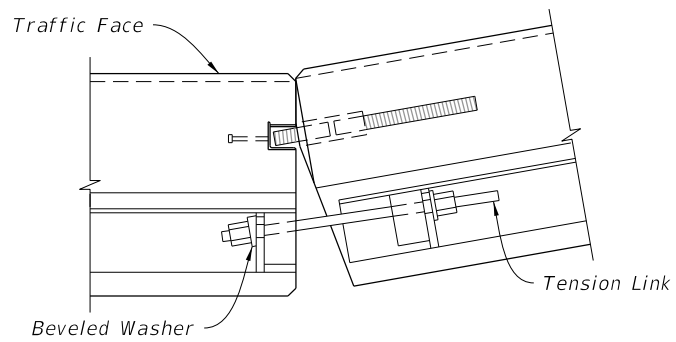

CONCAVE CONNECTION

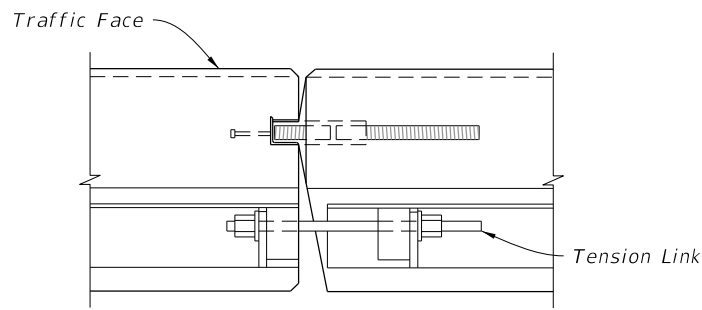

PARALLEL CONNECTION

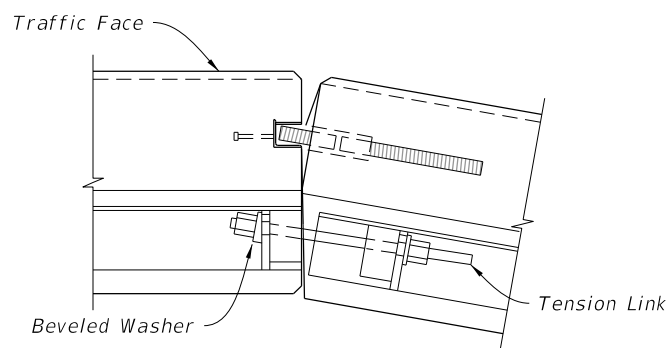

CONVEX CONNECTION

PLAN VIEWS OF CONNECTIONS

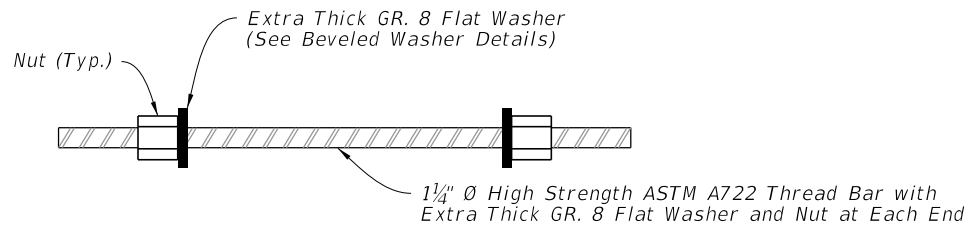

TENSION LINK DETAIL

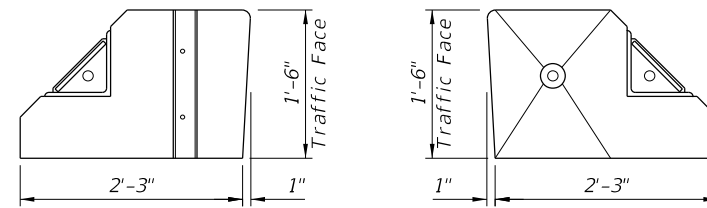

FLAT FACE FEMALE END

BEVELED FACE MALE END

END VIEWS

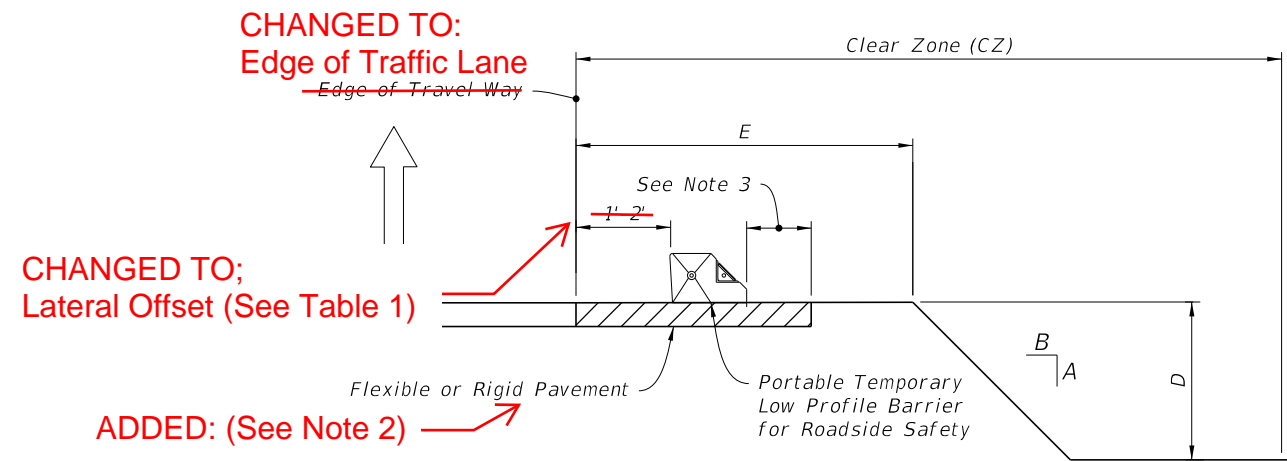

SETBACK DISTANCE AT DROP-OFFS

NOTES:

1. LIMITATION OF USE: This installation technique can only be used on flexible or rigid pavement.
2. ASPHALT PAD: Where existing pavement is not present, construct 2" Asphalt Pad using miscellaneous asphalt pavement in accordance with Specification 339 with the exception that the use of a pre-emergent herbicide is not required.
3. Minimum 9' on 1:10 or flatter slopes for 'Portable Temporary Low Profile Barrier For Roadside Safety.' For values A, B, D and E see Index 102-600.

SYMBOLS:

- Type I Object Marker
- ⇒ Direction of Traffic

ADDED TITLE: TABLE 1

WORK ZONE SPEED	LATERAL OFFSET	SETBACK DISTANCE
45 MPH OR LESS	1' MIN, 2' PREFERRED	9'

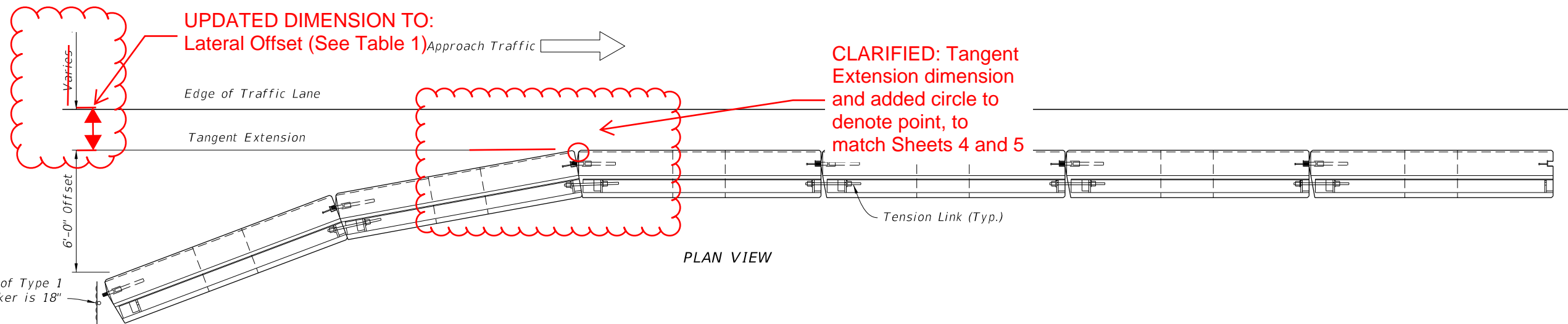

PLAN VIEW

APPROACH END OFFSET

9/26/2025 11:07:59 AM

LAST REVISION	DESCRIPTION:
11/01/25	
11/01/26	

2027-28

FY ~~2026-27~~  
STANDARD PLANS

LOW PROFILE BARRIER

INDEX	SHEET
102-120	2 of 5

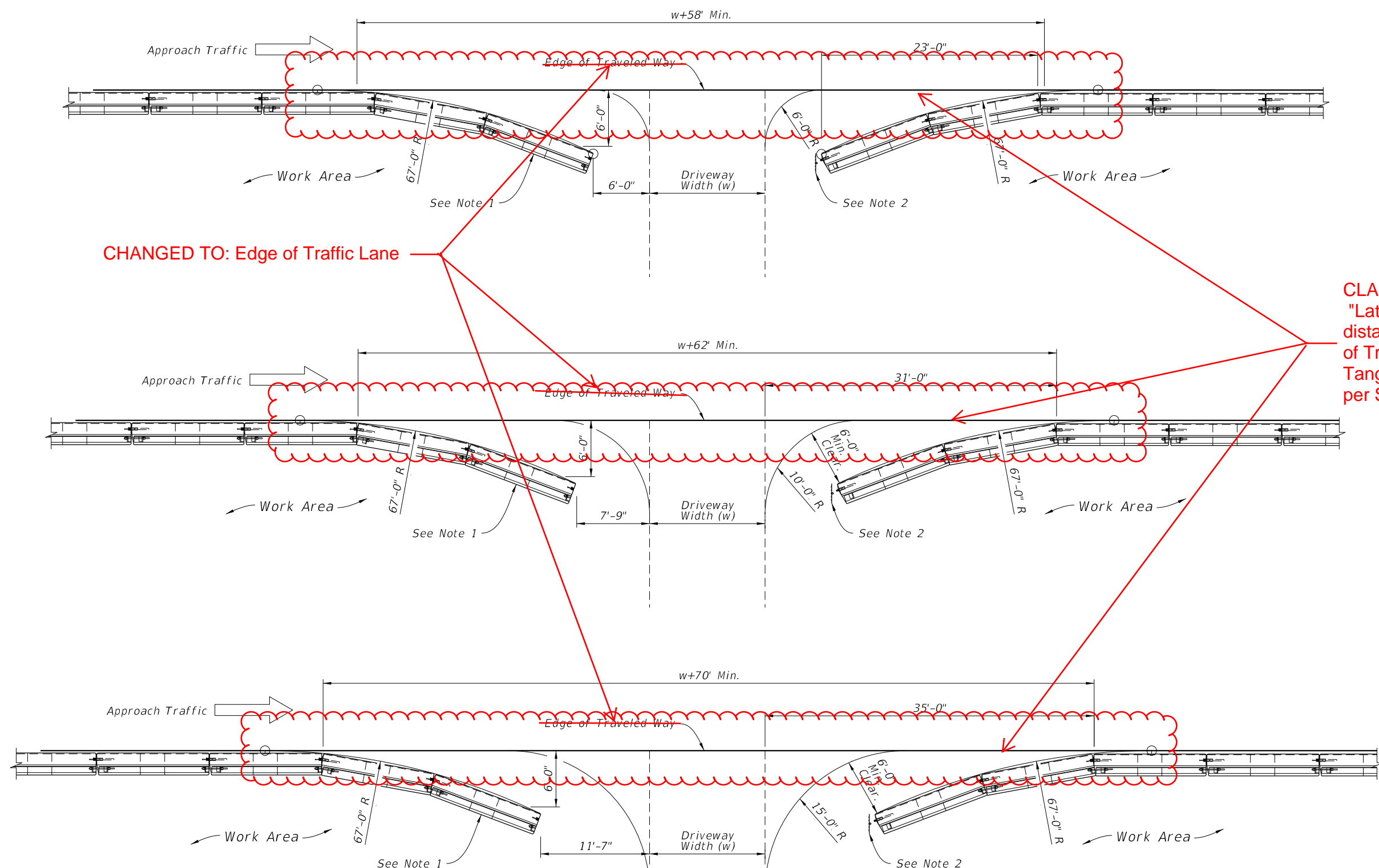

**NOTES:**

1. Trailing end flares are not required when barrier located outside the clear zone of opposing traffic.
2. Type I Object Marker to be installed when trailing end flare falls within the clear zone of opposing traffic.

**SYMBOLS:**

- Type I Object Marker
- Direction of Traffic

**BARRIER OPENINGS AT DRIVEWAYS**

**2027-28**



**FY ~~2026-27~~  
STANDARD PLANS**

**LOW PROFILE BARRIER**

**INDEX  
102-120**

**SHEET  
4 of 5**

9/26/2025 11:08:12 AM

LAST REVISION	DESCRIPTION:
<del>11/01/19</del>	
11/01/26	

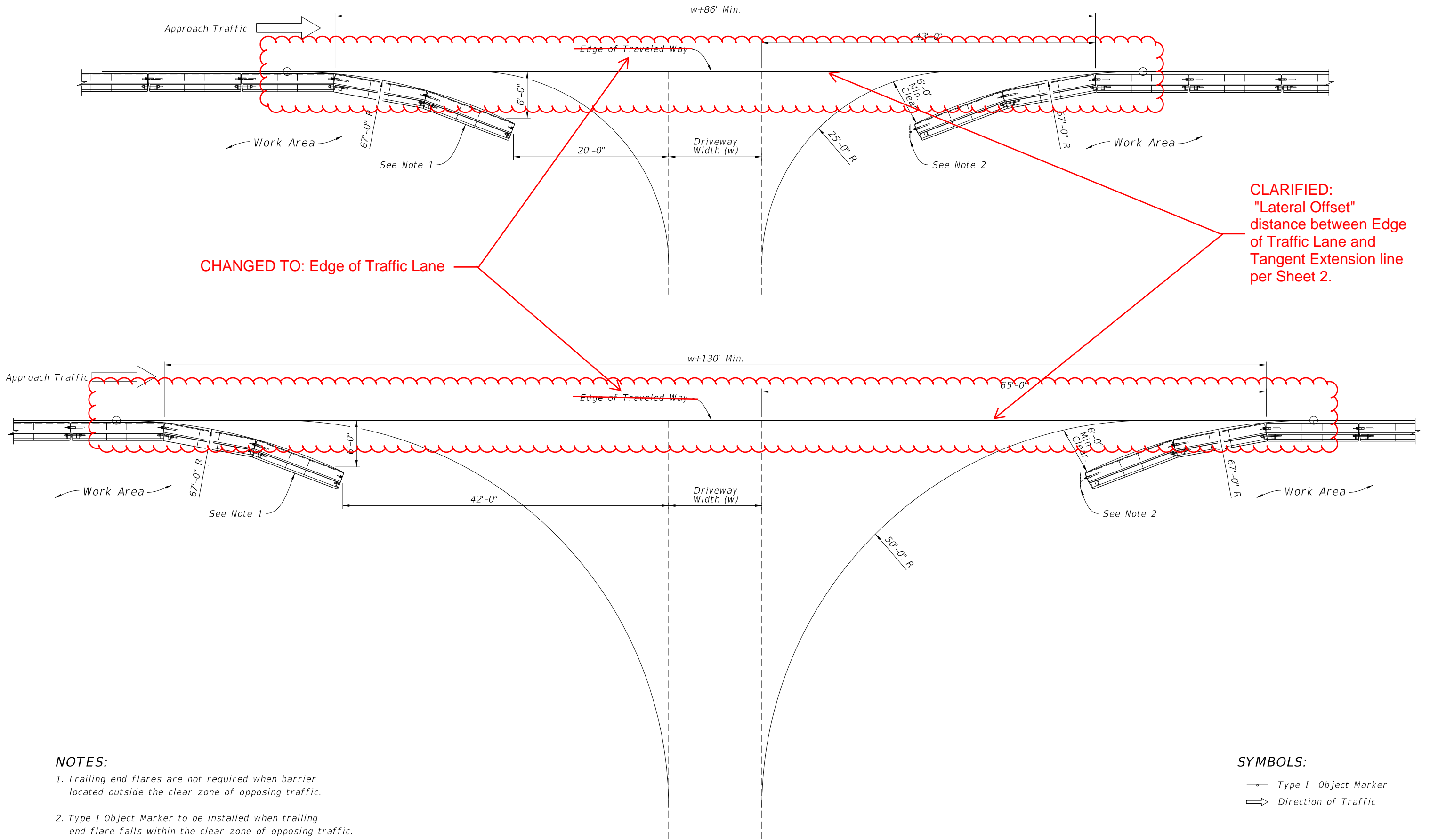

CHANGED TO: Edge of Traffic Lane

CLARIFIED:  
"Lateral Offset"  
distance between Edge  
of Traffic Lane and  
Tangent Extension line  
per Sheet 2.

**NOTES:**

1. Trailing end flares are not required when barrier located outside the clear zone of opposing traffic.
2. Type 1 Object Marker to be installed when trailing end flare falls within the clear zone of opposing traffic.

**SYMBOLS:**

- Type 1 Object Marker
- Direction of Traffic

**BARRIER OPENINGS AT DRIVEWAYS**

2027-28



FY ~~2026-27~~  
STANDARD PLANS

LOW PROFILE BARRIER

INDEX  
102-120

SHEET  
5 of 5

9/26/2025 11:08:18 AM

LAST REVISION	DESCRIPTION:
<del>11/01/19</del>	11/01/26

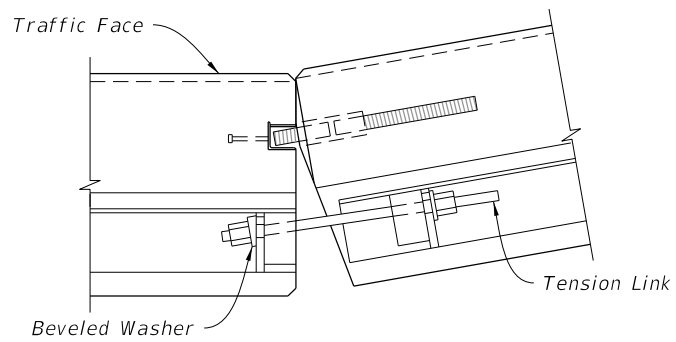

CONCAVE CONNECTION

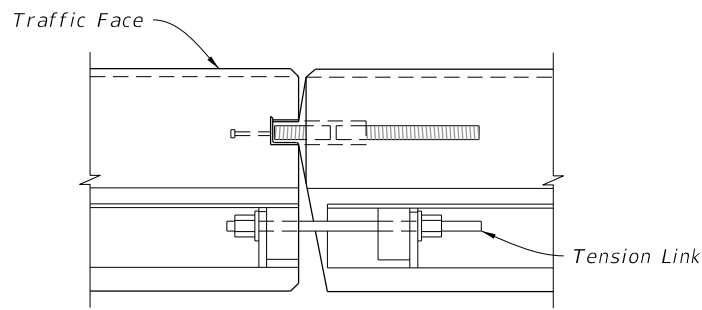

PARALLEL CONNECTION

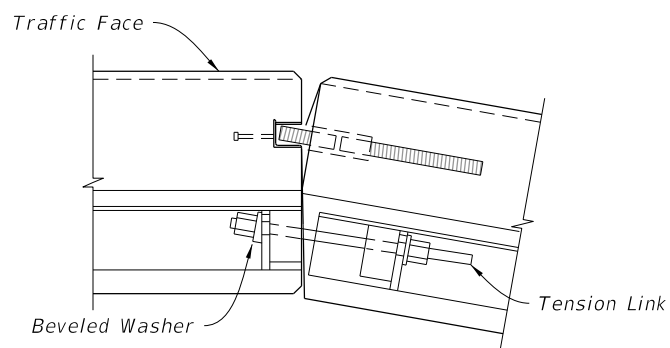

CONVEX CONNECTION

PLAN VIEWS OF CONNECTIONS

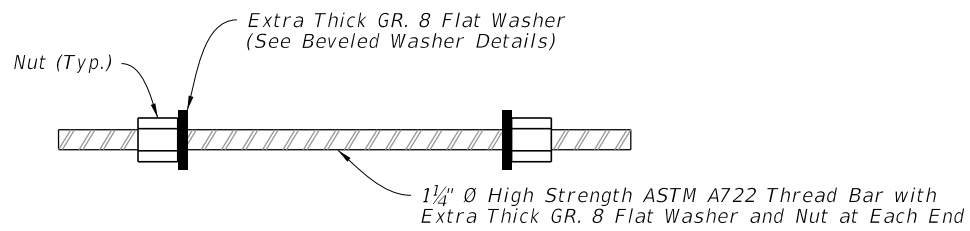

TENSION LINK DETAIL

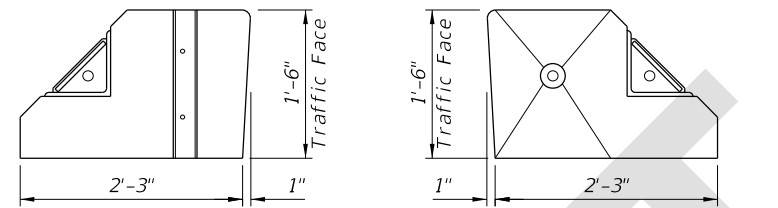

END VIEWS

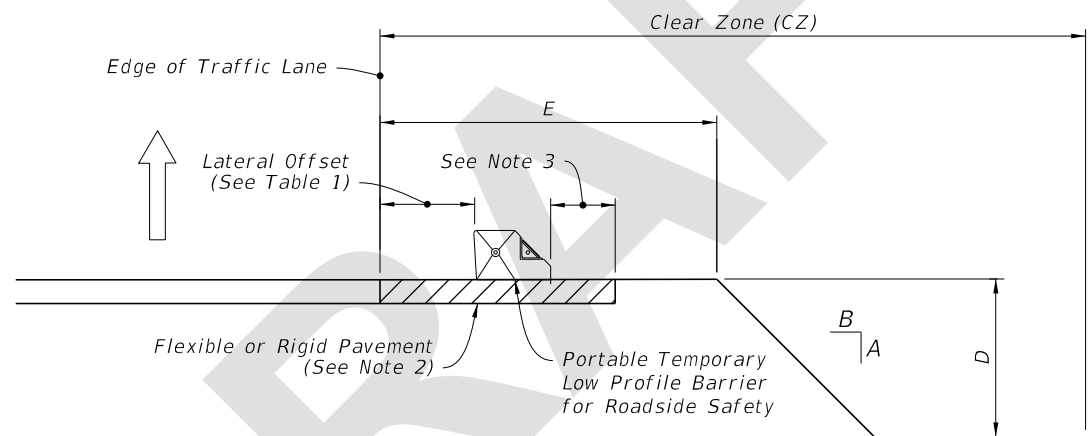

SETBACK DISTANCE AT DROP-OFFS

NOTES:

1. LIMITATION OF USE: This installation technique can only be used on flexible or rigid pavement.
2. ASPHALT PAD: Where existing pavement is not present, construct 2" Asphalt Pad using miscellaneous asphalt pavement in accordance with Specification 339 with the exception that the use of a pre-emergent herbicide is not required.
3. Minimum 9' on 1:10 or flatter slopes for 'Portable Temporary Low Profile Barrier For Roadside Safety.' For values A, B, D and E see Index 102-600.

SYMBOLS:

- Type I Object Marker
- ⇒ Direction of Traffic

WORK ZONE SPEED	LATERAL OFFSET	SETBACK DISTANCE
45 MPH or Less	1' Min, 2' Preferred	9"

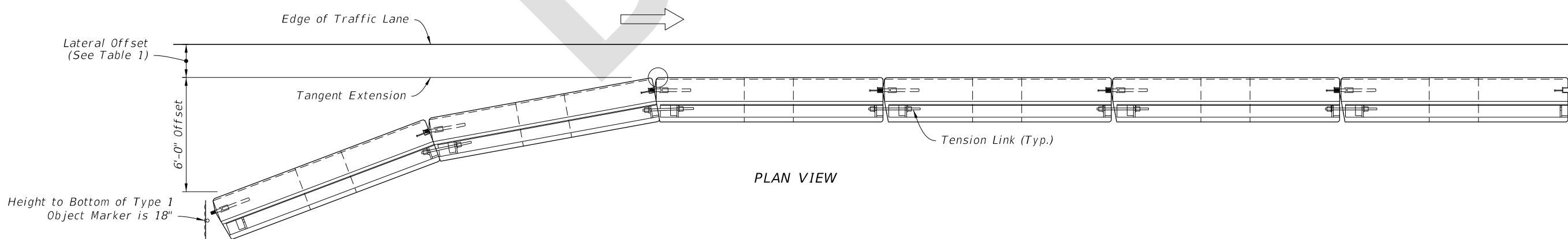

PLAN VIEW

APPROACH END OFFSET

5/15/2026 8:04:12 AM

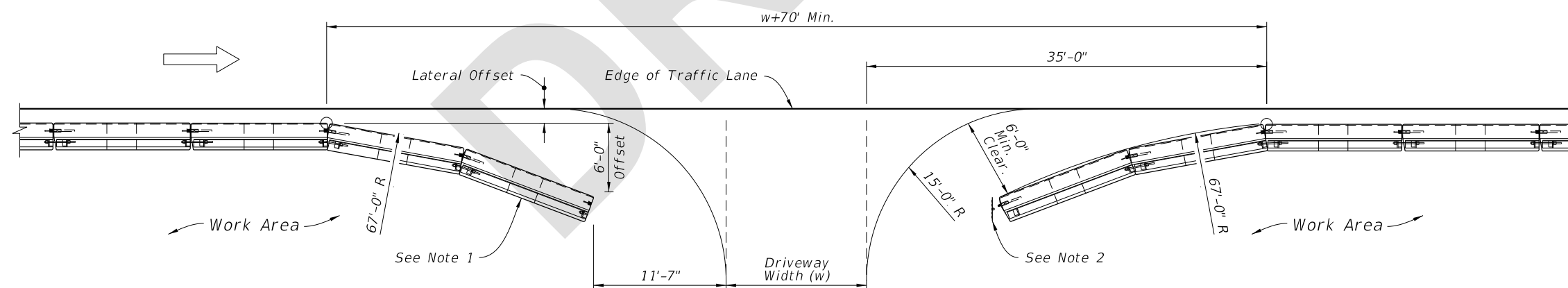
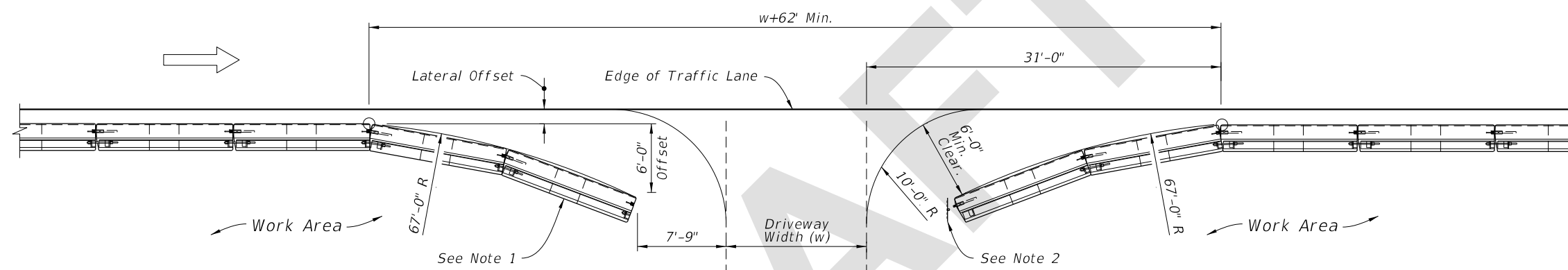
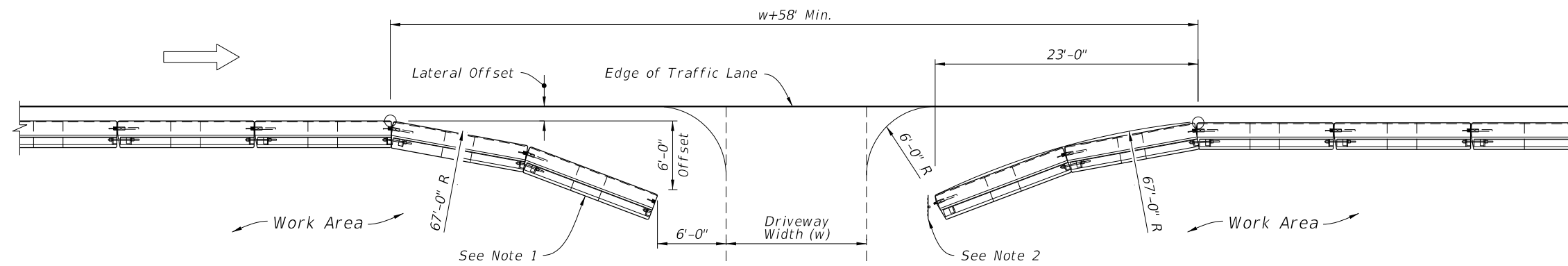

**NOTES:**

1. Trailing end flares are not required when barrier located outside the clear zone of opposing traffic.
2. Type I Object Marker to be installed when trailing end flare falls within the clear zone of opposing traffic.

**SYMBOLS:**

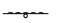
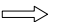
-  Type I Object Marker
-  Direction of Traffic

**BARRIER OPENINGS AT DRIVEWAYS**

5/15/2026 8:04:15 AM

LAST REVISION 11/01/26	REVISION	DESCRIPTION:		FY 2027-28 STANDARD PLANS	LOW PROFILE BARRIER	INDEX 102-120	SHEET 4 of 5
---------------------------	----------	--------------	--	------------------------------	---------------------	------------------	-----------------

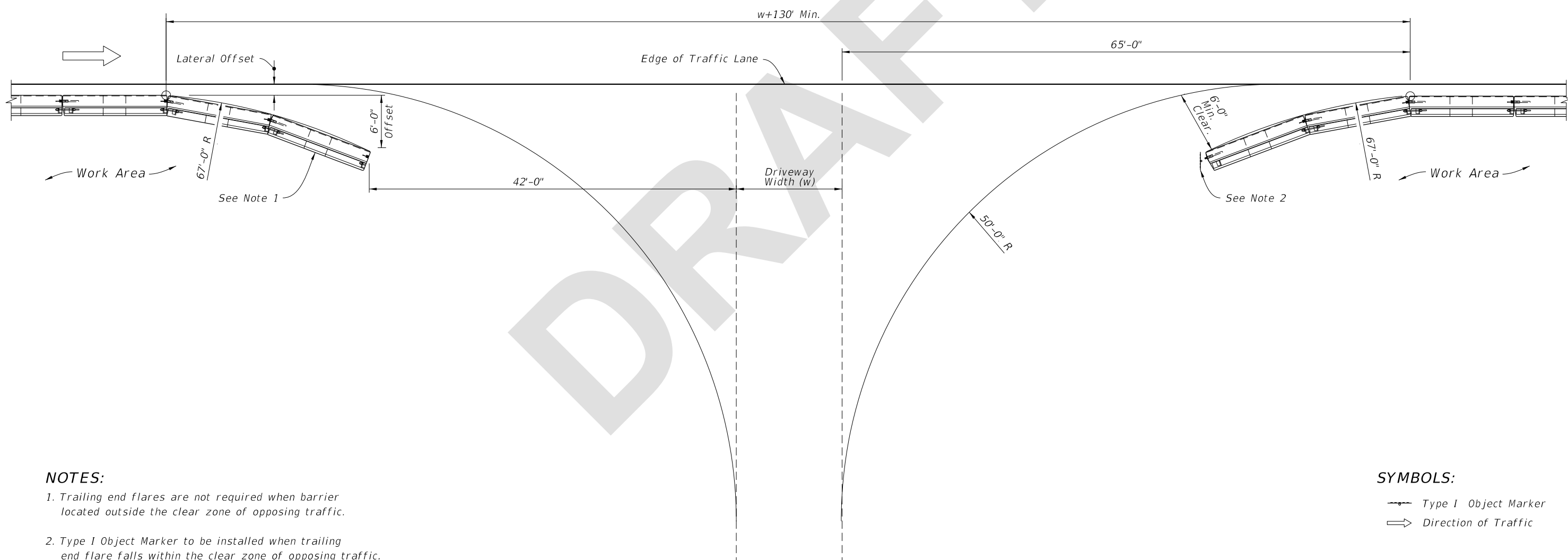
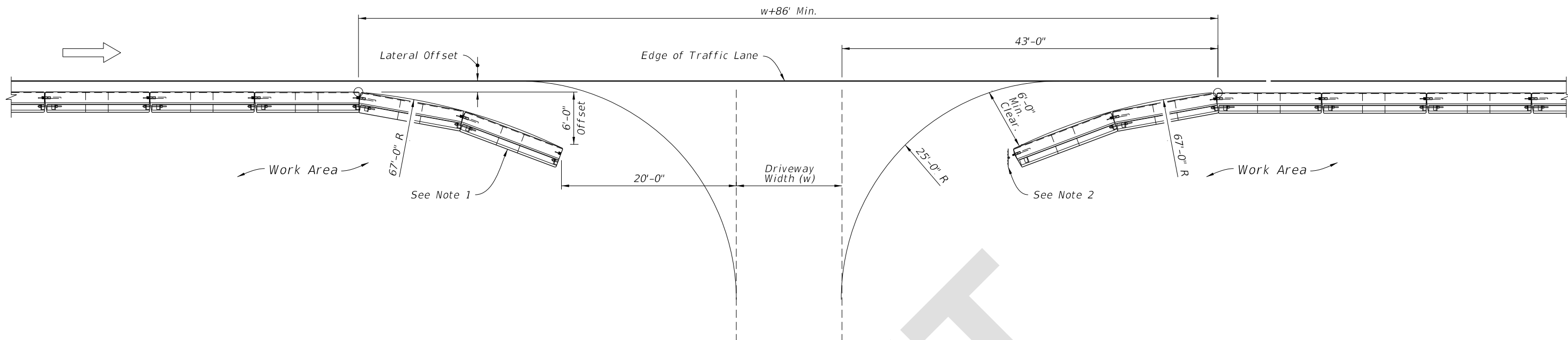

**NOTES:**

1. Trailing end flares are not required when barrier located outside the clear zone of opposing traffic.
2. Type 1 Object Marker to be installed when trailing end flare falls within the clear zone of opposing traffic.

**SYMBOLS:**

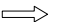
-  Type 1 Object Marker
-  Direction of Traffic

**BARRIER OPENINGS AT DRIVEWAYS**

5/15/2026 8:04:17 AM

LAST REVISION 11/01/26	DESCRIPTION:	 FY 2027-28 STANDARD PLANS	LOW PROFILE BARRIER	INDEX 102-120	SHEET 5 of 5
---------------------------	--------------	---	---------------------	------------------	-----------------