ORIGINATION FORM

Proposed Revisions to a Standard Plans Index
(Please provide all information — Incomplete forms will be returned)

Contact Information:

Date: January 27, 2021
Originator: Rick Jenkins
Phone: (850) 414-4355
Email: rick.jenkins@dot.state.fl.us

Standard Plans:

Index Number: 520-001
Sheet Number (s): All
Index Title: Curb and Gutter

Summary of the changes:

- Sheet 1: New General Note and Overview.
- Sheet 2: (Old Sheet 1) Renumbered, rearranged, and updated notes.
- Sheet 3: (Old Sheet 2) Renumbered, rearranged and moved General Notes to new Sheet 1.

Commentary / Background:

Redeveloped index. Moved General Notes to new sheet 1 and created isometric views to stay consistent with other indexes.

Other Affected Offices / Documents: (Provide name of person contacted)

- | Yes | No | |
|--------------------------|-------------------------------------|-----------------------------|
| <input type="checkbox"/> | <input checked="" type="checkbox"/> | Other Standard Plans – |
| <input type="checkbox"/> | <input checked="" type="checkbox"/> | FDOT Design Manual – |
| <input type="checkbox"/> | <input checked="" type="checkbox"/> | Basis of Estimates Manual – |
| <input type="checkbox"/> | <input checked="" type="checkbox"/> | Standard Specifications – |
| <input type="checkbox"/> | <input checked="" type="checkbox"/> | Approved Product List – |
| <input type="checkbox"/> | <input checked="" type="checkbox"/> | Construction – |
| <input type="checkbox"/> | <input checked="" type="checkbox"/> | Maintenance – |

Origination Package Includes:

(Email or hand deliver package to Rick Jenkins)

- | Yes | N/A | |
|-------------------------------------|--------------------------|--|
| <input checked="" type="checkbox"/> | <input type="checkbox"/> | Redline Mark-ups |
| <input type="checkbox"/> | <input type="checkbox"/> | Proposed Standard Plan Instruction (SPI) |
| <input type="checkbox"/> | <input type="checkbox"/> | Revised SPI |
| <input type="checkbox"/> | <input type="checkbox"/> | Other Support Documents |

Implementation:

- Design Bulletin (Interim)
- DCE Memo
- Program Mgmt. Bulletin
- FY-Standard Plans (Next Release)

Contact the Roadway Design Office for assistance in completing this form

NEW SHEET
GENERAL NOTES AND OVERVIEW

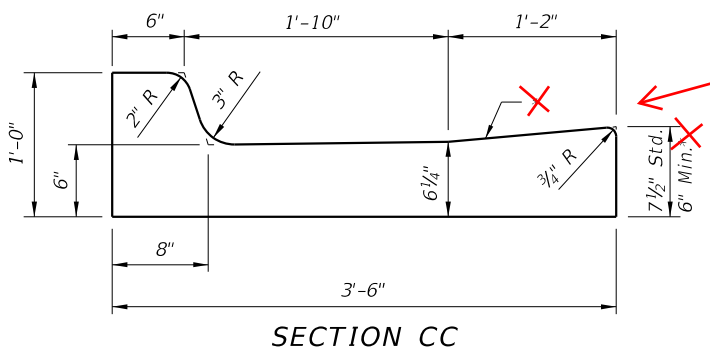
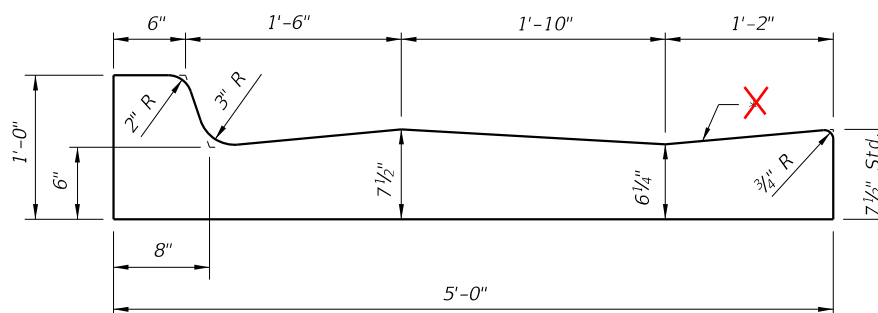
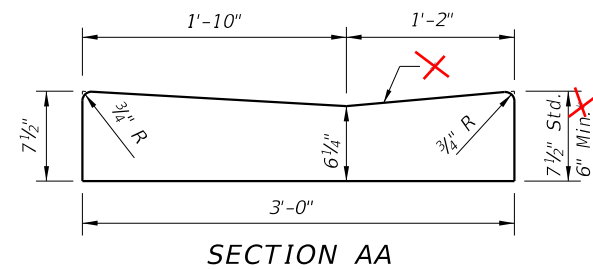
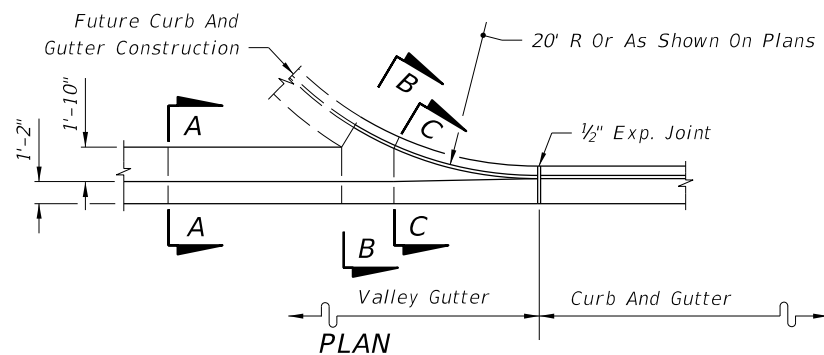

VALLEY GUTTER

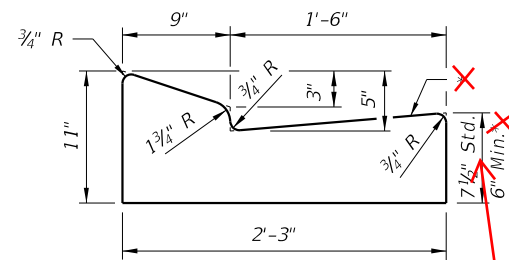

TYPE E

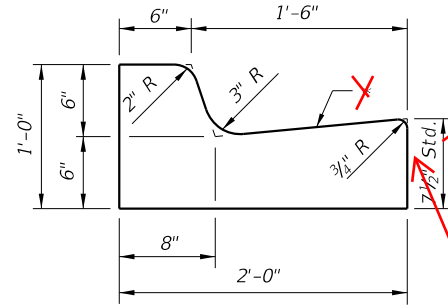

TYPE F

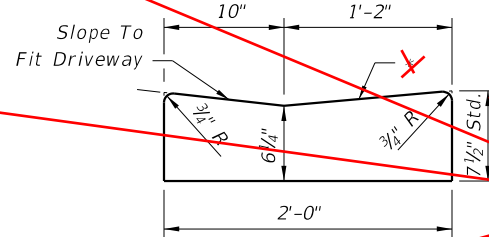

DROP CURB

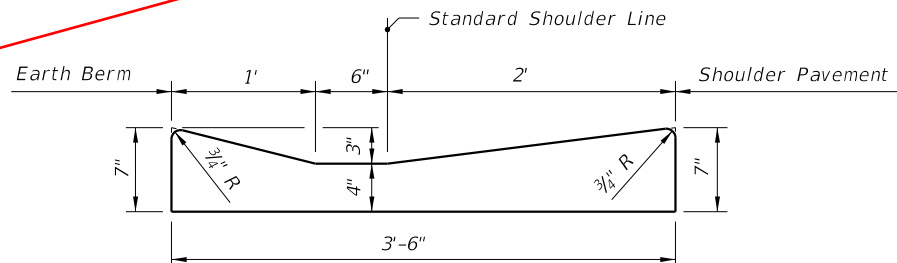

SHOULDER GUTTER

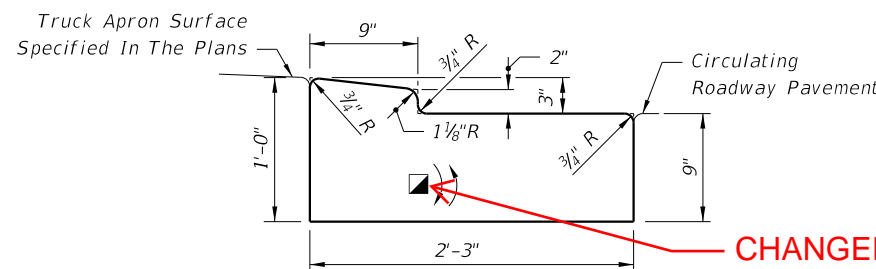

TRAFFIC BEARING SECTION FOR USE IN ROUNDABOUT CENTRAL ISLAND CONSTRUCTION TYPE RA

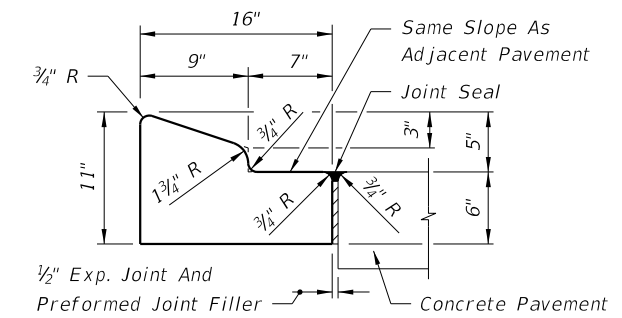

TYPE A

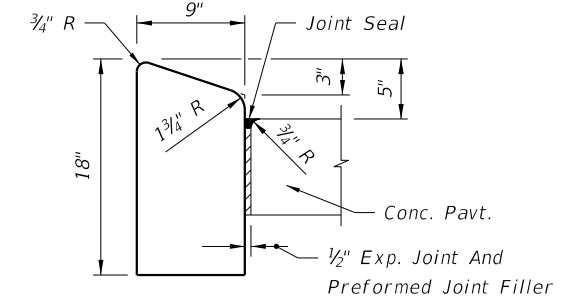

TYPE B

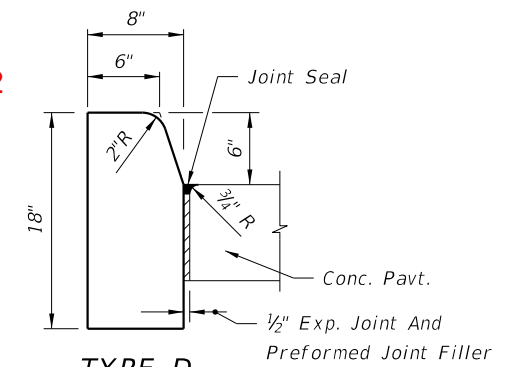

TYPE D

Note: For use adjacent to concrete or flexible pavement, concrete shown. Expansion joint, preformed joint filler and joint seal are required between curbs and concrete pavement only, see Sheet 2.

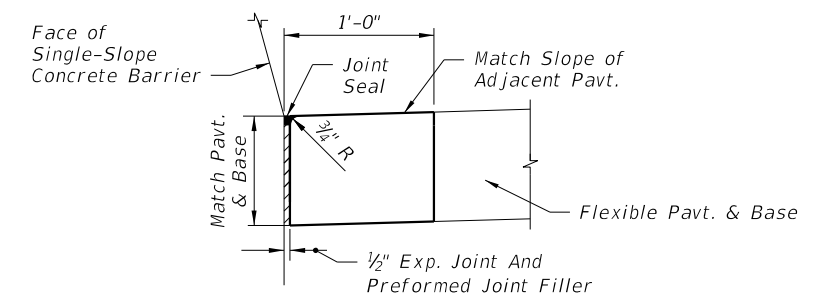

TOLL HEADER CURB (See the toll site details for conduit requirements)

CHANGED TO: See Note 2

CHANGED TO: See Note 3

2. ~~X~~ When used on high side of roadways, the cross slope of the gutter shall match the cross slope of the adjacent pavement. The thickness of the lip shall be 6", unless otherwise shown on plans.
3. ~~X~~ Rotate entire section so that gutter cross slope matches slope of adjacent circulating roadway pavement.
1. For use adjacent to concrete or flexible pavement. For details depicting usage adjacent to flexible pavement, see Sheet 2. Expansion joint, preformed joint filler and joint seal are required between curb & gutter and concrete pavement only, see Sheet 2.

UPDATED NOTES

10/12/2020 7:31:45 AM

LAST REVISION	DESCRIPTION:
11/01/20	
11/01/21	



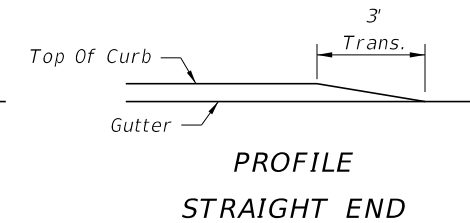
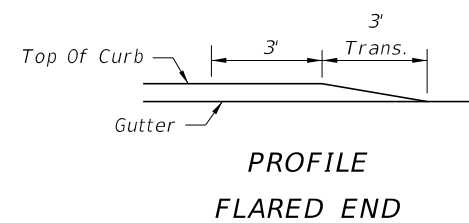
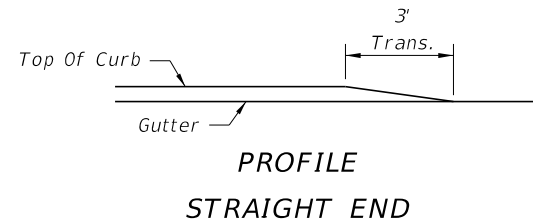
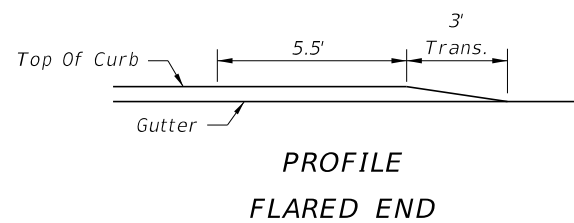
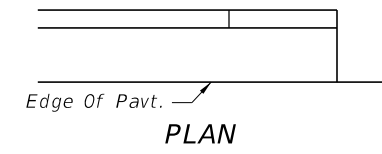
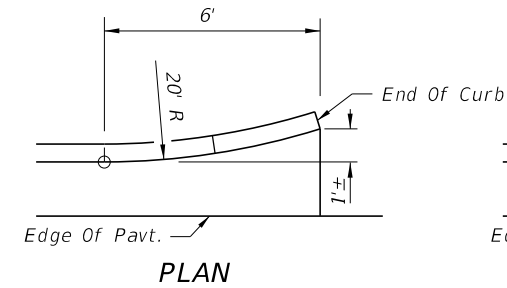
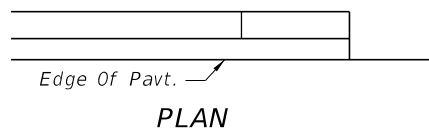
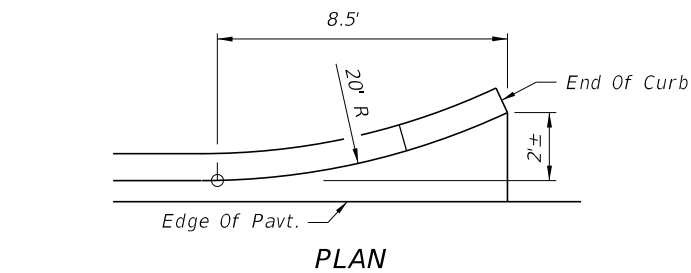

CURB TYPE A

CURB AND GUTTER ENDINGS

CURB AND GUTTER TYPES E & F

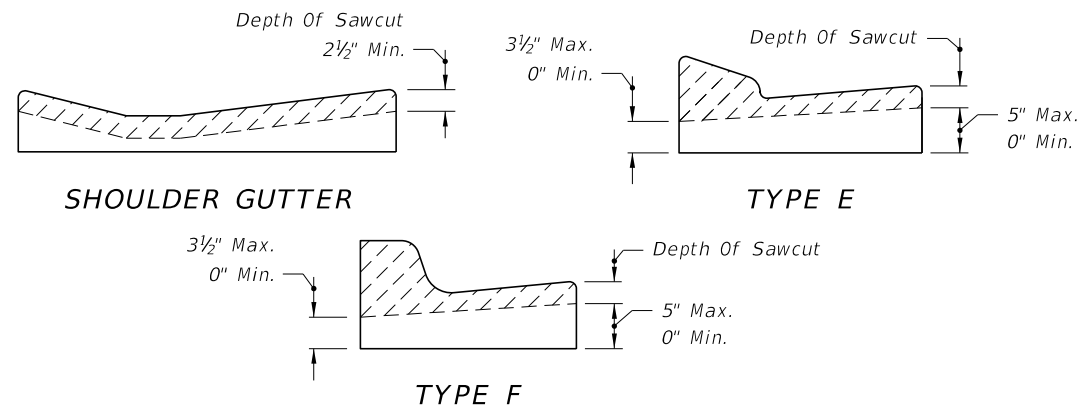

CHANGED TO: See Note

CHANGED TO: See Note 1

Surface On Low Side Of Pavement To Be 1/4" Above Lip Of Gutter. Surface On High Side To Be Flush With Lip Of Curb Or Curb & Gutter.

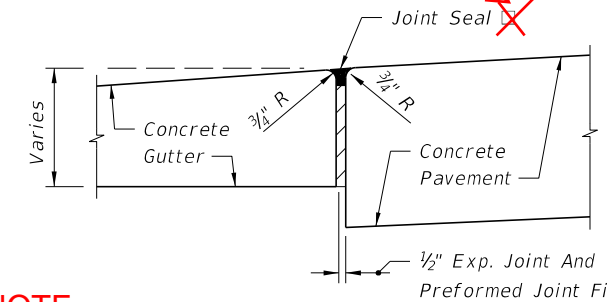

NOTE

Applies to both high and low sides of pavement, low side shown.

EXPANSION JOINT BETWEEN GUTTER AND CONCRETE PAVEMENT

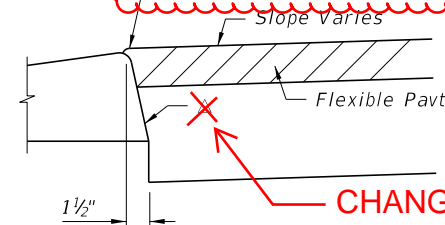

CHANGED TO: See Note 2

Applies to both high and low sides of pavement, low side shown. Applies to shoulder gutter only where adjoining traffic lanes.

CURB AND GUTTER AND TYPE A CURB ADJACENT TO FLEXIBLE PAVEMENT

MOVED TO SHEET 1
GENERAL NOTES

- For curb, gutter and curb & gutter provide 1/8" - 1/4" contraction joints at 10' centers (max.). Contraction joints adjacent to concrete pavement on tangents and flat curves are to match the pavement joints, with intermediate joints not to exceed 10' centers. Curb, gutter and curb & gutter expansion joints shall be located in accordance with Specification 520.
- Ends of Curbs Types B and D shall transition from full to zero heights in 3'.

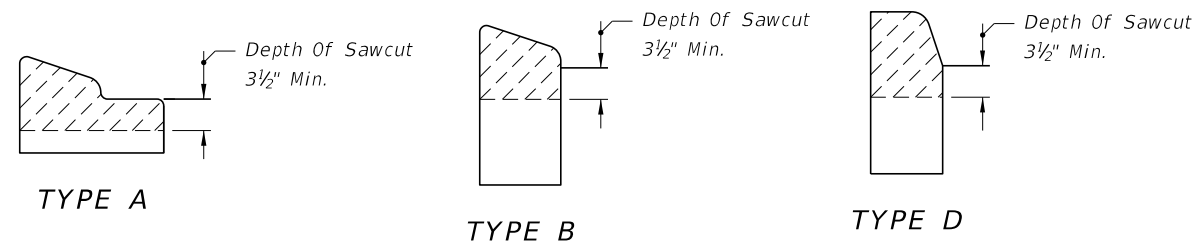

CONTRACTION JOINT IN CURB

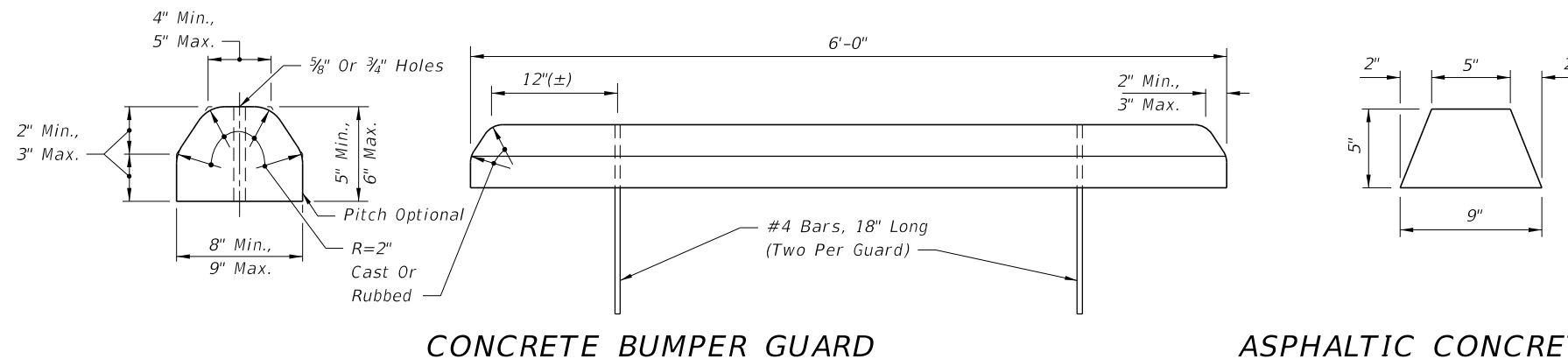

CONCRETE BUMPER GUARD

ASPHALTIC CONCRETE CURB

10/12/2020 7:31:47 AM

LAST REVISION	DESCRIPTION:
11/01/17	11/01/21

GENERAL NOTES:

1. For curb, gutter and curb & gutter provide $\frac{1}{8}$ " - $\frac{1}{4}$ " contraction joints at 10' centers (max.). Contraction joints adjacent to concrete pavement on tangents and flat curves are to match the pavement joints, with intermediate joints not to exceed 10' centers.
2. Locate expansion joints for curb, gutter and curb & gutter in accordance with Specification 520.

TABLE OF CONTENTS:	
Sheet	Description
1	General Notes and Contents
2	Concrete Curb and Gutter
3	Curb and Gutter Joints and Endings, Concrete Bumper Guard, and Asphaltic Concrete Curb

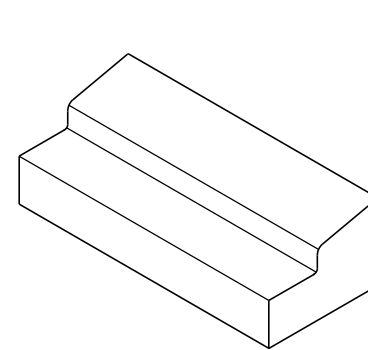

TYPE A

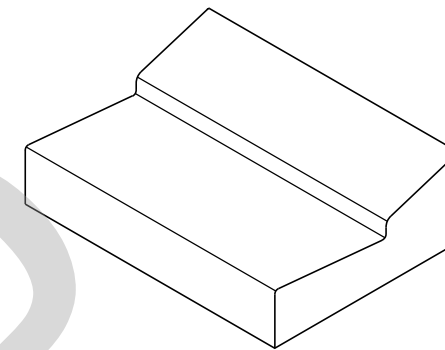

TYPE E

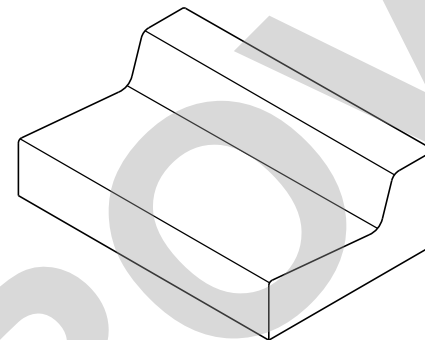

TYPE F

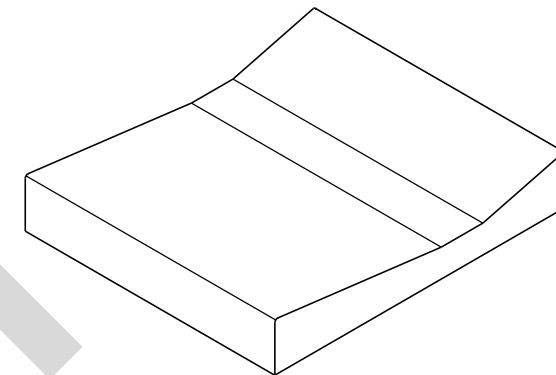

SHOULDER GUTTER

===== TYPE A, TYPE E, TYPE F, AND SHOULDER GUTTER =====
(Other Types Similar)

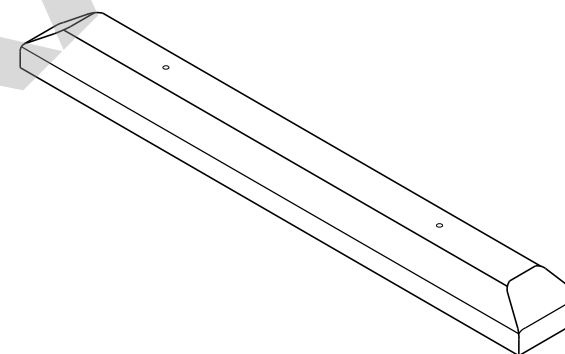

===== CONCRETE BUMPER GUARD =====

APPROVED DRAFT

8/5/2021 4:25:07 PM

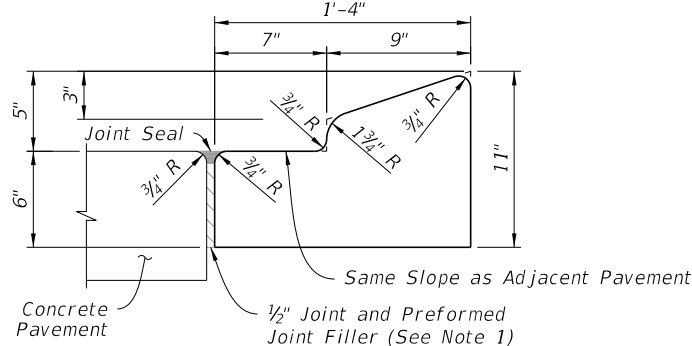

NOTE: For use adjacent to concrete or flexible pavement, concrete shown (See Note 4).

TYPE A

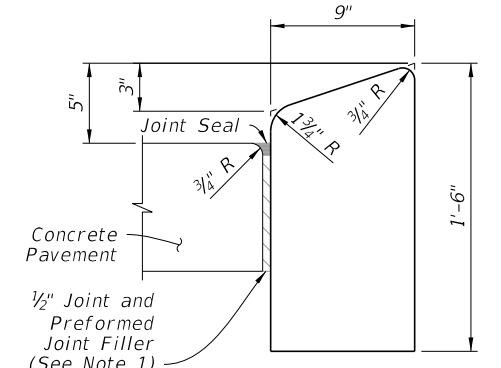

NOTE: For use adjacent to concrete or flexible pavement, concrete shown.

TYPE B

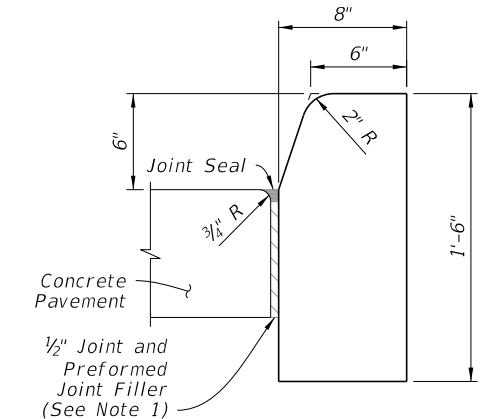

NOTE: For use adjacent to concrete or flexible pavement, concrete shown.

TYPE D

- NOTES:**
- For Type A, Type B, and Type D Curb: Expansion joint, preformed joint filler and joint seal are required between curbs and concrete pavement only, see Sheet 3.
 - For Type E, Type F, Drop Curb, and Valley Gutter: When used on high side of roadways, match the cross slope of the gutter to the cross slope of the adjacent pavement. The thickness of the lip is 6", unless otherwise shown on Plans.
 - For Type RA, rotate entire section so that gutter cross slope matches slope of adjacent circulating roadway pavement.
 - For details depicting usage of Type A Curb adjacent to flexible pavement see Sheet 3.

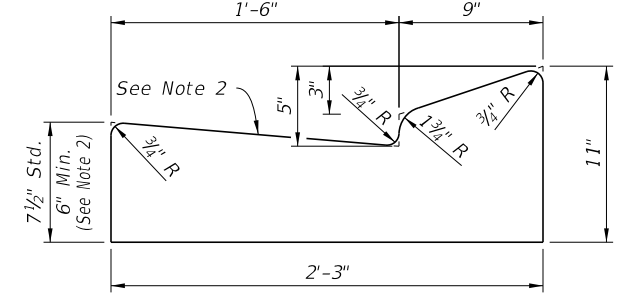

TYPE E

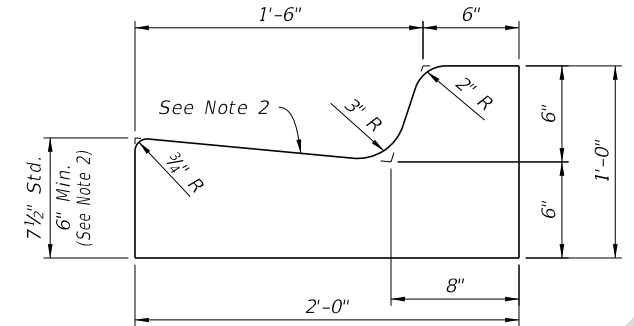

TYPE F

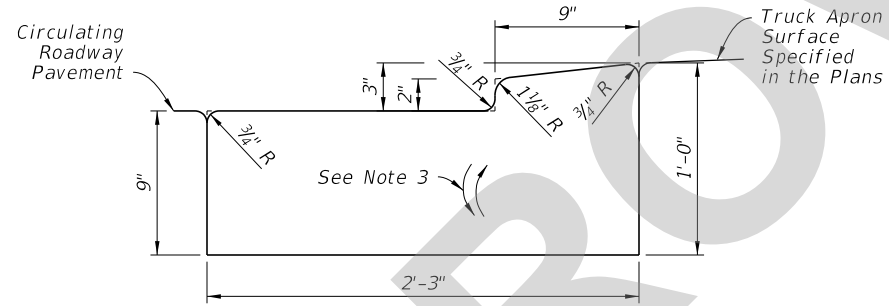

NOTE: Traffic Bearing Sections for use in Roundabout Central Island Construction.

TYPE RA

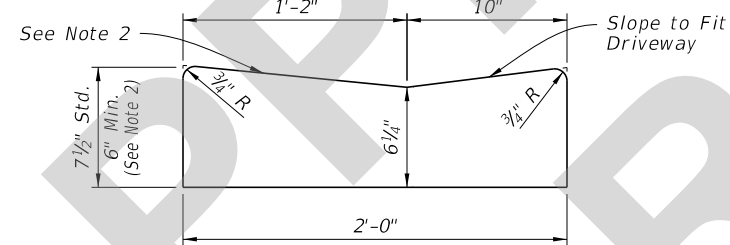

DROP CURB

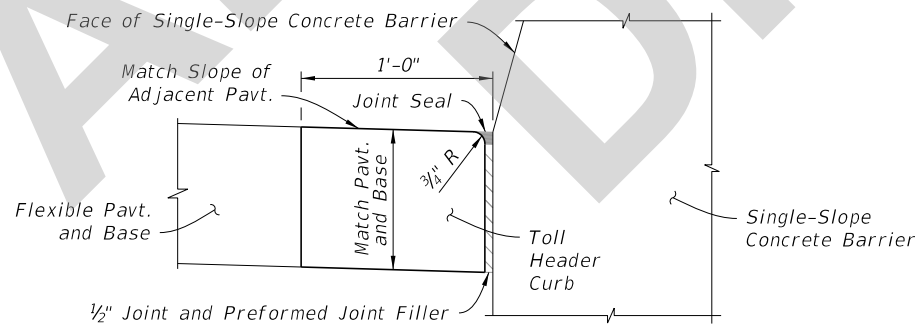

NOTE: See the toll site details for conduit requirements.

TOLL HEADER CURB

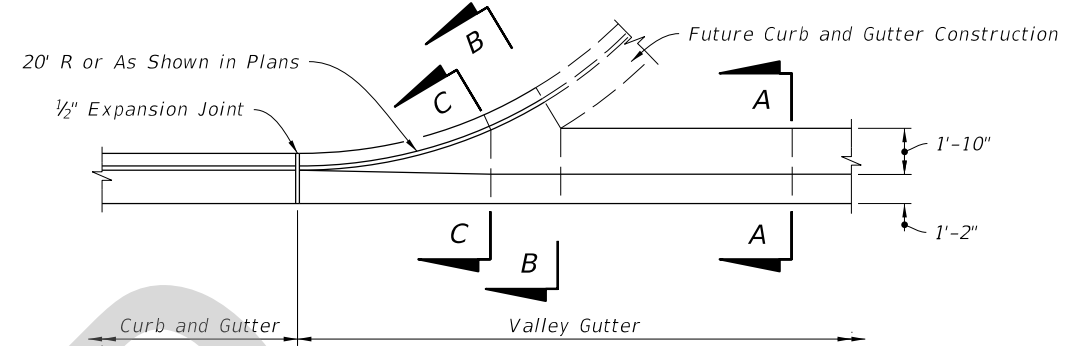

PLAN VIEW

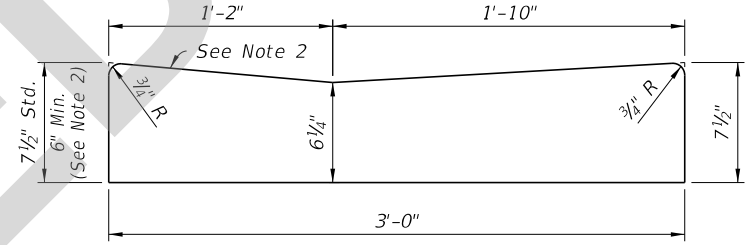

SECTION A-A

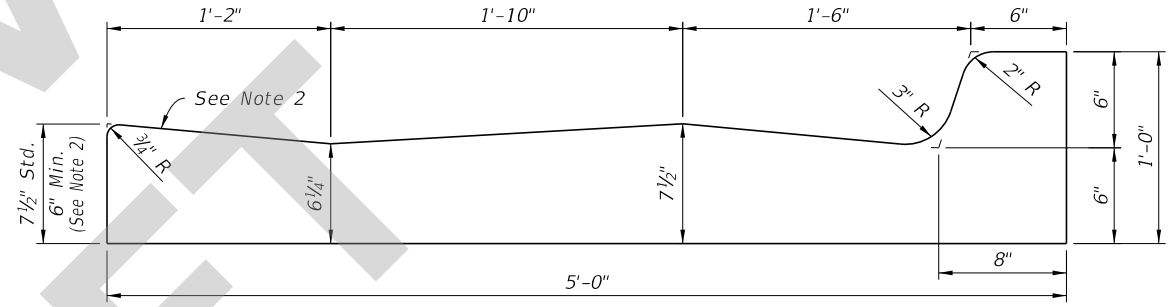

SECTION B-B

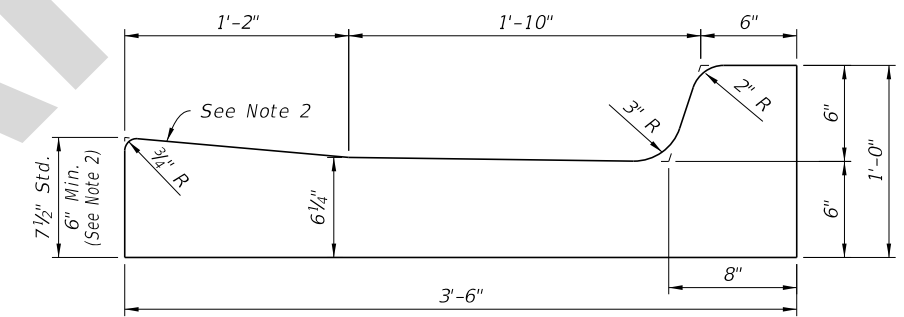

SECTION C-C

VALLEY GUTTER

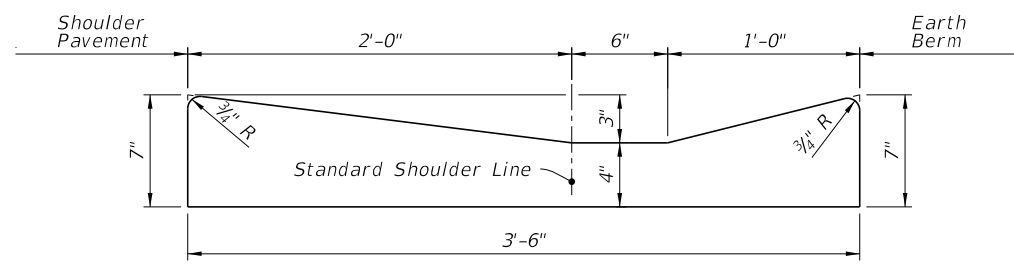

SHOULDER GUTTER

CONCRETE CURB AND GUTTER

8/5/2021 4:25:11 PM

LAST REVISION 11/01/21	DESCRIPTION:	FDOT	FY 2022-23 STANDARD PLANS	CURB AND GUTTER	INDEX 520-001	SHEET 2 of 3
---------------------------	--------------	------	------------------------------	-----------------	------------------	-----------------

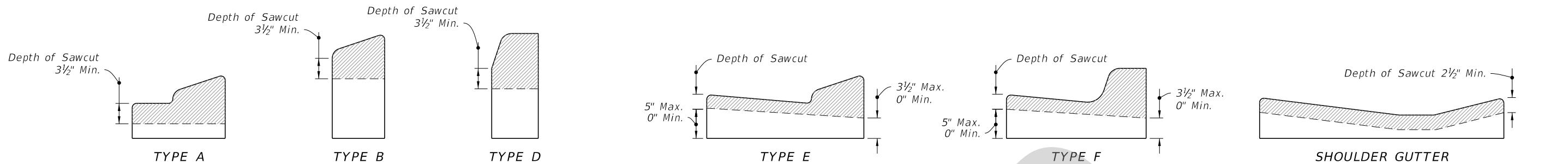

NOTE: Sawcuts should be avoided within valley gutter and within curb and gutter endings.

CONTRACTION JOINTS IN CURB

CONTRACTION JOINTS IN CURB & GUTTER

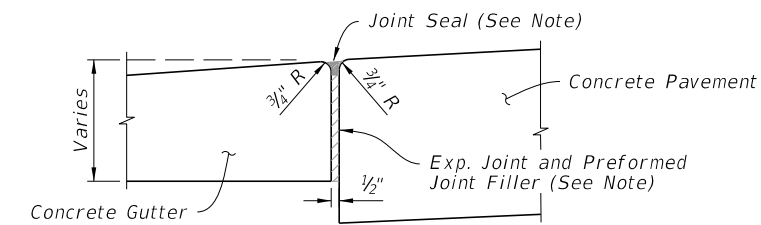
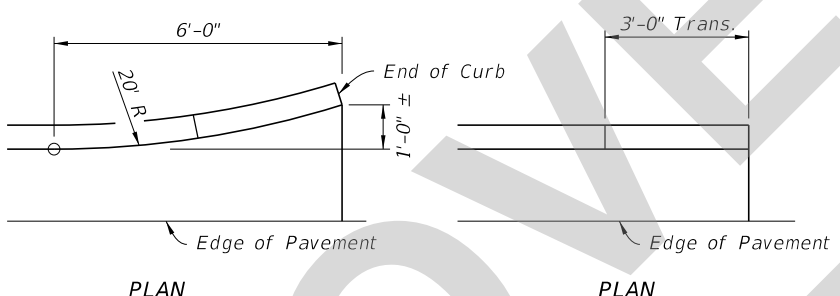
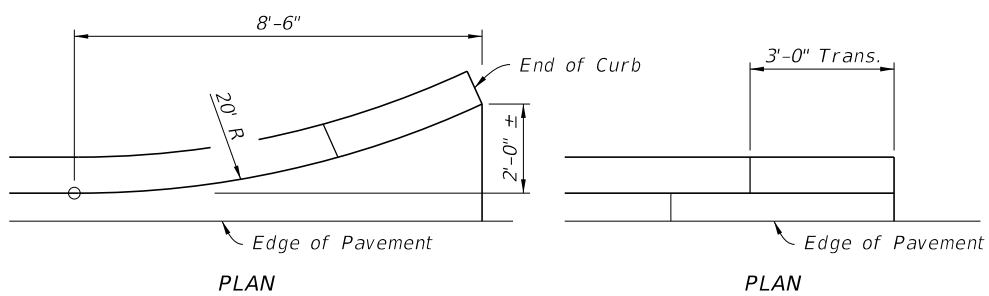

NOTE: Joint Seal application applies to both high and low sides of pavement, low side shown.

EXPANSION JOINT BETWEEN GUTTER AND CONCRETE PAVEMENT

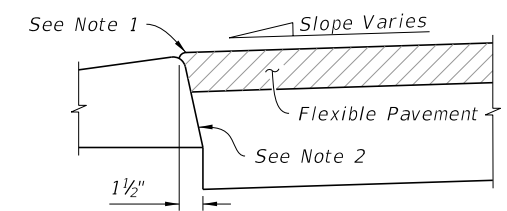
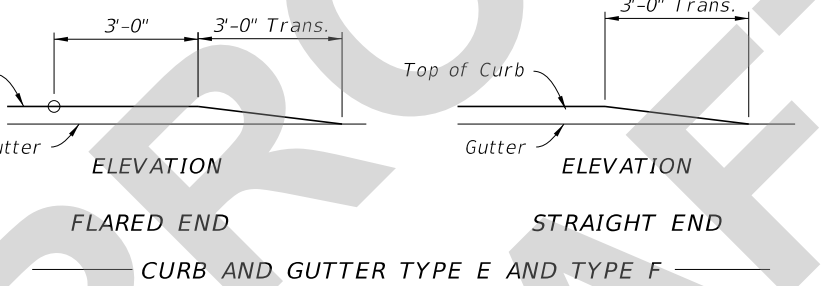
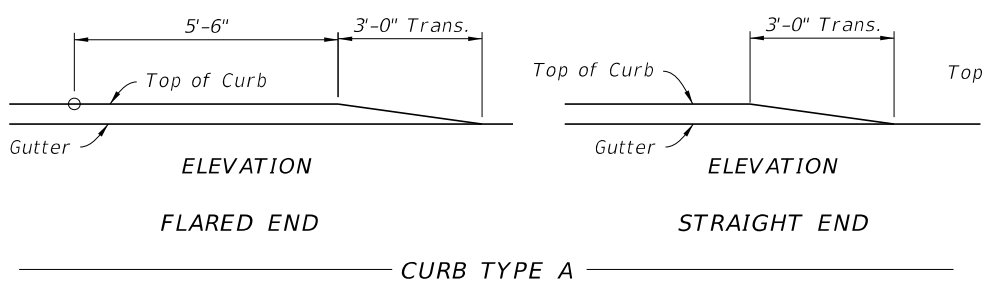

- NOTES:
1. Surface on Low Side of Pavement to be 1/4" Above Lip of Gutter. Surface on High Side to be Flush With Lip of Curb or Curb & Gutter.
 2. Applies to both high and low sides of pavement, low side shown. Applies to shoulder gutter only where adjoining traffic lanes.

CURB AND CURB & GUTTER ENDINGS

NOTE: Ends of Type B and D Curb transition from full to zero heights in 3 ft.

CURB AND GUTTER AND TYPE A CURB ADJACENT TO FLEXIBLE PAVEMENT

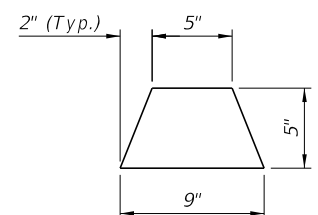
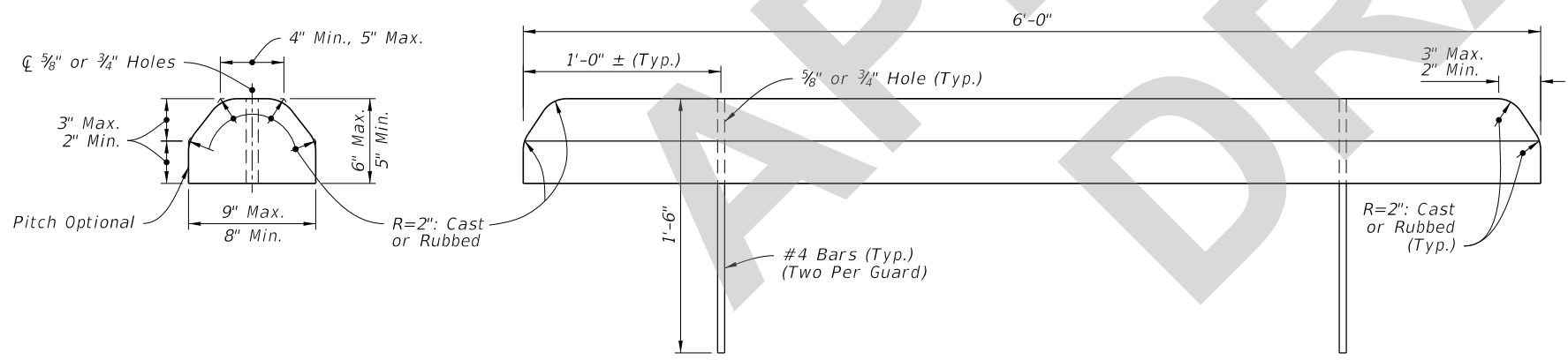

CONCRETE BUMPER GUARD

ASPHALTIC CONCRETE CURB

CURB AND GUTTER JOINTS AND ENDINGS, CONCRETE BUMPER GUARD, AND ASPHALTIC CONCRETE CURB

8/5/2021 4:25:14 PM

LAST REVISION 11/01/21	DESCRIPTION:	FDOT	FY 2022-23 STANDARD PLANS	CURB AND GUTTER	INDEX 520-001	SHEET 3 of 3
---------------------------	--------------	------	------------------------------	-----------------	------------------	-----------------