ORIGINATION FORM

Proposed Revisions to a Standard Plans Index
(Please provide all information — Incomplete forms will be returned)

Contact Information:

Date: June 18, 2021
Originator: Mary Jane Hayden
Phone: (850) 414-4783
Email: MaryJane.Hayden@dot.state.fl.us

Standard Plans:

Index Number: 350-001
Sheet Number (s): 1 of 4
Index Title: Concrete Pavement Joints

Summary of the changes:

Sheet 1: Updated Note 3.B (Deleted "standard load transfer" and changed Spacing of #5 bars from 38"); Correct line work to extend to the bottom of the pavement in the BUTT CONSTRUCTION JOINT details; Added "Relation of Dowels to Tie Bars" detail.

Commentary / Background:

Rev 1: Clarification-Butt Construction Joints should be depicted to show the joint extending from the top of the slab all the way to the bottom of the slab. Rev 2: Correction-tie bars are not used for load transfer. Rev 3: Change-tie bar spacing changed to provide a consistent and even spacing for slabs, which are typically 15' long. Rev 4: new detail.

Other Affected Offices / Documents: (Provide name of person contacted)

- | Yes | No | |
|--------------------------|-------------------------------------|--|
| <input type="checkbox"/> | <input checked="" type="checkbox"/> | Other Standard Plans – |
| <input type="checkbox"/> | <input checked="" type="checkbox"/> | FDOT Design Manual – |
| <input type="checkbox"/> | <input checked="" type="checkbox"/> | Basis of Estimates Manual – |
| <input type="checkbox"/> | <input checked="" type="checkbox"/> | Standard Specifications – |
| <input type="checkbox"/> | <input checked="" type="checkbox"/> | Approved Product List – |
| <input type="checkbox"/> | <input checked="" type="checkbox"/> | Construction – Tie bar revisions were coordinated with Rich Hewitt |
| <input type="checkbox"/> | <input checked="" type="checkbox"/> | Maintenance – |

Origination Package Includes:

(Email or hand deliver package to Rick Jenkins)

- | Yes | N/A | |
|-------------------------------------|--------------------------|--|
| <input checked="" type="checkbox"/> | <input type="checkbox"/> | Redline Mark-ups |
| <input type="checkbox"/> | <input type="checkbox"/> | Proposed Standard Plan Instruction (SPI) |
| <input type="checkbox"/> | <input type="checkbox"/> | Revised SPI |
| <input checked="" type="checkbox"/> | <input type="checkbox"/> | Other Support Documents |

Implementation:

- | | |
|-------------------------------------|----------------------------------|
| <input type="checkbox"/> | Design Bulletin (Interim) |
| <input type="checkbox"/> | DCE Memo |
| <input type="checkbox"/> | Program Mgmt. Bulletin |
| <input checked="" type="checkbox"/> | FY-Standard Plans (Next Release) |

Contact the Roadway Design Office for assistance in completing this form

Email to: Rick Jenkins rick.jenkins@dot.state.fl.us and Darren Martin darren.martin@dot.state.fl.us

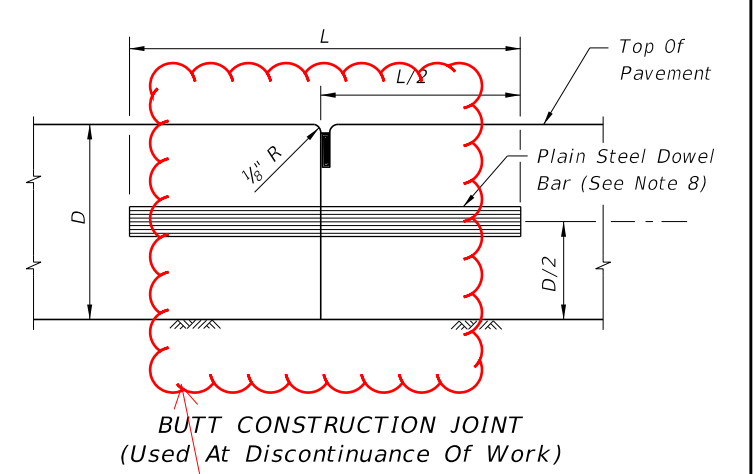
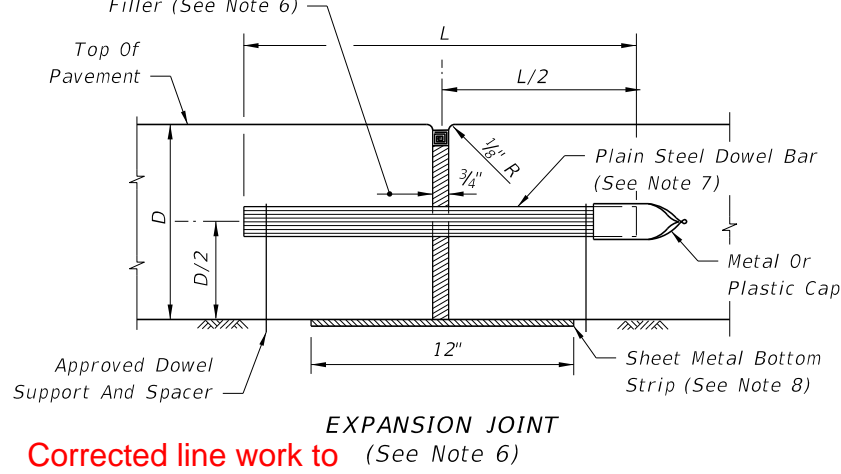
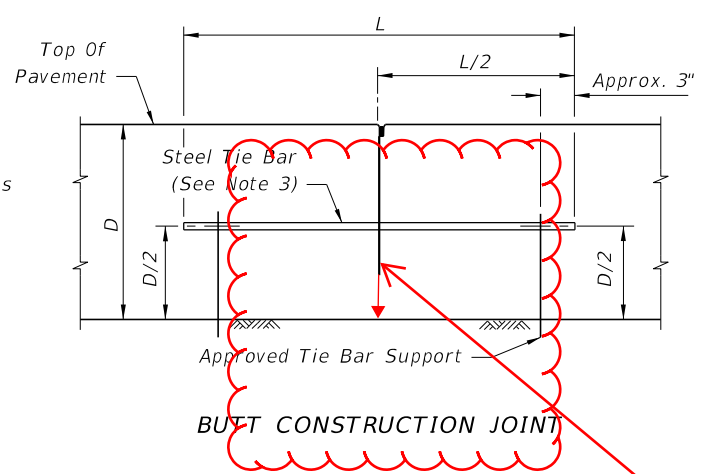
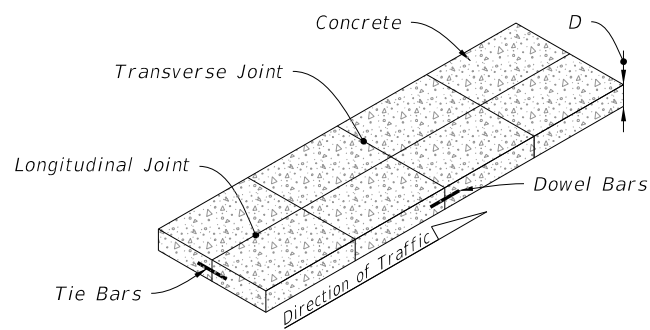

NOTES:

1. For joint seal dimensions see Sheet 2.
2. For slabs poured simultaneously, tie bars may be inserted in the plastic concrete by means approved by the Engineer.
3. For Longitudinal Joints:
 - A. Tie bars are deformed #4 or #5 reinforcing steel bars meeting the requirements of Specification 931.
 - B. Provide a ~~standard load transfer tied joint~~ with #4 bars 25" in length at 24" spacing or #5 bars 30" in length at ~~24"~~ spacing.
4. Transverse joints are to be spaced at a maximum of 15'. Dowels are required at all transverse joints unless otherwise noted in the plans.
5. Expansion joints to be placed at street intersections and other locations as indicated in the Plans. For bridge expansion joints, see Index 370-001.
6. Punch clean holes in preformed joint filler greater than bar diameter.
7. Coat and lubricate plain steel dowel bars in accordance with Specification 350.
8. Sheet metal bottom strips in accordance with Specification 931. Not required with asphalt base.

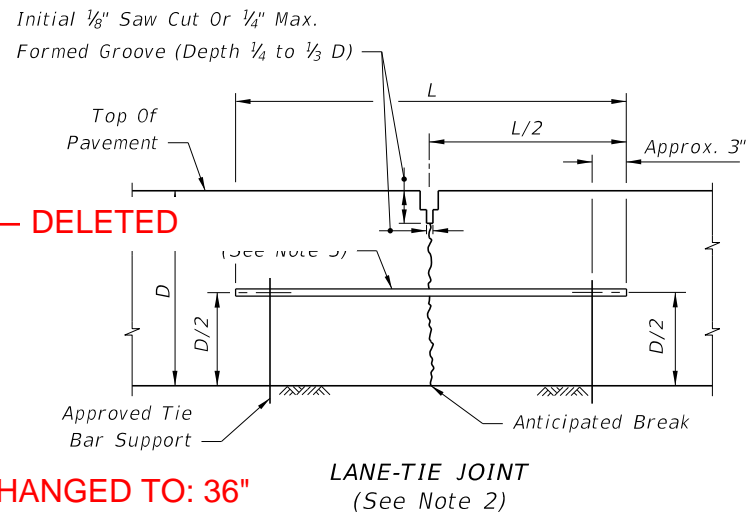

Corrected line work to extend to the bottom of pavement.

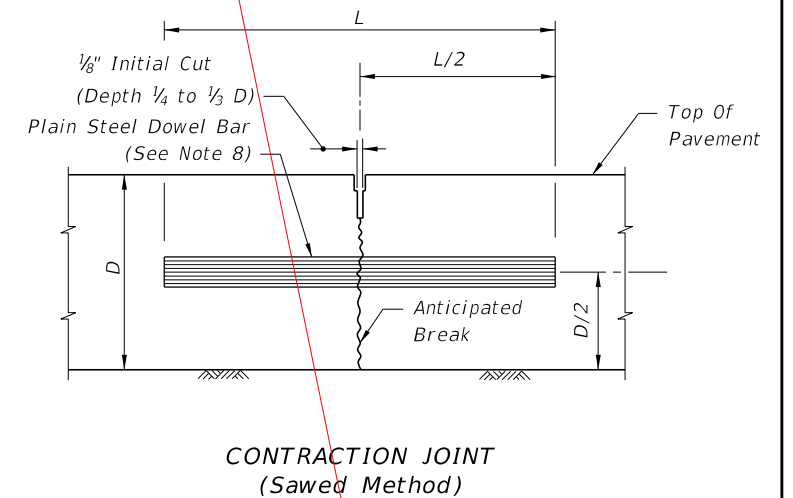
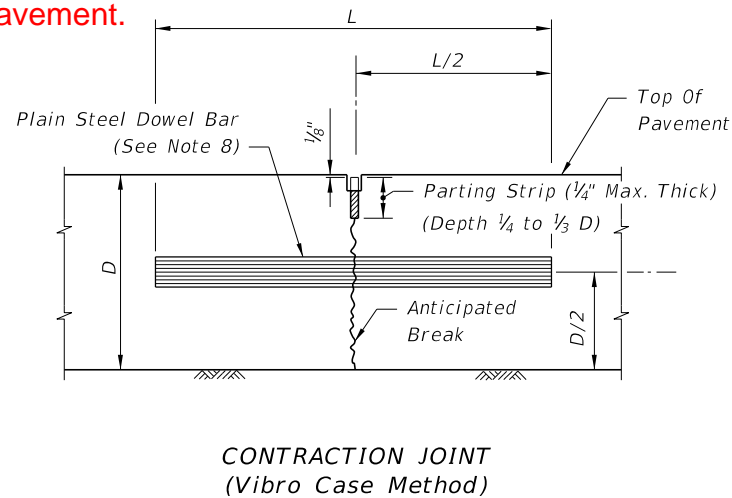

DELETED

CHANGED TO: 36"

LONGITUDINAL JOINTS

TRANSVERSE JOINTS

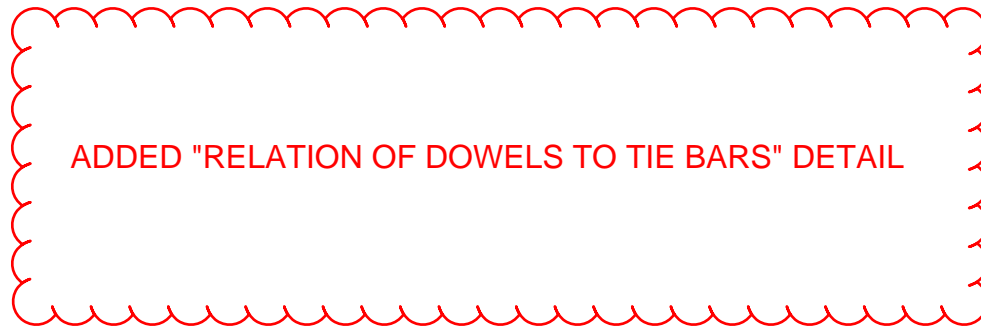

Corrected line work to show joint all the way to bottom of pavement

DOWELS (LENGTH 18")	
Pavement Thickness "D"	Diameter
6"-6 1/2"	3/4"
7"-8"	1"
8 1/2"-10 1/2"	1 1/4"
≥11"	1 1/2"

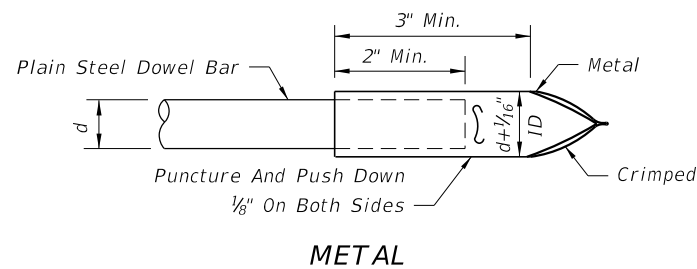

METAL

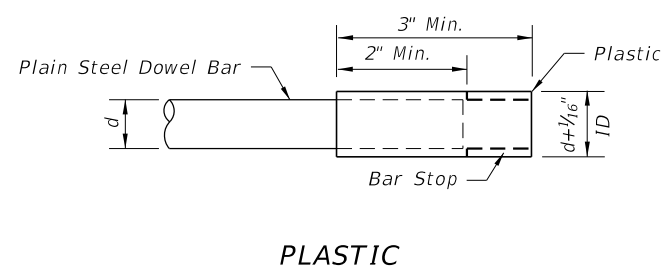

PLASTIC

DOWEL BARS CAPS

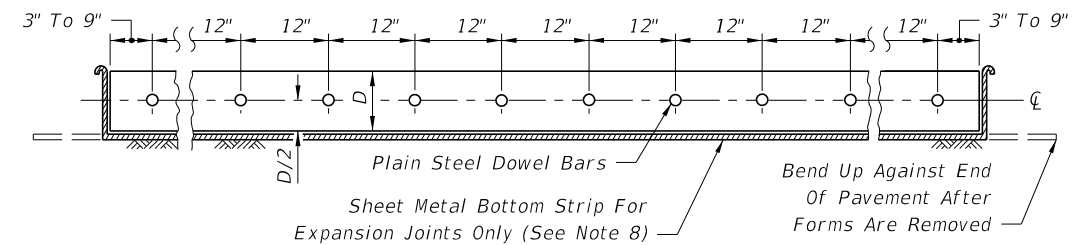

DOWEL BAR LAYOUT

10/12/2020 6:39:04 AM

LAST REVISION	DESCRIPTION:
11/01/19	11/01/21



FY 2021-22
STANDARD PLANS

CONCRETE PAVEMENT JOINTS

INDEX
350-001

SHEET
1 of 4

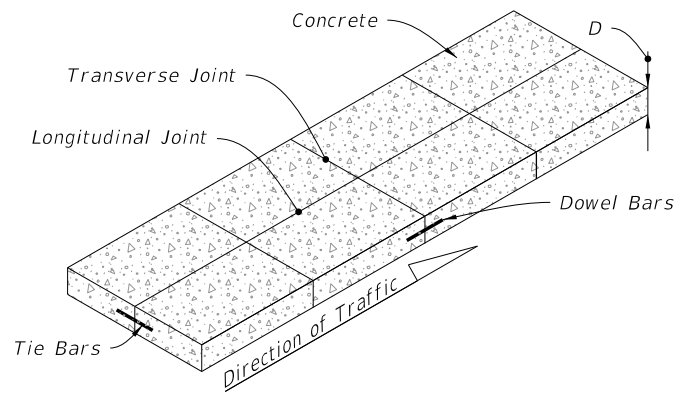

NOTES:

1. For joint seal dimensions see Sheet 2.
2. For slabs poured simultaneously, tie bars may be inserted in the plastic concrete by means approved by the Engineer.
3. For Longitudinal Joints:
 - A. Tie bars are deformed #4 or #5 reinforcing steel bars meeting the requirements of Specification 931.
 - B. Provide a tied joint with #4 bars 25" in length at 24" spacing or #5 bars 30" in length at 36" spacing.
4. Transverse joints are to be spaced at a maximum of 15'. Dowel Bars are required at all transverse joints unless otherwise noted in the plans.
5. Expansion joints to be placed at street intersections and other locations as indicated in the Plans. For bridge expansion joints, see Index 370-001.
6. Punch clean holes in preformed joint filler greater than bar diameter.
7. Coat and lubricate plain steel dowel bars in accordance with Specification 350.
8. Sheet metal bottom strips in accordance with Specification 931. Not required with asphalt base.

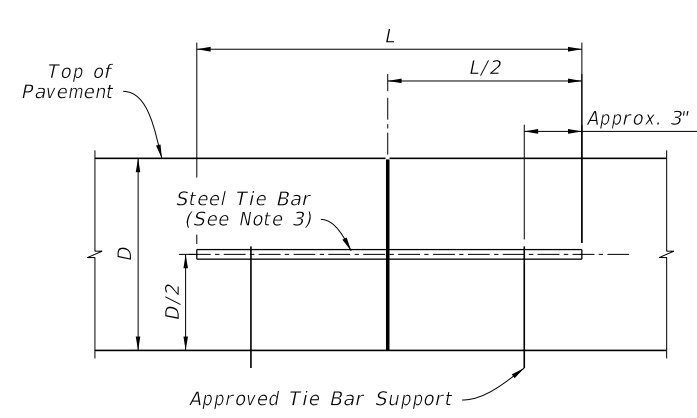

BUTT CONSTRUCTION JOINT

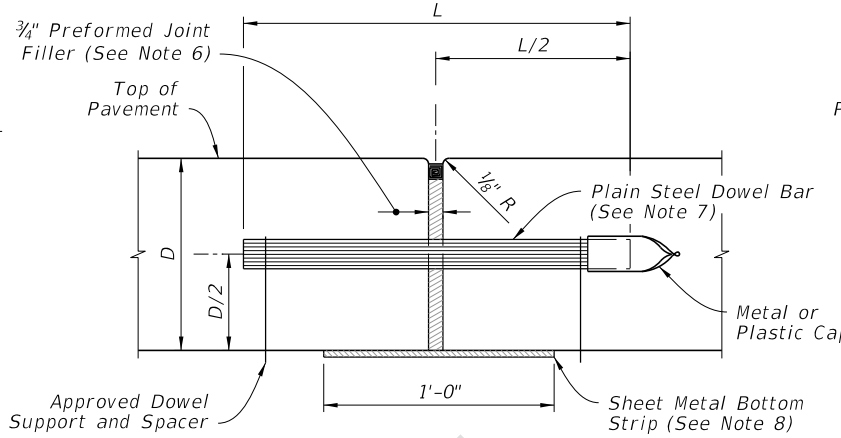

EXPANSION JOINT (See Note 6)

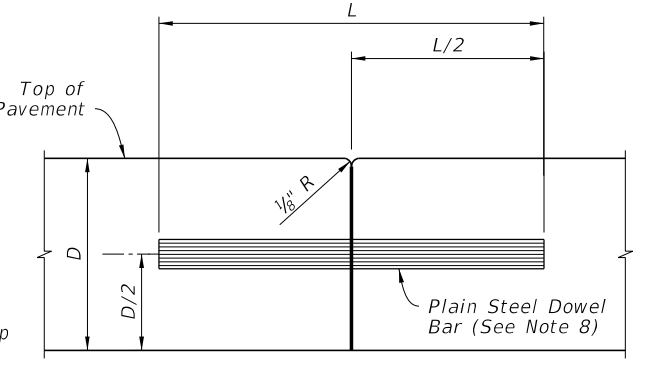

BUTT CONSTRUCTION JOINT (Used At Discontinuance Of Work)

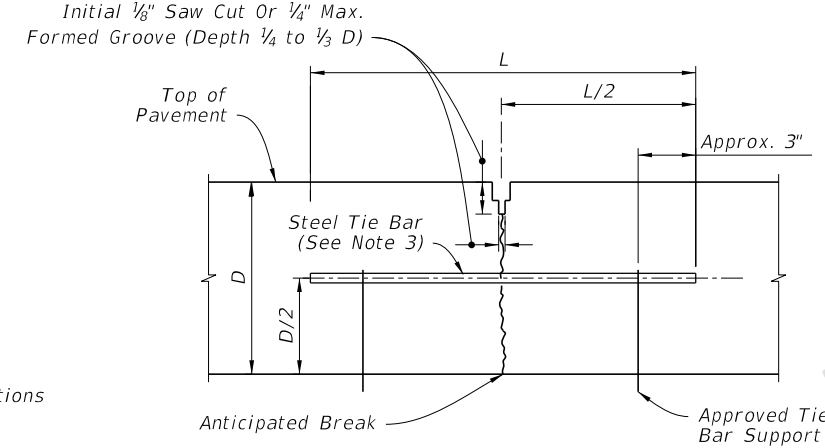

LANE-TIE JOINT (See Note 2)

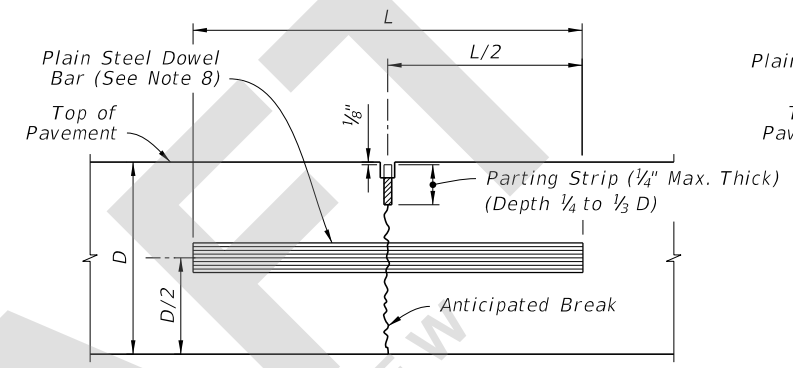

CONTRACTION JOINT (Vibro Case Method)

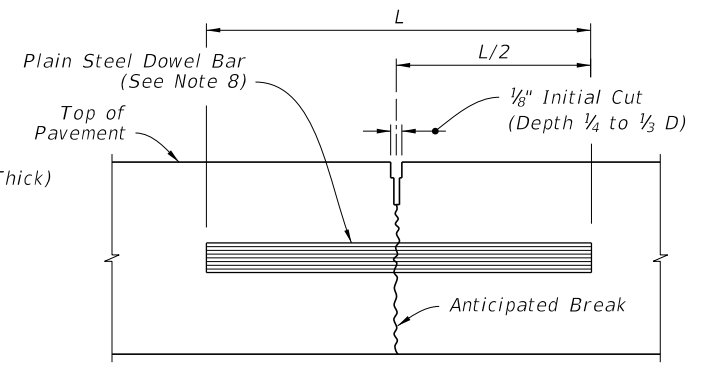

CONTRACTION JOINT (Sawed Method)

LONGITUDINAL JOINTS

TRANSVERSE JOINTS

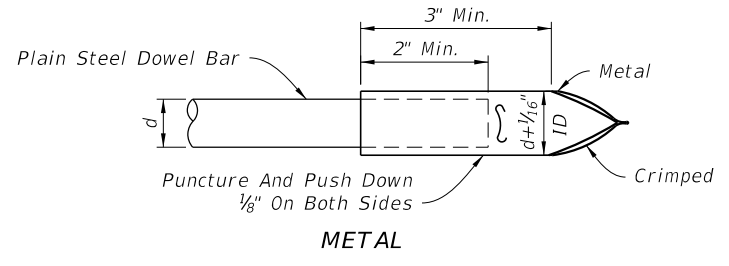

METAL

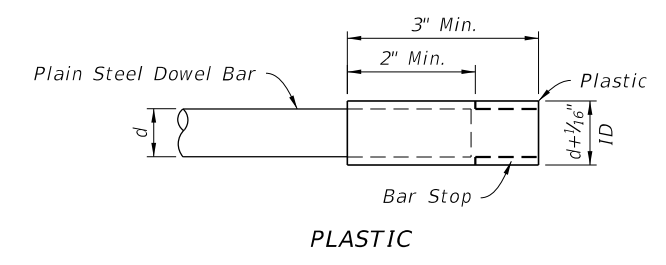

PLASTIC

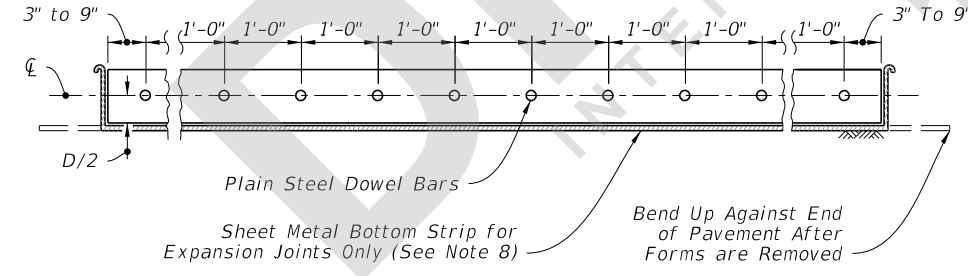

DOWEL BARS (LENGTH 18")	
Pavement Thickness "D"	Diameter
6"-6 1/2"	3/4"
7"-8"	1"
8 1/2"-10 1/2"	1 1/4"
≥11"	1 1/2"

DOWEL BAR LAYOUT

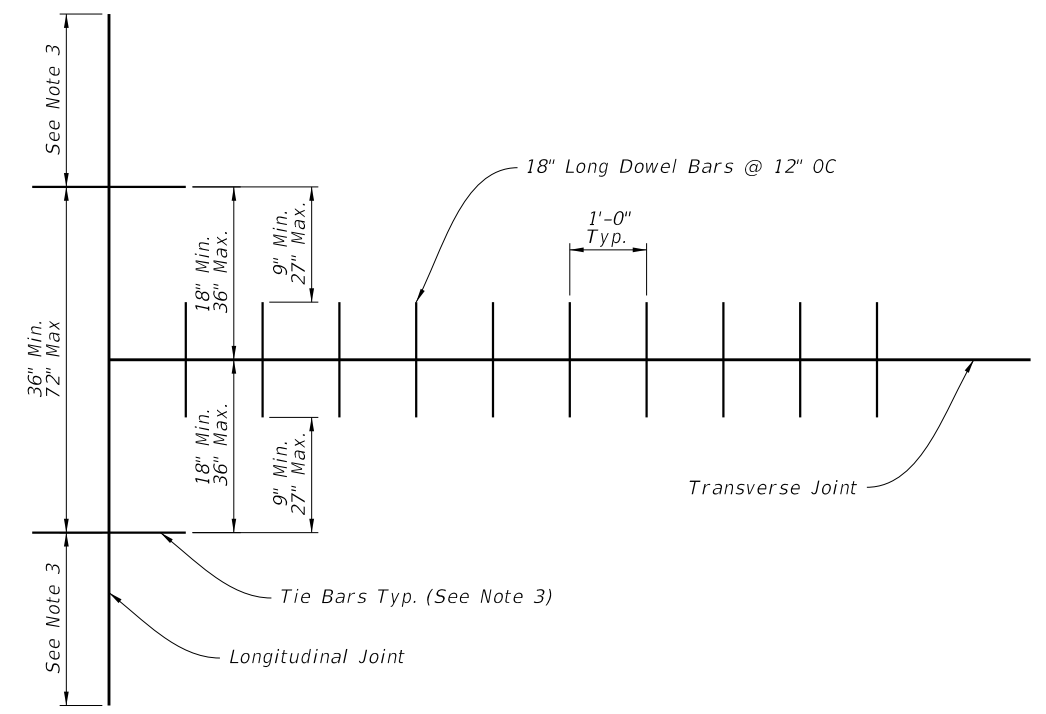

RELATION OF TIE BARS TO DOWEL BARS

7/22/2021 12:05:43 PM