

---

---

## Index 102-665 Limited Access, Temporary Opening

### **ORIGINATION**

**Date:** May 26, 2020

**Name:** Derwood Sheppard

**Phone:** 8(50) 414-4334

**Email:** derwood.sheppard@dot.state.fl.us

### **COMMENTARY**

Sheet 1: Revised Details and Notes 1-3, 9 & 12; Updated Symbols; Deleted Notes 4 & 6;  
Moved Notes 5, 7, 8, & 13 to Spec 102.

### **COMMENTS AND RESPONSES**

**BLACK** = Industry Review Comments    **RED** = Standard Plans Response

**Name:** Dan Preslar / FDOT District 1

**Date:** September 14, 2020

#### **COMMENT:**

Should Note 4 be placed within Spec 102? It establishes criteria for placement in general.

**RESPONSE:** Agreed, the notes have been revised.

**Change Made**

*Date: 09/26/2020*

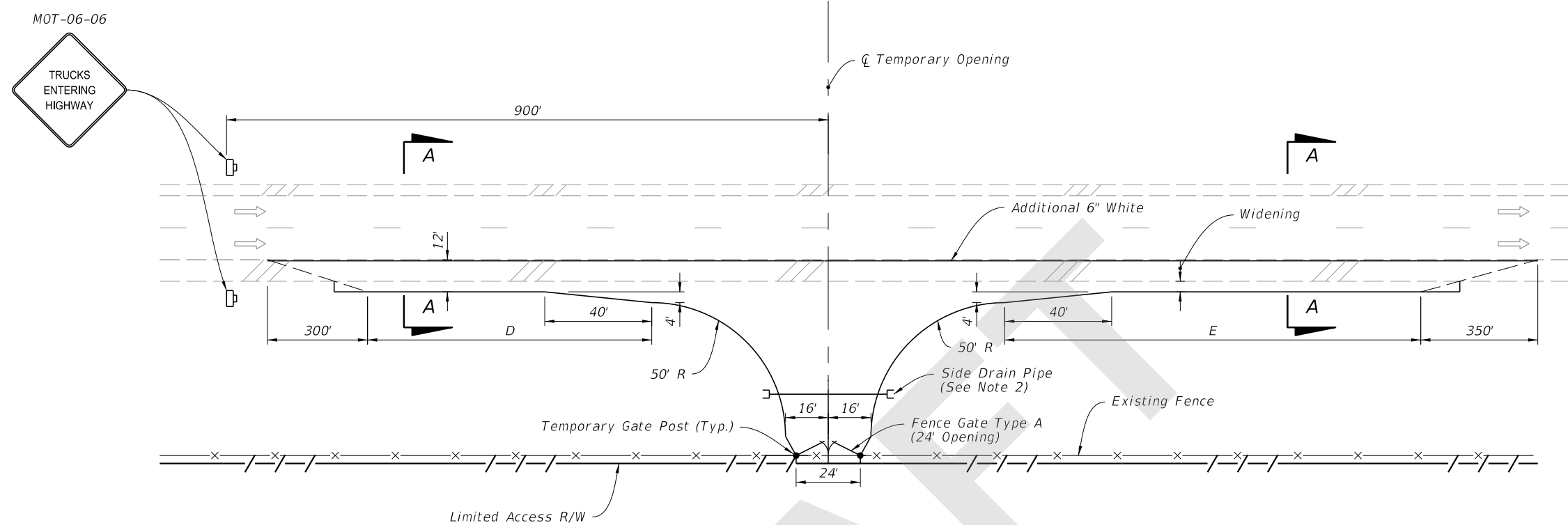

- NOTES:**
1. X = Work Zone Sign Distance, see Index 102-600 for "X" value.
  2. Use mitered end sections for any end sections within the clear zone.
  3. Match cross slope of existing shoulder for widening.
  4. Provide 2' of unpaved shoulder outside of the widening.
  5. No more than two (2) access openings will be allowed on each project.
  6. Do not vary from the plan detail without approval of the Engineer.

- SYMBOLS:**
- Work Zone Sign
  - Lane Identification and Direction of Traffic

LENGTH OF ACCESS LANES		
Grade	D (feet)	E (feet)
2% or less	590	1540
3 to 4% Upgrade	530	2310
3 to 4% Downgrade	710	925

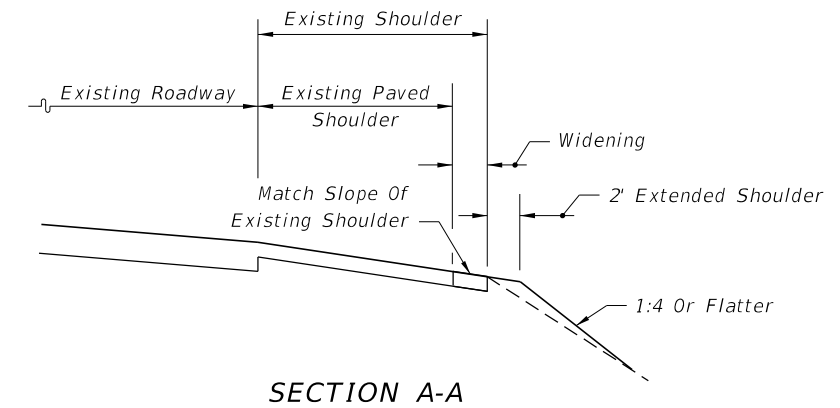

9/18/2020 9:50:38 AM