

---

## ORIGINATION FORM

---

### Proposed Revisions to a Standard Plans Index (Please provide all information — Incomplete forms will be returned)

**Contact Information:**

Date: May 26, 2020

Originator: Derwood Sheppard

Phone: (850) 414-4334

Email: derwood.sheppard@dot.state.fl.us

**Standard Plans:**

Index Number: 102-665

Sheet Number (s): 1

Index Title: Limited Access, Temporary Opening

**Summary of the changes:**

Sheet 1: Revised Details and Notes 1-3, 9 & 12; Updated Symbols; Deleted Notes 4 & 6; Moved Notes 5, 7, 8, & 13 to Spec 102.

**Commentary / Background:****Other Affected Offices / Documents:** (Provide name of person contacted)

- | Yes                                 | No                       |   |
|-------------------------------------|--------------------------|---|
| <input type="checkbox"/>            | <input type="checkbox"/> | Other Standard Plans –                      |
| <input type="checkbox"/>            | <input type="checkbox"/> | FDOT Design Manual –                        |
| <input type="checkbox"/>            | <input type="checkbox"/> | Basis of Estimates Manual –                 |
| <input checked="" type="checkbox"/> | <input type="checkbox"/> | Standard Specifications – Daniel Strickland |
| <input type="checkbox"/>            | <input type="checkbox"/> | Approved Product List –                     |
| <input type="checkbox"/>            | <input type="checkbox"/> | Construction –                              |
| <input type="checkbox"/>            | <input type="checkbox"/> | Maintenance –                               |

**Origination Package Includes:**

(Email or hand deliver package to Rick Jenkins)

- | Yes                                 | N/A                      |  |
|-------------------------------------|--------------------------|--|
| <input checked="" type="checkbox"/> | <input type="checkbox"/> | Redline Mark-ups                         |
| <input type="checkbox"/>            | <input type="checkbox"/> | Proposed Standard Plan Instruction (SPI) |
| <input type="checkbox"/>            | <input type="checkbox"/> | Revised SPI                              |
| <input type="checkbox"/>            | <input type="checkbox"/> | Other Support Documents                  |

**Implementation:**

- |                                     |                                  |
|-------------------------------------|----------------------------------|
| <input type="checkbox"/>            | Design Bulletin (Interim)        |
| <input type="checkbox"/>            | DCE Memo                         |
| <input type="checkbox"/>            | Program Mgmt. Bulletin           |
| <input checked="" type="checkbox"/> | FY-Standard Plans (Next Release) |

---

Contact the Roadway Design Office for assistance in completing this form

---

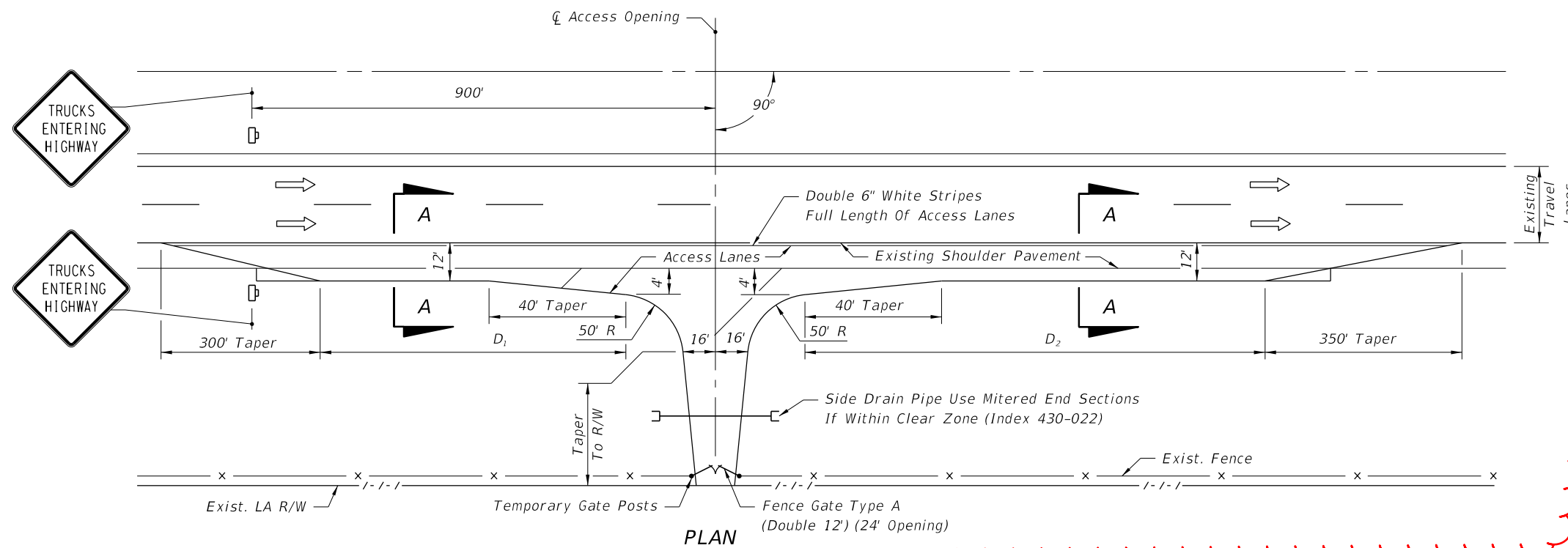

REVISED DETAIL

MOVED TO SPEC 102

REVISED NOTES

GENERAL NOTES

LENGTH OF ACCESS LANES (Ft.)		
Grade	D <sub>1</sub>	D <sub>2</sub>
2% or less	590	1540
3 to 4% Upgrade	530	2310
3 to 4% Downgrade	710	925

1. Access openings across limited access right of way and use of this Index are prohibited unless specifically permitted in the Contract Plans or Special Provisions. When permitted in the Contract Plans or Special Provisions and prior to construction of any opening, the Contractor must submit, in writing, a request identifying specific locations for approval by the Engineer.
2. No more than two (2) access openings will be allowed on each project.
3. Access openings shall be located only in areas having adequate sight distance and shall not be located within 1.5 miles of interchanges nor within 2000 ft. of acceleration-deceleration lanes at rest areas, other access openings or other highway service areas.

7. Access openings in the limited access fence shall have gates which are to be locked during nonwork hours or periods when the access is not in active use.
8. The contractor shall take all precautions necessary to insure against entrance by livestock or unauthorized persons or vehicles.

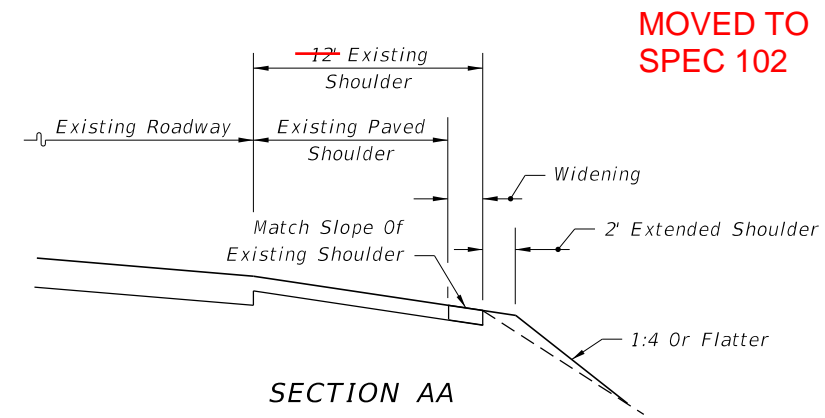

MOVED TO SPEC 102

4. ~~Access openings shall not be constructed directly opposite temporary median crossovers nor within 2000 ft. of temporary median crossovers.~~
5. Access openings shall be within the project limits and shall not be used for transporting materials to or from any other project. The acceleration-deceleration surfaces shall be paved. RAP material is acceptable for driveway surfacing.
6. ~~Any Motorist Aid Call Boxes affected by the temporary access openings shall be relocated outside the limits of access lanes and remain in use during construction. Upon removal of access lanes, call boxes shall be returned to their previous location. Temporary relocation and restoration of call boxes shall be at the contractor's expense.~~

9. The contractor shall not vary from the plan detail without approval of the Engineer.
10. Gates shall be removed and access opening locations shall be restored to preconstruction condition immediately upon completion of activities utilizing the materials being transported through the openings whether or not the project is completed.
11. Failure to comply with any provision of the access opening plan shall be cause for terminating use of all openings. Upon notification by the Engineer, the contractor shall cease hauling and begin restoration of affected areas. Under this condition expense of removal, restoration and of additional hauling distances shall be borne by the contractor.
12. No guardrail or barrier wall will be removed for access openings.

MOVED TO SPEC 102

REVISED NOTES

MOVED TO SPEC 102

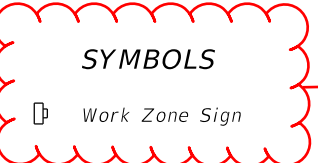

UPDATED SYMBOLS

2021-22

LAST REVISION	DESCRIPTION:
11/01/17	11/01/20

FY 2020-21  
 STANDARD PLANS

LIMITED ACCESS TEMPORARY OPENING

INDEX	SHEET
102-665	1 of 1

2/26/2020 12:44:32 PM

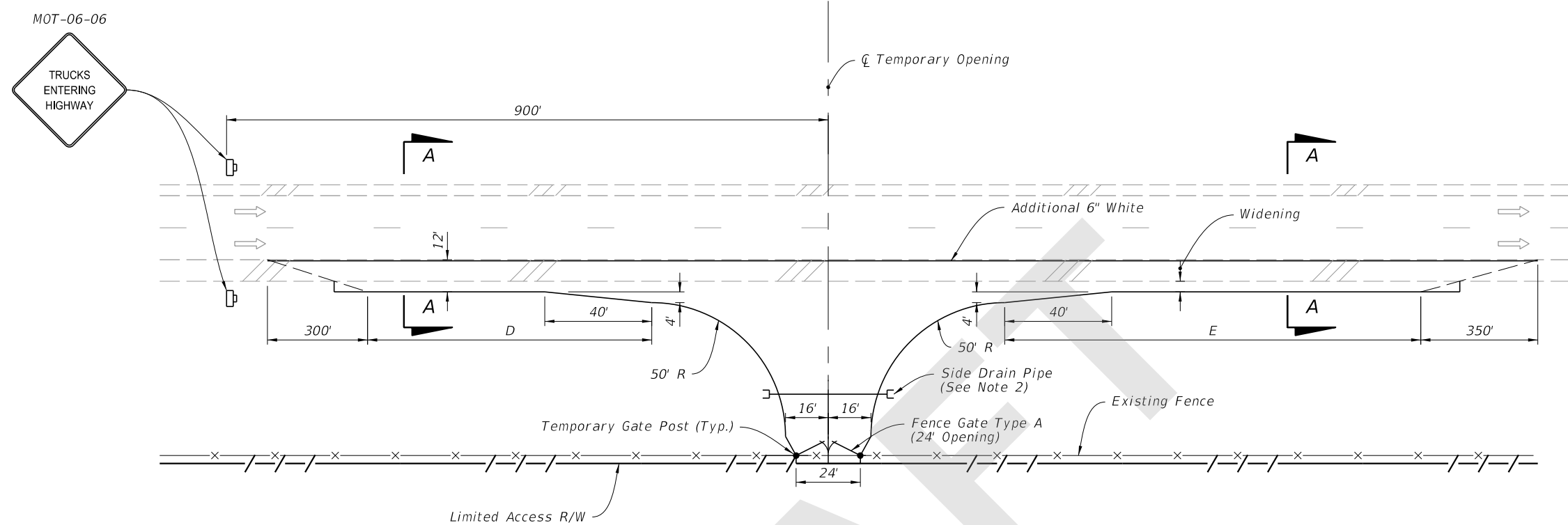

- NOTES:**
1. X = Work Zone Sign Distance, see Index 102-600 for "X" value.
  2. Use mitered end sections for any end sections within the clear zone.
  3. Match cross slope of existing shoulder for widening.
  4. Provide 2' of unpaved shoulder outside of the widening.
  5. No more than two (2) access openings will be allowed on each project.
  6. Do not vary from the plan detail without approval of the Engineer.

- SYMBOLS:**
- Work Zone Sign
  - Lane Identification and Direction of Traffic

LENGTH OF ACCESS LANES		
Grade	D (feet)	E (feet)
2% or less	590	1540
3 to 4% Upgrade	530	2310
3 to 4% Downgrade	710	925

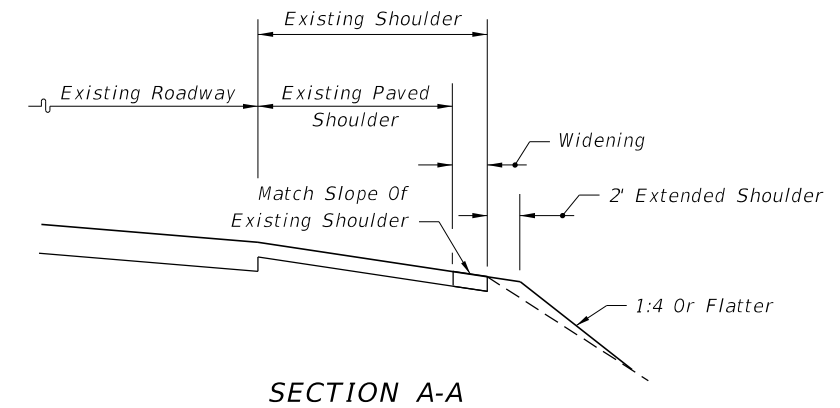

9/18/2020 9:50:38 AM