

---

## Index 102-665 Limited Access, Temporary Opening

### **ORIGINATION**

**Date:** May 26, 2020

**Name:** Derwood Sheppard & Olivia Townsend

**Phone:** 850-414-4334

**Email:** [Derwood.Sheppard@dot.state.fl.us](mailto:Derwood.Sheppard@dot.state.fl.us) or [Olivia.Townsend@dot.state.fl.us](mailto:Olivia.Townsend@dot.state.fl.us)

### **COMMENTARY**

Sheet 1: Revised Details and Notes 1-3, 9 & 12; Updated Symbols; Deleted Notes 4 & 6; Moved Notes 5, 7, 8, & 13 to Spec 102.

### **COMMENTS AND RESPONSES**

**BLACK** = Internal Review Comments    **RED** = Standard Plans Response

**Name:** D5

**Date:** August 21, 2020

**COMMENT:** Sheet 1: Side Drain Pipe callout incorrect. Correct to “See Note 6”

**RESPONSE:** *Agreed*

**Change Made:** *Call-out corrected.*

**Date:** *8/23/2020*

MOT-06-06

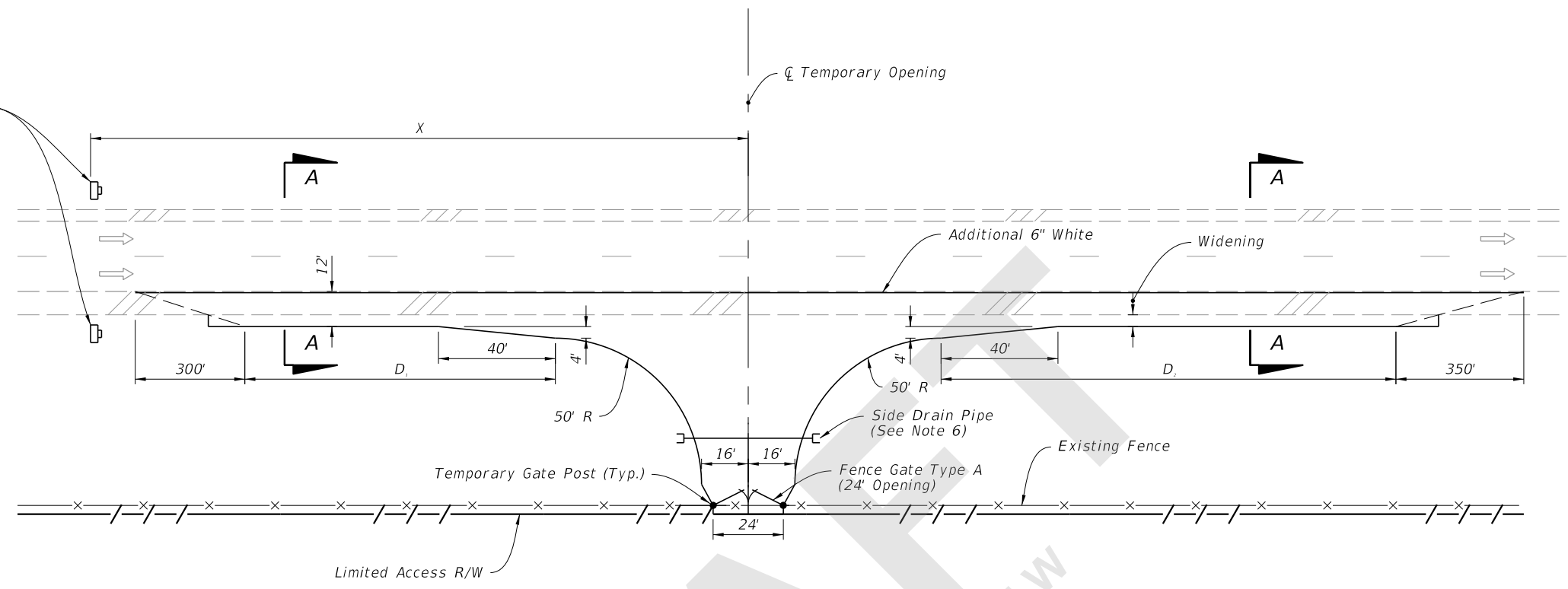

**NOTES:**

1. X = Work Zone Sign Distance, see Index 102-600 for "X" value.
2. Access openings across limited access right of way and use of this Index are prohibited unless specifically permitted in the Contract Documents. When permitted in the Contract Documents and prior to construction of any opening, the Contractor must submit, in writing, a request identifying specific locations within the project limits for approval by the Engineer.
3. Locate temporary openings in areas having adequate sight distance.
4. Do not locate temporary openings within 1.5 miles of interchanges, nor within 2000 feet of the acceleration-deceleration lanes at rest areas, median openings, other access openings, or other highway service areas.
5. Do not remove existing guardrail or barrier for temporary openings.
6. Use mitered end sections for any end sections within the clear zone.
7. Match cross slope of existing shoulder for widening.
8. Provide 2' of unpaved shoulder outside of the widening.
9. No more than two (2) access openings will be allowed on each project.
10. Do not vary from the plan detail without approval of the Engineer.

**SYMBOLS:**

- Work Zone Sign
- Lane Identification and Direction of Traffic

LENGTH OF ACCESS LANES		
Grade	D <sub>1</sub> (feet)	D <sub>2</sub> (feet)
2% or less	590	1540
3 to 4% Upgrade	530	2310
3 to 4% Downgrade	710	925

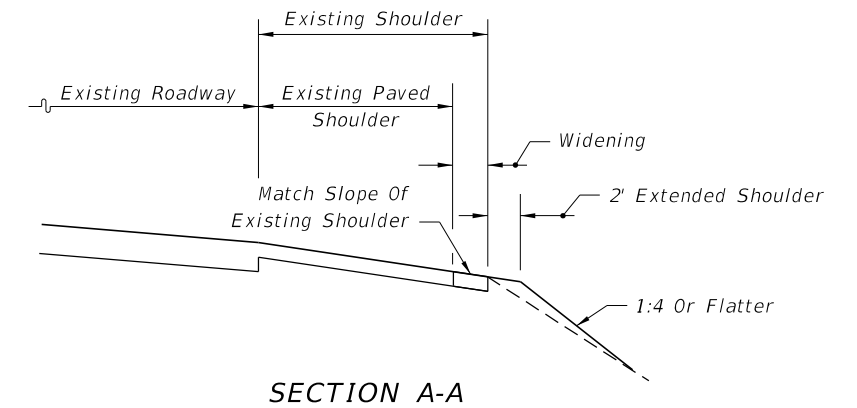

8/31/2020 6:09:48 AM