

Index 425-031

Shoulder Barrier Inlet (Adjacent Barrier Inlet)

ORIGINATION

Date: July 1, 2019

Name: Richard Stepp

Phone: 850-414-4313

Email: richard.stepp@dot.state.fl.us

COMMENTARY

All Sheets: Changed Index title to: "Adjacent Barrier Inlet"

Sheet 1: Changed GENERAL NOTE 1 to include median barriers. Updated section labels to include median barriers

COMMENTS AND RESPONSES

BLACK = Industry Review Comments **RED** = Standard Plans Response

Name: Turnpike

Date: August 8, 2019

COMMENT:

- (1) Index 521-001 - Concrete Barrier, has mainly two barriers; shoulder and median. The barrier wall inlets were changed previously to follow these two barrier types; shoulder barrier inlet and median barrier inlet (425-030). This revision adds that this shoulder inlet is now also allowed for median barrier and the name changed to "adjacent barrier inlet". We want to verify that it is okay to use this inlet for at-grade median barrier that only has a base that is 6 inches below grade and does not have a footer per say?

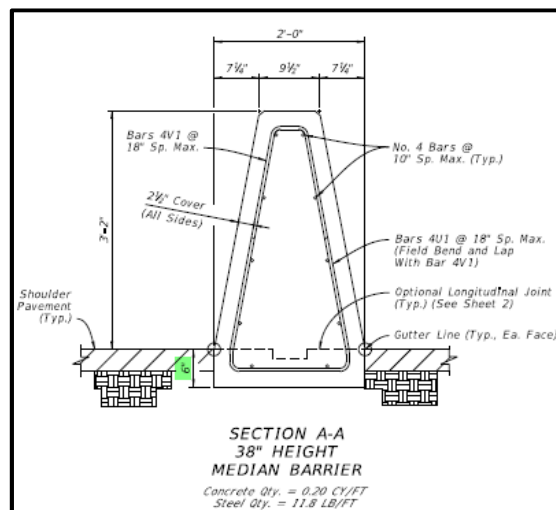

- (2) Recommend the name be changed to “barrier inlet” (remove “adjacent”). This applies to where it is noted in 521-001 as well.
- (3) here are times when a barrier inlet is needed in a shoulder that is in transition. When this occurs, a special design is needed to modify the top. Can this index be modified to include the structural requirements for varying top slopes (maybe in a table)? Say 0.05, 0.04, 0.03, and 0.02?

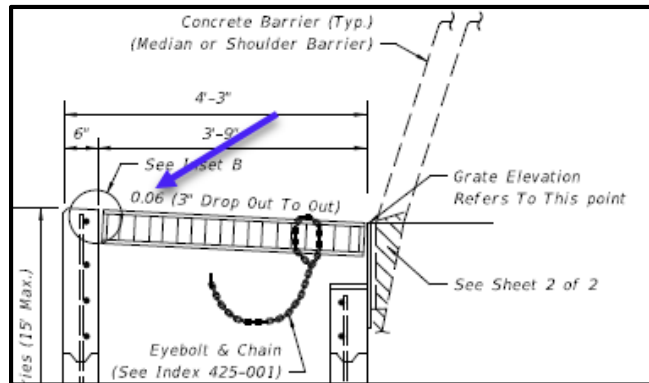
**RESPONSE:**

Date: August 27, 2019

- (1) OK as-is. Yes, the intent is to allow usage with median barrier for the cases not covered in 425-030 (see Origination Form).
- (2) OK as-is. This was changed to provide a better description of the intended use of the inlet.
- (3) This comment is beyond the scope the proposed revisions. This is logged for consideration in the next cycle's Standard Plans.