

# ORIGINATION FORM

Proposed Revisions to a Standard Plans Index  
(Please provide all information – Incomplete forms will be returned)

## Contact Information:

Date: July 3, 2018  
Originator: **Ed Cashman**  
Phone: (850) 414-4314  
Email: edward.cashman@dot.state.fl.us

## Standard Plans:

Index Number: **706-001**  
Sheet Number (s): 5-6  
Index Title: Typical Placement of Raised Pavement Markers

## Summary of the changes:

Sheet 4: Changed and Deleted RPMs in the RPM PLACEMENT AT ISLANDS, Details G and H.  
Sheet 5: Added new sheet showing the placement of raised pavement markers at limited access crossovers.  
Sheet 6: Added new sheet showing the placement of blue raised pavement markers.

## Commentary / Background:

The installation of raised pavement markers at limited access crossovers is typical and should not have to be detailed in the Plans. Blue raised pavement markers are used to mark fire hydrants, but the maintenance has been an issue in the past (this was an innovative idea).

## Other Affected Offices / Documents: (Provide name of responsible personnel)

Yes	No	
<input checked="" type="checkbox"/>	<input type="checkbox"/>	Other Standard Plans – Ed Cashman
<input checked="" type="checkbox"/>	<input type="checkbox"/>	FDOT Design Manual – Mary Jane Hayden
<input type="checkbox"/>	<input checked="" type="checkbox"/>	Basis of Estimates Manual –
<input type="checkbox"/>	<input checked="" type="checkbox"/>	Standard Specifications –
<input type="checkbox"/>	<input checked="" type="checkbox"/>	Approved Product List –
<input type="checkbox"/>	<input checked="" type="checkbox"/>	Construction –
<input type="checkbox"/>	<input checked="" type="checkbox"/>	Maintenance –

## Origination Package Includes: (Email or hand deliver package to Derwood Sheppard)

Yes	N/A	
<input checked="" type="checkbox"/>	<input type="checkbox"/>	Redline Mark-ups
<input type="checkbox"/>	<input checked="" type="checkbox"/>	Proposed Standard Plan Instructions (SPI)
<input type="checkbox"/>	<input checked="" type="checkbox"/>	Revised SPI
<input type="checkbox"/>	<input checked="" type="checkbox"/>	Other Support Documents

## Implementation:

Design Bulletin (Interim)    DCE Memo    Program Mgmt. Bulletin    FY-Standard Plans (Next Release)

Contact the Roadway Design Office for assistance in completing this form

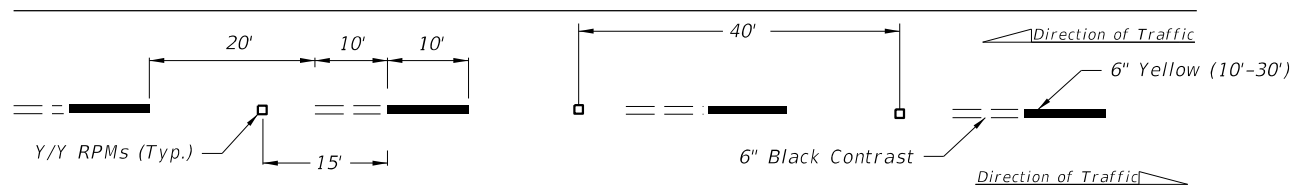

ALTERNATING SKIP LINE

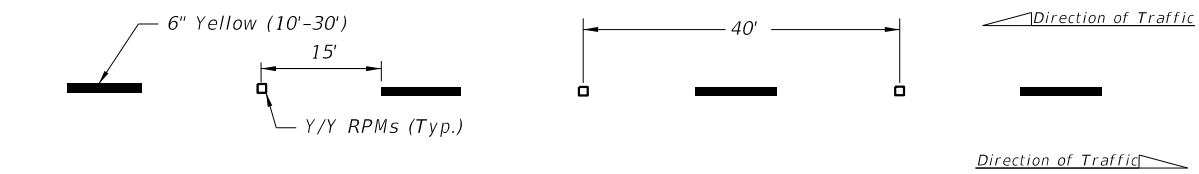

SKIP LINE

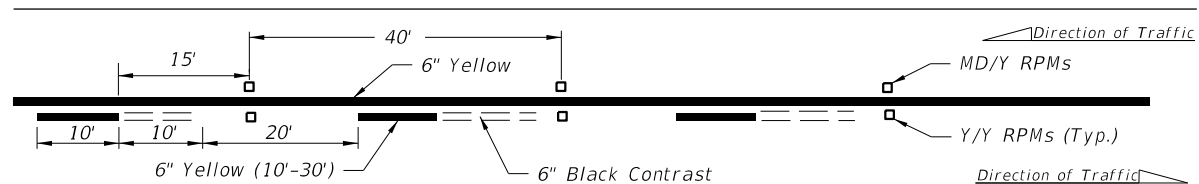

SOLID LINE WITH ALTERNATING SKIP

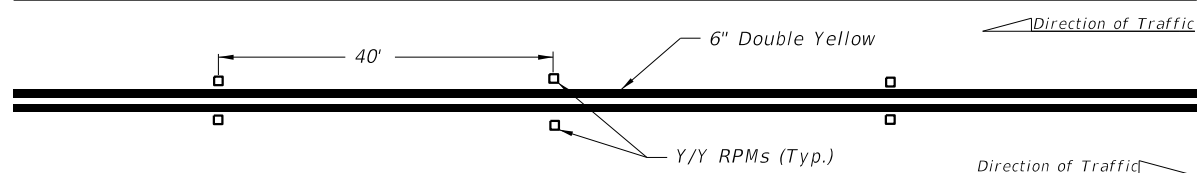

DOUBLE SOLID LINE

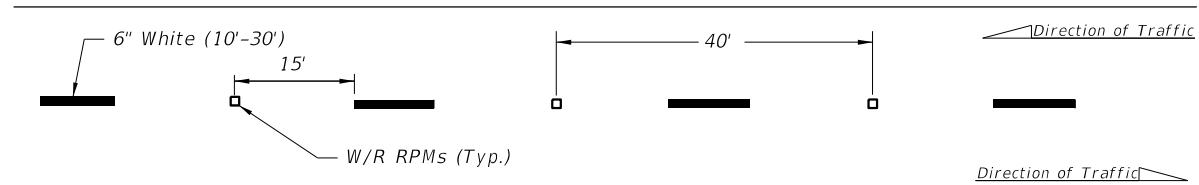

MULTILANE

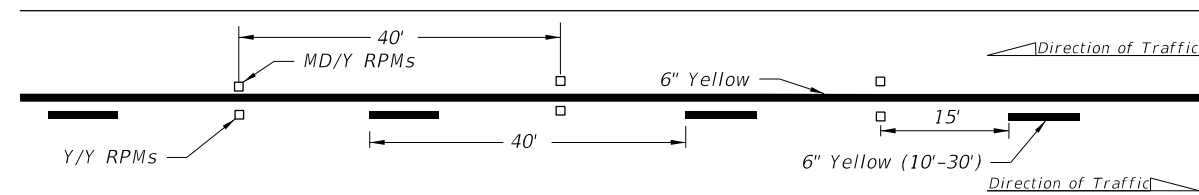

SOLID LINE WITH SKIP

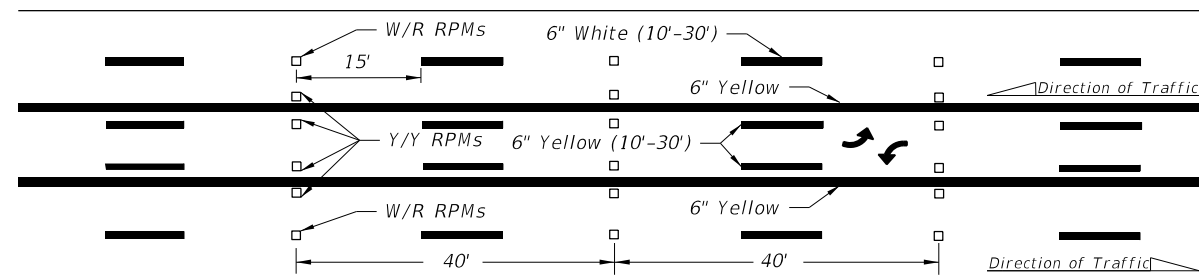

SKIP LINE WITH TWO-WAY LEFT TURN LANE

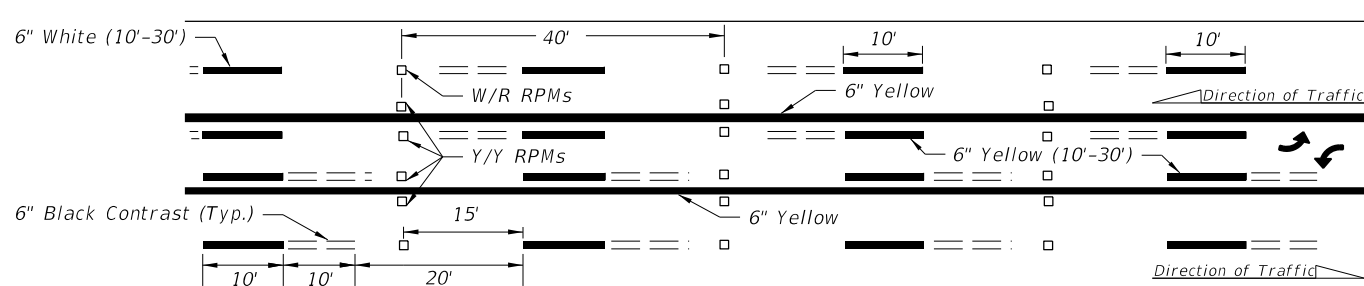

ALTERNATING SKIP LINE WITH TWO-WAY LEFT TURN LANE

**GENERAL NOTES:**

1. Offset all RPMs 1" from solid longitudinal lines unless otherwise noted or shown.
2. Spacing may be reduced for sharp curves if required.
3. For placement of RPMs on ramps, see Index 711-003.
4. Make the traffic face of the RPM the same color as the pavement marking that it is supplementing.

**LEGEND:**

- B/C = BACK OF CURB
- EOP = EDGE OF PAVEMENT
- RPM = RAISED PAVEMENT MARKER
- W/R = WHITE/RED RPM
- Y/Y = YELLOW/YELLOW RPM
- Y/R = YELLOW/RED RPM
- MD/Y = MONO-DIRECTIONAL YELLOW RPM

10/23/2017 8:03:02 AM

Renumbered: 1 of 6

LAST REVISION <del>11/01/17</del>	REVISION ← 11/01/18	DESCRIPTION:		FY 2018-19 STANDARD PLANS	TYPICAL PLACEMENT OF RAISED PAVEMENT MARKERS	INDEX 706-001	SHEET 1 of 4
--------------------------------------	------------------------	--------------	--	------------------------------	---	------------------	-----------------

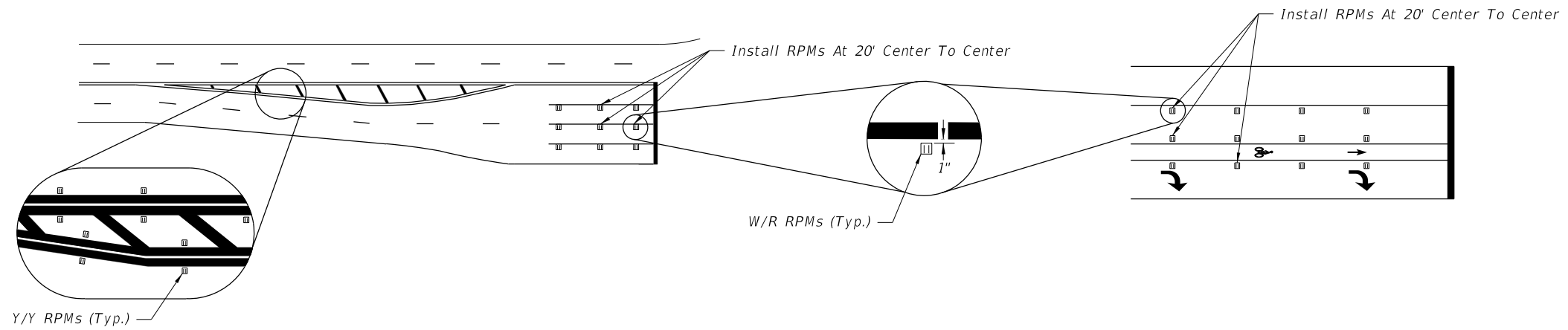

RPM PLACEMENT AT INTERSECTIONS

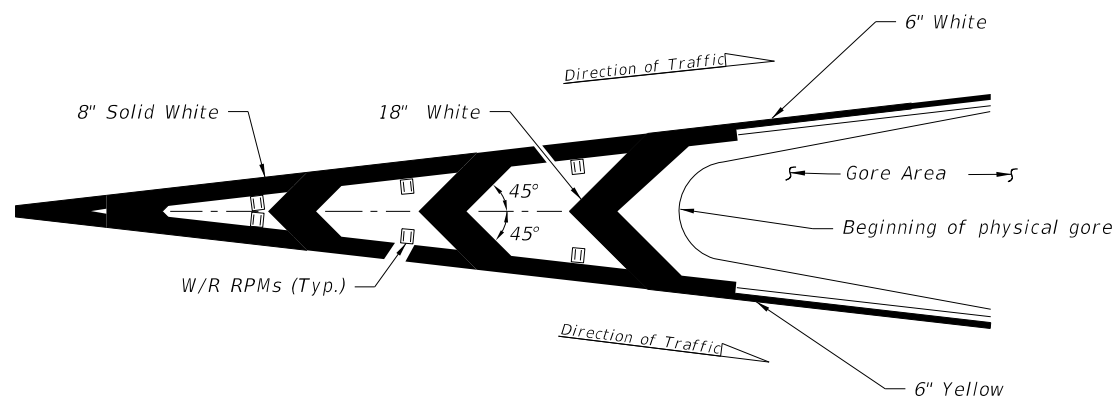

RPM PLACEMENT AT TRAFFIC CHANNELIZATION AT GORE  
(Traffic Flows In Same Direction)

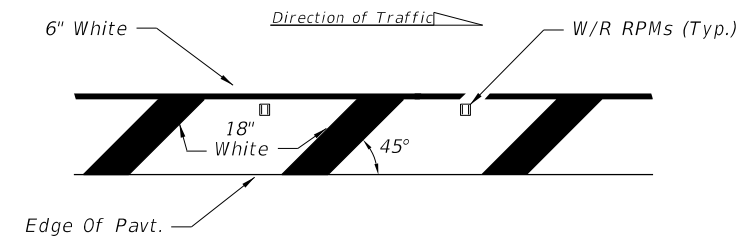

Right side of the roadway shown. For the left side of roadway, the pavement marking is yellow and oriented opposite hand.

RPM PLACEMENT AT ROADSIDE CROSSHATCHING

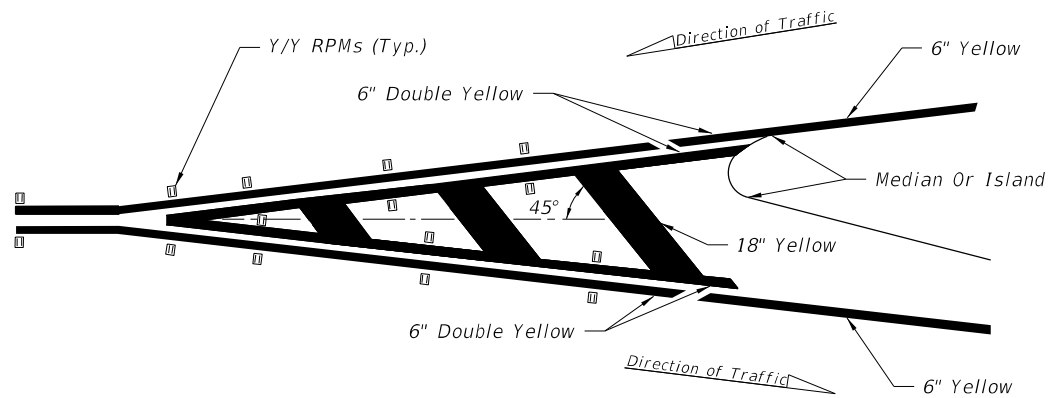

RPM PLACEMENT AT TRAFFIC SEPARATION  
(Traffic Flows In Opposite Direction)

**NOTE:**

- Center the Raised Pavement Markers between chevrons and crosshatching.

**LEGEND:**

- B/C = BACK OF CURB
- EOP = EDGE OF PAVEMENT
- RPM = RAISED PAVEMENT MARKER
- W/R = WHITE/RED RPM
- Y/Y = YELLOW/YELLOW RPM
- Y/R = YELLOW/RED RPM
- MD/Y = MONO-DIRECTIONAL YELLOW RPM

Renumbered: 2 of 6

10/23/2017 8:03:02 AM

LAST REVISION <del>11/01/17</del>	REVISION ← 11/01/18	DESCRIPTION:		FY 2018-19 STANDARD PLANS	TYPICAL PLACEMENT OF RAISED PAVEMENT MARKERS	INDEX 706-001	SHEET <del>2 of 4</del>
--------------------------------------	------------------------	--------------	--	------------------------------	---	------------------	----------------------------

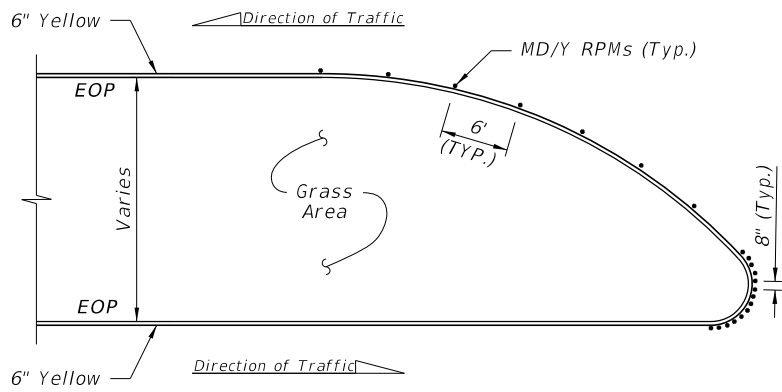

DETAIL "A"

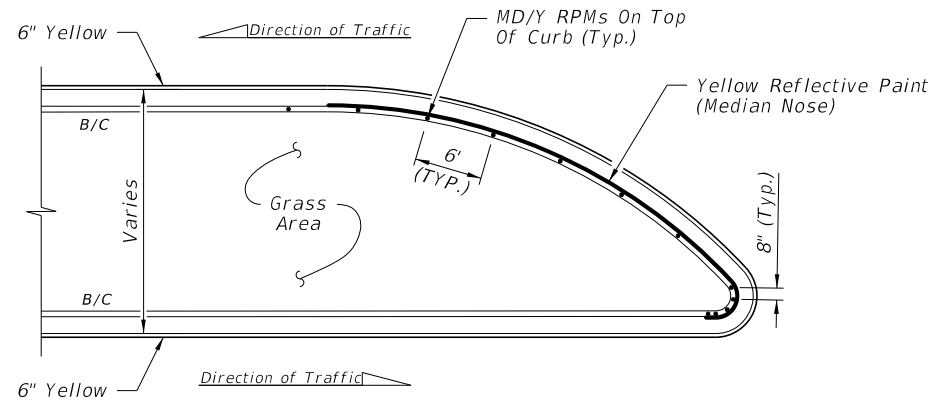

DETAIL "D"

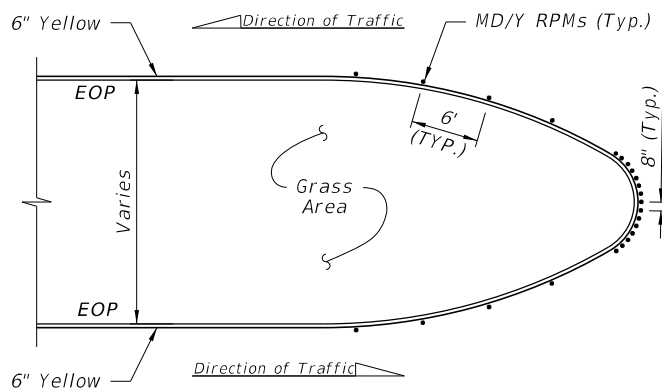
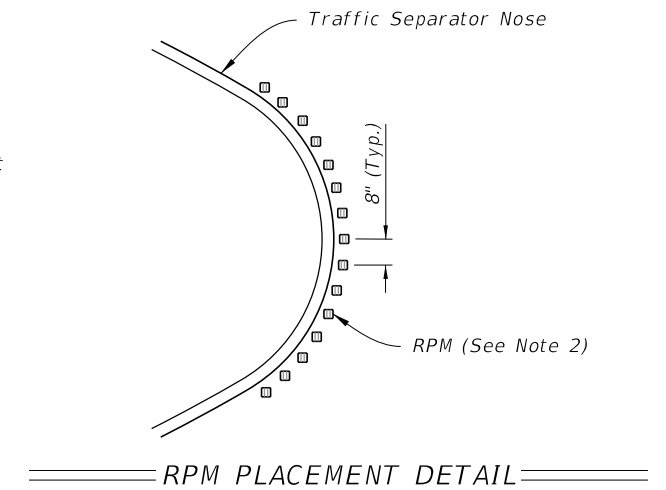

DETAIL "B"

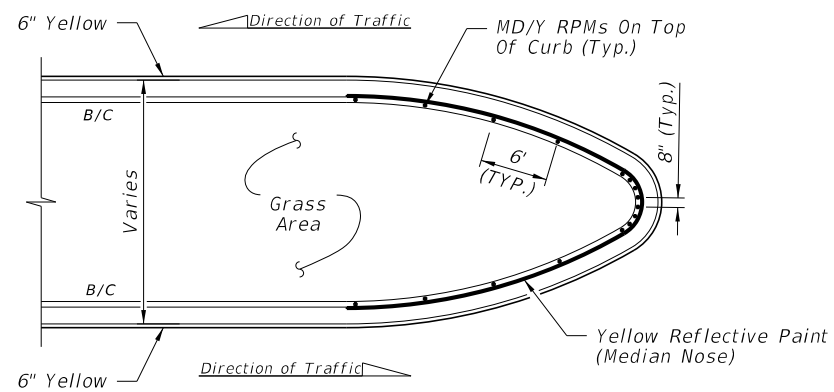

DETAIL "E"

POSTED SPEED LIMIT MPH	"Y" FEET
30 OR LESS	10
35	20
40	20
45	30
50 OR MORE	40

**LEGEND:**

- B/C = BACK OF CURB
- EOP = EDGE OF PAVEMENT
- RPM = RAISED PAVEMENT MARKER
- W/R = WHITE/RED RPM
- Y/Y = YELLOW/YELLOW RPM
- Y/R = YELLOW/RED RPM
- MD/Y = MONO-DIRECTIONAL YELLOW RPM

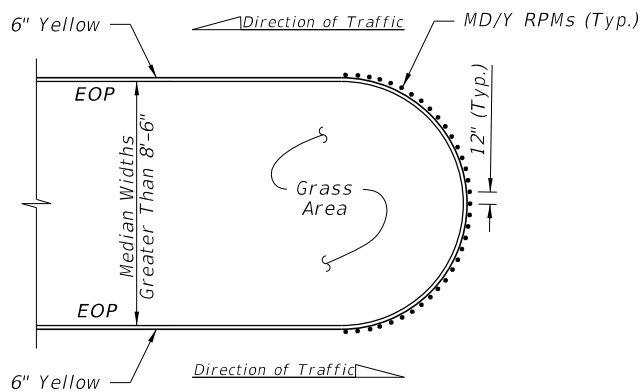

DETAIL "C"

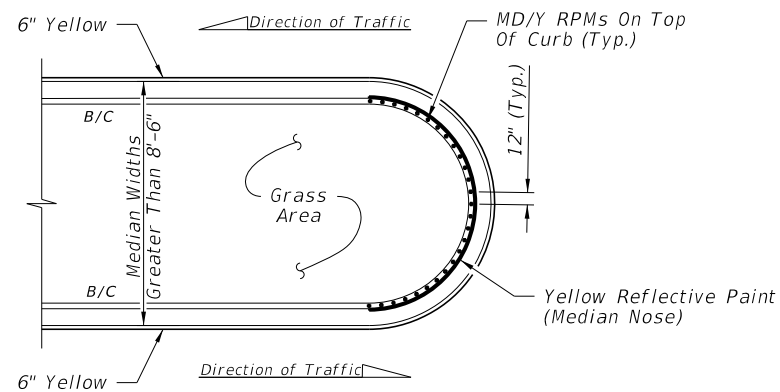

DETAIL "F"

**NOTES:**

1. For Type "E" Curb, install RPMs along the pavement edge marking using the same spacing shown.
2. Orient traffic faces of RPMs in curb median radii to be parallel to direction of travel lanes.

FLUSH MEDIAN OPENINGS

TYPE "D" OR "F" CURB

RPM PLACEMENT AT MEDIAN OPENINGS  
(When called for in the Plans)

Renumbered: 3 of 6

3/29/2018 12:49:14 PM

LAST REVISION <del>11/01/17</del>	DESCRIPTION: ← 11/01/18
--------------------------------------	----------------------------



FY 2018-19  
STANDARD PLANS

TYPICAL PLACEMENT OF  
RAISED PAVEMENT MARKERS

INDEX  
706-001

SHEET  
3 of 4

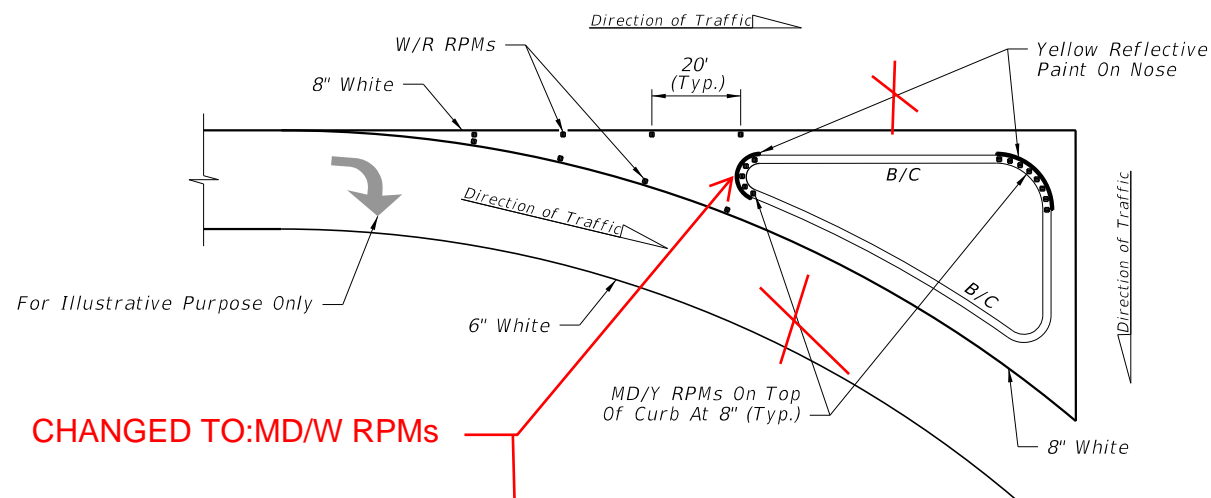

CHANGED TO: MD/W RPMs

DETAIL "G"

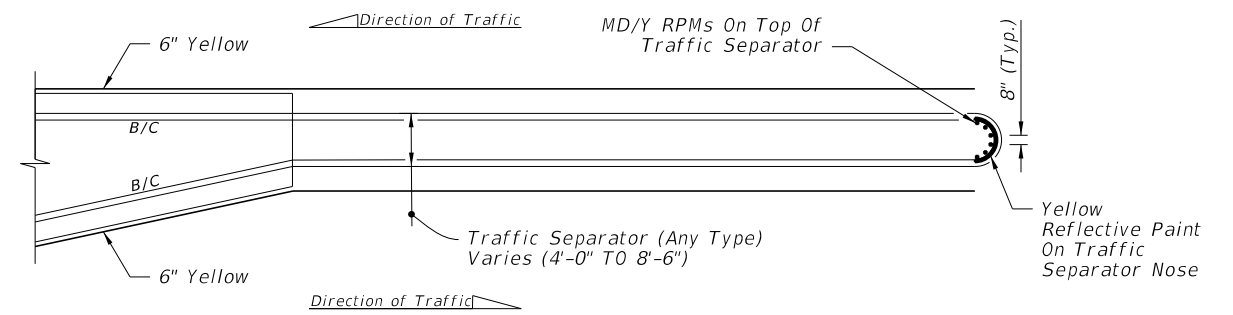

DETAIL "J"

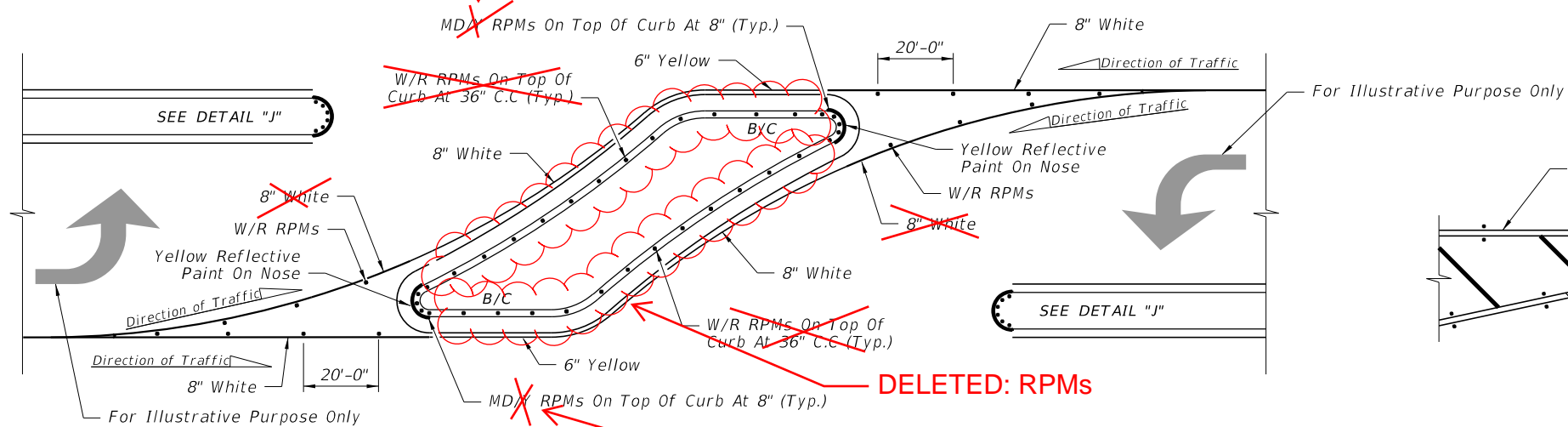

DELETED: RPMs

CHANGED TO: MD/W RPMs

DETAIL "H"

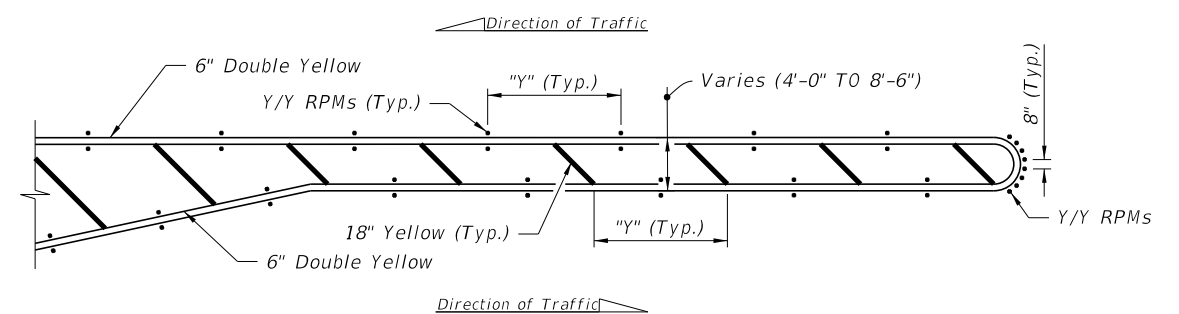

DETAIL "K"

RPM PLACEMENT AT ISLANDS  
(When called for in the Plans)

RPM PLACEMENT AT TRAFFIC SEPARATORS  
(When called for in the Plans)

POSTED SPEED LIMIT MPH	"y" FEET
30 OR LESS	10
35	20
40	20
45	30
50 OR MORE	40

NOTES:

- For Type "E" Curb install RPMs along the pavement edge marking using the same spacing shown.
- Orient traffic faces of RPMs in median radii to be parallel to direction of travel lanes.

LEGEND:

- B/C = BACK OF CURB
- EOP = EDGE OF PAVEMENT
- RPM = RAISED PAVEMENT MARKER
- W/R = WHITE/RED RPM
- Y/Y = YELLOW/YELLOW RPM
- Y/R = YELLOW/RED RPM
- MD/Y = MONO-DIRECTIONAL YELLOW RPM

Added: MD/W

Renumbered: 4 of 6

3/29/2018 12:49:14 PM

LAST REVISION	DESCRIPTION:
11/01/17	← 11/01/18



FY 2018-19  
STANDARD PLANS

TYPICAL PLACEMENT OF  
RAISED PAVEMENT MARKERS

INDEX  
706-001

SHEET  
4 of 4

NEW SHEET 5 OF 6

RPM PLACEMENT FOR CROSSOVERS ON LIMITED ACCESS ROADWAYS

NEW SHEET 6 OF 6  
BLUE RPM PLACEMENT

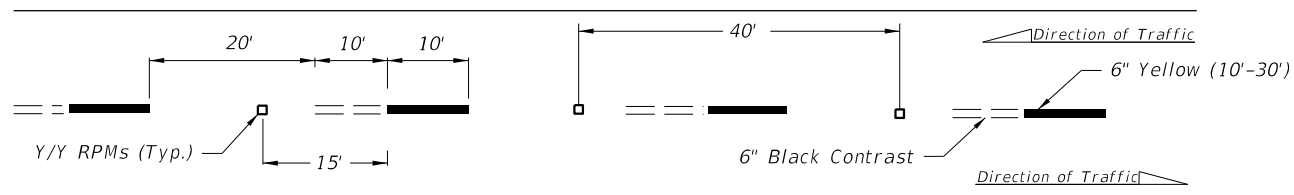

ALTERNATING SKIP LINE

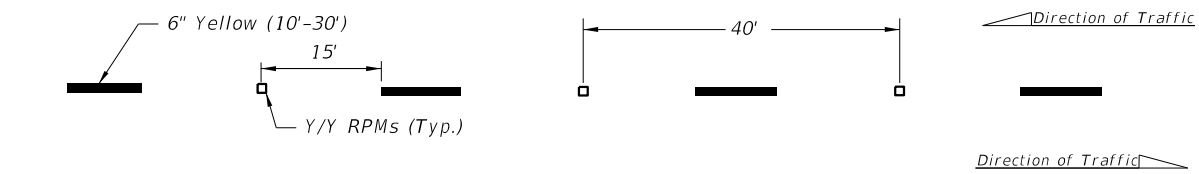

SKIP LINE

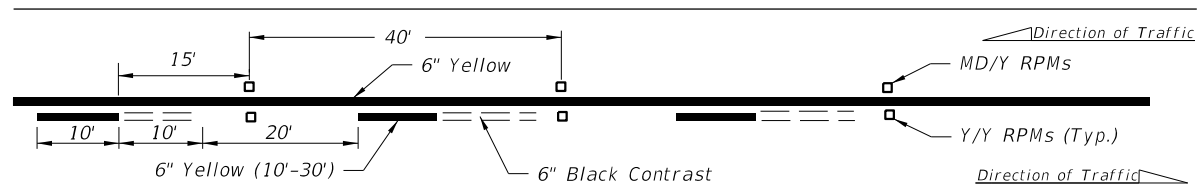

SOLID LINE WITH ALTERNATING SKIP

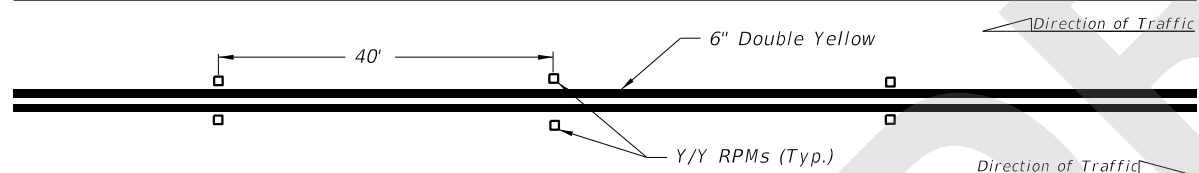

DOUBLE SOLID LINE

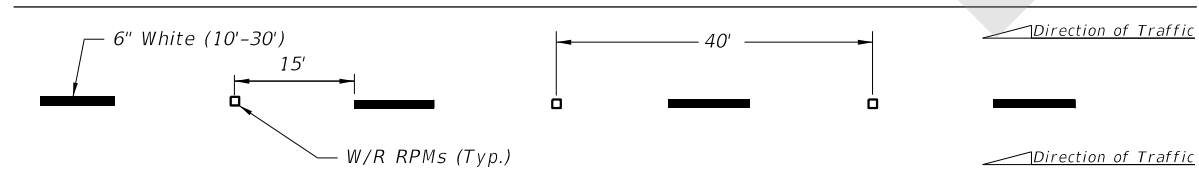

MULTILANE

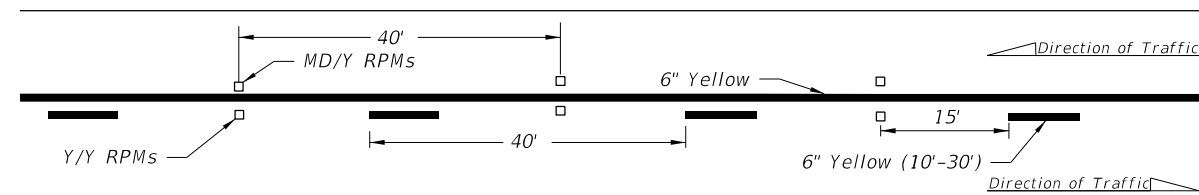

SOLID LINE WITH SKIP



SKIP LINE WITH TWO-WAY LEFT TURN LANE

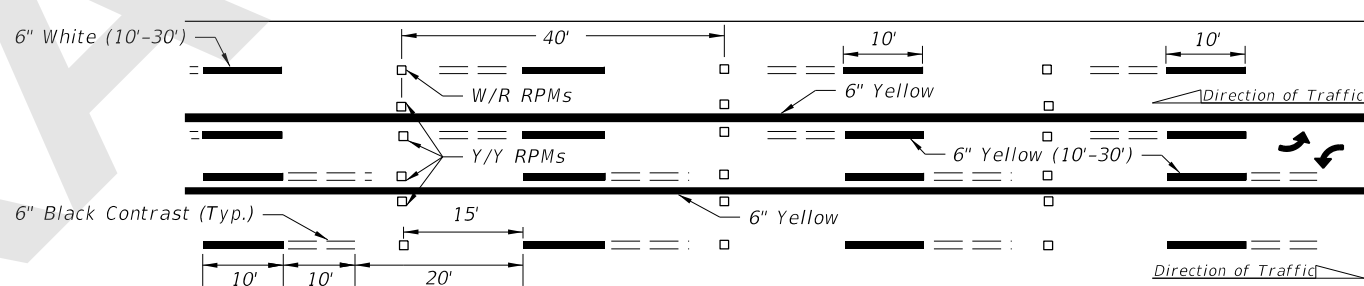

ALTERNATING SKIP LINE WITH TWO-WAY LEFT TURN LANE

**GENERAL NOTES:**

1. Offset all RPMs 1" from solid longitudinal lines unless otherwise noted or shown.
2. Spacing may be reduced for sharp curves if required.
3. For placement of RPMs on ramps, see Index 711-003.
4. Make the traffic face of the RPM the same color as the pavement marking that it is supplementing.

**LEGEND:**

- B/C = BACK OF CURB
- EOP = EDGE OF PAVEMENT
- RPM = RAISED PAVEMENT MARKER
- W/R = WHITE/RED RPM
- Y/Y = YELLOW/YELLOW RPM
- Y/R = YELLOW/RED RPM
- MD/Y = MONO-DIRECTIONAL YELLOW RPM

8/14/2018 11:19:23 AM

LAST REVISION 11/01/18	REVISION	DESCRIPTION:	 FY 2019-20 STANDARD PLANS	<b>TYPICAL PLACEMENT OF          RAISED PAVEMENT MARKERS</b>	INDEX <b>706-001</b>	SHEET <b>1 of 6</b>
---------------------------	----------	--------------	---	--	-------------------------	------------------------



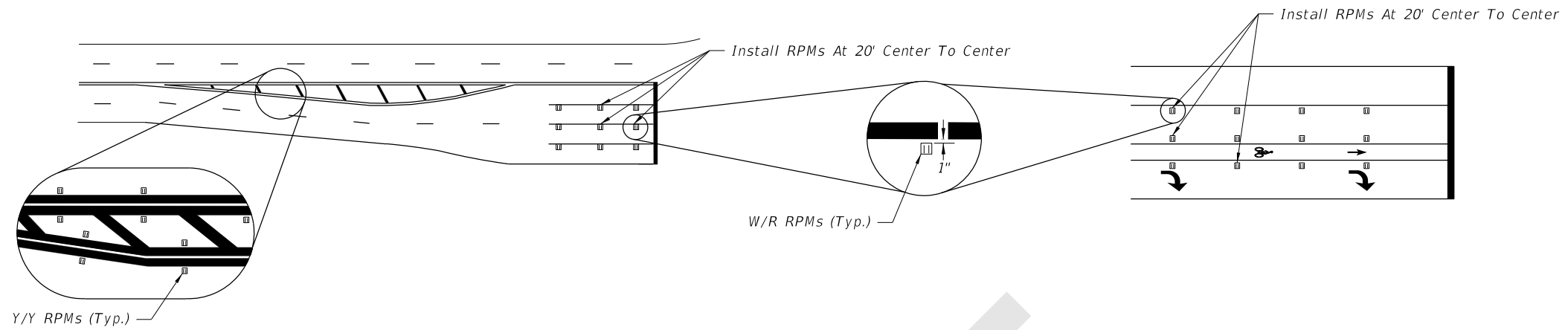

RPM PLACEMENT AT INTERSECTIONS

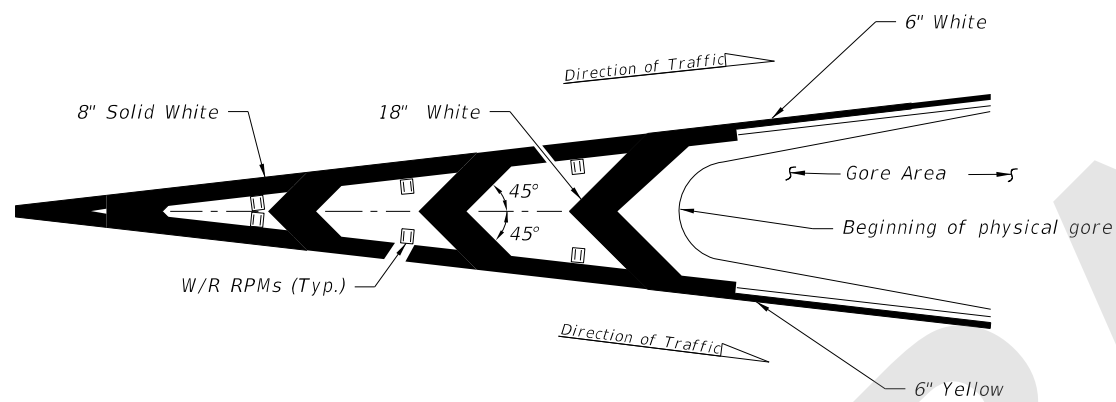

RPM PLACEMENT AT TRAFFIC CHANNELIZATION AT GORE  
(Traffic Flows In Same Direction)

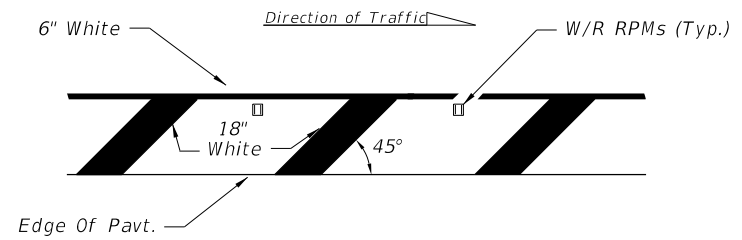

Right side of the roadway shown. For the left side of roadway, the pavement marking is yellow and oriented opposite hand.

RPM PLACEMENT AT ROADSIDE CROSSHATCHING

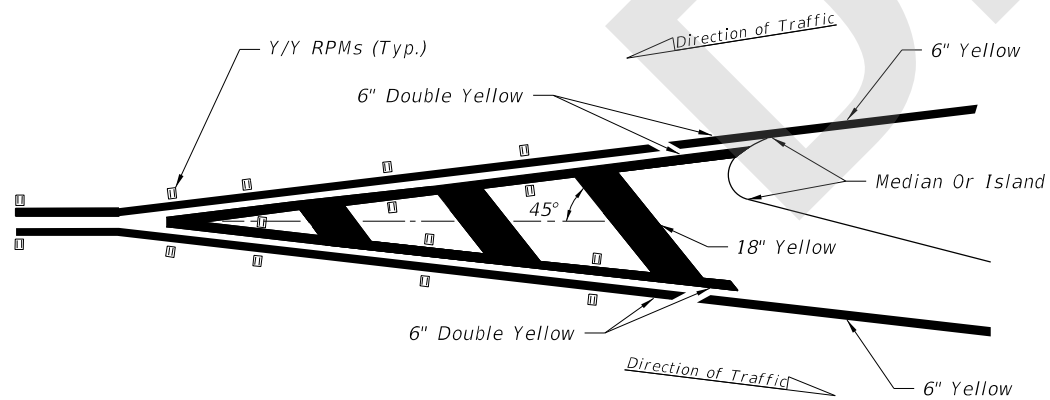

RPM PLACEMENT AT TRAFFIC SEPARATION  
(Traffic Flows In Opposite Direction)

**NOTE:**

1. Center the Raised Pavement Markers between chevrons and crosshatching.

**LEGEND:**

- B/C = BACK OF CURB
- EOP = EDGE OF PAVEMENT
- RPM = RAISED PAVEMENT MARKER
- W/R = WHITE/RED RPM
- Y/Y = YELLOW/YELLOW RPM
- Y/R = YELLOW/RED RPM
- MD/Y = MONO-DIRECTIONAL YELLOW RPM

8/14/2018 11:19:23 AM

LAST REVISION 11/01/18	REVISION	DESCRIPTION:		FY 2019-20 STANDARD PLANS	TYPICAL PLACEMENT OF RAISED PAVEMENT MARKERS	INDEX 706-001	SHEET 2 of 4
---------------------------	----------	--------------	--	------------------------------	---	------------------	-----------------

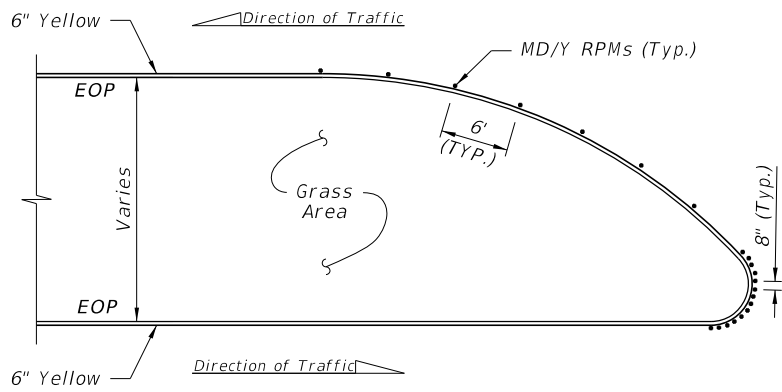

DETAIL "A"

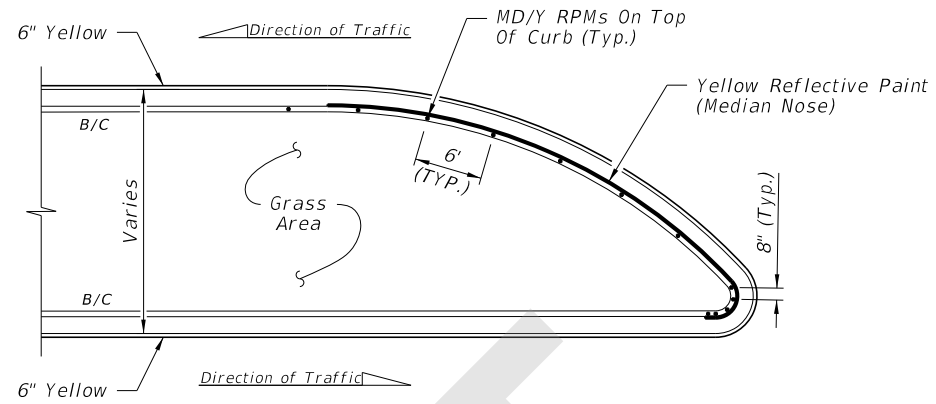

DETAIL "D"

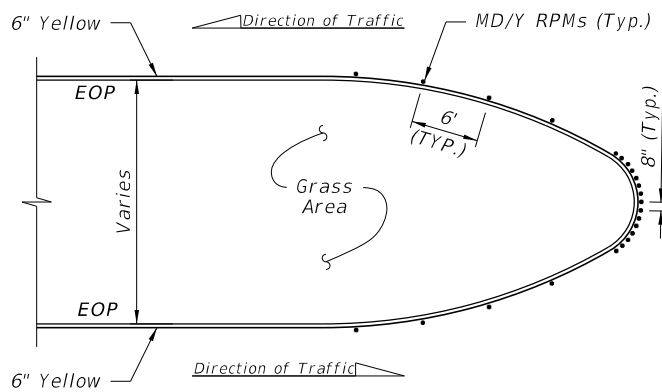
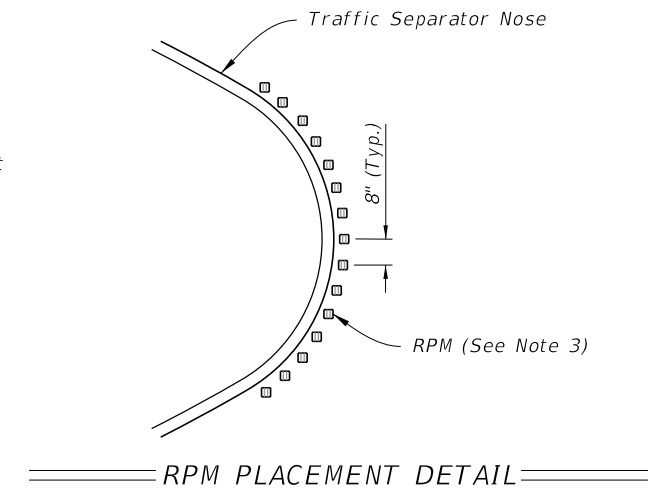

DETAIL "B"

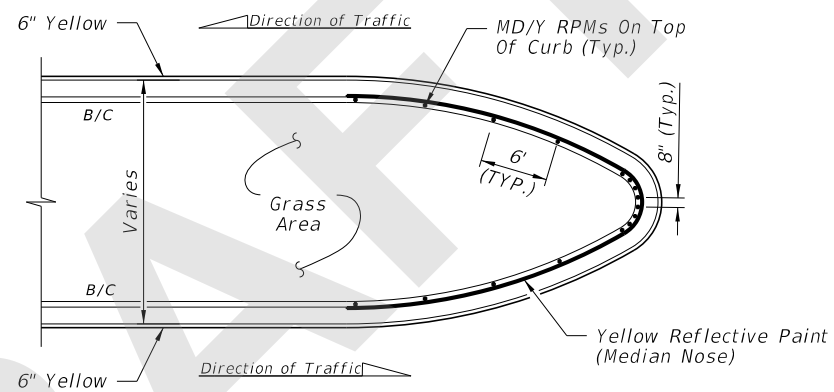

DETAIL "E"

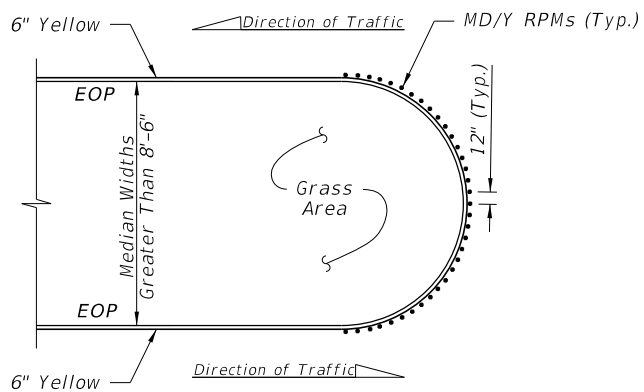

DETAIL "C"

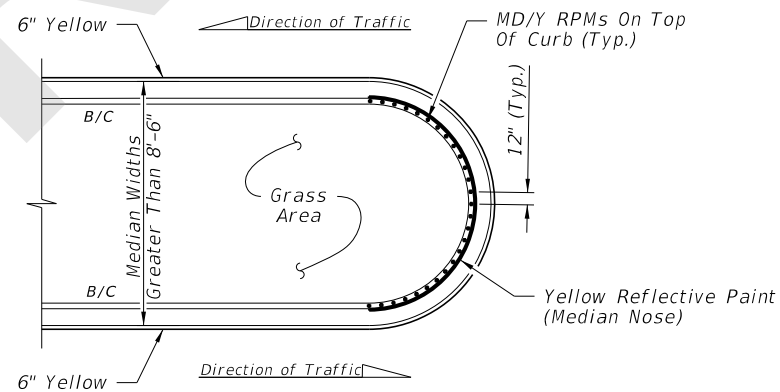

DETAIL "F"

FLUSH MEDIAN OPENINGS

TYPE "D" OR "F" CURB

RPM PLACEMENT AT MEDIAN OPENINGS  
(When called for in the Plans)

POSTED SPEED LIMIT MPH	"Y" FEET
30 OR LESS	10
35	20
40	20
45	30
50 OR MORE	40

LEGEND:

- B/C = BACK OF CURB
- EOP = EDGE OF PAVEMENT
- RPM = RAISED PAVEMENT MARKER
- W/R = WHITE/RED RPM
- Y/Y = YELLOW/YELLOW RPM
- Y/R = YELLOW/RED RPM
- MD/Y = MONO-DIRECTIONAL YELLOW RPM

NOTES:

1. For Type "E" Curb, install RPMs along the pavement edge marking using the same spacing shown.
2. Orient traffic faces of RPMs in curb median radii to be parallel to direction of travel lanes.

8/14/2018 11:19:24 AM

LAST REVISION	DESCRIPTION:
11/01/18	



FY 2019-20  
STANDARD PLANS

TYPICAL PLACEMENT OF  
RAISED PAVEMENT MARKERS

INDEX  
706-001

SHEET  
3 of 4

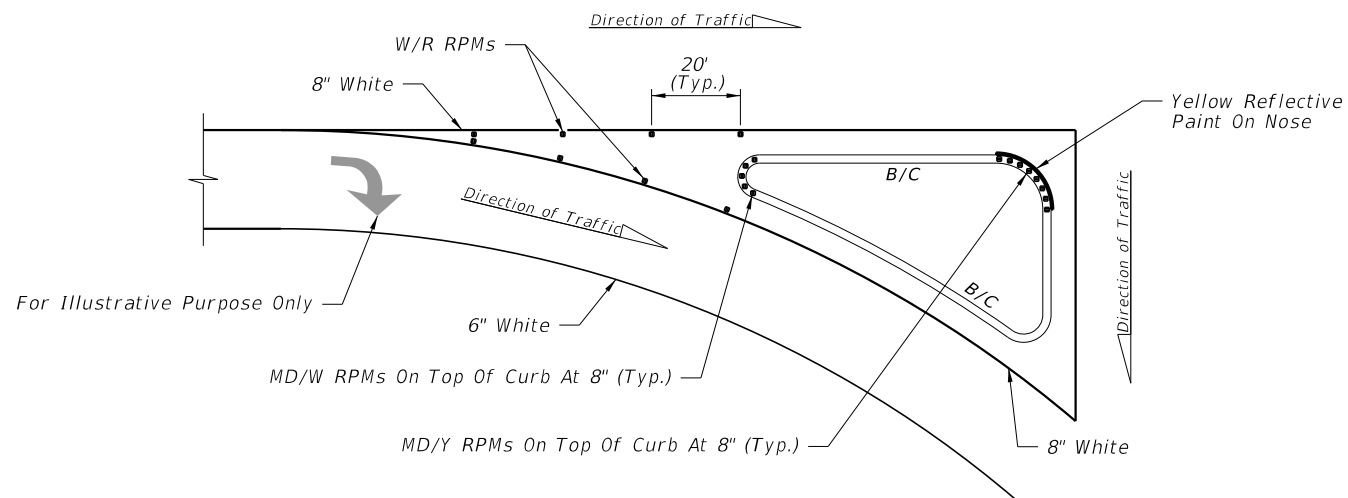

DETAIL "G"

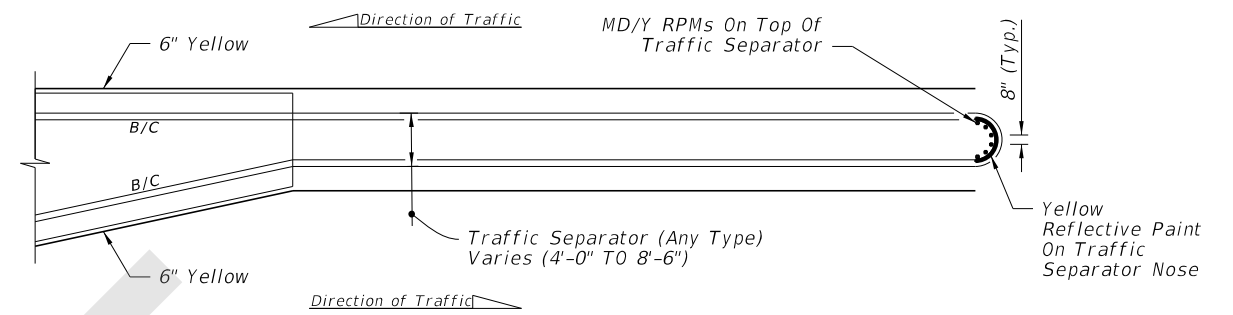

DETAIL "J"

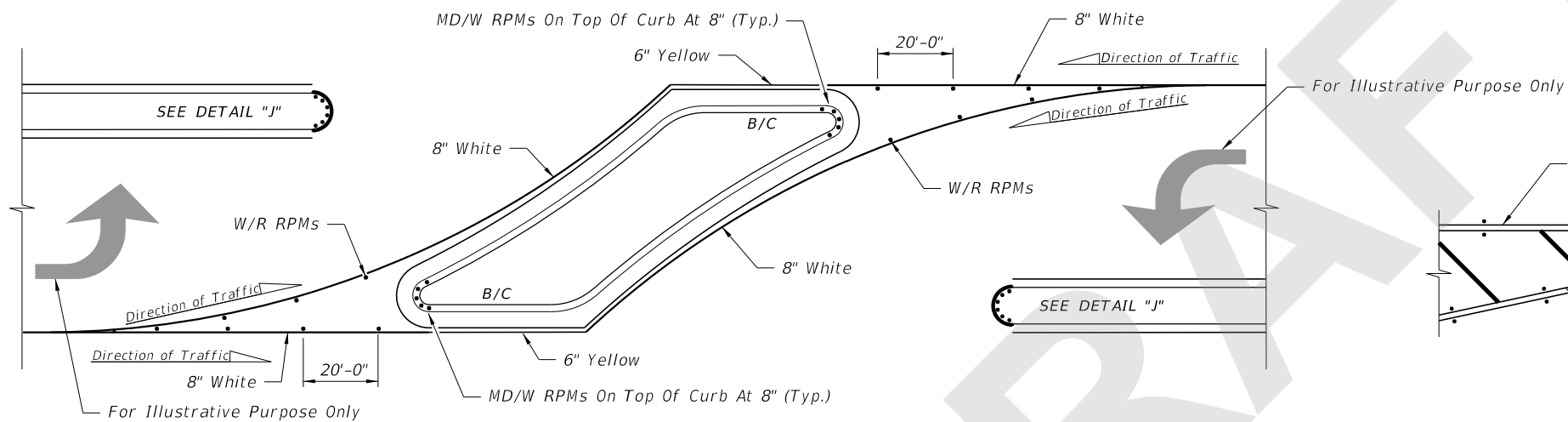

DETAIL "H"

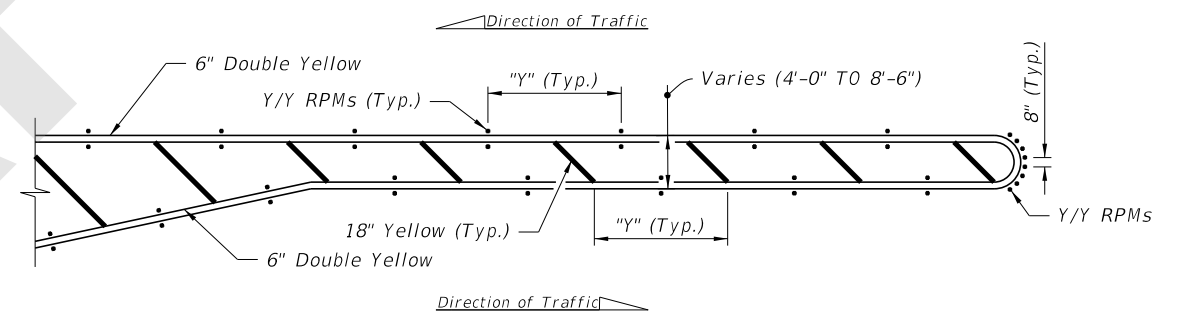

DETAIL "K"

**RPM PLACEMENT AT ISLANDS**  
(When called for in the Plans)

**RPM PLACEMENT AT TRAFFIC SEPARATORS**  
(When called for in the Plans)

POSTED SPEED LIMIT MPH	"y" FEET
30 OR LESS	10
35	20
40	20
45	30
50 OR MORE	40

**NOTES:**

1. For Type "E" Curb install RPMs along the pavement edge marking using the same spacing shown.
2. Orient traffic faces of RPMs in median radii to be parallel to direction of travel lanes.

**LEGEND:**

- B/C = BACK OF CURB
- EOP = EDGE OF PAVEMENT
- RPM = RAISED PAVEMENT MARKER
- W/R = WHITE/RED RPM
- Y/Y = YELLOW/YELLOW RPM
- Y/R = YELLOW/RED RPM
- MD/Y = MONO-DIRECTIONAL YELLOW RPM
- MD/W = MONO-DIRECTIONAL WHITE RPM

8/15/2018 6:42:10 AM

LAST REVISION	DESCRIPTION:
11/01/18	



**FY 2019-20  
STANDARD PLANS**

**TYPICAL PLACEMENT OF  
RAISED PAVEMENT MARKERS**

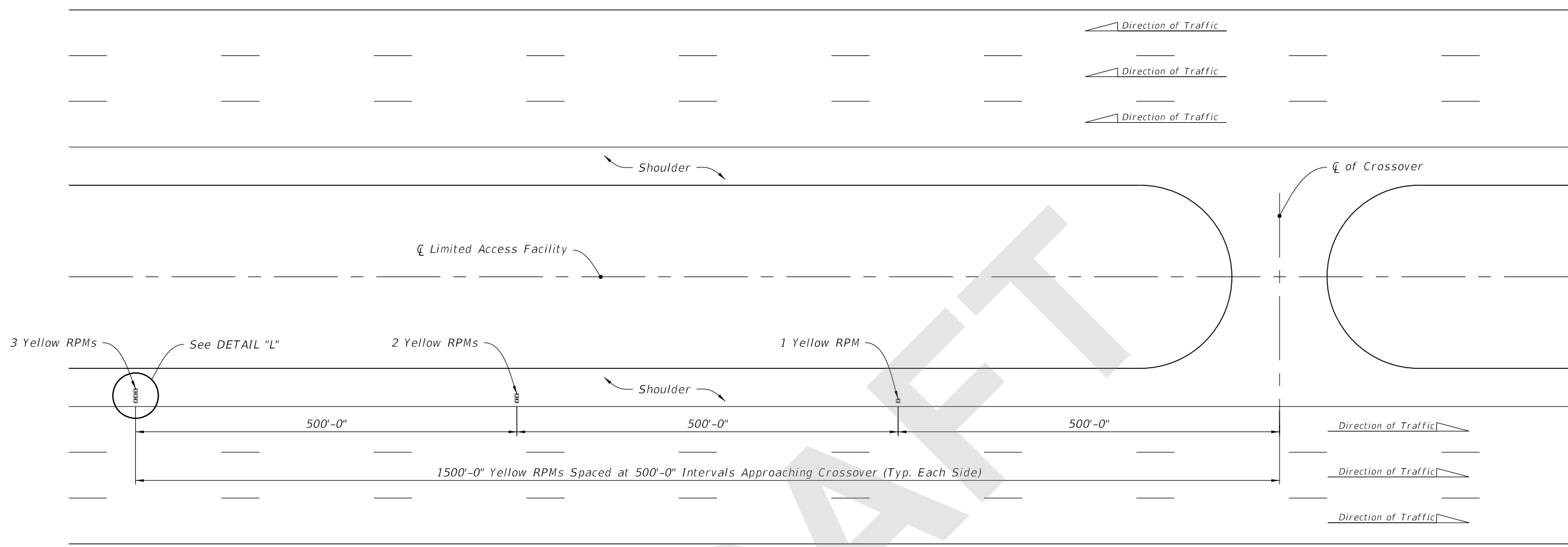
INDEX	SHEET
706-001	4 of 6

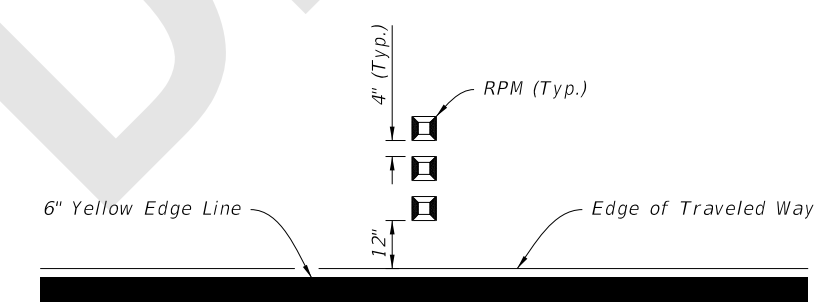

RPM PLACEMENT FOR CROSSOVERS ON LIMITED ACCESS ROADWAYS



DETAIL "L"

8/14/2018 11:19:28 AM

LAST REVISION 11/01/18	REVISION	DESCRIPTION:	 FY 2019-20 STANDARD PLANS	TYPICAL PLACEMENT OF RAISED PAVEMENT MARKERS	INDEX 706-001	SHEET 5 of 6
---------------------------	----------	--------------	--	---	------------------	-----------------

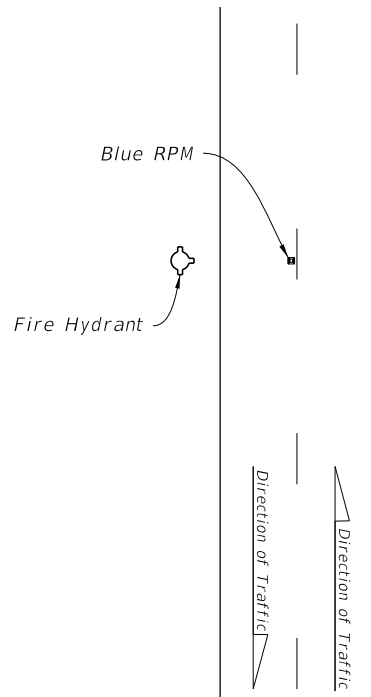

TWO-LANE ROADWAY

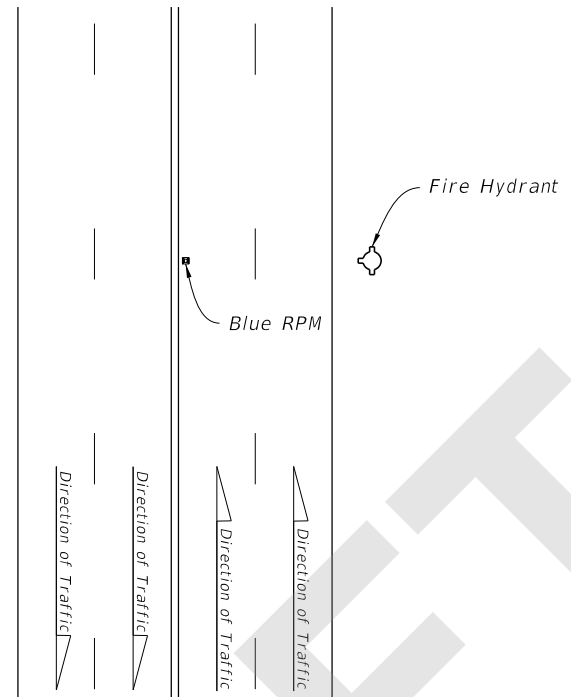

MULTILANE ROADWAY

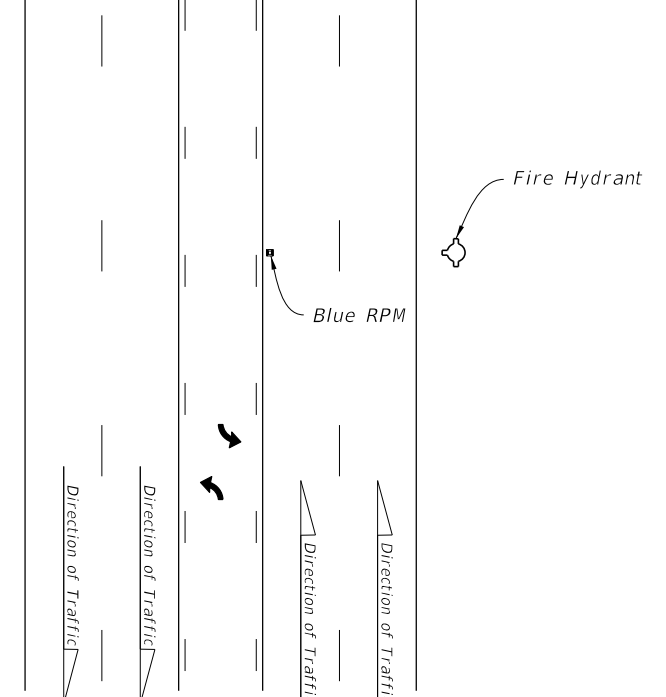

MULTILANE ROADWAY WITH TURN LANE

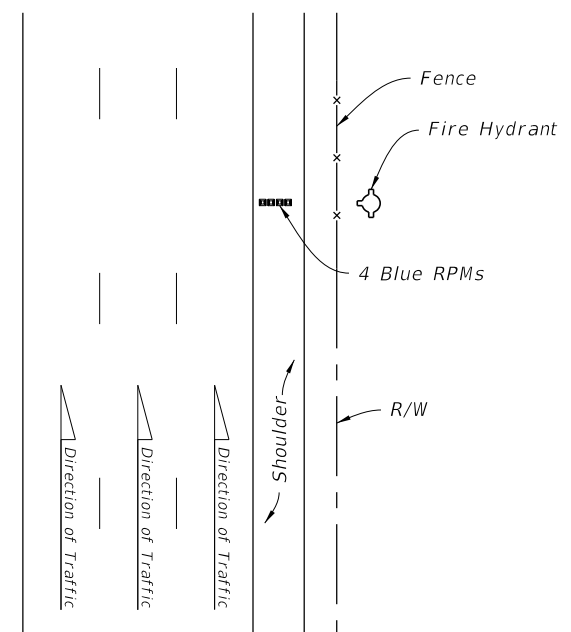

LIMITED ACCESS ROADWAY

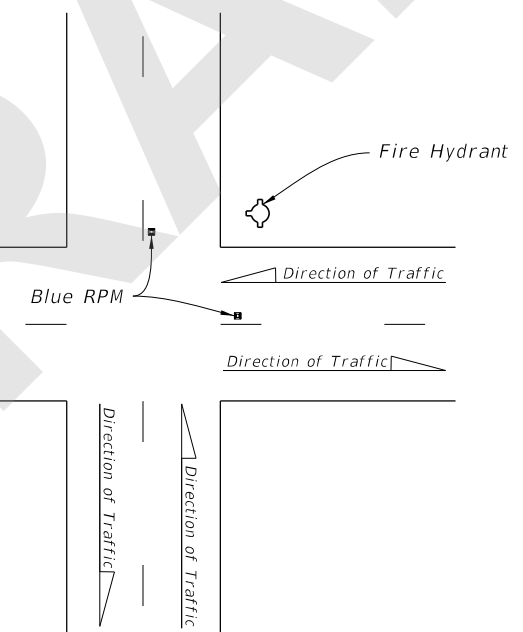

TWO-LANE ROADWAY AT INTERSECTION

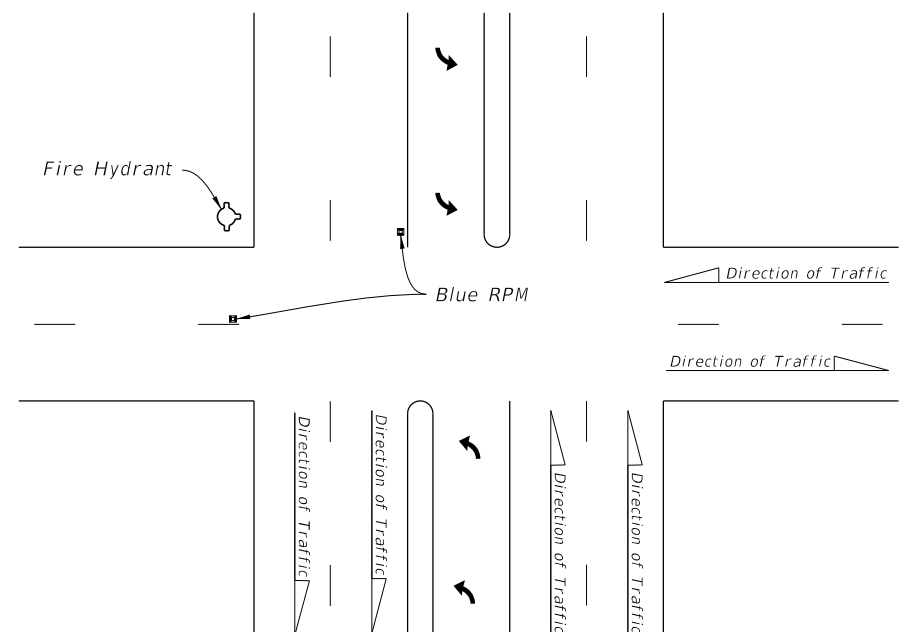

MULTILANE ROADWAY AT INTERSECTION

BLUE RPM PLACEMENT

8/14/2018 11:19:28 AM

LAST REVISION 11/01/18	REVISION	DESCRIPTION:		FY 2019-20 STANDARD PLANS	TYPICAL PLACEMENT OF RAISED PAVEMENT MARKERS	INDEX 706-001	SHEET 6 of 6
---------------------------	----------	--------------	--	------------------------------	---	------------------	-----------------