

FABRICATION NOTES

1. The abbreviated FSB designation for depth and width is FSB "depth" x "width", e.g. FSB 12 x 48.
2. All bar dimensions are out-to-out.
3. Strands N shall be ASTM A416, Grade 250 or 270, $\frac{3}{8}$ " \emptyset or larger strands, stressed to 10,000 lbs. each.
4. Unless otherwise noted, the minimum concrete cover for reinforcing steel shall be 2".
5. For referenced Dimensions, Angles and Case Numbers, see Florida Slab Beam - Table of Variables in Structures Plans.
6. Bars 4D1 & 6Y1 correspond to END 1, and 4D2 & 6Y2 correspond to END 2.
7. Bars 5E1 correspond to interior FSBs, and 5E2 correspond to exterior FSBs.
8. Rake the top surface of the Slab Beams transversely to provide a roughened surface with $\frac{1}{4}$ " amplitude.
9. Embedment of Safety Line Anchorage Devices are permitted to accommodate full protection systems. See shop drawings for details and spacings.

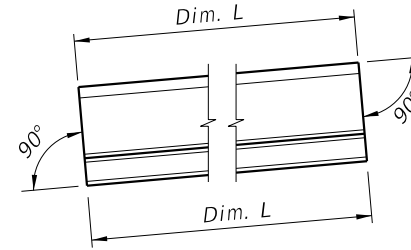

SCHEMATIC SIDE ELEVATION OF BEAM
 (Beam on a Positive Grade shown; Beam on a Negative Grade or Horizontal Grade similar.)

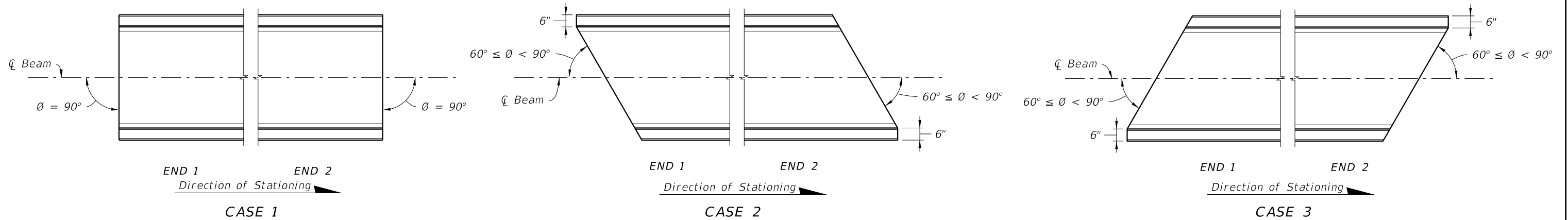

SCHEMATIC PLAN VIEWS AT BEAM ENDS

10/16/2025 2:42:30 PM

LAST REVISION 04/01/23	REVISION	DESCRIPTION:		FY 2026-27 STANDARD PLANS	FLORIDA SLAB BEAM TYPICAL DETAILS AND NOTES	INDEX 450-450	SHEET 1 of 3
---------------------------	----------	--------------	---	------------------------------	--	------------------	-----------------

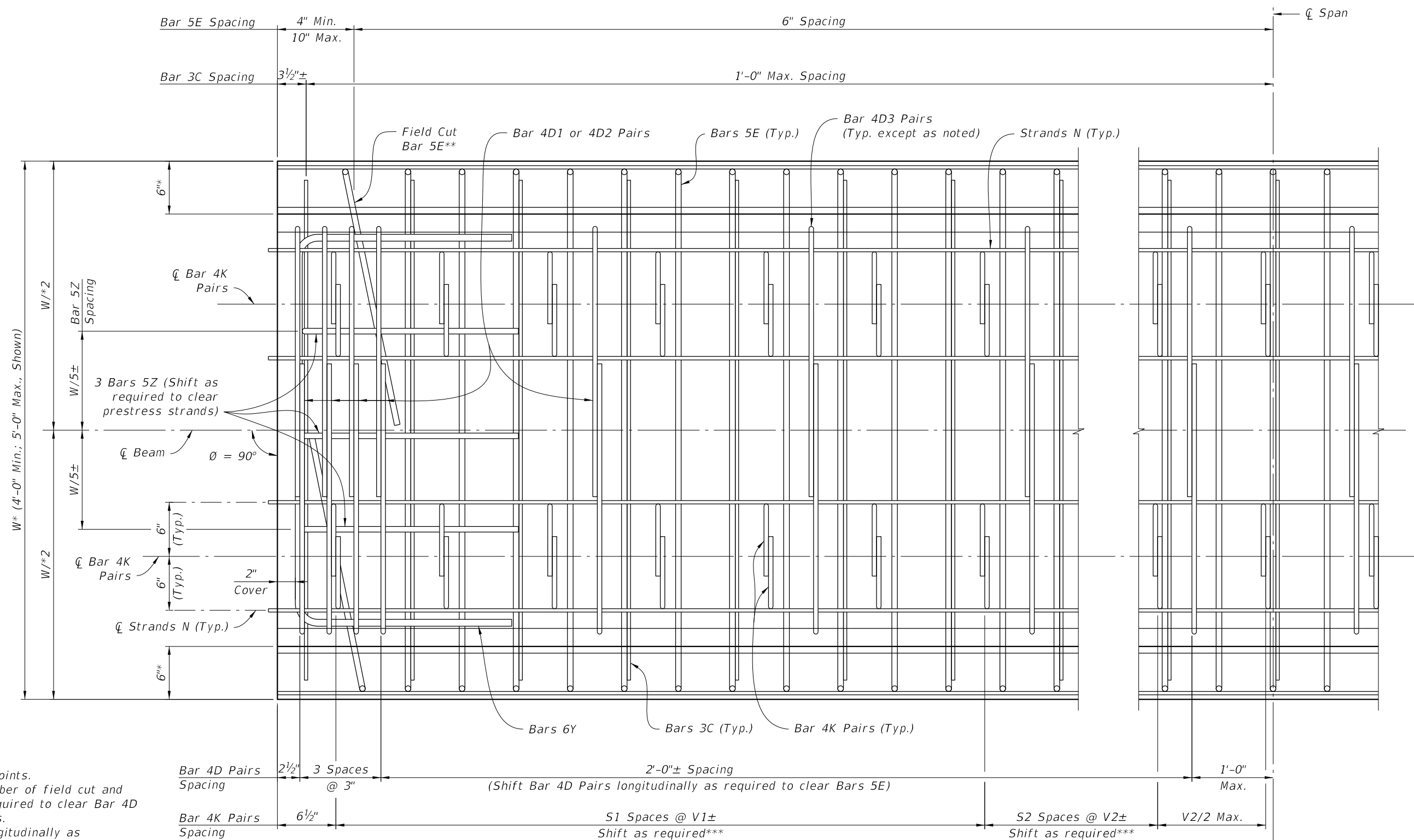

* Measured to Working Points.
 ** At Beam ends, use number of field cut and rotated Bars 5E as required to clear Bar 4D Pairs and Bar 4K Pairs.
 *** Shift Bar 4K Pairs longitudinally as required to clear Bar 4D Pairs and Bars 3C and 5E.

CROSS REFERENCE:
 For Dimensions V1, V2 & W and number of spaces S1 & S2, see Florida Slab Beam - Table of Variables in Structures Plans.
 See Indexes 450-451, 450-452 and 450-453 for Bars 5E Details.

PARTIAL PLAN VIEW $\theta = 90^\circ$
 (END 1 SHOWN, END 2 SIMILAR)
 (INTERIOR BEAM SHOWN, EXTERIOR BEAM SIMILAR, SEE BARS 5E DETAILS)

10/6/2025 2:42:37 PM

LAST REVISION 04/01/23	REVISION	DESCRIPTION:	 FY 2026-27 STANDARD PLANS	FLORIDA SLAB BEAM TYPICAL DETAILS AND NOTES	INDEX 450-450	SHEET 2 of 3
---------------------------	----------	--------------	--	--	-------------------------	------------------------

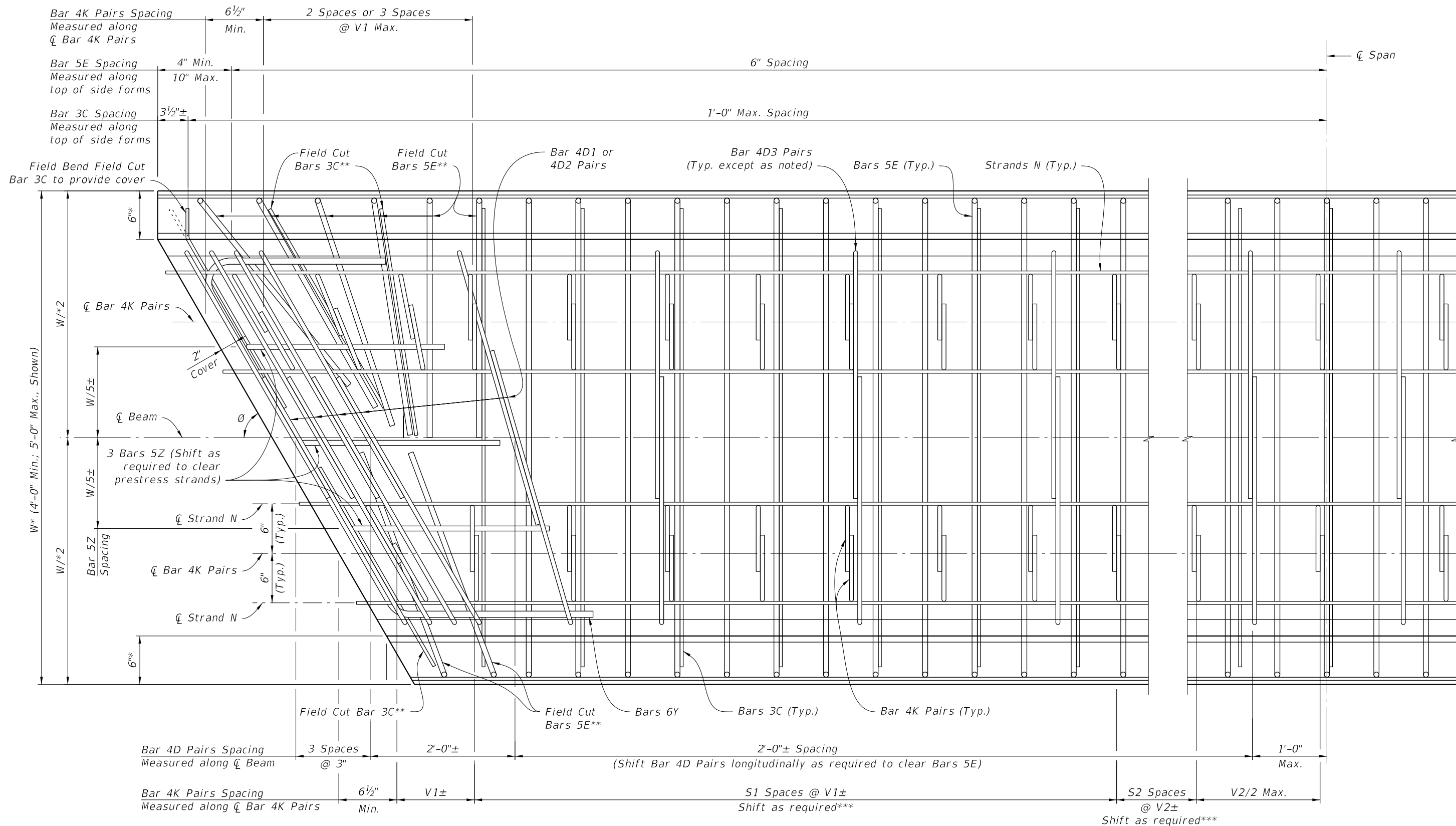

PARTIAL PLAN VIEW $60^\circ \leq \theta < 90^\circ$

(END 1 SHOWN, END 2 SIMILAR)
 (INTERIOR BEAM SHOWN, EXTERIOR BEAM SIMILAR, SEE BARS 5E DETAILS)

* Measured to Working Points.
 ** At Beam ends, use number of field cut and rotated Bars 3C and 5E as required to clear Bar 4D Pairs and Bar 4K Pairs.
 *** Shift Bar 4K Pairs longitudinally as required to clear Bar 4D Pairs and Bars 3C and 5E.

CROSS REFERENCE:
 For Dimensions V1, V2 & W, Angle θ and number of spaces S1 & S2, see Florida Slab Beam - Table of Variables in Structures Plans.

See Indexes 450-451, 450-452 and 450-453 for Bars 5E Details.

10/16/2025 2:42:43 PM

LAST REVISION 04/01/23	DESCRIPTION:		FY 2026-27 STANDARD PLANS	FLORIDA SLAB BEAM TYPICAL DETAILS AND NOTES	INDEX 450-450	SHEET 3 of 3
---------------------------	--------------	--	------------------------------	--	------------------	-----------------