

9/10/2024 11:11:48 AM

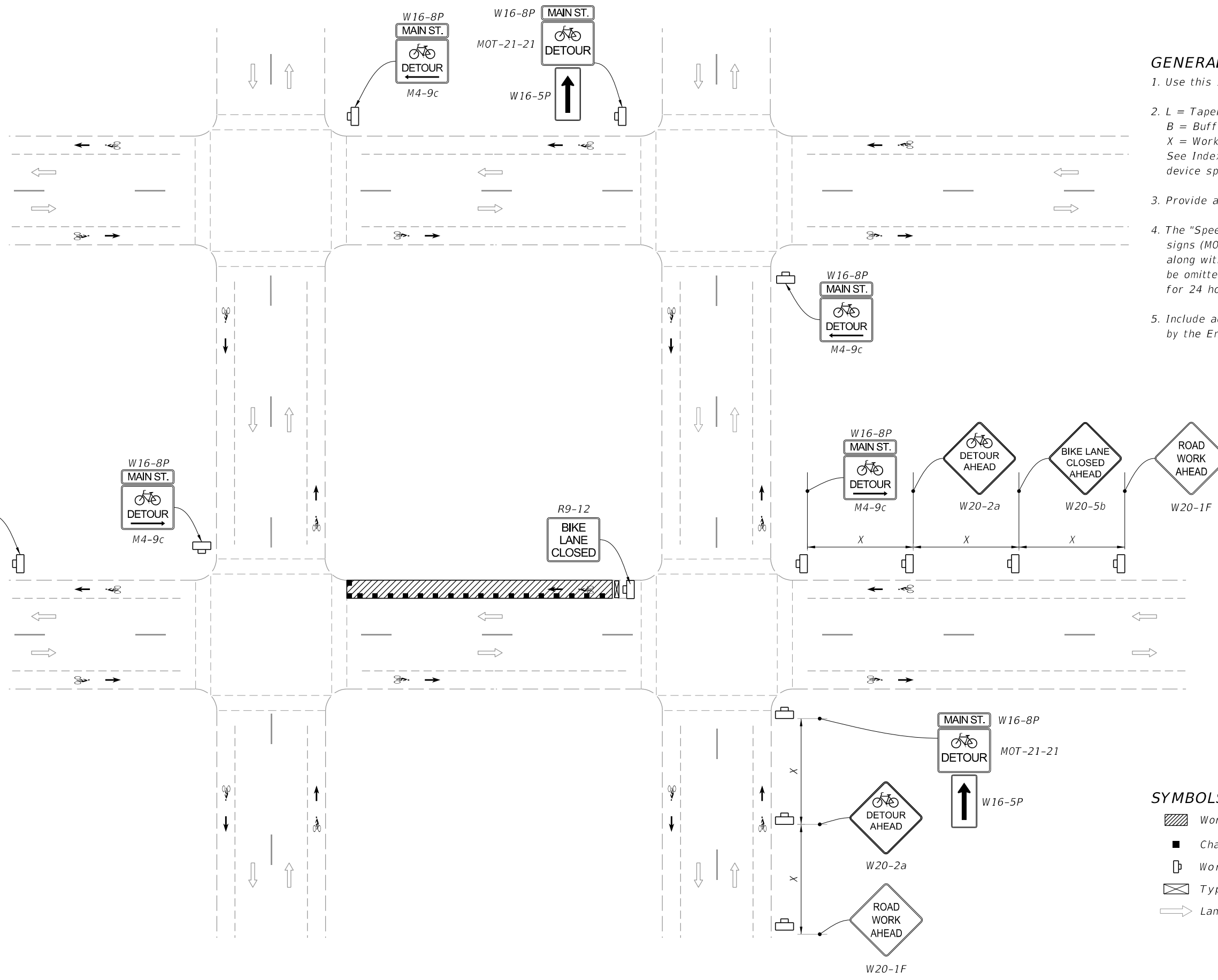

GENERAL NOTES:

1. Use this Index only when called for in the Plans.
2. L = Taper Length
B = Buffer Length
X = Work Zone Sign Distance
See Index 102-600 for "L", "B", "X", channelizing device spacing values.
3. Provide a minimum 5'-0" wide bicycle path.
4. The "Speeding Fines Doubled When Workers Present" signs (MOT-13-06) and "End Road Work" signs (G20-2), along with associated work zone sign distances, may be omitted when the work operation will be in place for 24 hours or less.
5. Include additional signage at intersections as required by the Engineer or shown in the Plans.

SYMBOLS:

- Work Area
- Channelizing Device (See Index 102-600)
- Work Zone Sign
- Type III Barricade
- Lane Identification and Direction of Traffic

=====**BICYCLE DETOUR**=====

LAST REVISION 11/01/24	REVISION	DESCRIPTION:
---------------------------	----------	--------------

**FY 2025-26
STANDARD PLANS**

BICYCLE FACILITY CLOSURES

INDEX 102-661	SHEET 1 of 2
-------------------------	------------------------

