

**GENERAL NOTES:**

1. Temporary barrier systems may be any of the following:
  - A. Type K Temporary Concrete Barrier System (Index 102-110) installed as either Free-Standing or Anchored.
  - B. Proprietary Temporary Barrier Systems on the Approved Product List (APL).
    - a. Concrete Barrier (Free-Standing or Anchored)
    - b. Steel Barrier (Anchored)
2. Where existing flexible pavement is not present, construct a minimum 2" thick temporary Asphalt Pad using Miscellaneous Asphalt Pavement in accordance with Specification 339 with the exception that the use of a pre-emergent herbicide is not required.
3. For Barrier Delineators, see Specification 102. Mount on top of temporary barriers. Color must match adjacent longitudinal pavement marking.
4. Remove all grass debris, loose dirt, and sand for the pavement, bridge deck, or asphalt pad surface within the barrier footprint just prior to placement of the temporary barrier.
5. Ensure the setback distance is clear of any grass, construction debris, stockpiled materials, equipment, and objects.
6. Transitions are required between Type K Barrier and free-standing, anchored, back-filled or other types of temporary barrier. See Index 102-110 for transitions between Type K Barrier and permanent bridge or traffic railing. Refer to the APL for transitions allowed for Proprietary Temporary Barrier Systems.
7. Anchoring (Bolting) of temporary barrier or crash cushions is not permitted on bridge superstructures that contain post-tensioned tendons within the concrete deck (top flange of concrete box girders) or on bridge superstructures consisting of longitudinally prestressed, transversely post-tensioned, solid or voided concrete slab units.
8. Anchor abutting segments of temporary barrier terminated with a Crash Cushion as shown in Index 102-110 or the APL.
9. The requirements of this Index do not apply to Temporary Low Profile Barrier, See Index 102-120.
10. Setback requirements below cover most Temporary Barrier options. Provide additional setback distance for APL products that require additional setback (deflection) space.

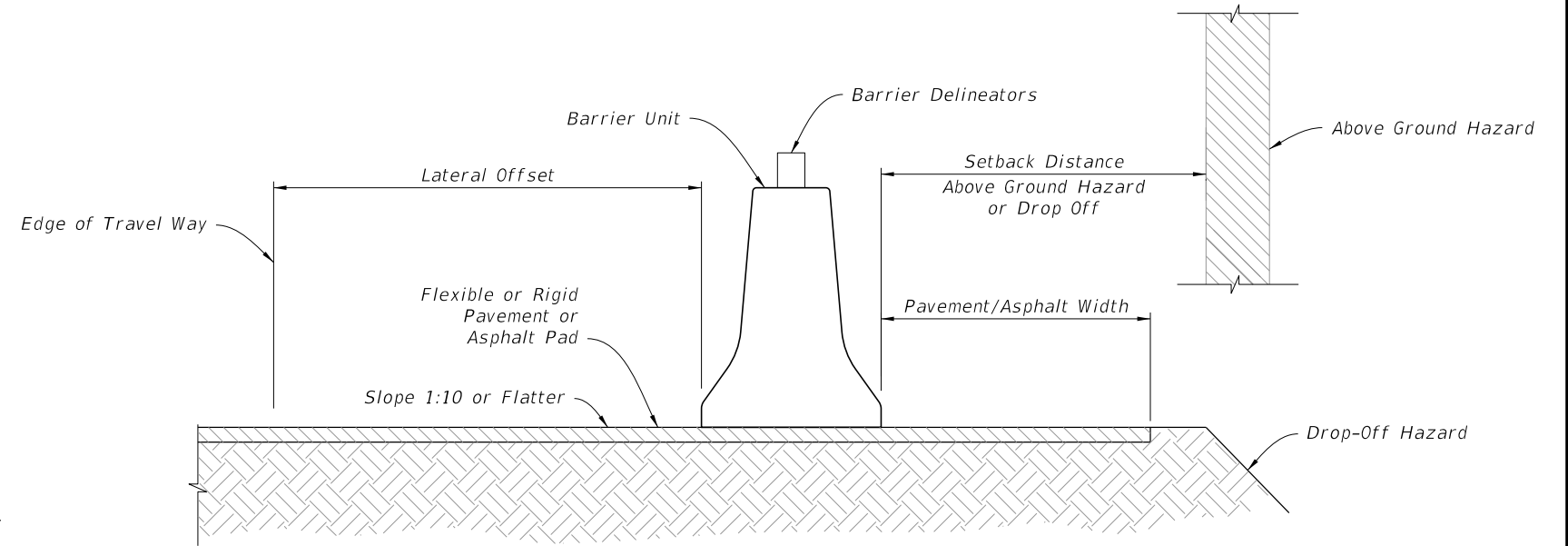

**ROADSIDE INSTALLATION**

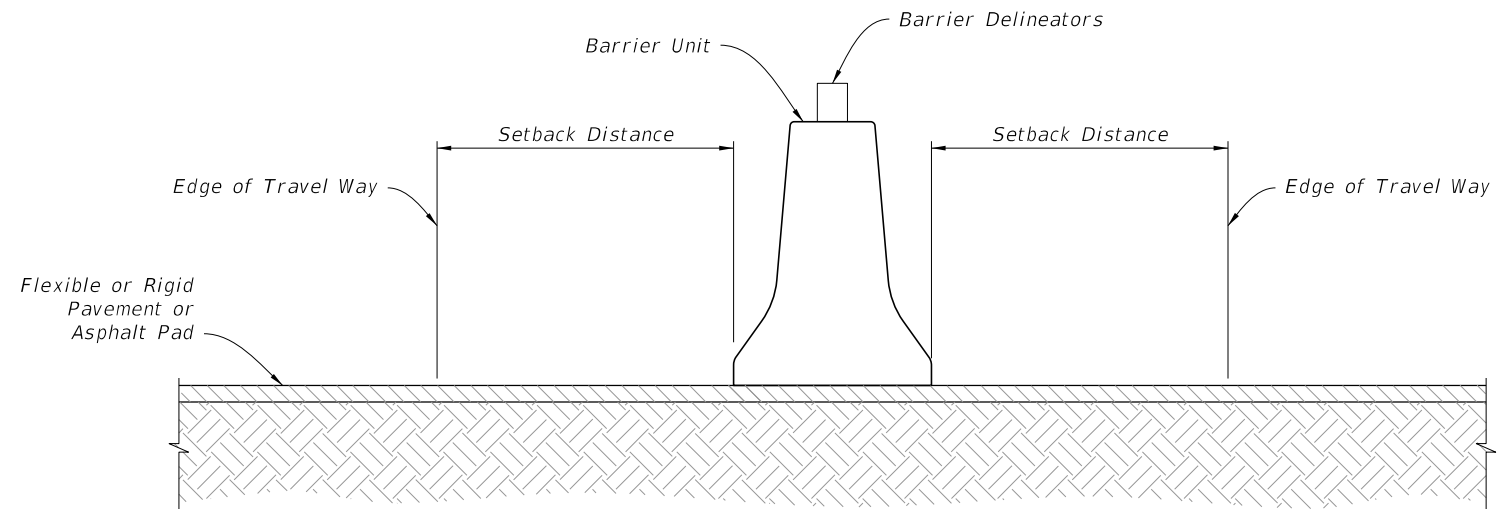

**MEDIAN INSTALLATION**

**INSTALLATION DATA**

CONDITION	LATERAL OFFSET	SETBACK DISTANCE	PAVEMENT / ASPHALT WIDTH
Anchored	2' Min.	2' Min. (See Note)	1' Min.
Free-standing	2' Min.	4' Min.	4' Min.

*NOTE: For Bridge Decks see Index 102-110 or APL.*

9/10/2024 10:36:02 AM

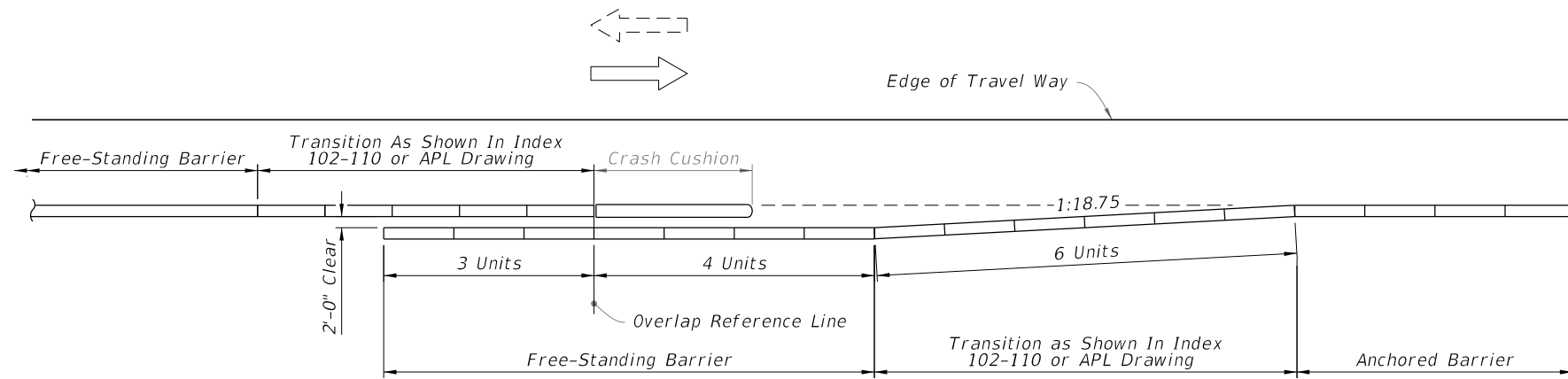

APPROACH SHOULDER BARRIER TRANSITION ON UNDIVIDED FACILITIES

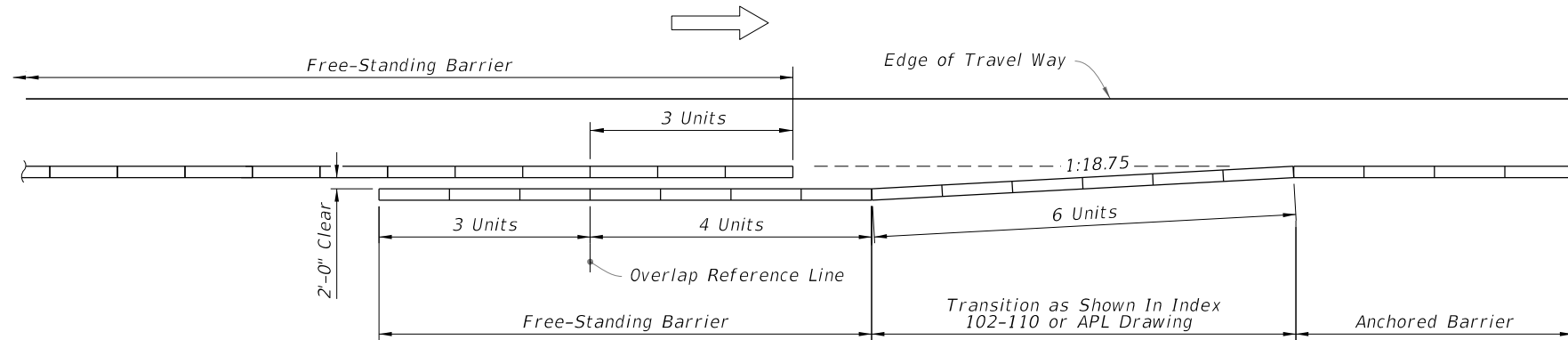

APPROACH SHOULDER BARRIER TRANSITION ON DIVIDED FACILITIES

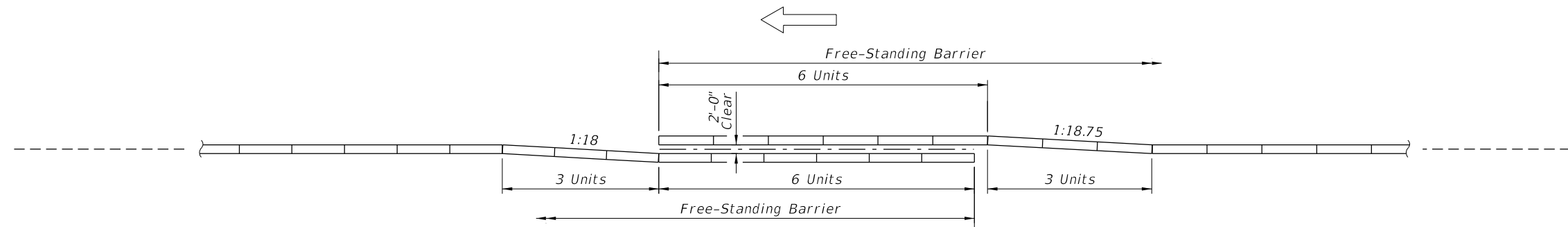

MEDIAN BARRIER TRANSITION

SYMBOL:

→ Direction of Traffic

9/10/2024 10:36:09 AM

LAST REVISION 11/01/20	REVISION	DESCRIPTION:	 FY 2025-26 STANDARD PLANS	TEMPORARY BARRIER	INDEX 102-100	SHEET 2 of 4
---------------------------	----------	--------------	--	-------------------	------------------	-----------------

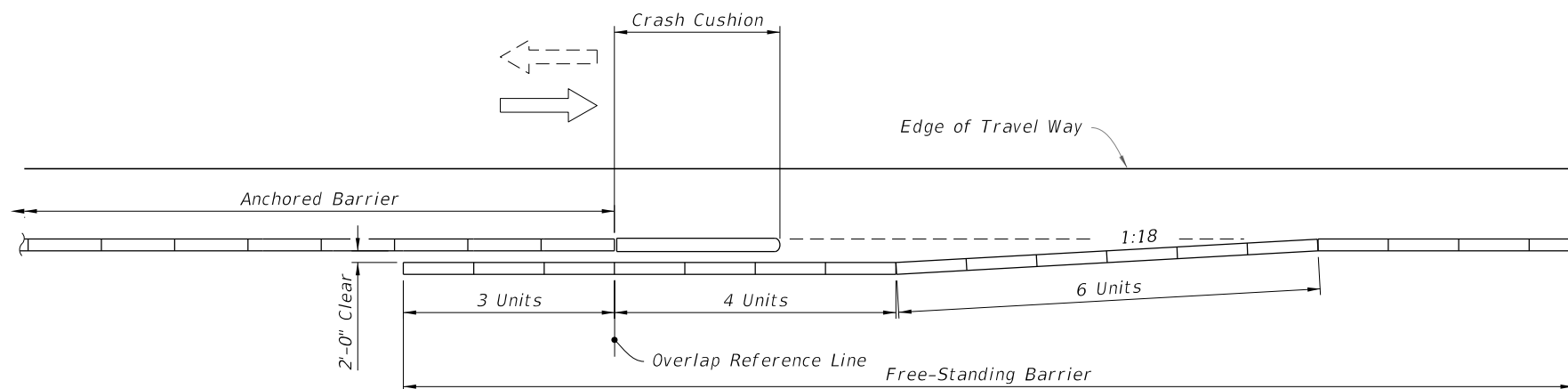

DEPARTURE SHOULDER BARRIER TRANSITION ON UNDIVIDED FACILITIES

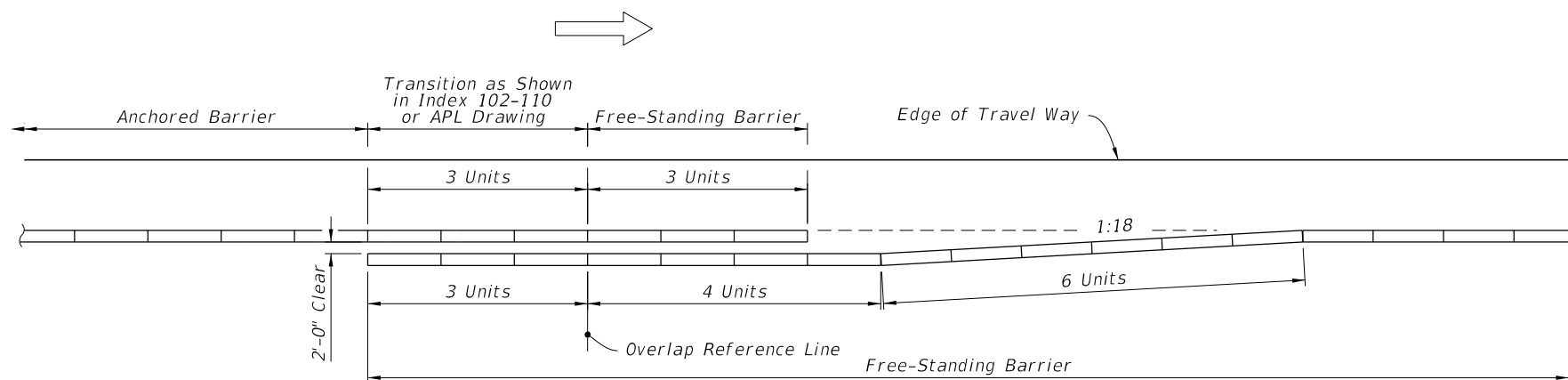

DEPARTURE (TRAILING) SHOULDER BARRIER TRANSITION ON DIVIDED FACILITIES

SYMBOL:

⇒ Direction of Traffic

9/10/2024 10:36:16 AM

LAST REVISION 11/01/20	REVISION	DESCRIPTION:
---------------------------	----------	--------------



FY 2025-26  
STANDARD PLANS

TEMPORARY BARRIER

INDEX  
102-100

SHEET  
3 of 4

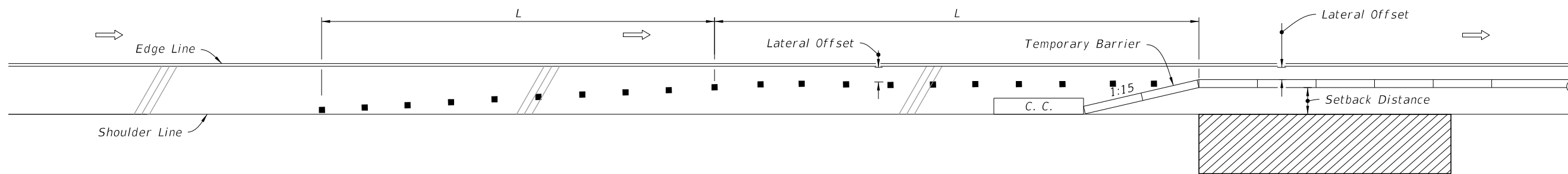

**BARRIER AND TRANSITION LOCATED ON SHOULDERS**

*(Right Lane Shown - Inverted For Left Lane)*

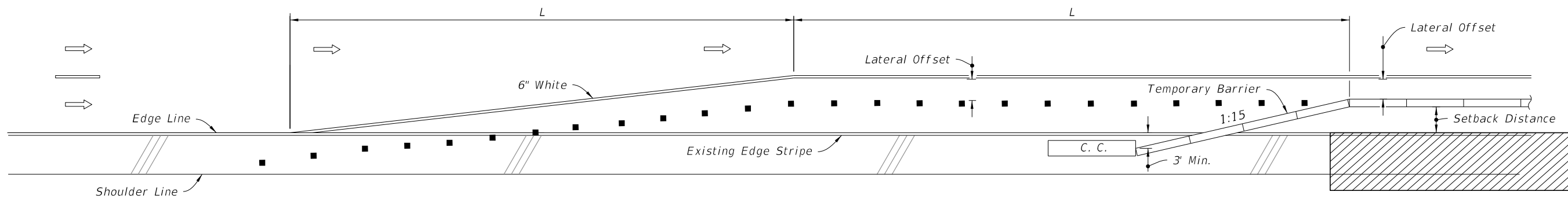

**BARRIER AND TRANSITION WITH LANE DROP ON MULTILANE FACILITIES**

*(Right Lane Merge Left Shown - Inverted For Left Lane Merge Right)*

**NOTE:**

*L = Taper Length, See Index 102-600 for "L" and channelizing device spacing values.*

**SYMBOLS:**

-  Work Area
-  Channelizing Device (See Index 102-600)
-  Crash Cushion
-  Lane Identification and Direction of Traffic

9/10/2024 10:36:23 AM

LAST REVISION 11/01/20	REVISION	DESCRIPTION:		FY 2025-26 STANDARD PLANS	TEMPORARY BARRIER	INDEX 102-100	SHEET 4 of 4
---------------------------	----------	--------------	--	------------------------------	-------------------	------------------	-----------------