

OPTION I

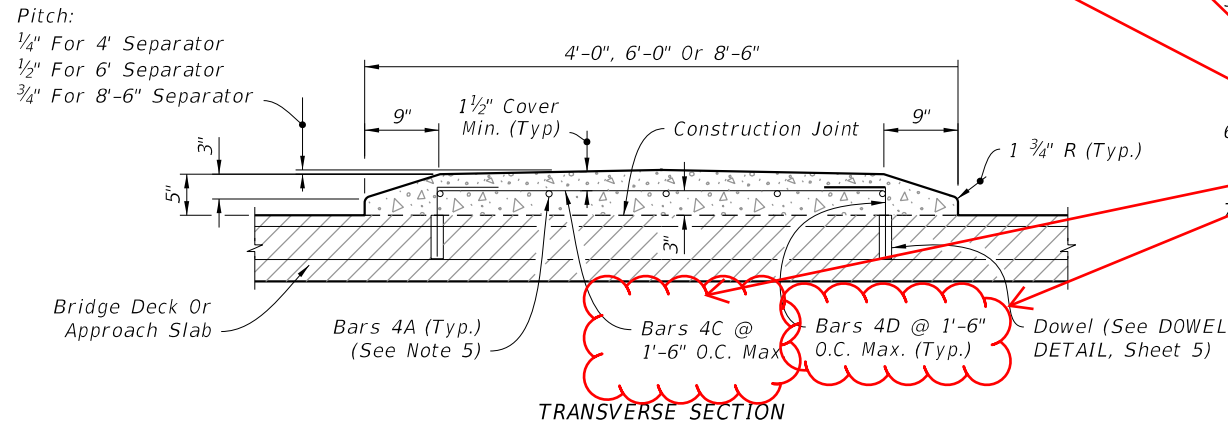
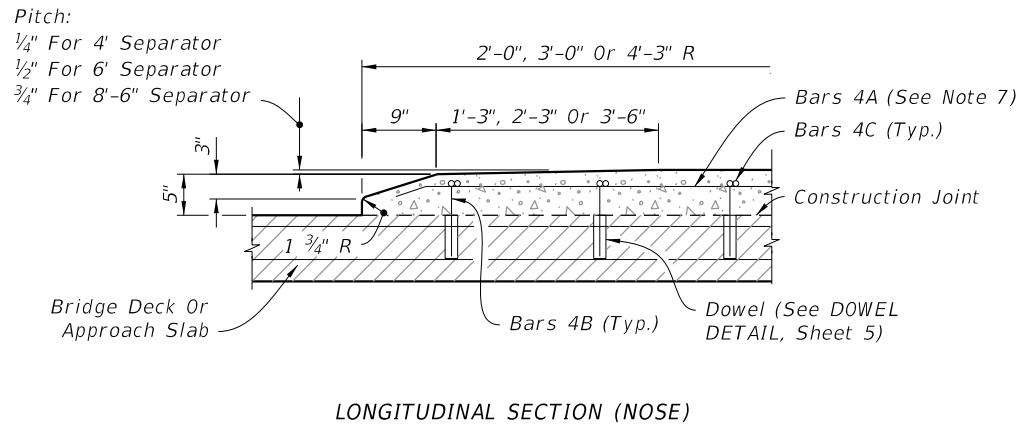

OPTION II

**NOTES:**

1. Traffic Separator transverse reinforcement adjacent to deck expansion joints shall be field adjusted to maintain clearance and spacing. Bars shall be field cut as shown, bars may be rotated to maintain clearance.
2. Traffic Separator ends at deck expansion joints shall follow the deck joint limits. Drainage joints and b" V-Grooves shall be placed perpendicular or radial to the  $\bar{C}$  of the Traffic Separator. See Structures Plans, Superstructure and Approach Slab Sheets for details.
3. See Structures Plans, Superstructure Sheets for actual dimensions and joint orientation.
4. Option II is not permitted on bridge decks with prestressing steel.
5. Bar Spacing:  
 4'-0" @ 3 equal spaces (continuous)  
 6'-0" @ 5 equal spaces (continuous)  
 8'-6" @ 7 equal spaces (continuous)
6. At the Contractor substituted for 1
7. Field bend and cut

**Corrected print error for Bars 4B, 4C, 4D, and 4E.**

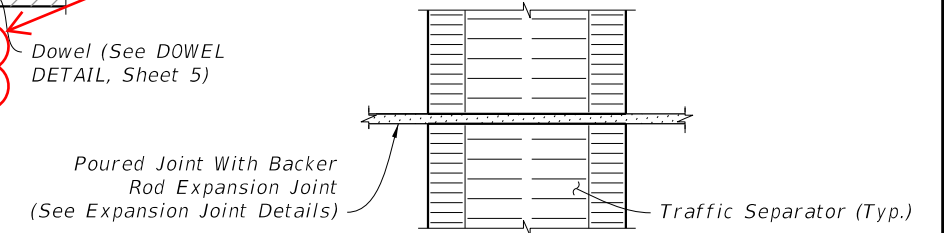

**REINFORCING STEEL**  
(Bridge Deck Shown, Approach Slab Similar)

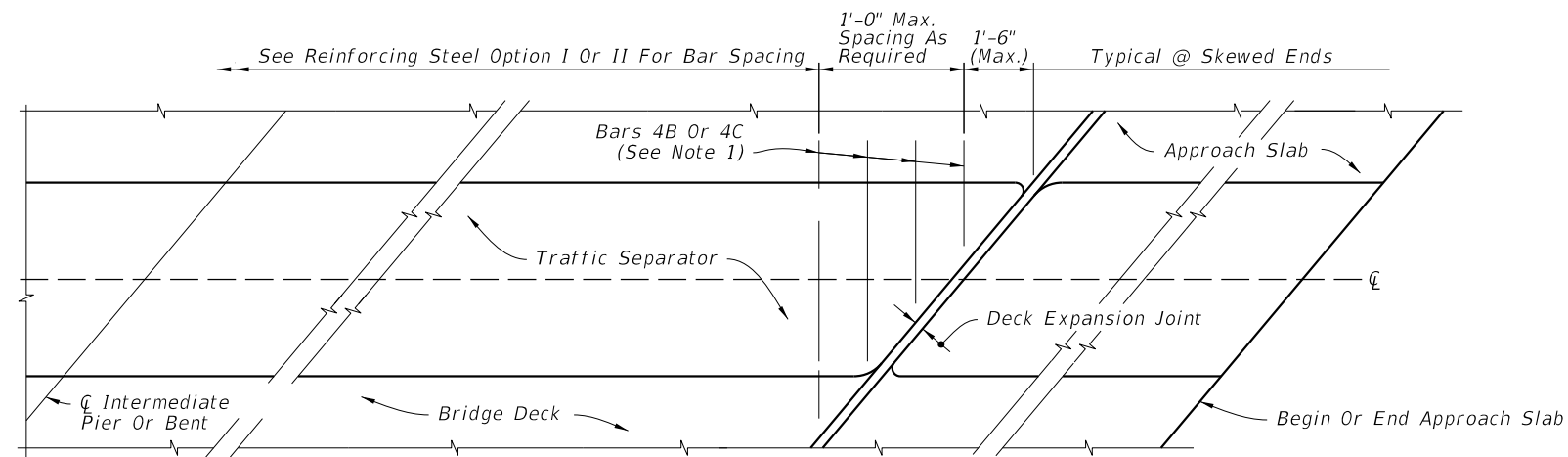

**SKewed BRIDGE DECK AND APPROACH SLAB WITH TRAFFIC SEPARATOR**  
(Deck Expansion Joint at Begin or End Bridge Shown, Expansion Joint at  $\bar{C}$  Pier or Intermediate Bents Similar)

**DETAIL AT Poured Joint With Backer Rod Expansion Joints**

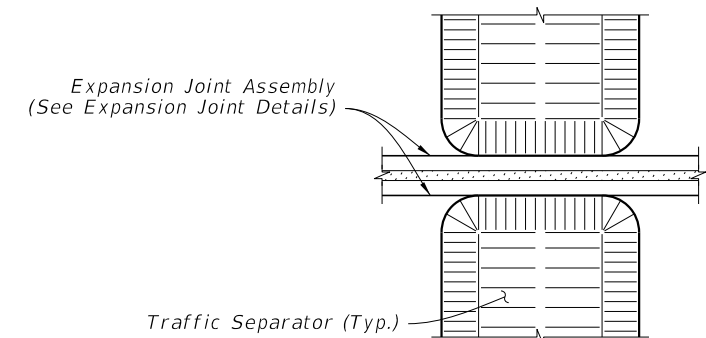

**DETAIL AT EXPANSION JOINTS**  
(Strip Seal Shown, Other Armored Joint Types Similar)

**BRIDGE INSTALLATIONS - TYPE "E" CURB**

2/3/2025 1:27:33 PM

LAST REVISION 11/01/17	DESCRIPTION:		FY 2024-25 STANDARD PLANS	TRAFFIC SEPARATORS	INDEX 520-020	SHEET 3 of 5
---------------------------	--------------	--	------------------------------	--------------------	------------------	-----------------

Pitch:  
 1/4" For 4' Separator  
 1/2" For 6' Separator  
 3/4" For 8'-6" Separator

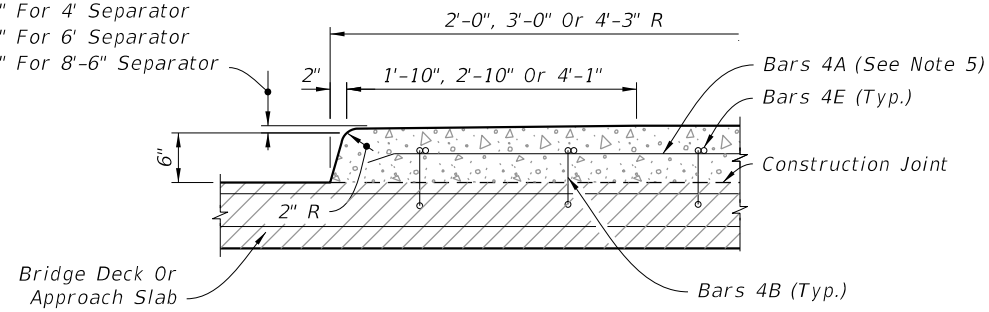

LONGITUDINAL SECTION (NOSE)

Pitch:  
 1/4" For 4' Separator  
 1/2" For 6' Separator  
 3/4" For 8'-6" Separator

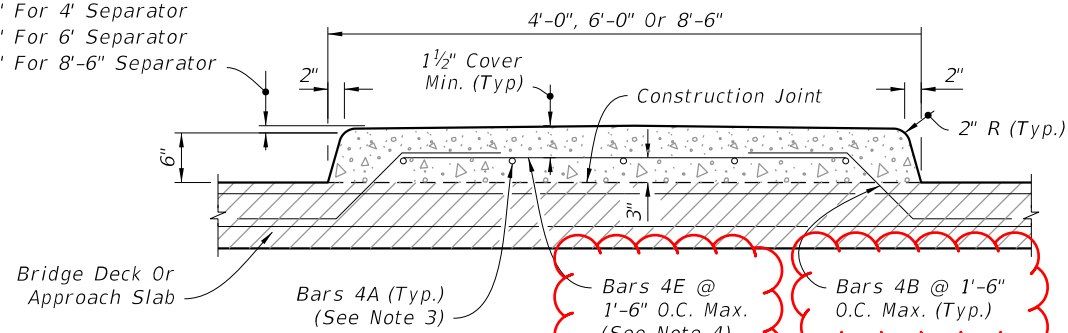

TRANSVERSE SECTION

OPTION I

Pitch:  
 1/4" For 4' Separator  
 1/2" For 6' Separator  
 3/4" For 8'-6" Separator

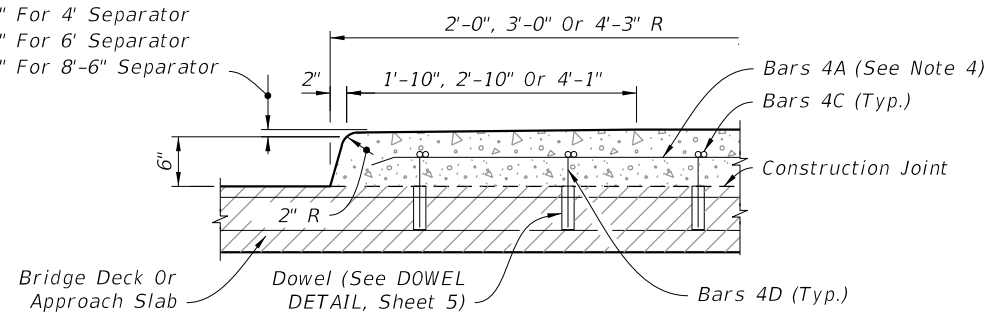

LONGITUDINAL SECTION (NOSE)

Pitch:  
 1/4" For 4' Separator  
 1/2" For 6' Separator  
 3/4" For 8'-6" Separator

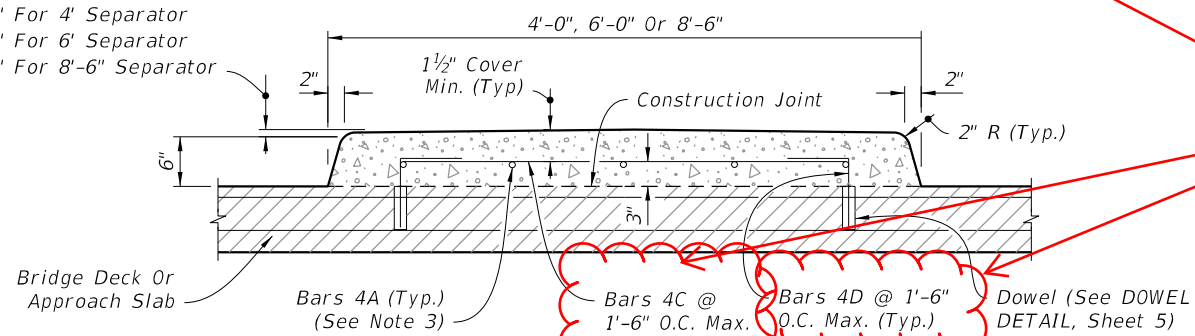

TRANSVERSE SECTION

OPTION II

REINFORCING STEEL

(Bridge Deck Shown, Approach Slab Similar)

Expansion Joint Assembly  
 (See Expansion Joint Details)

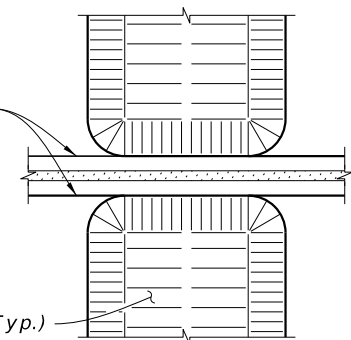

Traffic Separator (Typ.)

DETAIL AT EXPANSION JOINTS

(Strip Seal Shown, Other Armored Joint Types Similar)

Poured Joint With Backer  
 Rod Expansion Joint  
 (See Expansion Joint Details)

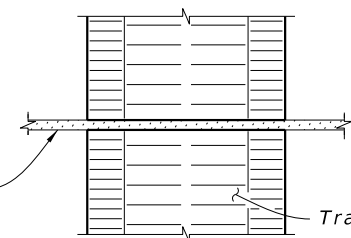

Traffic Separator (Typ.)

DETAIL AT POURED JOINT WITH  
 BACKER ROD EXPANSION JOINTS

NOTES:

1. Treatment of separators on straight bridges shown. For additional notes and treatment of separators on skewed bridges, see Sheet 2.
2. Option II is not permitted on bridge decks with prestressing steel.
3. Bar Spacing:  
 4'-0" @ 3 equal spaces (continuous)  
 6'-0" @ 5 equal spaces (continuous)  
 8'-6" @ 7 equal spaces (continuous)
4. At the Contractor's option, a one piece bar may be substituted for Bars 4B and 4E.
5. Field bend and cut rebar as required to maintain cover.

Corrected print error for Bars 4B, 4C, 4D, and 4E.

1:27:41 PM  
2/3/2025

LAST REVISION 11/01/17	REVISION	DESCRIPTION:		FY 2024-25 STANDARD PLANS	TRAFFIC SEPARATORS	INDEX 520-020	SHEET 4 of 5
---------------------------	----------	--------------	--	------------------------------	--------------------	------------------	-----------------