

CONCAVE CONNECTION

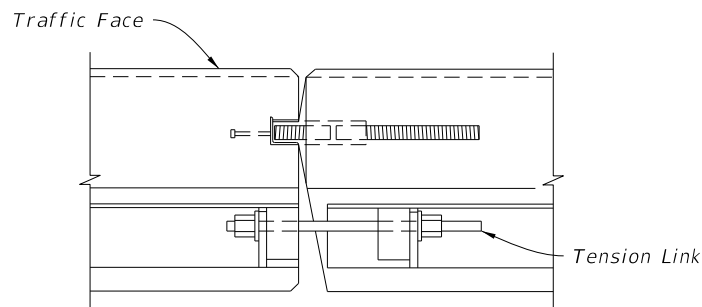

PARALLEL CONNECTION

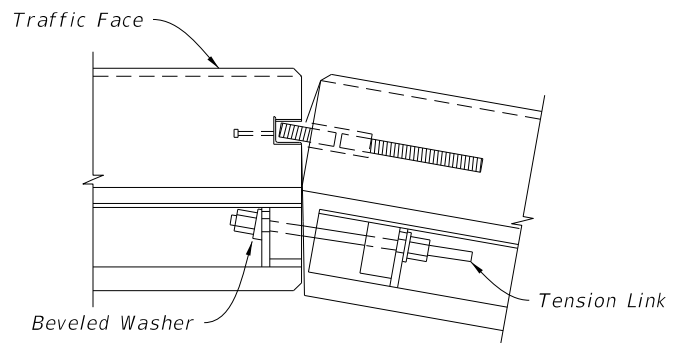

CONVEX CONNECTION

PLAN VIEWS OF CONNECTIONS

Nut (Typ.)

Extra Thick GR. 8 Flat Washer
(See Beveled Washer Details)

CORRECTED: 1-1/4" Thread Bar Size

1 1/2" Ø High Strength ASTM A722 Threaded Bar with
Extra Thick GR. 8 Flat Washer and Nut at Each End

TENSION LINK DETAIL

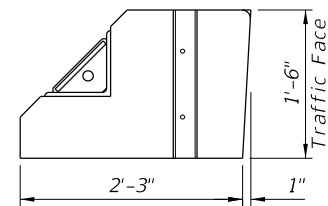

FLAT FACE FEMALE END

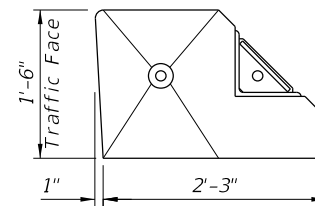

BEVELED FACE MALE END

END VIEWS

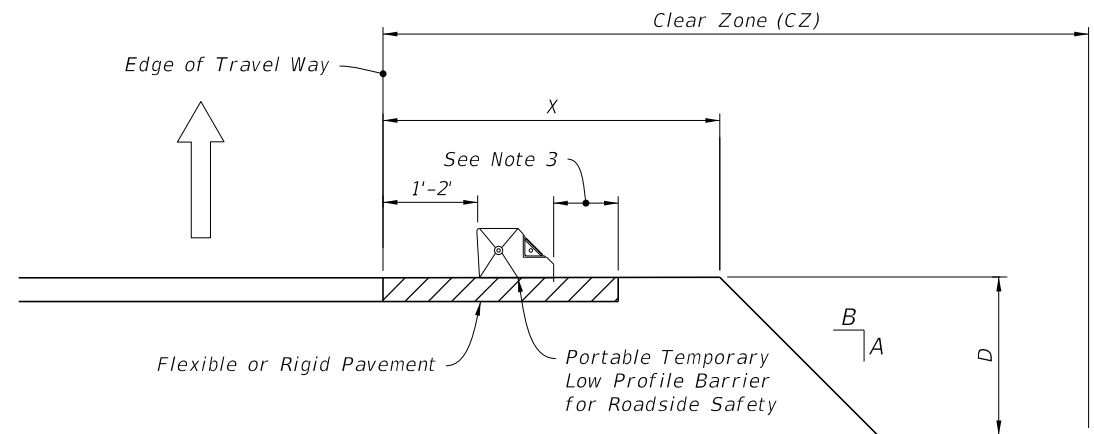

SETBACK DISTANCE AT DROP-OFFS

NOTES:

1. LIMITATION OF USE: This installation technique can only be used on flexible or rigid pavement.
2. ASPHALT PAD: Where existing pavement is not present, construct 2" Asphalt Pad using miscellaneous asphalt pavement in accordance with Specification 339 with the exception that the use of a pre-emergent herbicide is not required. Payment for asphalt pad will be included in the cost of the barrier.
3. Minimum 9" on 1:10 or flatter slopes for 'Portable Temporary Low Profile Barrier For Roadside Safety.' For values A, B, D and X see Index 102-600.

SYMBOLS:

- Type I Object Marker
- Direction of Traffic

WORK ZONE SPEED	LATERAL OFFSET	SETBACK DISTANCE
45 MPH OR LESS	1' MIN, 2' PREFERRED	9"

Approach Traffic

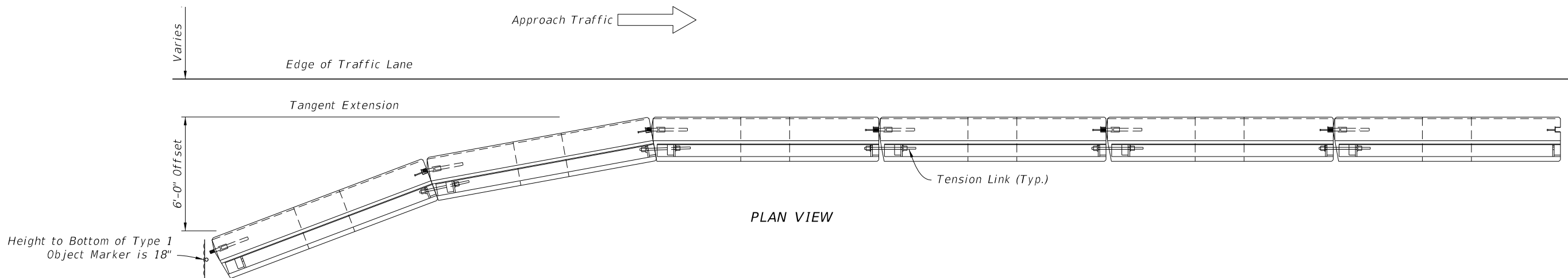

PLAN VIEW

APPROACH END OFFSET

10/6/2022 1:22:20 PM