

CONTRACT PLANS COMPONENTS

ROADWAY PLANS

A DETAILED INDEX APPEARS ON THE KEY SHEET OF EACH COMPONENT

INDEX OF ROADWAY PLANS

SHEET NO.	SHEET DESCRIPTION
1	KEY SHEET
2	PROJECT CONTROL
3	ROADWAY PLAN
4	TEMPORARY TRAFFIC CONTROL PLAN
5	SIGNING AND PAVEMENT MARKING

DEVELOPMENTAL STANDARD PLANS:
D520-030 RAISED CROSSWALKS

GOVERNING STANDARD PLANS:

Florida Department of Transportation, FY2022-23 Standard Plans for Road and Bridge Construction and applicable Interim Revisions (IRs).

Standard Plans for Road Construction and associated IRs are available at the following website: <http://www.fdot.gov/design/standardplans>

Standard Plans for Bridge Construction are included in the Structures Plans Component

GOVERNING SPECIFICATIONS:

Florida Department of Transportation, FY 2022-2023 Standard Specifications for Road and Bridge Construction at the following website: <http://www.fdot.gov/programmanagement/Implemented/SpecBooks>

Exhibit A Scope of Services and Fixed Capital Outlay Non-Technical Specifications Dated August 31, 2016

**STATE OF FLORIDA
DEPARTMENT OF TRANSPORTATION**

CONTRACT PLANS

FINANCIAL PROJECT ID 444761-5-52-01

FDOT DISTRICT IV MAIN OFFICE PARKING LOT
3400 W. COMMERCIAL BLVD. FT LAUDERDALE, FL 33309

BROWARD COUNTY

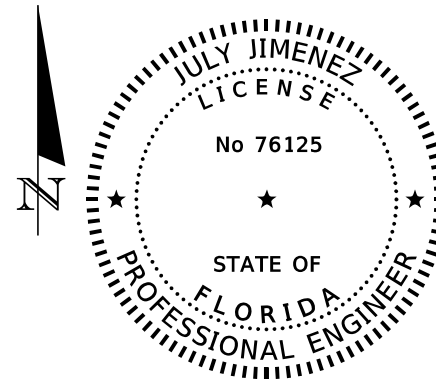
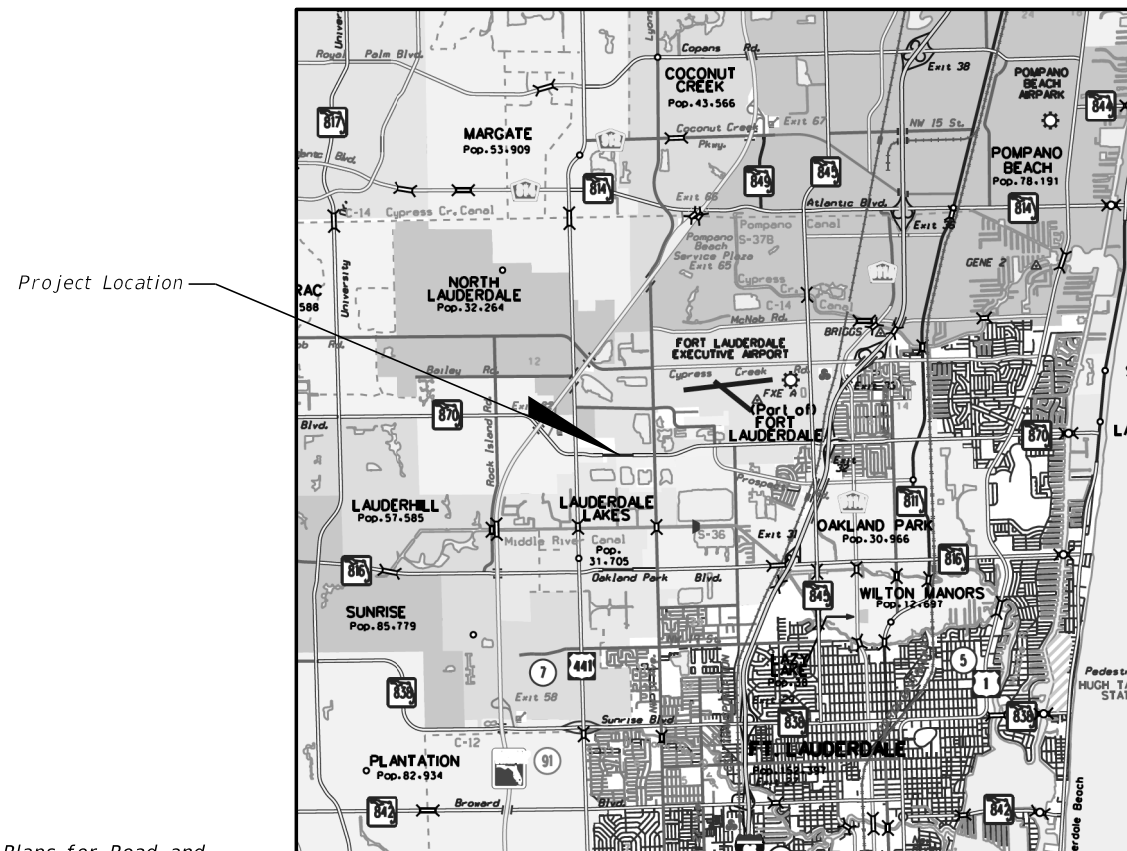
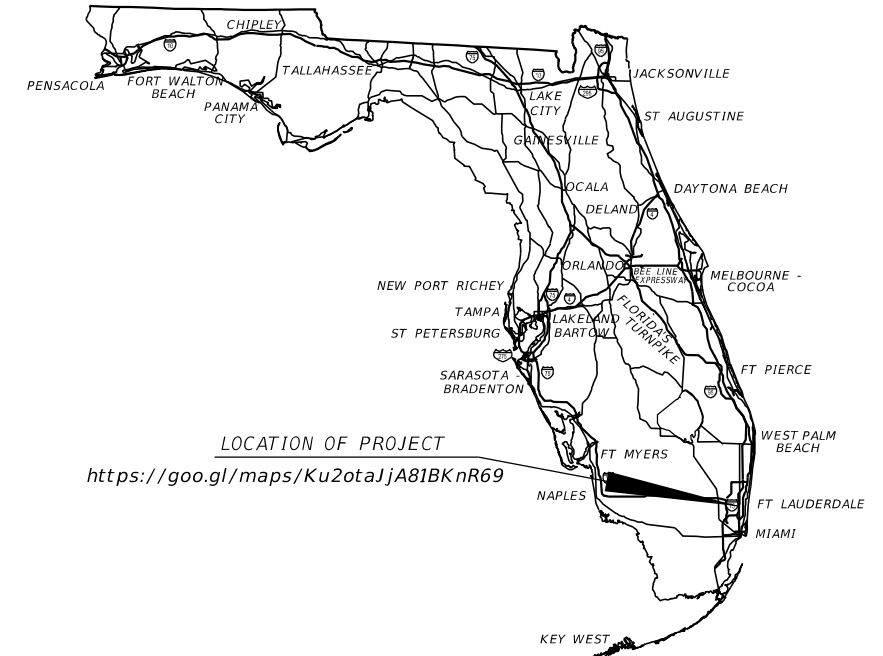

THIS ITEM HAS BEEN DIGITALLY SIGNED AND SEALED BY

ON THE DATE ADJACENT TO THE SEAL

PRINTED COPIES OF THIS DOCUMENT ARE NOT CONSIDERED SIGNED AND SEALED AND THE SIGNATURE MUST BE VERIFIED ON ANY ELECTRONIC COPIES.

ROADWAY PLANS
ENGINEER OF RECORD:

July C. Jimenez, P.E.
P.E. LICENSE 76125
FLORIDA DEPARTMENT OF TRANSPORTATION
ROADWAY DESIGN SECTION 2
3400 WEST COMMERCIAL BLVD
FT. LAUDERDALE, FL 33309

FDOT PROJECT MANAGER

July C. Jimenez, P.E.

CONSTRUCTION CONTRACT NO.	FISCAL YEAR	SHEET NO.
F4006	22	1

PROJECT CONTROL POINTS

☒ SURVEY 3400 W. COMMERCIAL BLVD. DTRICT 4 OFFICE
SECTION 18 TOWNSHIP 49 SOUTH RANGE 42 EAST

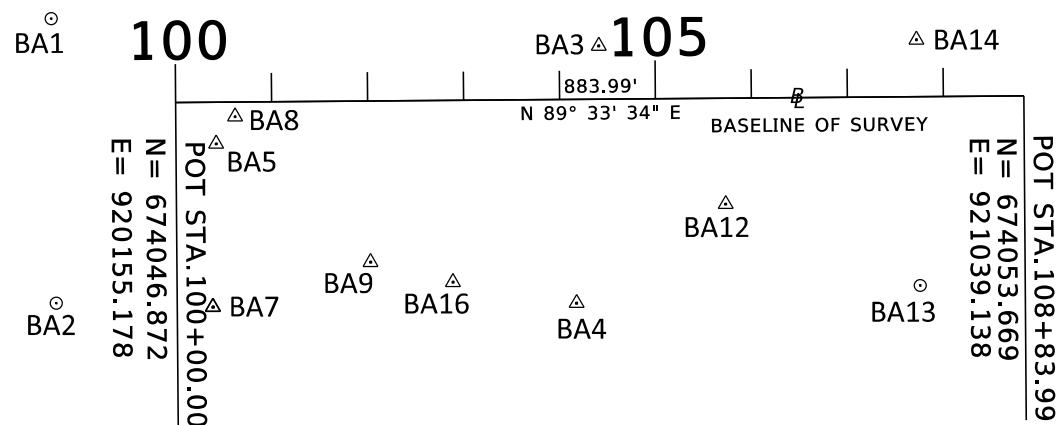
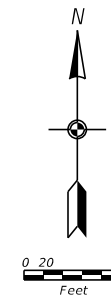

LIMITS: 3400 W. COMMERCIAL BLVD.

ABBREVIATIONS:

- ☒ - BASELINE
- C.R. - COUNTY ROAD
- NO. - NUMBER
- PNC - PROJECT NETWORK CONTROL
- POT - POINT ON TANGENT
- S.R. - STATE ROAD
- STA - STATION

SYMBOLS:

⊙ △ - PRIMARY CONTROL POINT

BASELINE WAS NOT STAKED IN THE FIELD
 BASELINE OF SURVEY WAS ASSUMED SETTING TWO RANDOM POINTS USING RTK
 BEARINGS AND COORDINATES ARE RELATIVE TO THE STATE PLANE COORDINATES, FLORIDA EAST ZONE,
 NORTH AMERICAN DATUM (NAD) OF 83/90 ADJUSTMENT
 A BEARING OF S 1°01'23.6\"/>

POINT NAME	(Y) NORTHING	(X) EASTING	SCALE FACTOR	LATITUDE	LONGITUDE	BASELINE STATION	OFFSET	(Z) ELEVATION	DESCRIPTION
BA1	674134.275	920025.399	1.000021010	26°11'09.82314	80°11'43.43945	N/A	N/A	8.070	SET 5/8" I.R. & FDOT CAP
BA2	673837.699	920030.696	1.000021010	26°11'06.88562	80°11'43.40148	N/A	N/A	8.860	SET 5/8" I.R. & FDOT CAP
BA3	674105.904	920596.060	1.000021350	26°11'09.50710	80°11'37.17733	104+41.322	-55.640'	6.640	SET PK NAIL & WASHER
BA4	673837.740	920573.035	1.000021340	26°11'06.85271	80°11'37.44835	104+16.236	212.339'	6.970	SET PK NAIL & WASHER
BA5	673998.790	920187.793	1.000021100	26°11'08.47137	80°11'41.66610	100+32.244	48.332'	8.075	SET PK NAIL & WASHER
BA7	673833.648	920194.051	1.000021110	26°11'06.83547	80°11'41.60865	100+37.232	213.517'	7.701	SET PK NAIL & WASHER
BA8	674032.129	920216.989	1.000021120	26°11'08.79976	80°11'41.34335	100+61.695	15.218'	8.005	SET PK NAIL & WASHER
BA9	673880.497	920358.326	1.000021210	26°11'07.28936	80°11'39.80225	102+01.862	167.932'	8.880	SET PK NAIL & WASHER
BA12	673940.929	920728.376	1.000021430	26°11'07.86510	80°11'35.73618	105+72.366	110.347'	8.052	SET PK NAIL & WASHER
BA13	673856.146	920931.174	1.000021560	26°11'07.01295	80°11'33.51590	107+72.458	-59.482'	8.268	SET 5/8" I.R. & FDOT CAP
BA14	674112.292	920927.157	1.000021550	26°11'09.54999	80°11'33.54251	107+74.506	196.687'	6.305	SET PK NAIL & WASHER
BA16	673859.690	920444.158	1.000021260	26°11'07.07802	80°11'38.86151	102+87.531	189.399'	7.681	SET PK NAIL & WASHER

REVISIONS		ENGINEER OF RECORD		STATE OF FLORIDA DEPARTMENT OF TRANSPORTATION			PROJECT CONTROL	SHEET NO. 2
DATE	DESCRIPTION	DATE	DESCRIPTION	ROAD NO.	COUNTY	FINANCIAL PROJECT ID		
					BROWARD	444761-5-52-01		

12/13/2021 9:40:38 AM RD452BR C:\p\o\p\cts\FDOT\444761-5-52-01\Roadway\PLAN\RD02.dgn

THE OFFICIAL RECORD OF THIS SHEET IS THE ELECTRONIC FILE DIGITALLY SIGNED AND SEALED UNDER RULE 61G15-23.004, F.A.C.

GENERAL NOTES

- BENCHMARK ELEVATIONS SHOWN ON THE PLANS ARE NORTH AMERICAN VERTICAL DATUM OF 1988 (NAVD 88).
- ALL SURVEY INFORMATION WAS OBTAINED FROM A LICENSED FLORIDA PROFESSIONAL SURVEYOR AND MAPPER AND UTILIZED AS SUPPORTING DATA IN THE PRODUCTION OF DESIGN PLANS AND FOR CONSTRUCTION ON SUBJECT PROJECT. THE PROFESSIONAL SURVEYOR'S LICENSE NUMBER IS: PSR 15000.
- THE LOCATIONS OF THE UTILITIES SHOWN IN THE PLANS (INCLUDING THOSE DESIGNATED BY "V", "W", AND "U") ARE BASED ON LIMITED INVESTIGATION TECHNIQUES AND SHOWN BY CONSIDERED APPROXIMATE. ONLY THE VERIFIED LOCATIONS/ELEVATIONS APPLY ONLY AT THE POINTS SHOWN. INTERPOLATIONS BETWEEN THESE POINTS HAVE NOT BEEN VERIFIED.
- NO FILLED MATERIAL IS TO BE UTILIZED IN THIS PROJECT.

PAY ITEM NOTES:

- 711 16101 THERMOPLASTIC, STANDARD, OTHER SURFACES, WHITE, SOLID, 6" INCLUDES THE COST OF GREEN 6" THERMOPLASTIC.
- 711 12100 THERMOPLASTIC, PREFORMED, WHITE, MESSAGE, INCLUDES THE COST OF GREEN MESSAGES.

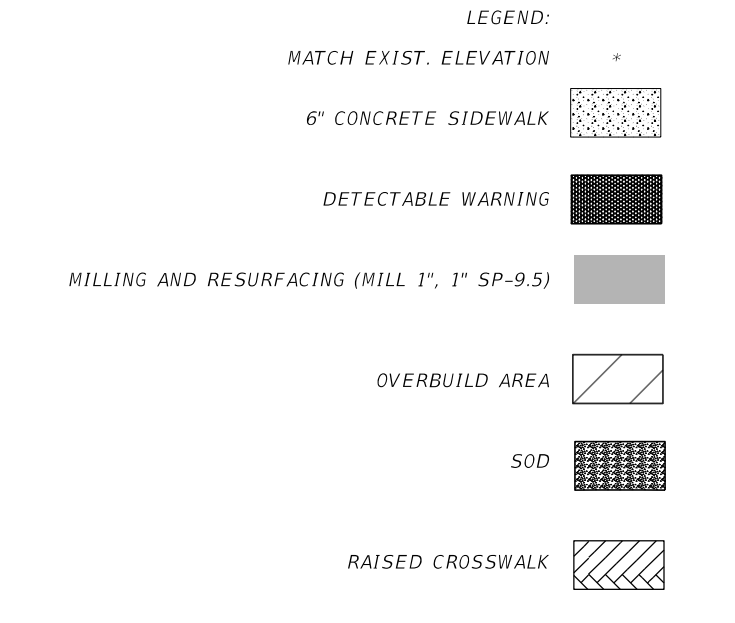

DRAINAGE STRUCTURES TABLE

STR. NO.	STA.	OFFSET	SIDE	INVERT ELEVATION (NAVD 88)				STR. BOTTOM ELEVATION	STRUCTURE TYPE	FDOT INDEX NUMBER	REMARKS
				N	S	E	W				
S-1	104+28.37	35.51'	RP	1.12			-2.35		TYPE F DBI	425-053	
S-2	105+19.99	37.35'	RP	7.00	1.50	8.07	-2.00		TYPE F DBI	425-053	
S-3	105+36.59	20.60'	RP	6.00	0.11	-0.90	-2.00		TYPE F DBI	425-052	
S-4	105+19.99	20.60'	RP	2.95	-1.01		-2.00		TYPE F DBI	425-052	
S-5	107+32.60	20.14'	RP	3.88	0.73	0.00	-2.00		TYPE F DBI	425-052	
S-7	107+32.34	236.30'	RP	2.35	-0.50		-2.00		TYPE F DBI	425-052	

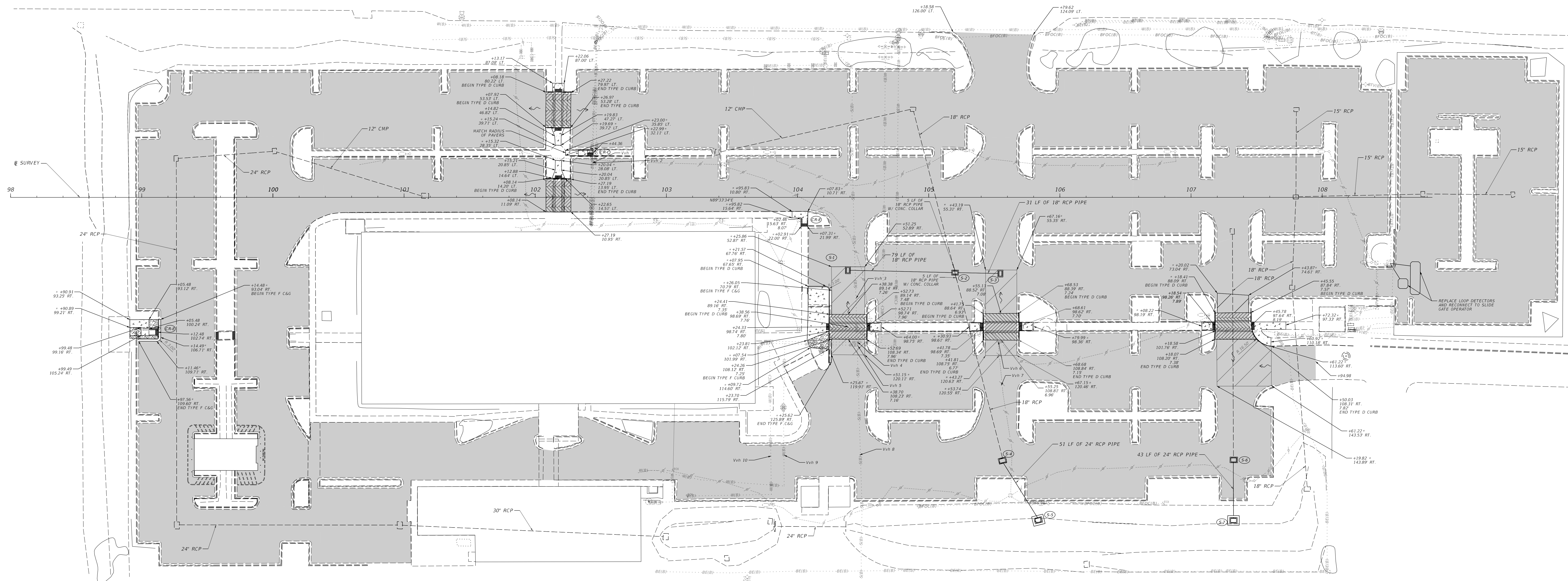

THE OFFICIAL RECORD OF THIS SHEET IS THE ELECTRONIC FILE DIGITALLY SIGNED AND SEALED UNDER RULE 61E15-23.004, F.A.C.

TEMPORARY TRAFFIC CONTROL PLAN NOTES

- FOR ALL PHASES EXCEPT 1A AND 1B, WORK TO BE PERFORMED FROM 6:30 PM TO 5:00 AM, MONDAY THROUGH FRIDAY, AND ALL DAY SATURDAY AND SUNDAY. PHASES 1A AND 1B MAY BE PERFORMED DURING THE DAY.
- AREA IDENTIFIED AS 1B MAY BE USED FOR STORAGE OF STORAGE EQUIPMENT DURING THE DURATION OF THE PROJECT EXCEPT FOR THE AREAS IDENTIFIED AS 1A AND 1B.
- PARKING LOT TO BE OPEN AND CLEAR TO ALLOW USE AFTER 5:00 AM ON WEEKDAYS.
- CONTACT THE FOLLOWING PRIOR TO PHASE 1 CONSTRUCTION TO COORDINATE MOTOR POOL VEHICLE REMOVAL: RICHARD PALUSH, DISTRICT FLEET MANAGER (954) 777-8276.
- CONTACT THE FOLLOWING PRIOR TO ALL CONSTRUCTION PHASES FOR COORDINATION: PATRICK PATRICK, DISTRICT FACILITY MANAGER (954) 671-2594 OR CELL PHONE (954) 620-2574. KYLE VILLENA, BUILDING SUPERINTENDENT (954) 777-4096 OR CELL PHONE (954) 918-0122.

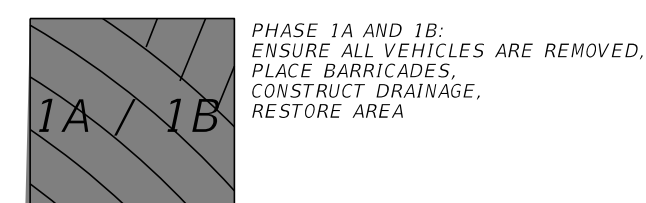

PHASE 1A AND 1B:
ENSURE ALL VEHICLES ARE REMOVED.
PLACE BARRIERS.
CONSTRUCT BARRIERS.
RESTORE AREA.

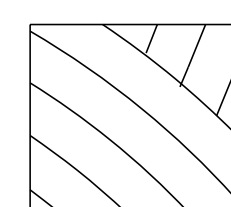

PHASE 2:
ENSURE ALL VEHICLES ARE REMOVED.
PLACE BARRIERS.
CONSTRUCT CURB AND SIDEWALK.
NILL AND RECONSTRUCT LOT.
CONSTRUCT RAISED CROSSWALK.
INSTALL PAINT FOR PHAS.
INSTALL CONCRETE BUMPER GUARDS.

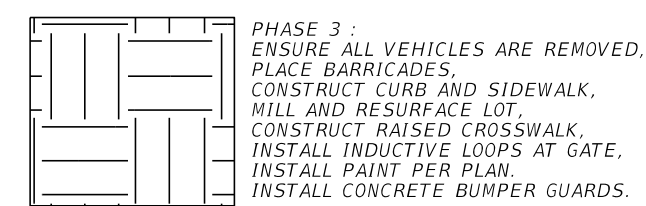

PHASE 3:
ENSURE ALL VEHICLES ARE REMOVED.
PLACE BARRIERS.
CONSTRUCT CURB AND SIDEWALK.
NILL AND RECONSTRUCT LOT.
CONSTRUCT RAISED CROSSWALK.
INSTALL PAINT FOR PHAS.
INSTALL CONCRETE BUMPER GUARDS.

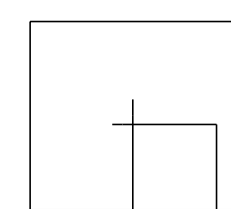

PHASE 4:
ENSURE ALL VEHICLES ARE REMOVED.
PLACE BARRIERS.
CONSTRUCT CURB AND SIDEWALK.
NILL AND RECONSTRUCT LOT.
CONSTRUCT RAISED CROSSWALK.
INSTALL PAINT FOR PHAS.
INSTALL CONCRETE BUMPER GUARDS.

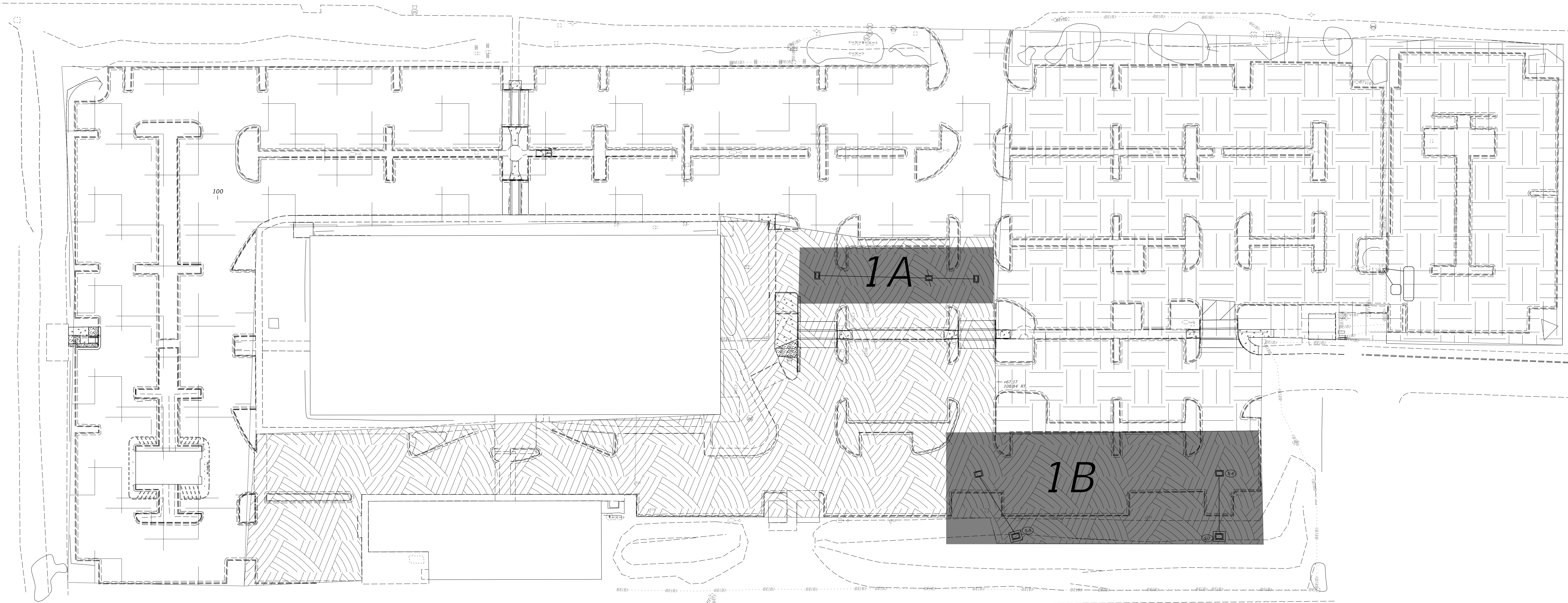

THE OFFICIAL RECORD OF THIS SHEET IS THE ELECTRONIC FILE DIGITALLY SIGNED AND SEALED UNDER RULE 61E15-23.004, F.A.C.

PAVEMENT MARKING NOTES:

1. FIRE LANE MARKINGS AND MESSAGES ARE YELLOW. THE CURB ADJACENT TO IT IS TO BE PAINTED YELLOW AS WELL.
2. NO PARKING MESSAGES ARE YELLOW.
3. GUEST PARKING SPACES ARE TO HAVE YELLOW PAINTED BUMPER GUARDS WITH BLACK TEXT AS FOLLOWS: GUEST

LEGEND:

- E ELECTRIC VEHICLE PARKING SPACE
- GUEST GUEST PARKING SPACE

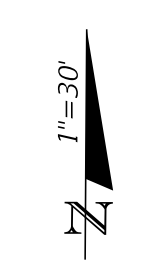
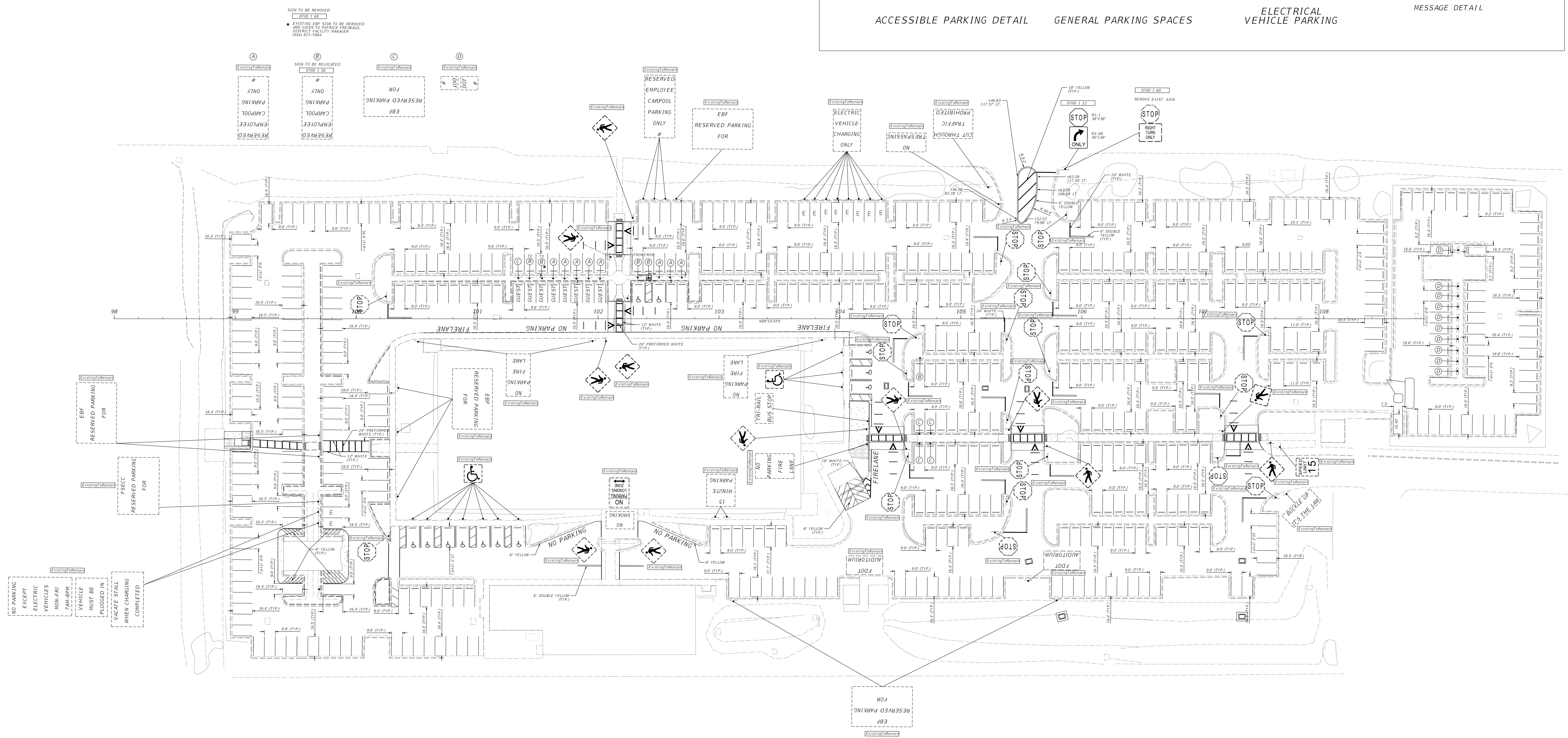
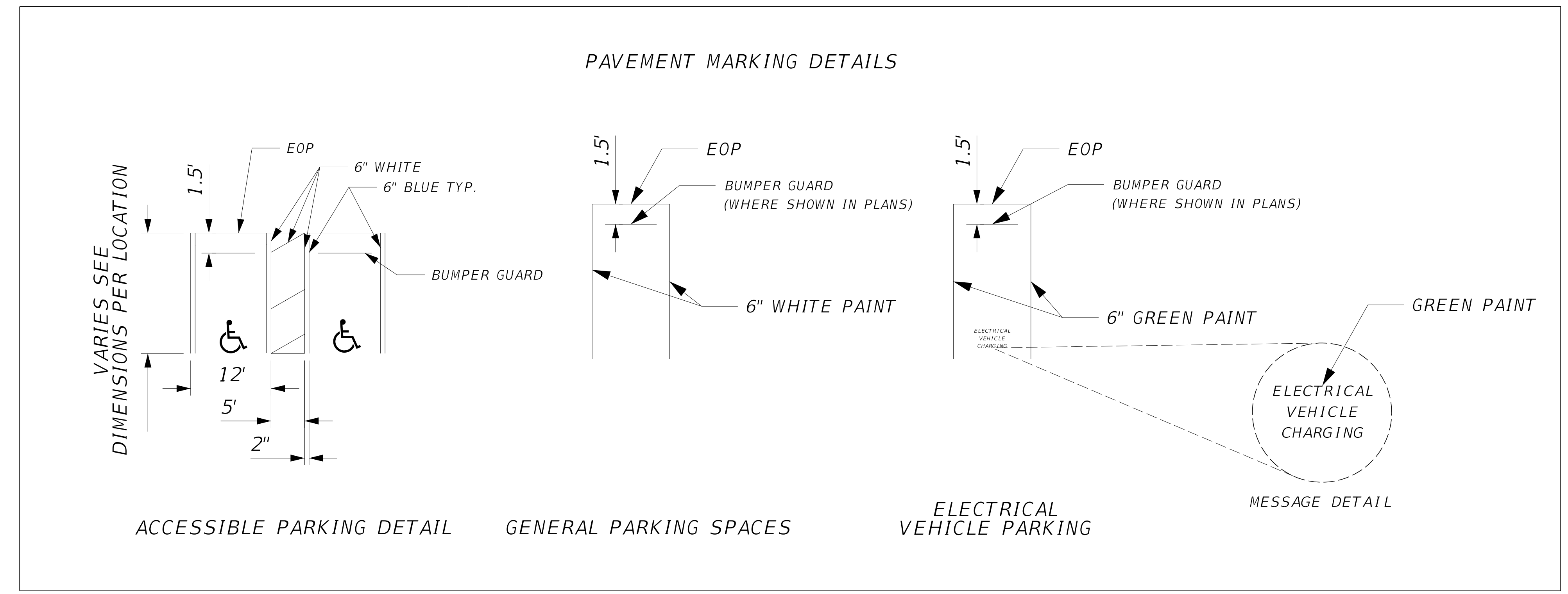

THE OFFICIAL RECORD OF THIS SHEET IS THE ELECTRONIC FILE DIGITALLY SIGNED AND SEALED UNDER RULE 61B15-23.004, F.A.C.

GENERAL NOTES:

1. Work this Index with Developmental Specifications 520.
2. Install detectable warnings in accordance with Specification 527.
3. Match the final lift of asphalt to the raised crosswalk to the final lift used on the adjacent roadway.
4. See the Plans for milling and paving details.

TABLE OF CONTENTS:	
Sheet	Description
1	General Notes and Contents
2	Raised Crosswalk With RC Channel Gutter
3	Raised Crosswalk With Type D Curb
4	Pavement Markings

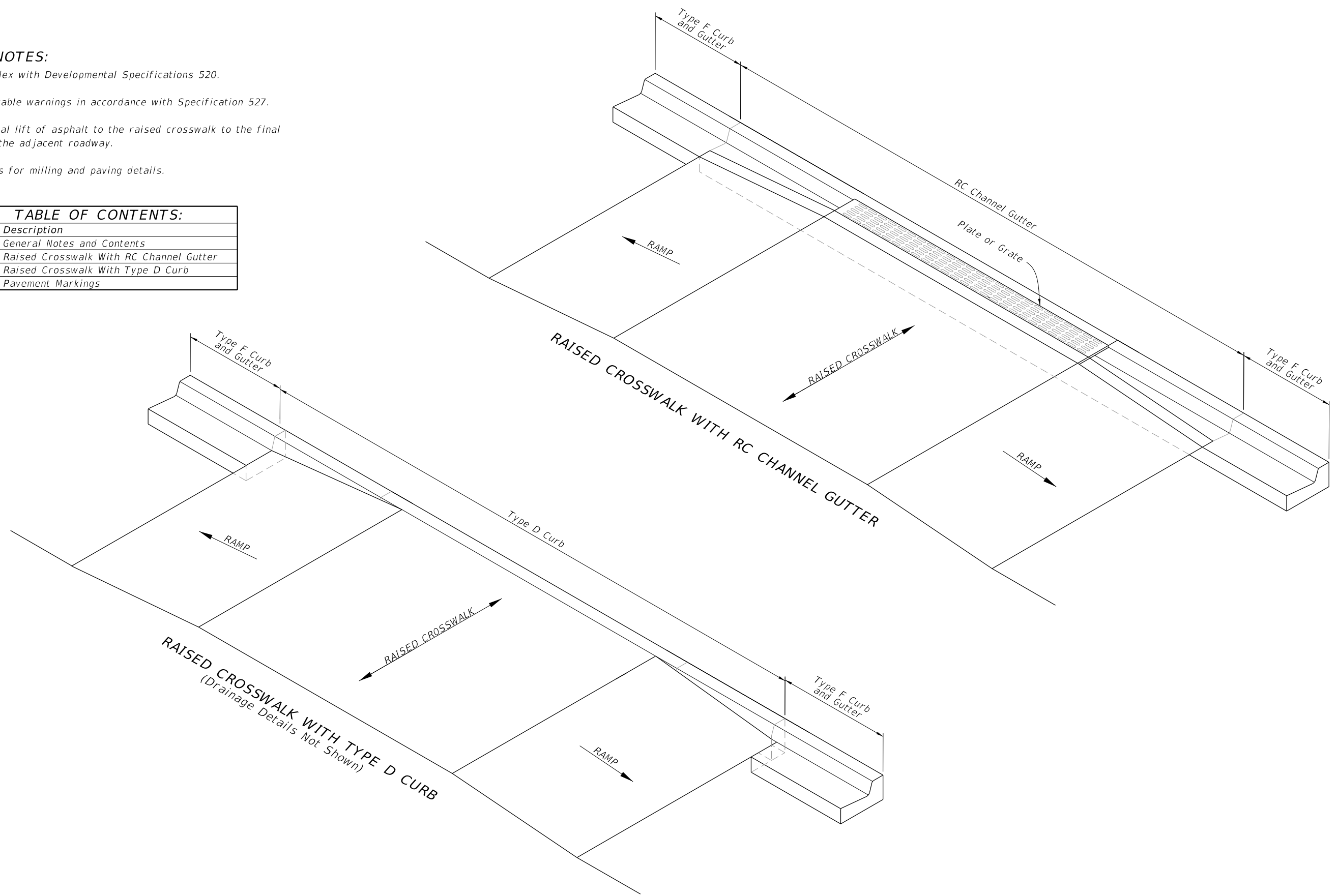

12/11/2020 8:00:27 AM

LAST REVISION 09/01/20	DESCRIPTION:
---------------------------	--------------



RAISED CROSSWALK

INDEX D520-030	SHEET 1 of 4
-------------------	-----------------

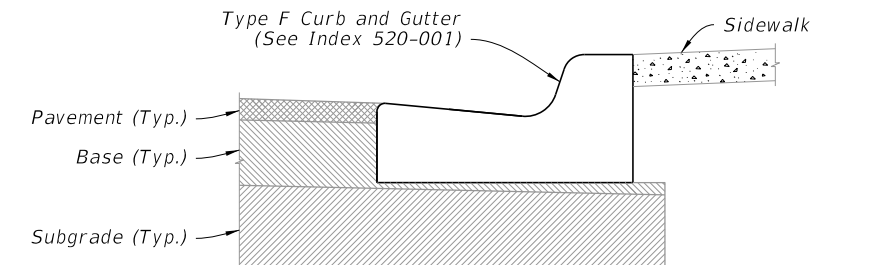
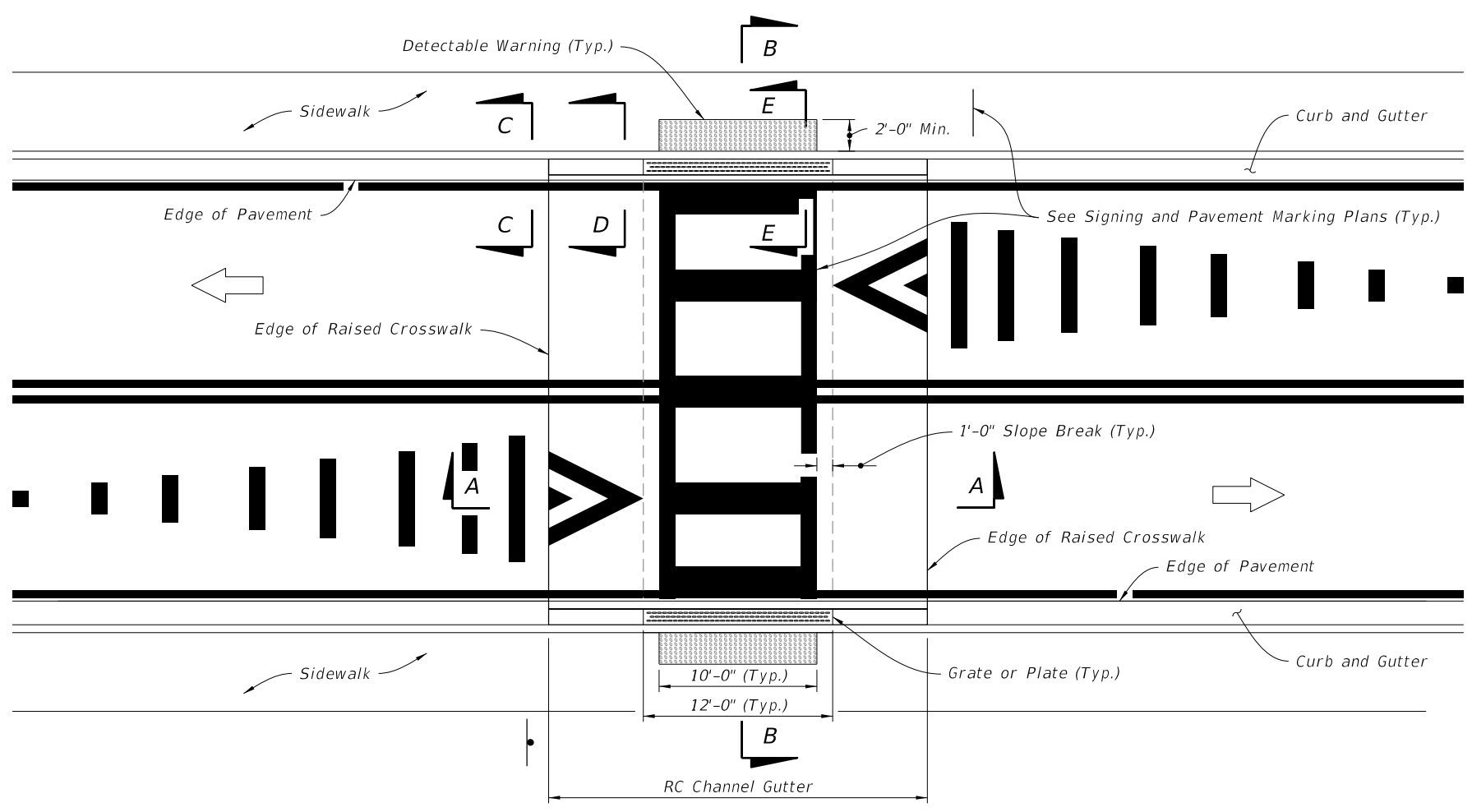

SECTION C-C

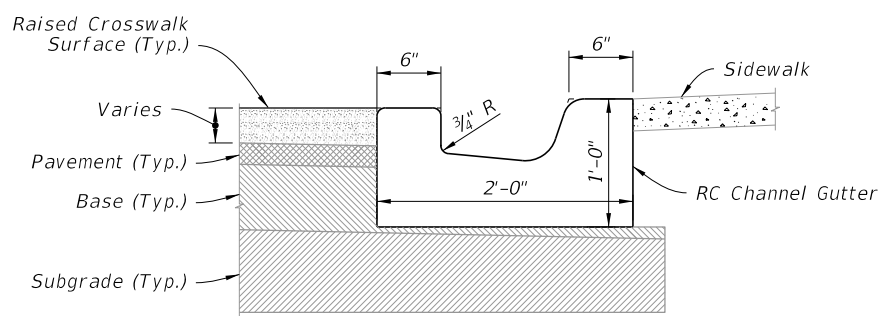

SECTION D-D

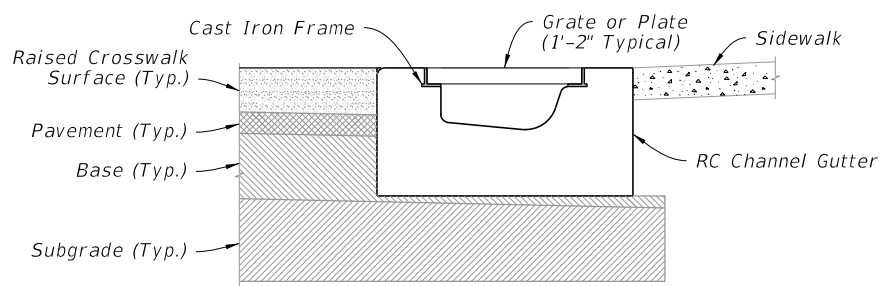

SECTION E-E

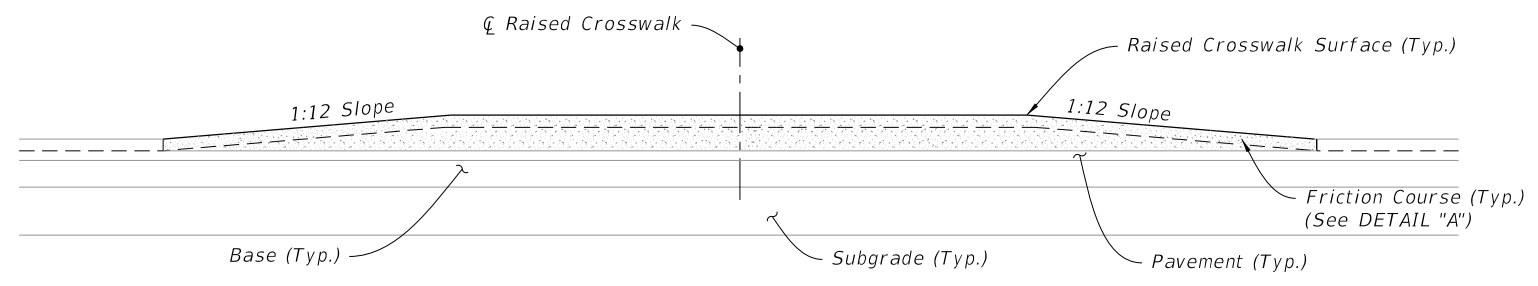

SECTION A-A

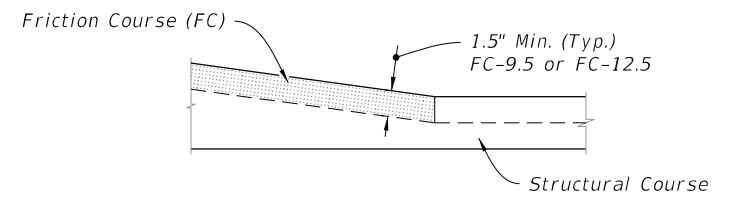

DETAIL "A"

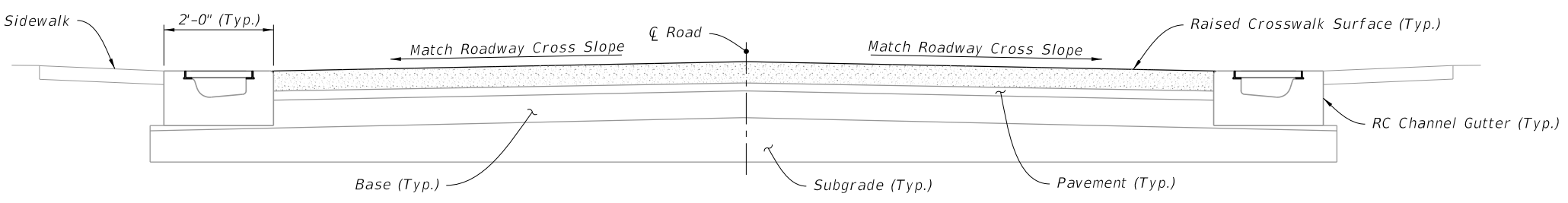

SECTION B-B

- SYMBOLS:**
- Direction of Traffic
 - Sign and Column

RAISED CROSSWALK WITH RC CHANNEL GUTTER

12/11/2020 8:00:32 AM

LAST REVISION 12/11/20	REVISION	DESCRIPTION:		DEVELOPMENTAL STANDARD PLANS	RAISED CROSSWALK	INDEX D520-030	SHEET 2 of 4
---------------------------	----------	--------------	--	---------------------------------	------------------	-------------------	-----------------

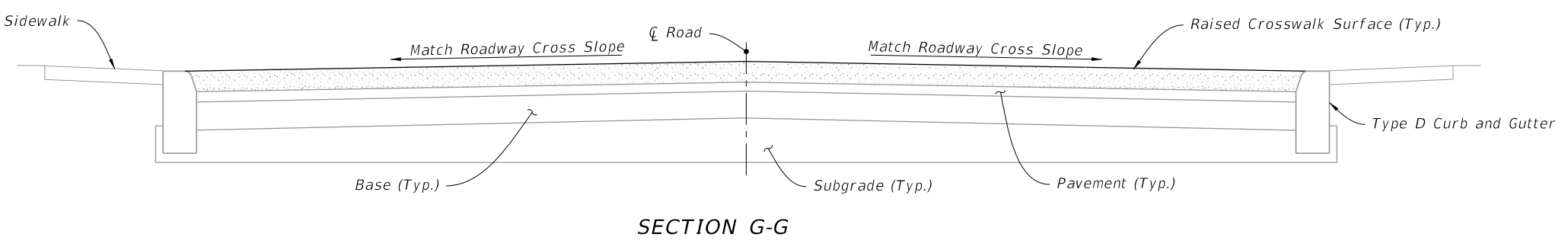
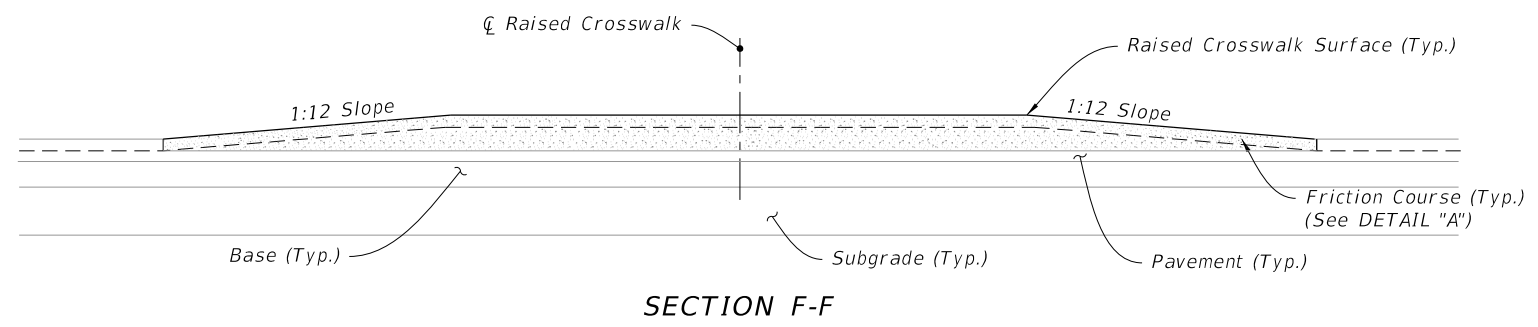
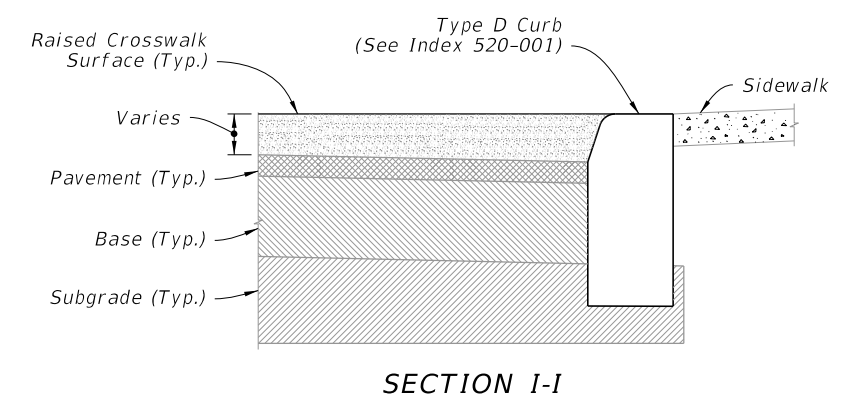
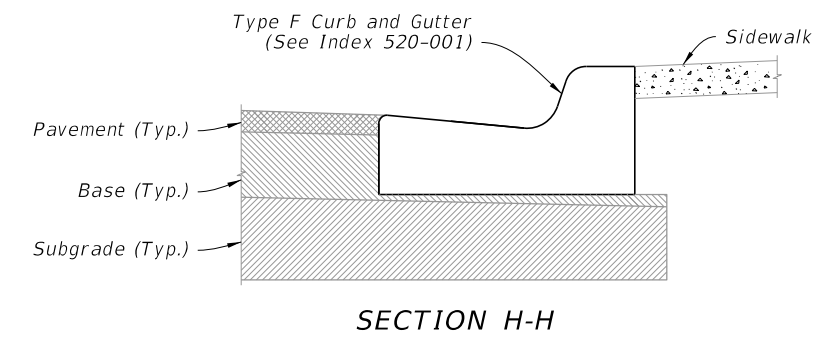
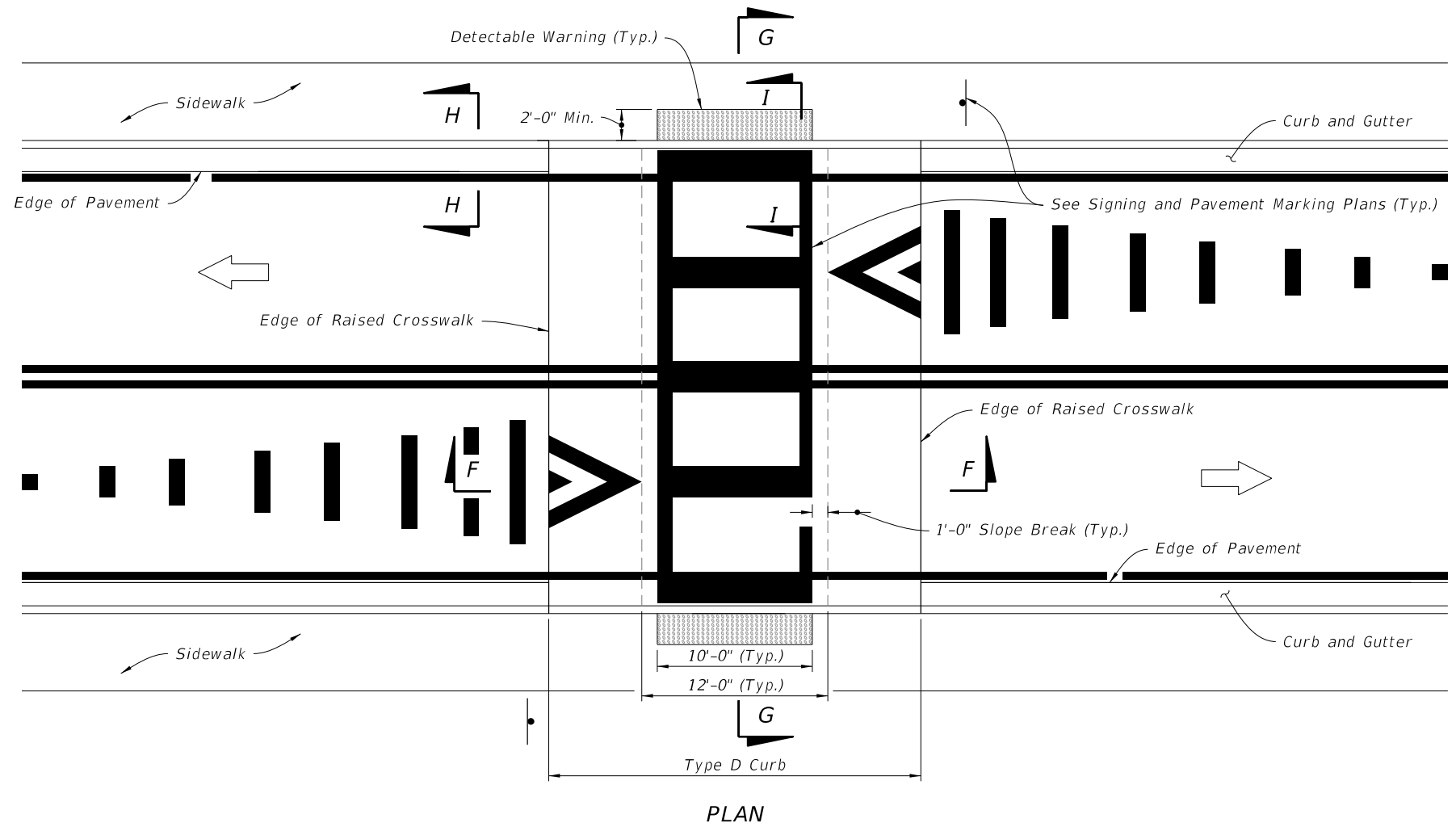

SYMBOLS:

➔ Direction of Traffic

⊙ Sign and Column

RAISED CROSSWALK WITH TYPE D CURB

12/11/2020 8:00:38 AM

LAST REVISION 12/11/20	REVISION	DESCRIPTION:	DEVELOPMENTAL STANDARD PLANS	RAISED CROSSWALK	INDEX	SHEET
					D520-030	3 of 4

NOTE:

Only install advance warning marking when shown in Plans.

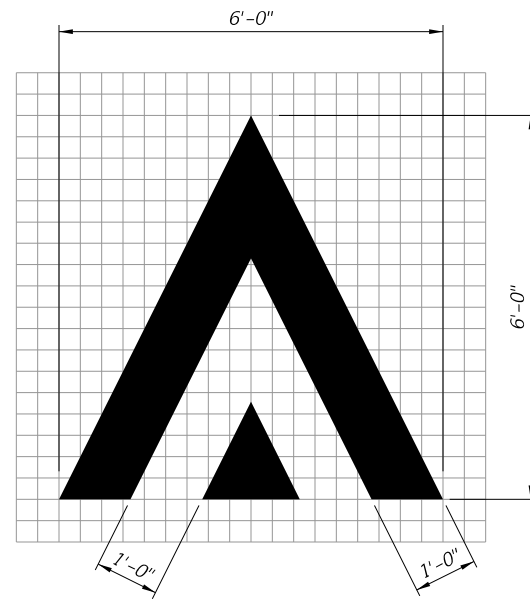

12 S.F.

=====**VERTICAL DEFLECTION MARKING**=====

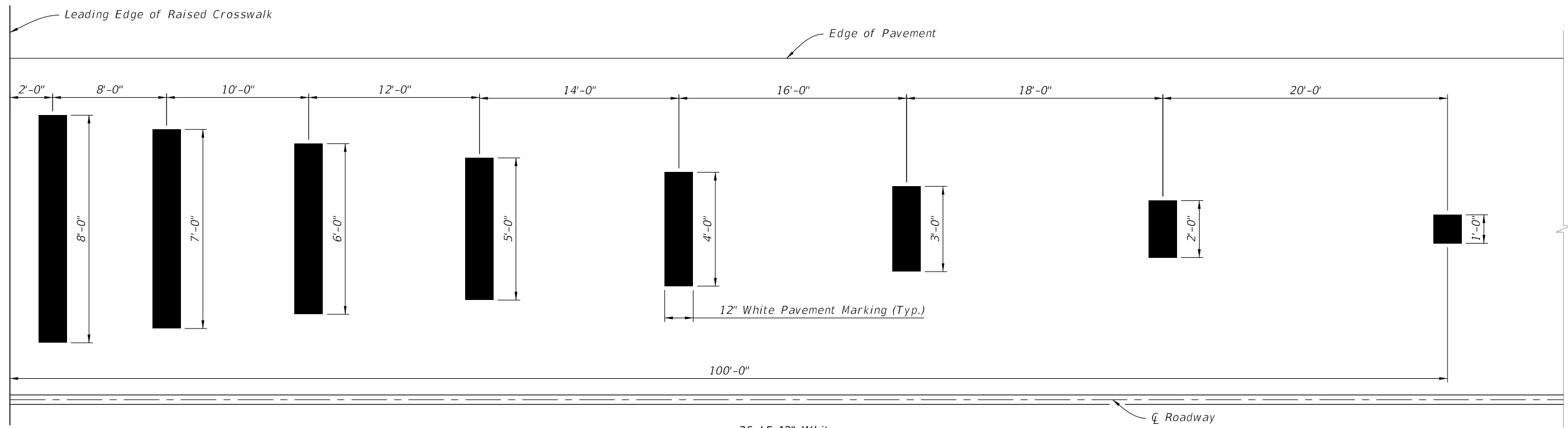

=====**VERTICAL DEFLECTION ADVANCE WARNING MARKING**=====

12/11/2020 8:00:40 AM

PAVEMENT MARKINGS

LAST REVISION 09/01/20	REVISION	DESCRIPTION:
---------------------------	----------	--------------



**DEVELOPMENTAL
STANDARD PLANS**

RAISED CROSSWALK

INDEX
D520-030

SHEET
4 of 4