

CONTRACT PLANS COMPONENTS
ROADWAY PLANS
SIGNING AND PAVEMENT MARKING PLANS
SIGNALIZATION PLANS
INTELLIGENT TRANSPORTATION SYSTEMS PLANS
LIGHTING PLANS
LANDSCAPE PLANS
ARCHITECTURAL PLANS
STRUCTURE PLANS
TOLL FACILITIES PLANS

STATE OF FLORIDA
DEPARTMENT OF TRANSPORTATION

CONTRACT PLANS

FINANCIAL PROJECT ID 123456-1-52-01
(FEDERAL FUNDS)
BAY COUNTY (46080)
STATE ROAD NO. 22 (WEWA HWY)

INDEX OF ROADWAY PLANS

SHEET NO.	SHEET DESCRIPTION
1	KEY SHEET
2	SIGNATURE SHEET
3	SUMMARY OF PAY ITEMS
4	DRAINAGE MAP
5 - 6	TYPICAL SECTIONS
7	TYPICAL SECTION DETAILS
SQ-1 - SQ-6	SUMMARY OF QUANTITIES
8	SUMMARY OF DRAINAGE STRUCTURES
9	OPTIONAL MATERIALS TABULATION
10	PROJECT LAYOUT
11	PROJECT CONTROL
12	GENERAL NOTES
13 - 16	ROADWAY PLAN-PROFILES
17	TRAFFIC MONITORING SITE
18	SPECIAL PROFILES
19	INTERSECTION LAYOUT
20 - 26	DRAINAGE STRUCTURES
27 - 33	BOX CULVERT DETAILS
34	LATERAL DITCH PLAN-PROFILES
35	LATERAL DITCH CROSS SECTIONS
36	SPECIAL DETAILS
37 - 47	CROSS SECTIONS
48	STORMWATER POLLUTION PREVENTION PLAN
49 - 52	TEMPORARY TRAFFIC CONTROL PLANS
53 - 57	UTILITY ADJUSTMENTS
58 - 62	SELECTIVE CLEARING AND GRUBBING
GR-1*	ROADWAY SOIL SURVEY

DEVELOPMENTAL DESIGN STANDARDS (DDS):
D450 HIGH-TENSION CABLE BARRIER

* This sheet is included in the Index of Roadway Plans only to indicate that it is part of the Roadway Plans. This sheet is contained in a separate digitally signed and sealed document.

GOVERNING DESIGN STANDARDS:

Florida Department of Transportation, FY2016-17 Design Standards eBook (DSeB) and applicable Design Standards Revisions (DSRs) at the following website:
<http://www.fdot.gov/roadway/DesignStandards/Standards.shtm>

APPLICABLE DSRs: DSR400-01, DSR410-01, DSR411-01

GOVERNING STANDARD SPECIFICATIONS:

Florida Department of Transportation, July 2016 Standard Specifications for Road and Bridge Construction at the following website:
<http://www.fdot.gov/programmanagement/Implemented/SpecBooks>

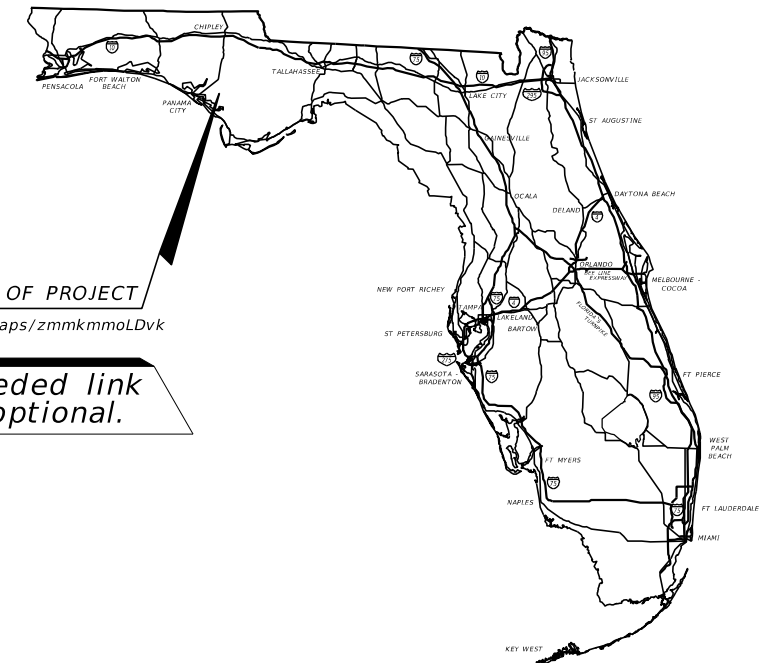

LOCATION OF PROJECT
<https://goo.gl/maps/zmmkmmoLDvk>

Embedded link is optional.

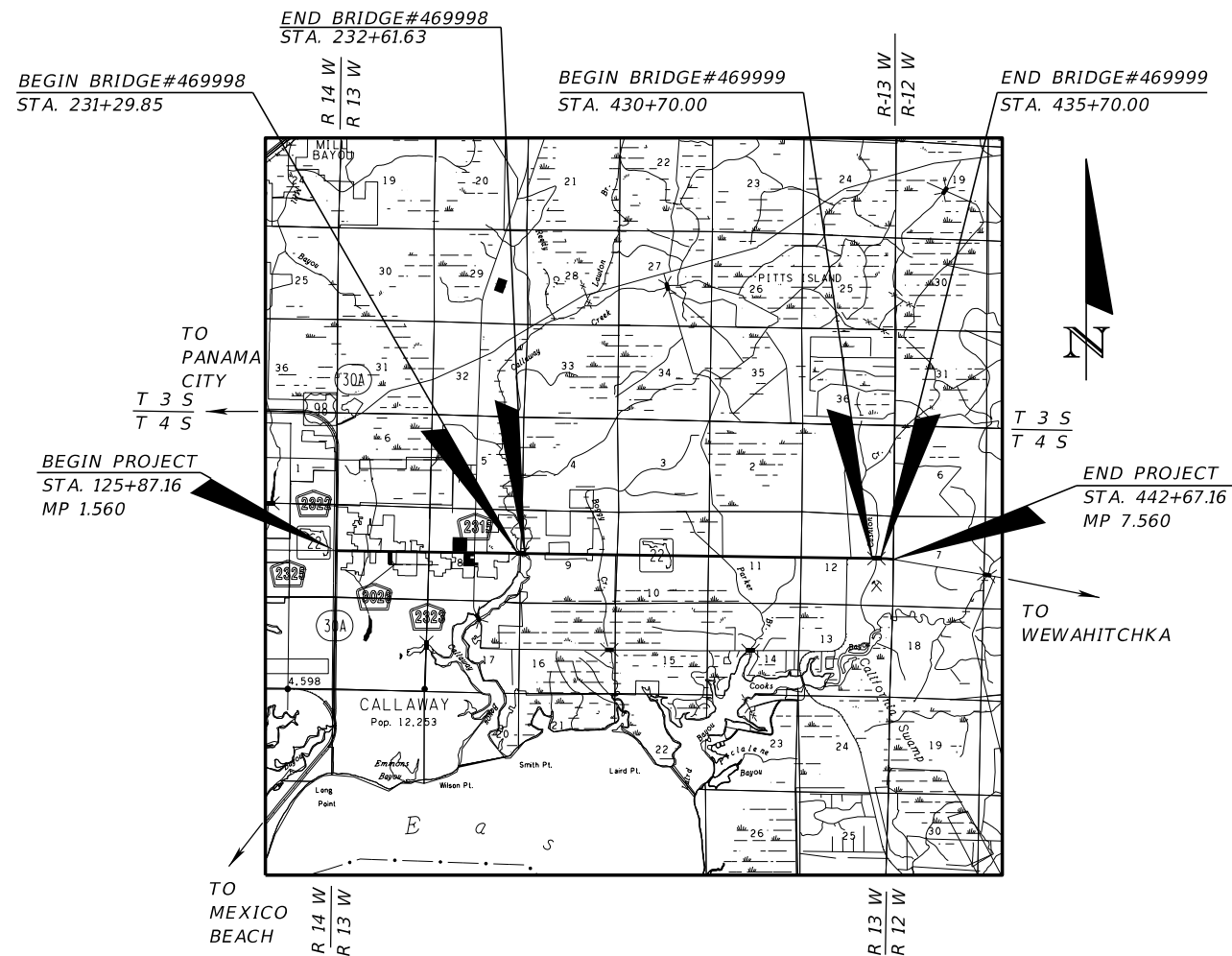

**ROADWAY PLANS
ENGINEER OF RECORD:**

LUKE S. WALKER, P.E. NO.: 99991
ROADWAY ENGINEERS, INC.
123 MAIN STREET
TALLAHASSEE, FL 32301
(850) 671-1313
CONTRACT NO.: C0000
VENDOR NO.: 99-999999
CERTIFICATE OF AUTHORIZATION NO.: 12345

FDOT PROJECT MANAGER:

BEN K. UWAIBI, P.E.

KS-1:
Original Key Sheet
Date: 1/1/17

CONSTRUCTION CONTRACT NO.	FISCAL YEAR	SHEET NO.
T0000	17	1

- CONTRACT PLANS COMPONENTS**
 ROADWAY PLANS
 SIGNING AND PAVEMENT MARKING PLANS
 SIGNALIZATION PLANS
 INTELLIGENT TRANSPORTATION SYSTEMS PLANS
 LIGHTING PLANS
 LANDSCAPE PLANS
 ARCHITECTURAL PLANS
 STRUCTURE PLANS
 TOLL FACILITIES PLANS

STATE OF FLORIDA
 DEPARTMENT OF TRANSPORTATION

CONTRACT PLANS

FINANCIAL PROJECT ID 123456-1-52-01
 (FEDERAL FUNDS)
 BAY COUNTY (46080)
 STATE ROAD NO. 22 (WEWA HWY)

INDEX OF ROADWAY PLANS

SHEET NO.	SHEET DESCRIPTION
1	KEY SHEET
2 - 2A	SIGNATURE SHEET
3	SUMMARY OF PAY ITEMS
4	DRAINAGE MAP
5 - 6	TYPICAL SECTIONS
7	TYPICAL SECTION DETAILS
SQ-1 - SQ-6	SUMMARY OF QUANTITIES
8	SUMMARY OF DRAINAGE STRUCTURES
9	OPTIONAL MATERIALS TABULATION
10	PROJECT LAYOUT
11	PROJECT CONTROL
12	GENERAL NOTES
13 - 16	ROADWAY PLAN-PROFILES
17	TRAFFIC MONITORING SITE
18	SPECIAL PROFILES
19	INTERSECTION LAYOUT
20 - 26	DRAINAGE STRUCTURES
27 - 33	BOX CULVERT DETAILS
34	LATERAL DITCH PLAN-PROFILES
35	LATERAL DITCH CROSS SECTIONS
36 - 36A	SPECIAL DETAILS
37 - 47	CROSS SECTIONS
48	STORMWATER POLLUTION PREVENTION PLAN
49 - 52	TEMPORARY TRAFFIC CONTROL PLANS
53 - 57	UTILITY ADJUSTMENTS
58 - 62	SELECTIVE CLEARING AND GRUBBING
GR-1*	ROADWAY SOIL SURVEY

USE CLOUD FOR POST-LET REVISIONS

DEVELOPMENTAL DESIGN STANDARDS (DDS):
 D450 HIGH-TENSION CABLE BARRIER

* This sheet is included in the Index of Roadway Plans only to indicate that it is part of the Roadway Plans. This sheet is contained in a separate digitally signed and sealed document.

GOVERNING DESIGN STANDARDS:

Florida Department of Transportation, FY2016-17 Design Standards eBook (DSeB) and applicable Design Standards Revisions (DSRs) at the following website:
<http://www.fdot.gov/roadway/DesignStandards/Standards.shtm>

APPLICABLE DSRs: DSR400-01, DSR410-01, DSR411-01

GOVERNING STANDARD SPECIFICATIONS:

Florida Department of Transportation, July 2016 Standard Specifications for Road and Bridge Construction at the following website:
<http://www.fdot.gov/programmanagement/Implemented/SpecBooks>

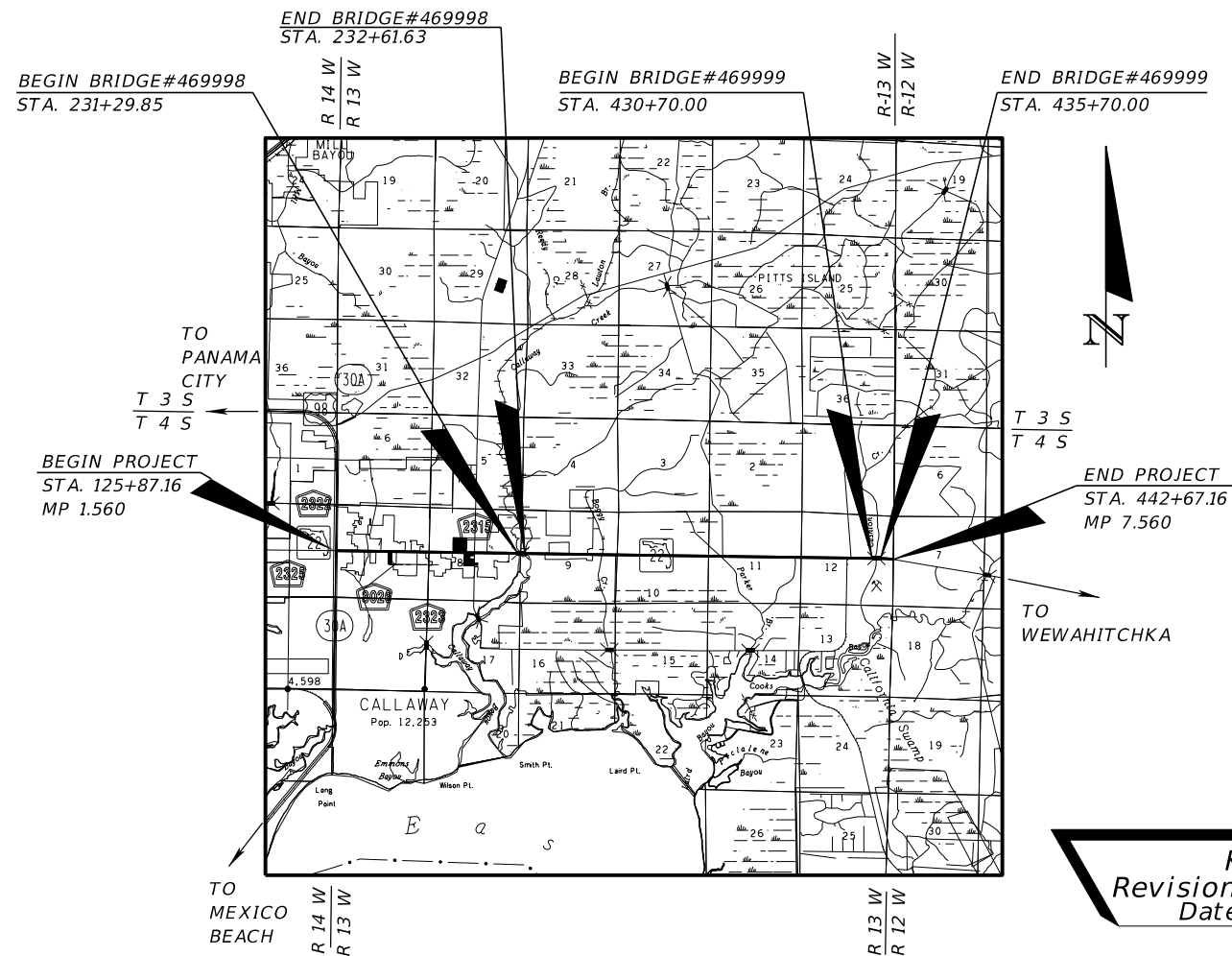
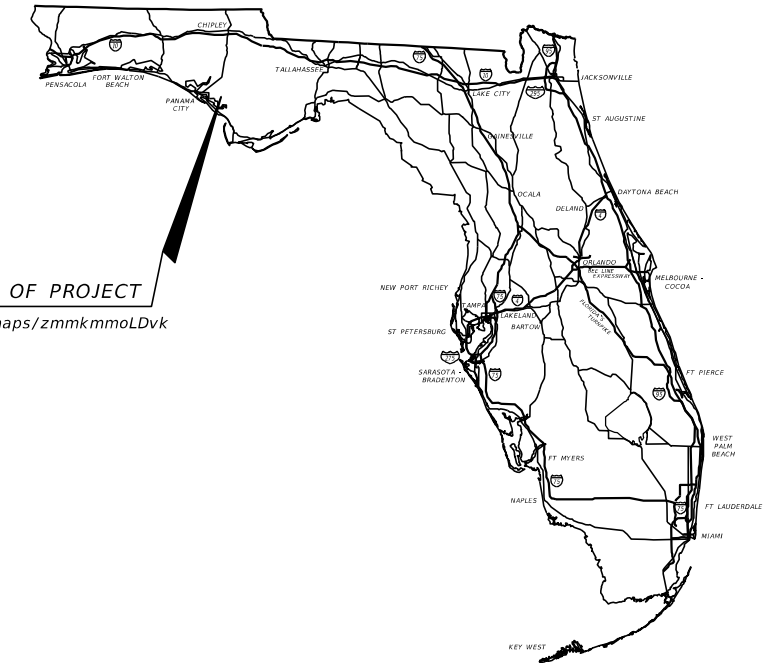

KS-2:
 Revision Key Sheet
 Date: 1/1/17

REVISIONS:

- FINANCIAL PROJECT ID 123456-1-52-01
 Roadway Sheet 1, 2A, 27, & 35A (Revised 10-14-16)
- FINANCIAL PROJECT ID 123457-1-52-01
 Structure Sheets B-1 & C-1 THRU C-10 (Revised 10-14-16)

KEY SHEET REVISIONS	
DATE	DESCRIPTION
10-14-16	Added Sheet Numbers 2A & 35A to index

**ROADWAY PLANS
 ENGINEER OF RECORD:**

LUKE S. WALKER, P.E. NO.: 99991
 ROADWAY ENGINEERS, INC.
 123 MAIN STREET
 TALLAHASSEE, FL 32301
 (850) 671-1313
 CONTRACT NO.: C0000
 VENDOR NO.: 99-999999
 CERTIFICATE OF AUTHORIZATION NO.: 12345

FDOT PROJECT MANAGER:

BEN K. UWAIBI, P.E.

CONSTRUCTION CONTRACT NO.	FISCAL YEAR	SHEET NO.
T0000	17	1A

THE OFFICIAL RECORD OF THIS SHEET IS THE ELECTRONIC FILE DIGITALLY SIGNED AND SEALED UNDER RULE 61G15-23.004, F.A.C.

STATE OF FLORIDA
DEPARTMENT OF TRANSPORTATION

CONTRACT PLANS

FINANCIAL PROJECT ID 123456-1-52-01
(FEDERAL FUNDS)
BAY COUNTY (46080)
STATE ROAD NO. 22 (WEWA HWY)

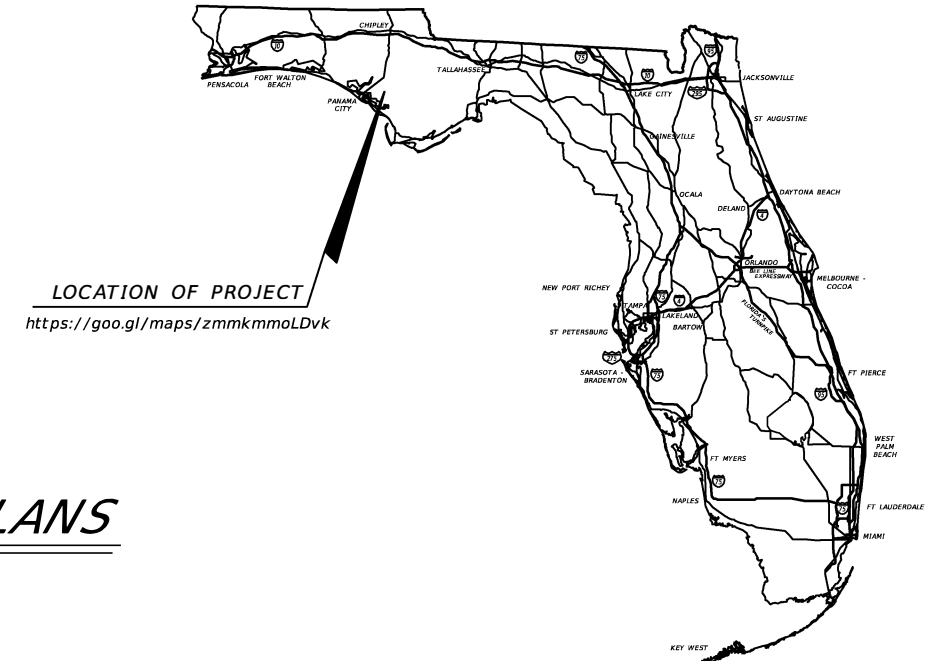

LOCATION OF PROJECT
<https://goo.gl/maps/zmmkmmoLDvk>

INDEX OF SIGNING AND
PAVEMENT MARKING PLANS

SHEET NO.	SHEET DESCRIPTION
S-1	KEY SHEET
S-2	TABULATION OF QUANTITIES
S-3	GENERAL NOTES
S-4 - S-14	PLAN SHEETS
S-15	GUIDE SIGN WORKSHEET

SIGNING AND PAVEMENT MARKINGS PLANS

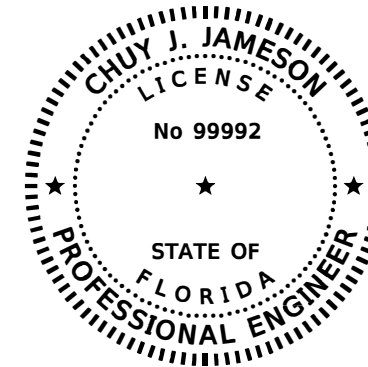

THIS DOCUMENT HAS BEEN DIGITALLY
SIGNED AND SEALED BY:
CHUY J. JAMESON
Date: 2016.10.14
13:53:01 - 04'00'

PRINTED COPIES OF THIS DOCUMENT ARE
NOT CONSIDERED SIGNED AND SEALED.
THE SIGNATURE MUST BE VERIFIED
ON THE ELECTRONIC DOCUMENTS.

**SIGNING AND PAVEMENT
MARKINGS PLANS**
ENGINEER OF RECORD:

CHUY J. JAMESON, P.E. NO.: 99992
ROADWAY ENGINEERS, INC.
123 MAIN STREET
TALLAHASSEE, FL 32301
(850) 671-1313
CONTRACT NO.: C0001
VENDOR NO.: 99-999999
CERTIFICATE OF AUTHORIZATION NO.: 12345

FDOT PROJECT MANAGER:
BEN K. UWAIBI, P.E.

KS-3:
Component Key Sheet
Date: 1/1/17

CONSTRUCTION CONTRACT NO.	FISCAL YEAR	SHEET NO.
T0000	17	1

THE OFFICIAL RECORD OF THIS SHEET IS THE ELECTRONIC FILE DIGITALLY SIGNED AND SEALED UNDER RULE 61G15-23.004, F.A.C.

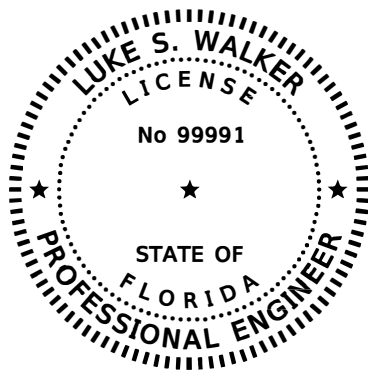

THIS DOCUMENT HAS BEEN DIGITALLY SIGNED AND SEALED BY:

LUKE S. WALKER
Date: 2016.03.09
16:52:48 - 4'00'

PRINTED COPIES OF THIS DOCUMENT ARE NOT CONSIDERED SIGNED AND SEALED. THE SIGNATURE MUST BE VERIFIED ON THE ELECTRONIC DOCUMENTS.

ROADWAY ENGINEERS, INC.
 123 MAIN STREET
 TALLAHASSEE, FL 32301
 CERTIFICATE OF AUTHORIZATION: 12345
 LUKE S. WALKER, P.E. NO. 99991

THE ABOVE NAMED PROFESSIONAL ENGINEER SHALL BE RESPONSIBLE FOR THE FOLLOWING SHEETS IN ACCORDANCE WITH RULE 61G15-23.004, F.A.C.

<u>SHEET NO.</u>	<u>SHEET DESCRIPTION</u>
1	KEY SHEET
2	SIGNATURE SHEET
3	SUMMARY OF PAY ITEMS
4	DRAINAGE MAP
5-6	TYPICAL SECTIONS
7	TYPICAL SECTION DETAILS
SQ1 - SQ-6	SUMMARY OF QUANTITIES
8	SUMMARY OF DRAINAGE STRUCTURES
9	OPTIONAL MATERIALS TABULATION
10	PROJECT LAYOUT
11	GENERAL NOTES
12	PROJECT CONTROL
13-16	ROADWAY PLAN-PROFILES
17	TRAFFIC MONITORING SITE
18	SPECIAL PROFILES
19	INTERSECTION LAYOUT
20-26	DRAINAGE STRUCTURES
34	LATERAL DITCH PLAN-PROFILES
35	LATERAL DITCH CROSS SECTIONS
36	SPECIAL DETAILS
37-47	CROSS SECTIONS
48	STORMWATER POLLUTION PREVENTION PLANS
49-52	TEMPORARY TRAFFIC CONTROL PLANS
53-57	UTILITY ADJUSTMENTS

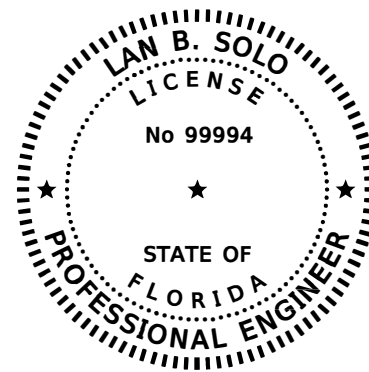

THIS DOCUMENT HAS BEEN DIGITALLY SIGNED AND SEALED BY:

LAN B. SOLO
Date: 2016.03.09
16:42:28 - 4'00'

PRINTED COPIES OF THIS DOCUMENT ARE NOT CONSIDERED SIGNED AND SEALED. THE SIGNATURE MUST BE VERIFIED ON THE ELECTRONIC DOCUMENTS.

STIFF STRUCTURES, CORP.
 605 SEMINOLE STREET
 TALLAHASSEE, FL 32311
 CERTIFICATE OF AUTHORIZATION: 54321
 LAN B. SOLO, P.E. NO. 99994

THE ABOVE NAMED PROFESSIONAL ENGINEER SHALL BE RESPONSIBLE FOR THE FOLLOWING SHEETS IN ACCORDANCE WITH RULE 61G15-23.004, F.A.C.

<u>SHEET NO.</u>	<u>SHEET DESCRIPTION</u>
2	SIGNATURE SHEET
27 - 33	BOX CULVERT DETAILS
D450	HIGH-TENSION CABLE BARRIER

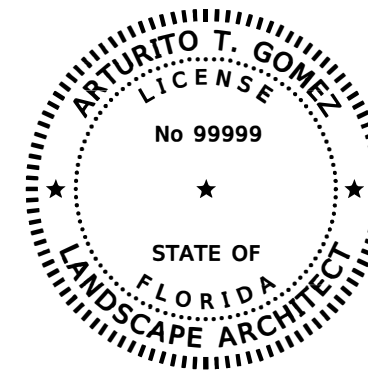

THIS DOCUMENT HAS BEEN DIGITALLY SIGNED AND SEALED BY:

ARTURITO T. GOMEZ
Date: 2016.03.09
15:35:13 - 4'00'

PRINTED COPIES OF THIS DOCUMENT ARE NOT CONSIDERED SIGNED AND SEALED. THE SIGNATURE MUST BE VERIFIED ON THE ELECTRONIC DOCUMENTS.

LANDSCAPERS, LLC.
 345 IVY LANE
 ORLANDO, FL 32801
 CERTIFICATE OF AUTHORIZATION: 98765
 ARTURITO T. GOMEZ, L.A. NO. 99999

THE ABOVE NAMED REGISTERED LANDSCAPE ARCHITECT SHALL BE RESPONSIBLE FOR THE FOLLOWING SHEETS IN ACCORDANCE WITH RULE 61G10-11.011, F.A.C.

<u>SHEET NO.</u>	<u>SHEET DESCRIPTION</u>
2	SIGNATURE SHEET
58 - 62	SELECTIVE CLEARING AND GRUBBING

SS-1: Original Signature Sheet
 Date: 1/1/17

REVISIONS				LUKE S. WALKER, P.E. P.E. LICENSE NUMBER 99991 ROADWAY ENGINEERS, INC. 123 MAIN STREET TALLAHASSEE, FL 32301 CERTIFICATE OF AUTHORIZATION 12345	STATE OF FLORIDA DEPARTMENT OF TRANSPORTATION			SHEET NO. 2
DATE	DESCRIPTION	DATE	DESCRIPTION		ROAD NO.	COUNTY	FINANCIAL PROJECT ID	
					SR 22	BAY	123456-1-52-01	

SIGNATURE SHEET

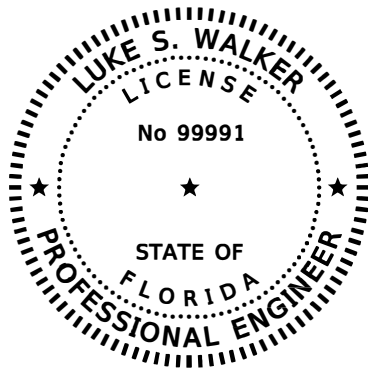

THIS DOCUMENT HAS BEEN DIGITALLY SIGNED AND SEALED BY:

LUKE S. WALKER
Date: 2016.10.14
13:50:13 - 04'00'

PRINTED COPIES OF THIS DOCUMENT ARE NOT CONSIDERED SIGNED AND SEALED. THE SIGNATURE MUST BE VERIFIED ON THE ELECTRONIC DOCUMENTS.

ROADWAY ENGINEERS, INC.
 123 MAIN STREET
 TALLAHASSEE, FL 32301
 CERTIFICATE OF AUTHORIZATION: 12345
 LUKE S. WALKER, P.E. NO. 99991

THE ABOVE NAMED PROFESSIONAL ENGINEER SHALL BE RESPONSIBLE FOR THE FOLLOWING SHEETS IN ACCORDANCE WITH RULE 61G15-23.004, F.A.C.

<u>SHEET NO.</u>	<u>SHEET DESCRIPTION</u>
1	KEY SHEET
2A	SIGNATURE SHEET
36A	SPECIAL DETAIL SHEET

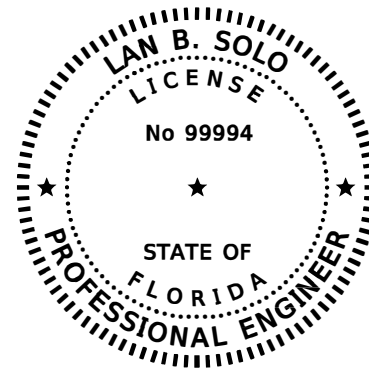

THIS DOCUMENT HAS BEEN DIGITALLY SIGNED AND SEALED BY:

LAN B. SOLO
Date: 2016.10.14
14:44:24 - 4'00'

PRINTED COPIES OF THIS DOCUMENT ARE NOT CONSIDERED SIGNED AND SEALED. THE SIGNATURE MUST BE VERIFIED ON THE ELECTRONIC DOCUMENTS.

STIFF STRUCTURES, CORP.
 605 SEMINOLE STREET
 TALLAHASSEE, FL 32311
 CERTIFICATE OF AUTHORIZATION: 54321
 LAN B. SOLO, P.E. NO. 99994

THE ABOVE NAMED PROFESSIONAL ENGINEER SHALL BE RESPONSIBLE FOR THE FOLLOWING SHEETS IN ACCORDANCE WITH RULE 61G15-23.004, F.A.C.

<u>SHEET NO.</u>	<u>SHEET DESCRIPTION</u>
2A	SIGNATURE SHEET
27	BOX CULVERT DETAILS

SS-2: Revision
 Signature Sheet
 Date: 1/1/17

REVISIONS				LUKE S. WALKER, P.E. P.E. LICENSE NUMBER 99991 ROADWAY ENGINEERS, INC. 123 MAIN STREET TALLAHASSEE, FL 32301 CERTIFICATE OF AUTHORIZATION 12345	STATE OF FLORIDA DEPARTMENT OF TRANSPORTATION			SHEET NO.
DATE	DESCRIPTION	DATE	DESCRIPTION		ROAD NO.	COUNTY	FINANCIAL PROJECT ID	
10-14-16	1 ADDED SHEET				SR 22	BAY	123456-1-52-01	SIGNATURE SHEET
								2A