

COMPONENTS OF CONTRACT PLANS SET

- ROADWAY PLANS
- SIGNING AND PAVEMENT MARKING PLANS
- SIGNALIZATION PLANS
- INTELLIGENT TRANSPORTATION SYSTEMS PLANS
- LIGHTING PLANS
- LANDSCAPE PLANS
- ARCHITECTURAL PLANS
- STRUCTURE PLANS

EXAMPLE ONLY: CONTRACT PLANS SET
MAY NOT CONTAIN ALL OF THE
LISTED COMPONENTS/SHEETS.

A DETAILED INDEX APPEARS ON THE
KEY SHEET OF EACH COMPONENT

INDEX OF ROADWAY PLANS

SHEET NO.	SHEET DESCRIPTION
1	KEY SHEET
2-2A	SUMMARY OF PAY ITEMS
3	DRAINAGE MAP
4-5	TYPICAL SECTIONS
6	TYPICAL SECTION DETAILS
7	SUMMARY OF QUANTITIES
8	SUMMARY OF DRAINAGE STRUCTURES
9	OPTIONAL MATERIALS TABULATION
10	PROJECT LAYOUT
11-15	ROADWAY PLAN-PROFILES
16-17	SPECIAL PROFILES
18	INTERSECTION LAYOUT/DETAIL
19-25	DRAINAGE STRUCTURES
26-32	BOX CULVERT DETAILS
33	LATERAL DITCH PLAN-PROFILES
34	LATERAL DITCH CROSS SECTIONS
35	SPECIAL DETAILS
36	ROADWAY SOIL SURVEY
37-47	CROSS SECTIONS
48	STORMWATER POLLUTION PREVENTION PLANS
49-52	TEMPORARY TRAFFIC CONTROL PLANS
53-57	UTILITY ADJUSTMENTS
58-62	SELECTIVE CLEARING AND GRUBBING

GOVERNING STANDARDS AND SPECIFICATIONS:
FLORIDA DEPARTMENT OF TRANSPORTATION,
DESIGN STANDARDS FISCAL YEAR 2012/2013,
AND STANDARD SPECIFICATIONS FOR ROAD AND
BRIDGE CONSTRUCTION DATED 2010,
AS AMENDED BY CONTRACT DOCUMENTS.

APPLICABLE DESIGN STANDARDS REVISIONS: MM/DD/YY
For Design Standards Revisions click on
"Design Standards" at the following web site:
<http://www.dot.state.fl.us/rddesign/>

REVISIONS

FINANCIAL PROJECT ID 000001-1-52-01

- ▲ Roadway Sheets 1, 6, 7 & 13 (Revised 01-10-12)
- ▲ Signing & Pavement Marking Sheets 5-2 & 5-3 (Revised 3-10-12)
- ▲ Signalization Sheets T-1 & T-2 (Revised 3-10-12)
- ▲ Roadway Sheets 14 & 33 (Revised 3-31-12)
- ▲ Summary of Pay Items (Revised 3-31-12)

FINANCIAL PROJECT ID 000002-1-52-02

- ▲ Roadway Sheets 1, 8 & 10 (Revised 1-30-12)
- ▲ Structure Sheets B-1 & C-1 thru C-10 (Revised 1-30-12)

STATE OF FLORIDA
DEPARTMENT OF TRANSPORTATION

CONTRACT PLANS

FINANCIAL PROJECT ID 000001-1-52-01
(FEDERAL FUNDS)
BAY COUNTY (46001)
STATE ROAD NO. 22

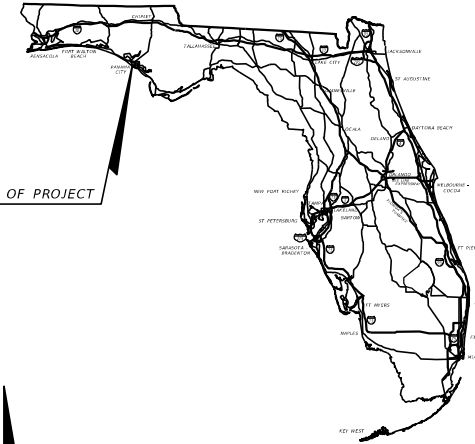

LOCATION OF PROJECT

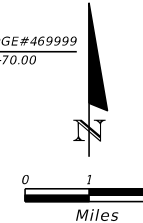
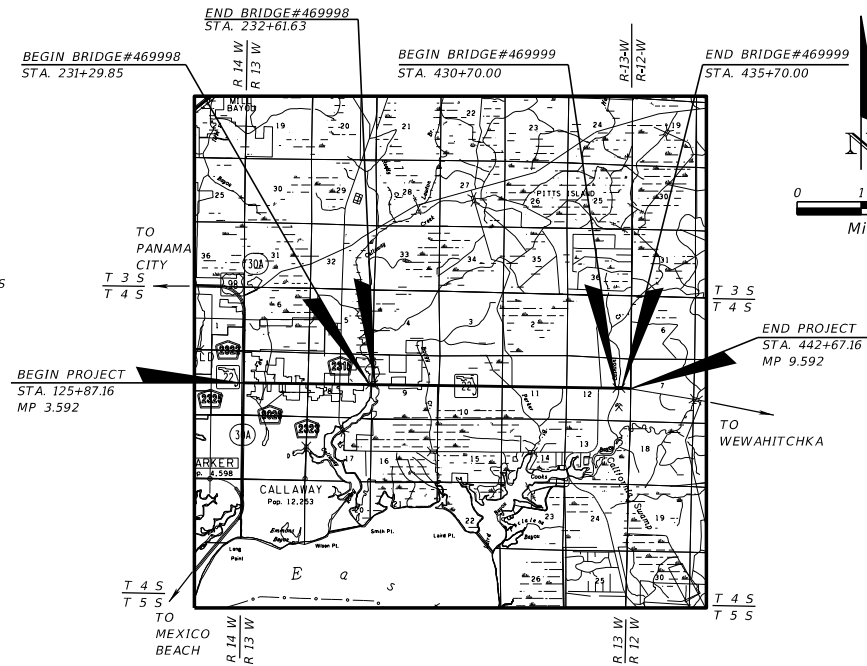

ROADWAY SHOP DRAWINGS
TO BE SUBMITTED TO:

NAME(S) AND ADDRESS(ES) OF
ENGINEER(S) RESPONSIBLE FOR REVIEW
OF SHOP DRAWINGS, WHEN REQUIRED.

PLANS PREPARED BY:

NAME, ADDRESS, CONSULTANT CONTRACT NUMBER,
VENDOR NUMBER, AND CERTIFICATE OF
AUTHORIZATION NUMBER OF THE CONSULTANT FIRM
WHEN THE PLANS ARE PREPARED BY A CONSULTANT.

NOTE: THIS PROJECT TO BE LET TO CONTRACT
WITH FINANCIAL PROJECT ID 000002-1-52-02

NOTE: THE SCALE OF THESE PLANS MAY
HAVE CHANGED DUE TO REPRODUCTION.

EXHIBIT KS-1
Date: 1/1/12

LENGTH OF PROJECT		
	LINEAR FEET	MILES
ROADWAY	31,048.22	5.880
BRIDGES	631.78	0.120
NET LENGTH OF PROJECT	31,680.00	6.000
EXCEPTIONS		
GROSS LENGTH OF PROJECT	31680.00	6.000

KEY SHEET REVISIONS	
DATE	DESCRIPTION
1-10-09	Revised sequence of contract plans.

ROADWAY PLANS
ENGINEER OF RECORD: _____

P.E. NO.: _____

FISCAL YEAR	SHEET NO.
13	1

FDOT PROJECT MANAGER:

