

- Recommended placement of bicycle lane markings:
 - At the beginning of a bicycle lane, on the far side of major intersections, and prior to and within the bicycle lane keyhole.
 - Along the roadway as needed to provide a maximum spacing of 1,320 feet for posted speeds less than 45 mph, 2,640 feet for a posted speed of 45 mph or greater.
- Recommended spacing for shared lane marking symbols: Immediately after intersections and at a maximum spacing of 250 feet.
- All pavement markings and pavement messages shall be White.
- All pavement messages shall be performed thermoplastic.
- Bike lane signs (R3-17, R3-17a, R3-17b) are not required.

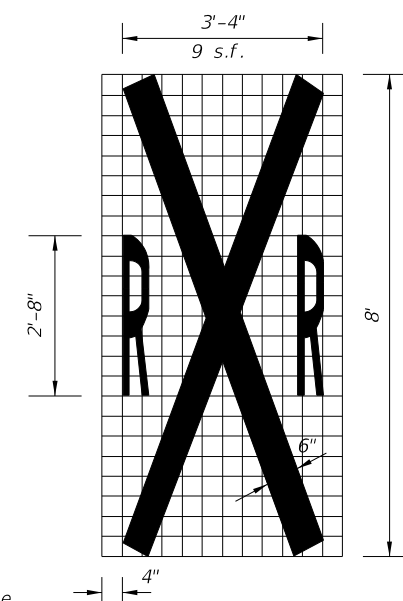

No stripe at edge of curb & gutter or paved shoulders.

6" WHITE

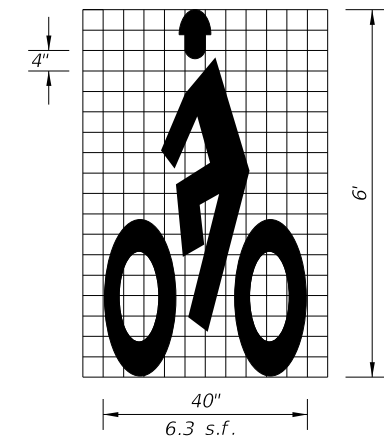
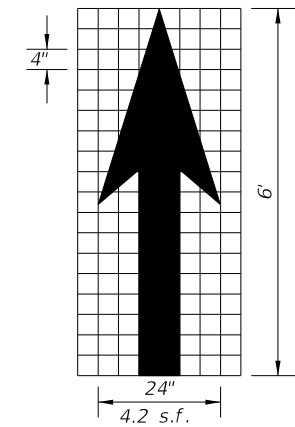
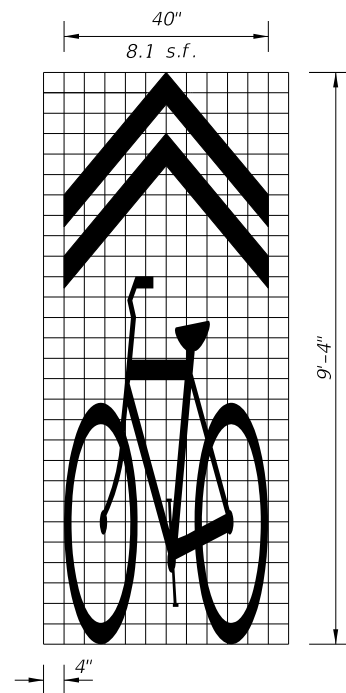
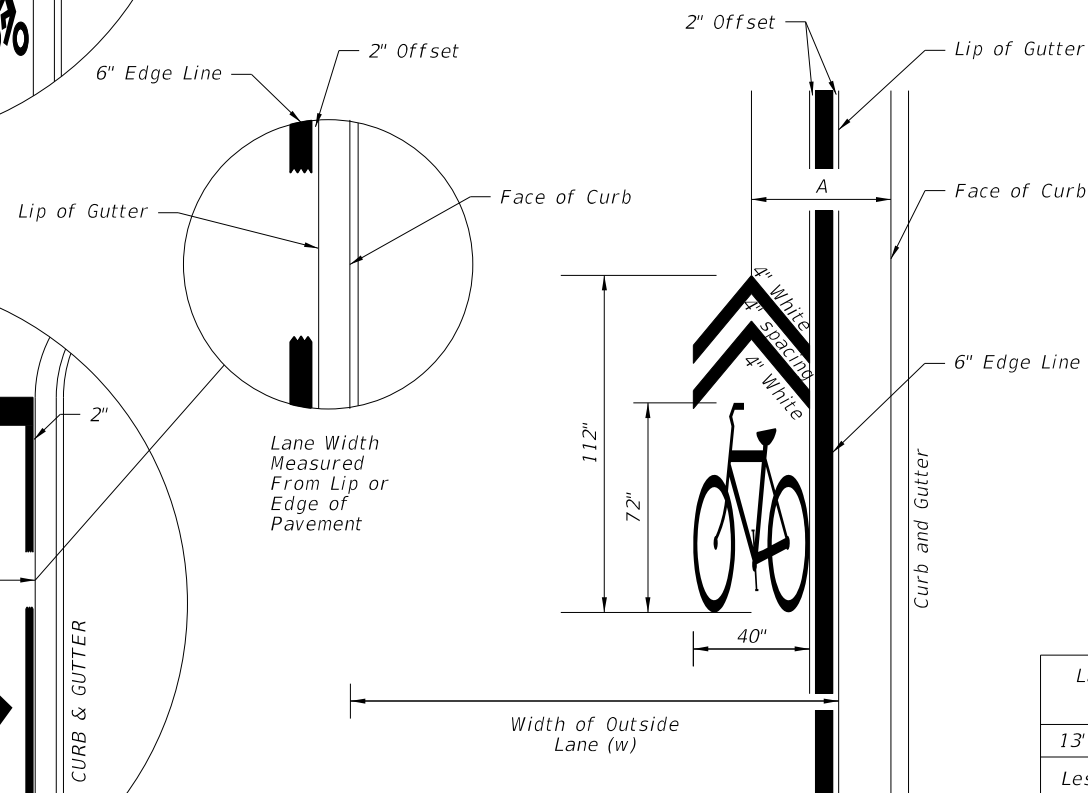
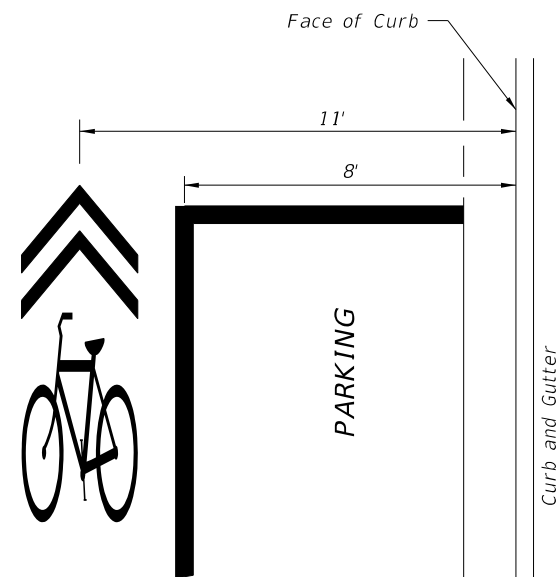
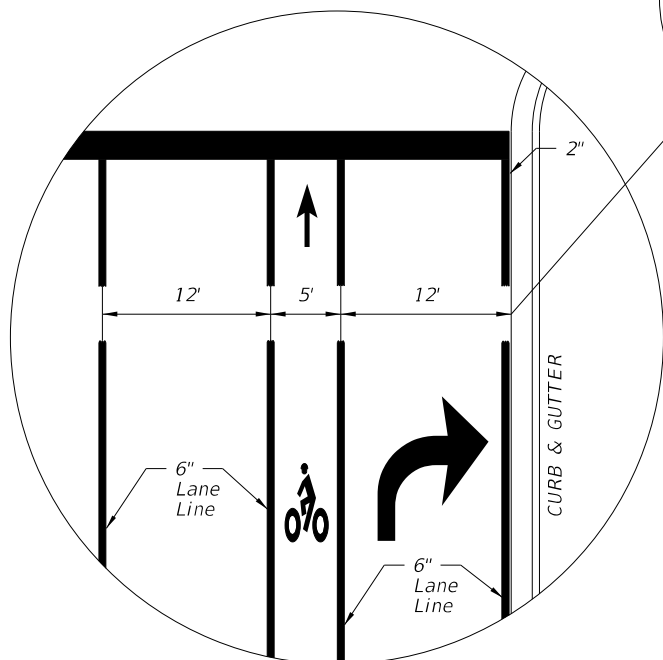
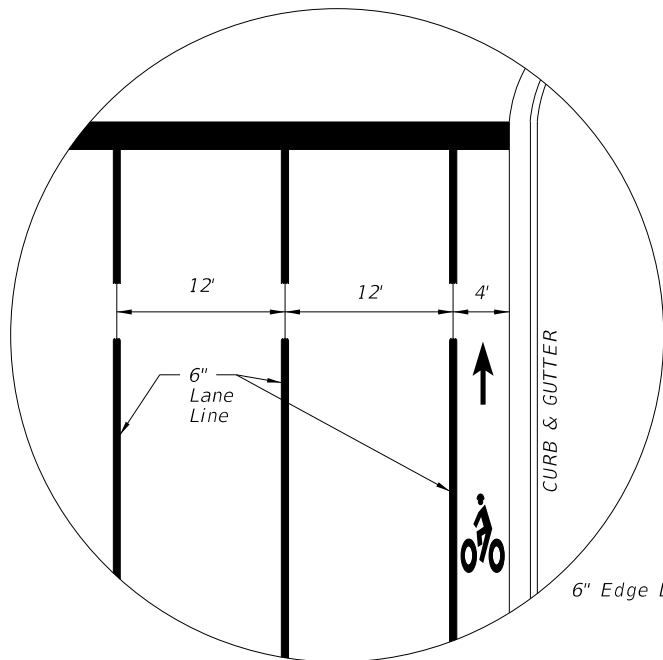
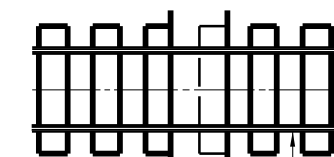
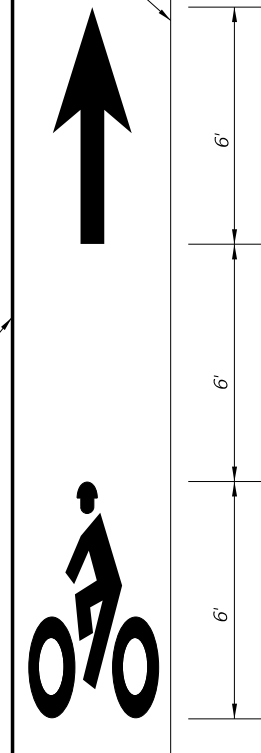

Shared Use Path
Stop Bar Perpendicular To Edge Of Path or Bike Lane

White

* Pavement Message White

W10-1
18" Diameter

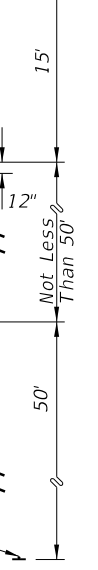

** For lane widths less than 11' in width, the symbol shall be centered in the lane.

* When used in bike lane, markings shall be placed adjacent to markings in travel lane and W10-1 sign shall be deleted.

6/28/2012 12:13:12 PM rd9607h C:\projects\standards\roadway\17300-s\17347-01.dgn

6/28/2012 12:13:14 PM r0960/h C:\projects\standards\roadway\17300-s\17347-02.dgn

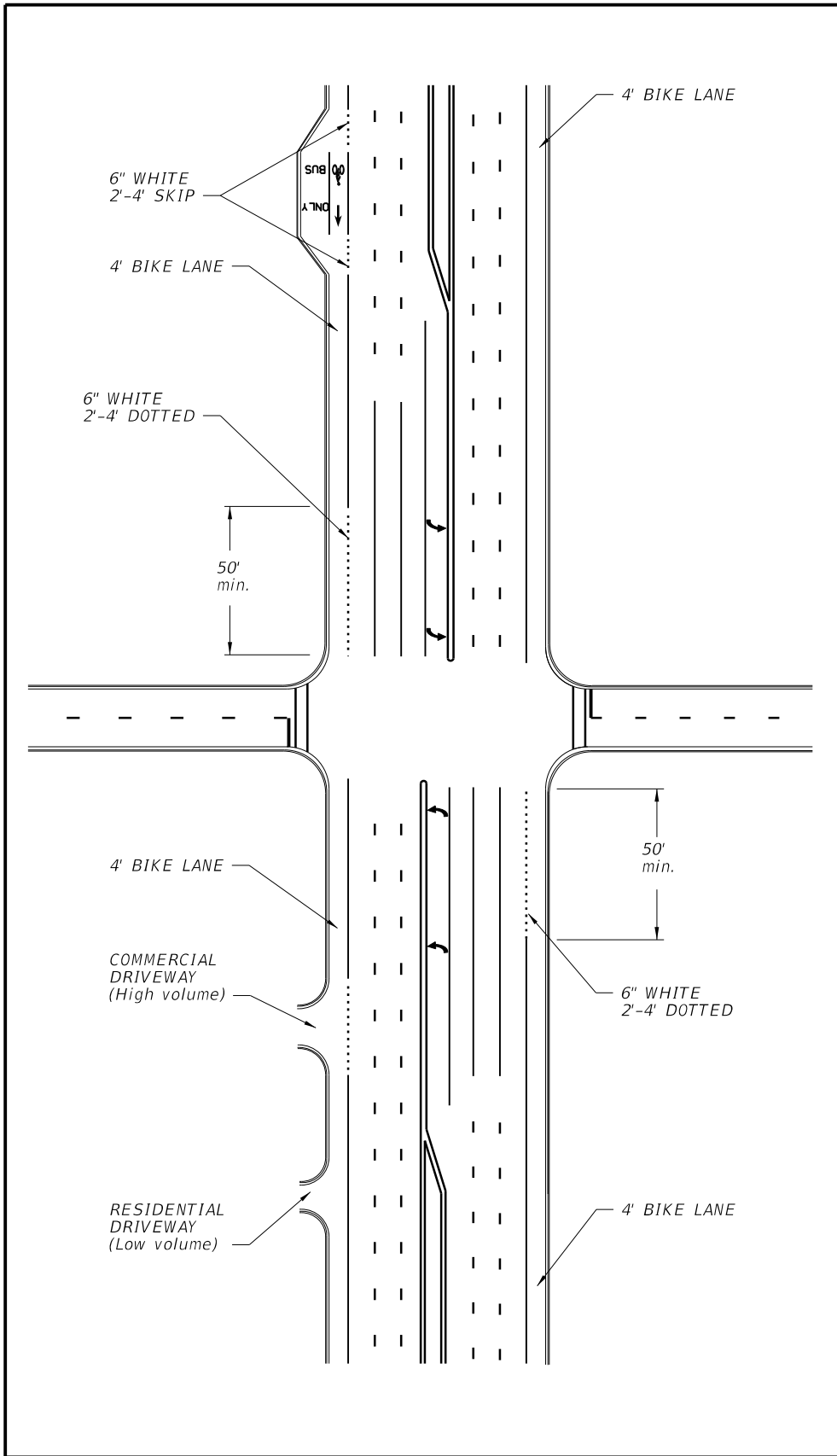

INTERSECTION WITH BUS BAY,
NO RIGHT TURN LANE, CURB
AND GUTTER TYPICAL SECTION

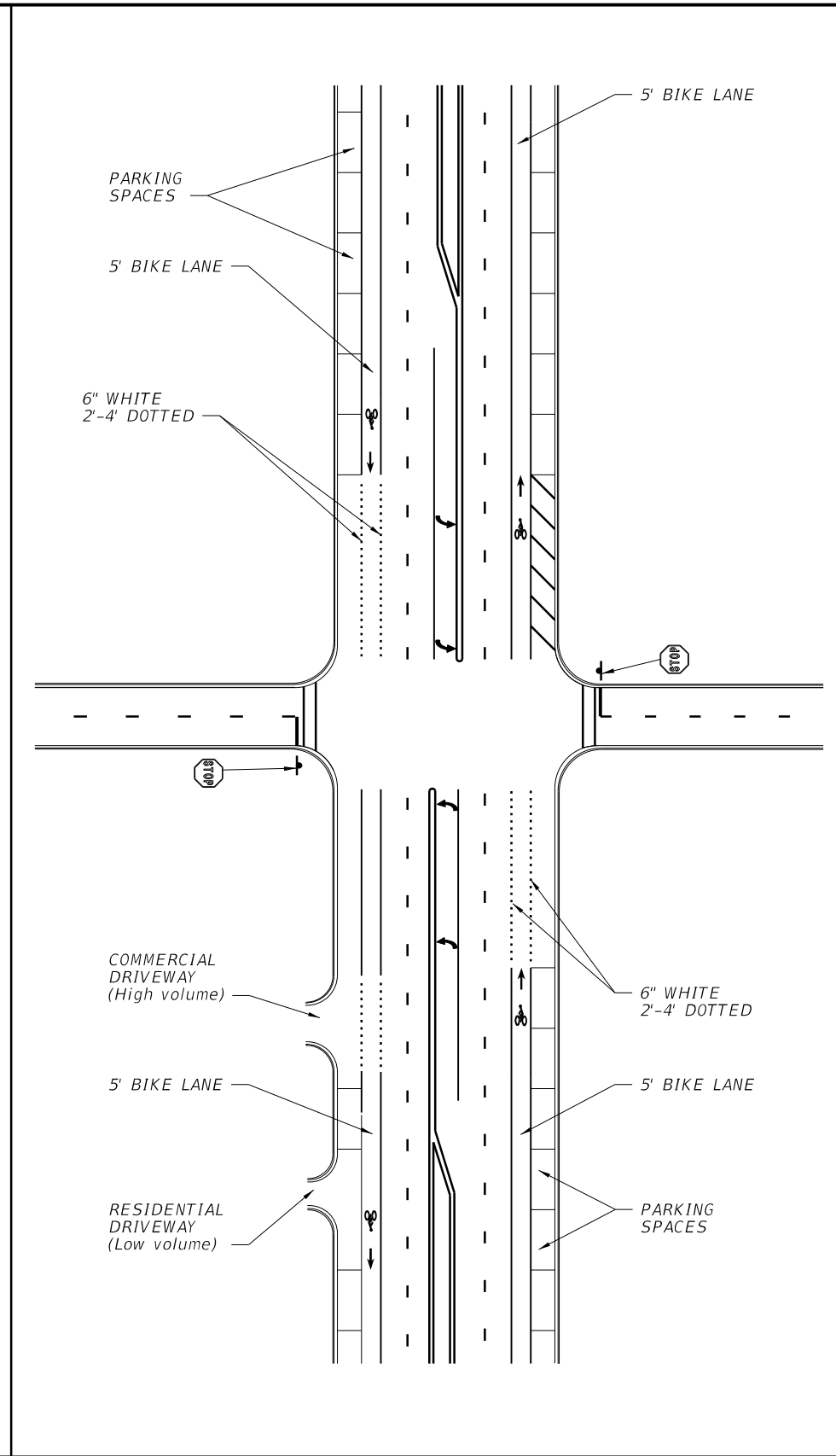

INTERSECTION WITH ON STREET
PARKING, NO RIGHT TURN LANE,
CURB AND GUTTER TYPICAL SECTION

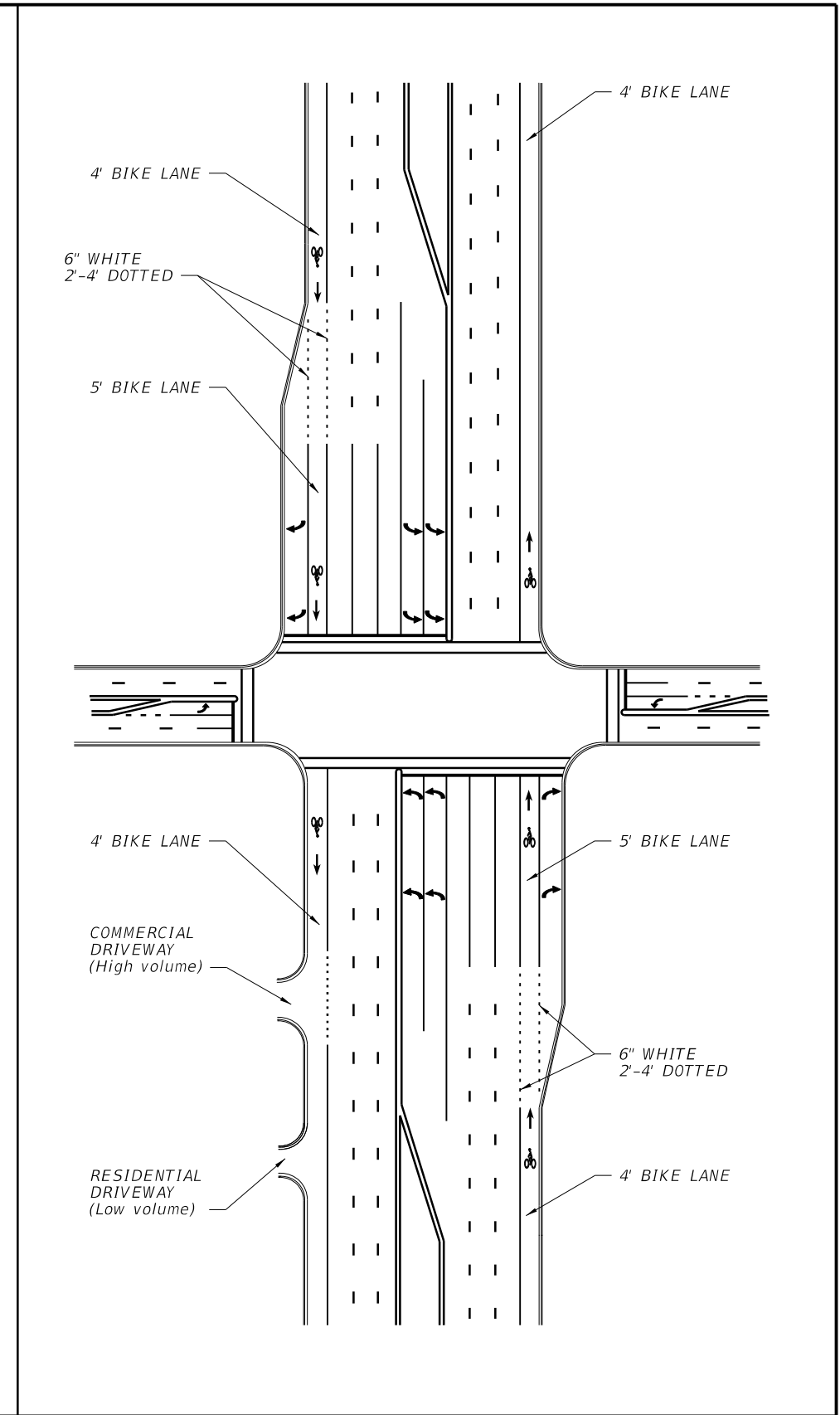

INTERSECTION WITH SEPARATE
RIGHT TURN LANE, CURB AND
GUTTER TYPICAL SECTION

LAST REVISION	DESCRIPTION:
07/01/12	



FDOT DESIGN STANDARDS
2013

BICYCLE MARKINGS

INDEX NO.	SHEET NO.
17347	2

6/28/2012 12:13:16 PM r09607h C:\projects\standards\roadway\17300-s\17347-03.dgn

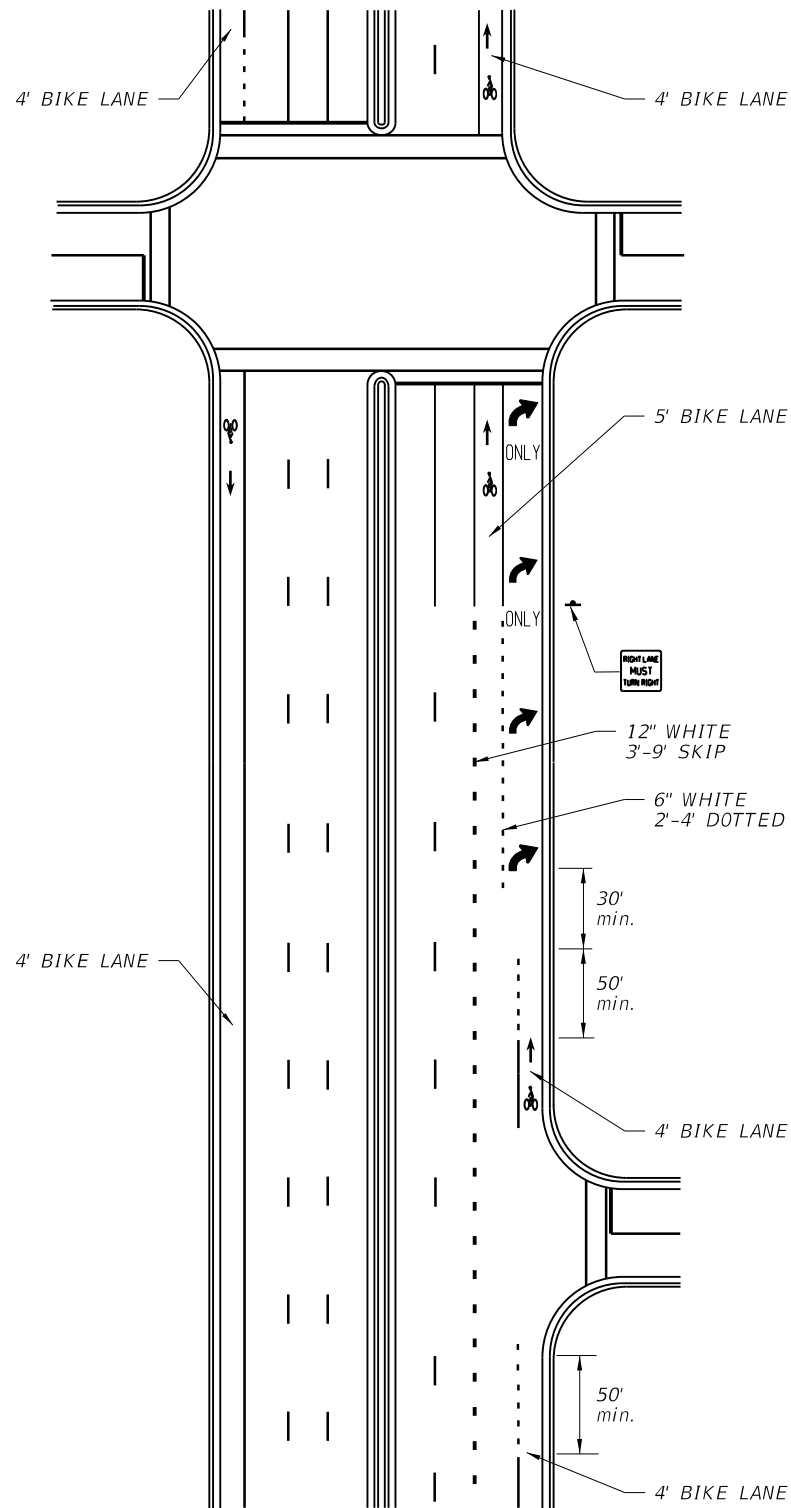

INTERSECTION WITH RIGHT TURN DROP LANE,
CURB AND GUTTER TYPICAL SECTION

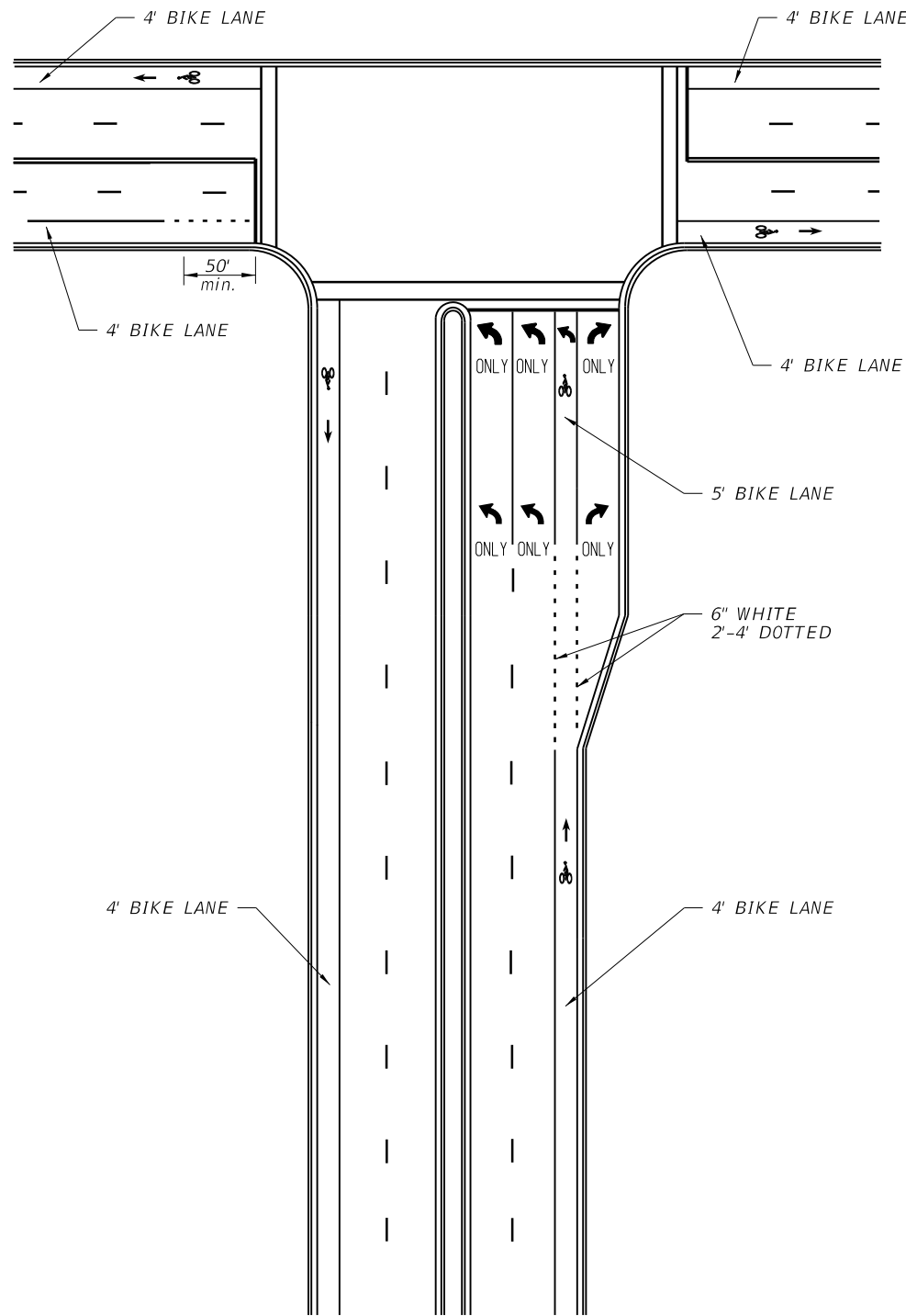

"TEE" INTERSECTION WITH SEPARATE RIGHT TURN
LANE, CURB & GUTTER TYPICAL SECTION

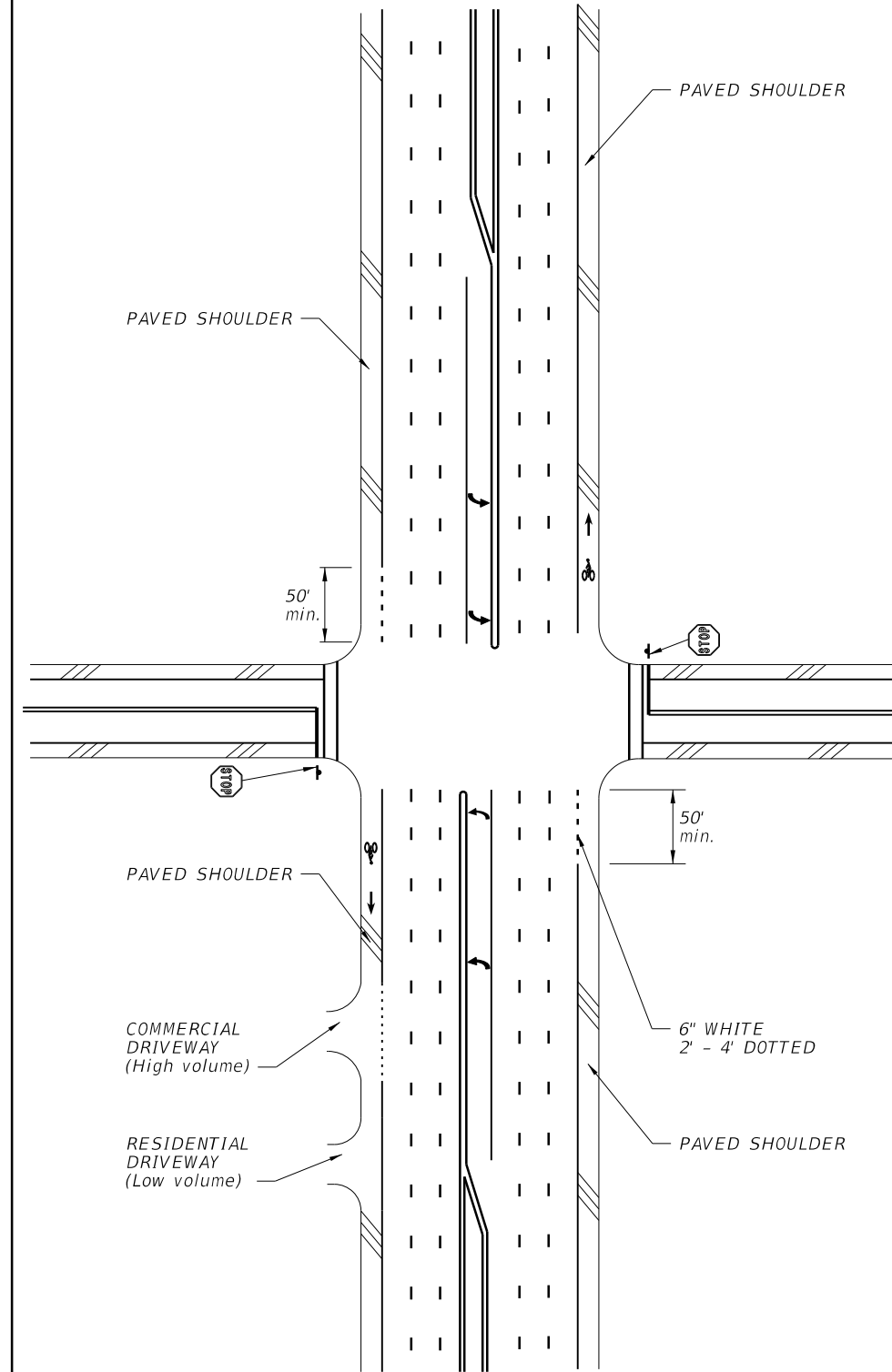

INTERSECTION, NO RIGHT TURN LANE,
FLUSH SHOULDER TYPICAL SECTION

LAST REVISION	DESCRIPTION:
07/01/12	

6/28/2012 12:13:19 PM rd9607h C:\projects\standards\roadway\17300-s\17347-04.dgn

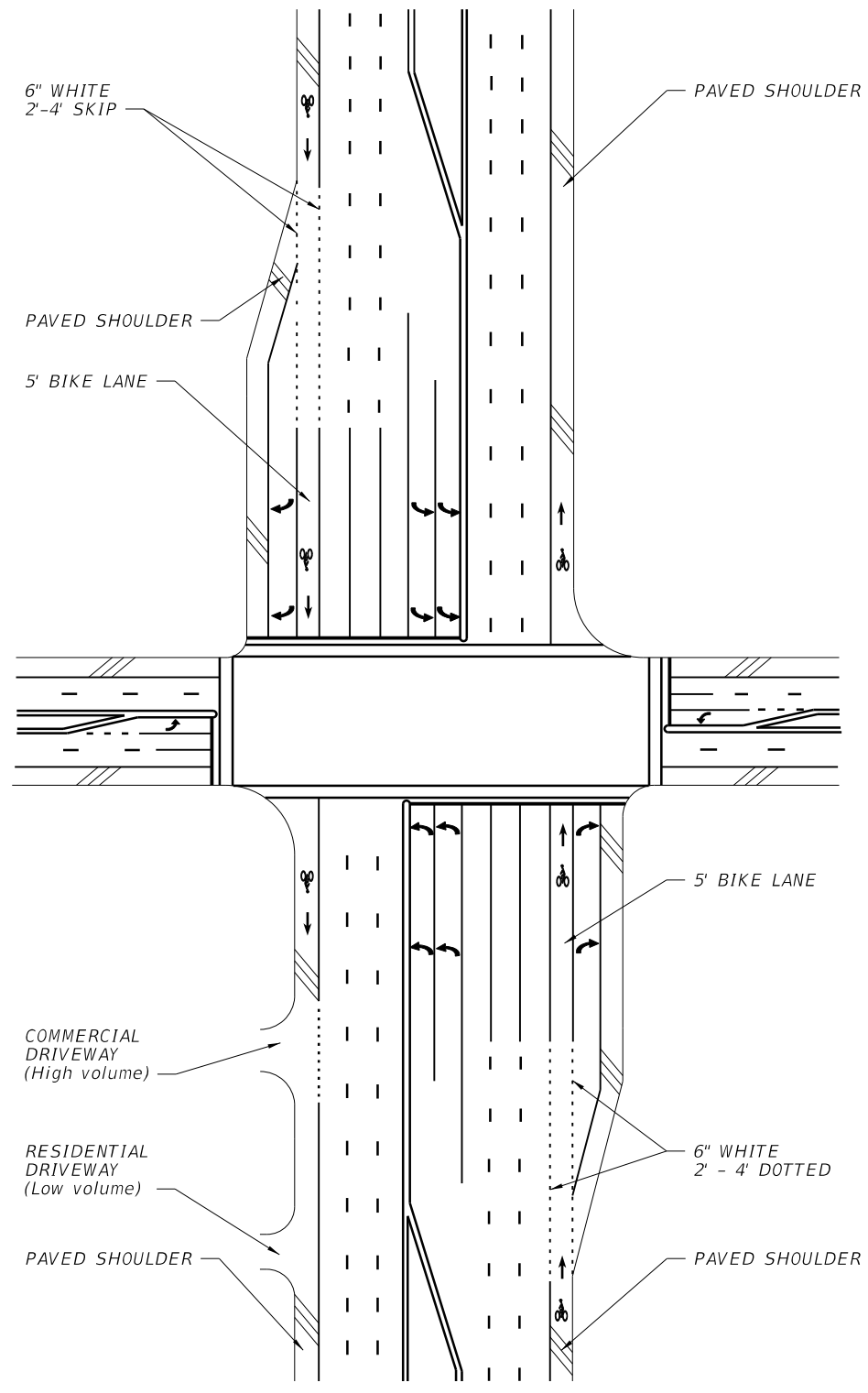

INTERSECTION WITH SEPARATE RIGHT TURN LANE, FLUSH SHOULDER TYPICAL SECTION

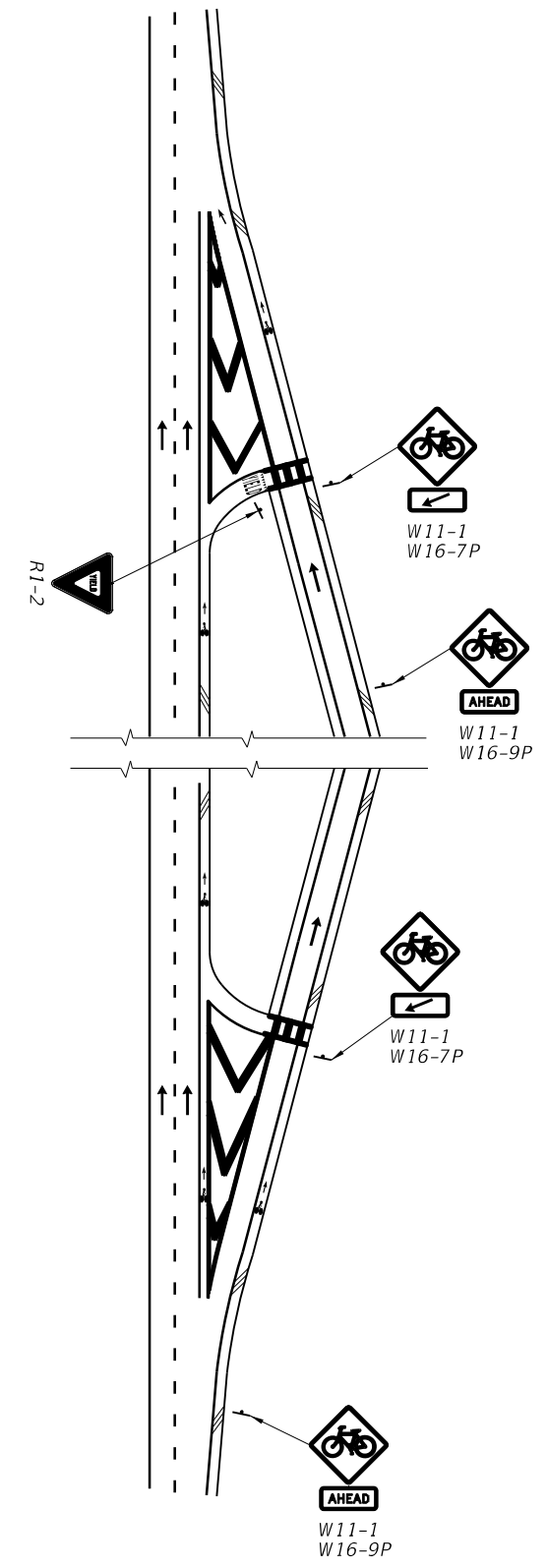

INTERCHANGE RAMPS WITH MARKED CROSSING, FLUSH SHOULDER TYPICAL SECTION

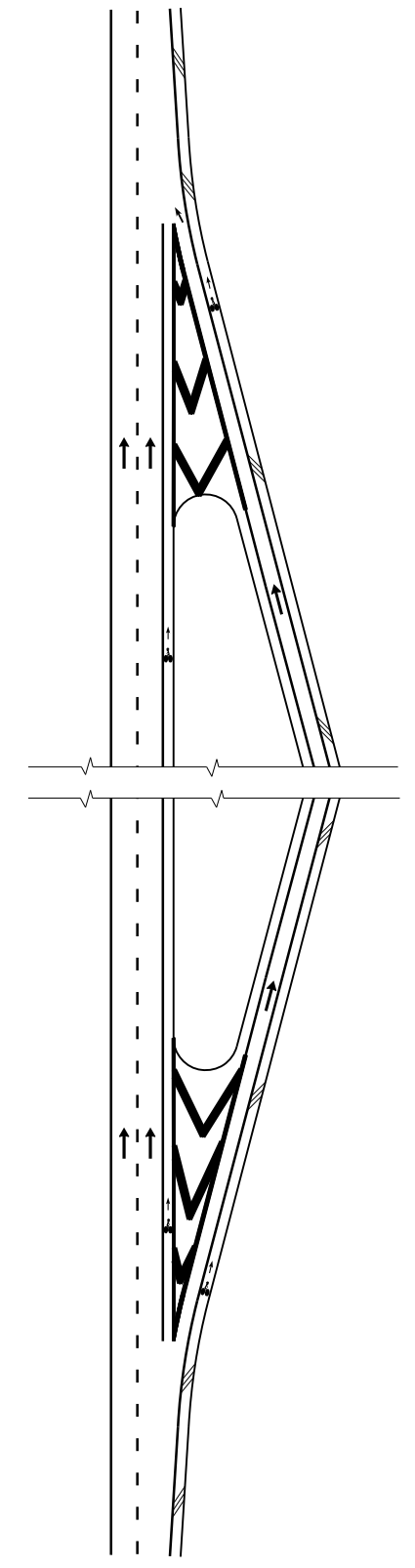

INTERCHANGE RAMPS, FLUSH SHOULDER TYPICAL SECTION

LAST REVISION	DESCRIPTION:
01/01/12	



FDOT DESIGN STANDARDS
2013

BICYCLE MARKINGS

INDEX NO.	SHEET NO.
17347	4