

BUILD-UP DIAGRAM FOR TANGENT SPANS
(ALONG CL BEAM) (CASE 1)

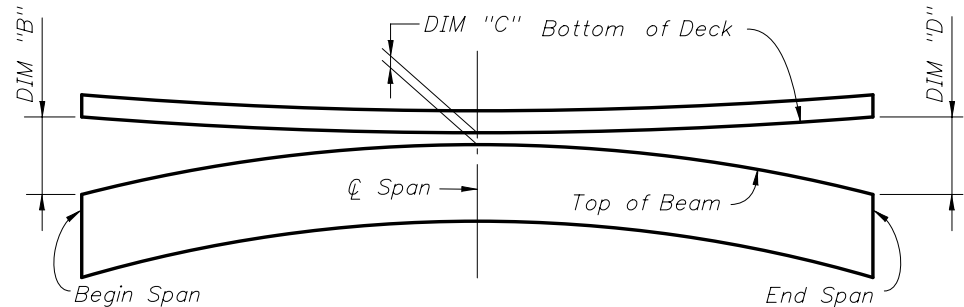

BUILD-UP DIAGRAM FOR SAG VERTICAL CURVE SPANS
(ALONG CL BEAM) (CASE 2)

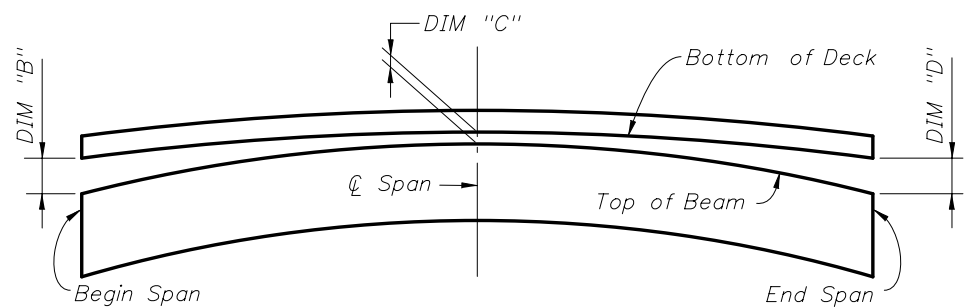

BUILD-UP DIAGRAM FOR CREST VERTICAL CURVE SPANS
- CONTROL AT CL SPAN
(ALONG CL BEAM) (CASE 3)

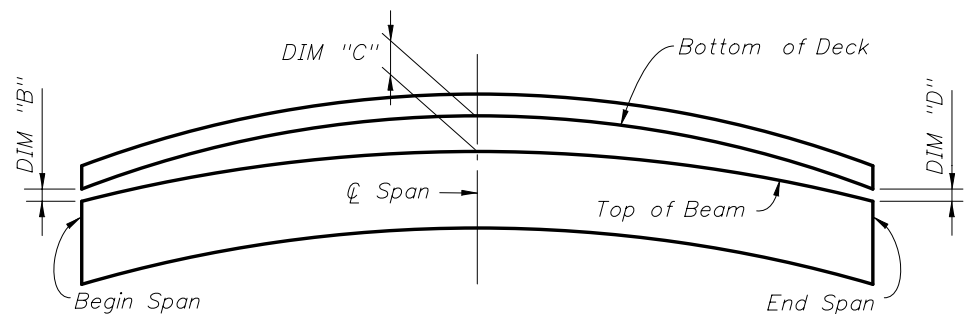

BUILD-UP DIAGRAM FOR CREST VERTICAL CURVE SPANS
- CONTROL AT BEGIN OR END SPAN
(ALONG CL BEAM) (CASE 4)

BEAM CAMBER AND BUILD-UP NOTES:

The build-up values given in the table are based on theoretical beam cambers. The Contractor shall monitor beam cambers for the purpose of predicting camber values at the time of the deck pour. If the predicted cambers based on field measurements differ more than $\pm 1/2$ " from the theoretical "Net Beam Camber @ 120 Days" shown in the Data Table, obtain approval from the Engineer to modify the build-up dimensions as required. When the measured beam cambers create a conflict with the bottom mat of deck steel, notify the Engineer a minimum of 21 days prior to casting.

DIM "A" includes the weight of the Stay-In-Place Formwork.

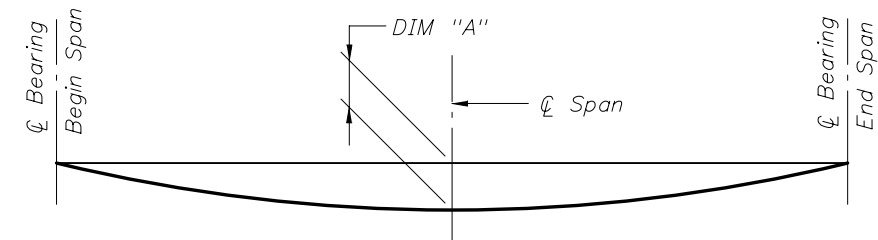

DEAD LOAD DEFLECTION DIAGRAM

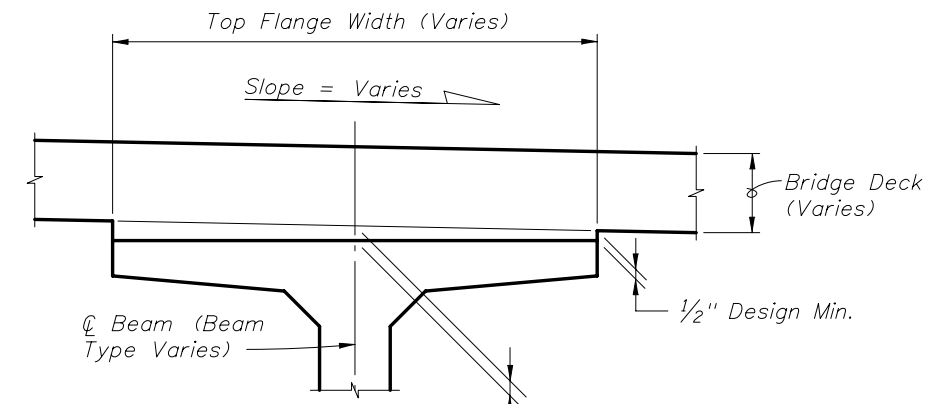

BUILD-UP OVER BEAMS

INSTRUCTIONS TO DESIGNER:

Although not shown here in the Diagrams or Notes, the effect of Horizontal Curvature, when present, needs to be considered for the Build-up Calculations.

NOTE:

Work this Index with the Build-up and Deflection Data Table for AASHTO, Bulb-T and Florida-I Beams in Structures Plans.

REVISIONS

DATE	BY	DESCRIPTION	DATE	BY	DESCRIPTION
01/01/10	SJN	Added FLORIDA-I BEAMS to the Standard Title Block and Note. Changed the beam section to Florida-I Beam in the BUILD UP OVER BEAMS detail.			

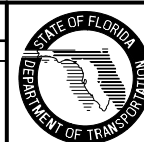

2010 Interim Design Standard

**BUILD-UP & DEFLECTION DATA FOR
AASHTO, BULB-T AND FLORIDA-I BEAMS**

Interim Date	Sheet No.
01/01/10	1 of 1
Index No.	
20199	