

1. Recommended spacing of symbols: Immediately after intersections and major driveways and at a maximum spacing of 600 feet for urban sections and 1320 feet for rural sections.

2. All pavement markings and pavement messages shall be white.

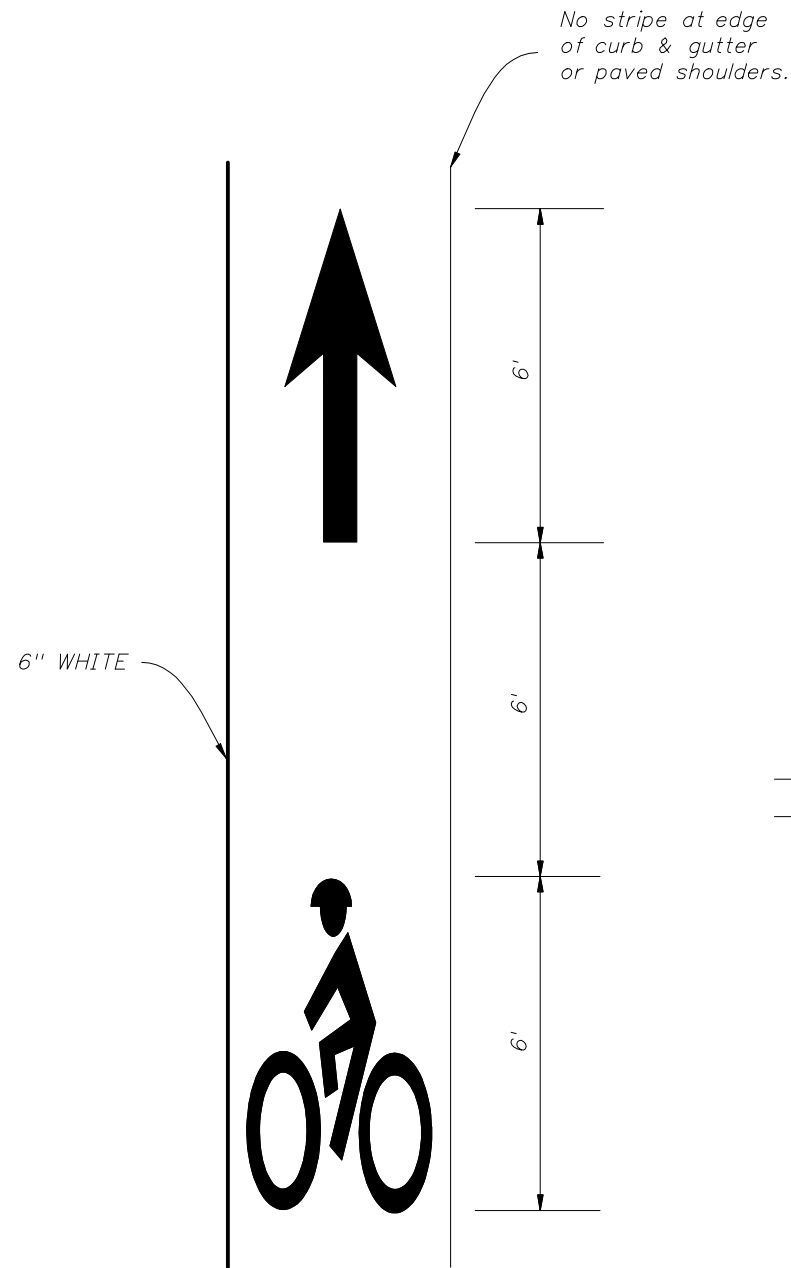

DETAIL OF BIKE LANE MARKINGS

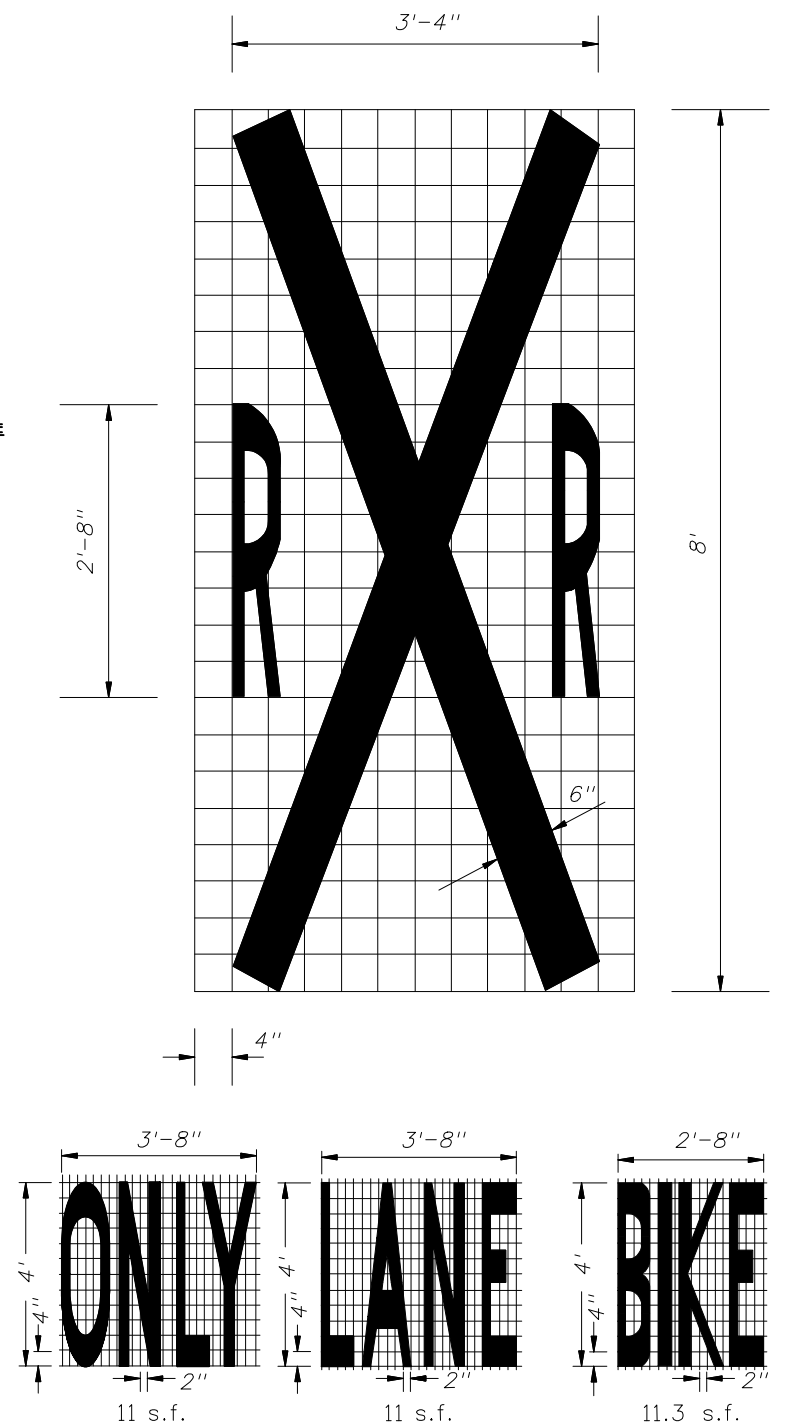
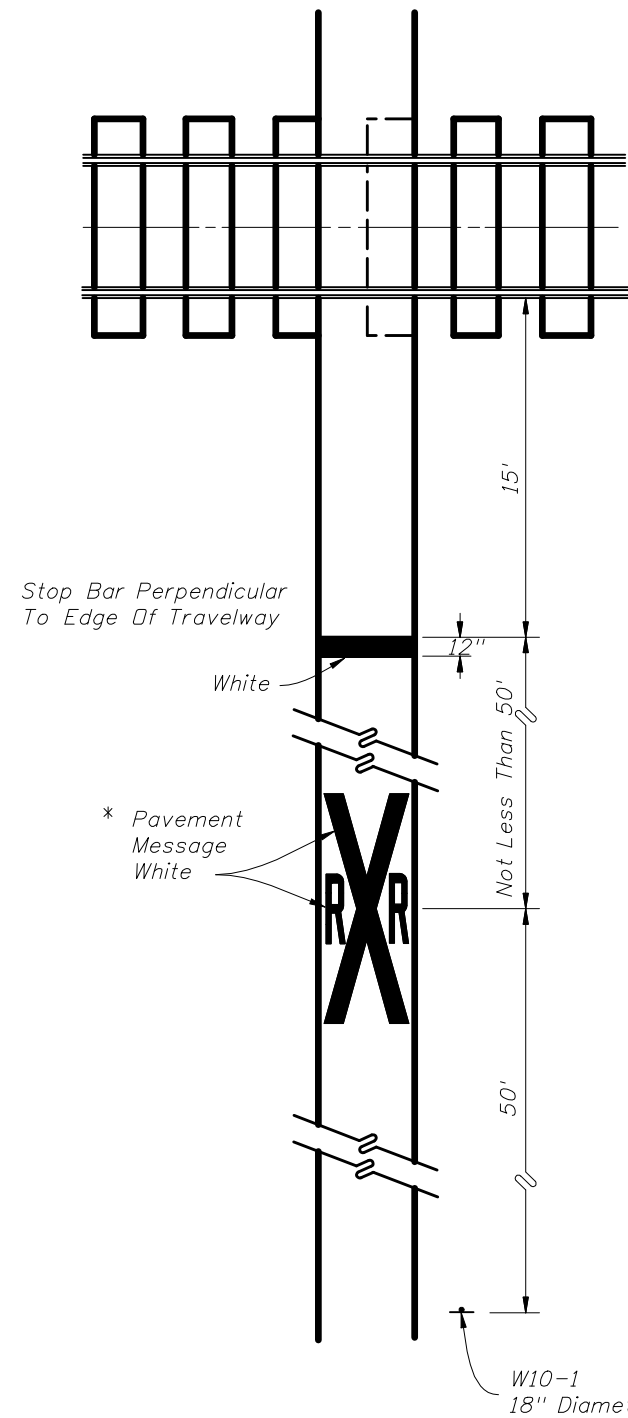
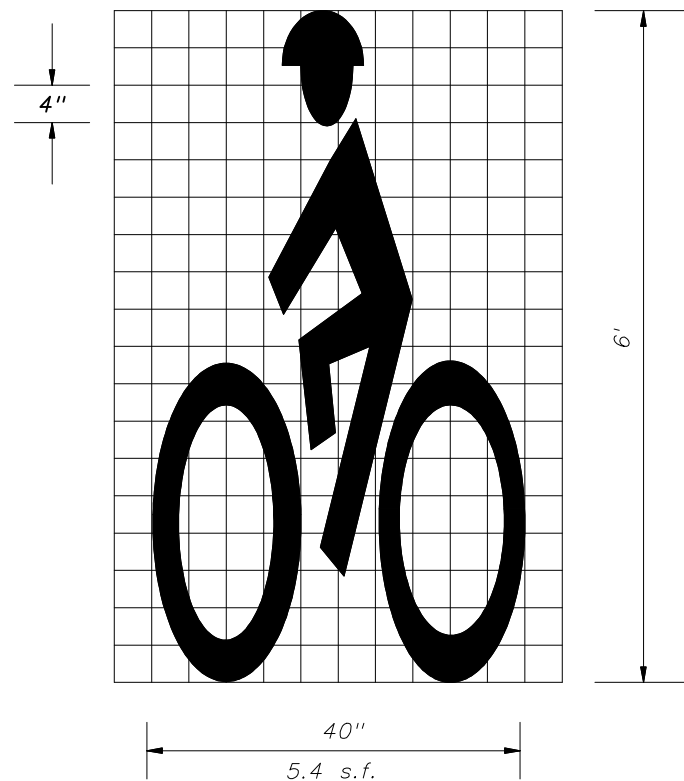
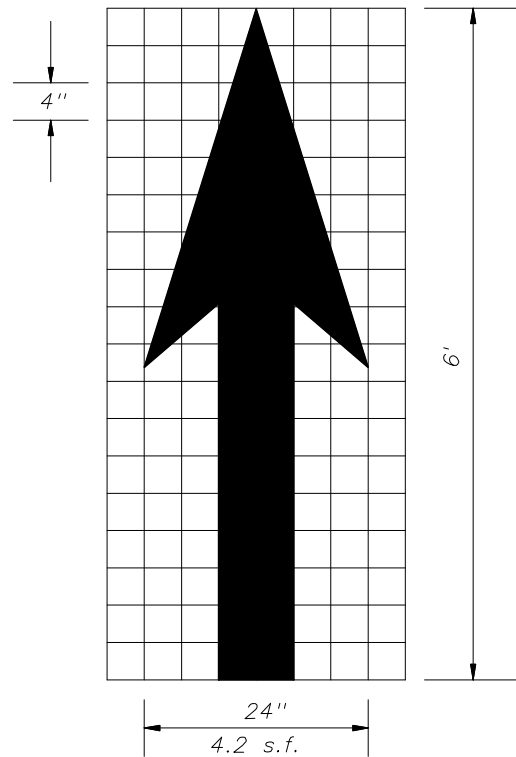

PAVEMENT MESSAGE DETAILS

* NOTE

3. When used on a bike lane (adjacent to vehicle lane) markings shall be placed adjacent to markings for vehicles & W10-1 sign shall be sized and placed for vehicles.

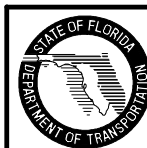

2010 FDOT Design Standards

BICYCLE MARKINGS

| | |
|---------------|-----------|
| Last Revision | Sheet No. |
| 07/01/09 | 1 of 4 |
| Index No. | |
| 17347 | |

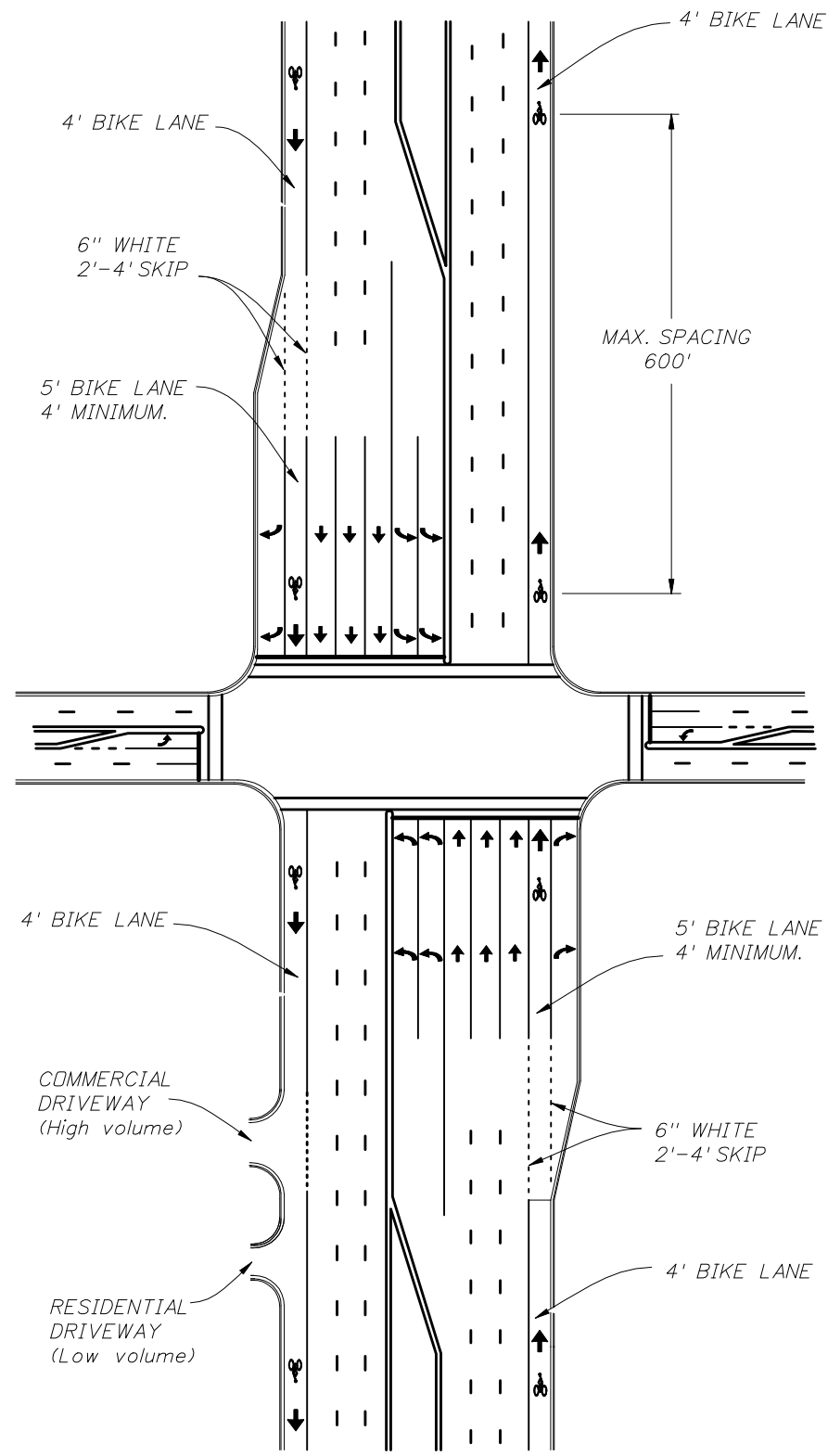

MAJOR INTERSECTION WITH SEPARATE RIGHT TURN LANE URBAN TYPICAL SECTION (CURB AND GUTTER)

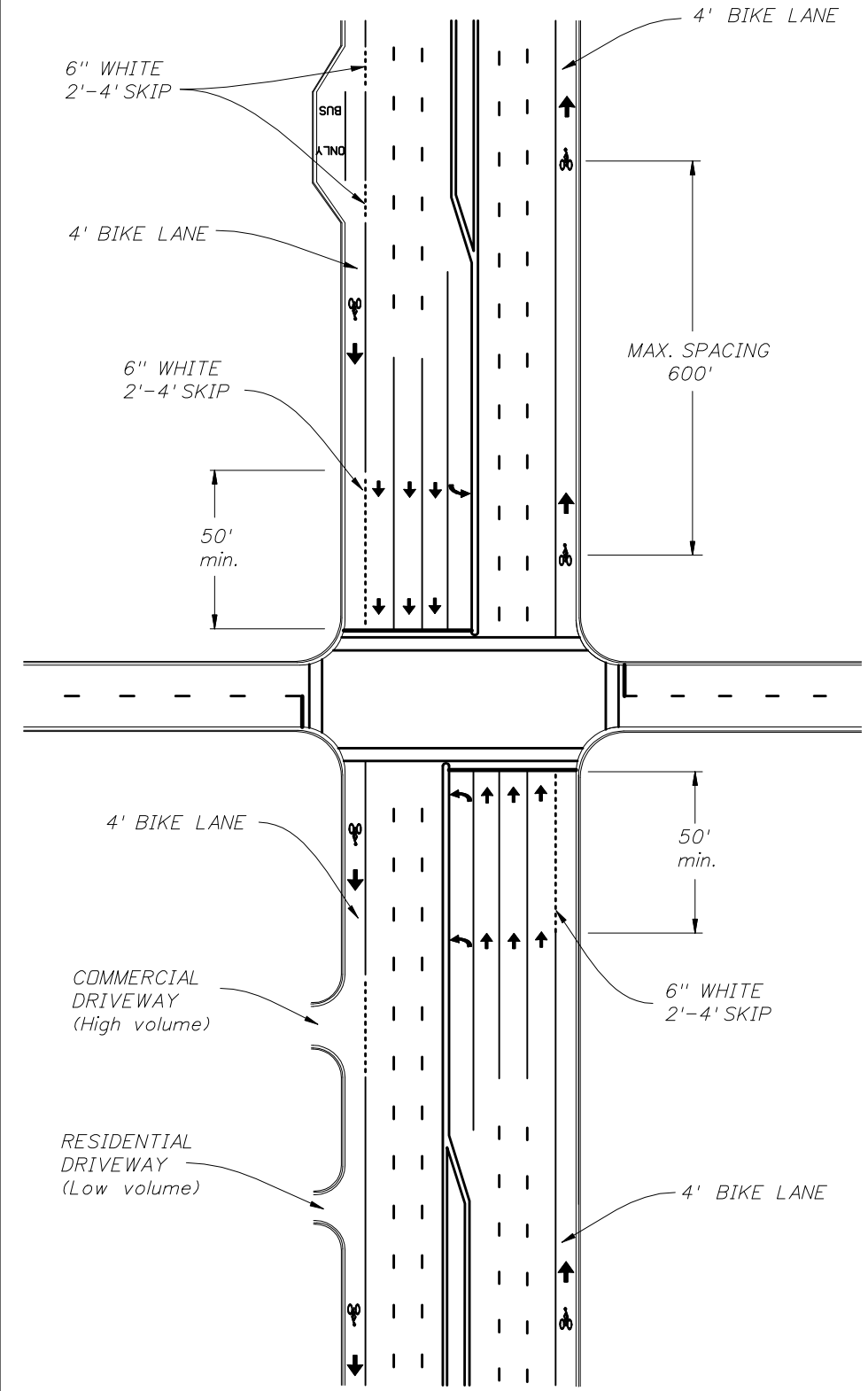

MAJOR INTERSECTION, NO RIGHT TURN LANE PLUS BUSBAY URBAN TYPICAL SECTION (CURB AND GUTTER)

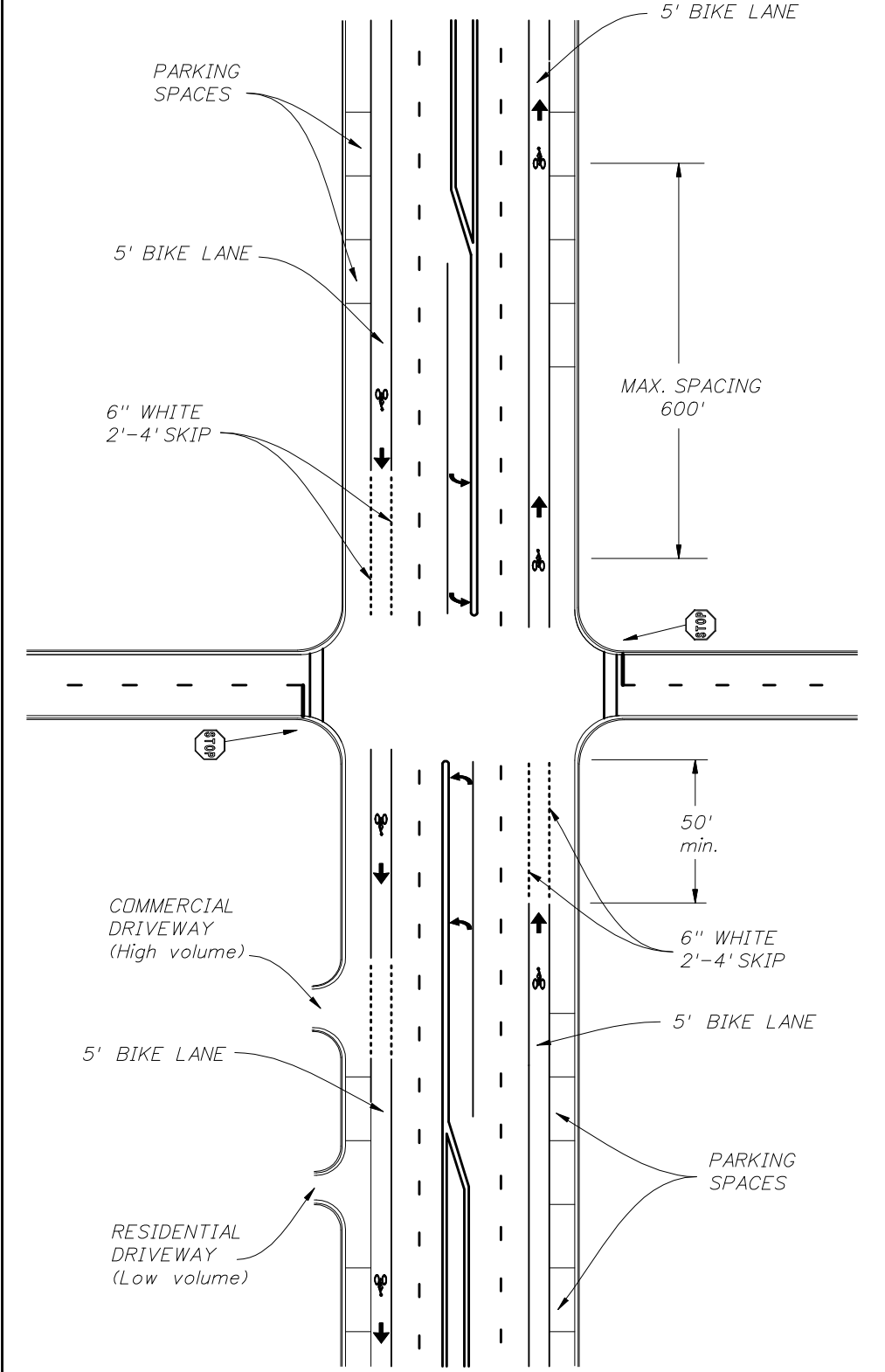

MAJOR WITH LOCAL STREET INTERSECTION, NO RIGHT TURN LANE, ON STREET PARKING URBAN TYPICAL SECTION (CURB AND GUTTER)

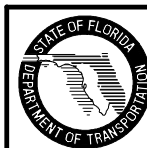

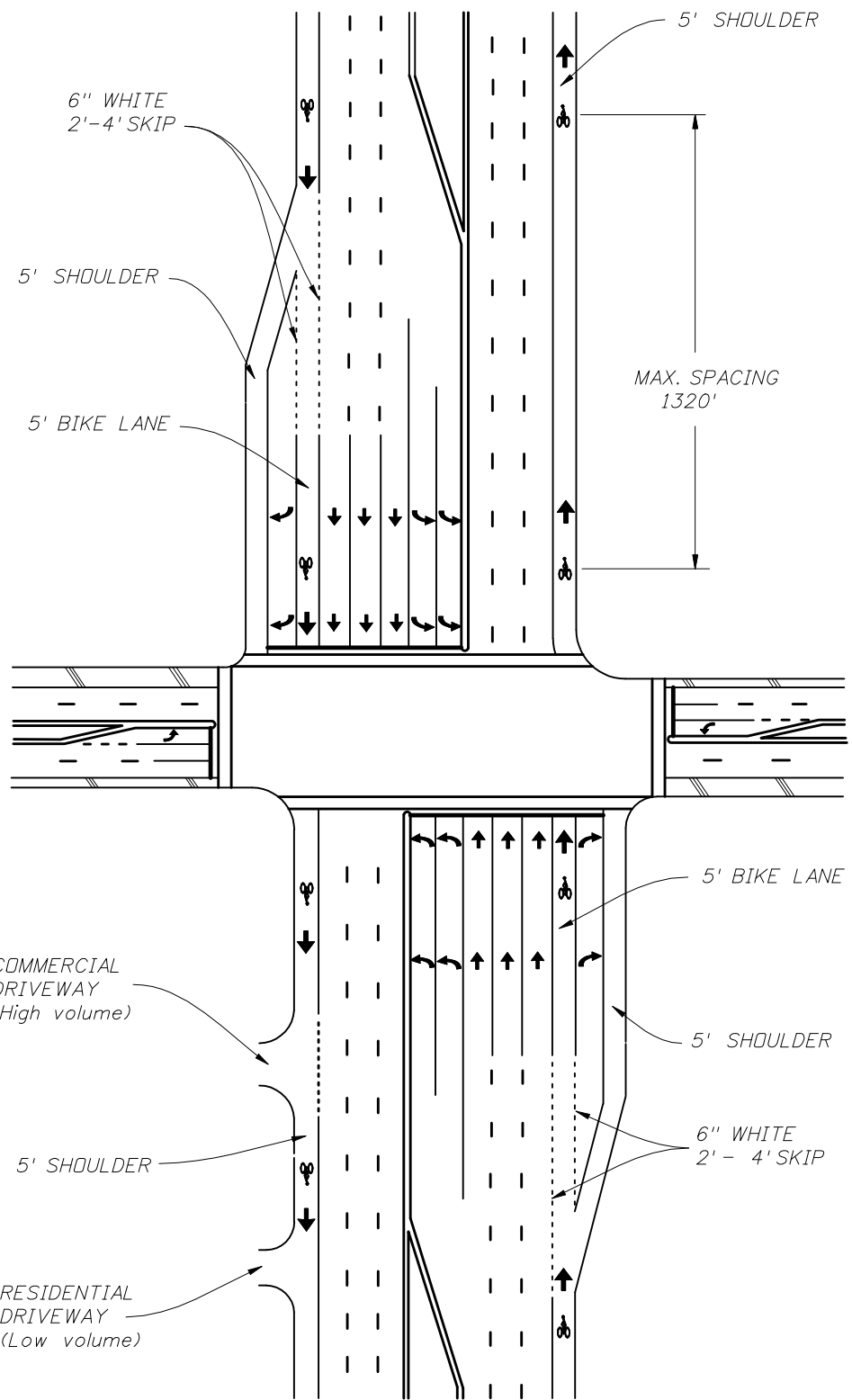

MAJOR INTERSECTION WITH DESIGNATED SHOULDER, AND SEPARATE RIGHT TURN LANE RURAL TYPICAL SECTION (PAVED SHOULDER)

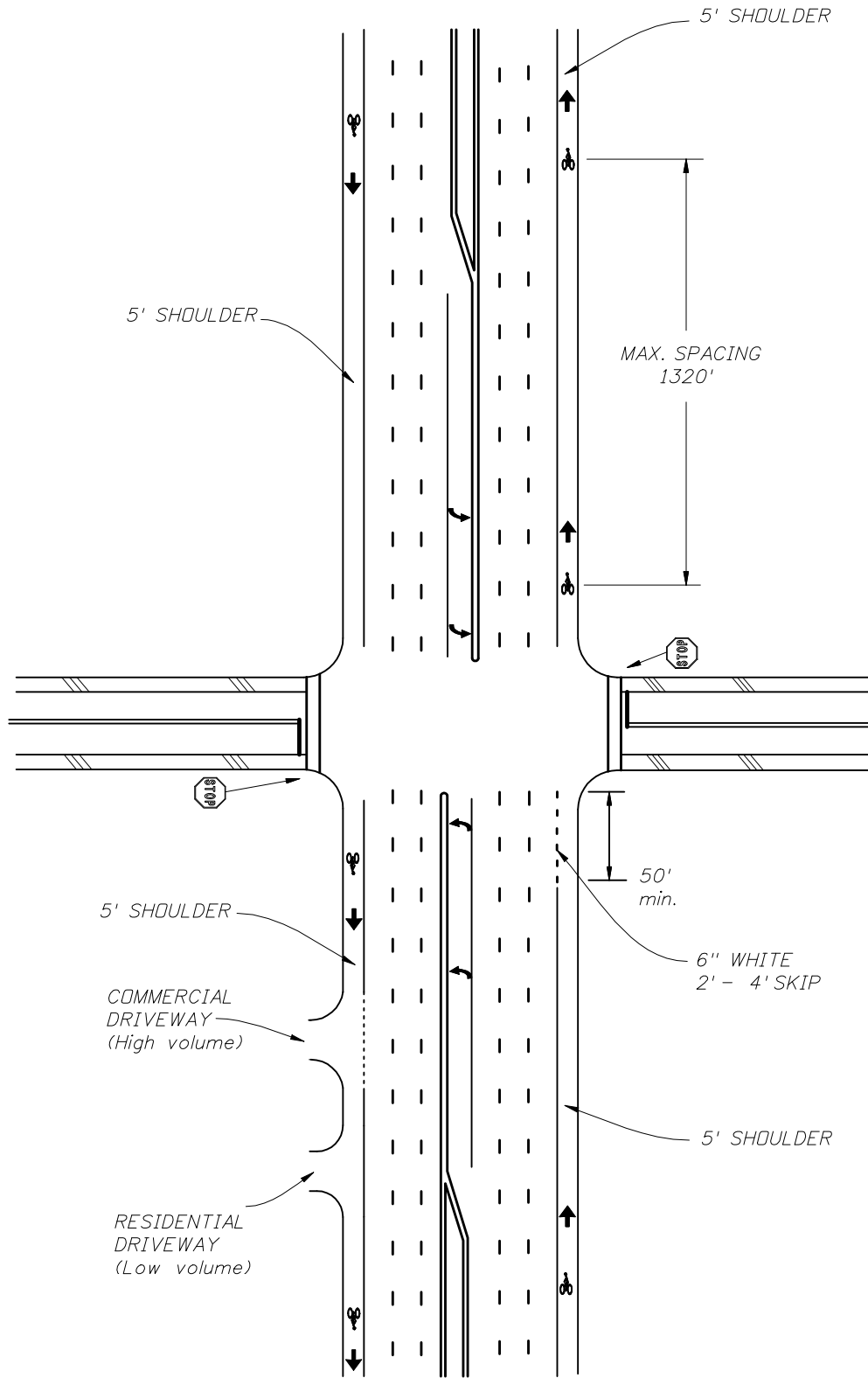

MAJOR WITH LOCAL STREET INTERSECTION, DESIGNATED SHOULDER, AND NO RIGHT TURN LANE RURAL TYPICAL SECTION (PAVED SHOULDER)

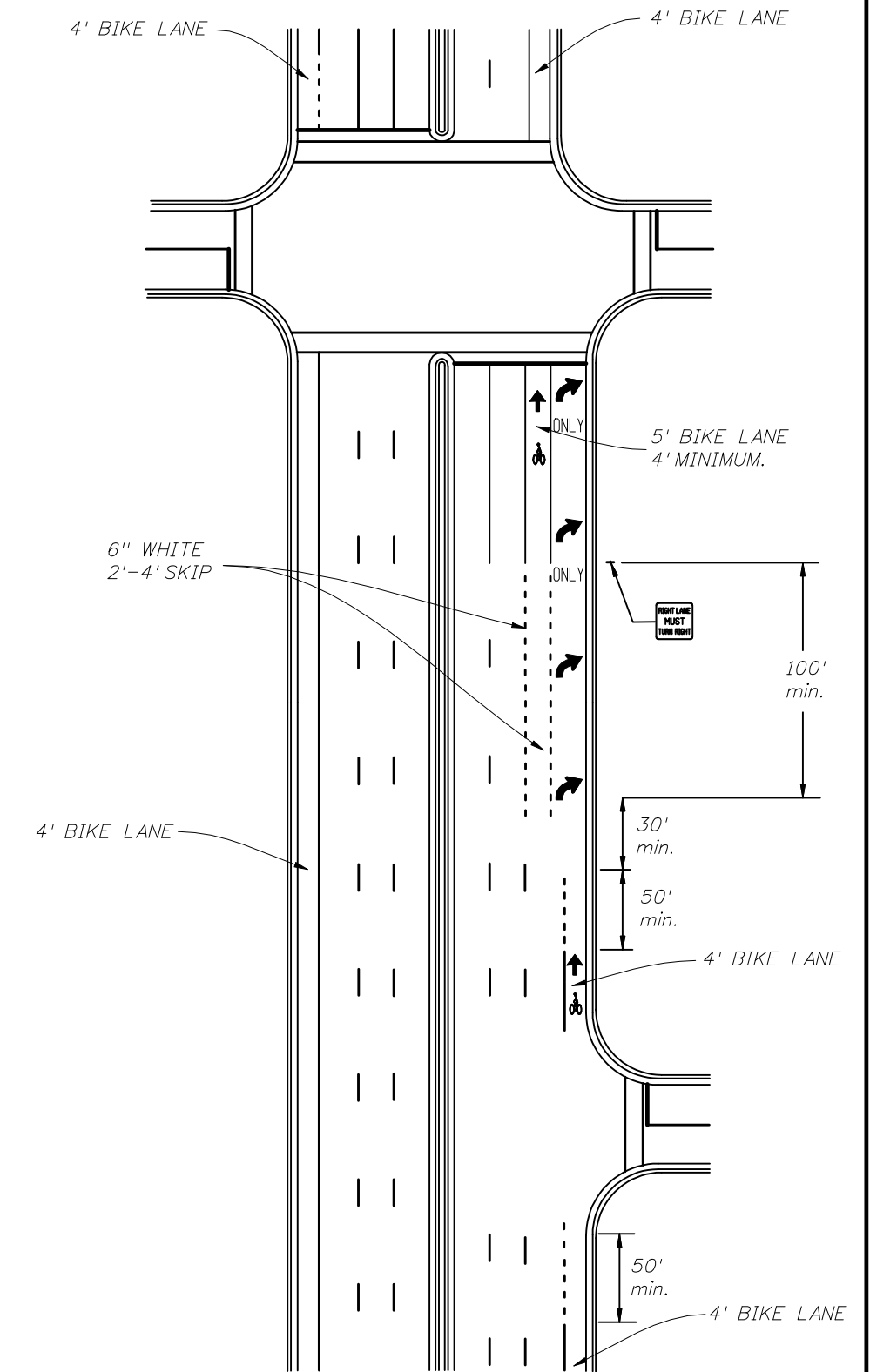

MAJOR INTERSECTION WITH RIGHT TURN DROP LANE AND DESIGNATED OR UNDESIGNATED BIKE LANE URBAN TYPICAL SECTION (CURB AND GUTTER)

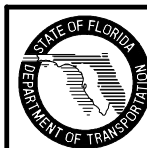

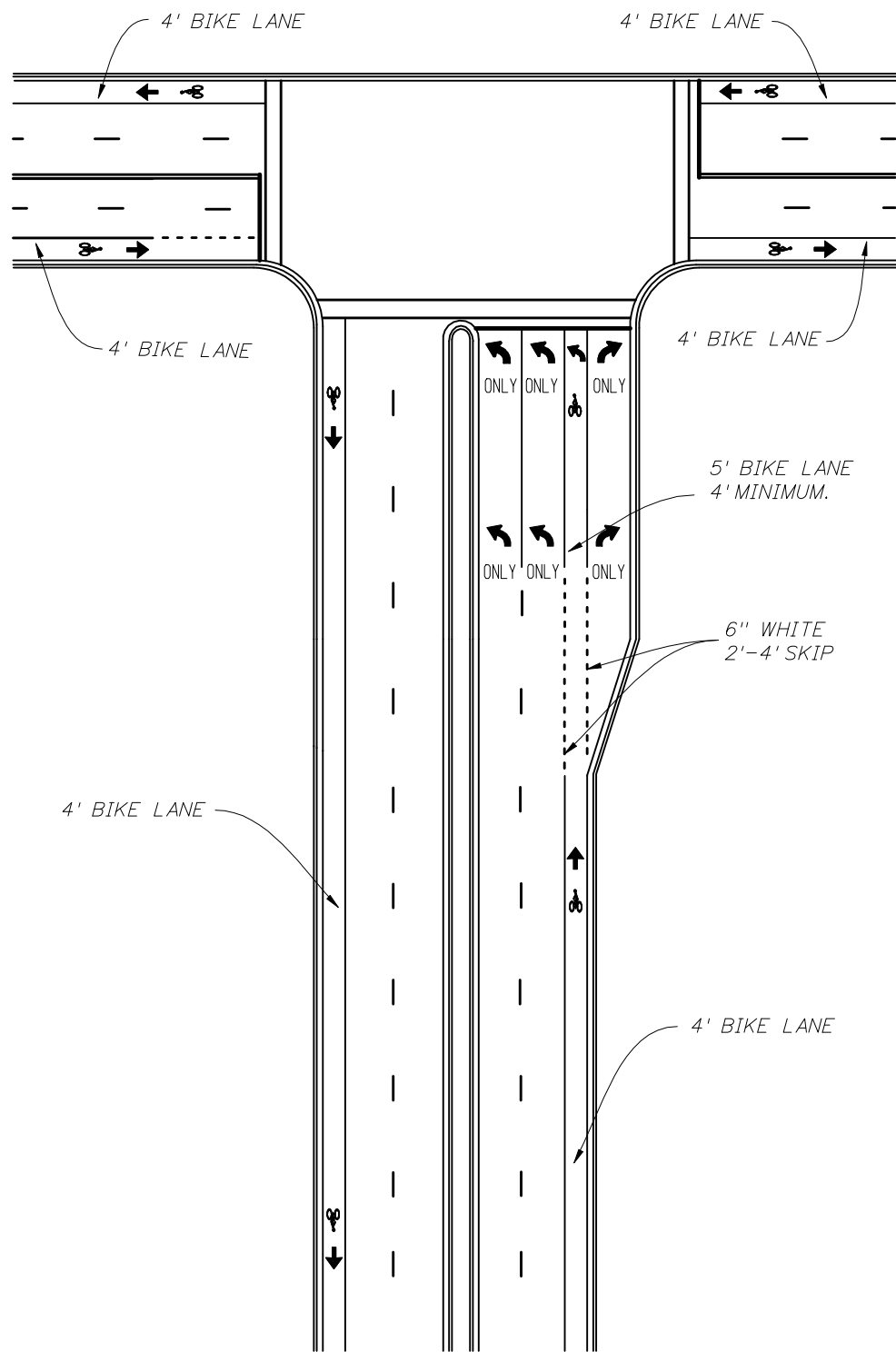

"TEE" INTERSECTION WITH SEPARATE RIGHT TURN LANE URBAN TYPICAL SECTION (CURB & GUTTER)

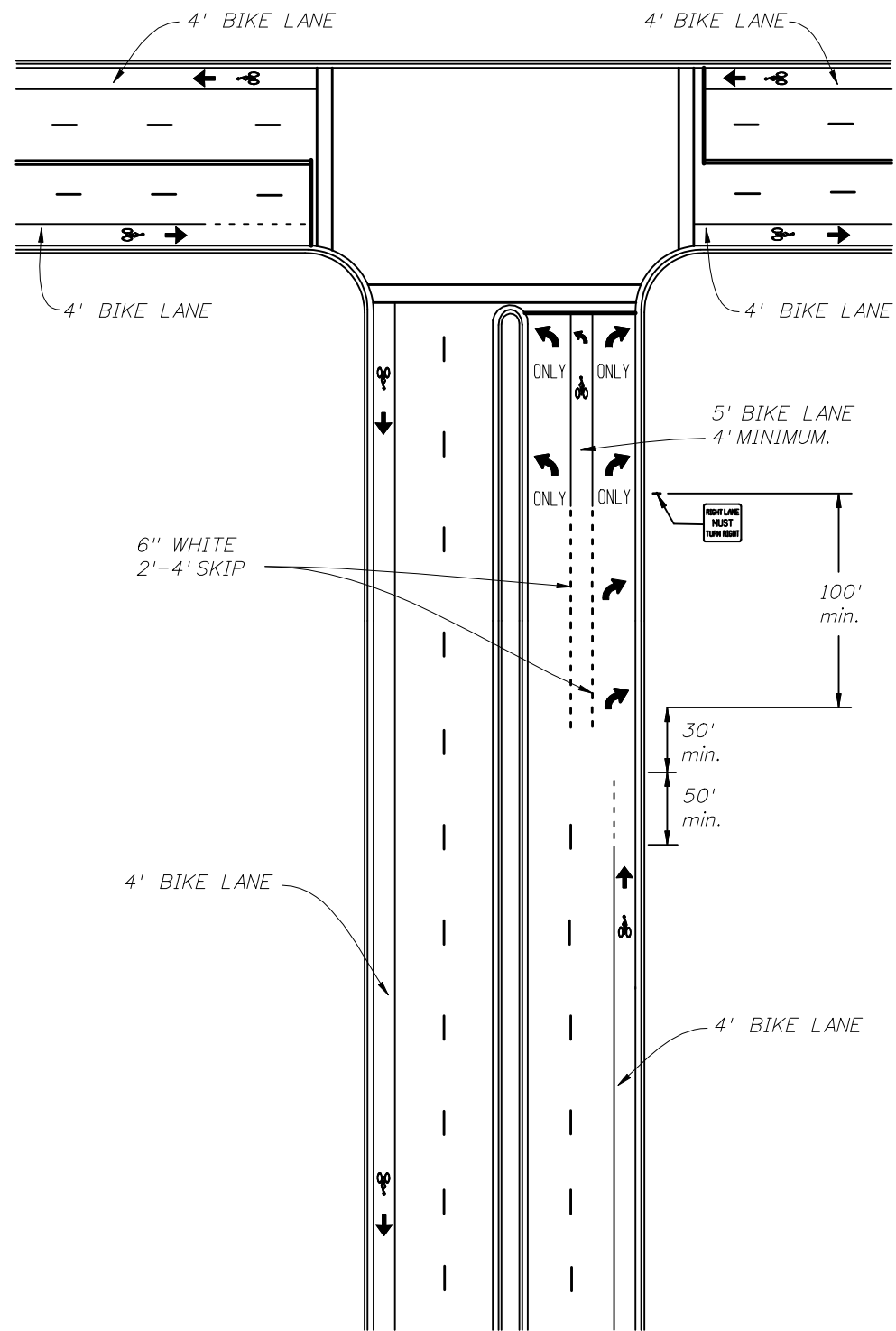

"TEE" INTERSECTION WITH RIGHT TURN DROP LANE URBAN TYPICAL SECTION (CURB & GUTTER)

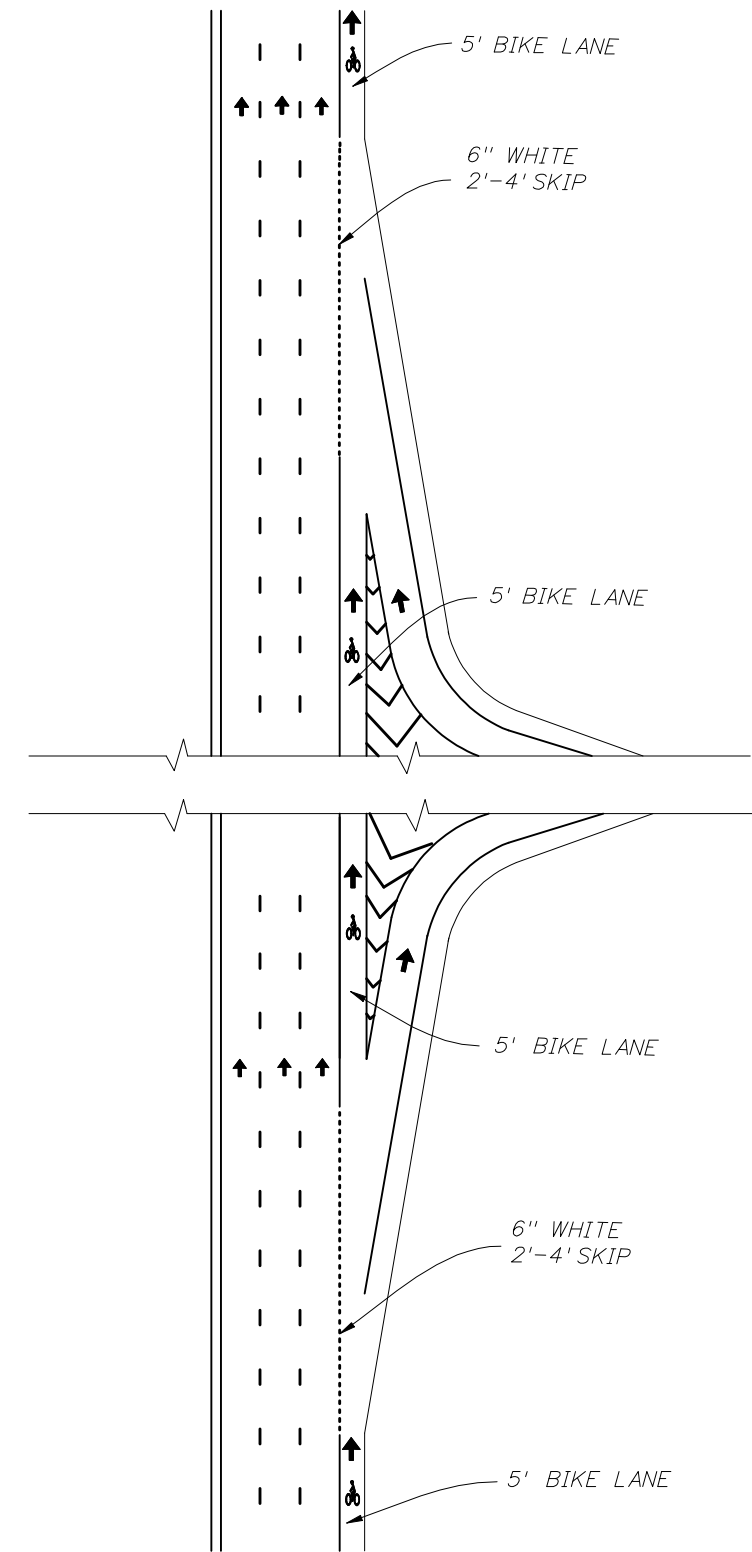

INTERCHANGE RAMP RURAL TYPICAL SECTION (PAVED SHOULDER)



2010 FDOT Design Standards

BICYCLE MARKINGS

| | |
|---------------|-----------|
| Last Revision | Sheet No. |
| 07/01/09 | 4 of 4 |
| Index No. | |
| 17347 | |