

ELEVATION
FENCING TERMINALS AT BRIDGE ENDS
(ROADWAY)

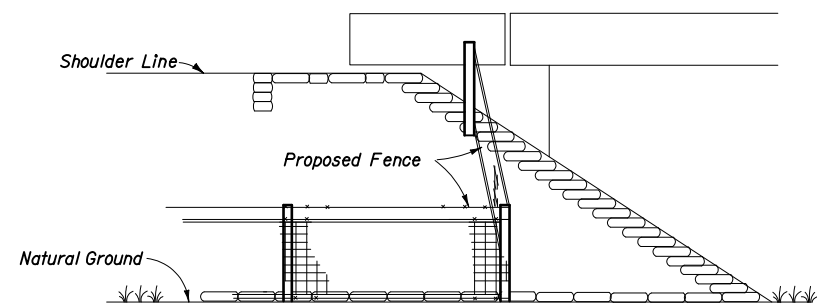

ELEVATION
FENCING TERMINALS AT BRIDGE ENDS
(STREAM CROSSING)

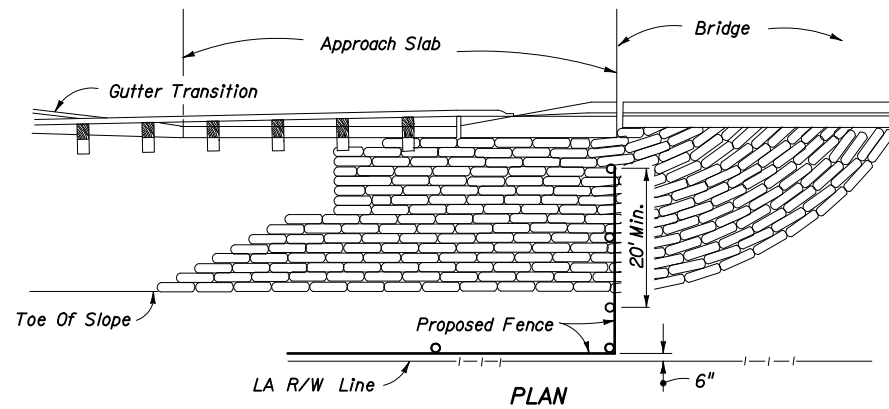
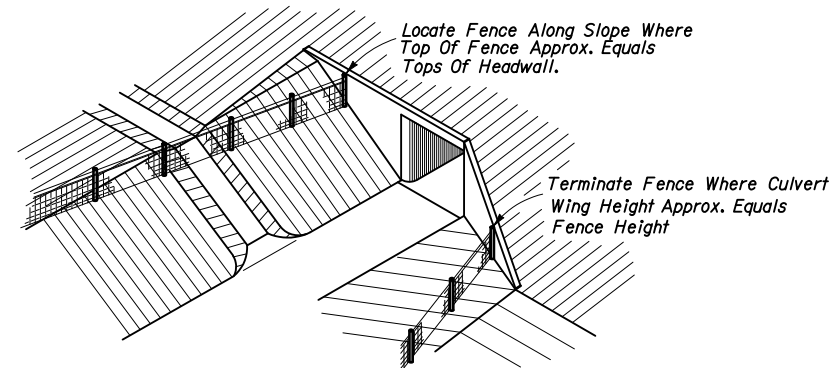

PICTORIAL VIEW

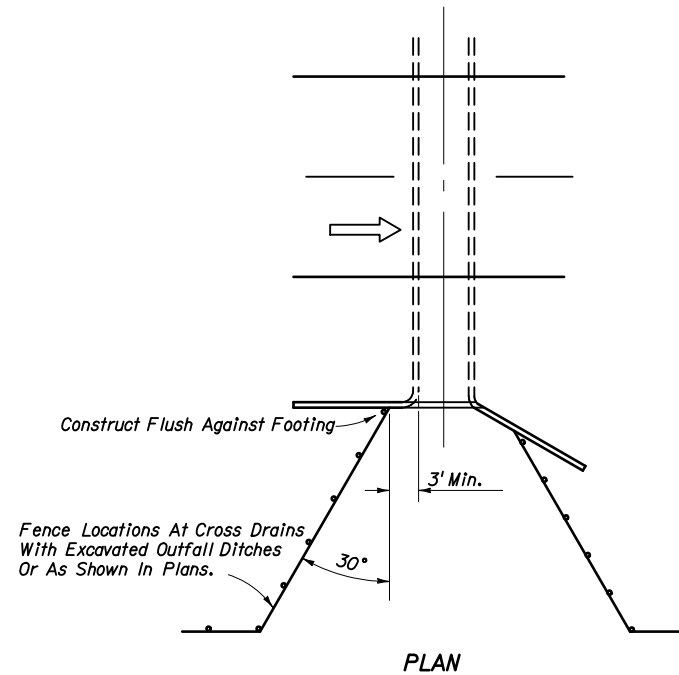

(For Heights Of Headwall Greater Than 4')
FENCING TERMINALS AT BOX CULVERTS

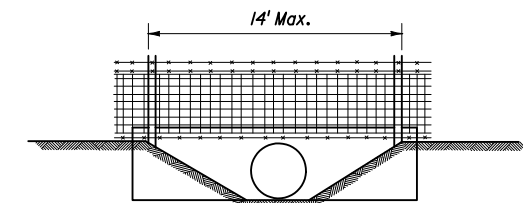

FENCING DETAIL AT CULVERT
(For Heights Of Headwalls 4' Or Less.)

Note: When height of headwall is 4' or less (drainage pipe 36" or less) the fence shall not be tied to the headwall, but shall span the lateral ditch.



2008 FDOT Design Standards

FENCE LOCATION

Last Revision	Sheet No.
07/01/05	1 of 2
Index No.	
800	

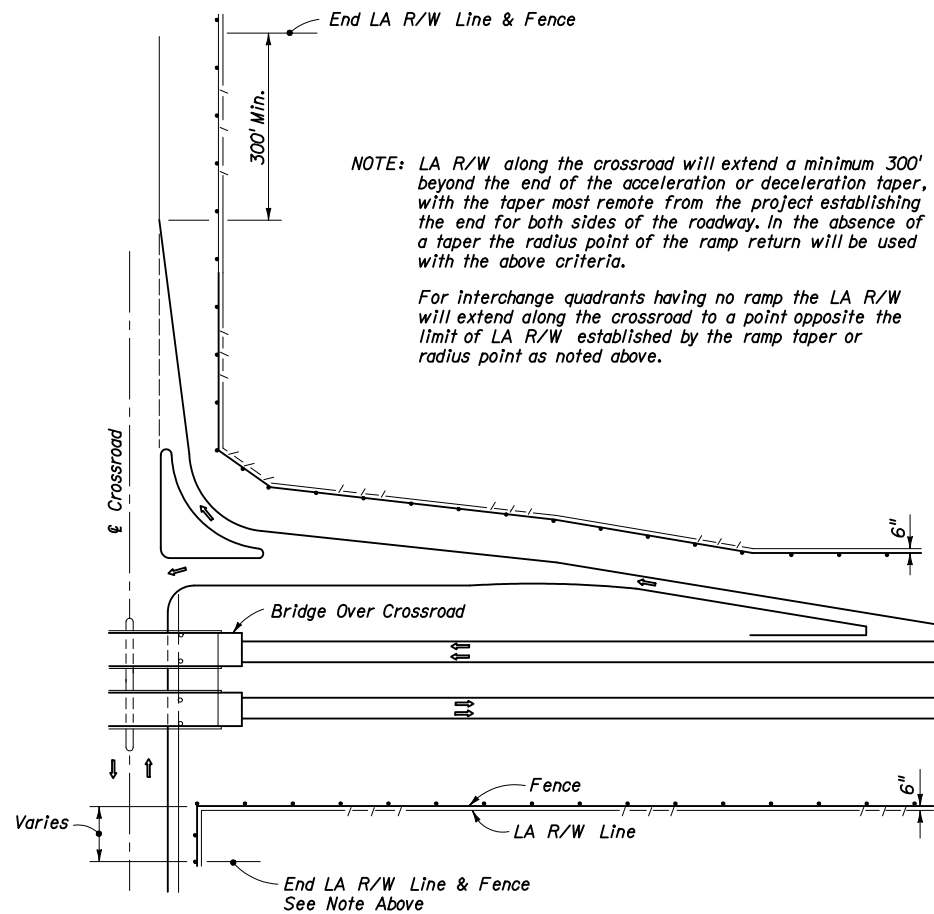

APPLIES TO BRIDGE OVER CROSSROAD AND CROSSROAD OVER FREEWAY (BRIDGE OVER CROSSROAD SHOWN)
FENCING TERMINALS AT RURAL INTERCHANGES

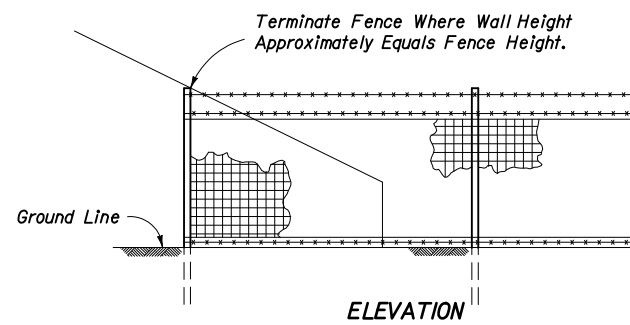
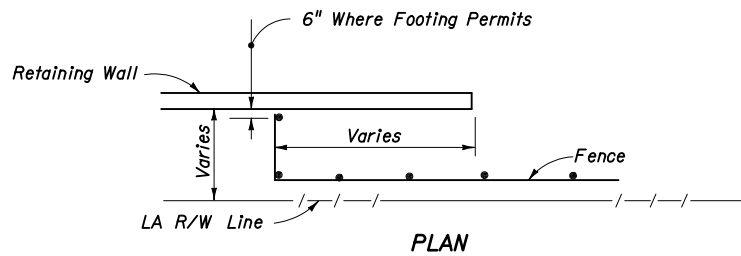

FENCING TERMINALS AT RETAINING WALLS

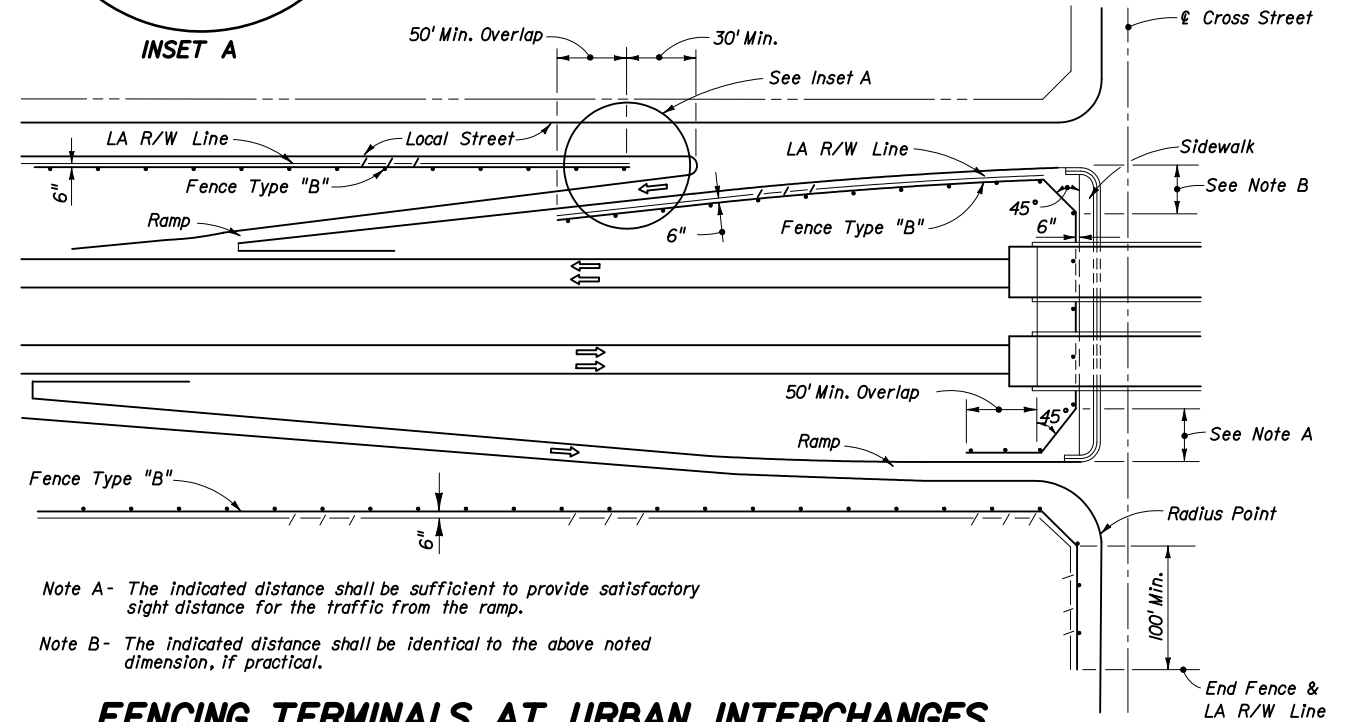
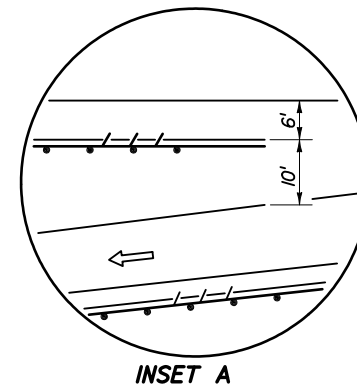

Note A - The indicated distance shall be sufficient to provide satisfactory sight distance for the traffic from the ramp.

Note B - The indicated distance shall be identical to the above noted dimension, if practical.

FENCING TERMINALS AT URBAN INTERCHANGES



2008 FDOT Design Standards

FENCE LOCATION

Last Revision	Sheet No.
07/01/05	2 of 2
Index No.	
800	