

| LENGTH OF ACCESS LANES (Ft.) | | |
|------------------------------|----------------|----------------|
| Grade | D ₁ | D ₂ |
| 2% or less | 590' | 1540' |
| 3 to 4% Upgrade | 530' | 2310' |
| 3 to 4% Downgrade | 710' | 925' |

PLAN

GENERAL NOTES

1. Temporary median crossovers shall be within the project limits and shall not be used for transporting materials to or from any other project. The acceleration-deceleration surfaces shall be paved. RAP material is acceptable for crossing surfacing.
2. Temporary median crossovers shall be located only in areas having adequate sight distance. On limited access facilities temporary median crossovers shall not be located within 1.5 miles of interchanges nor within 2000 ft. of acceleration-deceleration lanes at rest areas, other access openings or other highway service areas.
3. For paving train operations at permanent crossovers, see Index No. 630.
4. All traffic control devices are to be removed when crossover will not be in use for one hour or longer.
5. Trailer mounted advance warning panel may be used in lieu of advance warning vehicle.
6. When a crossover is no longer needed, all temporary construction shall be immediately removed and the area restored to its original condition.
7. Cost of construction, maintenance, removal and restoration work related to temporary crossovers shall be included in the contract unit price for Maintenance of Traffic, LS.

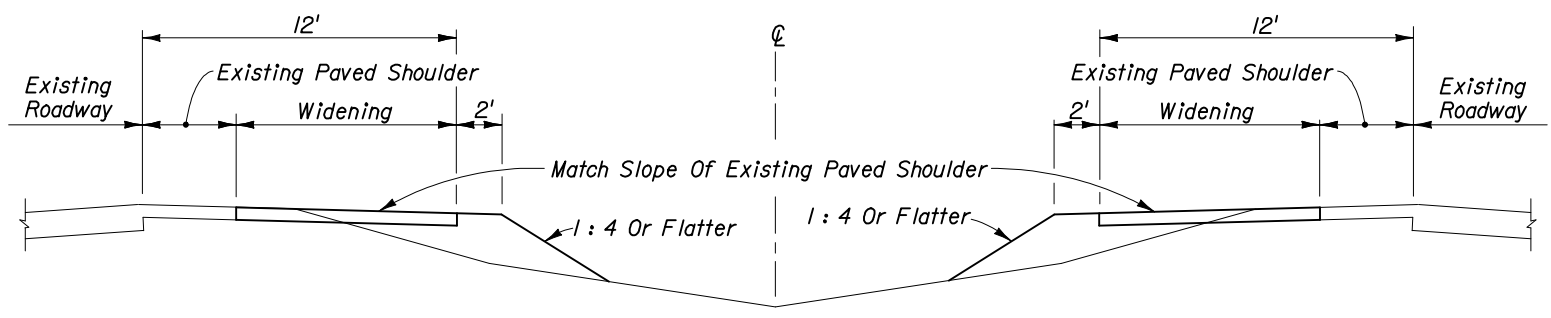

SECTION AA

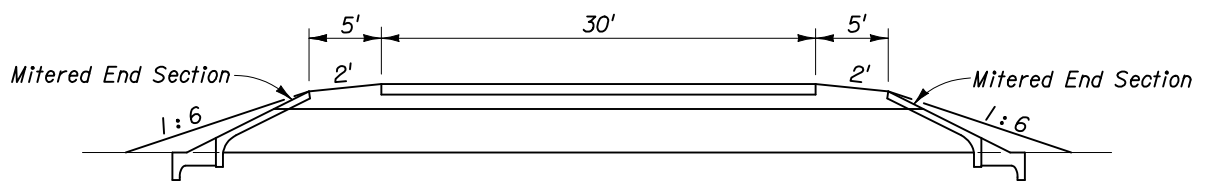

SECTION BB

- SYMBOLS**
- ▣ Work Zone Sign
 - ⇒ Lane Identification + Direction of Traffic

TEMPORARY CROSSOVER FOR MEDIAN WIDTHS ≥ 75'

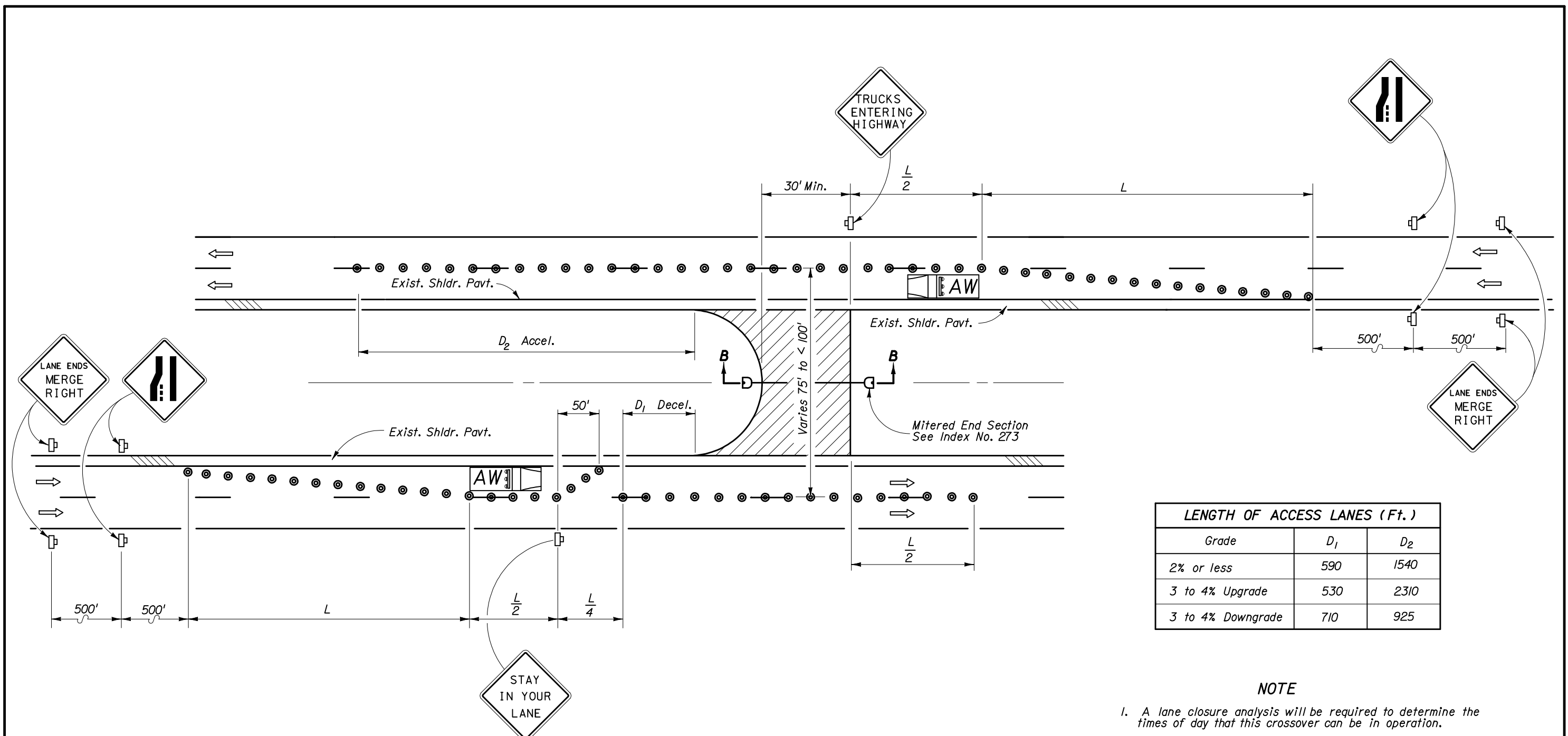

| LENGTH OF ACCESS LANES (Ft.) | | |
|--------------------------------|----------------|----------------|
| Grade | D ₁ | D ₂ |
| 2% or less | 590 | 1540 |
| 3 to 4% Upgrade | 530 | 2310 |
| 3 to 4% Downgrade | 710 | 925 |

NOTE

1. A lane closure analysis will be required to determine the times of day that this crossover can be in operation.

SYMBOLS

- Work Area, Hazard Or Work Phase (Any Pattern Within A Boundary)
- Work Zone Sign
- Cone Or Tubular Marker
- Advance Warning Vehicle
- Lane Identification + Direction of Traffic

Maximum Spacing Between Cones And Tubular Markers Shall Be 25'

$L (Min.) = WS$
 $S = Existing Posted Speed (MPH)$

TEMPORARY CROSSOVER FOR MEDIAN WIDTHS FROM 50' TO <75'