

Approach Speed (MPH)	Distance A (FT)
25 To 35	200
36 To 45	350
46 To 55	500

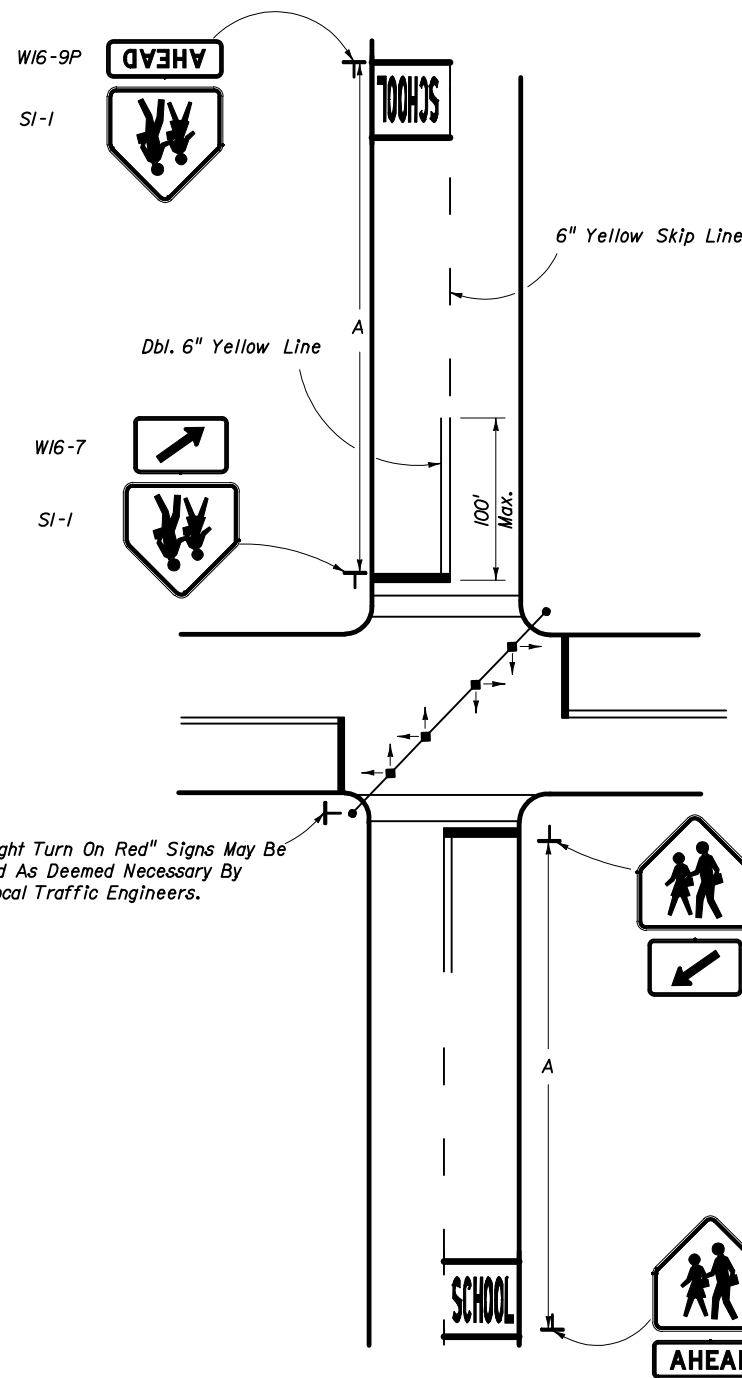

1. TRAFFIC CONTROL DEVICES FOR A SCHOOL CROSSWALK AT A SIGNALIZED INTERSECTION

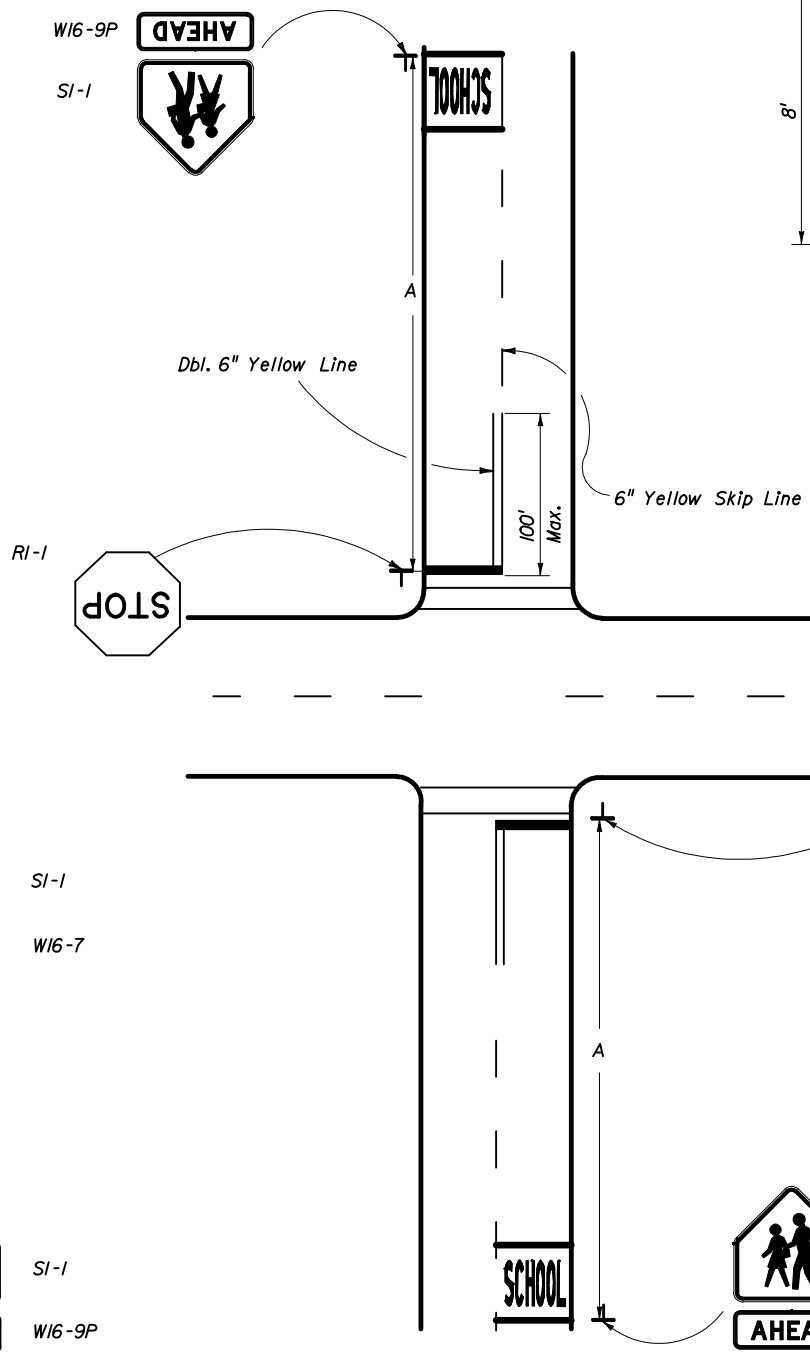

2. TRAFFIC CONTROL DEVICES FOR A SCHOOL CROSSWALK AT A STOP CONTROLLED INTERSECTION

Note: Special speed restrictions are not normally applicable to these two cases.

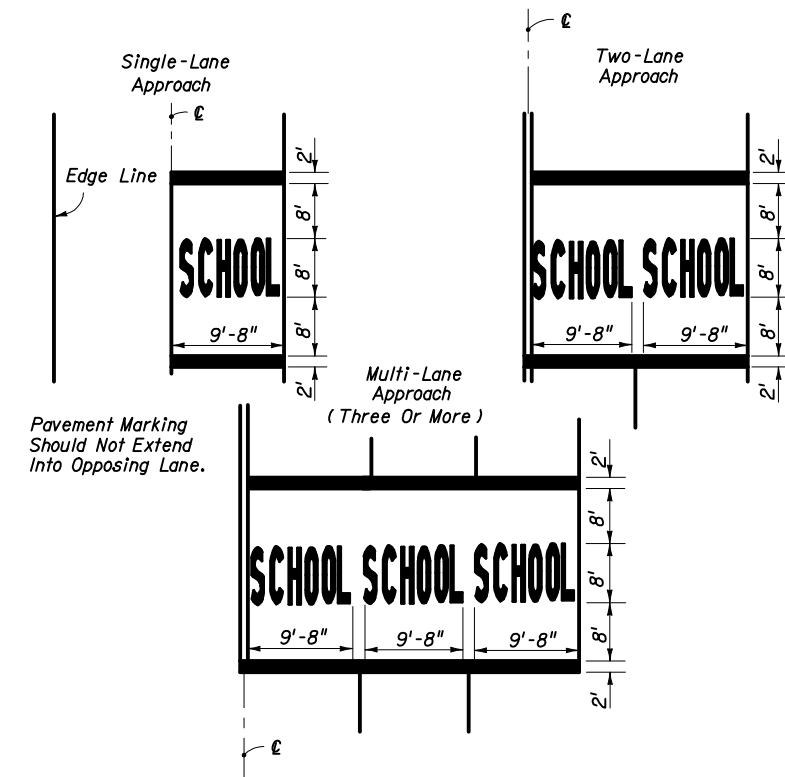
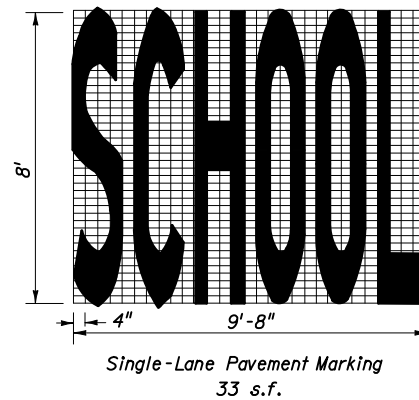

PAVEMENT MARKINGS

Notes

Signs shall be erected in accordance with Index No. 17302.

When computing pavement message quantities do not include transverse lines.

All school signs shall be reflective.

School crosswalk width shall be 6' min. 10' std. without public sidewalk curb ramps 10' min. with public sidewalk curb ramps. See Index No. 17346 sheet 9 of 13.

For signalized intersections or mid-block signalized crossings where flashing beacon speed limit signs (post mounted or overhead) are installed, the minimum distance from the speed limit sign to the stop line shall be 100'. The sign shall not block the view of the signal.

STATE OF FLORIDA DEPARTMENT OF TRANSPORTATION				
SCHOOL SIGNS & MARKINGS				
Names	Dates	Approved By		
Designed By	7-76	C. Lamb O. Scott State Traffic Standards Engineer		
Drawn By		Revision	Sheet No.	Index No.
Checked By	7-76	02	1 of 6	17344

3. TRAFFIC CONTROL DEVICES WITH FLASHING BEACON FOR REDUCED SPEED ZONE AT A SCHOOL CROSSWALK (2 LANES - 2 WAY TRAFFIC)
 (MIDBLOCK OR ON THRU STREET AT AN INTERSECTION)

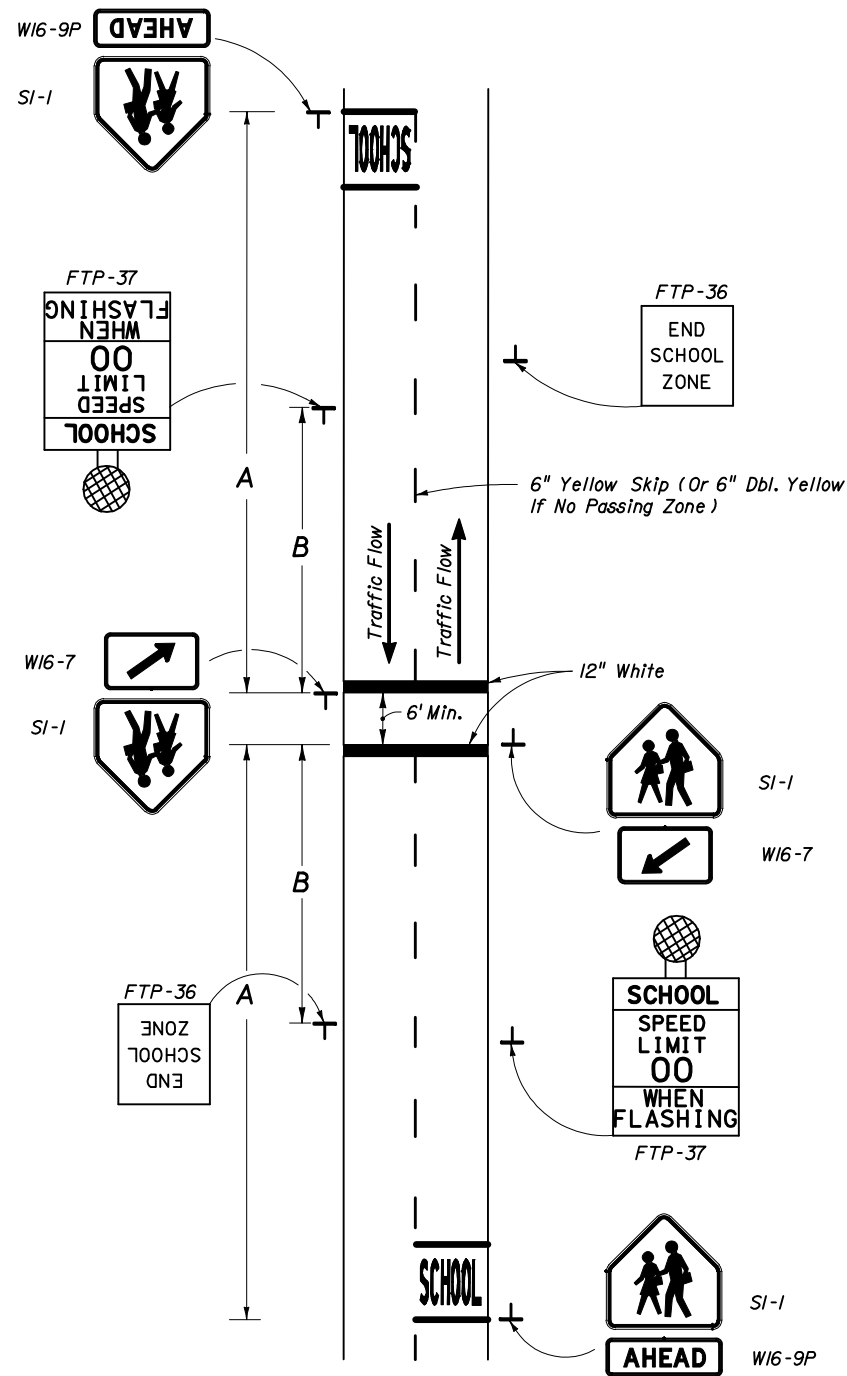

4. TRAFFIC CONTROL DEVICES FOR A REDUCED SPEED ZONE AT A SCHOOL CROSSWALK (NO FLASHING BEACON)
 (2 LANES - 2 WAY TRAFFIC)
 (MIDBLOCK OR ON THRU STREET AT AN INTERSECTION)

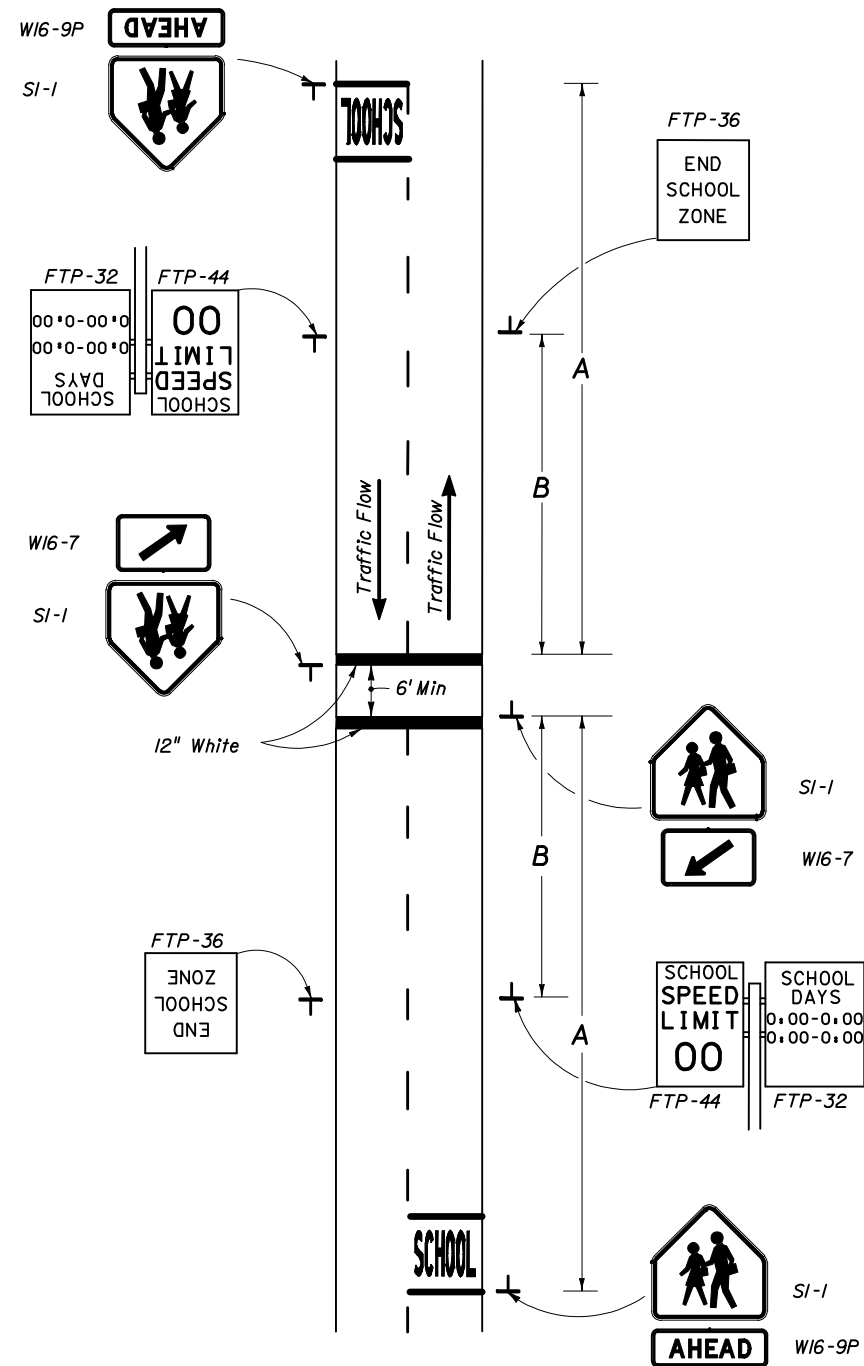

5. TRAFFIC CONTROL DEVICES FOR A REDUCED SPEED ZONE AT A SCHOOL CROSSWALK WITH OVERHEAD FLASHING BEACON SPEED LIMIT SIGNS
 (4 LANES UNDIVIDED - 2 WAY TRAFFIC)
 (MIDBLOCK OR ON THRU STREET AT AN INTERSECTION)

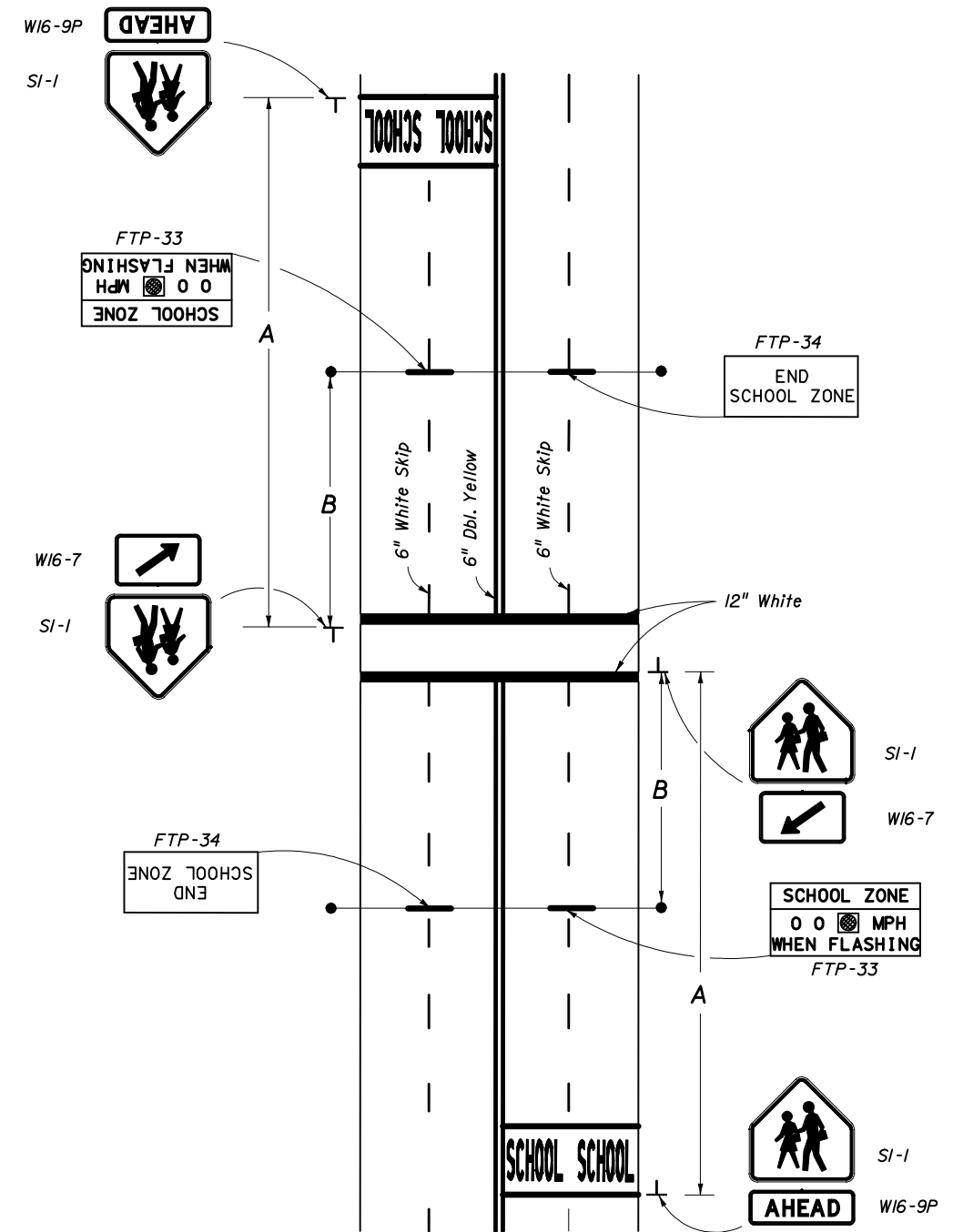

APPROACH SPEED MPH	SUGGESTED DISTANCE IN FEET	
	A	B
25 To 35	200	50
36 To 45	350	65
46 To 55	500	80

School crosswalk width shall be 6' min.
 10' std. without public sidewalk curb ramps.
 10' min. with public sidewalk curb ramps.
 See Index No. 17346 sheet 9 of 13.

STATE OF FLORIDA DEPARTMENT OF TRANSPORTATION

SCHOOL SIGNS & MARKINGS

Names	Dates	Approved By		
Designed By	7-76	Charles Scott State Traffic Standards Engineer		
Drawn By				
Checked By	7-76	Revision	Sheet No.	Index No.
		02	2 of 6	17344

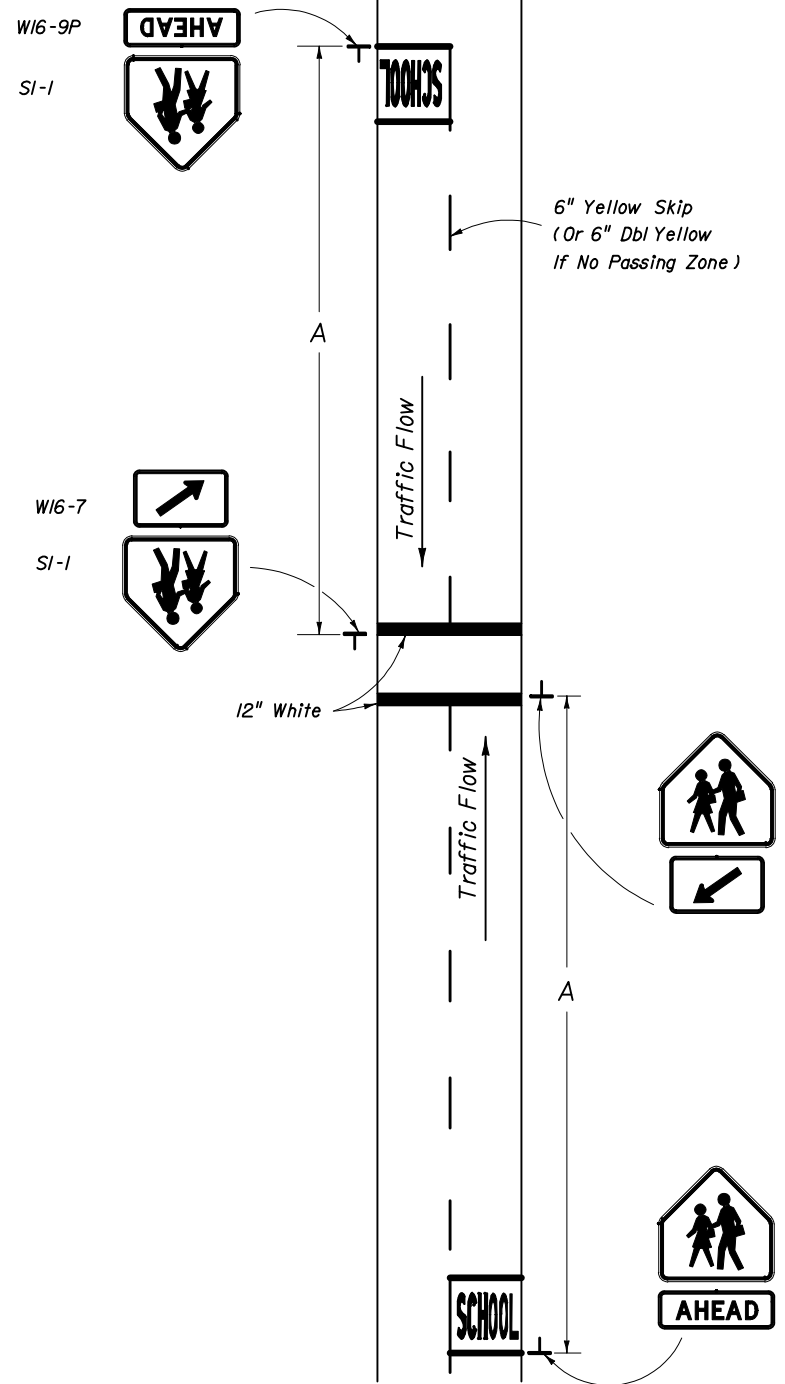

6. TRAFFIC CONTROL DEVICES FOR A SCHOOL CROSSWALK WITHOUT A SPEED REDUCTION (2 LANES - 2 WAY TRAFFIC)

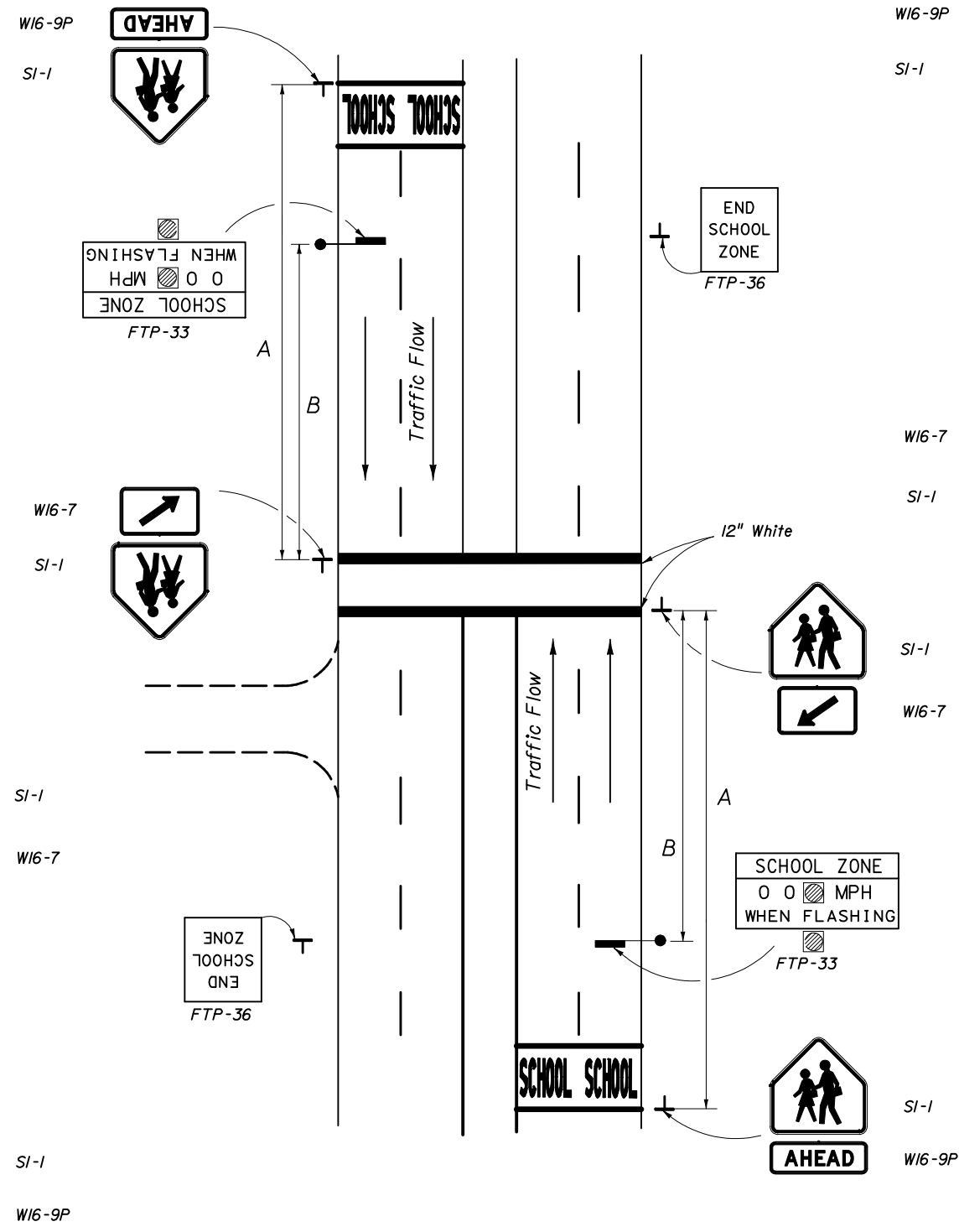

7. TRAFFIC CONTROL DEVICES FOR A REDUCED SPEED ZONE AT A SCHOOL CROSSWALK WITH OVERHEAD FLASHING BEACON SPEED LIMIT SIGNS (4 LANES DIVIDED - 2 WAY TRAFFIC)

APPROACH SPEED MPH	SUGGESTED DISTANCE IN FEET	
	A	B
25 To 35	200	50
36 To 45	350	65
46 To 55	500	80

School crosswalk width shall be 6' min. 10' std. without public sidewalk curb ramps. 10' min. with public sidewalk curb ramps. See Index No. 17346 sheet 9 of 13.

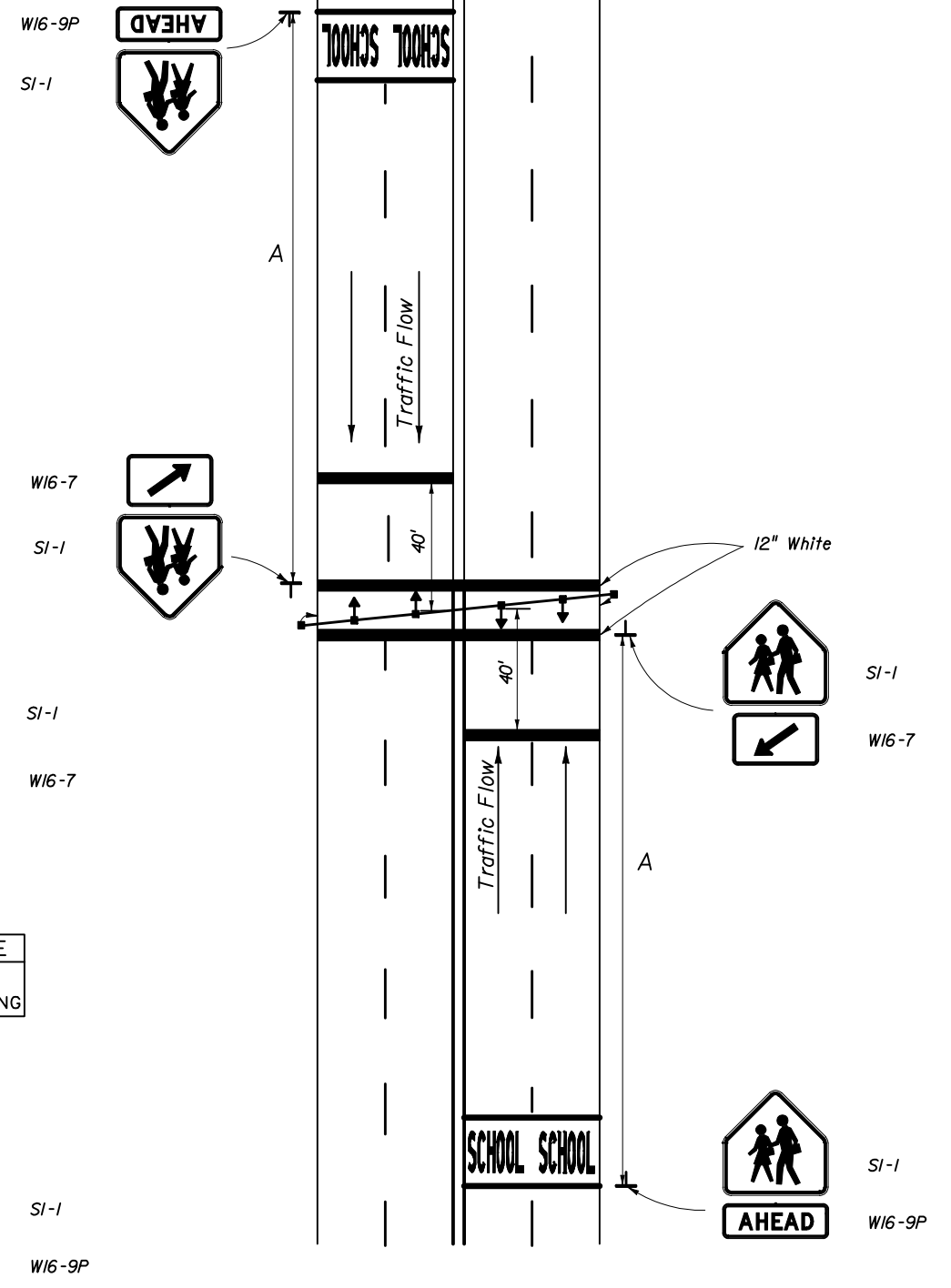

8. TRAFFIC CONTROL DEVICES FOR SIGNALIZED MIDBLOCK SCHOOL CROSSWALK

STATE OF FLORIDA DEPARTMENT OF TRANSPORTATION

SCHOOL SIGNS & MARKINGS

Designed By		Dates	7-76	Approved By	<i>Charles A. Scott</i>
Drawn By		Revision		State Traffic Standards Engineer	
Checked By		7-76	02	Sheet No.	3 of 6
				Index No.	17344

24"X24"
W13-1

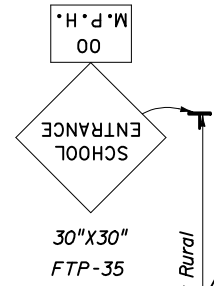

750' For Rural

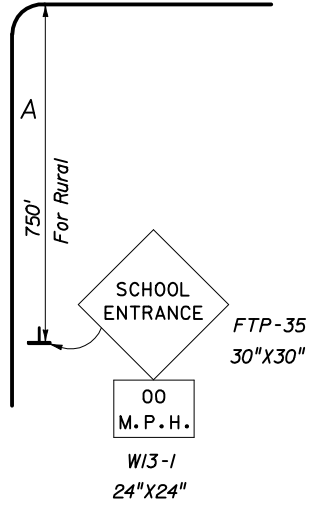
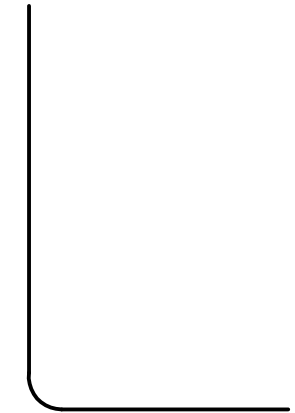

9. TRAFFIC CONTROL DEVICES AT SCHOOL ENTRANCES WITH LOW VOLUMES OF WALKING STUDENTS

These signs are intended for use only at those few locations where the school entrance is not evident to the motorist, and must be approved in advance by the responsible traffic engineering authority.

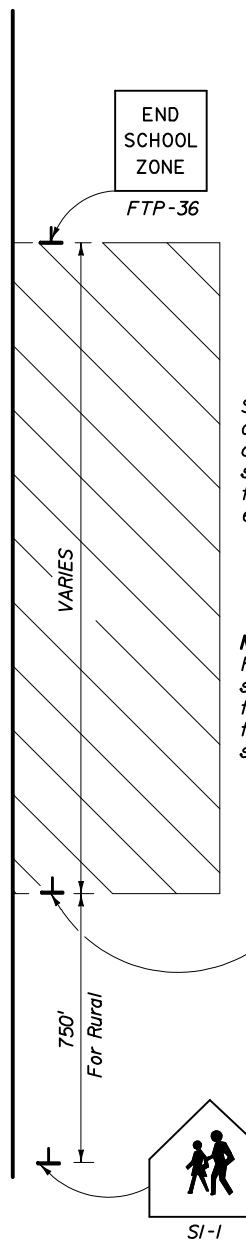
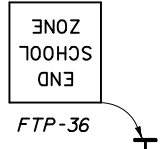
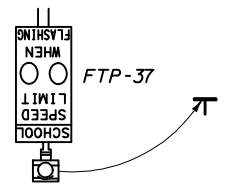
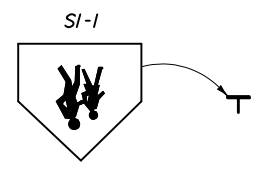

END SCHOOL ZONE
FTP-36

VARIES

School zone limits or unprotected activity as defined by local school board through the local traffic engineers

Note:
Roll out school signs shall not be utilized to control traffic through an established school zone

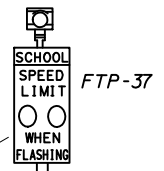

Location Of School Speed Limit Sign When A Reduced Speed Limit Has Been Approved



10. TRAFFIC CONTROL DEVICES FOR A TYPICAL SCHOOL ZONE FRONTING THE SCHOOL PROPERTY

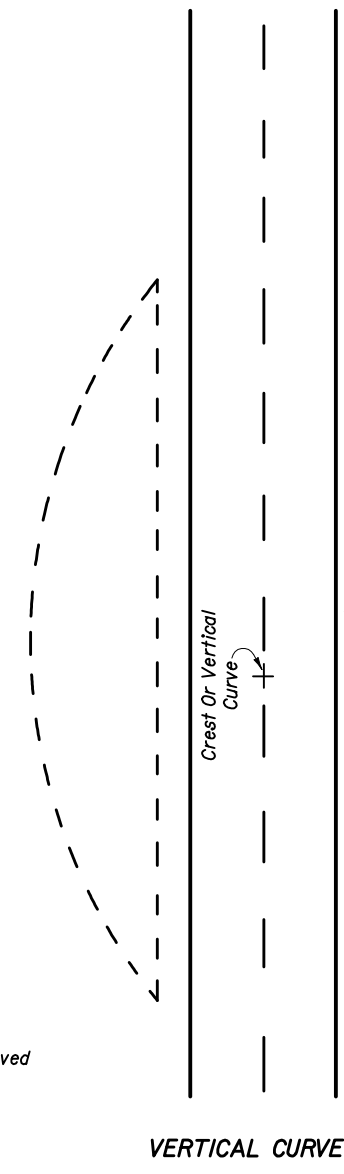

VERTICAL CURVE

II. SCHOOL BUS STOP

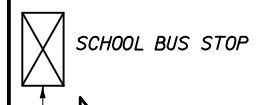

500'

Note:

The school bus stop ahead sign is to be used in advance of locations where a school bus, when stopped to pick up or discharge passengers, is not visible for a distance of 500' in advance. It shall have a min. size of 30"X30". It is not intended that these signs be used wherever a school bus stops to pick up or discharge passengers. These signs are intended for use only where terrain and roadway features limit the approach sight distance and where there is no opportunity to relocate the stop to another location with adequate visibility.

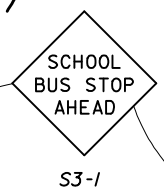

S3-1

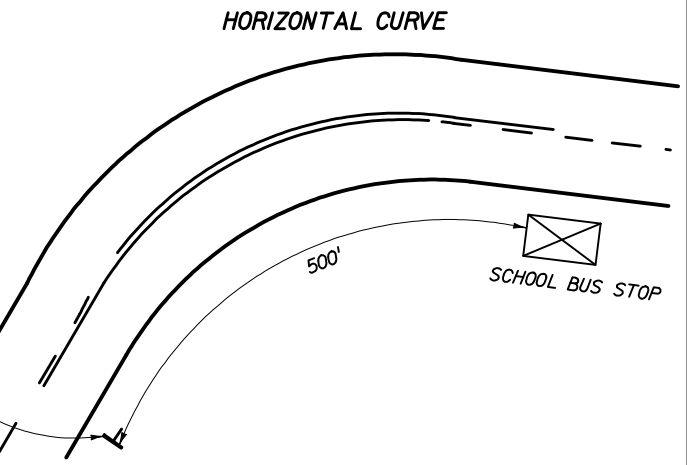

HORIZONTAL CURVE

500'

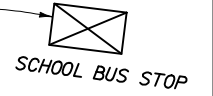

SCHOOL BUS STOP

STATE OF FLORIDA DEPARTMENT OF TRANSPORTATION

SCHOOL SIGNS & MARKINGS

Designed By	Names	Dates	Approved By
Drawn By		7-76	<i>Charles Scott</i> State Traffic Standards Engineer
Checked By		7-76	Revision Sheet No. Index No.
			00 4 of 6 17344

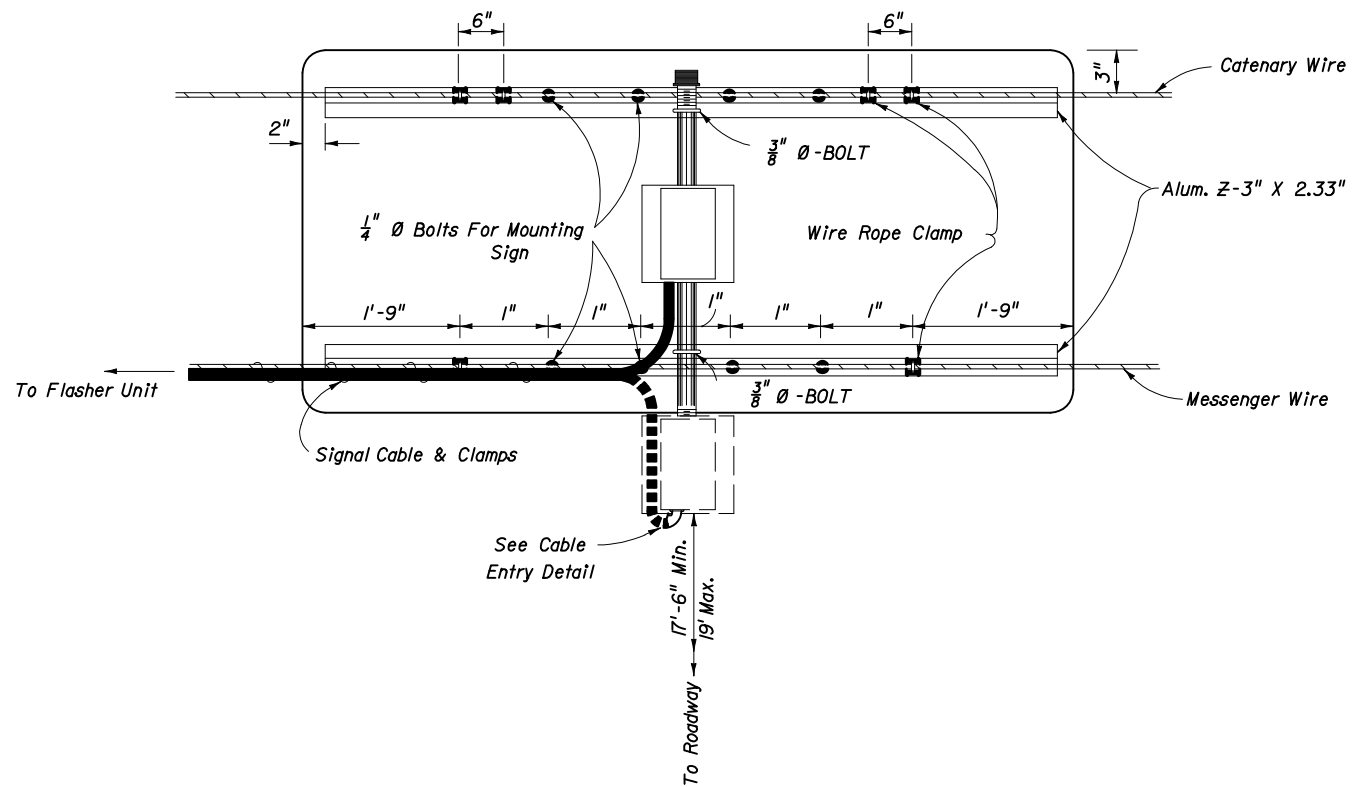

REAR VIEW

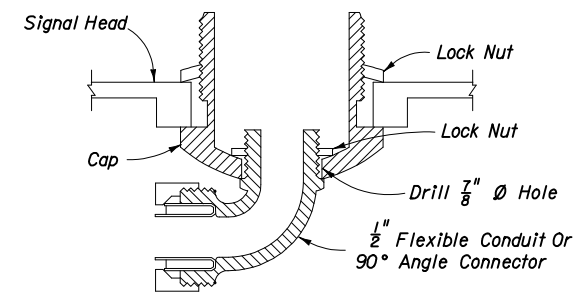

CABLE ENTRY DETAIL

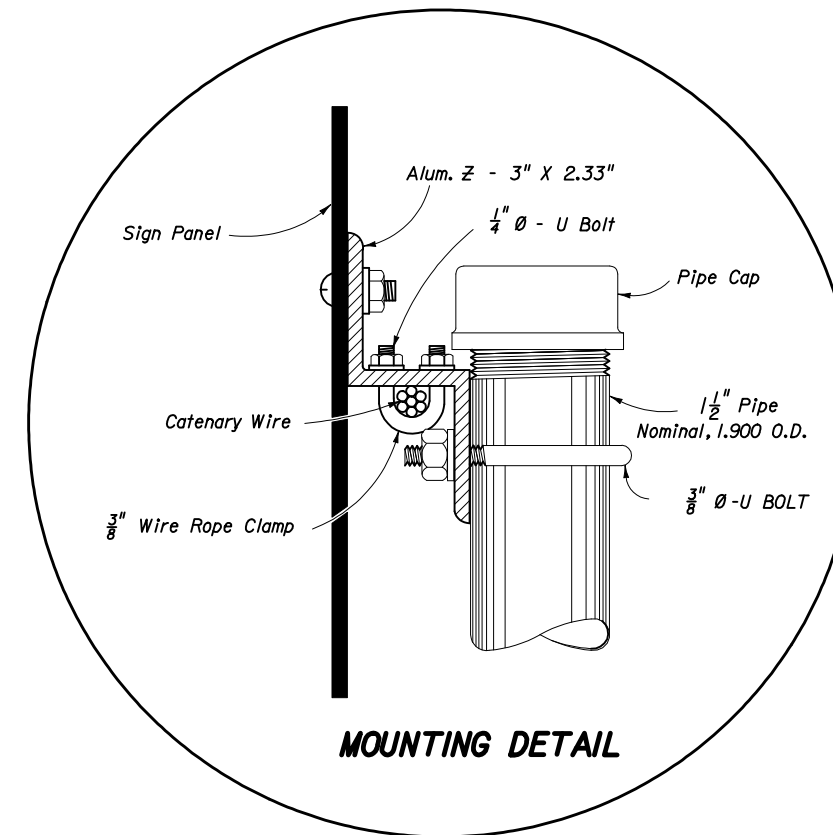

MOUNTING DETAIL

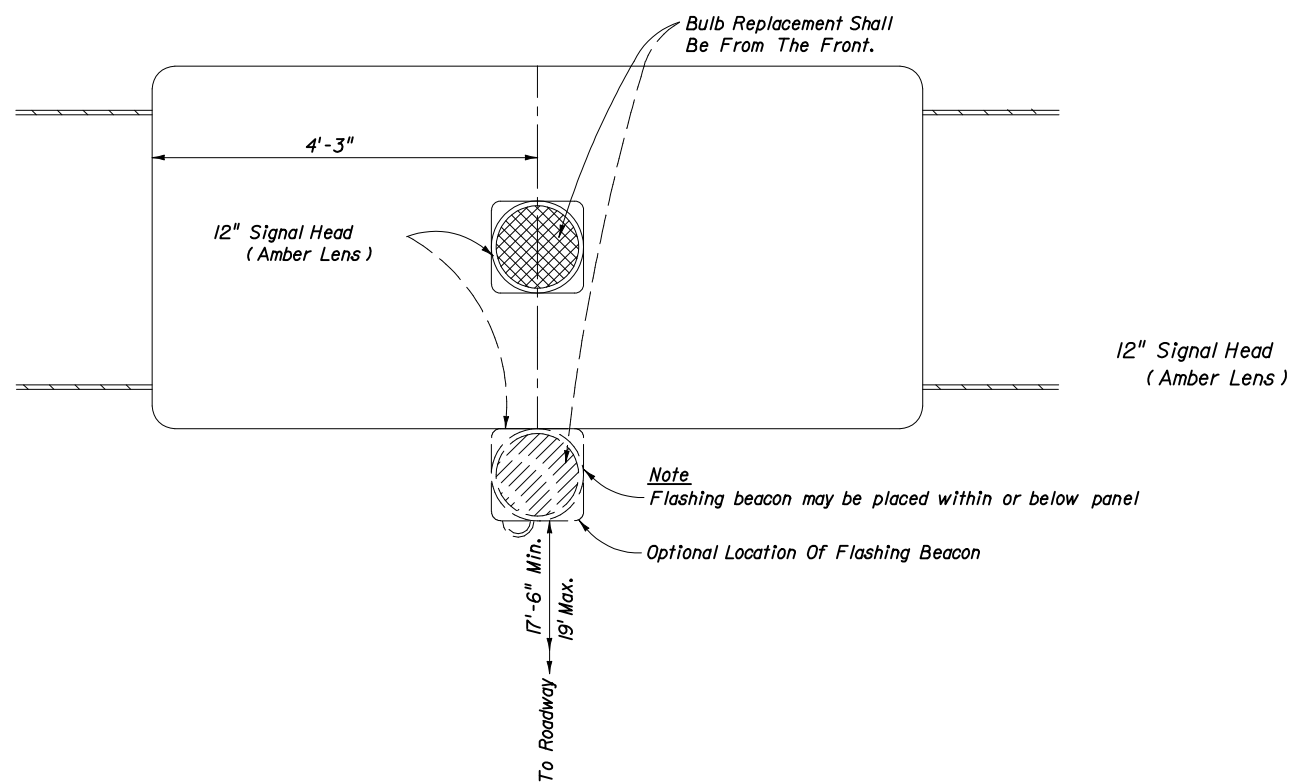

FRONT VIEW

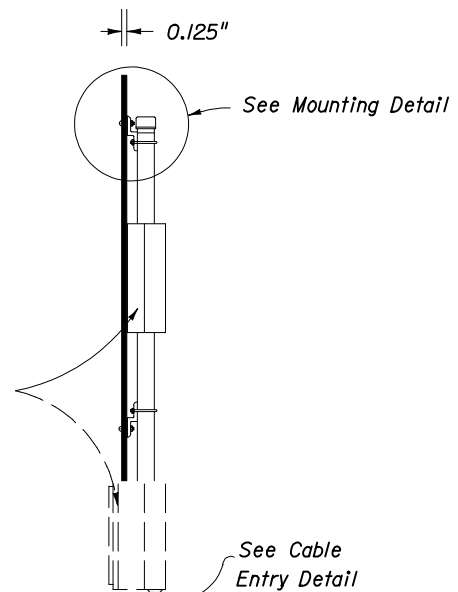

SIDE VIEW

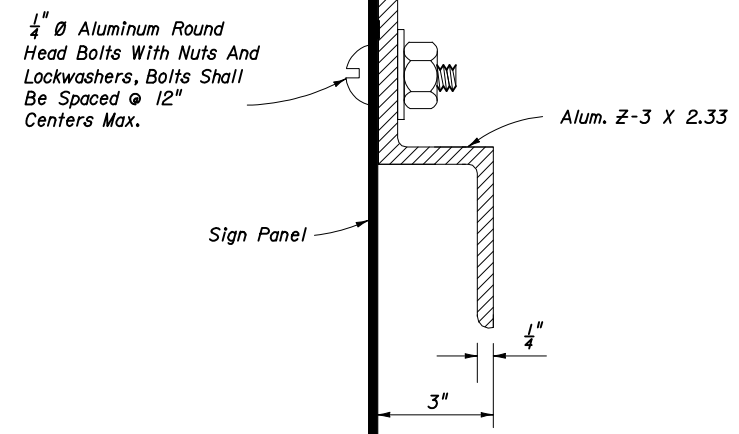

Z SECTION DETAIL

Flasher unit and cabinet to be placed on the strain pole supporting overhead sign assembly or on service pole. The flasher unit not to overhang private property or sidewalk.

STATE OF FLORIDA DEPARTMENT OF TRANSPORTATION				
SCHOOL SIGNS & MARKINGS				
Designed By		Dates	Approved By <i>Charles Scott</i>	
Drawn By			State Traffic Standards Engineer	
Checked By		7-76	Revision	Sheet No. Index No.
			00	5 of 6 17344

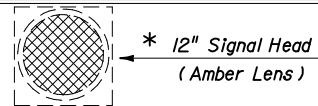
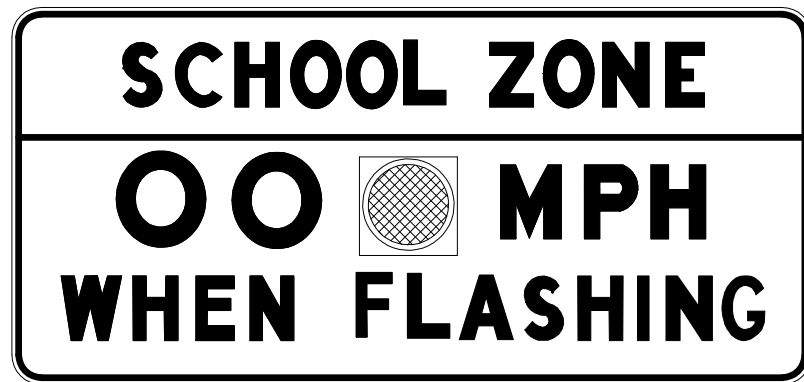

FTP - 33

OVERHEAD STANDARD

* Flashing Beacon May Be Placed Within Or Below Panel



FTP - 35

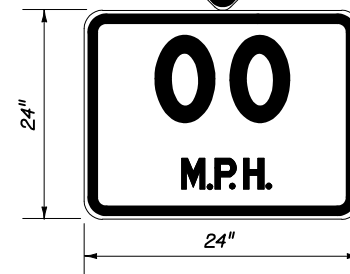

W13 - 1

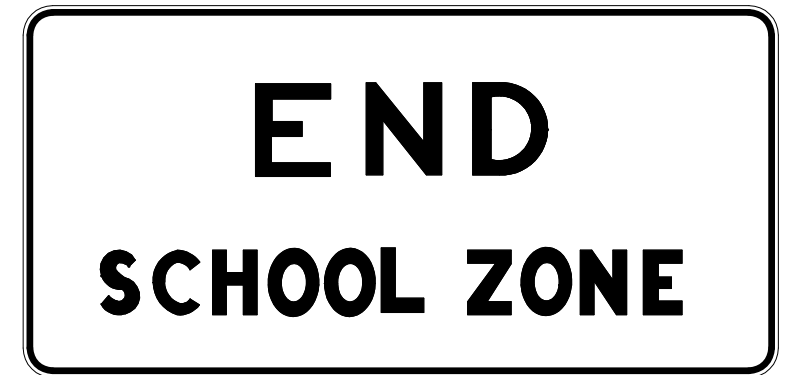

FTP - 34

12" Signal Head (Amber Lens)



FTP - 37

Ground Mount Standard

Note:
Existing ground mount school speed limit signs utilizing a single 8" min. size beacon or two 6" min. size beacons inside the sign border are considered meeting the standard. However, replacement or upgrading of these school speed limit signs shall conform to the above standard. Numerical speed limit displayed shall be established by appropriate regulatory authorities.

Notes:

1. Standard size signs should be used whenever possible. Minimum sizes may be used only on low volume, low speed (less than 35 m.p.h.) streets. Special sizes should be used on expressway facilities where special emphasis is needed.
2. The value of the actual school zone speed limit shall be determined by the District Traffic Operations Engineer in cooperation with local school superintendents. In no case shall it be less than the 15 m.p.h. min. as set by law.
3. See Index No. 17355 for sign details.

SPEED LIMIT ASSEMBLY

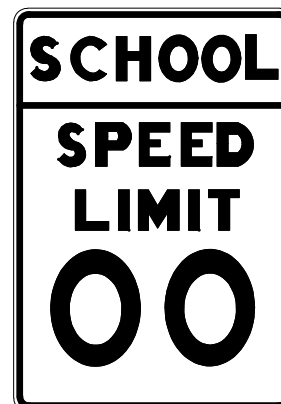

FTP-44

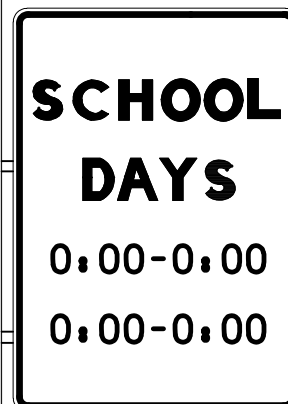

FTP - 32

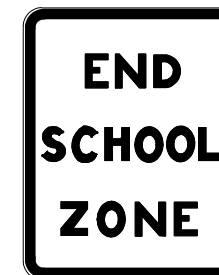

FTP - 36

STATE OF FLORIDA DEPARTMENT OF TRANSPORTATION				
SCHOOL SIGNS & MARKINGS				
Designed By	Names	Dates	Approved By	
Drawn By		7-76	<i>Charles A. Scott</i> State Traffic Standards Engineer	
Checked By	Revision	7-76	Sheet No.	Index No.
	00		6 of 6	17344