

NOTE: Exit numbering panel shall be located to the right side for right exit and to the left for left exit.

Mounting of Exit Numbering Panels To Highway Signs
ELEVATION

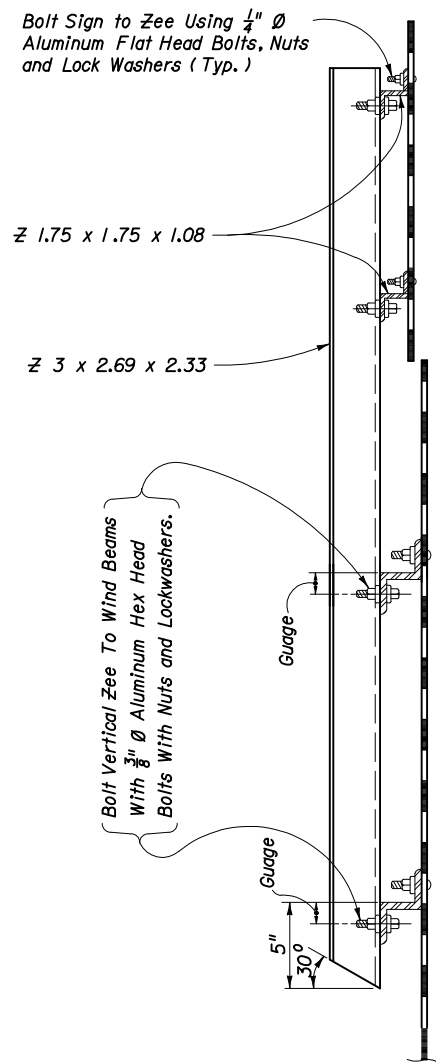

SECTION AA

GENERAL NOTES

DESIGN SPECIFICATION: Latest Standard Specifications for Structural Supports for Highway Signs, Luminaires and Traffic Signals, AASHTO 1994.

SHEETS AND PLATES: Material used shall meet the requirements of Aluminum Association Alloy 6061-T6 and ASTM B209. Sheets are to be degreased, etched, neutralized and treated with Alodine 11200, Iridite 14-2 Bonderite 721, or equal. No stenciling permitted on sheets.

MATERIALS: All aluminum materials shall meet the requirements of the Aluminum Association Alloy 6061-T6 and also the following ASTM specifications for the following: Sheets and plates B209; extruded shapes B221 and standard structural shapes B308.

ALUMINUM BOLTS, NUTS & LOCK WASHERS: Aluminum bolts shall meet the requirements of the Aluminum Association Alloy 2024-T4 or 6061-T6 (ASTM B211). The bolts shall have an anodic coating of at least .0002" thick and be chromate sealed. Lockwashers shall meet the requirement of Aluminum Association Alloy 7075-T6 (ASTM B221). Nuts shall meet the requirement of Aluminum Association Alloy 6262-T9 or 6061-T6.

SIGN FACE: All sign face corners shall be rounded. See sign layout sheet for dimension "L" and sign face details.

MATERIAL STRESSES: All allowable stresses are in accordance with Standard Specifications for Structural Supports for Highway Signs, Luminaires and Traffic Signals. AASHTO for all materials shown in the plans.

For mounting details refer to Index No. 11037.

STATE OF FLORIDA DEPARTMENT OF TRANSPORTATION

MOUNTING EXIT NUMBERING PANELS TO HIGHWAY SIGNS

Designed By	CK/CWB	Dates	7-82	Approved By	<i>W. V. [Signature]</i>
Drawn By		Revision		Sheet No.	1 of 1
Checked By	CK	7-82	02	Index No.	13417