

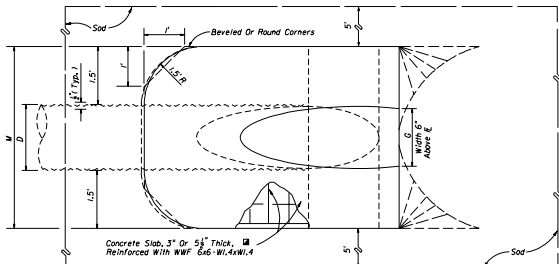

DIMENSIONS AND QUANTITIES

	D	X	A	B	C	E	F	G	M				N	5 1/2" CONCRETE SLAB (CY) ■				SODDING (SQ. YDS.)			
									Single Pipe	Double Pipe	Triple Pipe	Quad. Pipe		Single Pipe	Double Pipe	Triple Pipe	Quad. Pipe	Single Pipe	Double Pipe	Triple Pipe	Quad. Pipe
1/2 Slope	15"	2'-7"	2.5	1.68	4.8	1.50	5'	1.23	4.33	6.36	9.50	12.08	1.04	0.35	0.54	0.74	0.94	21	24	27	29
	18"	2'-0"	2.5	2.24	4.74	2.00	5'	1.41	4.58	6.55	13.08	1.04	0.38	0.52	0.87	1.12	22	25	28	31	
	24"	3'-5"	2.5	3.35	5.25	3.00	5'	1.73	5.08	8.50	11.58	16.33	1.04	0.47	0.76	1.05	1.34	23	27	31	35
	30"	4'-3"	2.5	4.47	6.37	4.00	6'	2.00	5.58	9.33	14.08	18.33	1.04	0.57	0.96	1.31	1.77	25	30	35	39
	36"	5'-1"	2.5	5.59	8.09	5.00	9'	2.04	6.08	10.7	16.55	21.1	1.04	0.67	1.09	1.72	2.26	27	33	38	44
	42"	6'-0"	2.5	6.71	9.91	6.00	10'	2.45	6.58	12.58	18.58	24.58	1.04	0.78	1.48	2.17	2.87	29	36	42	49
	48"	6'-9"	2.5	7.83	11.83	7.00	11'	2.87	7.08	13.58	20.58	27.58	1.04	0.89	1.71	2.54	3.35	31	38	46	53
	54"	7'-8"	2.5	8.94	13.84	8.00	12'	3.28	7.58	15.58	22.58	30.58	1.04	1.02	1.94	3.00	4.14	33	41	50	58
	60"	8'-6"	2.5	10.06	15.86	9.00	13'	3.00	8.08	16.58	25.08	33.58	1.04	1.14	2.38	3.63	4.89	34	44	53	63
	4/1 Slope	15"	2'-7"	2.5	3.09	5.59	3.0	7.0	1.23	4.33	6.36	9.50	12.08	1.04	0.44	0.68	0.9	1.15	22	25	28
18"		2'-0"	2.5	4.12	6.89	4.0	8.0	1.41	4.58	6.55	13.08	1.04	0.49	0.77	1.03	1.31	24	27	30	34	
24"		3'-5"	2.5	6.18	8.68	6.0	10.0	1.73	5.08	8.50	11.58	16.33	1.04	0.65	1.09	1.38	1.77	27	30	34	38
30"		4'-3"	2.5	8.25	10.75	8.0	12.0	2.00	5.58	9.33	14.08	18.33	1.04	0.81	1.34	1.90	2.44	29	32	36	41
36"		5'-1"	2.5	10.31	12.81	10.0	14.0	2.24	6.08	10.7	16.55	21.1	1.04	0.97	1.68	2.41	3.14	32	36	41	47
42"		6'-0"	2.5	12.37	14.87	12.0	16.0	2.45	6.58	12.58	18.58	24.58	1.04	1.13	2.00	3.06	4.02	33	42	48	55
48"		6'-9"	2.5	14.43	16.93	14.0	18.0	2.87	7.08	13.58	20.58	27.58	1.04	1.29	2.49	3.69	4.88	34	46	53	61
54"		7'-8"	2.5	16.49	18.99	16.0	20.0	3.28	7.58	15.58	22.58	30.58	1.04	1.48	2.98	4.47	5.98	37	49	58	68
60"		8'-6"	2.5	18.55	21.05	18.0	22.0	3.00	8.08	16.58	25.08	33.58	1.04	1.66	3.49	5.31	7.13	41	53	63	72

■ See General Note No. 3.  
See Sheet 5 of 6 For 3" Slab Quantities



TOP VIEW - SINGLE PIPE

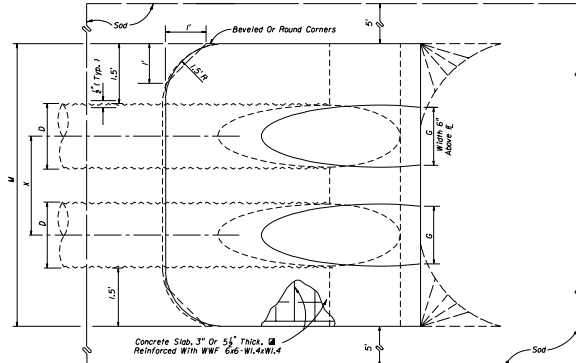

TOP VIEW - MULTIPLE PIPE

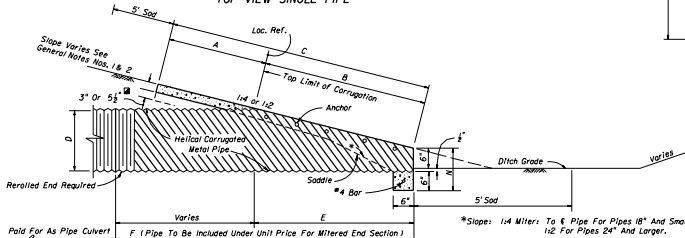

SECTION

NOTE: See Sheet 6 For Details And Notes.

\*Slope: 1/4 Miter: To 6" Pipe For Pipes 18" And Smaller, 1/2" For Pipes 24" And Larger.

1/2 Miter: To 6" Pipe For Pipes 18" And Smaller, 1/4" For Pipes 24" And Larger.

STATE OF FLORIDA DEPARTMENT OF TRANSPORTATION  
ROAD DESIGN

CROSS DRAIN  
MITERED END SECTION  
SINGLE AND MULTIPLE ROUND CORRUGATED METAL PIPE

DESIGNED BY	DATE	APPROVED BY	
CHK	06/78	[Signature]	STATE OF FLORIDA
DRAWN BY		CHECKED BY	FORM NO.
CHK	06/78	00	2 of 6

1974 AASHTO

## DIMENSIONS AND QUANTITIES

SLOPE	DRAIN PIPE	K	A	B	C	E	F	G	M				N	5 1/2" CONCRETE SLAB (CY) ■				SODDING (SQ. YDS.)				
									Single Pipe	Double Pipe	Triple Pipe	Quad. Pipe		Single Pipe	Double Pipe	Triple Pipe	Quad. Pipe	Single Pipe	Double Pipe	Triple Pipe	Quad. Pipe	
1/2	17"	2'-6"	2'-5"	1'-0"	3'-0"	1'-0"	4'	1'-39"	4.50	7.00	9.50	12.00	1.04	0.41	0.61	0.81	1.02	21	23	26	29	
	20"	2'-0"	2'-5"	1'-0"	1'-68"	4'-7"	1'-50"	5'	1'-76"	4.83	7.60	10.50	13.33	1.04	0.43	0.66	0.88	1.10	22	25	28	31
	24"	2'-0"	2'-5"	2'-5"	5'-11"	2'-33"	5'	2'-39"	5'-45"	8.83	12.25	15.60	19.00	1.04	0.51	0.73	1.05	1.33	23	26	30	34
	30"	4'-0"	2'-5"	3'-35"	3'-85"	8'-00"	9'	2'-55"	2'-00"	10.00	14.00	18.00	22.00	1.04	0.59	0.80	1.02	1.25	24	29	33	38
	36"	4'-9"	2'-5"	4'-29"	6'-79"	3'-83"	8'	2'-37"	6'-58"	11.33	16.00	20.83	25.67	1.04	0.64	1.04	1.46	1.87	26	31	37	42
	42"	3'-3"	2'-5"	6'-03"	4'-50"	9'	1'-34"	12'-51"	12'-51"	12.50	18.77	23.67	28.67	1.04	0.71	1.12	1.52	1.92	28	34	40	46
	51"	3'-6"	2'-5"	5'-36"	8'-46"	5'-33"	8'	1'-65"	14.77	7.83	14.77	20.50	26.83	1.04	0.83	1.44	2.04	2.64	29	36	44	51
	64"	4'-3"	7'-10"	2'-5"	6'-89"	9'-39"	6'-11"	11'	3.89	8.42	15.50	22.58	29.67	1.04	0.95	1.67	2.39	3.31	31	39	47	55
	71"	4'-7"	7'-10"	2'-5"	7'-64"	10'-4"	6'-83"	12'	4.14	9.00	16.83	24.67	32.50	1.04	1.05	1.89	2.74	3.57	33	41	50	59
	1/4	17"	3'-6"	2'-5"	2'-4"	4'-9"	2'-33"	7'	1'-39"	4.50	7.00	9.50	12.00	1.04	0.48	0.71	0.95	1.18	22	25	27	30
20"		2'-0"	2'-5"	3'-09"	5'-59"	3'-00"	8'	1'-76"	5.59	7.50	10.50	13.33	1.04	0.52	0.80	1.09	1.31	23	26	28	31	
24"		2'-0"	2'-5"	4'-81"	7'-31"	4'-20"	9'	2'-39"	5'-45"	8.83	12.25	15.60	19.00	1.04	0.61	0.92	1.27	1.59	25	29	33	37
30"		4'-0"	2'-5"	6'-18"	8'-68"	6'-00"	11'	2'-55"	6.00	10.00	14.00	18.00	1.04	0.73	1.14	1.55	1.97	28	32	37	41	
36"		4'-9"	2'-5"	7'-30"	10'-40"	7'-61"	12'	2'-37"	6.58	11.33	16.00	20.83	1.04	0.87	1.39	1.91	2.45	30	35	41	46	
42"		3'-3"	2'-5"	9'-26"	11'-76"	9'-00"	14'	1'-34"	14.77	12.50	18.77	23.67	1.04	1.00	1.66	2.36	3.05	32	38	45	51	
51"		3'-6"	2'-5"	11'-00"	13'-50"	10'-69"	16'	1'-65"	14.77	7.83	14.77	20.50	26.83	1.04	1.18	2.00	2.82	3.64	35	42	49	56
64"		4'-3"	7'-10"	2'-5"	12'-71"	15-21"	12'-33"	17'	3.89	8.42	15.50	22.58	29.67	1.04	1.36	2.39	3.38	4.38	38	46	53	61
71"		4'-7"	7'-10"	2'-5"	14-09"	16-57"	13-07"	19'	4.14	9.00	16.83	24.67	32.50	1.04	1.50	2.65	3.68	4.87	40	48	57	66

■ See General Note No. 3.  
See Sheet 5 Of 6 For 3" Slab Quantities

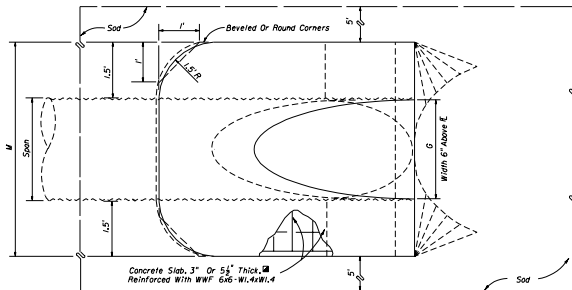

TOP VIEW - SINGLE PIPE

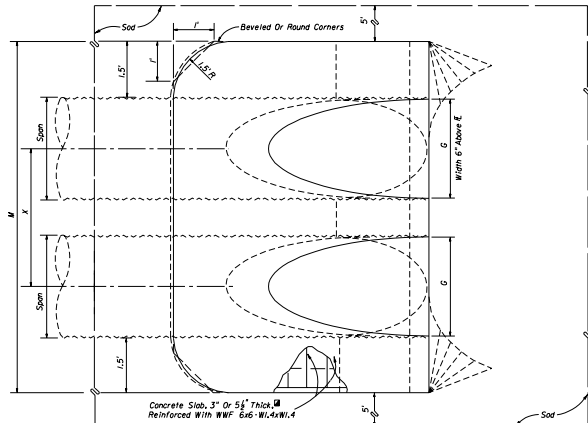

TOP VIEW - MULTIPLE PIPE

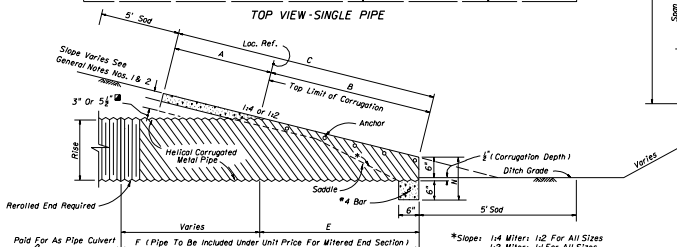

SECTION

\*Slope: 1/4 Meters: 1/2 For All Sizes  
1/2 Meters: 1/4 For All Sizes.

NOTE: See Sheet 6 For Details And Notes.

STATE OF FLORIDA DEPARTMENT OF TRANSPORTATION  
ROAD DESIGN

CROSS DRAIN  
MITERED END SECTION  
SINGLE AND MULTIPLE CORRUGATED METAL PIPE - ARCH

Revised By	DCR	08/78	Approved By	J. A. McPherson
Drawn By	KW	06/78	Checked By	W. J. McPherson
Designed By	DD		Scale	

3 of 6 272

DIMENSIONS & QUANTITIES																					
Rise ft	Span ft	x	A	B	C	E	F	G	M				N	5' CONC. SLAB (CY) <sup>1</sup>				SODDING (SQ. YDS.)			
									Single Pipe	Double Pipe	Triple Pipe	Quad. Pipe		Single Pipe	Double Pipe	Triple Pipe	Quad. Pipe	Single Pipe	Double Pipe	Triple Pipe	Quad. Pipe
1/2	18	2'-2 1/4"	1.97	1.62	1.59	1.56	4	1.50	4.30	7.71	13.58	13.42	1.20	0.45	0.68	0.92	1.14	24	28	29	19
1/4	18	3'-4"	2.07	1.99	2.00	1.99	5	1.50	4.30	8.77	15.04	14.36	1.23	0.53	0.81	1.02	27	32	33	20	
3/8	18	4'-0"	2.16	2.06	2.03	2.02	6	1.50	4.30	9.74	16.19	15.42	1.26	0.58	0.87	1.06	29	34	35	21	
1/2	18	4'-6"	2.24	2.12	2.07	2.06	7	1.50	4.30	10.71	17.34	16.57	1.29	0.63	0.96	1.13	31	36	37	22	
3/4	18	5'-0"	2.32	2.19	2.13	2.12	8	1.50	4.30	11.68	18.49	17.72	1.32	0.68	1.04	1.18	33	38	39	23	
1	18	5'-6"	2.40	2.26	2.19	2.18	9	1.50	4.30	12.65	19.64	18.87	1.35	0.73	1.11	1.21	35	40	41	24	
1 1/4	18	6'-0"	2.48	2.32	2.24	2.23	10	1.50	4.30	13.62	20.79	19.96	1.38	0.78	1.18	1.24	37	42	43	25	
1 1/2	18	6'-6"	2.56	2.38	2.29	2.28	11	1.50	4.30	14.59	21.94	21.03	1.41	0.83	1.21	1.27	39	44	45	26	
1 3/4	18	7'-0"	2.64	2.44	2.34	2.33	12	1.50	4.30	15.56	23.09	22.18	1.44	0.88	1.24	1.30	41	46	47	27	
2	18	7'-6"	2.72	2.50	2.39	2.38	13	1.50	4.30	16.53	24.24	23.33	1.47	0.93	1.27	1.33	43	48	49	28	
2 1/4	18	8'-0"	2.80	2.58	2.46	2.45	14	1.50	4.30	17.50	25.39	24.48	1.50	0.98	1.30	1.36	45	50	51	29	
2 1/2	18	8'-6"	2.88	2.66	2.53	2.52	15	1.50	4.30	18.47	26.54	25.63	1.53	1.03	1.33	1.39	47	52	53	30	
2 3/4	18	9'-0"	2.96	2.74	2.61	2.60	16	1.50	4.30	19.44	27.69	26.78	1.56	1.08	1.36	1.42	49	54	55	31	
3	18	9'-6"	3.04	2.82	2.68	2.67	17	1.50	4.30	20.41	28.84	27.93	1.59	1.13	1.39	1.46	51	56	57	32	
3 1/4	18	10'-0"	3.12	2.90	2.75	2.74	18	1.50	4.30	21.38	29.99	29.02	1.62	1.18	1.42	1.50	53	58	59	33	
3 1/2	18	10'-6"	3.20	2.98	2.81	2.80	19	1.50	4.30	22.35	31.14	30.17	1.65	1.23	1.45	1.54	55	60	61	34	
3 3/4	18	11'-0"	3.28	3.06	2.88	2.87	20	1.50	4.30	23.32	32.29	31.32	1.68	1.28	1.48	1.58	57	62	63	35	
4	18	11'-6"	3.36	3.14	2.95	2.94	21	1.50	4.30	24.29	33.44	32.47	1.71	1.33	1.51	1.62	59	64	65	36	
4 1/4	18	12'-0"	3.44	3.22	3.02	3.01	22	1.50	4.30	25.26	34.59	33.60	1.74	1.38	1.54	1.66	61	66	67	37	
4 1/2	18	12'-6"	3.52	3.30	3.09	3.08	23	1.50	4.30	26.23	35.74	34.71	1.77	1.43	1.57	1.70	63	68	69	38	
4 3/4	18	13'-0"	3.60	3.38	3.16	3.15	24	1.50	4.30	27.20	36.89	35.82	1.80	1.48	1.60	1.74	65	70	71	39	
5	18	13'-6"	3.68	3.46	3.23	3.22	25	1.50	4.30	28.17	38.04	36.93	1.83	1.53	1.63	1.78	67	72	73	40	
5 1/4	18	14'-0"	3.76	3.54	3.30	3.29	26	1.50	4.30	29.14	39.19	38.06	1.86	1.58	1.66	1.82	69	74	75	41	
5 1/2	18	14'-6"	3.84	3.62	3.37	3.36	27	1.50	4.30	30.11	40.34	39.19	1.89	1.63	1.69	1.86	71	76	77	42	
5 3/4	18	15'-0"	3.92	3.70	3.44	3.43	28	1.50	4.30	31.08	41.49	40.34	1.92	1.68	1.72	1.90	73	78	79	43	
6	18	15'-6"	4.00	3.78	3.51	3.50	29	1.50	4.30	32.05	42.64	41.49	1.95	1.73	1.75	1.94	75	80	81	44	

See General Note No. 3.  
See Sheet 5 Of 6 For 3' Slab Quantities

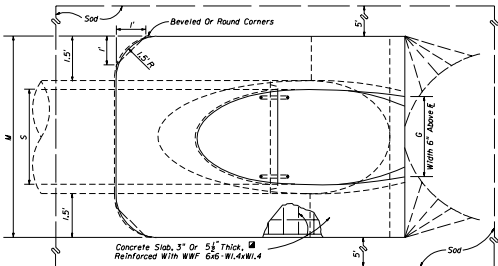

TOP VIEW - SINGLE PIPE

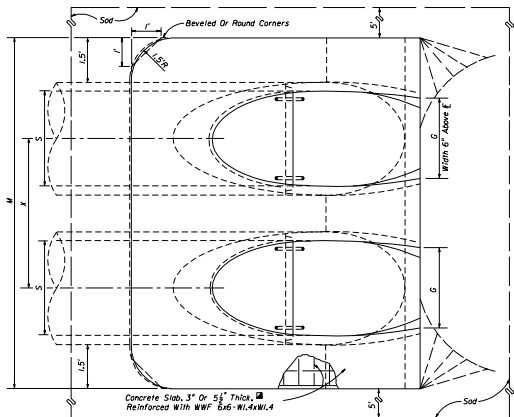

TOP VIEW - MULTIPLE PIPE

NOTE: See Sheet 6 For Details And Notes.

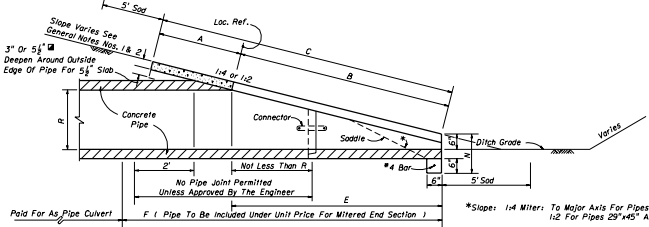

SECTION

\*Slope: 1/4 Miter: To Major Axis For Pipes 24"x38" And Smaller.  
1/2 For Pipes 29"x45" And Larger.  
1/2 Miter: To Major Axis For Pipes 29"x45" And Smaller.  
1/4 For Pipes 34"x53" And Larger.

STATE OF FLORIDA DEPARTMENT OF TRANSPORTATION ROAD DESIGN			
<b>CROSS DRAIN MITERED END SECTION</b>			
SINGLE AND MULTIPLE ELLIPTICAL CONCRETE PIPE			
Revised By	DATE	Approved By	
Drawn By	DATE	Checked By	
Checked By	DATE	Scale	
			272

QUANTITIES FOR 3" THICK CONCRETE SLABS (CY)

	D	ROUND-CONCRETE			
		Single Pipe	Double Pipe	Triples Pipe	Quad. Pipe
1:2 Slope	15"	0.27	0.41	0.54	0.67
	18"	0.31	0.45	0.60	0.75
	24"	0.39	0.59	0.79	1.00
	30"	0.46	0.76	1.04	1.32
	36"	0.55	0.94	1.33	1.71
	42"	0.66	1.15	1.66	2.15
	48"	0.76	1.37	1.96	2.57
	54"	0.87	1.62	2.38	3.14
1:4 Slope	60"	0.99	1.90	2.81	3.73
	66"	1.11	2.15	3.21	4.27
	72"	1.24	2.46	3.68	4.90
	15"	0.40	0.61	0.80	1.00
	18"	0.47	0.69	0.91	1.14
	24"	0.60	0.90	1.20	1.52
	30"	0.76	1.19	1.63	2.07
	36"	0.89	1.48	2.05	2.63
42"	1.05	1.82	2.57	3.34	
48"	1.21	2.15	3.07	4.00	
54"	1.39	2.55	3.72	4.88	
60"	1.59	3.02	4.44	5.86	
66"	1.81	3.66	5.40	7.15	
72"	2.12	4.48	6.24	8.30	

	D	ROUND-CMP			
		Single Pipe	Double Pipe	Triples Pipe	Quad. Pipe
1:2 Slope	15"	0.24	0.37	0.51	0.64
	18"	0.26	0.43	0.61	0.78
	24"	0.32	0.52	0.72	0.91
	30"	0.38	0.64	0.91	1.18
	36"	0.44	0.78	1.13	1.48
	42"	0.51	0.96	1.41	1.87
	48"	0.57	1.09	1.63	2.15
	54"	0.65	1.32	1.99	2.66
1:4 Slope	60"	0.71	1.49	2.28	3.07
	15"	0.31	0.47	0.63	0.79
	18"	0.34	0.53	0.71	0.90
	24"	0.44	0.69	0.92	1.18
	30"	0.53	0.88	1.25	1.60
	36"	0.62	1.07	1.53	2.00
	42"	0.71	1.30	1.92	2.52
	48"	0.80	1.54	2.29	3.02
54"	0.91	1.83	2.74	3.67	
60"	1.02	2.15	3.27	4.39	

	Slope	Rise	CMP-ARCH			
			Single Pipe	Double Pipe	Triples Pipe	Quad. Pipe
1:2 Slope		17" 13"	0.33	0.49	0.65	0.81
		20" 15"	0.33	0.50	0.67	0.83
		28" 20"	0.37	0.56	0.76	0.95
		35" 24"	0.40	0.62	0.84	1.07
		42" 29"	0.43	0.70	0.98	1.25
		49" 33"	0.49	0.82	1.15	1.48
		57" 39"	0.55	0.95	1.35	1.75
		64" 43"	0.62	1.10	1.57	2.05
1:4 Slope		17" 13"	0.38	0.56	0.74	0.92
		21" 15"	0.39	0.59	0.80	0.95
		28" 20"	0.43	0.64	0.88	1.10
		35" 24"	0.49	0.77	1.05	1.33
		42" 29"	0.57	0.92	1.27	1.62
		49" 33"	0.65	1.08	1.50	1.93
		57" 39"	0.76	1.30	1.83	2.37
		64" 43"	0.87	1.55	2.18	2.83
71" 47"	0.95	1.68	2.43	3.17		

	Slope	Rise	ELLIPTICAL-CONCRETE			
			Single Pipe	Double Pipe	Triples Pipe	Quad. Pipe
1:2 Slope		18" 18"	0.19	0.33	0.45	0.57
		18" 23"	0.25	0.40	0.55	0.69
		19" 30"	0.34	0.55	0.75	0.95
		24" 38"	0.43	0.71	1.00	1.28
		29" 45"	0.52	0.90	1.27	1.65
		34" 53"	0.62	1.11	1.60	2.09
		39" 60"	0.70	1.29	1.87	2.46
		43" 68"	0.81	1.54	2.26	2.99
1:4 Slope		48" 76"	0.93	1.79	2.66	3.53
		53" 83"	1.04	2.04	3.03	4.02
		58" 91"	1.17	2.33	3.49	4.66
		18" 18"	0.30	0.45	0.61	0.76
		18" 23"	0.36	0.56	0.76	0.95
		19" 30"	0.51	0.79	1.08	1.36
		24" 38"	0.68	1.10	1.53	1.96
		29" 45"	0.86	1.45	2.04	2.63
34" 53"	1.02	1.81	2.60	3.39		
38" 60"	1.18	2.14	3.01	4.05		
43" 68"	1.38	2.58	3.79	4.99		
48" 76"	1.59	3.05	4.51	5.97		
53" 83"	1.80	3.50	5.19	6.88		
58" 91"	2.04	4.04	6.05	8.05		

STATE OF FLORIDA DEPARTMENT OF TRANSPORTATION  
ROAD DESIGN

CROSS DRAIN  
MITERED END SECTION

Designed By	Drawn By	Checked By	Approved By
am	am	am	<i>A. A. Williams</i>
DATE: 05/06	DATE: 05/06	DATE: 05/06	DATE: 05/06
SCALE: 1"=10'	SCALE: 1"=10'	SCALE: 1"=10'	SCALE: 1"=10'
SHEET NO. 5 OF 6			PROJECT NO. 272

## GENERAL NOTES

- Mitered end sections for pipe sizes 15", 18" and 24" round or equivalent pipe arch or elliptical pipe are permitted within the clear zone. When the slope intersection permits, the mitered end section may be located with the culvert opening as close as 8' beyond the outside edge of the shoulder.
- Slope and ditch transitions shall be used when the normal roadway slope must be flattened to place end section outside clear zone. See detail left.
- The reinforced concrete slab shall be constructed for all sizes of cross drain pipe and cast in place with Class I concrete. Slabs shall be  $5\frac{1}{2}$ " thick unless 3" thickness called for in plans.
- Concrete pipe used in the assembly of mitered end sections shall be selective lengths to avoid excessive connections.
- Corrugated metal pipe galvanizing that is damaged during beveling and perforating for mitered end section shall be repaired.
- The portion of corrugated metal pipe in direct contact with the concrete slab shall be bituminous coated prior to placing of the concrete.
- Unless otherwise designated in the plans, concrete pipe mitered end sections may be used with any type of cross drain pipe; corrugated steel pipe mitered end sections may be used with any type of cross drain pipe except aluminum pipe; and, corrugated aluminum mitered end sections may be used with any type of cross drain pipe except steel pipe. When bituminous coated metal pipe is specified for cross drain pipe, mitered end sections shall be constructed with the pipe or concrete pipe.
- When the mitered end section pipe is dissimilar to the cross drain pipe, a concrete jacket shall be constructed in accordance with Standard Index 280.
- When existing multiple cross drain pipes are spaced other than the dimensions shown in this detail, or have non-parallel axes, or have non-uniform sections, the mitered end sections will be constructed either separately as single pipe mitered end sections or collectively as multiple pipe end sections as directed by the Engineer; however, mitered end sections will be paid for each based on each independent pipe end.
- The cost of all pipe(s), fasteners, reinforcing, connectors, anchors, concrete, sealants, jackets, and coupling bands shall be included in the cost for the mitered end section. Soding shall be paid for separately under the contract unit price of Soding, ST.
- Mitered end sections shall be paid for under the contract unit price for Mitered End Section (CD). Each, based on each independent pipe end.

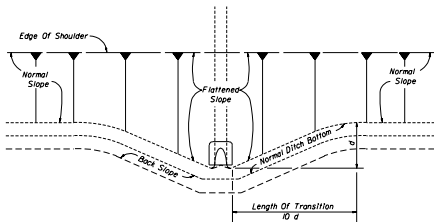

PLAN

NOTE: See General Note 2

### SLOPE AND DITCH TRANSITIONS

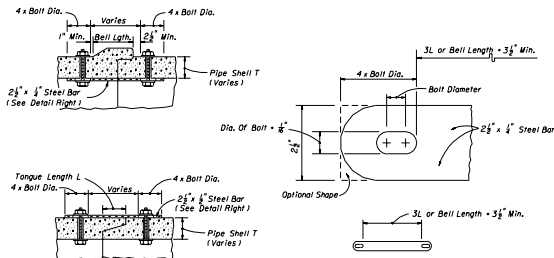

All bars, bolts, nuts and washers are to be galvanized steel.  
Bolt diameters shall be  $\frac{3}{8}$ " for 15" to 36" pipe and  $\frac{1}{2}$ " for 42" to 72" pipe.  
Two connectors required per joint, located 60° right and left of bottom center of pipe.  
Bolt holes in pipe shell are to be drilled.

### CONCRETE PIPE CONNECTOR

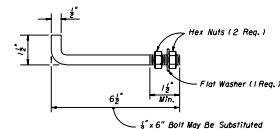

Anchors required for CMP only.

Anchor, washer and nuts to be galvanized steel.

Bend anchor where required to center in concrete slab. Damaged surfaces to be repaired after bending. Anchors are to be spaced a distance equal to four (4) corrugations. Place the anchors in the outside crest of corrugation.

Flat washers to be placed on inside wall of pipe.

Holes in the mitered end pipe are to be drilled or punched; burning not permitted.

### ANCHOR DETAIL

STATE OF FLORIDA DEPARTMENT OF TRANSPORTATION  
ROAD DESIGN

### CROSS DRAIN MITERED END SECTION SPECIAL DETAILS AND NOTES

DESIGNED BY	DATE	APPROVED BY
DCB	06/78	A. A. McManus
DRAWN BY		STATE OF FLORIDA DEPARTMENT OF TRANSPORTATION
CHECKED BY	06/78	DD
		6 of 6
		272