

PIPE SIZE	L	GRATE QUANTITIES			
		BILL OF STEEL		STEEL WEIGHT	
		BAR No. REQ'D.	LENGTH	CHANNEL 4" x 5.4"	FLAT 2" x 3/4" (3,4#)
30" x 36"	4'-9"	3	4'-4"	70	30
	A	2	4'-4"		52
	B	3	5'-1"	94	30
42" x 48"	6'-0"	B	4'-4"		65
	A	2	4'-4"		30
	C	3	6'-4"	117	65
54" x 60"	7'-3"	A	4'-4"		30
	B	2	4'-4"		77
	C	3	7'-7"	140	30
66" x 72"	8'-6"	A	4'-4"		30
	B	2	4'-4"		90
	C	3	8'-10"	164	30
SPECIAL 9'-9"	A	2	4'-4"		30
	B	2	10'-1"	187	103
SPECIAL 11'-0"	A	2	4'-4"		30
	B	2	11'-4"	211	116
SPECIAL 12'-3"	A	2	4'-4"		30
	B	2	12'-7"	234	128
SPECIAL 13'-6"	A	2	4'-4"		30
	B	2	13'-10"	257	141
SPECIAL 14'-9"	A	2	4'-4"		30
	B	2	15'-1"	281	154
SPECIAL 16'-0"	A	2	4'-4"		30
	B	2	16'-4"	304	167
SPECIAL 17'-3"	A	2	4'-4"		30
	B	2	17'-7"	328	179
SPECIAL 18'-6"	B	2	4'-4"		30
	C	3	18'-10"	352	192

GENERAL NOTES

- This Inlet is to be used at locations having high flow rates, usually where an endwall could not be utilized without hazardous intake.
- Inlet length (L) shall be set by the designer for the greater of either culvert requirement or inlet pool not to exceed 12" depth. Structures over 6' in depth are to be checked for flotation by the designer of project drainage.
- This inlet is not intended for use with Alternate B structure bottoms.
- Inlet and anti-vortex wall to be Class I Concrete.
- Reinforcing - #4 bars at 12" centers both ways for pipe sizes up to 72" diameters, 1/2" clearance to inside face and bottom of inlet. See Index 200, 5h & 4 for right steel modification for depths 13' to 15'. Bend top and corner bars to clear anchor holes. Inlets for special size pipe require special reinforcement design and design approval by the project design engineer.
- Channel section C 3 x 6 may be used as an alternate for the C 4 x 5.4 channel.
- Channels and bars shall be ASTM A242/A242M, A572/A572M or A588/A588M, Grade 50 steel, and galvanized in accordance with Section 962-7 of the Standard Specifications.
- Fence enclosure shall be Fence Type B (Index No. 452 L). All posts to be set in concrete. A minimum of 10 posts required. Corner and approach side posts to be 1" nominal diameter.
- Cast of ditch paving, anti-vortex wall, grate, concrete, reinforcing steel and fence enclosure to be included in the cost of inlet. Inlet to be paid for under the contract unit price for inlets (DT Bot) (Type K), Each.

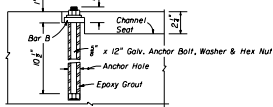
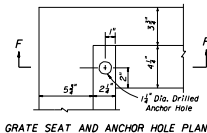
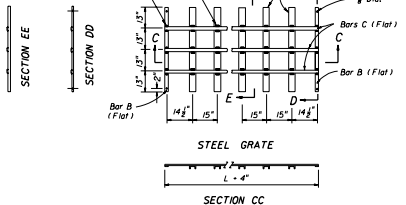

(With Bar B And Anchor Bolt)  
SECTION FF

STATE OF FLORIDA DEPARTMENT OF TRANSPORTATION  
ROAD DESIGN

DITCH BOTTOM INLET  
TYPE K

Drawn By	Checked By	Date	Scale	Project No.	Sheet No.	Sheet Total
SM	JB	6/79	00		1 of 1	235

Approved By: *J. A. McNamee*  
STATE OF FLORIDA HIGHWAY DEPARTMENT